

FLOORBOARD PAD KIT



P/N 2879606, 2884155

APPLICATION

Verify accessory fitment at www.indianmotorcycle.com.

BEFORE YOU BEGIN

Read these instructions and check to be sure all parts and tools are accounted for. Please retain these installation instructions for future reference and parts ordering information.

REQUIRED SOLD SEPARATELY

Bikes without factory installed floorboards.

Only parts for installation of the Indian Motorcycle® Floorboard Pad Kit are included. Prior installation of the following additional kits is also required (sold separately):

- *Standard Passenger Floor Board Kit*, P/N 2880293
- *Passenger Floor Board Mounts Kit*, P/N 2880288
- *Driver Floor Board Kit*, P/N 2889216

KIT CONTENTS

KIT PN 2879606

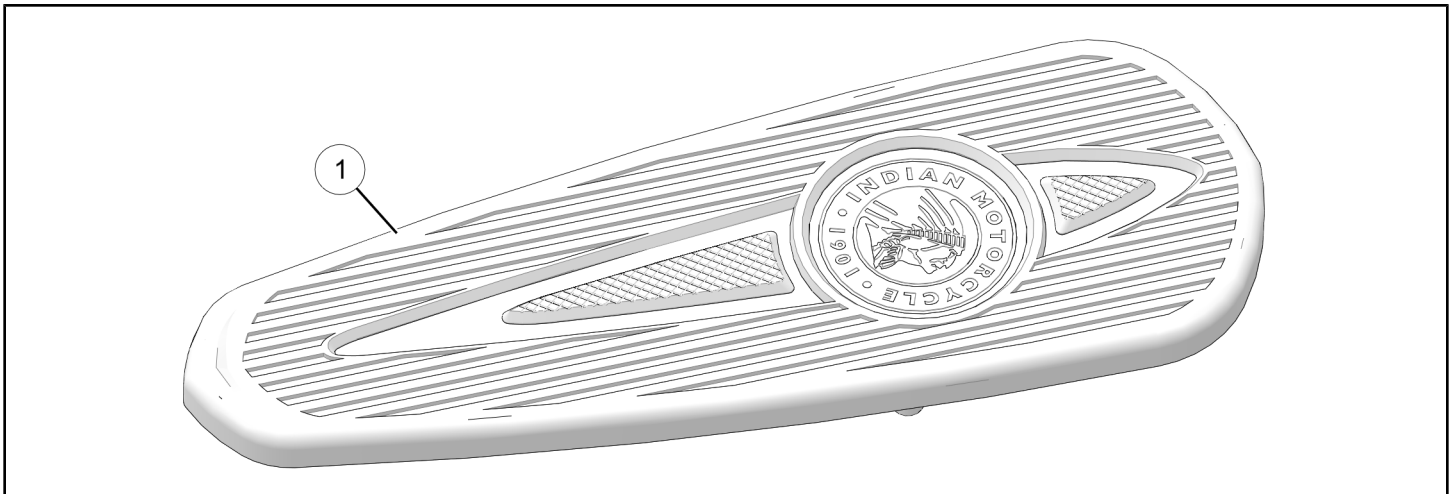

REF	QTY	PART DESCRIPTION	P/N AVAILABLE SEPARATELY
1	2	Floorboard Pads, Driver (Kit PN 2879606)	1019992

KIT PN 2884155

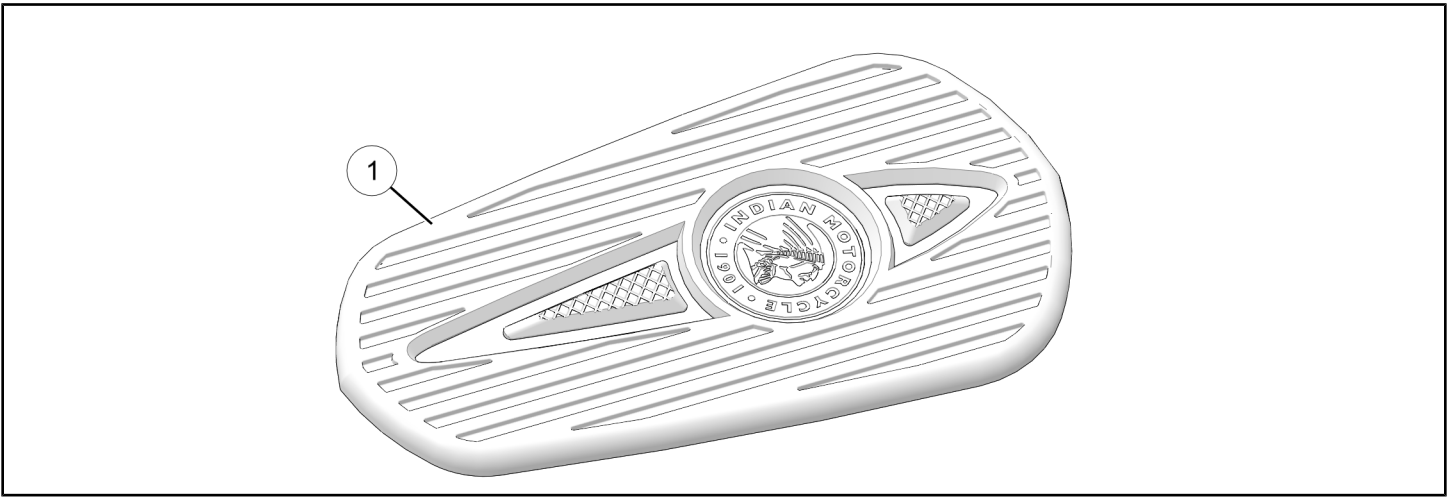

REF	QTY	PART DESCRIPTION	P/N AVAILABLE SEPARATELY
1	2	Floorboard Pads, Passenger (Kit PN 2884155)	1024874

TOOLS REQUIRED

None

IMPORTANT

Your Indian Motorcycle® Floorboard Pad Kit is exclusively designed for your vehicle. Please read the installation instructions thoroughly before beginning. Installation is easier if the vehicle is clean and free of debris. For your safety, and to ensure a satisfactory installation, perform all installation steps correctly in the sequence shown.

INSTALLATION INSTRUCTIONS

VEHICLE PREPARATION

GENERAL

1. Turn key or ignition switch to **OFF** position and remove key. If equipped with keyless fob, remove fob from proximity of vehicle.
2. Ensure motorcycle is parked on a flat surface, kickstand is fully extended, and vehicle is stable prior to installation.

ACCESSORY INSTALLATION

REMOVE STOCK FLOORBOARD PADS

1. Remove driver and/or passenger floorboard pads by pushing rubber protrusions through underside of floorboard and pulling up on floorboard pads.

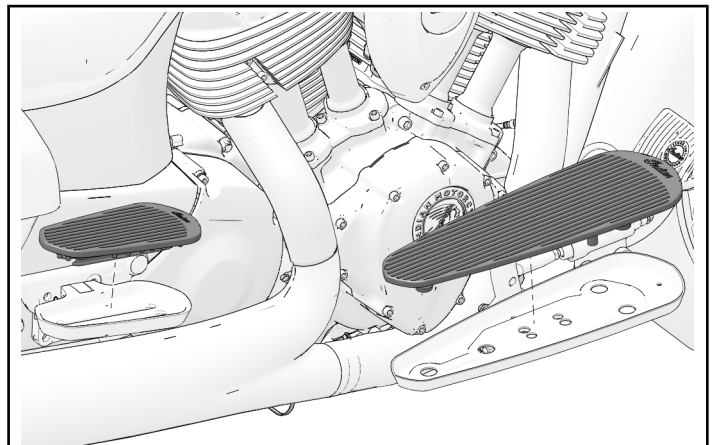

INSTALL NEW FLOORBOARD PADS

1. Install new floorboard pads into floorboards.
Push down from above to ensure full installation.

TIP

Apply soapy water to rubber protrusions to ease installation.

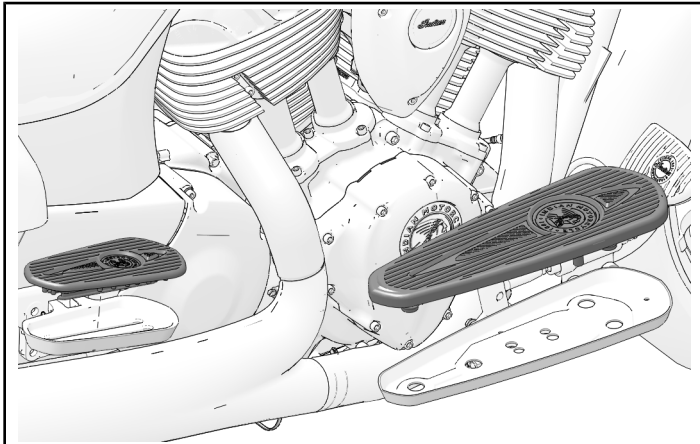

2. Ensure rubber protrusions are fully engaged with floorboard frame as shown.

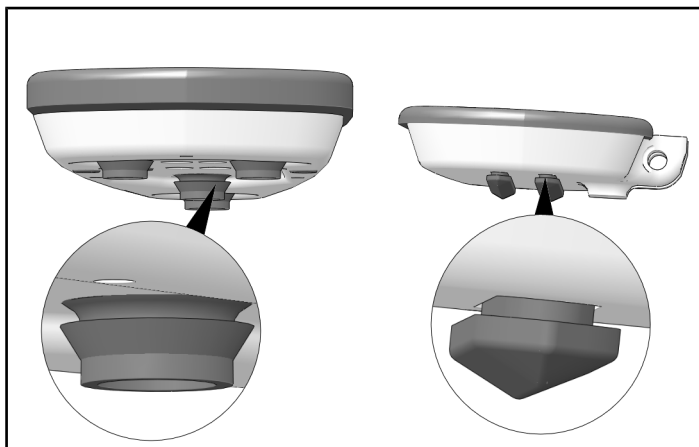

FEEDBACK FORM

A feedback form has been created for the installer to provide any comments, questions or concerns about the installation instructions. The form is viewable on mobile devices by scanning the QR code or by clicking [HERE](#) if viewing on a PC.

