



**WINCH  
MOUNT KIT  
For HONDA ATVs**

**OWNER'S MANUAL**

**MODEL NUMBER: 25-1161**

**CUSTOMER MUST RECEIVE A COPY OF THIS  
INSTRUCTION MANUAL AT TIME OF SALE**

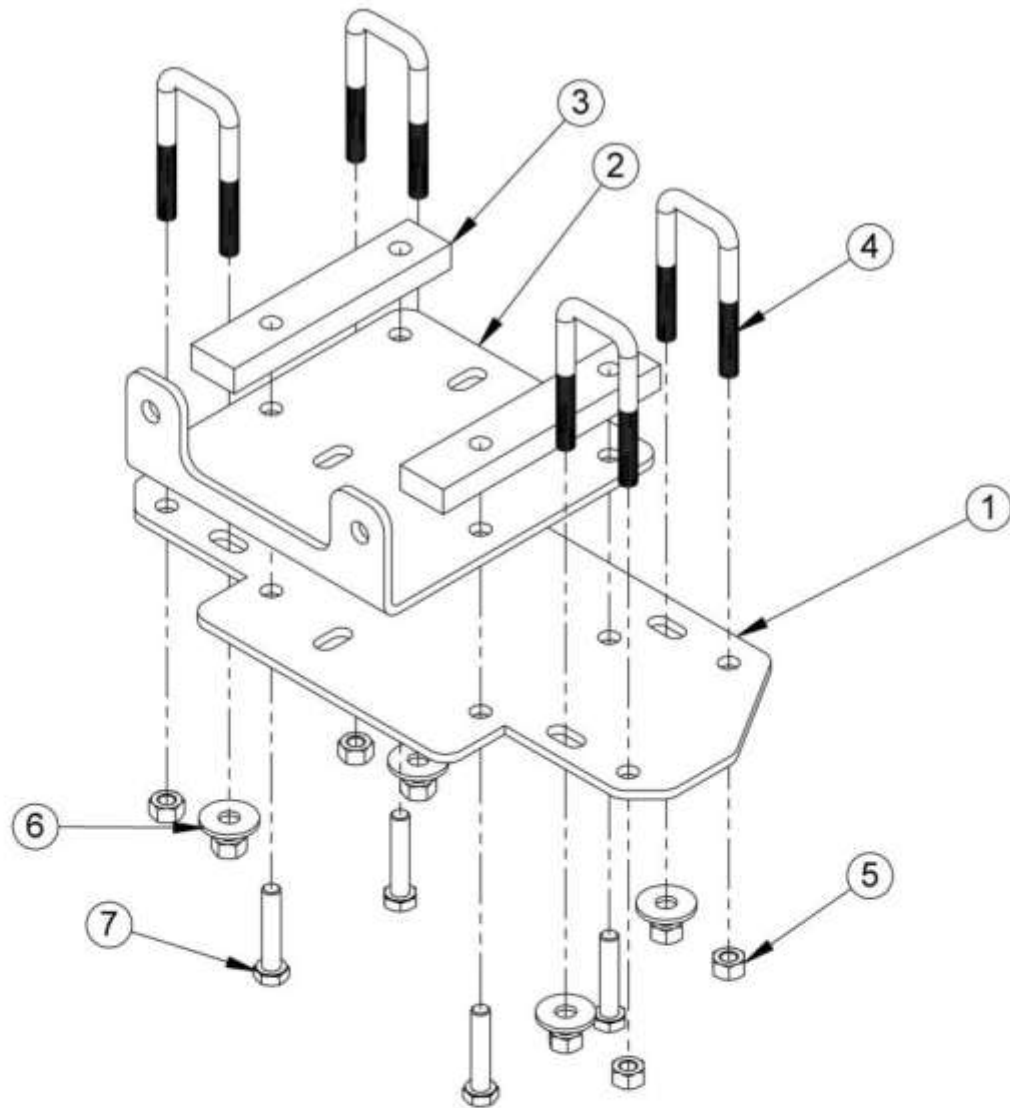

## Model Number 25-1161 Parts List

ITEM NO.	QTY.	PART NO.	DESCRIPTION
1	1	CYC5503	Winch Mount Plate
2	1	CYC5504	Roller Hawse Mount Plate
3	2	CYC5842	Winch Spacer
4	4	PUR3194	8mm X 30mm X 70mm Sq U-Bolt
5	8	PUR3068	Nylon Lock Nut M8
6	4	PUR3087	Flat Washer 8mm
7	4	PUR3015	Metric Bolt M8 x 40mm

## Hardware Package 5816

# THIS WINCH MOUNTING KIT CAN BE USED TO MOUNT EITHER A CYCLE COUNTRY 1500/2500 WINCH OR A WARN 1.5/15RT-XT/25RT-XT WINCH

All directions referring to right and left are when the rider is sitting on the machine. The roller hawse, cable clamp, cable stop, and hardware are included with the winch.

## MODEL NUMBER: 25-1161 WINCH MOUNT INSTALLATION INSTRUCTIONS

1. Remove lower plastic shroud. *See picture below.*

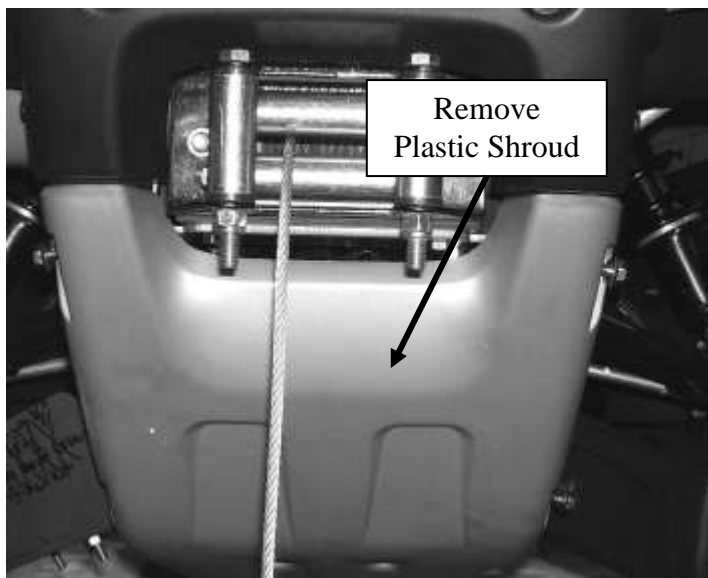

2. **Note: Skip steps 2 & 3 if your model is not equipped with the radiator shroud.** Remove three plastic push pins from one side of the radiator shroud (can be done on either side...left side shown) and remove plastic shroud. *See pictures below.*



3. Remove mesh radiator grill. *See picture below.*



4. Place the four U-bolts (Item 3) over the top of the bumper support braces. Insert the winch mount plate (Item 1) under the bottom of the bumper support braces with the center slots to the right side of the ATV. Attach to U-bolts with flatwashers and nylock nuts. Do not tighten at this time. Leave the winch mount plate hanging as low as possible to aid in winch installation. *See picture below.*

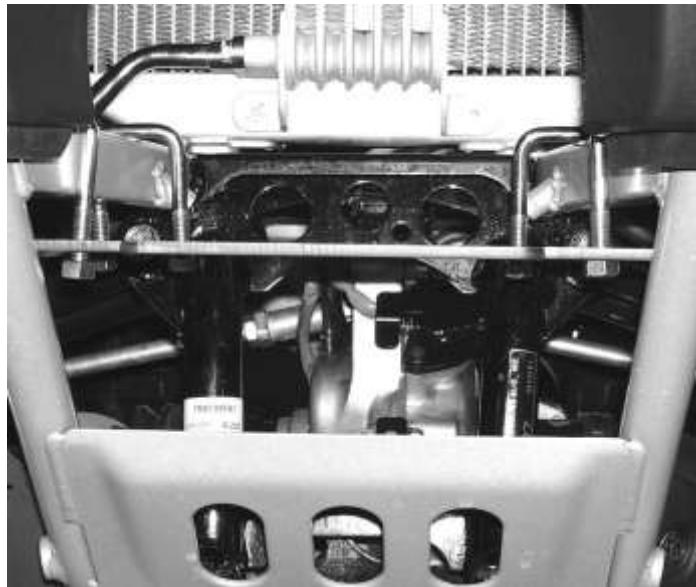

5. Go to instructions for your winch for winch installation. Note: use of spacers, and included bolts and flatwashers depends on each application.
6. Re-install mesh radiator grill, radiator side panel and lower plastic shroud removed in earlier steps.

## CYCLE COUNTRY 1500 WINCH MOUNTING INSTRUCTIONS

- I. **TRX 500 FA Rubicon 4x4:** Insert the Winch with the motor facing to the **LEFT** through the opening shown. (Note: The radiator mesh grill was removed to allow clearance for this step. Do not allow the winch to come in contact with the radiator or damage to the radiator may occur). Position the winch on top of the bumper support braces and then tighten the nylock nuts completely, pulling winch mount plate forward as far as possible during the tightening process. Go to Step III.

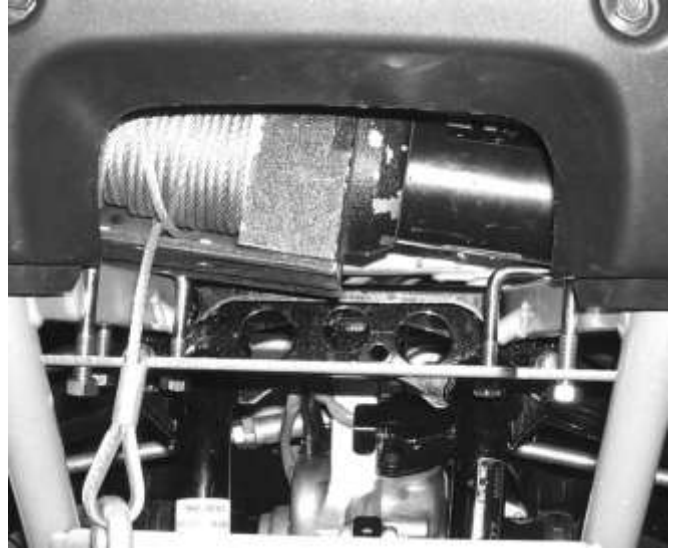

- II. **TRX 500 FPE Foreman 4x4 (Power Steering):** Insert the winch with the winch motor facing to the **LEFT**, through the opening shown below. Position the winch on top of the bumper support braces and then tighten the nylock nuts completely, pulling winch mount plate forward as far as possible during the tightening process. Go to Step III.

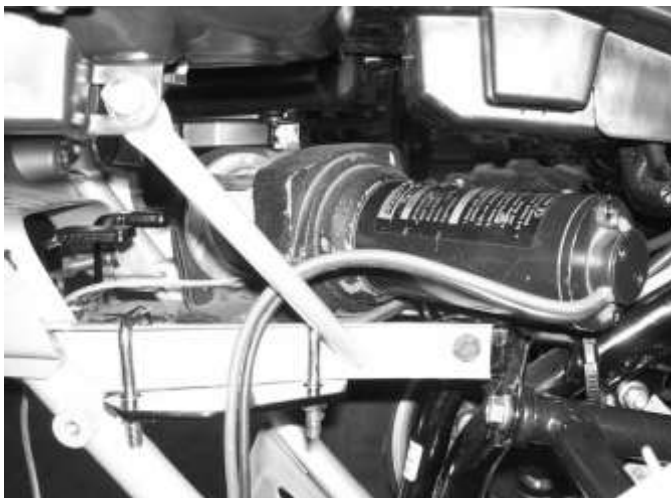

III. Insert the roller hawse mount plate (Item 2) between the winch mount plate (Item 1) and the winch. Set the winch onto the roller hawse mount plate, aligning the holes on the three components, using two M8 x 40mm bolts, two flatwashers and two nylock nuts. **Note:** The two spacers (Item 3), four 8x40 bolts (Item 8), two flatwashers (Item 6) and two lock nuts (Item 7) will not be used. Tighten at this time.

IV. GO TO ROLLER HAWSE INSTRUCTION ON PAGE 8.

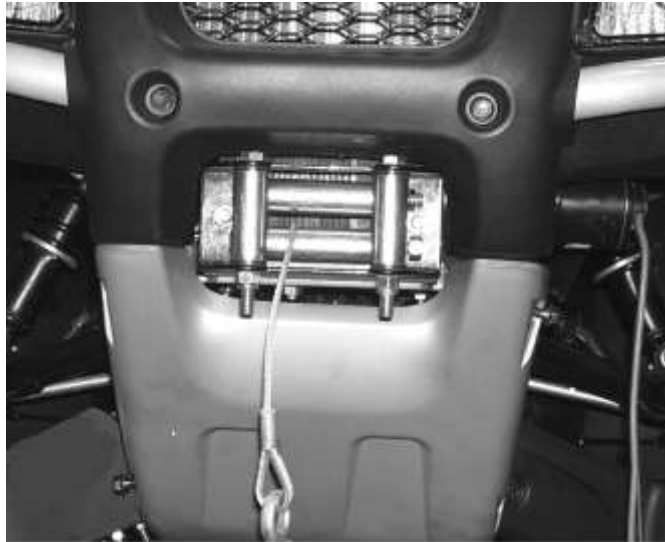

## CYCLE COUNTRY 2500 WINCH/WARN 2500 WINCH MOUNTING INSTRUCTIONS

- I. **TRX 500 FA Rubicon 4x4:** Insert the winch with the motor facing to the **RIGHT** through the opening shown. (Note: The radiator mesh grill was removed to allow clearance for this step. Do not allow the winch to come in contact with the radiator or damage to the radiator may occur). Position the winch on top of the bumper support braces and then tighten the nylock nuts completely, pulling winch mount plate forward as far as possible during the tightening process. Go to Step 3.

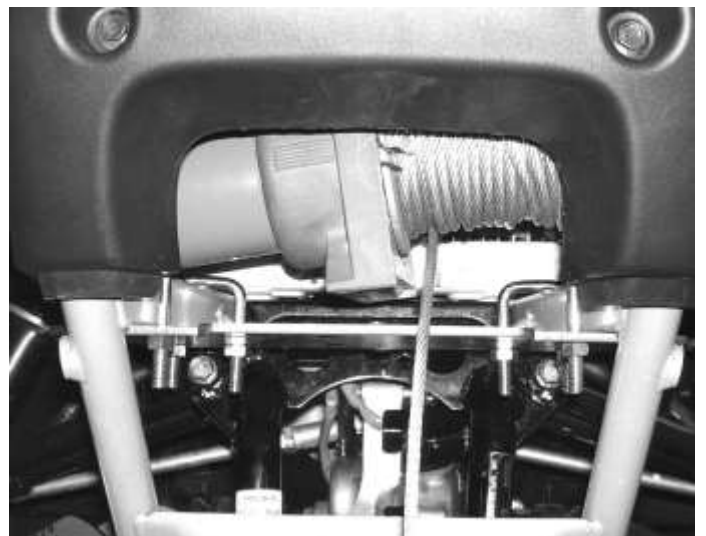

- II. **TRX 500 FPE Foreman 4x4 (Power Steering):** Insert the winch with the motor facing to the **RIGHT** through the opening shown below. Position the winch on top of the bumper support braces and then tighten the nylock nuts completely, pulling winch mount plate forward as far as possible during the tightening process. Go to Step III.



- III. Insert the roller hawse mount plate (Item 2) provided with the kit (the roller hawse mount plate provided with the winch will not be used) between the winch mount plate (Item 1) and the winch. Set the winch onto the roller hawse mount plate, aligning the holes on the three components, and using the four bolts PROVIDED WITH THE CYCLE COUNTRY WINCH, fasten them together. The two spacers, 8 bolts, four flatwashers, and four nylock nuts, will not be used. Tighten at this time.

- IV. GO TO ROLLER HAWSE INSTRUCTIONS ON PAGE 8.



## WARN 1.5/15RT-XT/25RT-XT WINCH MOUNTING INSTRUCTIONS

- Install winch spacers (Item 3) when using these Warn winches.
- Install the spacers between the winch and the roller hawse mount plate as shown on parts list. Orient the spacers with the longest gap to the mount hole to the front.
- For 1.5, 15RT & 15XT winches, use the M8 x 40mm bolts to mount the winch to the plates. For the 25RT & 25XT winches, use 8x40mm bolts and flatwashers to mount the winch to the plates.

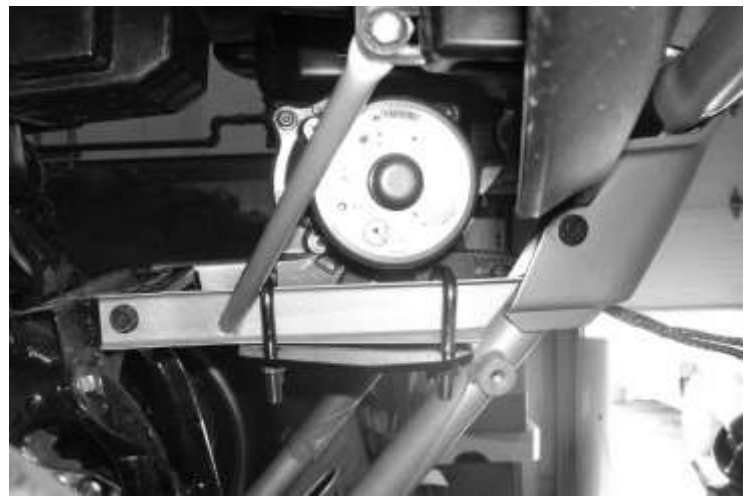

- GO TO ROLLER HAWSE INSTRUCTIONS BELOW

### ROLLER HAWSE INSTRUCTIONS

Remove one of the long rollers and feed the winch cable through the roller hawse. Reinstall the roller and be sure rollers move freely.

Attach the roller hawse to the roller hawse mount using the bolts and nylock nuts provided with the winch. Tighten all hardware.

Go to step 6 on page 4.

**See Winch Wiring Instructions supplied with the Winch for proper installation.**





## **One Year Limited Warranty**

For the period of one (1) year from the purchase date, Cycle Country (a Kolpin Powersports Brand) will replace for the original purchaser, free of charge, any part or parts found upon examination by Cycle Country to be defective in material, workmanship, or both.

All transportation costs incurred submitting product to Cycle Country for warranty consideration must be borne by the purchaser. If Cycle Country determines that the product must be returned to the factory for credit, please call 1-800-841-2222 for a Return Merchandise Authorization (RMA) number and shipping instructions.

This warranty does not apply to parts that have been damaged by accident, alteration, abuse, improper maintenance, normal wear, or other causes beyond the manufacturer's control. In order to protect you and your ATV, certain parts of the plow system and/or hardware are designed to fail when the equipment is over-stressed.

Peripheral products such as engines, electric motors, and actuators may carry an original manufacturer's warranty. Please call Cycle Country for more information.

**CYCLE COUNTRY**  
**(A KOLPIN POWERSPORTS BRAND)**  
**205 N DEPOT ST**  
**PO BOX 107**  
**FOX LAKE, WI 53933**  
**TOLL FREE: 800-841-2222**  
**FAX: 712-262-0248**  
**EMAIL: CCAC@CYCLECOUNTRY.COM**  
**WEBSITE: WWW.CYCLECOUNTRY.COM**