



WINCH MOUNT KIT

FOR HONDA PIONEER 700

P/N 25-1280

ASSEMBLY / OWNERS MANUAL

Application

WINCH KIT NO. 25-9xxx

Before you begin, please read these instructions and check to be sure all parts and tools are accounted for. The following instructions contain details required to install and service the contents of this kit.

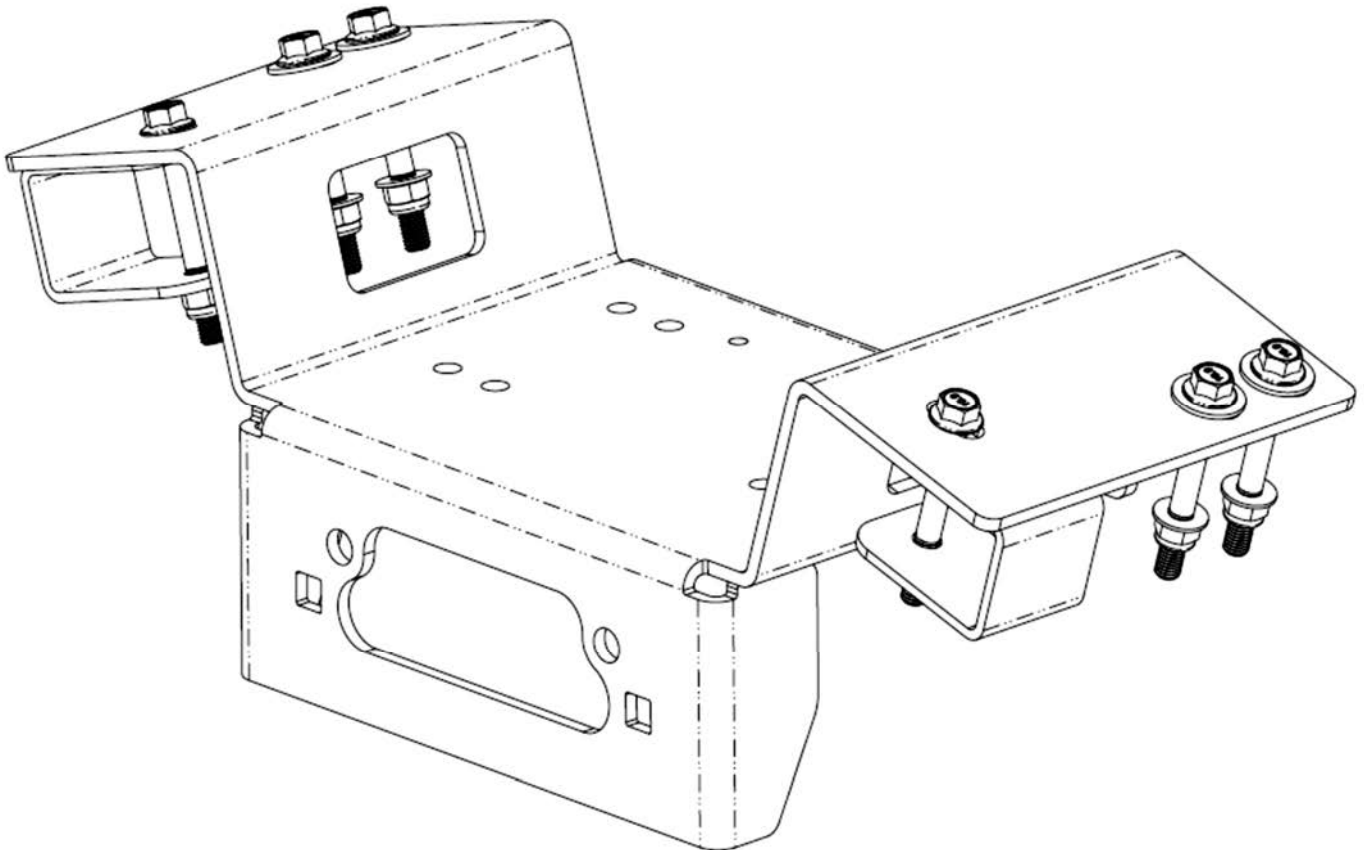

OPERATING INSTRUCTIONS

Congratulations! You've just purchased the most durable accessory component in the industry. Our accessories work great all year round! With proper care and maintenance, your Kolpin accessory will last for years to come! Please read and understand all assembly instructions, notices and warnings before assembling and using your Kolpin accessory.

Follow these guidelines to ensure a successful and satisfactory installation:

Read, understand this manual before beginning installation

Periodically check for wear and tightness of all fasteners.

Replace or re-torque fasteners as necessary.

SAFETY & GENERAL PRODUCT INFORMATION

Kolpin accessories are designed with your safety in mind.

In order to protect you and your vehicle, certain parts of the accessory and/or hardware may be designed to collapse or break when the equipment is over-stressed.

Kolpin winch mount kits are designed to be compatible with Kolpin and Cycle Country winches along with many others, but may not be compatible with some winches. Kolpin winch mount kits have design features that benefit snow plow applications.



! DANGER ! ! WARNING ! ! CAUTION !

To avoid personal injury or damage to your vehicle:

Read and understand all notices for:

Caution

Warning

Danger

Follow instructions for your vehicle, winch, winch mount and other items used in combination with this product.

Do not winch unsecured loads at any time.

Disconnect battery during winch installation or service to prevent electrical hazards.

Do not lift loads overhead.

Do not exceed the load capacity of the winch.

Always wear gloves when handling wire winch cable.

Do not use your winch or winch mount for towing.

Do not shock load the winch, cable or winch mount.

Keep fingers, hands and loose clothing away from roller fairlead and winch cable drum when in use.

Kit Contents:

Item	Qty	Part Description	Part Number
1	1	Winch Mount Plate	-
2	2	Bumper Clamping U-Bracket	-
3	6	Hex Flange Locknut, Zinc Plated, M8-1.25	-
4	4	Flat Fender Washer, Zinc Plated, M8	-
5	6	Hex Flange Bolt, Zinc Plated, M8-1.25 x 70mm LG	-
6	1	Instruction Guide (not shown)	-

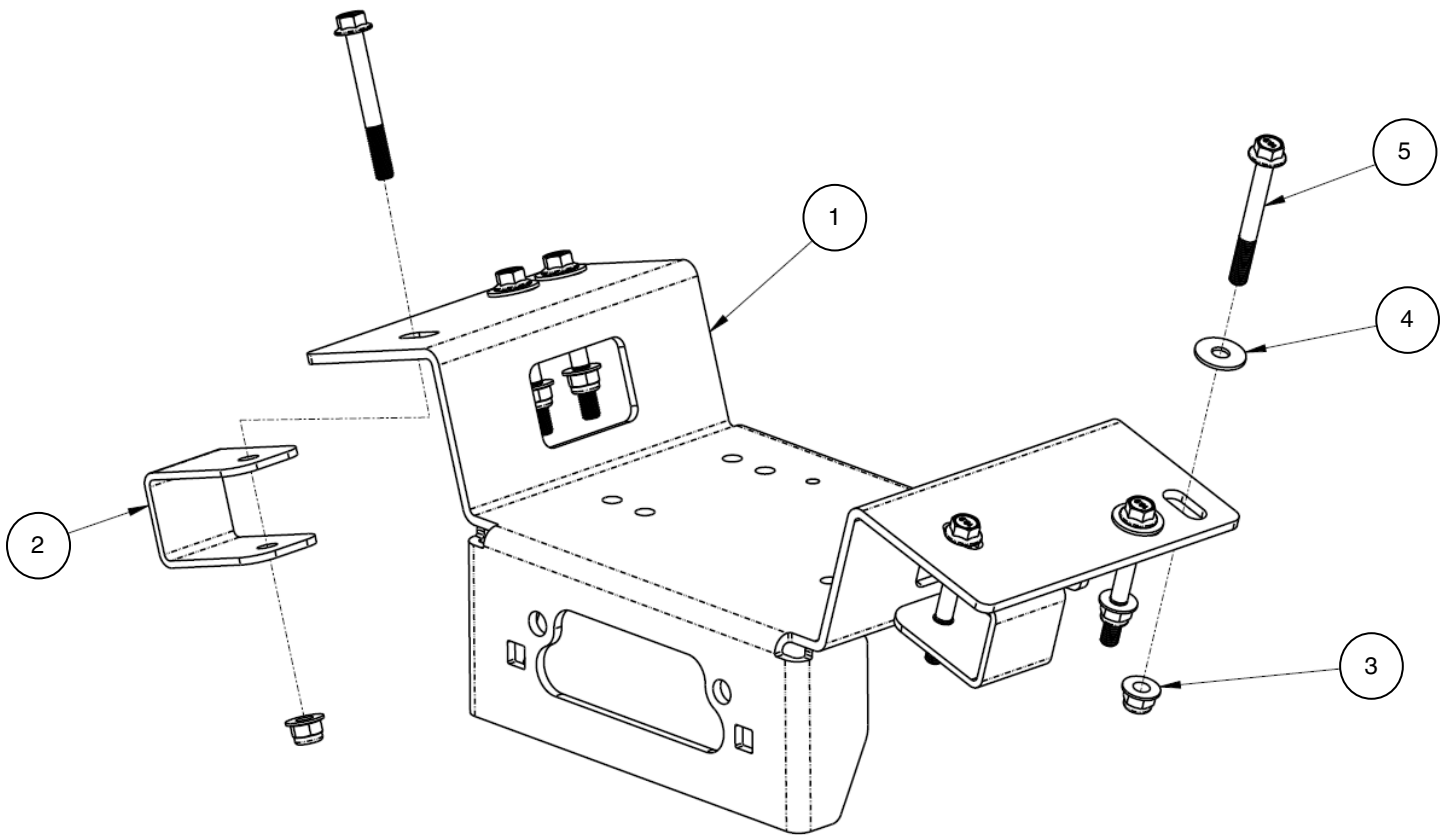

BEFORE YOU BEGIN:

- Your Kolpin accessory is exclusively designed for your vehicle
- Please read and understand all instructions
- Verify all parts and tools are accounted for
- To ensure a satisfactory installation, follow all steps correctly and in the sequence described
- Keep these instructions for future reference or for informational requests
- To facilitate installation, make sure that your vehicle is clean and free of debris
- All directions referring to right and left are when the rider is sitting on the machine

TOOLS REQUIRED:

- Metric Wrench set
- Metric Socket set
- Pliers
- Metric Hex Allen Key Wrench or Socket set
- Do not use impact tools to install hardware

APPROXIMATE ASSEMBLY TIME: 30 minutes

Note: If any hardware is missing, do not return to the store. Call us to help, Toll Free 1-877-956-5746.

Winch Mount plate (item #1) has pre-drilled holes for mounting Kolpin contactor (provided with winch kit) onto top side of bracket, as shown in image to the right. **Note, winch parts are included with the winch kit.**

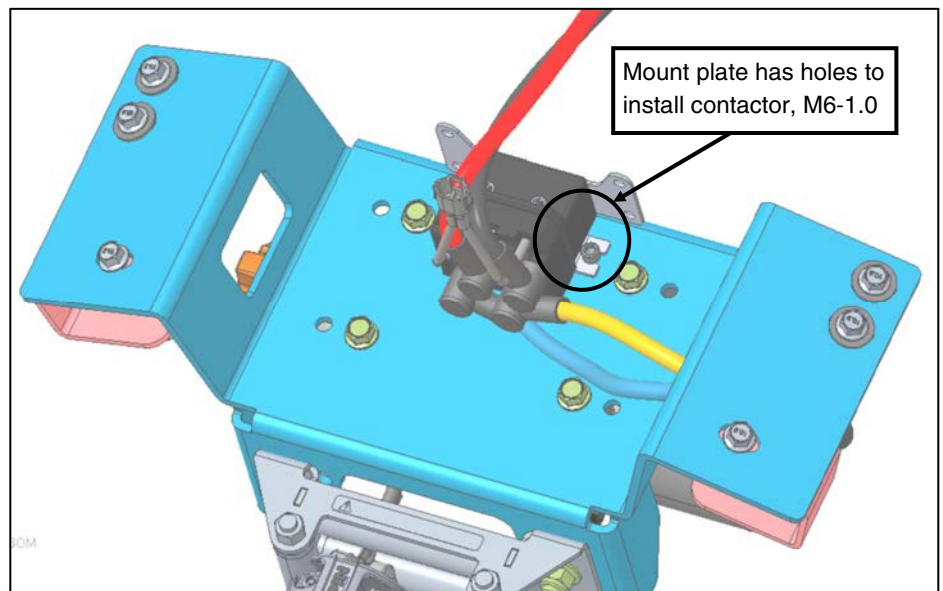

PIONEER 700 PREPARATION:

1. Shift vehicle transmission into "PARK". Turn key to "OFF" position and remove from vehicle.
2. To gain access to electrical connections, open the front hood and remove as shown. (See illustration 1-1). Remove passenger seat bottom.
3. Disconnect black (negative) and red (positive) cables from battery.

⚠ WARNING ⚠

ALWAYS disconnect black negative (-) cable from battery **FIRST**. Failure to do so will result in high current electrical arc, and may result in battery explosion if tool touches grounded frame. Death or serious injury may occur.

4. Remove the screws and front bumper as shown. Save all for re-install later. (See illustrations 1-2, 1-3 and 1-4). **Note, the 6mm and 10mm bolts will be re-used for bumper installation later.**

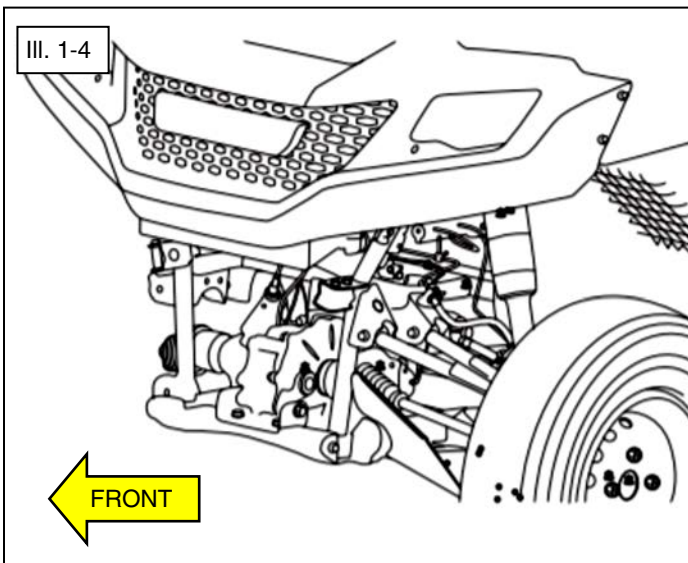
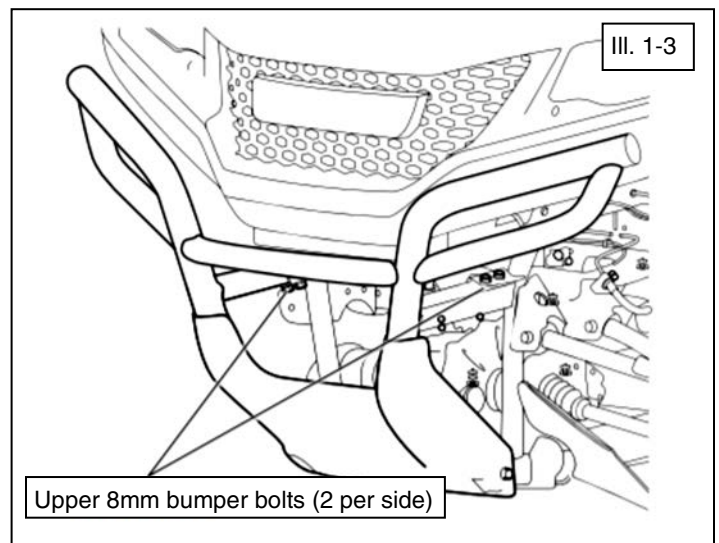
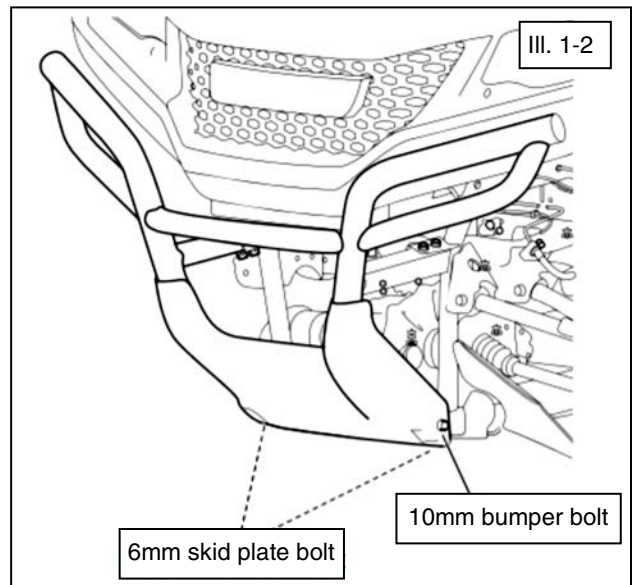
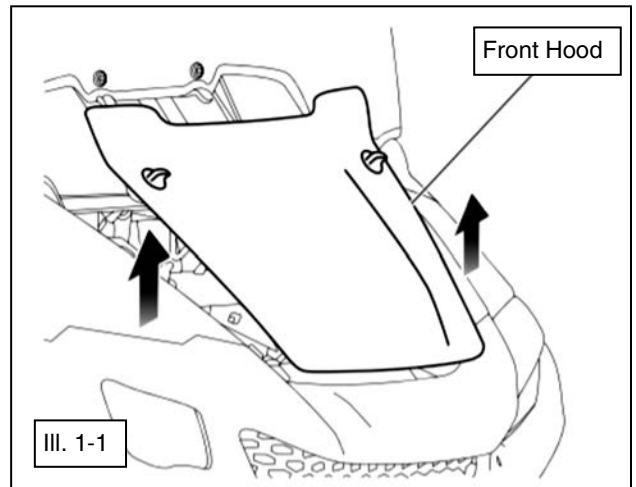

PIONEER 700 WINCH INSTALLATION:

5. Using the hardware provided with winch kit, attach the winch and roller fairlead to the mounting bracket (item #1) as shown. (See illustration 1-5). **Note, roller fairlead is included with winch kit, not mounting plate kit.**
6. Position the winch sub-assembly into the front bumper as shown. (See illustration 1-6).
7. Place the M8 flat washers (item #4) over four M8 long bumper bolts (item #5) and temporarily insert through the mounting bracket (item #1) and into the bumper holes as shown. This will keep the mount aligned into the bumper. (See illustrations 1-7 and 1-8). **Note, contactor shown mounted onto winch plate (item #1).**
8. Assemble the mounting bracket to the front bumper using the U- Bracket Clamps (item #2) and two M8 long bolts (item #5). Place the U-Bracket over the bumper frame tube as shown. Insert the bolts thru the winch bracket and U-Bracket and then fasten using M8 locknut (item #3). (See illustration 1-8).
9. Tighten the M8 fasteners to torque specification.

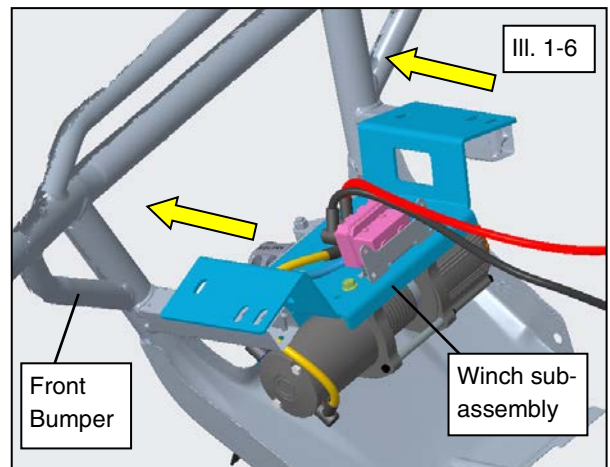
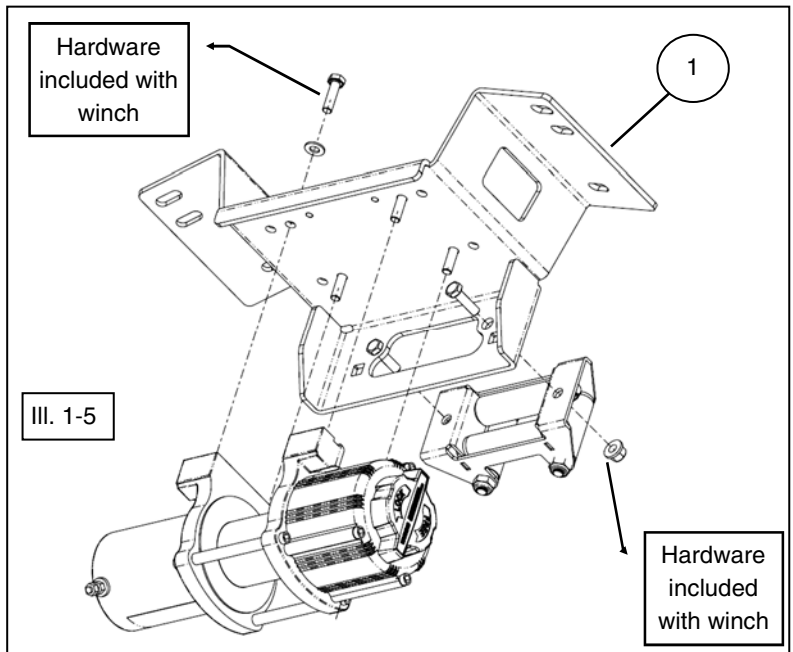

= T
8MM FASTENER TORQUE: 17 ft. lbs. (23 Nm)

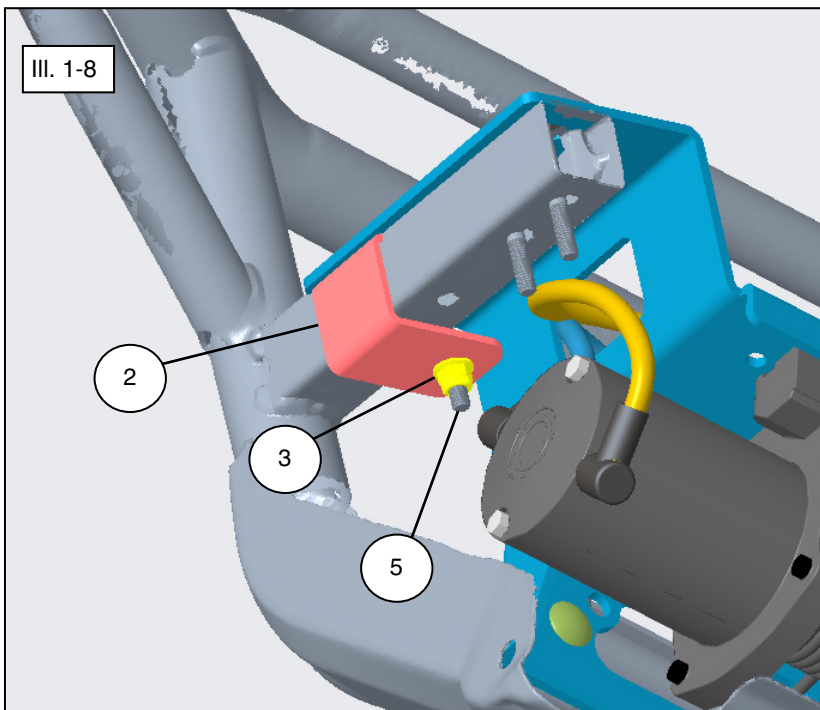
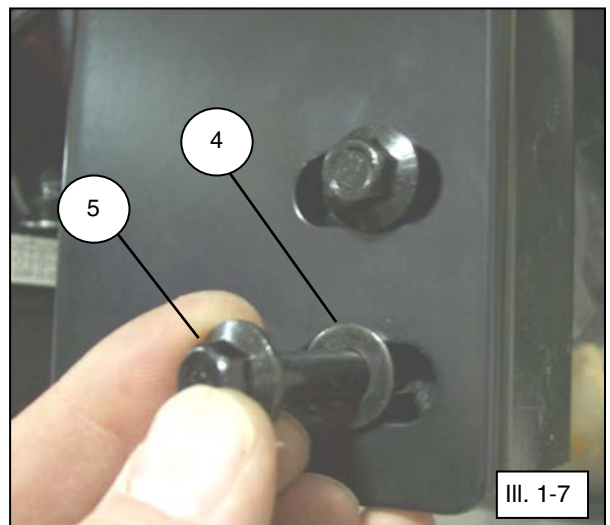

PIONEER 700 WINCH INSTALLATION (continued):

10. Install winch-bumper assembly onto the frame re-using the OEM hardware removed in step 4.
11. Install M8 flat washers (item #4) over the mount bracket slotted upper holes for the front bumper, then initially thread by hand, the four upper M8 bolts (item #5) into the four locations, two per side. Fasten the four bolts using M8 locknuts (item #3). Thread initially by hand, the OEM lower M10 bolt into the two locations, one per side as shown. Re-install the lower M6 OEM bolts into the skid plate. (See illustrations 1-9 and 1-10). **Note, the four M8 OEM upper bumper bolts and nuts will not be re-used. The M8 hardware supplied in kit will be used instead.**
12. Tighten the four M8 upper bumper screws, two M10 lower bumper bolts and two M6 skid plate bolts to torque specifications listed below.

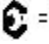
 = T
UPPER BUMPER 8MM FASTENER TORQUE: 17 ft. lbs. (23 Nm)

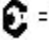
 = T
LOWER BUMPER 10MM FASTENER TORQUE: 34 ft. lbs. (46 Nm)

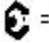
 = T
SKID PLATE 6MM FASTENER TORQUE: 8.9 ft. lbs. (12 Nm)

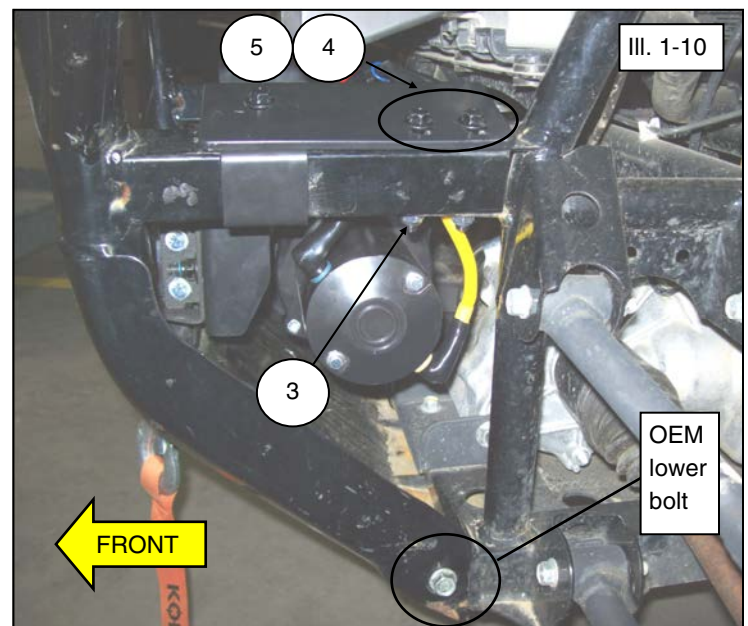
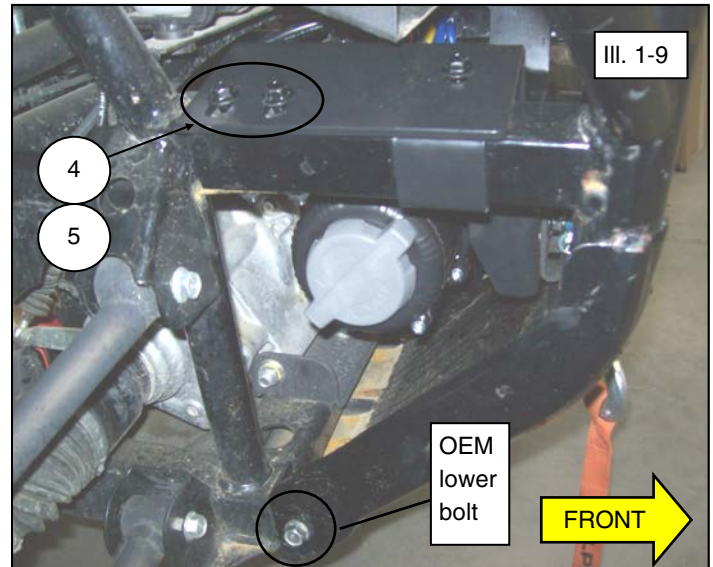

WINCH CABLE WRAP INSTALLATION ON SPOOL DRUM:

13. The winch cable or rope should be wrapped around spool drum, feeding from top, as shown. Spooling the cable as shown will prolong cable life and enhance winch performance. (See illustration 1-11).
14. Connect the hook to cable or rope by using hardware included in winch kit.



WINCH WIRING AND CONNECTIONS:

15. Using the winch kit instructions, route and connect the electrical cables and components for the winch system. Route the black and red power cables first into window above front gearcase as shown. Check that all wires are free to move and not pinched between the vehicle chassis and the winch-bumper assembly. (See illustration 1-12).

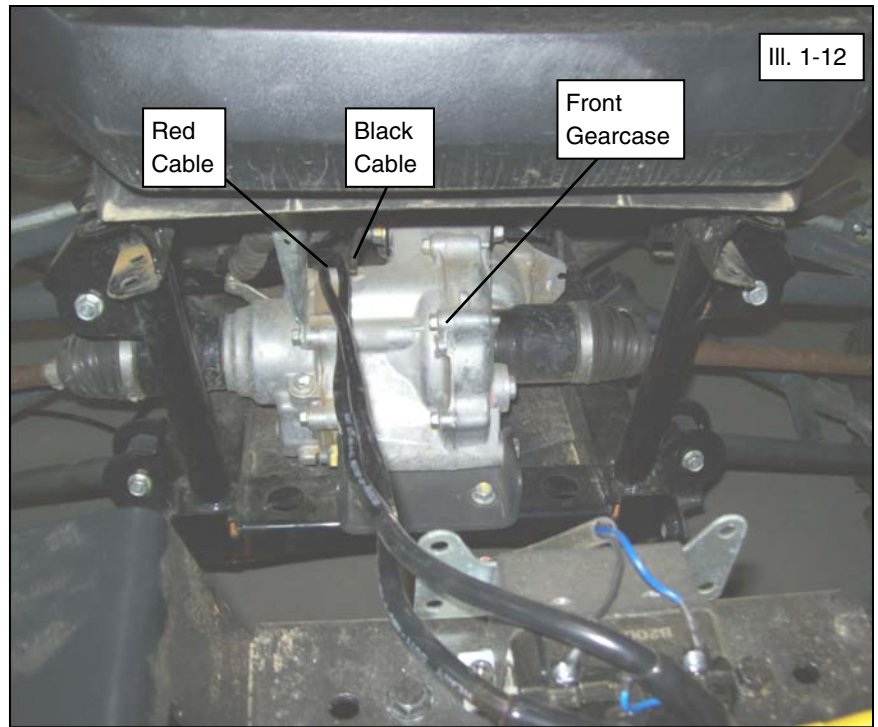

16. Continue routing red positive and black negative power connection cables directly underneath the radiator, continue under the steering pinion rack, along the frame, under passenger seat, to reach the battery as shown. Use the plastic cable ties with winch kit, loosely secure the red and black power cables to the frame and existing wiring. (See illustrations 1-13, 1-14, 1-15 and 1-16). **Note, do not connect the winch cables to the battery at this time.**

17. Secure all harnesses using cable ties (provided with winch kit) to prevent contact with hot components, sharp edges or moving parts.

18. Reconnect the main vehicle power cables and the winch power red (positive) and black (negative) cables to battery terminals at this time using original hardware.

19. Reinstall the front hood and passenger seat bottom.

20. With the vehicle key in the ON position, check winch for proper operation.

21. Retighten all hardware after 30 minutes of riding.

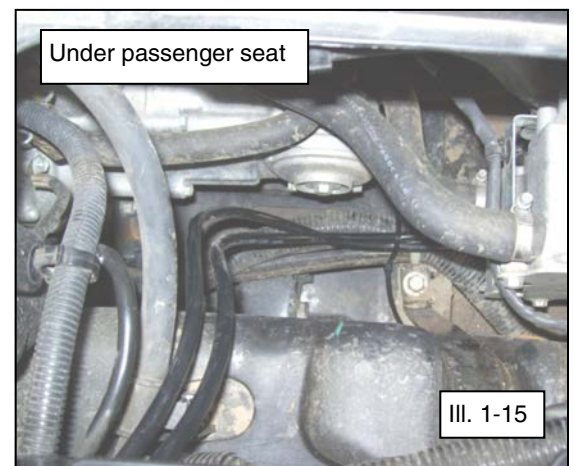
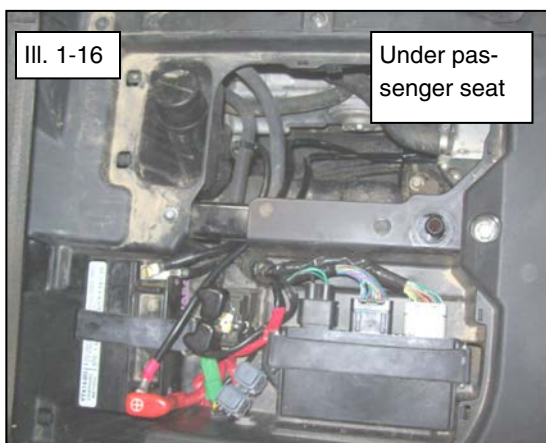
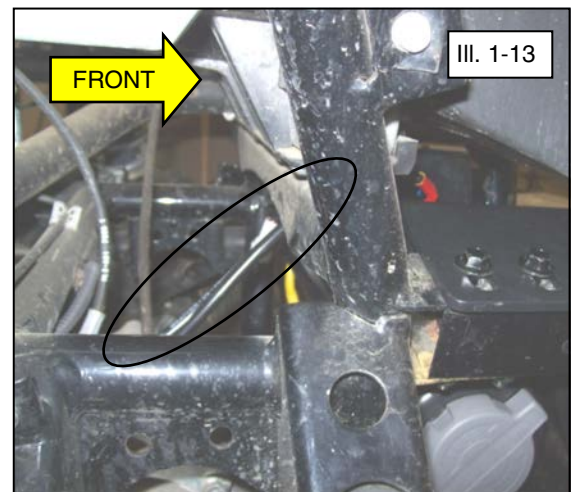
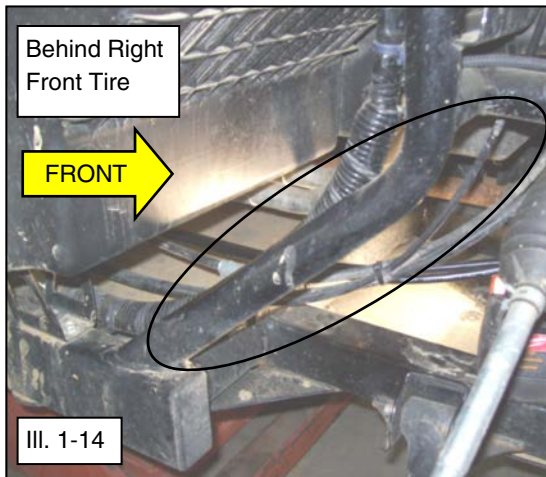



One Year Limited Warranty

For the period of one (1) year from the purchase date, Kolpin will replace for the original purchaser, free of charge, any part or parts found upon examination by Kolpin to be defective in material, workmanship, or both.

All transportation costs incurred submitting product to Kolpin for warranty consideration must be borne by the purchaser. If Kolpin determines that the product must be returned to the factory for credit, please call 1-877-956-5746 for a Return Merchandise Authorization (RMA) number and shipping instructions.

This warranty does not apply to parts that have been damaged by accident, alteration, abuse, improper maintenance, normal wear, or other causes beyond the manufacturer's control. In order to protect you and your ATV, certain parts of the system and/or hardware are designed to fail when the equipment is over-stressed. Parts that are lost due to loosening and improper maintenance are not covered under warranty. This warranty does not cover removal or reinstallation labor fees of the plow system and related components.

Peripheral products such as engines, electric motors, and actuators may carry an original manufacturer's warranty. Most hardware is general in nature and is easily obtained locally. Be sure to replace with minimum metric class 8.8 specification.

Kolpin Outdoors, Inc.

Telephone: (763)-478-5800

Toll Free: (877)-956-5746

Fax Number: (800)-245-7569

www.kolpin.com

Email: customerservice@kolpin.com