

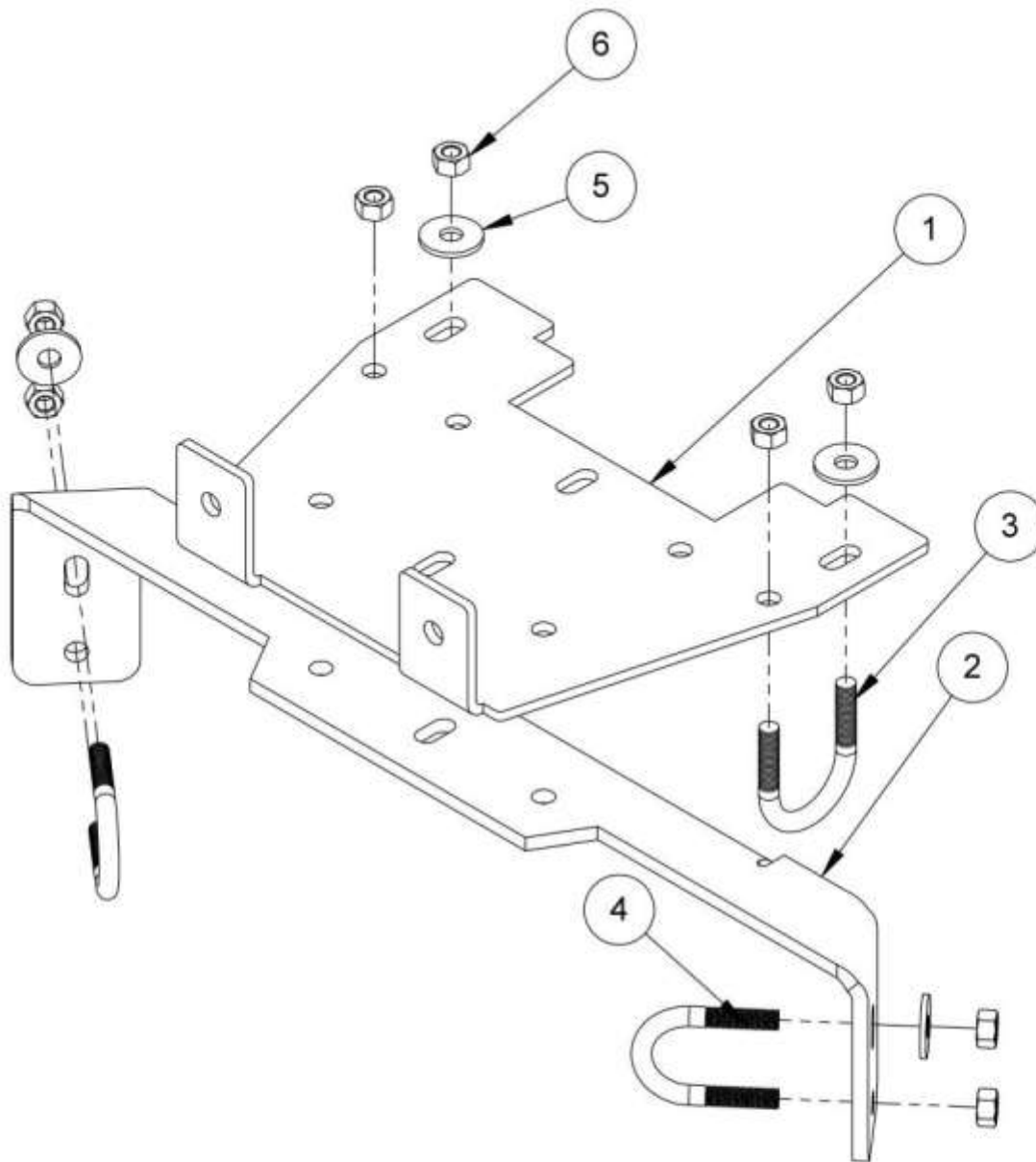

**WINCH
MOUNT KIT**
For KAWASAKI 610 MULE

**ASSEMBLY / OWNER'S
MANUAL**

MODEL NUMBER: 25-2240



**Model Number 25-2240
Parts List**

ITEM NO.	QTY.	PART NO.	DESCRIPTION
1	1	CYC5563	Winch Mount Plate
2	1	CYC5564	Winch Plate Support
3	2	PUR3191	U-bolt 8mm x 35mm x 50mm
4	2	PUR3190	U-bolt 8mm x 30mm x 50mm
5	4	PUR3087	Flat Washer 8mm
6	8	PUR3068	Nylon Lock Nut M8

Hardware Package 0011

THIS WINCH MOUNTING KIT CAN BE USED TO MOUNT EITHER CYCLE COUNTRY WINCHES OR OTHER AFTERMARKET WINCHES TO YOUR UTV.

Please Note:

- All directions referring to right and left are when the rider is sitting on the machine.
- Mounting of winches can be accomplished using either the 2-bolt pattern or the 4-bolt pattern, depending on the manufacturer (Excludes 4000 lb. winches). See Illustration.

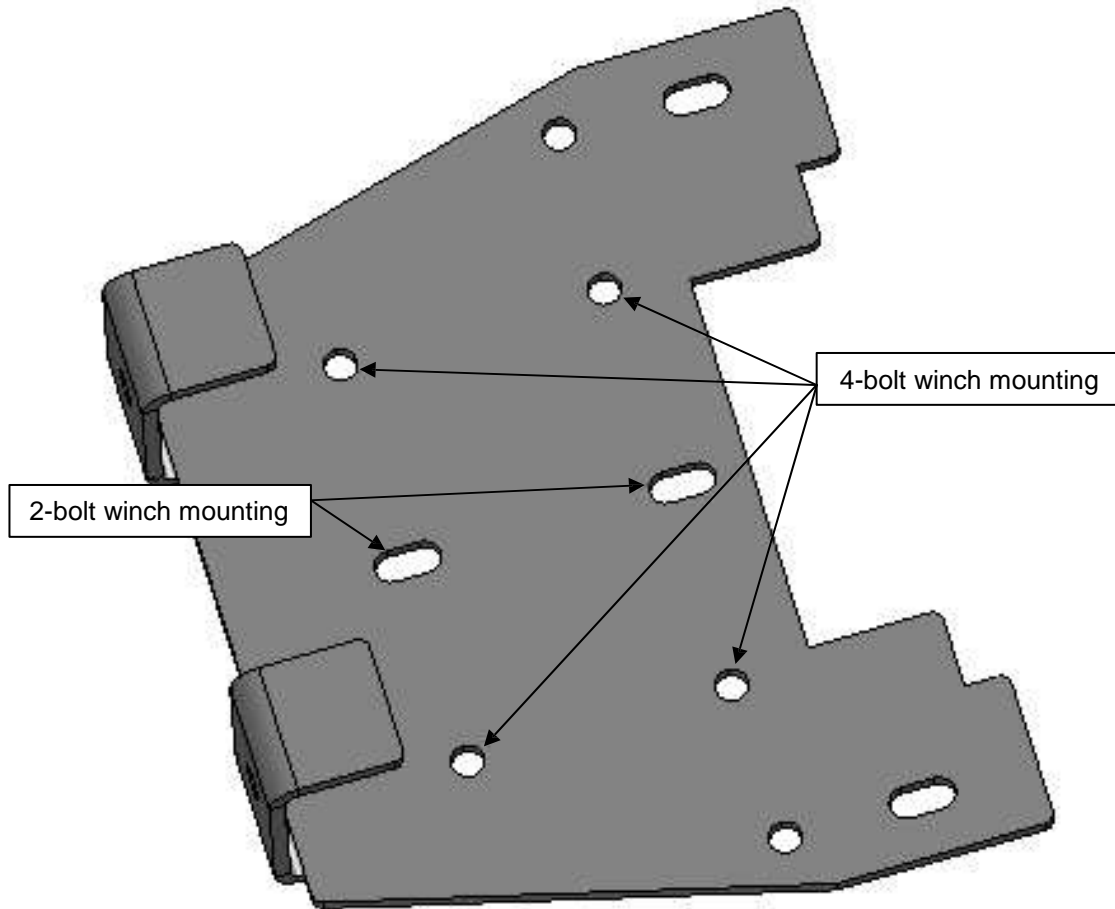

MODEL NUMBER 25-2240

WINCH MOUNT INSTALLATION INSTRUCTIONS

1. Remove plastic bumper from the UTV. Go to instructions for your winch.

2 – BOLT PATTERN WINCH MOUNTING INSTRUCTIONS

- Place your winch into the opening shown below with the winch motor on the **Left** side of the machine before any other parts are installed.
- Install the winch plate support, Item #2 to the UTV using the M8 x 30mm x 45mm U-bolts and nylock nuts. *Do not tighten at this time.*

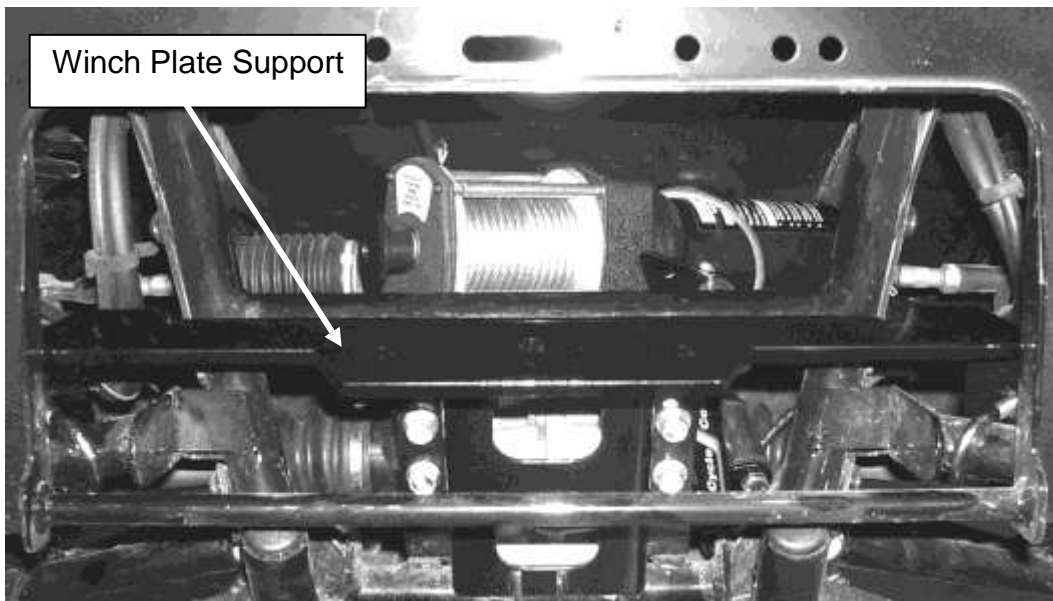

- Place the winch mount plate, Item #1 on top of the winch plate support and fasten the rear of the winch mount plate to the UTV with M8 x 35mm x 50mm U- bolts and nylock nuts. *See picture on page 5. Do not tighten at this time.*

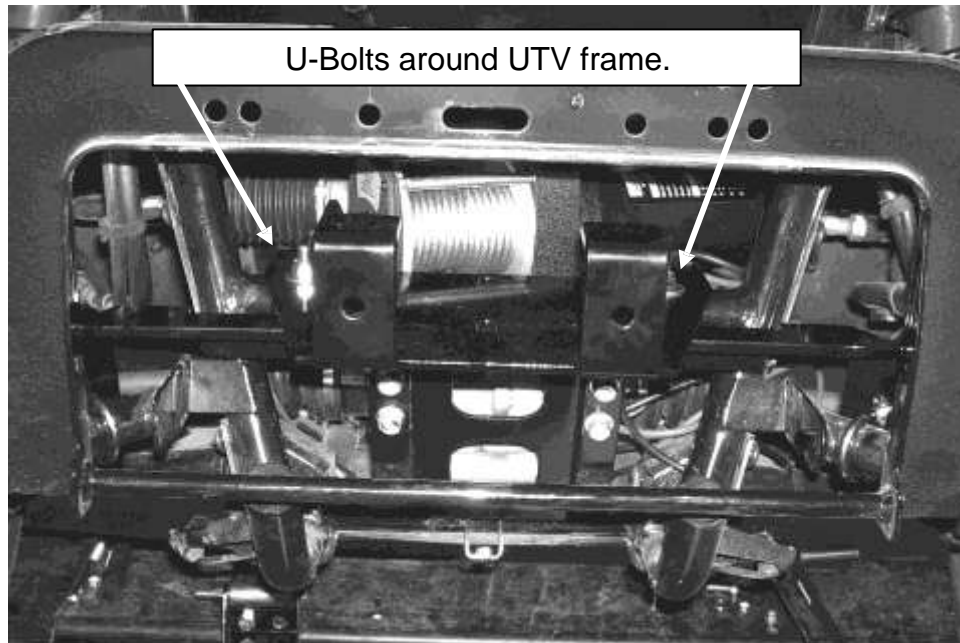

- Install the winch to the winch mount plate and winch plate support and tighten all hardware at this time. Go to roller hawse instructions on page 7.

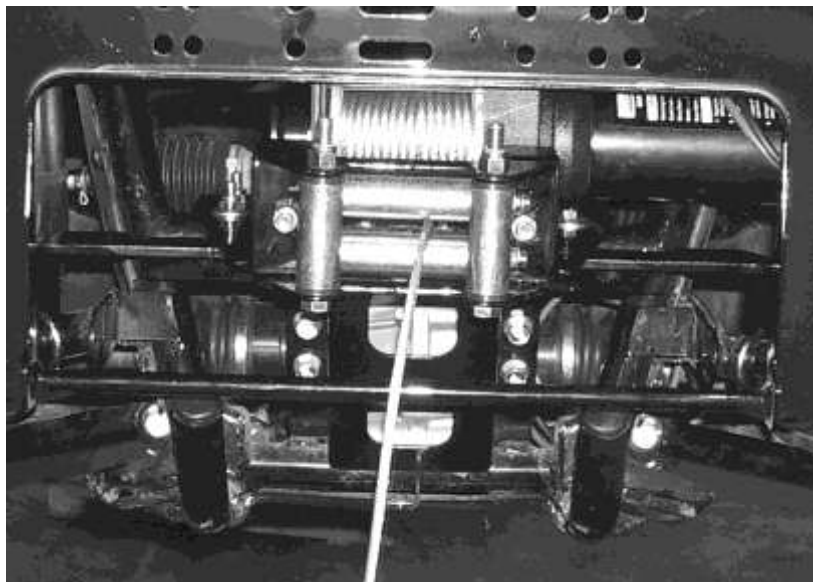

4 – BOLT PATTERN WINCH MOUNTING INSTRUCTIONS

- Place your winch into the opening shown below with the winch motor on the **Right** side of the machine before any other parts are installed.
- Install the winch plate support, Item #2, to the UTV using the M8 x 30mm x 45mm U-bolts and nylock nuts. *Do not tighten at this time.*
- Place the winch mount plate, Item #1 on top of the winch plate support and fasten the rear of the winch mount plate to the UTV with M8 x 35mm x 50mm U- bolts and nylock nuts. *See picture below. Do not tighten at this time.*

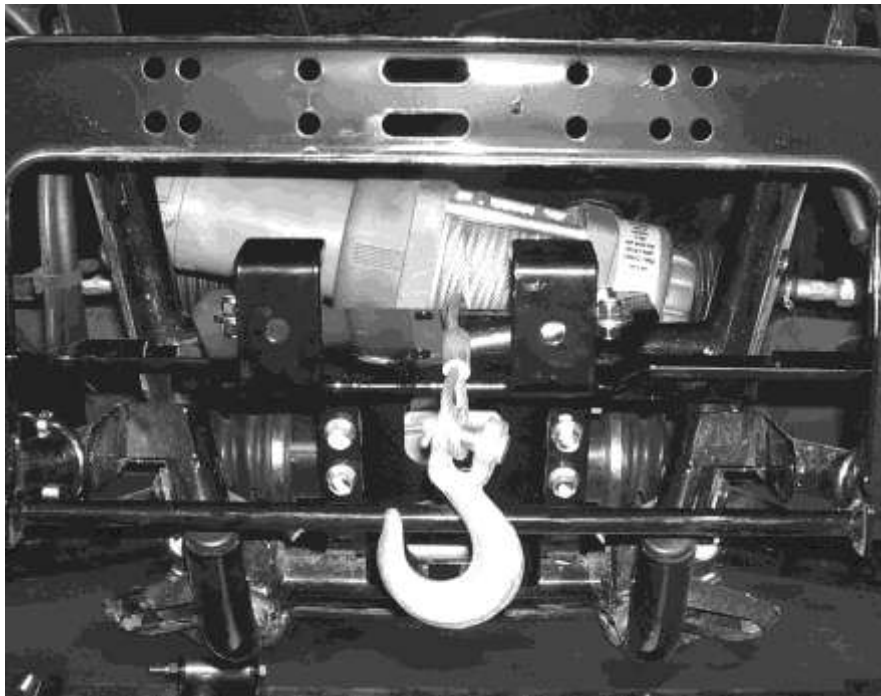

- Install the winch to the winch mount plate and winch plate support and tighten all hardware at this time. Go to Roller Hawse Instructions on page 7.

ROLLER HAWSE MOUNTING INSTRUCTIONS:

Remove one of the long rollers and the two side rollers and feed the winch cable through the roller hawse. Reinstall the rollers and be sure rollers move freely.

Attach the roller hawse to the winch mount plate using the bolts and nuts provided with the winch. Go to next instruction.

2. Instructions for optional switch mounting are on next page.
3. Re-install plastic bumper.

See winch instructions supplied with the winch for proper wiring installation.

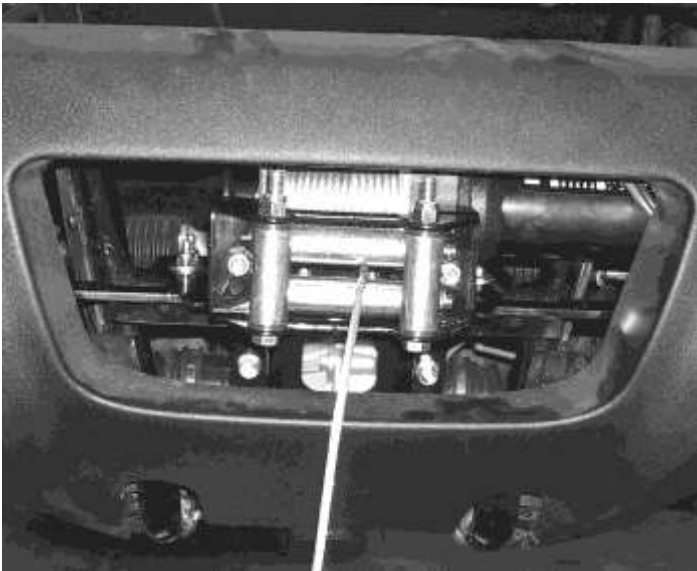



One Year Limited Warranty

For the period of one (1) year from the purchase date, Cycle Country (a Kolpin Powersports Brand) will replace for the original purchaser, free of charge, any part or parts found upon examination by Cycle Country to be defective in material, workmanship, or both.

All transportation costs incurred submitting product to Cycle Country for warranty consideration must be borne by the purchaser. If Cycle Country determines that the product must be returned to the factory for credit, please call 1-800-841-2222 for a Return Merchandise Authorization (RMA) number and shipping instructions.

This warranty does not apply to parts that have been damaged by accident, alteration, abuse, improper maintenance, normal wear, or other causes beyond the manufacturer's control. In order to protect you and your ATV, certain parts of the plow system and/or hardware are designed to fail when the equipment is over-stressed.

Peripheral products such as engines, electric motors, and actuators may carry an original manufacturer's warranty. Please call Cycle Country for more information.

Cycle Country
A Kolpin Powersports Brand
205 N Depot St.
PO Box 107
Fox Lake, WI 53933
Service: 1-800-841-2222
Fax: 1-800-245-7569
Email: ccac@cyclecountry.com
Web: www.cyclecountry.com

