

Polaris Ranger Midsize Quick-Mount 3500lb. Winch Kit



Product Instructions | Part No: 26-3025

Application: Polaris Ranger, verify accessory fitment at Kolpin.com.

Before You Begin: Read these instructions and check to be sure all parts and tools are accounted for. Please retain these installation instructions for future reference and parts ordering information.

Note: You must order power cables kit 85095 separately to connect battery to winch contactor for vehicle models:

2015-2021 Ranger Crew 570

2016-2020 Ranger Crew 570-6 Fullsize

Note: If any hardware is missing, do not return to the store. Call us to help, Toll Free 1-877-956-5746.

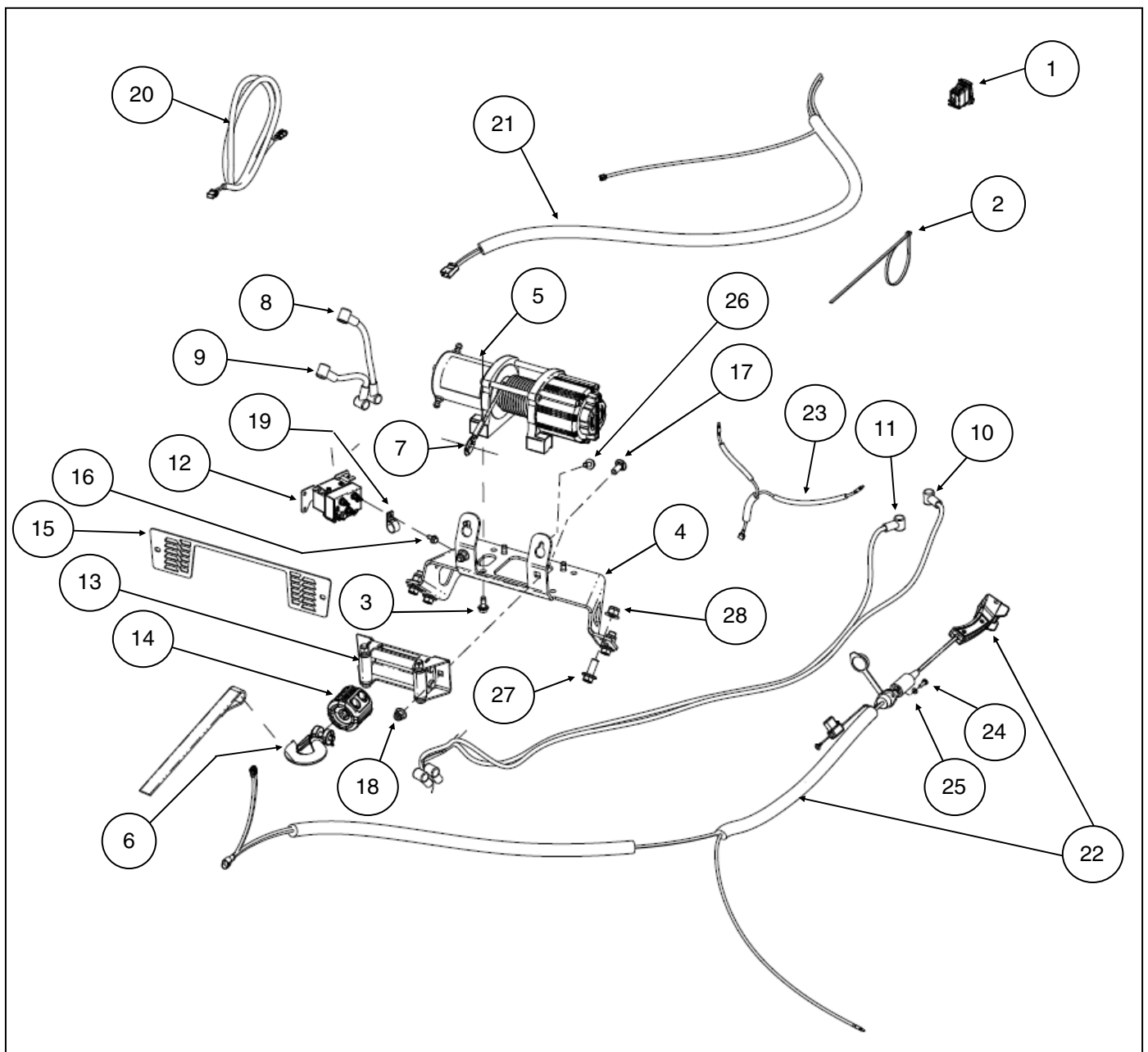

This Kit includes:

Item	Qty	Part Description	Part Number
1	1	Dash Switch, Panel Mount	4015688
2	10	Cable Ties, Nylon	-
3	4	Hex Flange Screw, Zinc Plated, M8 x 1.25 - 20mm LG	-
4	1	Mounting Bracket	25-3420
5	1	Winch - Kolpin, 3500lb.	25-9350R
6	1	Hook, Winch Latch	RPR0108
7	1	Winch Cable, Synthetic - 3500lb.	85065
8	1	Winch Connection Cable, Yellow 6 GA (190mm)	-
9	1	Winch Connection Cable, Blue 6 GA (190mm)	-
10	1	Power Connection Cable, Black 6 GA (1768mm)	-
11	1	Power Connection Cable, Red 6 GA (1700mm)	-
12	1	Contactor, Solenoid, 12V	85068
13	1	Roller Fairlead, Wide Pattern	85087
14	1	Rubber Winch Stopper	85080
15	1	Grill, Fairlead Cover	5255409
16	2	Hex Flange Tap Screw, Zinc Plated, M6 x 1.0 - 15mm LG	7518513
17	2	Carriage Screw, Zinc Plated, M10 x 1.5 - 25mm LG	7519372
18	2	Hex Flange Locknut, Zinc Plated, M10 x 1.5	7547423
19	1	Clamp, Rubber Coated Steel	7081116
20	1	Ranger Vehicle Dash Switch-Contactor Extension Harness	-
21	1	Ranger Vehicle Dash Switch Pigtail Harness	-
22	1	Ranger Vehicle Corded Remote Switch & Harness	-
23	1	Ranger Vehicle Accessory Power Splitter Harness	-
24	2	Pan Head Screw, Zinc Plated, #10 x 0.75" LG	-
25	2	Flat Washer, Zinc Plated, M5	-
26	2	Thread Forming Hex Flange Screw, 5/16"-18 x 1.25 LG	-
27	4	Hex Flange Screw, Zinc Plated, M12 x 1.75 - 30mm LG	7520054
28	4	Hex Flange Locknut, Zinc Plated, M12 - 1.75	7547441
29	1	Instruction Guide (not shown)	-
-	1	Service Free Spool Handle Knob (not included in kit)	85072

Tools Required:

- Safety Glasses
- Socket Set, Metric
- Wrench Set, Metric
- Drill or cutting tools for plastic
- Socket Set, Torx Bit
- Torque Wrench
- Pliers
- 1" Hole Saw or Drill Bit
- Electric Drill or Dremel tool

Assembly Time: Approximately 30 minutes

Note: The 26-3025 kit comes mostly assembled from the factory. Some assembly is required.

Older Generation Ranger / Newer Generation Ranger Note: The 26-3025 kit will fit the older generation and newer generation Ranger vehicles. The instructions will guide through commonly shared steps.

Important: Your Kolpin Ranger Quick-Mount Winch Kit is exclusively designed for your vehicle. Please read the installation instructions thoroughly before beginning. Installation is easier if the vehicle is clean and free of debris. For your safety, and to ensure a satisfactory installation, perform all installation steps correctly in the sequence shown. Additional time may be required to accommodate other installed accessories.

RANGER PREPARATION:

1. Shift vehicle transmission into "PARK". Turn ignition key to "OFF" position and remove from vehicle ignition.
2. Flip up and/or remove driver seat bottom and remove under seat storage compartment tray (if it exists) by pulling it in upward direction.
3. Disconnect black negative (-) cable from battery first, then disconnect red positive (+) cable from battery.

⚠ WARNING ⚠

ALWAYS disconnect black negative (-) cable from battery **FIRST**. Failure to do so will result in high current electrical arc, and may result in battery explosion if tool touches grounded frame. Death or serious injury may occur.

4. Remove the front bumper by removing seven bolts (four upper and three lower) as shown. (See illustration 1-1). **Note, the bumper is heavy, provide adequate support before removing final screws.**
5. Remove grill screen from bumper by removing two screws. Retain screws for reuse. (See illustration 1-2).
6. Detach rubber latch on both sides of vehicle and open the hood. (See illustration 1-3).

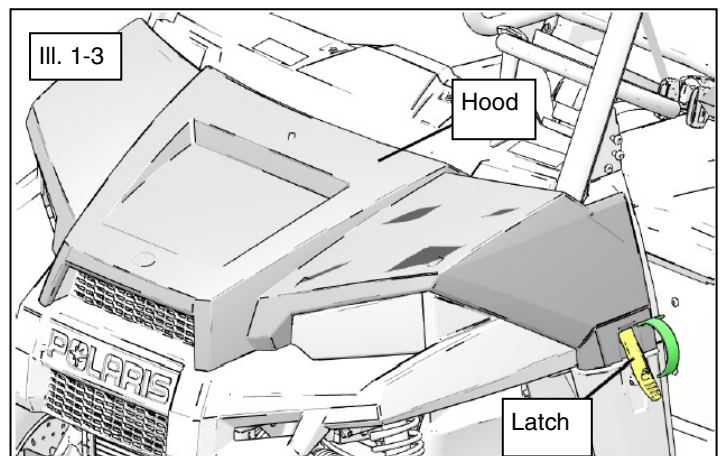
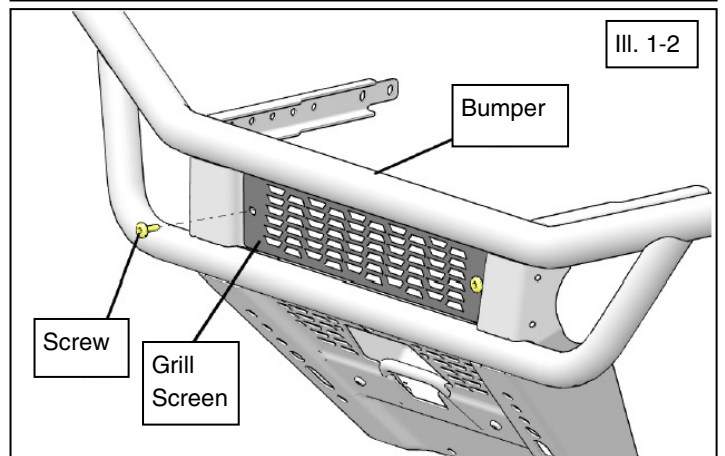
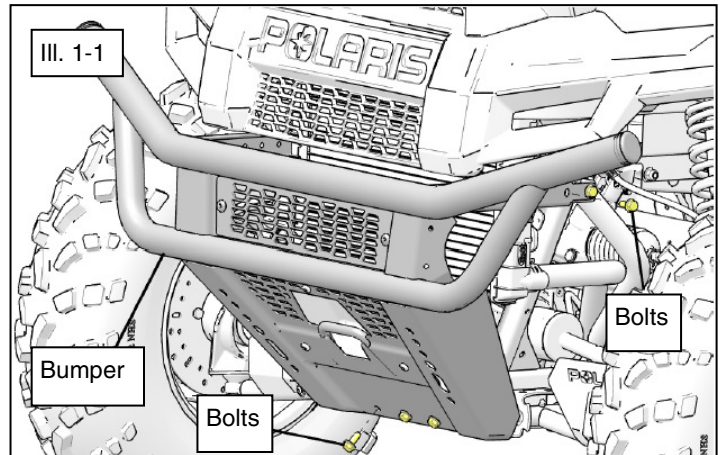

RANGER PREPARATION (continued):

- Remove seven screws securing drive shaft cover to the floor. Save fasteners for use during reinstallation. Remove driveshaft cover from vehicle. (See illustration 1-4).
- Remove the Ranger winch assembly from the packaging.

RANGER WINCH INSTALLATION:

NOTE: See the *Electrical Connections Reference Guide* section of the instruction manual for detailed photos of each part and their respective connections.

- Install two self-tapping screws (item #26) into the two holes on top bumper tube as shown, roughly 1/2 inch from bottoming out. (See illustration 1-5). **Note, the winch bracket assembly will need to fit onto these two screws. Do not tighten at this step.**
- Install winch mount assembly onto front bumper as shown. Install four M12 bolts (item #27) and fasten using M12 locknuts (item #28). Tighten M12 bolts and nuts to specification. (See illustration 1-6). **Tighten M8 self-tapping screws just until snug.**

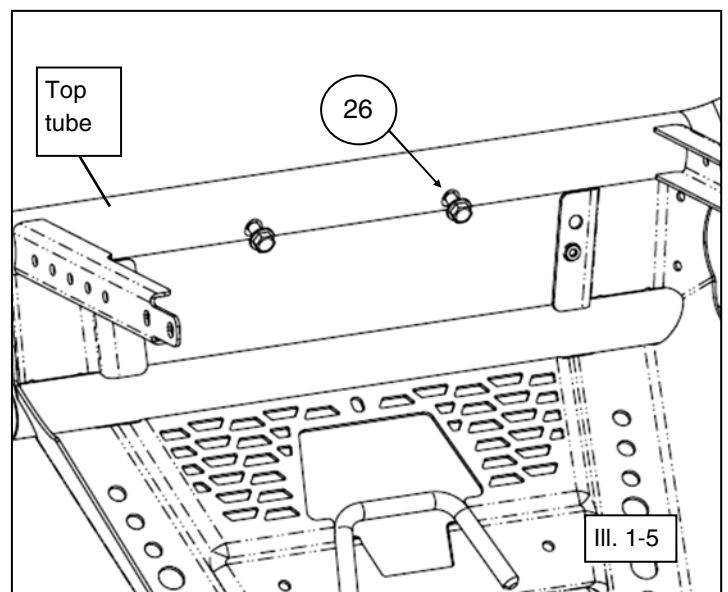
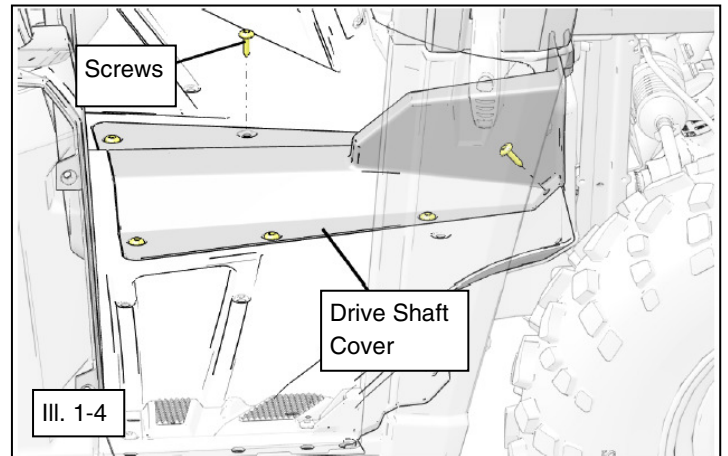

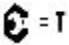

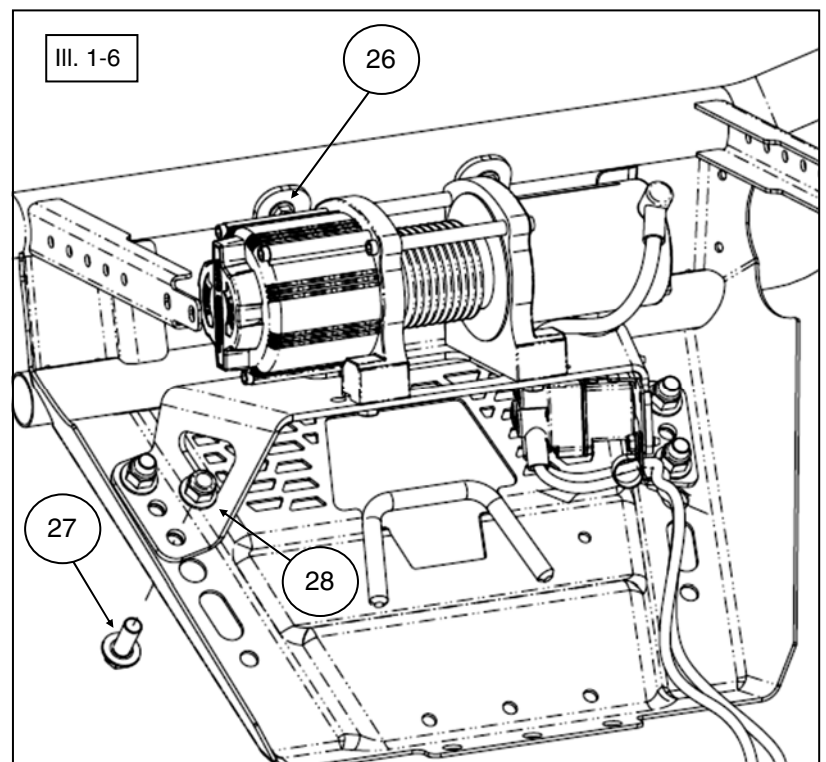
12MM FASTENER TORQUE: 34 ft. lbs. (46 Nm)

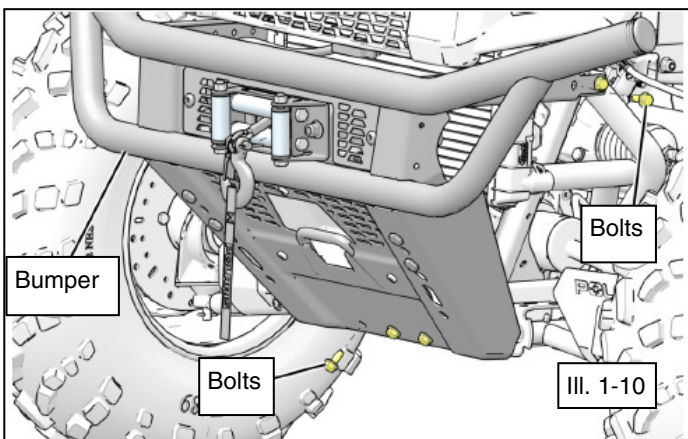
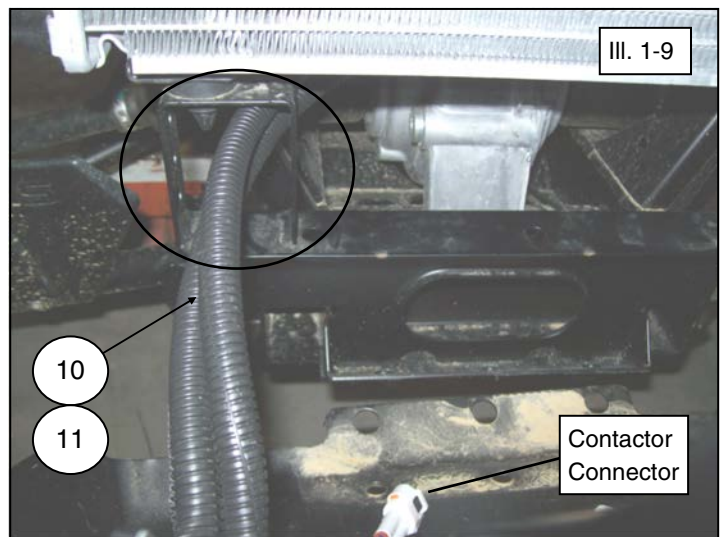
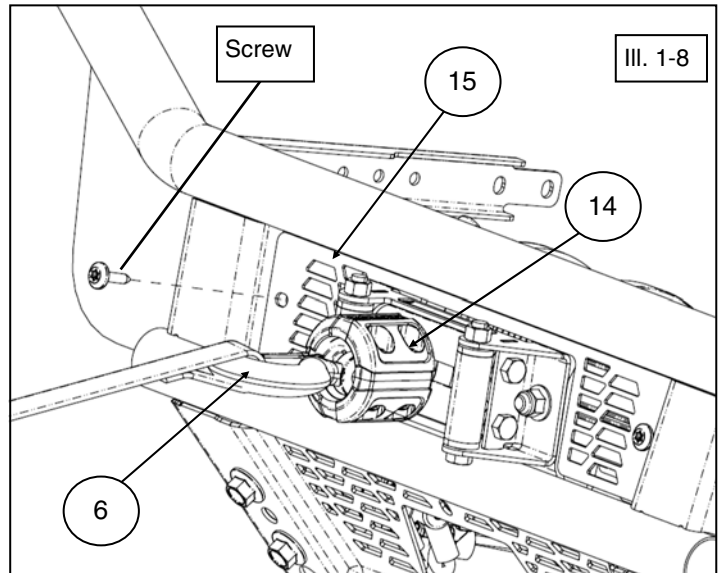
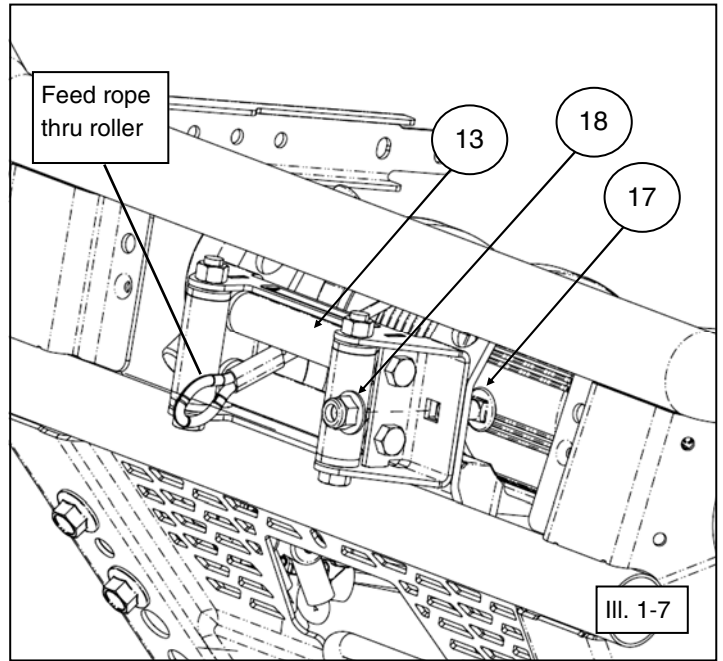

RANGER WINCH INSTALLATION (continued):

11. Install roller fairlead (item #13) to winch mounting bracket using M10 carriage screws (item #17) and fasten using M10 locknuts (item #18) as shown. Feed rope loop thru roller fairlead. (See illustration 1-7).
12. Install new grill screen (item #15) on front bumper using retained two screws. Install rubber bumper (item #14) and winch hook (item #6) onto rope thimble end loop. (See illustration 1-8).
13. Locate the red and black wires (items #10 and #11) on the winch assembly. If they are secured in a bundle with plastic tie, cut the tie to allow the cables to be routed through the front frame window shown below. (See illustration 1-9).
14. Using OEM hardware, re-install front bumper. Thread in all seven bolts before tightening. Tighten the lower bolts first, then the two bolts on both sides of the bumper. (See illustration 1-10). **Note, ensure no wires are pinched between the joining parts.**



RANGER POWER CABLES INSTALLATION:

15. Route red and black power cables (items #10 and #11) from winch assembly up through front gearcase area (up and over front gearcase) and back towards battery following the vehicle main wire harness as shown. Use cable ties (item #2) to secure the harness as shown. (See illustrations 1-11, 1-12 and 1-13).

Note, do not connect cables to battery and bus bar terminals at this time.

16. Double-check wire routing to make sure the red and black cables are secured away from any moving or potentially hot parts. Reinstall driveshaft floor cover using OEM screws.

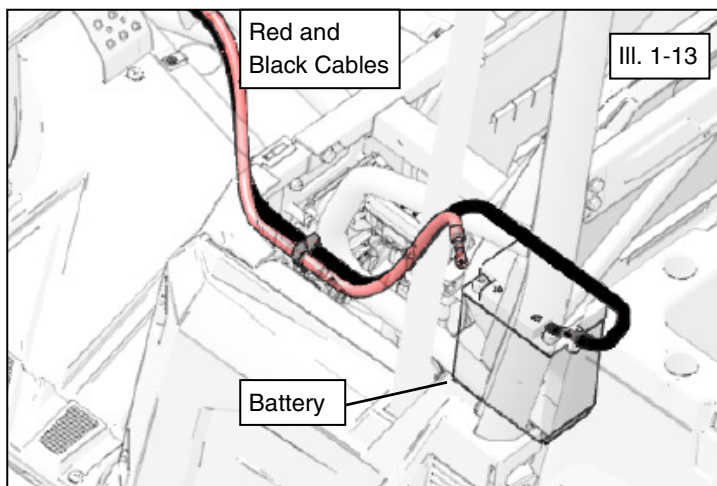
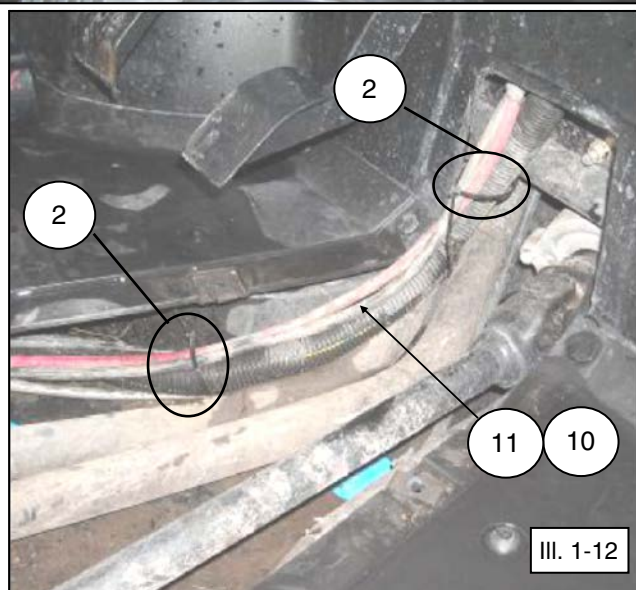
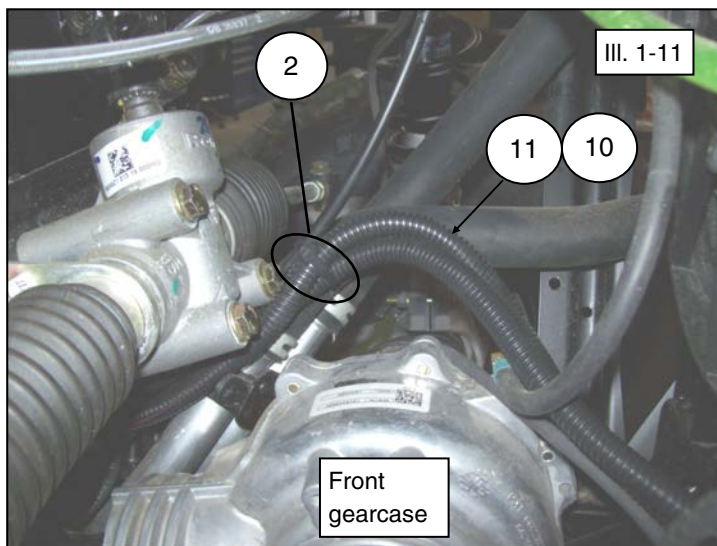

**RANGER CORDED REMOTE SWITCH
INSTALLATION:**

NOTE: See the *Electrical Connections Reference Guide* section of the instruction manual for detailed photos of each part and their respective connections.

17. Install corded remote switch socket on vehicle dash.
The recommended mounting location is inside the dash compartment located on right side of dash. The mounting hole locations have been marked as shown from the factory to aid in mounting.
18. Drill a 1" (25mm) diameter hole into the dash storage panel as shown, centered between dots embossed on dash. Drill two holes for screws with 5/32" (4.0mm) drill bit over embossed dots as shown in figures. (See illustrations 1-14 and 1-15).
19. Feed the corded remote harness thru the large hole and install the dash socket (item #22) using the supplied M5 flat washers (item #25) and small screws (item #24) into the dash as shown. (See illustrations 1-16 and 1-17). **Note, the screws have thread-forming feature and will cut threads into plastic dash panel.**
20. Torque screws to the specification listed, being careful not to overtighten.

 = T
SWITCH SCREW FASTENER TORQUE: 2 ft. lbs. (2.7 Nm)

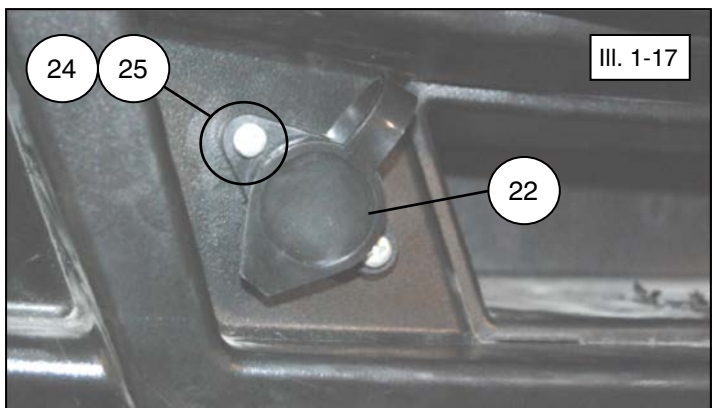
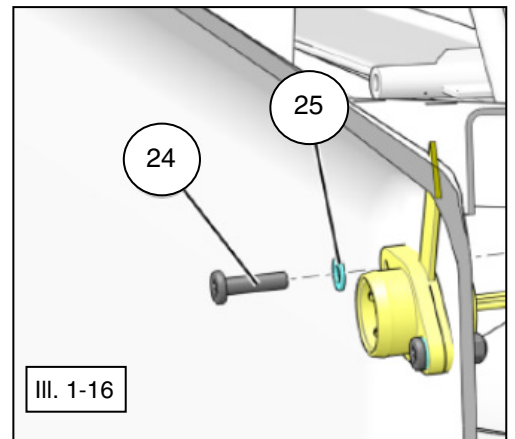
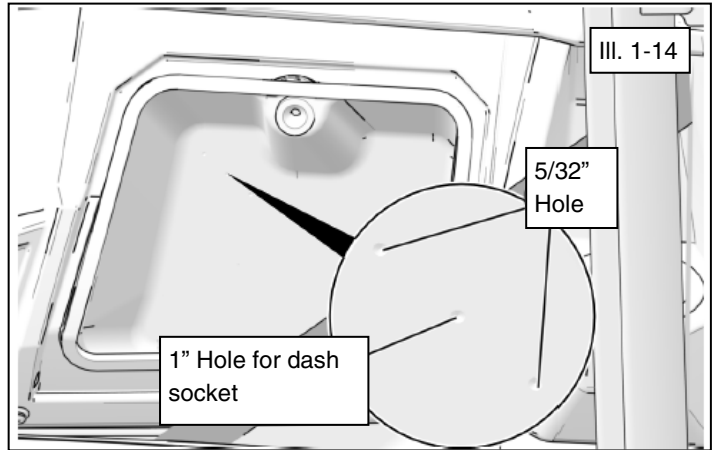

RANGER CORDED REMOTE SWITCH INSTALLATION (continued):

21. Locate the area where the wire harness will pass thru the dash wall. Route the supplied Ranger vehicle harness (item #22) through the firewall towards front gearcase area. Use cable ties (item #2) to secure the harness. (See illustration 1-18 and 1-20).
22. Attach the supplied red fused wire from harness kit (item #22) to the 12V accessory keyed power terminal post on the bus bar under the hood as shown. (See illustration 1-19). **Note, the power accessory splitter harness (item #23) will be used to connect to the Dash Mount switch into the red fused wire section. Also, if connecting both corded remote and dash switch, the splitter harness will connect the two switches to accessory power.**
23. Connect the white harness connector to the winch contactor connector as shown. Access is gained by reaching around the front bumper and thru the front gearcase access window to reach white contactor connector. (See illustration 1-20).

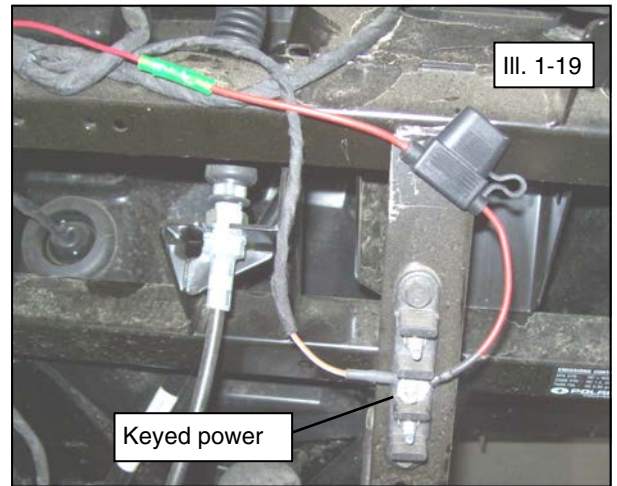
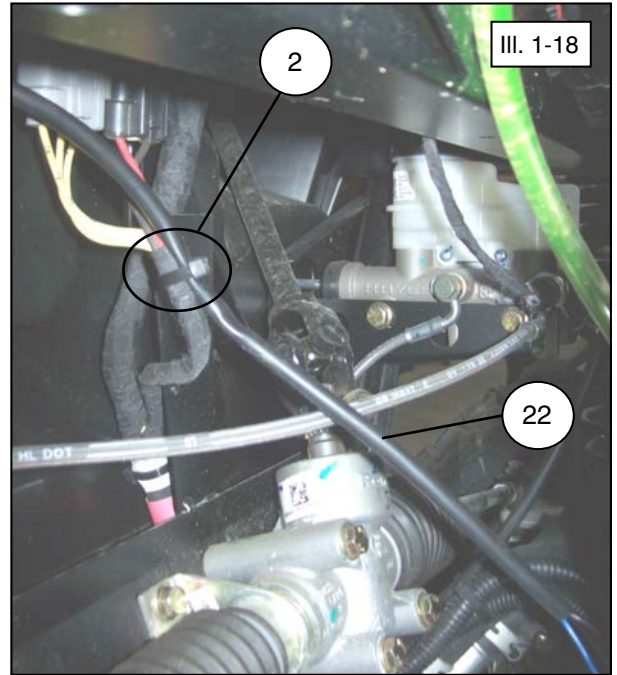

RANGER DASH MOUNT SWITCH INSTALLATION:

NOTE: See the Electrical Connections Reference Guide section of the instruction manual for detailed photos of each part and their respective connections.

24. Install dash mount switch (item #1) to desired location on your dash. Check to see if your vehicle has marked rectangular predefined switch location and trim area out. If not, use the cut-out dimensions shown below to cut-out the switch location in your desired location. (See illustrations 1-21 and 1-22).

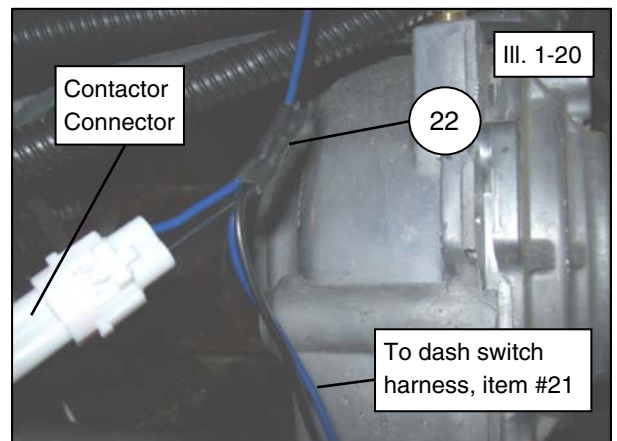
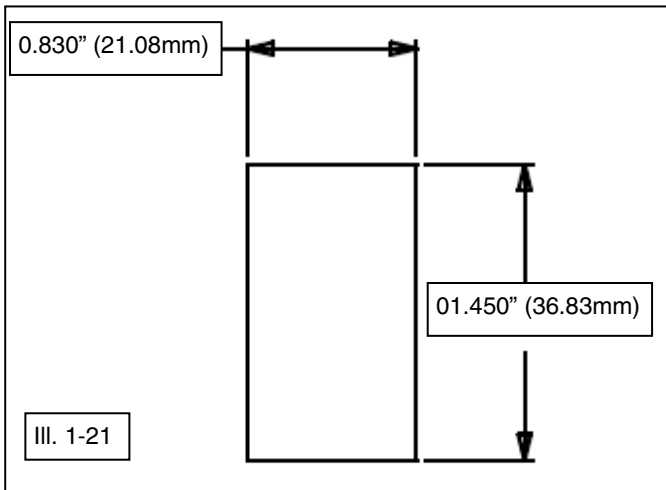

**RANGER DASH MOUNT SWITCH INSTALLATION
(continued):**

25. Connect the dash mount switch (item #1) to the Ranger Vehicle Dash Switch Harness (item #21). Connect green wire to the “Out” pin, red wire to the middle pin and black wire to the “In” pin as shown. (See illustration 1-23).
26. Insert the dash switch harness and switch assembly thru the panel hole as shown. The switch will clip into the dash panel. (See illustration 1-24).
27. From under the hood, connect the red lead wire from dash switch harness into the Accessory Power Splitter Harness (item #23) red wire receptacle, as mentioned in previous step 22. Then route and connect the Ranger Vehicle Dash Switch-Contactor Extension Harness (item #20) into the pigtail (item #21) and the white connector will plug into the winch contactor. (See illustrations 1-9, 1-20 and 1-25).

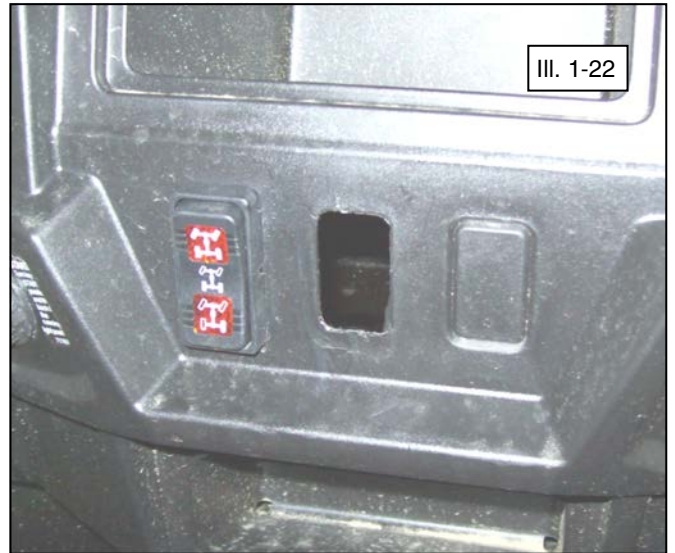

RANGER FINAL INSPECTION:

28. Confirm that all wiring is correct.
29. Confirm that there are no exposed wires or terminals.
30. All loose wires need to be wrapped tight, and secured away from moving parts and heat sources.

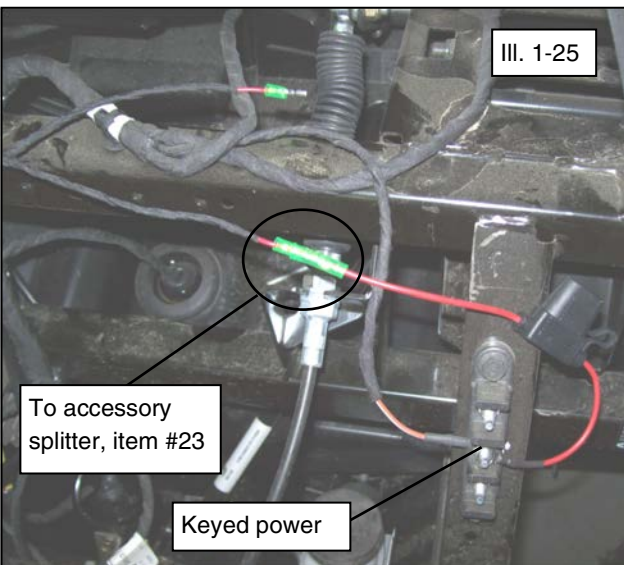
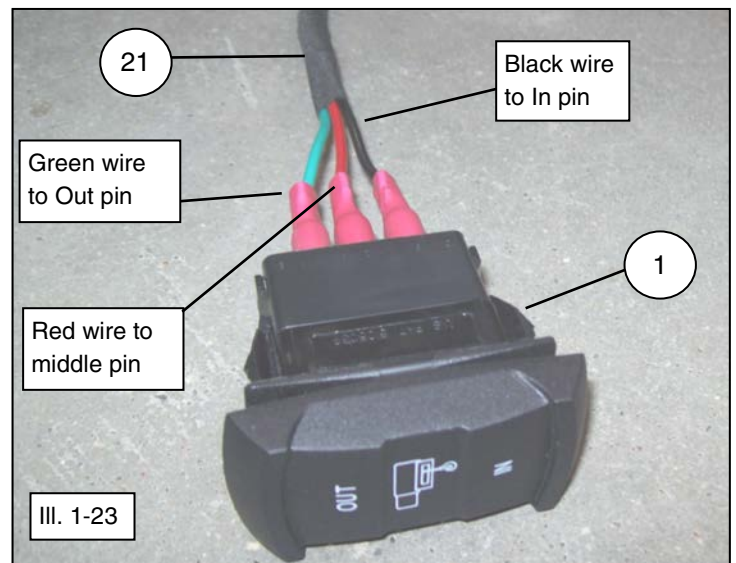

RANGER REINSTALLATION:

31. Reconnect the main vehicle power cables and the winch power red (positive) and black (negative) cables to battery terminals at this time using original hardware.
32. Re-install the seat.
33. Re-install the front hood.
34. Connect the corded winch remote switch (item #22) to the dash socket.
35. With vehicle key in the ON position, check winch for proper operation.

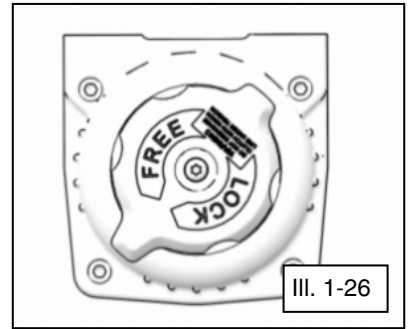

GEAR SELECTION:

Your winch is equipped with two different gear settings: “FREE” and “LOCK”.

1. FREE: Used to rapidly extend the rope/cable (faster than when in the “LOCK” position).
2. LOCK: Used to recover the rope/cable.

To shift between FREE and LOCK relieve all tension from the rope/cable, then rotate gear selector knob (located on end of winch) clockwise to engage LOCK mode, or counterclockwise to engage FREE mode.

Note, see kit contents for replacement knob PN.

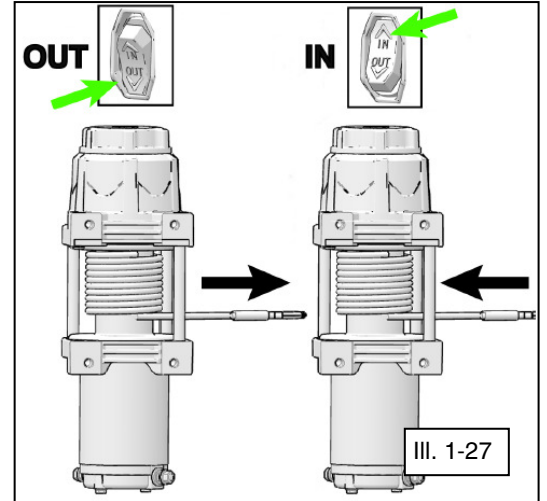

SWITCH OPERATION:

When properly installed, the handlebar switch allows you to operate the winch while seated on the vehicle. Proper switch operation is shown. (See illustration 1-27).

For additional assistance, please contact Kolpin customer service department at (877) 956-5746 or (763) 478-5800 or email customerservice@kolpin.com

Five Year Mechanical Limited Warranty and Three Year Electrical Limited Warranty

For the period of five (5) years from the purchase date, Kolpin will replace for the original purchaser, free of charge, any mechanical part or mechanical parts found upon examination by Kolpin to be defective in material, workmanship, or both. For the period of three (3) years from the purchase date, Kolpin will replace for the original purchaser, free of charge, any electrical part or electrical parts found upon examination by Kolpin to be defective in material, workmanship, or both.

All transportation costs incurred submitting product to Kolpin for warranty consideration must be borne by the purchaser. If Kolpin determines that the product must be returned to the factory for credit, please call 1-877-956-5746 for a Return Merchandise Authorization (RMA) number and shipping instructions.

This warranty does not apply to parts that have been damaged by accident, alteration, abuse, improper maintenance, normal wear, or other causes beyond the manufacturer's control. In order to protect you and your ATV, certain parts of the winch/plow system and/or hardware are designed to fail when the equipment is over-stressed. Parts that are lost due to loosening and improper maintenance are not covered under warranty. This warranty does not cover removal or reinstallation labor fees of the winch/plow system and related components.

Peripheral products such as engines, electric motors, and actuators may carry an original manufacturer's warranty. Most hardware is general in nature and is easily obtained locally. Be sure to replace with minimum metric class 8.8 specification.

Kolpin Outdoors, Inc.

www.kolpin.com

TROUBLESHOOTING

If your winch is not functioning properly, below is a short guide that can help you diagnose and correct the problem.

Symptom	Possible Causes	Recommended Solution
Winch will not operate	Contactors not receiving power	Turn vehicle key on.
	Connections between components not in proper order	Check connections. Connect wired handlebar switch connection from vehicle main wire harness directly to contactor to make sure a direct connection will operate the winch. If connections are not in the order shown in the pictures in the last page, the whole system may not function or only certain parts of it will function.
	Loose battery cable connections	Tighten nuts on all cable connections.
	Keyed power circuit (orange wires) not properly powered	Check fusebox for 10A accessory circuit. Check voltage in certain places, especially orange wires coming out of the main harness by the steering post.
	Contactors malfunctioning	Tap contactor to loosen contacts. Apply 12 volts to coil terminals directly. A clicking indicates proper activation.
	Defective switch assembly	Replace switch assembly.
	Defective motor	Check for voltage at armature port with switch pressed. If voltage is present, replace winch assembly.
	Nested and bounded cable within winch assembly	Move free spool knob to the "free spool" position. Manually pull cable out of winch until end is met and then re-spool cable back into winch.
	Water has entered motor	Allow to drain and dry. Run in short bursts without load until completely dry.
Winch makes noise but rope does not move	Contactors powered, but not winch	If you can hear a clicking sound when you press the winch control but the winch does not make any sounds, check the connections between the winch and the contactor.
	Winch not in proper gear	Move free spool knob to the "locked spool" position, then recheck. If problem persists, a qualified technician needs to check and repair.
Winch operates too slowly	Winch improperly loaded	Check that the winch is clear and the rope is not bound up and
	Insufficient current or voltage	The battery is weak, recharge. Run winch with vehicle motor running (battery should have a strong charge).
	Loose or corroded battery cable connections	Clean, tighten, or replace.
Winch overheating	Winch running time too long	Allow winch to cool down periodically.
Winch operates in one direction only	Defective or stuck contactor	Tap contactor to loosen contacts.
		Repair or replace contactor.
	Defective switch assembly	Replace switch assembly.
	Defective brake assembly	Replace winch assembly.

Note: If any hardware is missing, do not return to the store. Call us to help, Toll Free 1-877-956-5746.

NOTE

For further technical support, contact our help line at 1-877-956-5746.

ELECTRICAL CONNECTION REFERENCE GUIDE:

Ranger Midsize:

Winch with Roller Fairlead and Corded Remote Switch

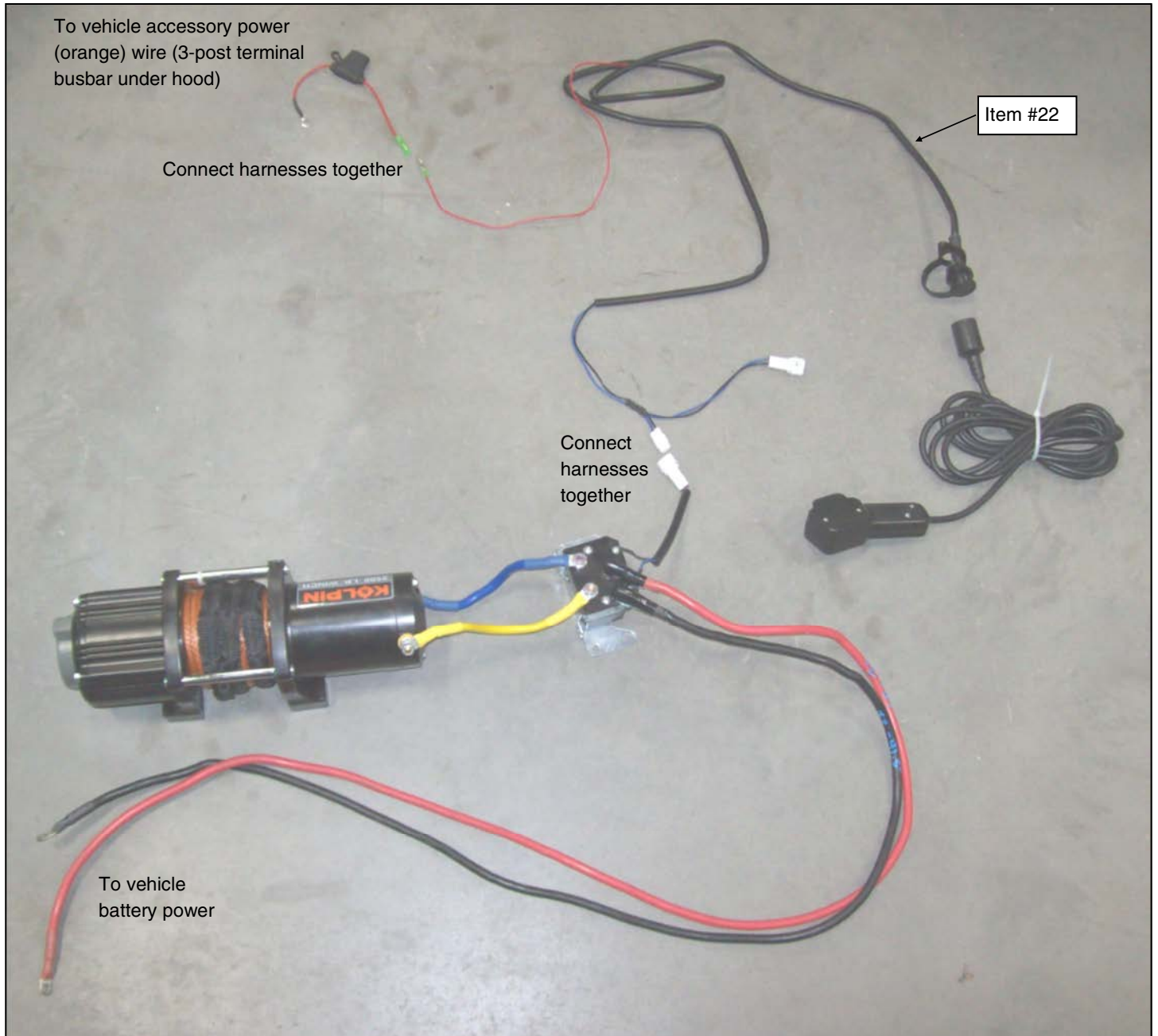

ELECTRICAL CONNECTION REFERENCE GUIDE (continued):

Ranger Midsize:

Winch with Roller Fairlead and Dash Switch

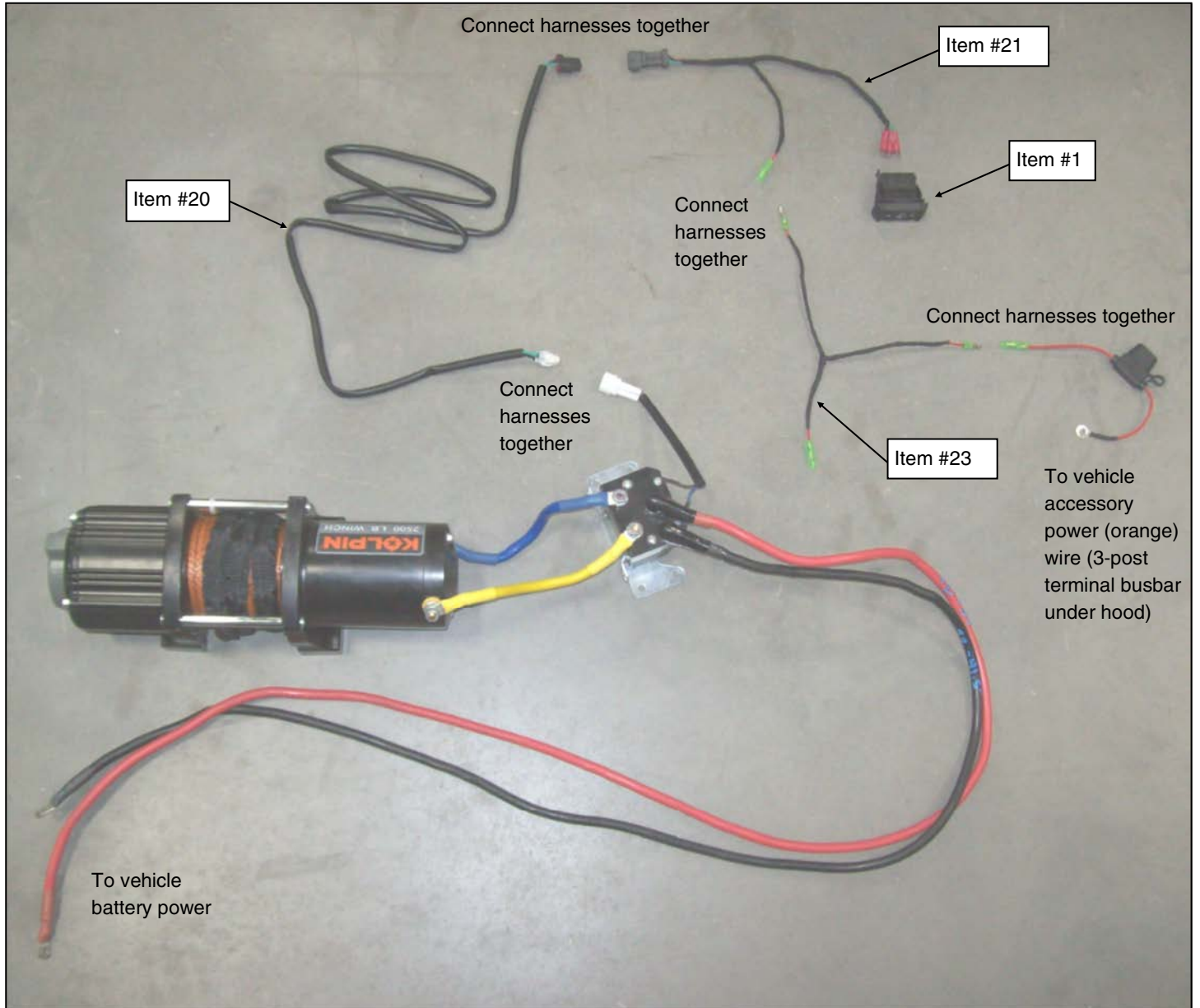

ELECTRICAL CONNECTION REFERENCE GUIDE (continued):

Ranger Midsize:

Winch with Roller Fairlead, Dash Switch and Corded Remote Switch

