

QUICK-MOUNT WINCH KIT

Assembly / Owner's Manual

APPLICATION: 2022 *RANGER* / *RANGER CREW*

Verify accessory fitment at [Kolpin.com](https://www.kolpin.com)

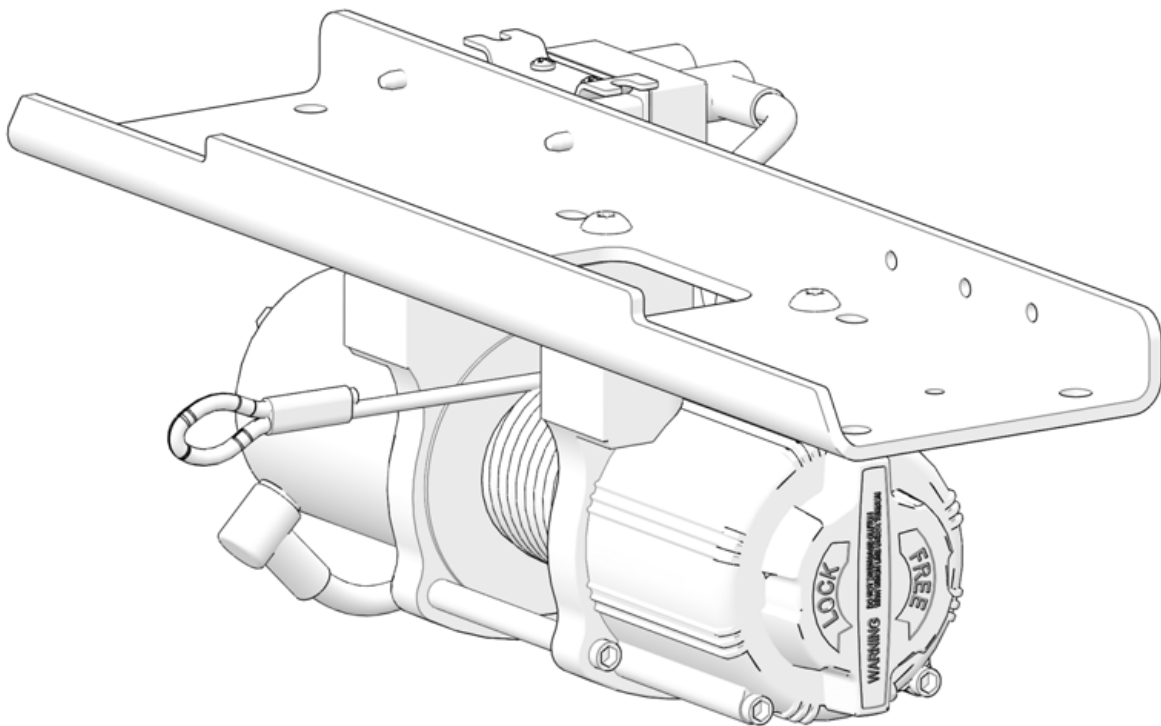

INTRO

Thank you for purchasing Kolpin® engineered products. With proper installation, usage, care, and maintenance, your Kolpin® product will last for years to come.

BEFORE YOU BEGIN

- Read and understand the entire installation manual, including all installation instructions, operating instructions, safety warnings and guidelines before installing or operating your accessory. Failure to comply may result in damage to the product and / or vehicle, and can lead to hazards up to and including death.
- Verify all parts and tools are accounted for. If parts are missing, do not return to the store. Call us for help, **Toll Free 1-877-956- 5746**
- Follow all steps correctly and in the sequence described.
- Keep these instructions for future reference or for informational requests.
- To facilitate installation, make sure that your vehicle is clean and free of debris.
- All directions referring to right and left are from the rider perspective when sitting on the machine.

IMPORTANT

You must order **Power Cables Kit 85095** separately to connect the battery to the contactor for models:

- 2022 *RANGER CREW 570*

ASSEMBLY TIME

Approximately 30 minutes

SAFETY INFORMATION

Please read and understand all assembly instructions, notices and warnings before assembling and operating your Kolpin winch system.

Follow these guidelines to ensure satisfactory operation:

- Read this manual and your ATV / UTV operators manual before use.
- Periodically check for wear and tightness of all fasteners. Replace or re-torque fasteners as necessary.

TOOLS REQUIRED

- Safety Glasses
- Cutting Tool
- Drill
 - 1 in (25 mm)
 - 5/32 in (4 mm)
- Pliers
- Socket Set, Metric
- Torque Wrench
- Wrench Set, Metric

KIT CONTENTS

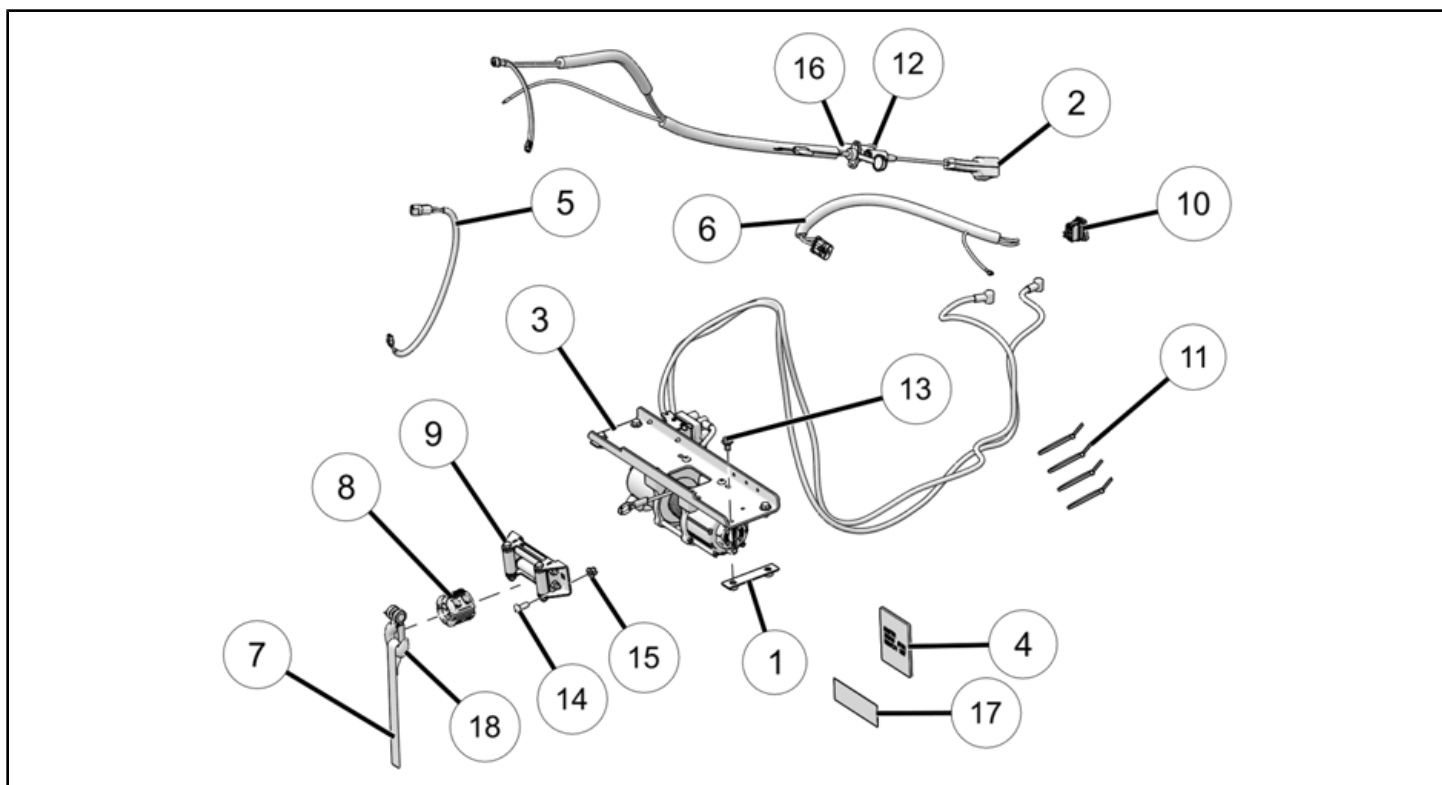

| REF | QTY | PART DESCRIPTION | PART NUMBER |
|-----|-----|------------------------------------|-------------|
| 1 | 2 | BRKT-Mount Backer | 25-3430 |
| 2 | 1 | Remote, Switch, 4500 | 85067 |
| 3 | 1 | ASM-Winch, 3500 INTG | n/a |
| 4 | 1 | INSTR-INTG 3500 SYN Winch Kit | n/a |
| 5 | 1 | Wire-Harness | n/a |
| 6 | 1 | Ranger Dash Harness | n/a |
| 7 | 1 | Strap, Winch, Hook, Kolpin, Orange | 85071 |
| 8 | 1 | Winch Stop | 85080 |
| 9 | 1 | Roller-Fairlead, Winch 4500 | 85087 |
| 10 | 1 | Switch-Winch | 25-0700 |
| 11 | 4 | Cable-Tie, 25-76MM, WEATH. -RES. | 7080492 |
| 12 | 2 | SCR- #10x3/4-HI/LO-PN-T25, TRX-M | 7512026 |
| 13 | 4 | SCR- HXFL-M10 x 1.5 x 20 8.8 Z NYL | 7518460 |
| 14 | 2 | SCR-RHCAR-M10 x 1.5 x 25 8.8 ZOD | 7519372 |
| 15 | 2 | NUT-M10 x 1.5 HFN NYLOC ZOD | 7547423 |
| 16 | 2 | Washer-M5, Flat | 7556724 |
| 17 | 1 | Promo Decal | n/a |
| 18 | 1 | Roller Hawse Hook | RPR0108 |

WINCH DETAIL

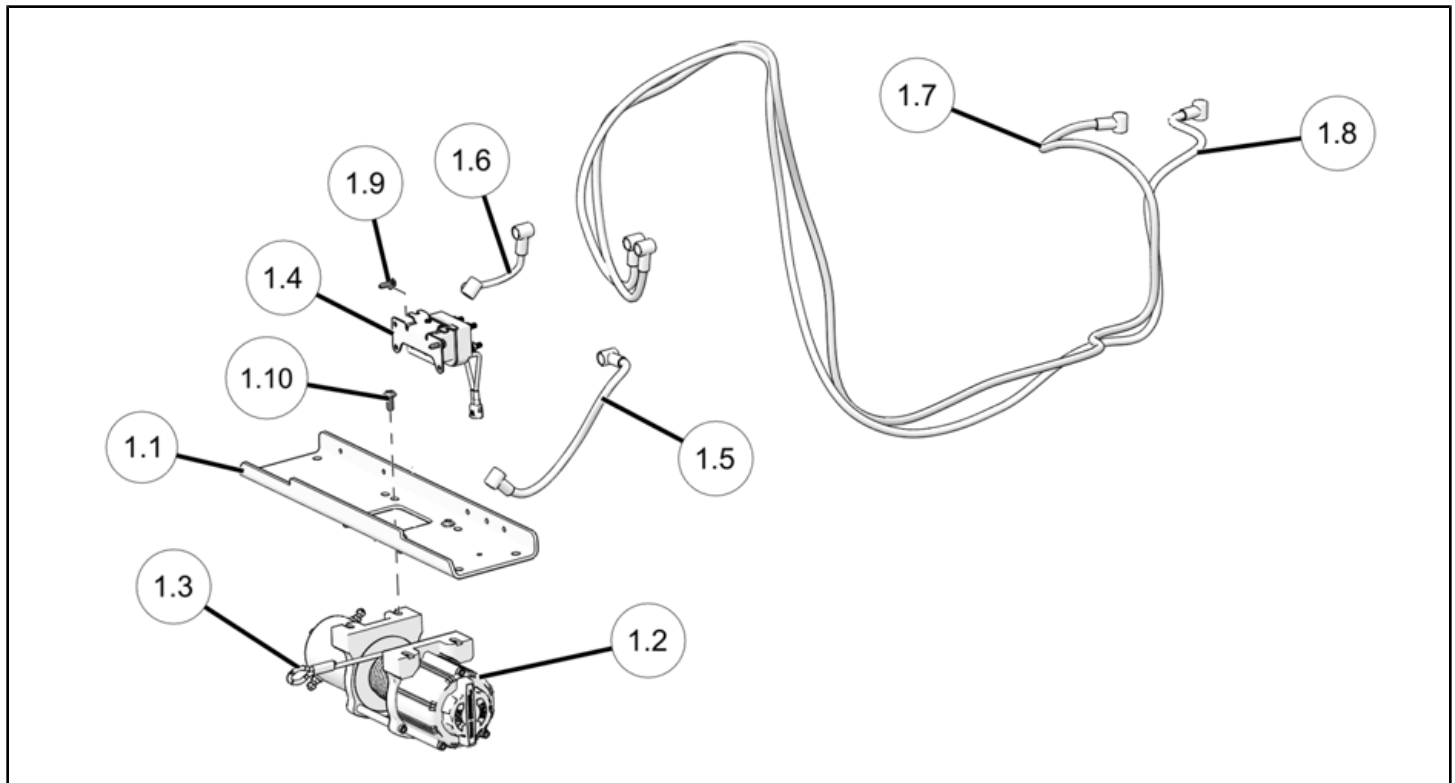

| REF | QTY | PART DESCRIPTION | PART NUMBER |
|------|-----|--|-------------|
| 1.1 | 1 | BRKT-Mount, Winch | 25-3430 |
| 1.2 | 1 | Replacement Winch 3500# | 25-9350R |
| 1.3 | 1 | Synthetic Rope, Kolpin Brand 2500/3500 | 85065 |
| 1.4 | 1 | Contactor | 85068 |
| 1.5 | 1 | Cable-Winch, Yellow 6 GA, 120mm | n/a |
| 1.6 | 1 | Cable-Winch, Blue 6 GA, 230mm | n/a |
| 1.7 | 1 | Cable-Power, Winch, Black #6 1651mm | n/a |
| 1.8 | 1 | Cable-Power, Winch, Red #6, 1651mm | n/a |
| 1.9 | 2 | SCR-TFHFL M6 x 1.0 x 15 CHS BLK | 7518513 |
| 1.10 | 4 | SCR-TXTH-M8 x 1.25 x 20 8.8 ZODP30 | 7519260 |

INSTALLATION INSTRUCTIONS

VEHICLE PREPARATION

GENERAL

1. Park the vehicle on a flat surface.
2. Shift the vehicle into PARK.
3. Turn the key to the OFF position and remove the key.
4. Flip up and/or remove the passenger's seat bottom and remove the under seat storage compartment tray (if applicable) by pulling it in upward direction.
5. Disconnect the black negative (-) cable from the battery, then disconnect the red positive (+) cable from the battery.

WARNING

ALWAYS disconnect black negative (-) cable from the battery **FIRST**. Failure to do so will result in high current electrical arc, and may result in battery explosion if a tool touches the grounded frame. Death or serious injury may occur.

6. Remove the front bumper by removing the four bolts (two upper and two lower) as shown. Retain the bolts for reuse.

NOTICE

The bumper is heavy. Provide adequate support before removing screws.

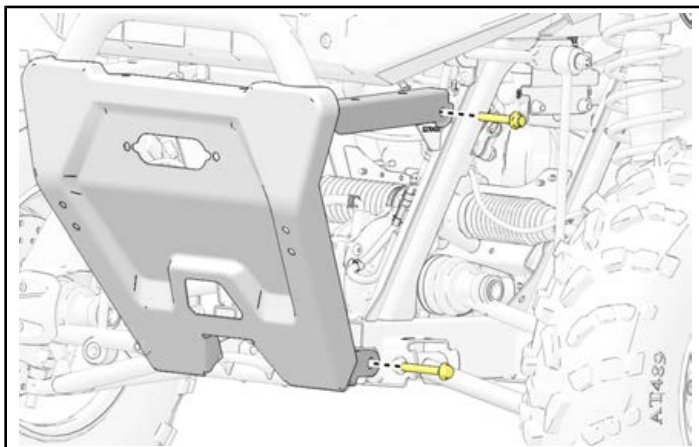

7. Unlatch the two hood latches to remove the hood.



8. Remove the eight plastic tuflock rivets securing the driveshaft cover to the floor. Save the fasteners for use during reinstallation. Remove the driveshaft cover from vehicle.

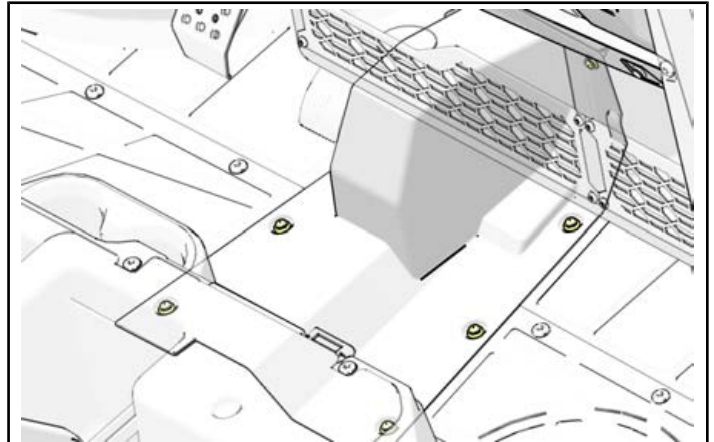

9. Remove the winch assembly from the packaging.



ACCESSORY INSTALLATION

WINCH INSTALLATION

1. Place the winch sub assembly onto the bumper of the vehicle.
2. Insert the four screws ⑬ through the mount and bumper.
3. Fasten the four screws ⑬ using the two nut brackets ①. Torque to specification.

TORQUE

Nut Bracket Screws:
34 ft-lbs (46 N·m)

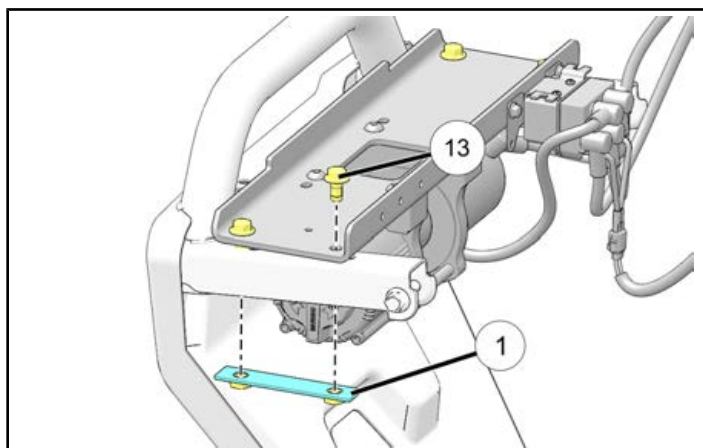

4. Install the roller fairlead ⑨ to the vehicle bumper using the two M10 carriage screws ⑭.

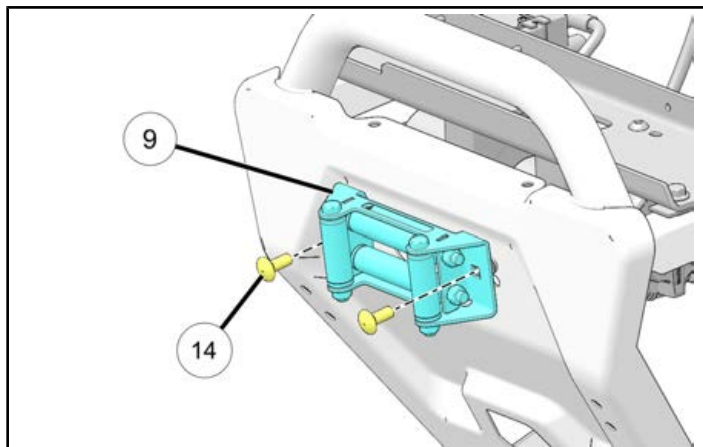

5. Feed the rope through the roller fairlead.

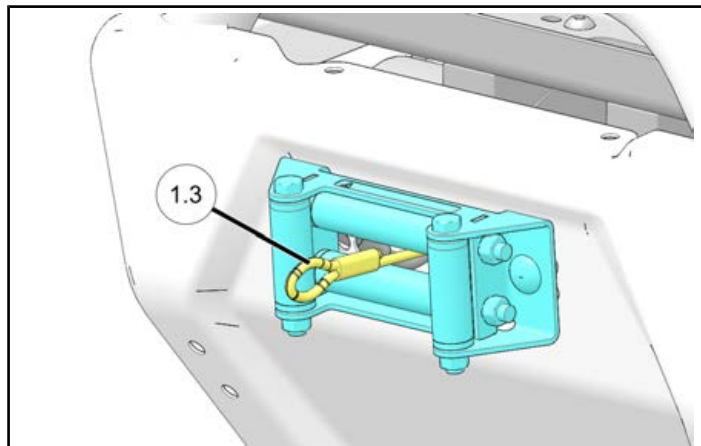

6. Fasten the screws ⑭ using the M10 locknuts ⑮. Torque to specification.

TORQUE

Roller Locknuts:
34 ft-lbs (46 N·m)

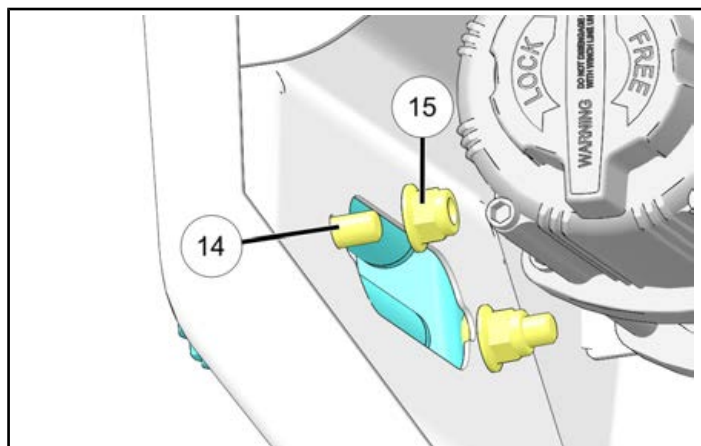

7. Install the rubber bumper ⑧, hook ⑱, and strap ⑦ onto the rope thimble end loop.

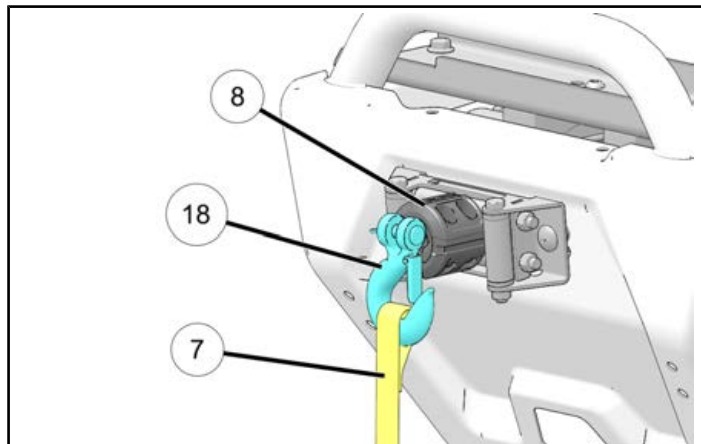

8. Locate the red and black wires on the winch assembly. If the wires are secured in a bundle with a plastic tie, cut the tie to allow the cables to be routed through the frame.

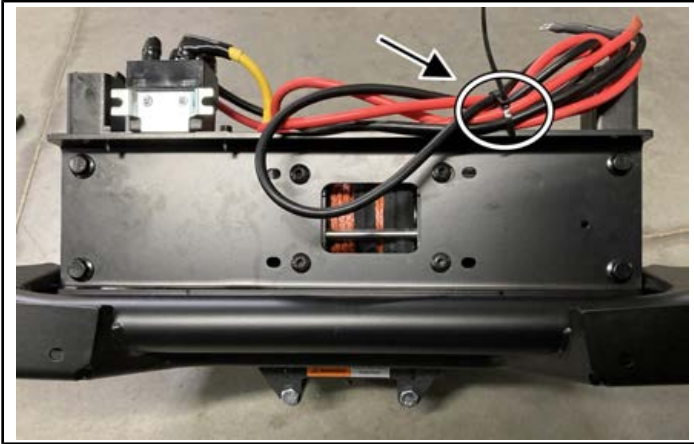

9. Reinstall the front bumper with the four retained bolts. Loosely install all bolts before tightening to specification.

IMPORTANT

Make sure no wires are pinched between the joining parts.

TORQUE

Bumper Bolts:
30 ft-lbs (41 N·m)

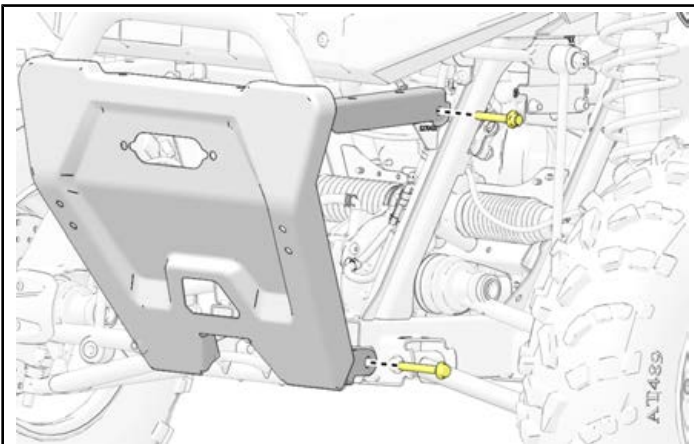

10. Route the red and black battery cables up along the front frame over the front shock (19), then down the cab wall (20) towards the center floor (21) along the existing factory wire harness. The black and red battery leads route and follow the main factory harness to the battery compartment (22). Use zip ties (23) to secure the harness.

IMPORTANT

Do not connect the cables to the battery and bus bar terminals at this time.

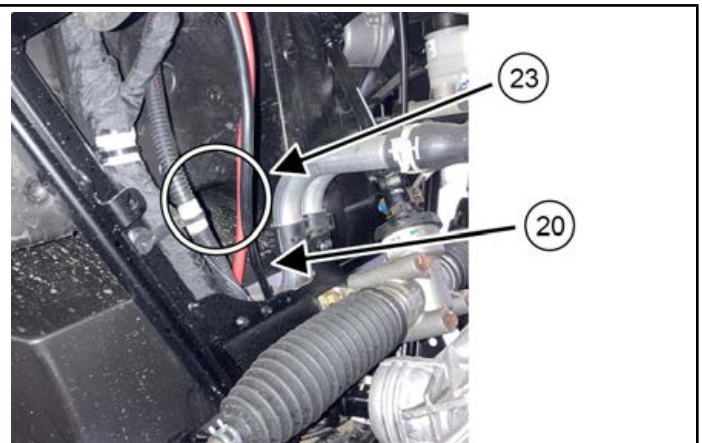
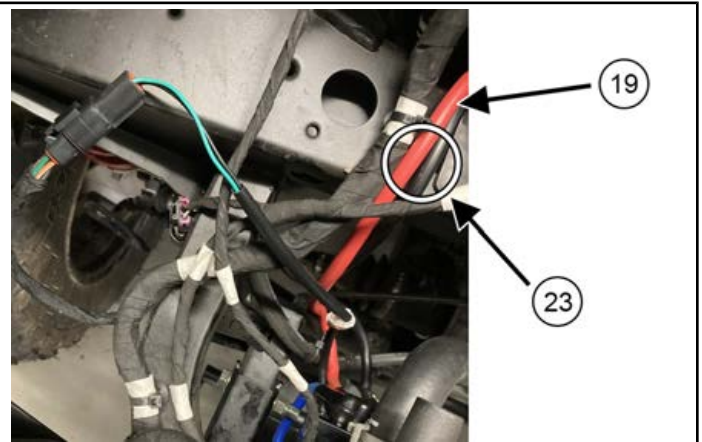
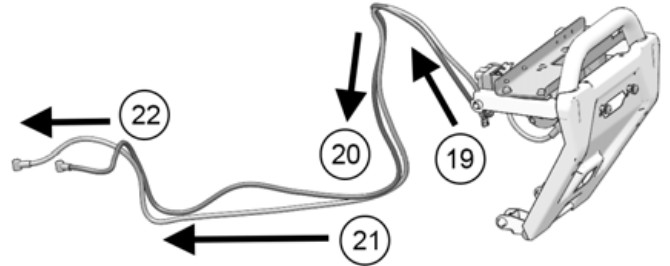

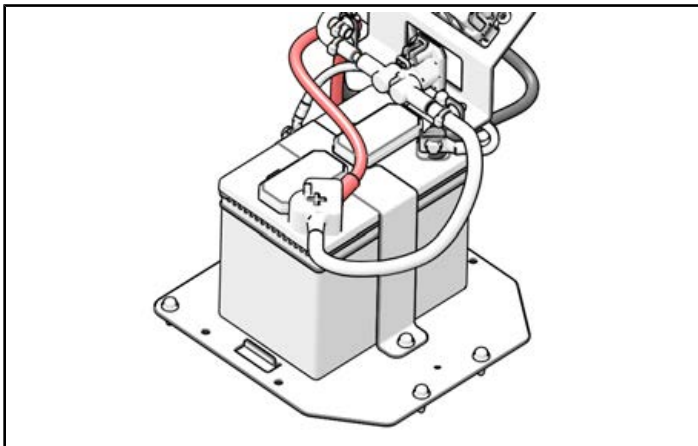
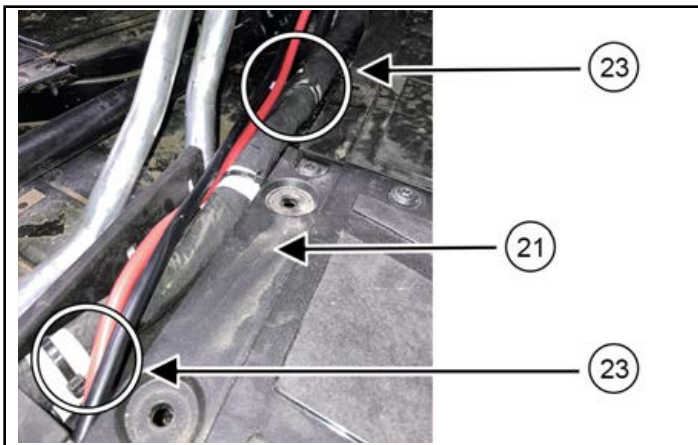

11. Verify the wire routing to make sure the red and black cables are secured away from any moving or potentially hot parts.
12. Reinstall the driveshaft floor cover using the eight plastic tuflok rivets previously removed.

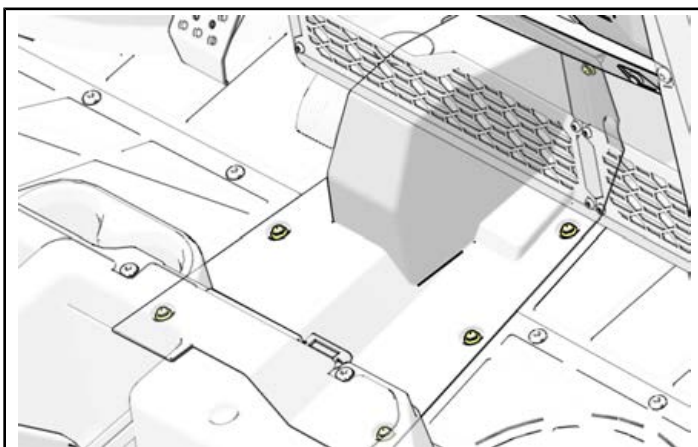

REMOTE AND SWITCH INSTALLATION

1. Remove the top center dash cover (cup holder) of the vehicle by removing the two plastic tuflok push rivets.

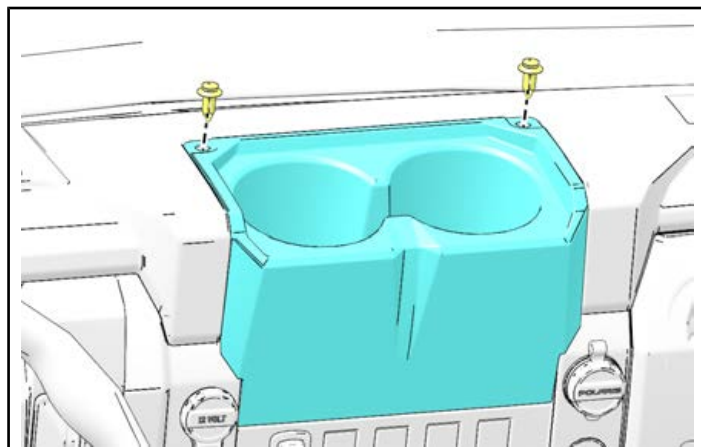

2. Connect the contactor to the vehicle harness ④ using the wire harness ⑤.

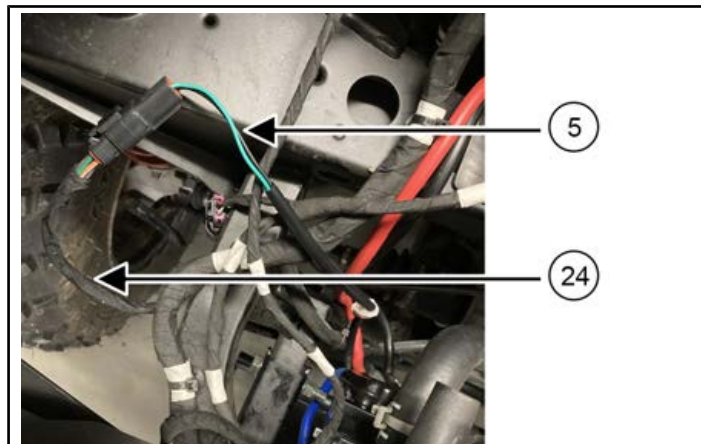
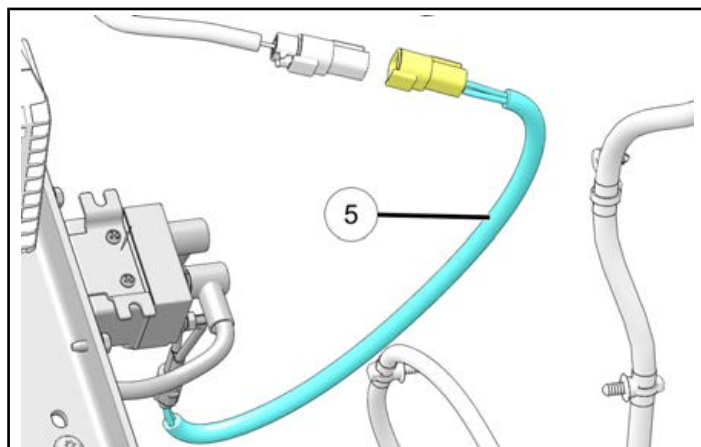

3. Connect the switch harness (dash harness) ⑥ to the vehicle plug connector near the cab wall.

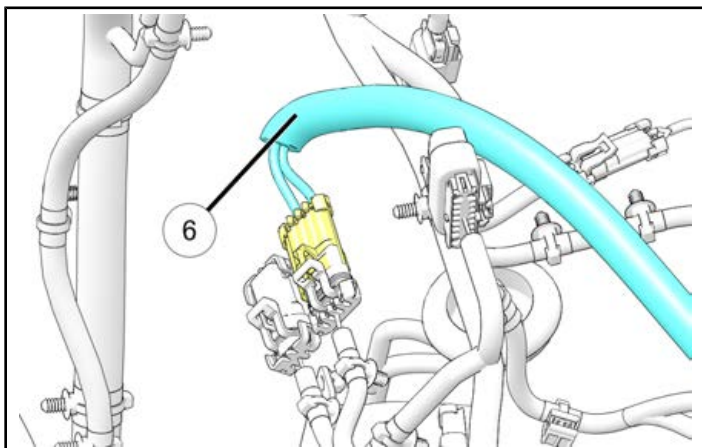

4. Route the switch harness (dash harness) ⑥ through the dash to the switch panel location. The switch harness (dash harness) should be secured with a zip tie to the main vehicle harness.

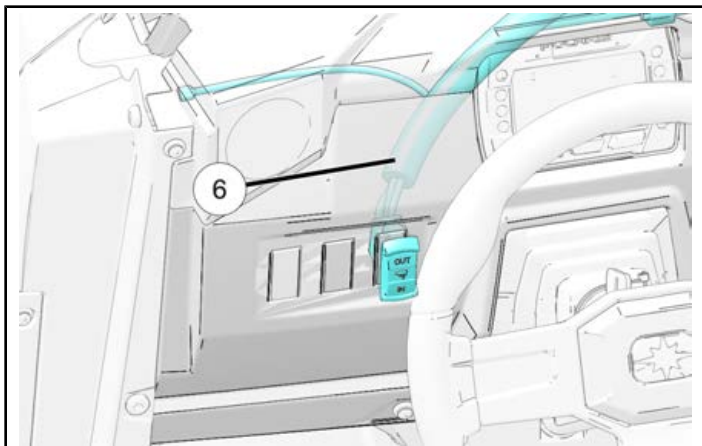

5. Cut out the dash pattern using the provided dimensions.

IMPORTANT

The pattern on the dash panel may not match the switch. Use the provided dimensions.

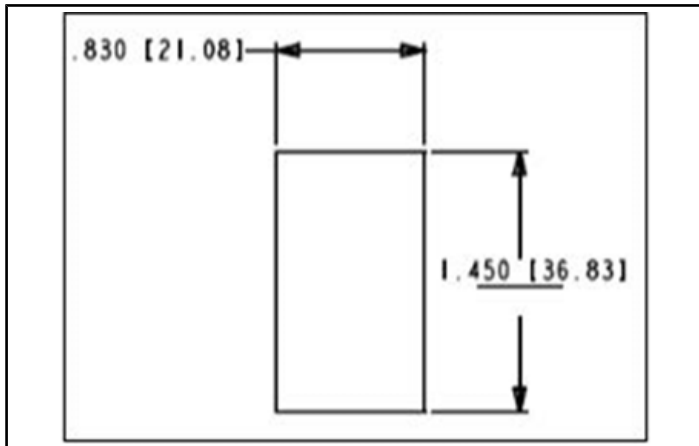
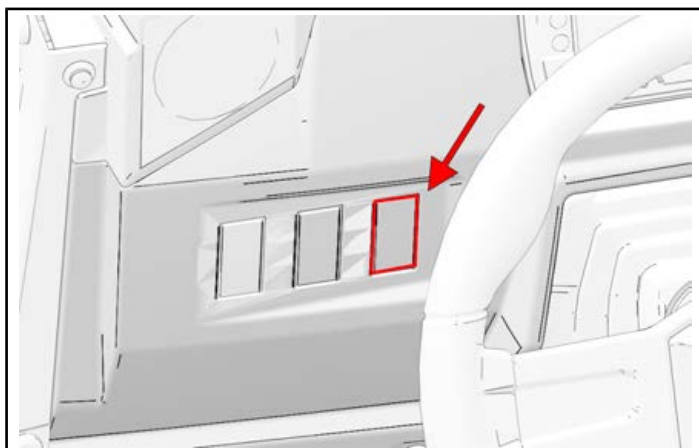

6. Install the dash switch into the panel cutout.

7. Connect the switch harness (dash harness) ⑥ to the dash switch.

IMPORTANT

Wires must be connected in the order shown.

- Top “Out” – Green wire
- Middle – Red wire
- Bottom “In” – Black wire

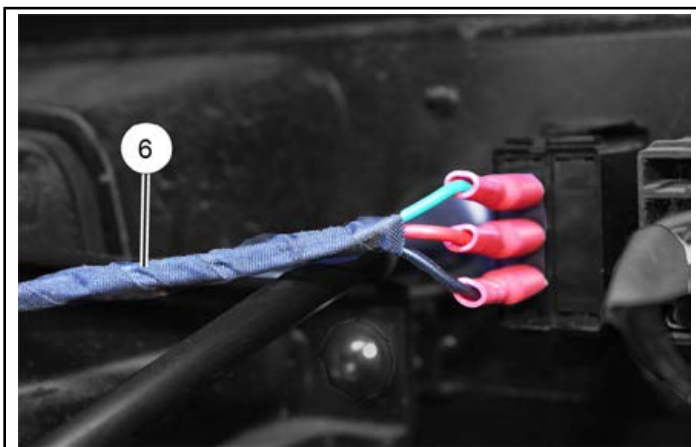

8. Locate the corded remote socket location in the glovebox.

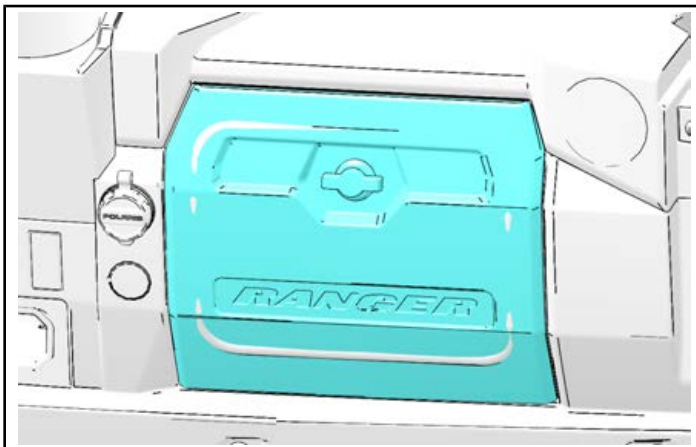

9. Drill a center 1 inch hole.

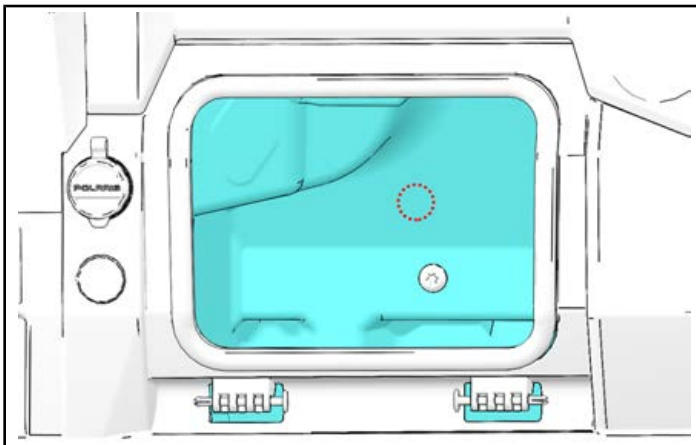

10. Install the harness socket into the drilled hole.

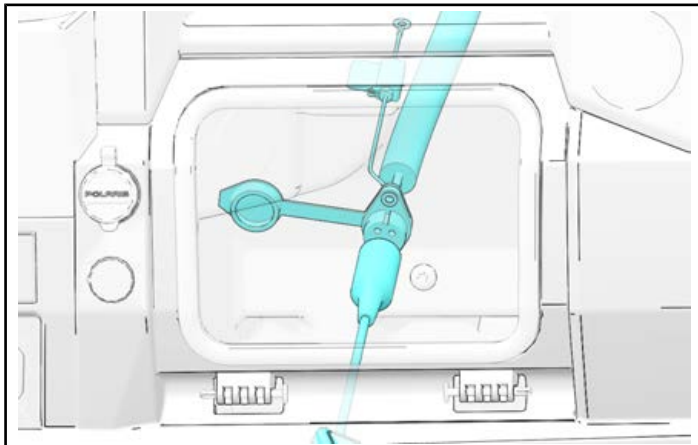

11. Mark the screw holes.

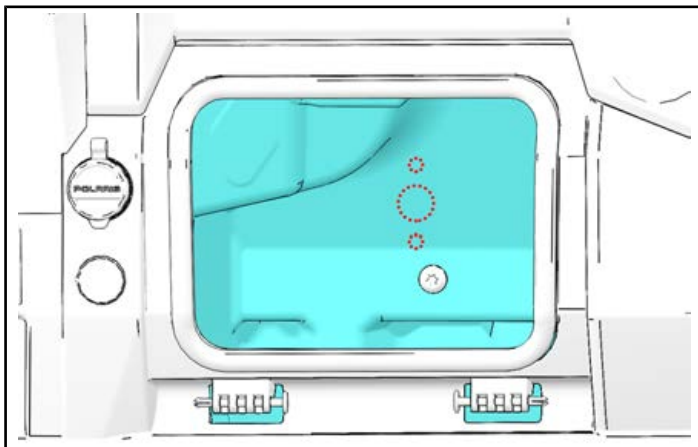

12. Drill the screw holes with a 5/32 inch (4mm) bit.

13. Install the two screws ⑫ and two washers ⑯ to attach the remote to the glovebox. Tighten the screws until fully seated.

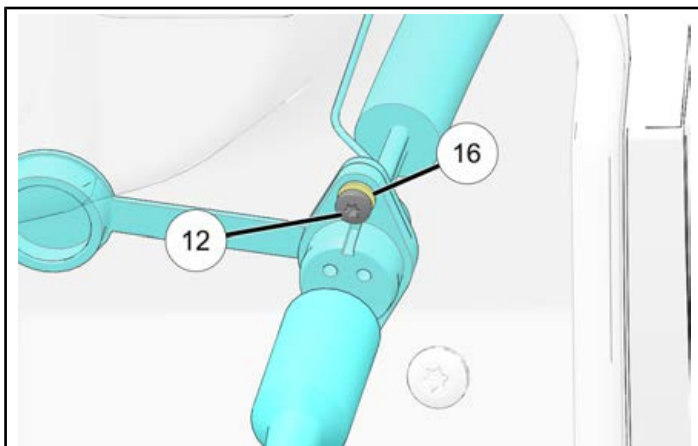

14. Connect the switch harness (dash harness) ⑥ red wire to the remote switch harness ② red wire.

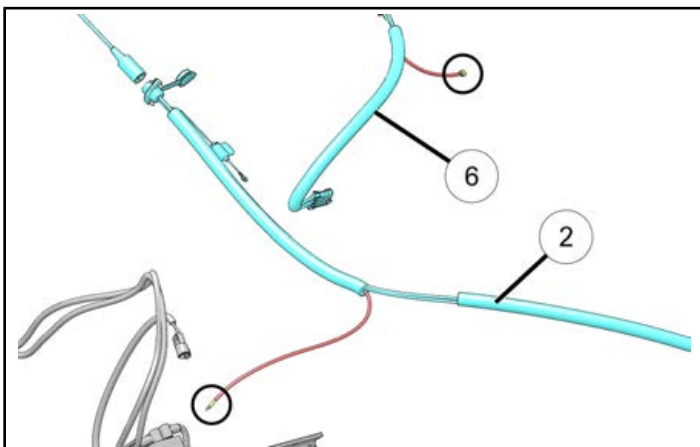

15. Put the remote harness ② down through the vehicle by the winch.

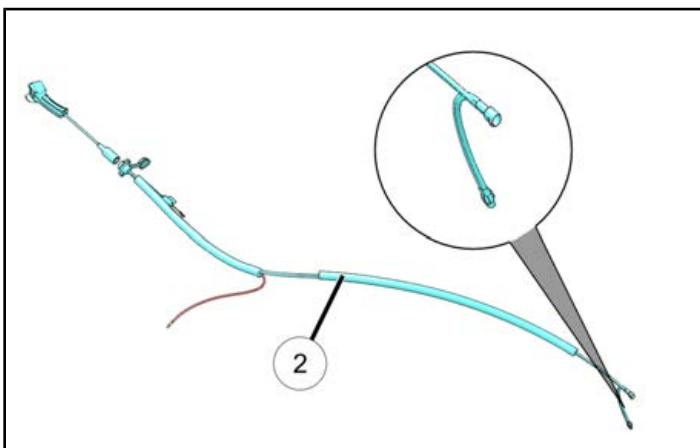

16. Connect the winch harness ⑤ to the winch contactor harness .

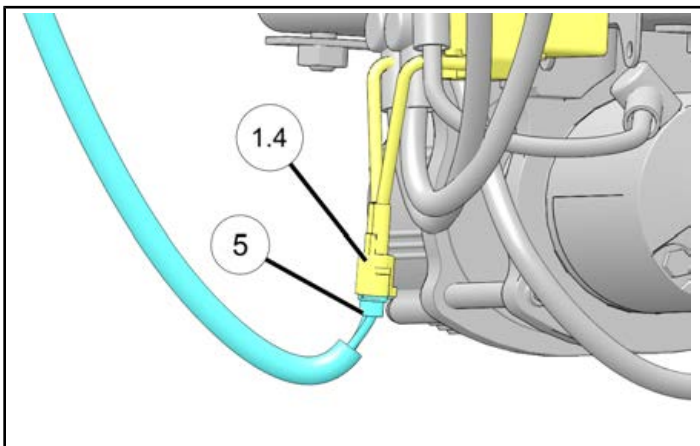

17. Secure the winch harness ⑤ to the frame with a zip tie ②③.

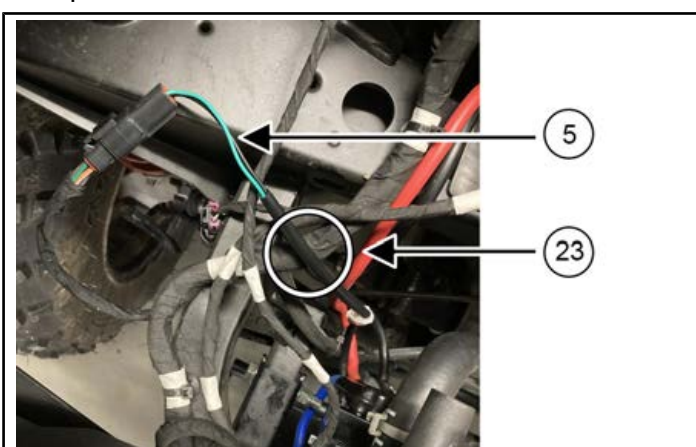

VEHICLE REASSEMBLY

1. Confirm all the wiring is correct and there are no exposed wires or terminals.
2. Tightly wrap all loose wires and secure all wires away from moving parts and heat sources.
3. Connect the positive and negative battery cables as shown in the Owner's manual.

⚠ WARNING

When BOTH battery cables are disconnected ALWAYS connect AND tighten the red positive (+) battery cable FIRST. Failure to comply will result in a high current electrical arc that may result in battery explosion if a tool touches the grounded frame. Death or serious injury may occur.

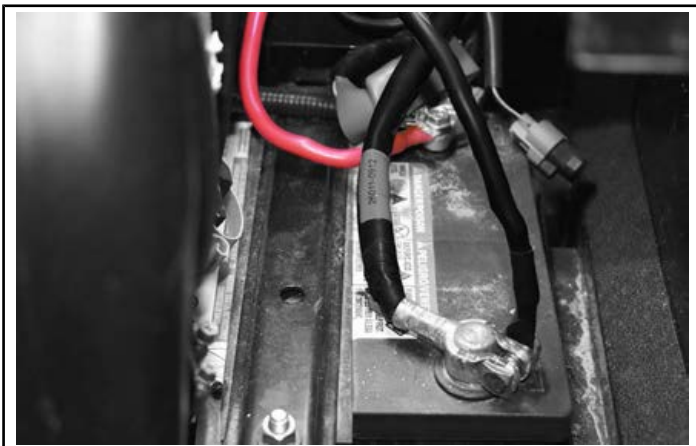

4. Reinstall the seat, the center dash panel, and the hood.
5. With the vehicle key ON, test the winch operation.

CONTROL SWITCH OPERATION

When properly installed, the control switches allow you to operate the winch while seated in the vehicle using the dash switch or remotely using the corded switch. Proper switch operation is shown.

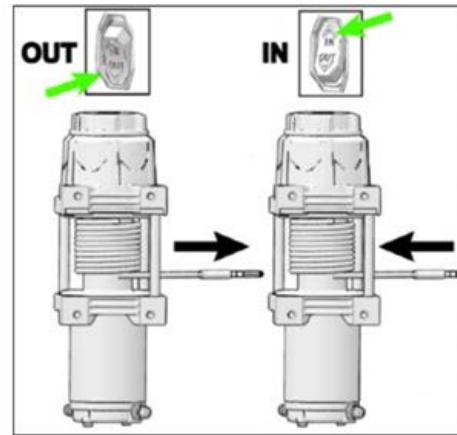

TROUBLESHOOTING

| SYMPTOM | POSSIBLE CAUSES | RECOMMENDED SOLUTION |
|--|--|--|
| Winch will not operate. | Contactors not receiving power. | Turn vehicle key ON. |
| | Connections between components not in proper order. | Check connections. Connect wired handlebar switch connection from vehicle main wire harness directly to contactor to make sure a direct connection will operate the winch. If connections are not in the order shown in the pictures on the last page, the whole system may not function, or only certain parts of it will function. |
| | Loose battery cable connections. | Tighten nuts on all cable connections. |
| | Keyed power circuit (orange wires) not properly powered. | Check fusebox for 10A accessory circuit. Check voltage in certain places, especially orange wires coming out of the main harness by the steering post. |
| | Contactors malfunctioning. | Tap contactor to loosen contacts. Apply 12 volts to coil terminals directly. A clicking indicates proper activation. |
| | Defective switch assembly. | Replace switch assembly. |
| | Defective motor. | Check for voltage at armature port with switch pressed. If voltage is present, replace winch assembly. |
| | Nested and bounded cable within winch assembly. | Move free spool knob to the "free spool" position. Manually pull cable out of winch until end is met and then re-spool cable back into winch. |
| | Water has entered motor. | Allow to drain and dry. Run in short bursts without load until completely dry. |
| Winch makes noise, but rope does not move. | Contactors powered, but not winch. | If you can hear a clicking sound when you press the winch control, but the winch does not make any sounds, check the connections between the winch and the contactor. |

| | | |
|---------------------------------------|--|---|
| | Winch not in proper gear. | Move free spool knob to the “locked spool” position, then recheck. If problem persists, a qualified technician needs to check and repair. |
| Winch operates too slowly. | Winch improperly loaded. | Check that the winch is clear and the rope is not bound up. |
| | Insufficient current or voltage. | The battery is weak, recharge. Run winch with the vehicle motor running (battery should have a strong charge). |
| | Loose or corroded battery cable connections. | Clean, tighten, or replace. |
| Winch overheating. | Winch running time too long. | Allow winch to cool down periodically. |
| Winch operates in one direction only. | Defective or stuck contactor. | Tap contactor to loosen contacts. |
| | | Repair or replace contactor. |
| | Defective switch assembly. | Replace switch assembly. |
| | Defective brake assembly. | Replace winch assembly. |

ELECTRICAL CONNECTION REFERENCE GUIDE

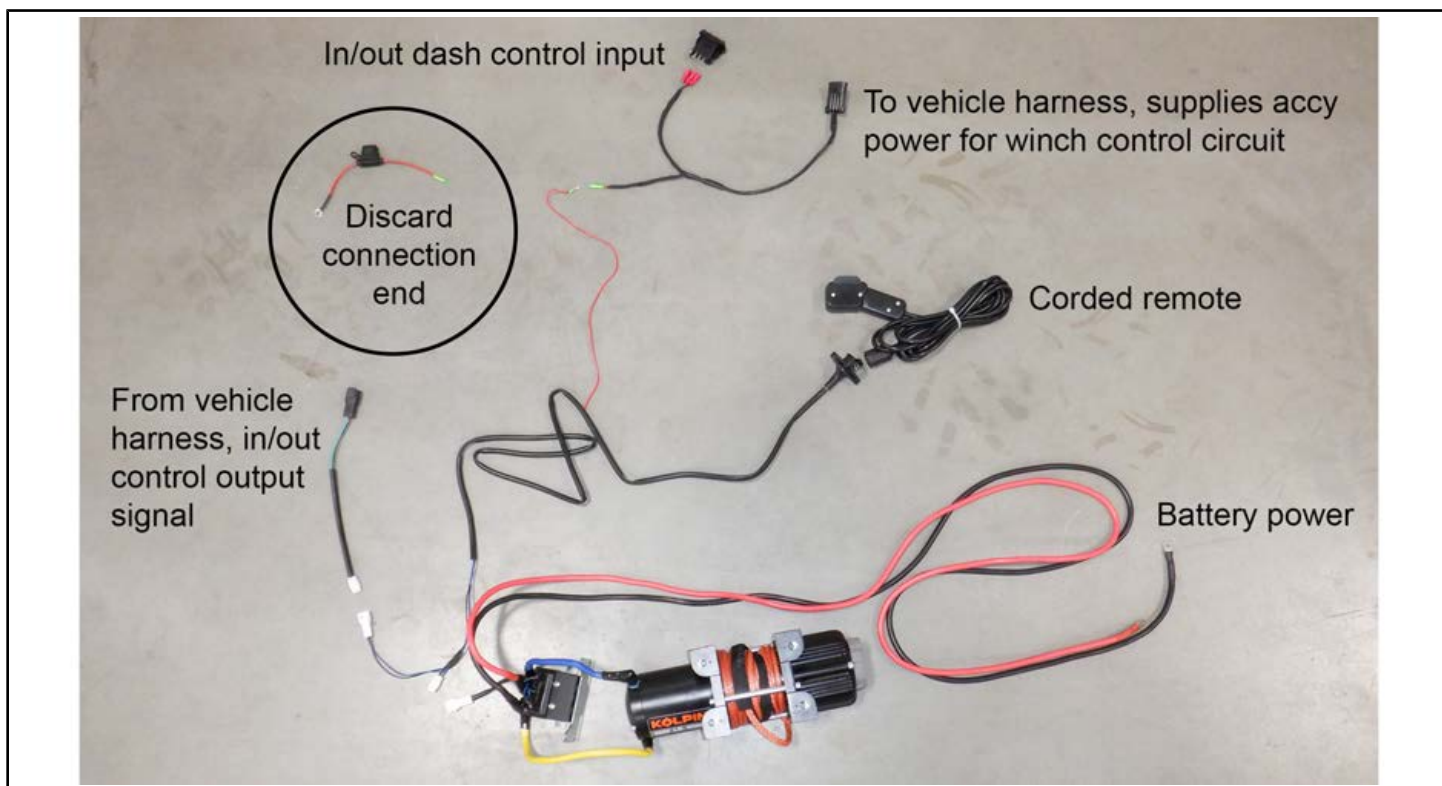

WARRANTY



FIVE YEAR MECHANICAL LIMITED WARRANTY AND THREE YEAR ELECTRICAL LIMITED WARRANTY

For the period of five (5) years from the purchase date, Kolpin will replace for the original purchaser, free of charge, any mechanical part or mechanical parts found upon examination by Kolpin to be defective in material, workmanship, or both. For the period of three (3) years from the purchase date, Kolpin will replace for the original purchaser, free of charge, any electrical part or electrical parts found upon examination by Kolpin to be defective in material, workmanship, or both.

All transportation costs incurred submitting product to Kolpin for warranty consideration must be borne by the purchaser. If Kolpin determines that the product must be returned to the factory for credit, please call 1-877-956-5746 for a Return Merchandise Authorization (RMA) number and shipping instructions.

This warranty does not apply to parts that have been damaged by accident, alteration, abuse, improper maintenance, normal wear, or other causes beyond the manufacturer's control. In order to protect you and your ATV, certain parts of the winch/plow system and/or hardware are designed to fail when the equipment is overstressed. Parts that are lost due to loosening and improper maintenance are not covered under warranty. This warranty does not cover removal or reinstallation labor fees of the winch/plow system and related components.

Peripheral products such as engines, electric motors, and actuators may carry an original manufacturer's warranty. Most hardware is general in nature and is easily obtained locally. Be sure to replace with minimum metric class 8.8 specification.

Kolpin Outdoors, Inc.

Telephone: (763)-478-5800

Toll Free: (877)-956-5746

Fax Number: (800)-245-7569

www.Kolpin.com

Email: customerservice@kolpin.com