

**POLARIS SPORTSMAN® QUICK-MOUNT
2500 LB / 3500 LB WINCH KIT**



P/N 26-3200; 26-3210

QUICK-MOUNT WINCH KIT

Assembly / Owner's Manual

APPLICATION: Polaris Sportsman®
Verify accessory fitment at Kolpin.com

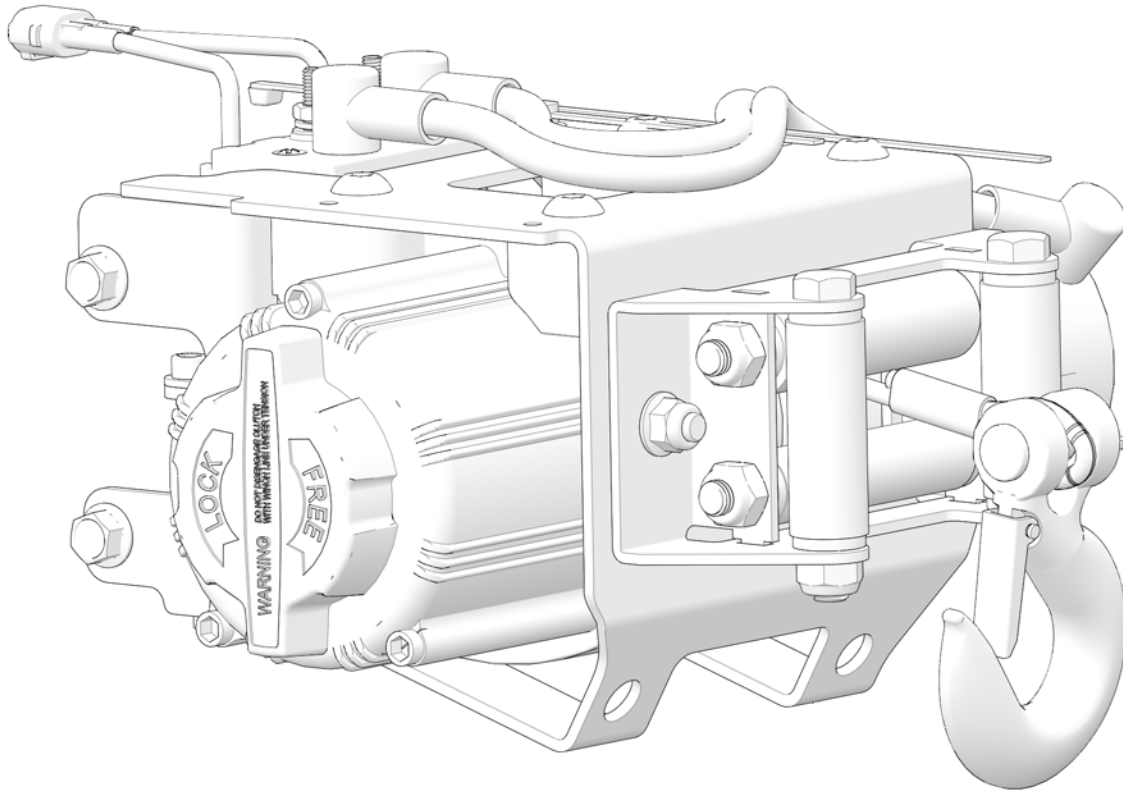

INTRO

Thank you for purchasing Kolpin engineered products. With proper installation, usage, care, and maintenance, your Kolpin product will last for years to come.

BEFORE YOU BEGIN

- Read and understand the entire installation manual, including all installation instructions, operating instructions, and safety warnings and guidelines before installing or operating your accessory. Failure to comply may result in damage to the product, damage to the vehicle, and can lead to hazards up to and including death.
- Verify all parts and tools are accounted for. If parts are missing, do not return to the store. Call us for help, **Toll Free 1-877-956- 5746**
- To ensure a satisfactory installation, follow all steps correctly and in the sequence described.
- Keep these instructions for future reference or for informational requests.
- To facilitate installation, make sure that your vehicle is clean and free of debris.
- All directions referring to right and left are when the rider is sitting on the machine.

ASSEMBLY TIME

Approximately 30 minutes

SAFETY INFORMATION

Please read and understand all assembly instructions, notices, and warnings before assembling and operating your Kolpin winch.

Follow these guidelines to ensure satisfactory operation:

- Read this manual and your ATV/ UTV operators manual before use.
- Periodically check for wear and tightness of all fasteners. Replace or re-torque fasteners as necessary.

TOOLS REQUIRED

- Safety Glasses
- Cutting Tool
- Pliers, Push Pin Rivet
- Socket Set, Metric
- Socket Set, Torx® Bit
- Torque Wrench
- Wrench Set, Metric

KIT CONTENTS

2500 LB WINCH P/N 26-3200; 3500 LB WINCH P/N 26-3210

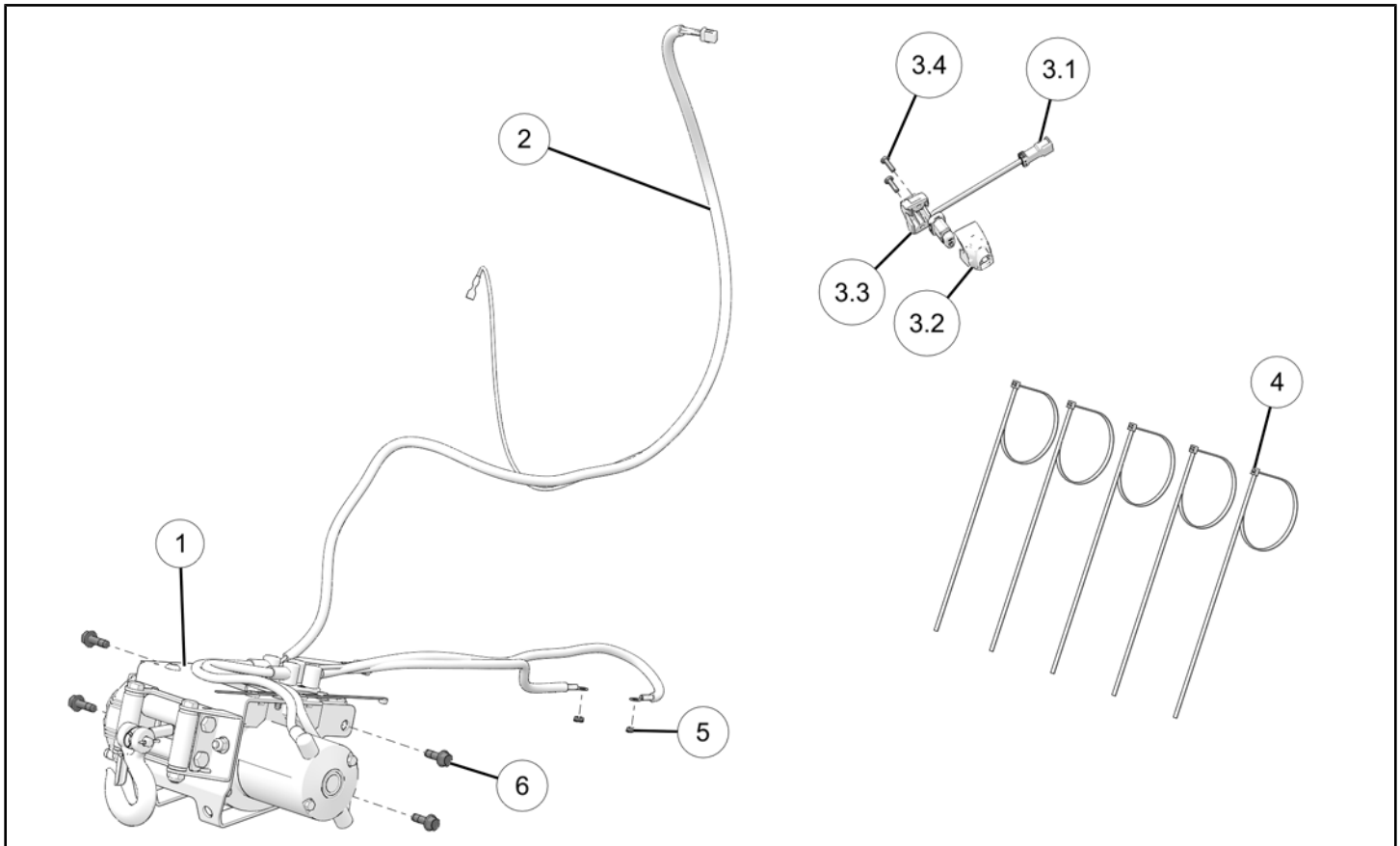

NOTICE

2500 lb Winch shown, 3500 lb similar.

| REF | QTY | PART DESCRIPTION | PART NUMBER |
|-----|-----|--|-------------|
| 1 | 1 | Winch Assembly – Polaris® 2500 lb Winch Assembly – Polaris® 3500 lb | n/a |
| 2 | 1 | Wire Harness | n/a |
| 3.1 | 1 | Switch | 85096 |
| 3.2 | 1 | Switch Housing, Front | 85096 |
| 3.3 | 1 | Switch Housing, Rear | 85096 |
| 3.4 | 1 | Screw – Torx® Pan Head, 10 x 5/8 in, HI/LO | 85096 |
| 4 | 5 | Cable Tie | 7080492 |
| 5 | 2 | Nut – Lock, 10-32 | 7547341 |
| 6 | 4 | Screw – Hex Flange, M8 x 1.25 x 25 mm | 7519739 |

2500 LB WINCH P/N 26-3200; 3500 LB WINCH P/N 26-3210 WINCH DETAIL

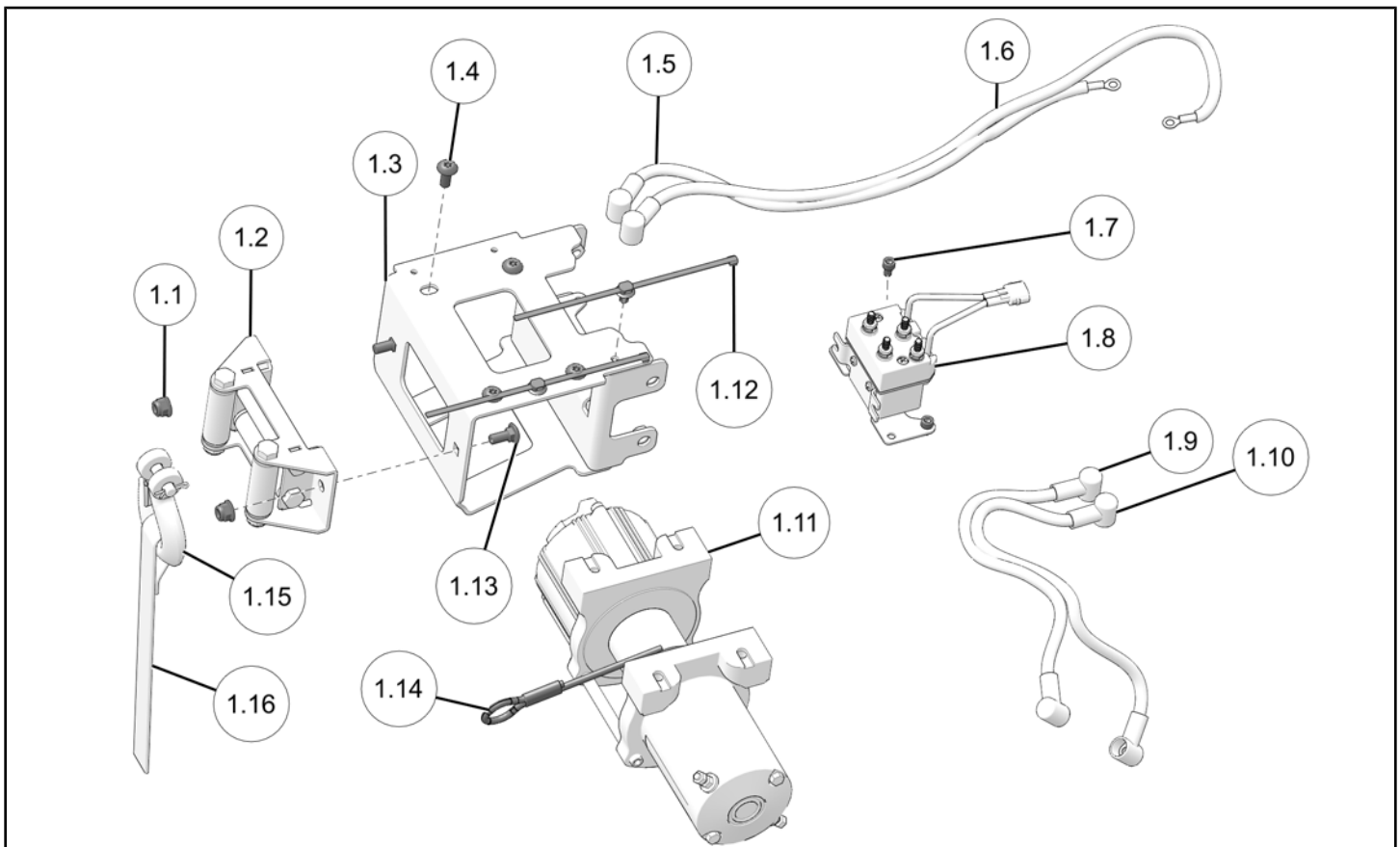

NOTICE

2500 lb Winch shown, 3500 lb similar.

| REF | QTY | PART DESCRIPTION | PART NUMBER |
|------|-----|---|----------------------|
| 1.1 | 2 | Nut – Hex Flange, M8 x 1.25 mm | 7547317 |
| 1.2 | 1 | Roller Hawse | 85069 |
| 1.3 | 1 | Winch Bracket | 25-3410 |
| 1.4 | 4 | Screw – Torx® Truss Head, M8 x 1.25 x 20 mm | 7519260 |
| 1.5 | 1 | Cable – Red, 6 GA | n/a |
| 1.6 | 1 | Cable – Black, 6 GA | n/a |
| 1.7 | 2 | Screw – Socket Head, M6 x 1.0 x 10.0 mm | 7517337 |
| 1.8 | 1 | Contactor | 85068 |
| 1.9 | 1 | Cable – Blue, 6 GA | n/a |
| 1.10 | 1 | Cable – Yellow, 6 GA | n/a |
| 1.11 | 1 | Winch, 2500 lb Winch, 3500 lb | 25-9250R 25-9350R |
| 1.12 | 2 | Routing Clip | 7081496 |
| 1.13 | 2 | Screw – Carriage Bolt, M8 x 1.25 x 20 mm | 7518479 |
| 1.14 | 1 | Cable – Steel, 3/16 in Rope – Synthetic, 3/16 in | 85062 85065 |

| REF | QTY | PART DESCRIPTION | PART NUMBER |
|------|-----|---|-------------|
| 1.15 | 1 | Roller Hawse Hook | RPR0108 |
| 1.16 | 1 | Strap, Kolpin® Orange | 85071 |
| | 1 | Winch Stop, Rubber – not shown (26–3210 only) | 85080 |

INSTALLATION INSTRUCTIONS

Vehicle Preparation, Accessory Installation, and Vehicle Reassembly instructions are provided for:

- 2021 Sportsman 450/570 models
- 2014–2020 Sportsman 450/570 models
- 2013–2021 Sportsman 850/1000 models

Proceed with installation procedures that best fit your model.

VEHICLE PREPARATION

GENERAL

1. Park vehicle on a flat surface.
2. Push engine stop switch to OFF position.
3. Turn key to OFF position and remove key.
4. Remove accessory front brush guard from vehicle, if equipped. See Kit Instructions for procedure.
5. Release rubber latch on both sides and open front rack.

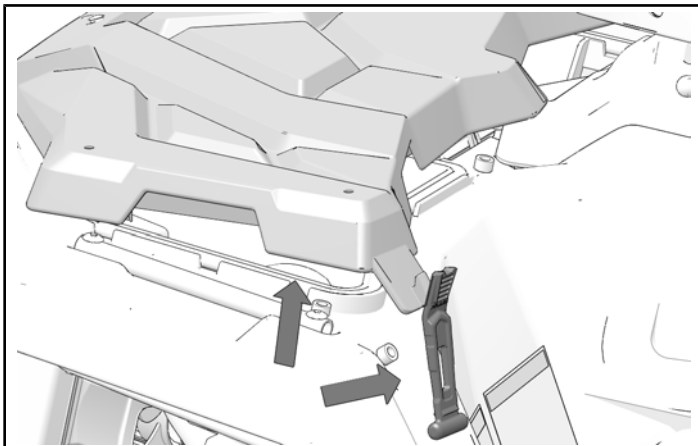

2021 SPORTSMAN 450/570 MODELS

1. Remove and keep nut from black (negative) battery cable and disconnect negative battery cable. Move boot off red (positive) battery cable. Remove and keep nut from red (positive) battery cable and disconnect positive battery cable.

⚠ WARNING

Always disconnect black negative (-) cable from battery FIRST. Failure to do so will result in high current electrical arc and may result in battery explosion if tool touches grounded frame. Death or serious personal injury may occur.

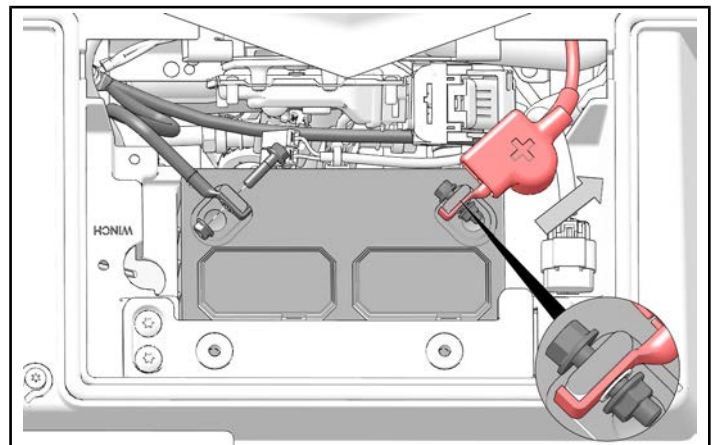

2. Remove and keep four bolts from lower front bumper cover. Remove lower front bumper cover.

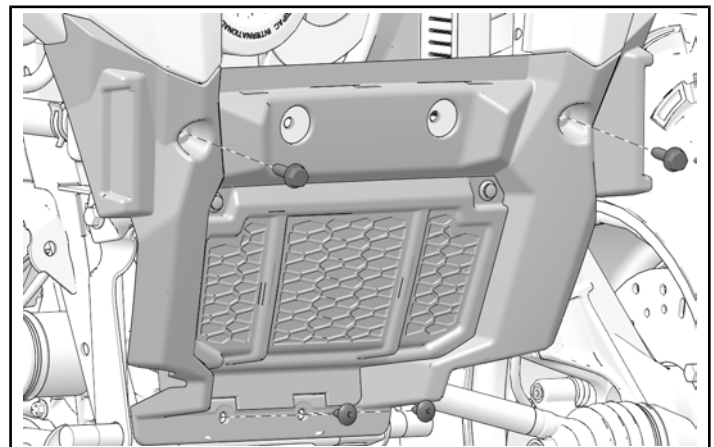

3. Remove and discard two push pin rivets from panel on front bumper cover. Remove and discard panel.

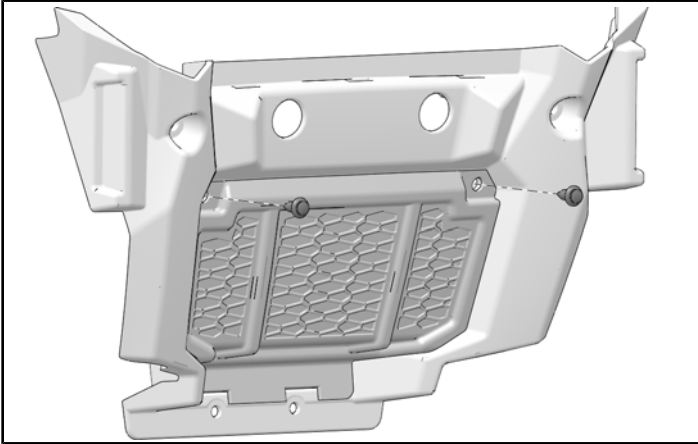

2014–2020 SPORTSMAN 450/570 MODELS

1. Remove and keep rubber seal (C).

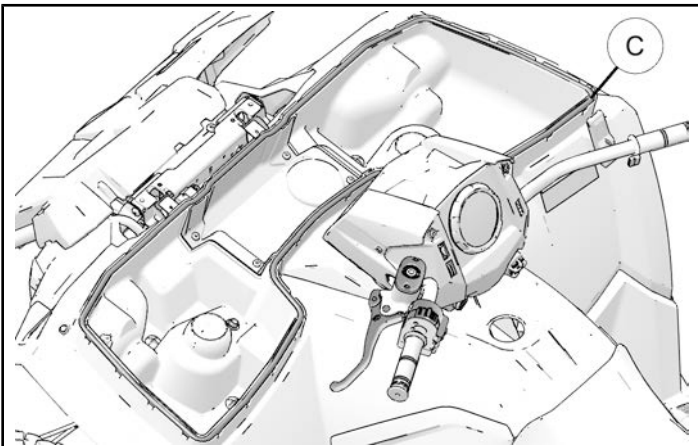

2. Remove and keep four screws (D) from front cover (E).

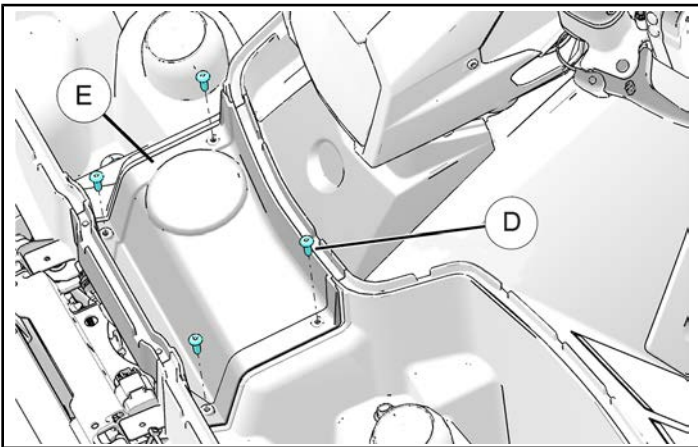

3. Lift front cover upwards slowly to disengage tabs on cover from slots (F).

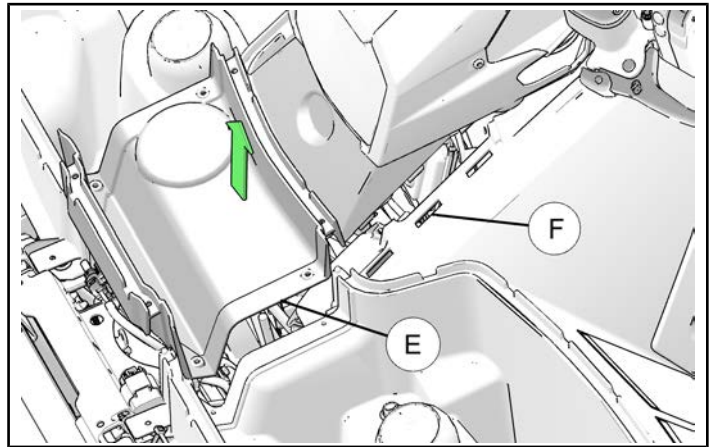

4. Remove and keep nut from black (negative) battery cable and disconnect negative battery cable. Move boot off red (positive) battery cable. Remove and keep nut from red (positive) battery cable and disconnect positive battery cable.

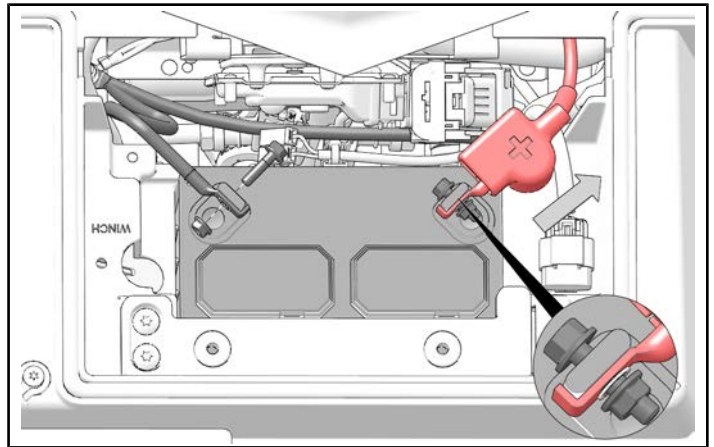

⚠ WARNING

Always disconnect black negative (-) cable from battery FIRST. Failure to do so will result in high current electrical arc and may result in battery explosion if tool touches grounded frame. Death or serious personal injury may occur.

- Remove and keep four lower front bumper cover bolts (K).

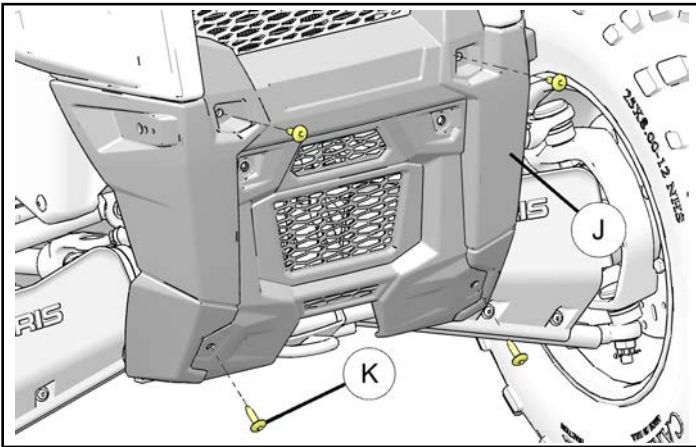

- Remove winch cover from lower front bumper cover.

TIP

If you plan to use a plow, do not reinstall lower front bumper cover. If you do not plan to use a plow, you may either cut out center section as shown and reinstall winch cover to lower front bumper cover, or choose to not reinstall.

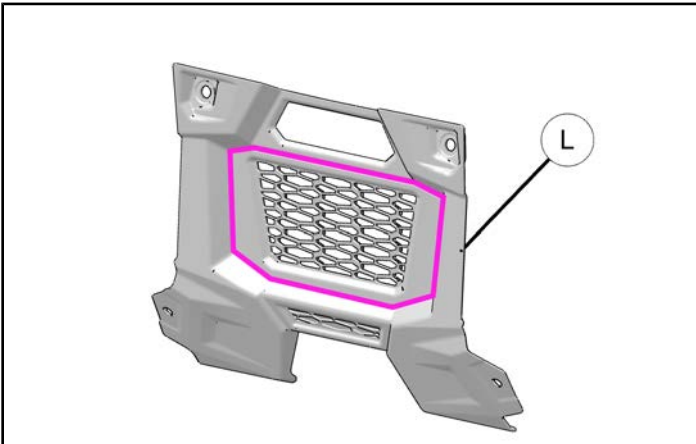

NOTICE

Before installing winch kit, add or replace proper fluid to your vehicle's front gear case as required in the service manual. This process will be difficult to do after winch is installed.

2013–2021 SPORTSMAN 850/1000 MODELS

- Turn two latches and lift out storage bin.

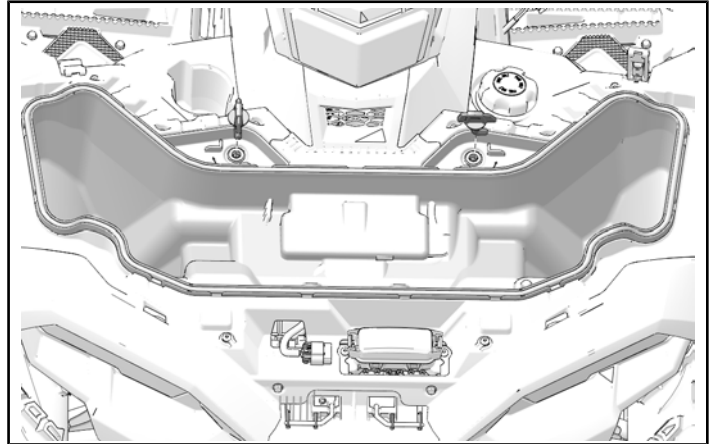

- Fold up ends of battery cover to access battery bolts.

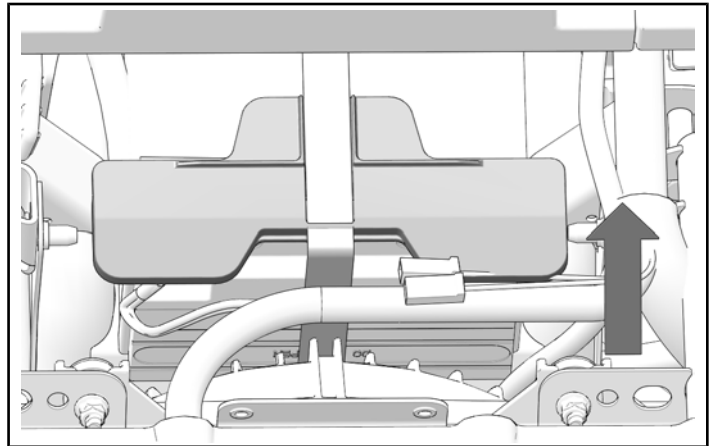

- Disconnect black (negative) and red (positive) cables from battery.

⚠ WARNING

Always disconnect black negative (-) cable from battery FIRST. Failure to do so will result in high current electrical arc and may result in battery explosion if tool touches grounded frame. Death or serious personal injury may occur.

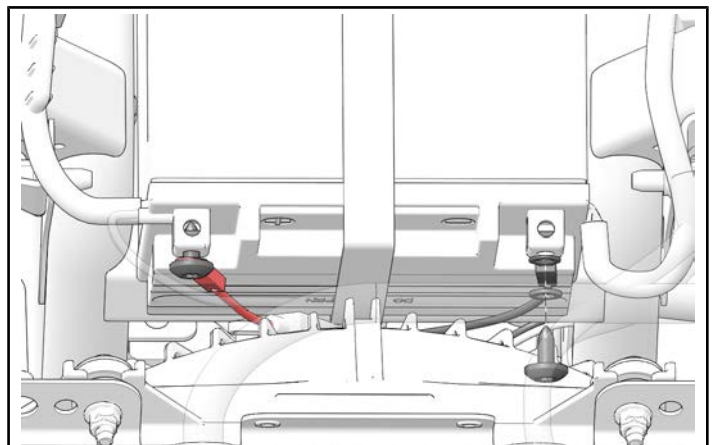

- Remove and keep four bolts from lower front bumper cover.

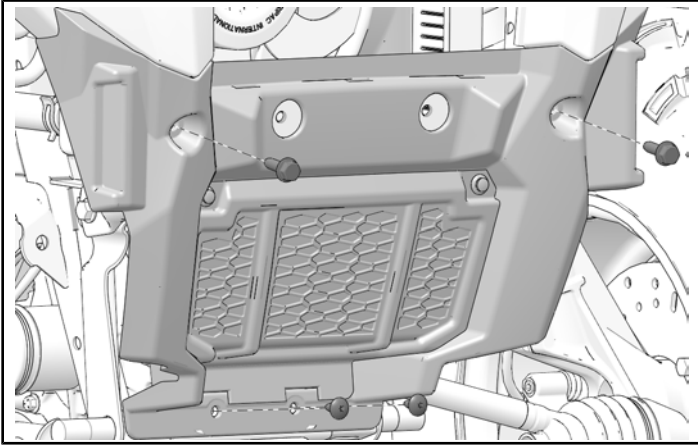

- Remove and discard two push pin rivets from winch cover. Remove and discard winch cover.

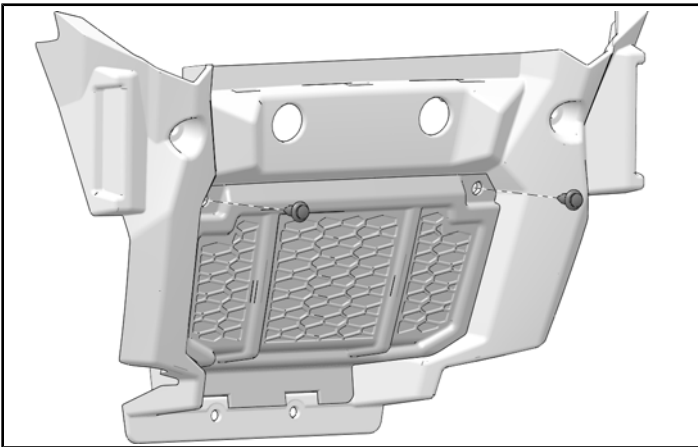

NOTICE

Before installing winch kit, add or replace proper fluid to your vehicle's front gear case as required in the service manual. This process will be difficult to do after winch is installed.

ACCESSORY INSTALLATION

WINCH INSTALLATION 2021 SPORTSMAN 450/570 MODELS

- Make sure wire routing and connections are as shown and make necessary adjustments.

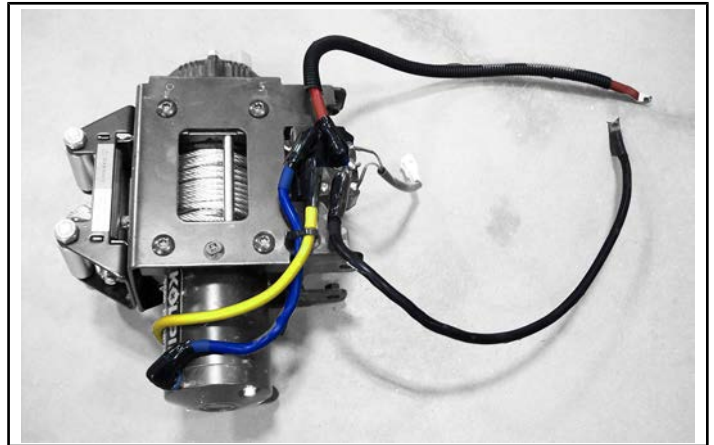

- Put red and black wires through the opening where the winch will go. Move winch onto radiator mount.

IMPORTANT

Check all wires are free to move, not pinched between vehicle chassis and winch assembly.

- Install two screws ⑥ on each side to attach winch. Torque to specification.

NOTICE

On models with strut front suspension, use front set of holes for mounting winch.

TORQUE

Winch Mounting Screws ⑥:
17 ft-lbs (23 N·m)

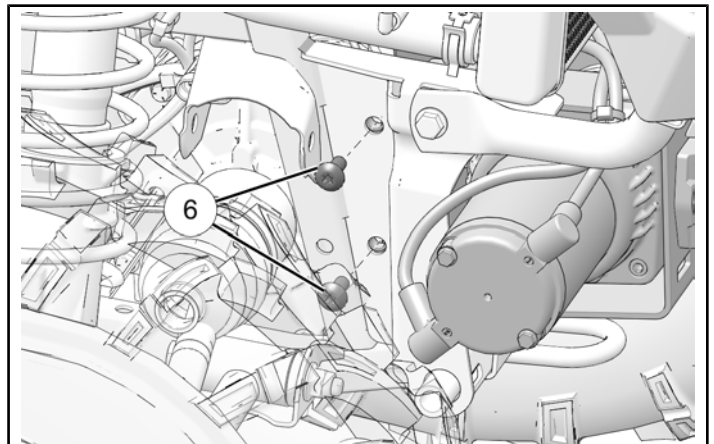

- Put red and black winch harness up vehicle frame behind radiator and through opening in body panel on negative side of battery.
- Attach red and black winch harness to main vehicle frame about halfway between winch and body panel with cable tie.

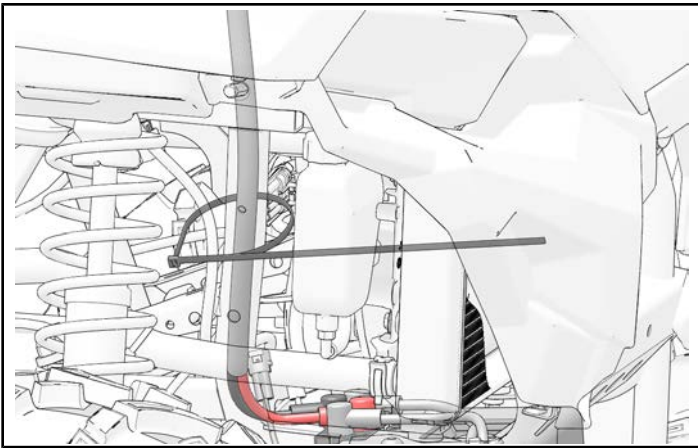

- Locate white connector on contactor. Connect it to the corresponding connector on vehicle harness.

WINCH INSTALLATION
2014–2020 SPORTSMAN 450/570 MODELS

- Loosen red, black, blue, and yellow connection cables from winch and contactor.
- Remove and keep two screws **1.7** from the contactor **1.8**.

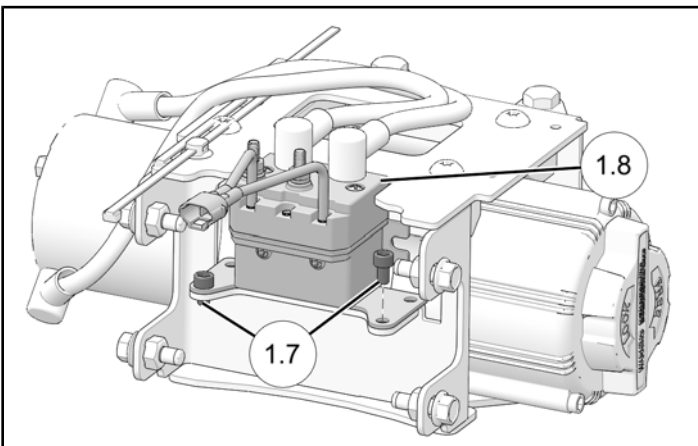

- Move contactor **1.8** to side tab of mounting bracket. Attach with two screws **1.7**. Torque to specification.

TORQUE
 Contactor Screw **1.7**:
7 ft-lbs (9.5 N·m)

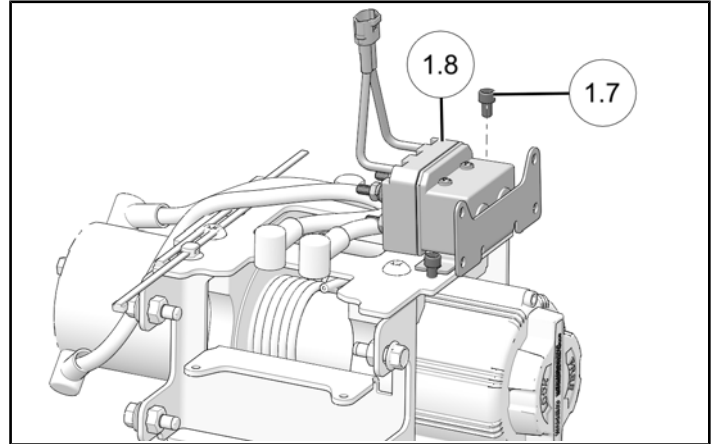

- Make sure wire routing and connections are as shown and make necessary adjustments.

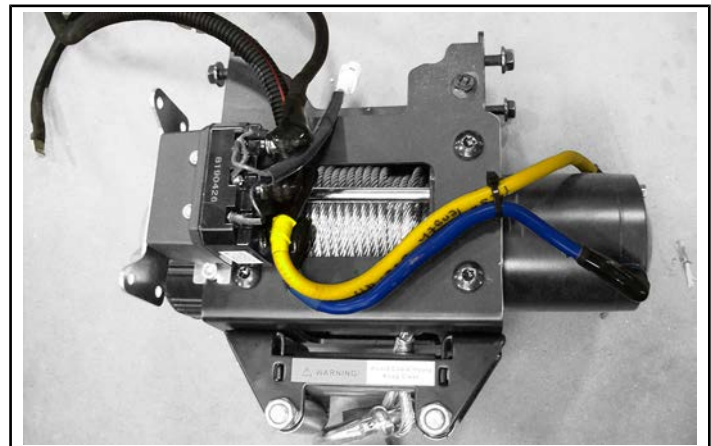

5. Locate white contactor connector (M) on vehicle. Cut cable tie and remove cap.

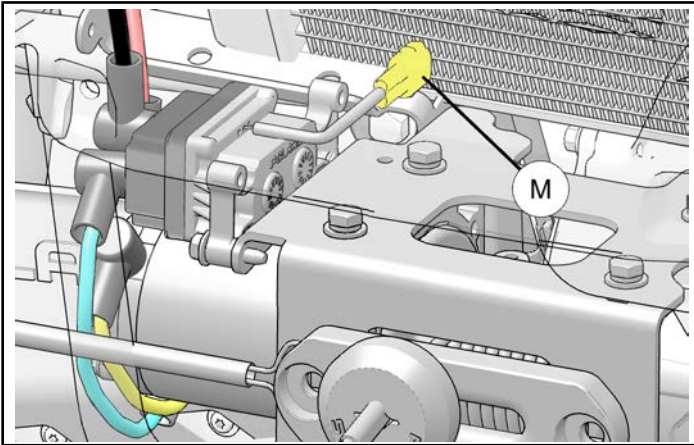

6. Put red and black wires through the opening where the winch will go. Move winch onto radiator mount.

IMPORTANT

Check all wires are free to move, not pinched between vehicle chassis and winch assembly.

7. Install two screws (6) on each side to attach winch. Torque to specification.

TORQUE

Winch Mounting Screws (6):
17 ft-lbs (23 N·m)

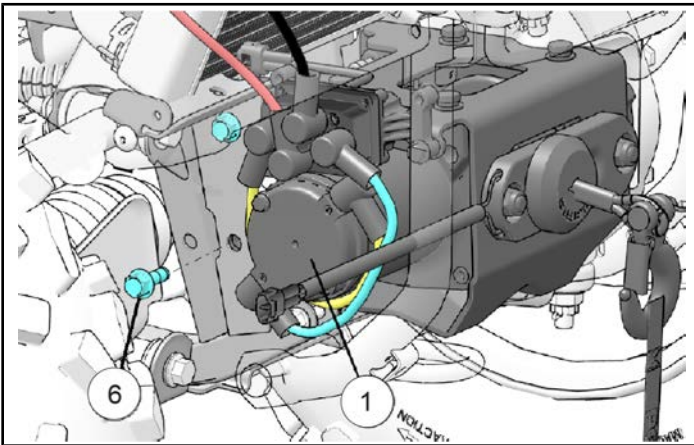

8. Put red (positive) and black (negative) power cables directly underneath the radiator, then up behind it to reach the three terminal bus bar.

IMPORTANT

Do not connect winch cables to busbar at this time.

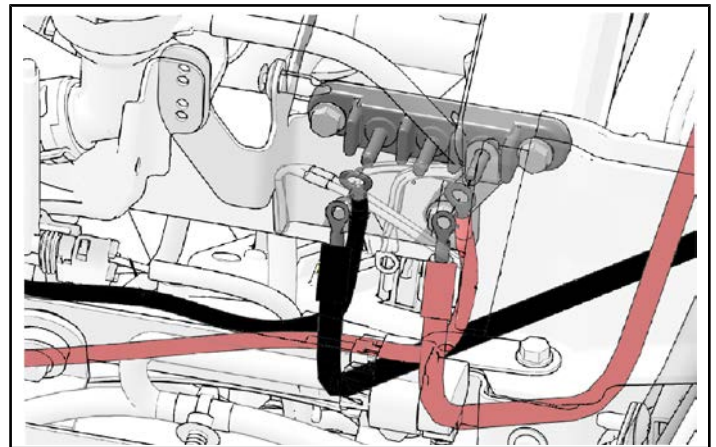

9. Using two cable ties (4), loosely secure red and black power cables to frame and existing wiring.

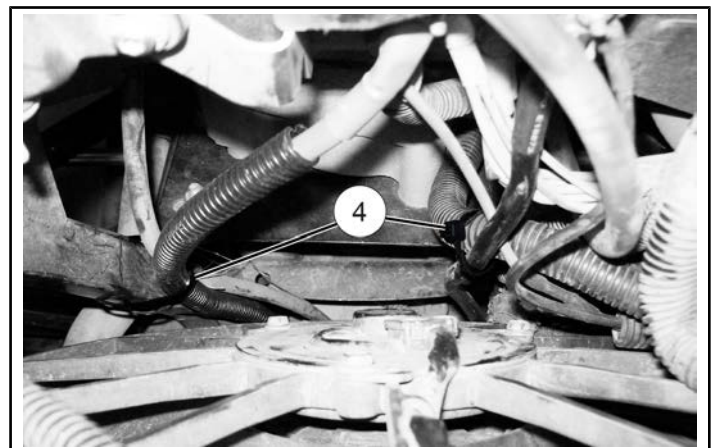

10. **For 2015-2020 models:** Locate white connector on contactor. Connect it to the corresponding connector on vehicle harness.
11. **For 2014 and Older models:** Put SPMN winch harness (2) from head light pod down to winch, using same path behind radiator as the power cables. Connect white harness connector to winch contactor connector. Put red end of harness to busbar area and connect to orange wire on vehicle main harness. Secure winch harness to vehicle with cable ties.
12. Connect red and black winch power cables to the busbar terminal and fasten using two nuts (5).

WINCH INSTALLATION 2013–2021 SPORTSMAN 850/1000 MODELS

1. Make sure wire routing and connections are as shown and make necessary adjustments.

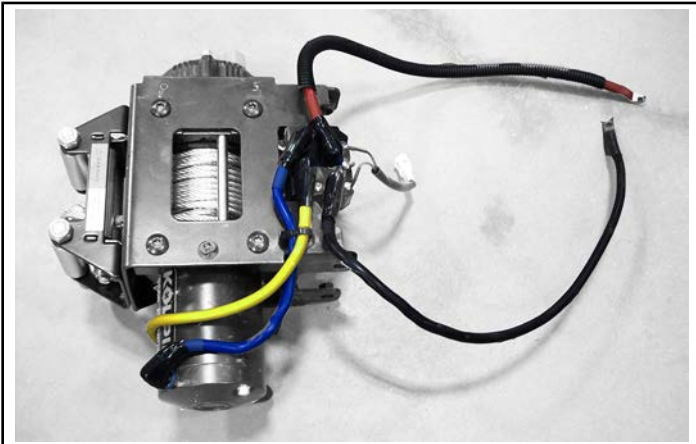

2. Put red and black wires through the opening where the winch will go. Move winch onto radiator mount.

IMPORTANT

Check all wires are free to move, not pinched between vehicle chassis and winch assembly.

3. Install two screws ⑥ on each side to attach winch. Torque to specification.

TORQUE

Winch Mounting Screws ⑥:
17 ft-lbs (23 N·m)

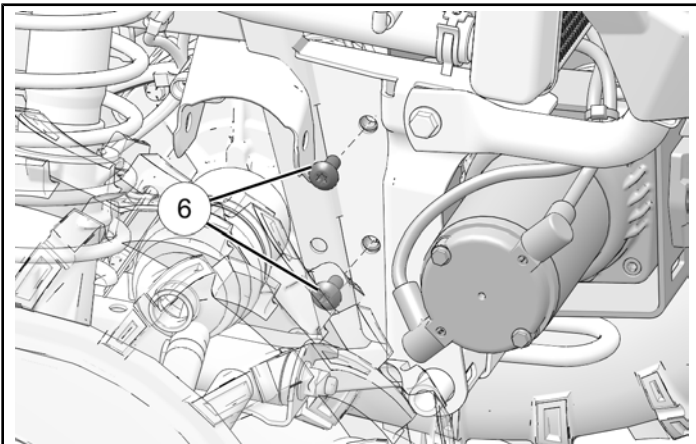

4. Put red (positive) and black (negative) power cables to battery area.

IMPORTANT

Do not connect winch cables to battery at this time.

5. Attach cables to chassis frame with cable tie ④.

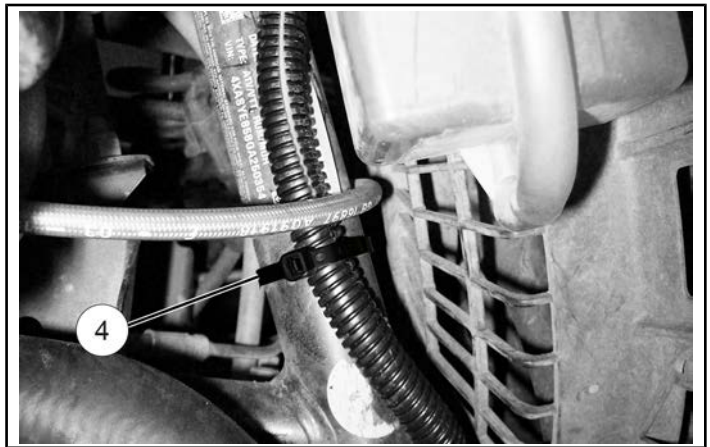

6. **For 2015 and Newer Vehicles:** Locate white contactor connector on frame tube behind front left tire. Remove cap from main harness connector and connect to white contactor winch connection.
7. **For 2014 and Older Vehicles:** Put SPMN winch harness ② from head light pod down to winch, using same path behind radiator as the power cables. Connect white harness connector to winch contactor connector. Put red end of harness to busbar area and connect to orange wire on vehicle main harness.

HANDLEBAR SWITCH INSTALLATION ALL MODELS

1. Install handlebar switch front 3.2 and switch rear 3.3 to handlebar with two screws 3.4 Torque to specification.

NOTICE

Handlebar switch fits in between the main controls and the brake mount.

TORQUE

Handlebar Screw 3.4:
24 in-lbs (2.7 N·m)

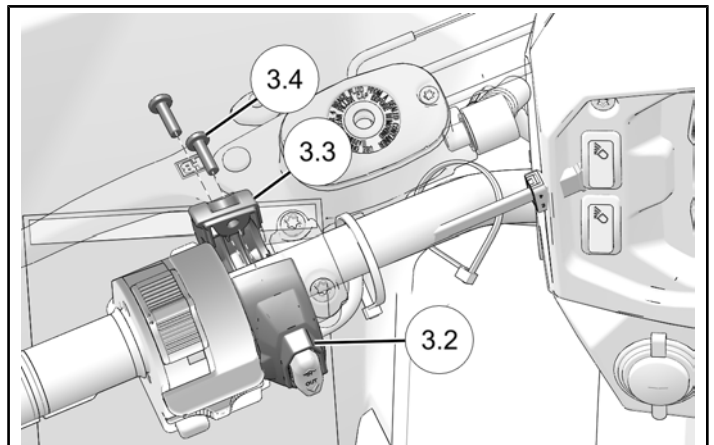

2. Connect handlebar switch connector to vehicle main wire harness.

NOTICE

Vehicle main wire harness connector is either attached to the handlebars where it can be seen or will be inside the headlight pod where it cannot be seen. The cap on the vehicle connector must be removed.

VEHICLE REASSEMBLY

GENERAL

1. Make sure there are no exposed wires or terminals. Tightly bind all loose wires and attach away from moving parts and heat sources.

⚠ WARNING

When BOTH battery cables are disconnected ALWAYS connect AND tighten red positive (+) battery cable FIRST. Failure to comply will result in a high current electrical arc that may result in battery explosion, if tool touches grounded frame. Death or serious personal injury may occur.

2021 SPORTSMAN 450/570 MODELS

1. Connect all red (positive) wires to the positive battery terminal. Connect all black (negative) wires to the negative battery terminal.

TIP

Put the winch wire through the opening in the electrical boot that covers the main vehicle power wire.

TORQUE

Battery Bolt:
60 in-lbs (6 N·m)

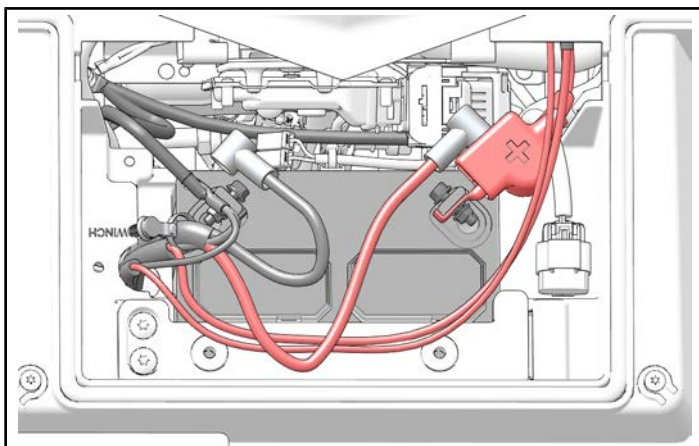

2. Put front bumper cover onto vehicle and identify area to be trimmed on both sides of bumper cover.

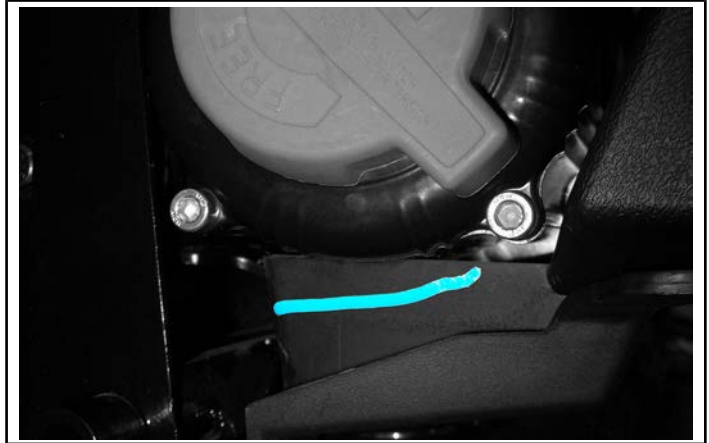

3. Cut along marked lines.
4. Install front bumper cover with four fasteners. Tighten until fully seated.

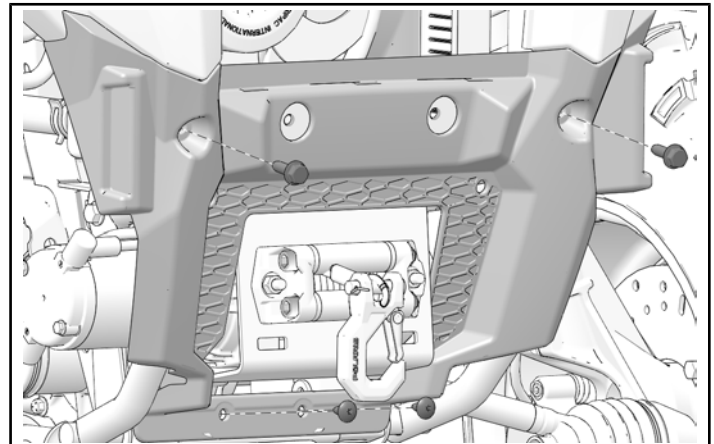

5. Close front rack and attach two rubber latches.

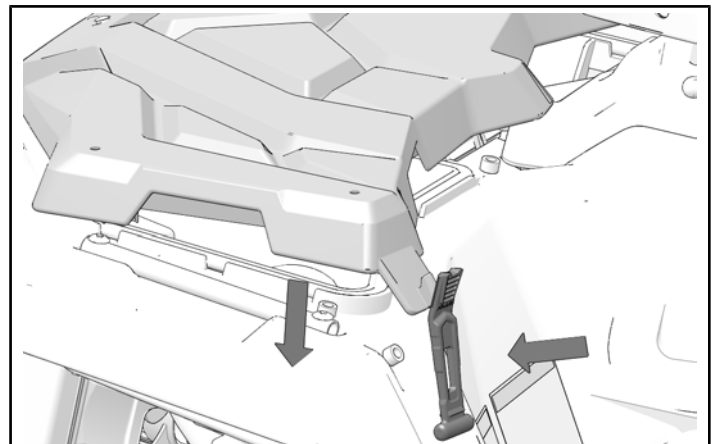

6. Install accessory front brush guard, if equipped. See Kit Instructions for procedure.
7. With vehicle key in ON position, test winch for proper operation.

2014–2020 SPORTSMAN 450/570 MODELS

1. If you do not plan to use a plow, reinstall winch cover.
2. Install front bumper cover with four fasteners. Tighten until fully seated.

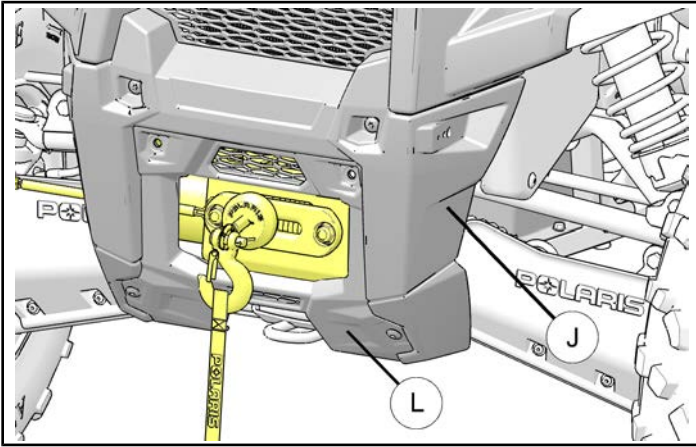

3. Connect all red positive wires to the positive battery terminal. Connect all black negative wires to the negative battery terminal. Torque to specification.

TORQUE

Battery Bolt:
60 in-lbs (6 N·m)

4. Lower front cover down slowly to engage tabs on cover into slots (F).

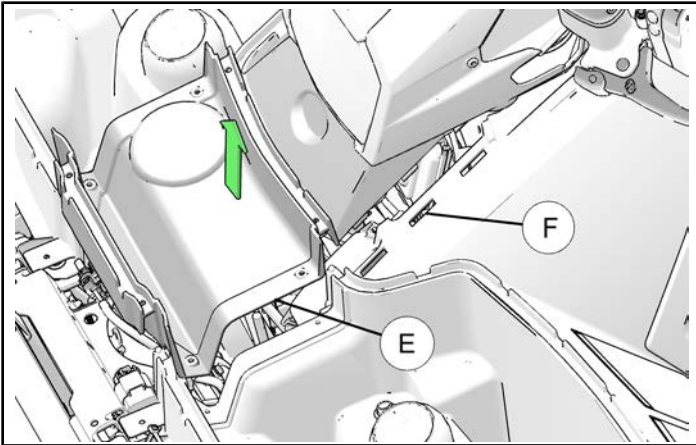

5. Install four screws (D) to front cover. Tighten until fully seated.

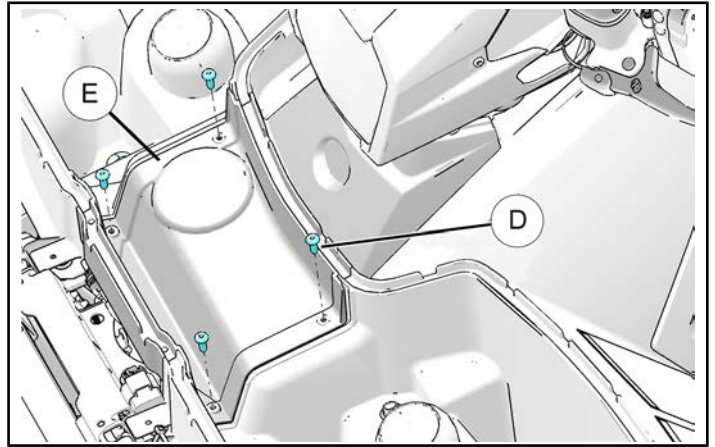

6. Install rubber seal.

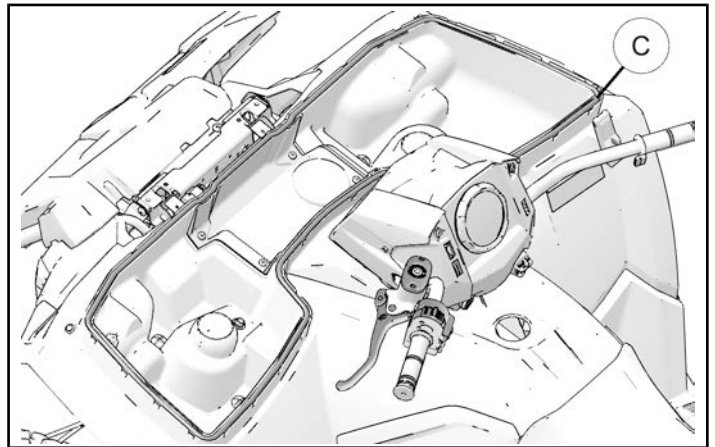

7. Close front rack and attach two rubber latches.

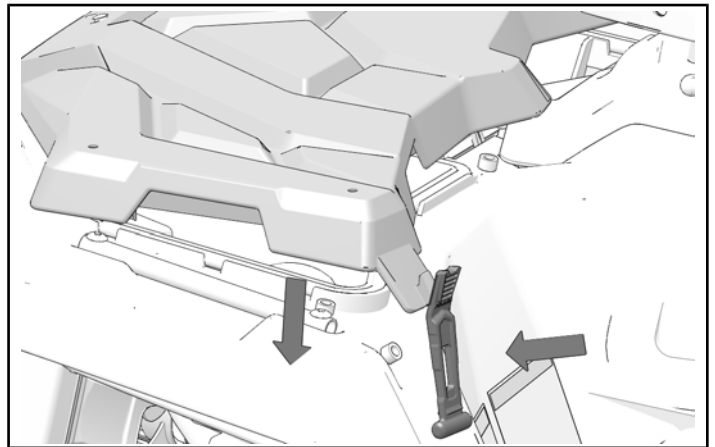

8. Install accessory front brush guard, if equipped. See Kit Instructions for procedure.
9. With vehicle key in ON position, test winch for proper operation.

2013–2021 SPORTSMAN 850/1000 MODELS

1. Connect all red positive wires to the positive battery terminal. Connect all black negative wires to the negative battery terminal. Torque to specification.

TORQUE

Battery Bolt:
60 in-lbs (6 N·m)

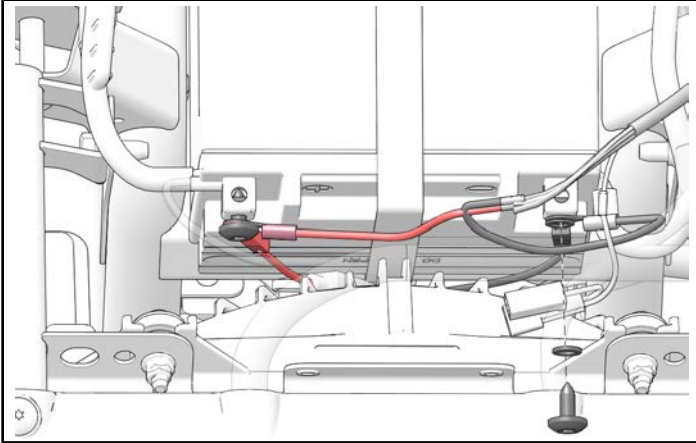

2. Install front storage bin and attach two fasteners.

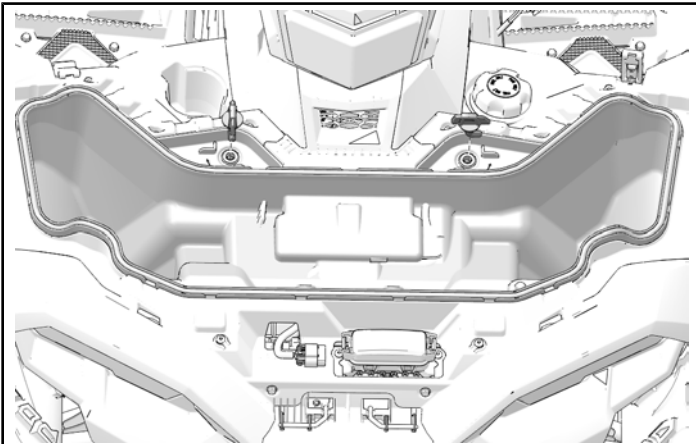

3. Install front bumper cover with four fasteners. Tighten until fully seated.

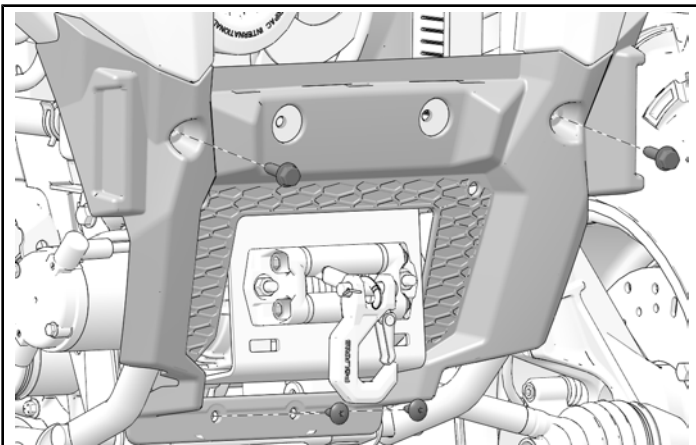

4. Close front rack and attach two rubber latches.

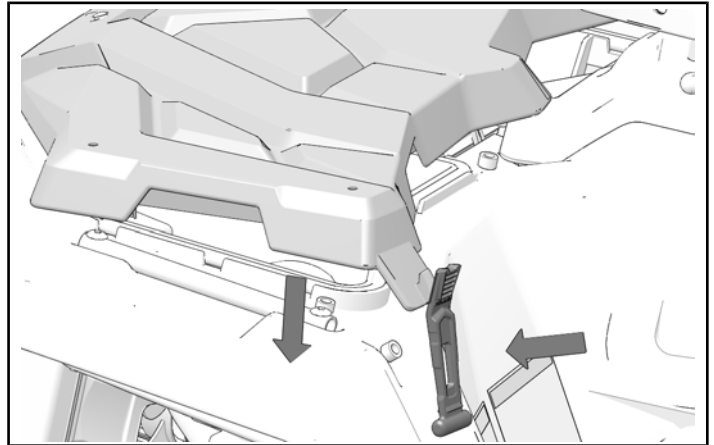

5. Install accessory front brush guard, if equipped. See Kit Instructions for procedure.
6. With vehicle key in ON position, test winch for proper operation.

OPERATION

CONTROL SWITCH OPERATION

When properly installed, the control switches allow you to operate the winch while seated in the vehicle using the dash switch or remotely using the corded switch. Proper switch operation is shown.

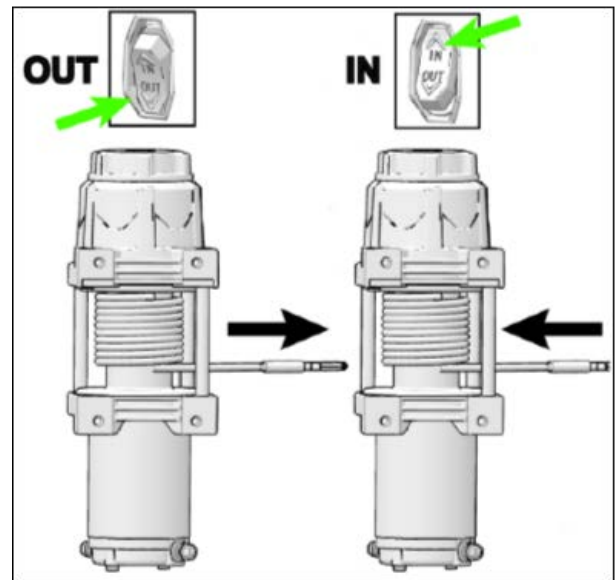

TROUBLESHOOTING

| SYMPTOM | POSSIBLE CAUSES | RECOMMENDED SOLUTION |
|--|--|--|
| Winch will not operate. | Contactors not receiving power. | Turn vehicle key ON. |
| | Connections between components not in proper order. | Check connections. Connect wired handlebar switch connection from vehicle main wire harness directly to contactor to make sure a direct connection will operate the winch. If connections are not in the order shown in the pictures on the last page, the whole system may not function, or only certain parts of it will function. |
| | Loose battery cable connections. | Tighten nuts on all cable connections. |
| | Keyed power circuit (orange wires) not properly powered. | Check fusebox for 10A accessory circuit. Check voltage in certain places, especially orange wires coming out of the main harness by the steering post. |
| | Contactors malfunctioning. | Tap contactor to loosen contacts. Apply 12 volts to coil terminals directly. A clicking indicates proper activation. |
| | Defective switch assembly. | Replace switch assembly. |
| | Defective motor. | Check for voltage at armature port with switch pressed. If voltage is present, replace winch assembly. |
| | Nested and bounded cable within winch assembly. | Move free spool knob to the "free spool" position. Manually pull cable out of winch until end is met and then re-spool cable back into winch. |
| Water has entered motor. | Allow to drain and dry. Run in short bursts without load until completely dry. | |
| Winch makes noise, but rope does not move. | Contactors powered, but not winch. | If you can hear a clicking sound when you press the winch control, but the winch does not make any sounds, check the connections between the winch and the contactors. |
| | Winch not in proper gear. | Move free spool knob to the "locked spool" position, then recheck. If problem persists, a qualified technician needs to check and repair. |
| Winch operates too slowly. | Winch improperly loaded. | Check that the winch is clear and the rope is not bound up. |
| | Insufficient current or voltage. | The battery is weak, recharge. Run winch with the vehicle motor running (battery should have a strong charge). |
| | Loose or corroded battery cable connections. | Clean, tighten, or replace. |
| Winch overheating. | Winch running time too long. | Allow winch to cool down periodically. |

| | | |
|---------------------------------------|-------------------------------|-----------------------------------|
| Winch operates in one direction only. | Defective or stuck contactor. | Tap contactor to loosen contacts. |
| | | Repair or replace contactor. |
| | Defective switch assembly. | Replace switch assembly. |
| | Defective brake assembly. | Replace winch assembly. |

ELECTRICAL CONNECTION REFERENCE GUIDE



WARRANTY



FIVE YEAR MECHANICAL LIMITED WARRANTY AND THREE YEAR ELECTRICAL LIMITED WARRANTY

For the period of five (5) years from the purchase date, Kolpin will replace for the original purchaser, free of charge, any mechanical part or mechanical parts found upon examination by Kolpin to be defective in material, workmanship, or both. For the period of three (3) years from the purchase date, Kolpin will replace for the original purchaser, free of charge, any electrical part or electrical parts found upon examination by Kolpin to be defective in material, workmanship, or both.

All transportation costs incurred submitting product to Kolpin for warranty consideration must be borne by the purchaser. If Kolpin determines that the product must be returned to the factory for credit, please call 1-877-956-5746 for a Return Merchandise Authorization (RMA) number and shipping instructions.

This warranty does not apply to parts that have been damaged by accident, alteration, abuse, improper maintenance, normal wear, or other causes beyond the manufacturer's control. In order to protect you and your ATV, certain parts of the winch/plow system and/or hardware are designed to fail when the equipment is overstressed. Parts that are lost due to loosening and improper maintenance are not covered under warranty. This warranty does not cover removal or reinstallation labor fees of the winch/plow system and related components.

Peripheral products such as engines, electric motors, and actuators may carry an original manufacturer's warranty. Most hardware is general in nature and is easily obtained locally. Be sure to replace with minimum metric class 8.8 specification.

Kolpin Outdoors, Inc.

Telephone: (763)-478-5800

Toll Free: (877)-956-5746

Fax Number: (800)-245-7569

www.kolpin.com

Email: customerservice@kolpin.com