

**POLARIS RZR XP 1000 QUICK-MOUNT
4500 LB WINCH KIT**



P/N 26-3300

QUICK-MOUNT WINCH KIT

Assembly / Owner's Manual

APPLICATION: 2024 RZR XP 1000
Verify accessory fitment at [Kolpin.com](https://www.kolpin.com)

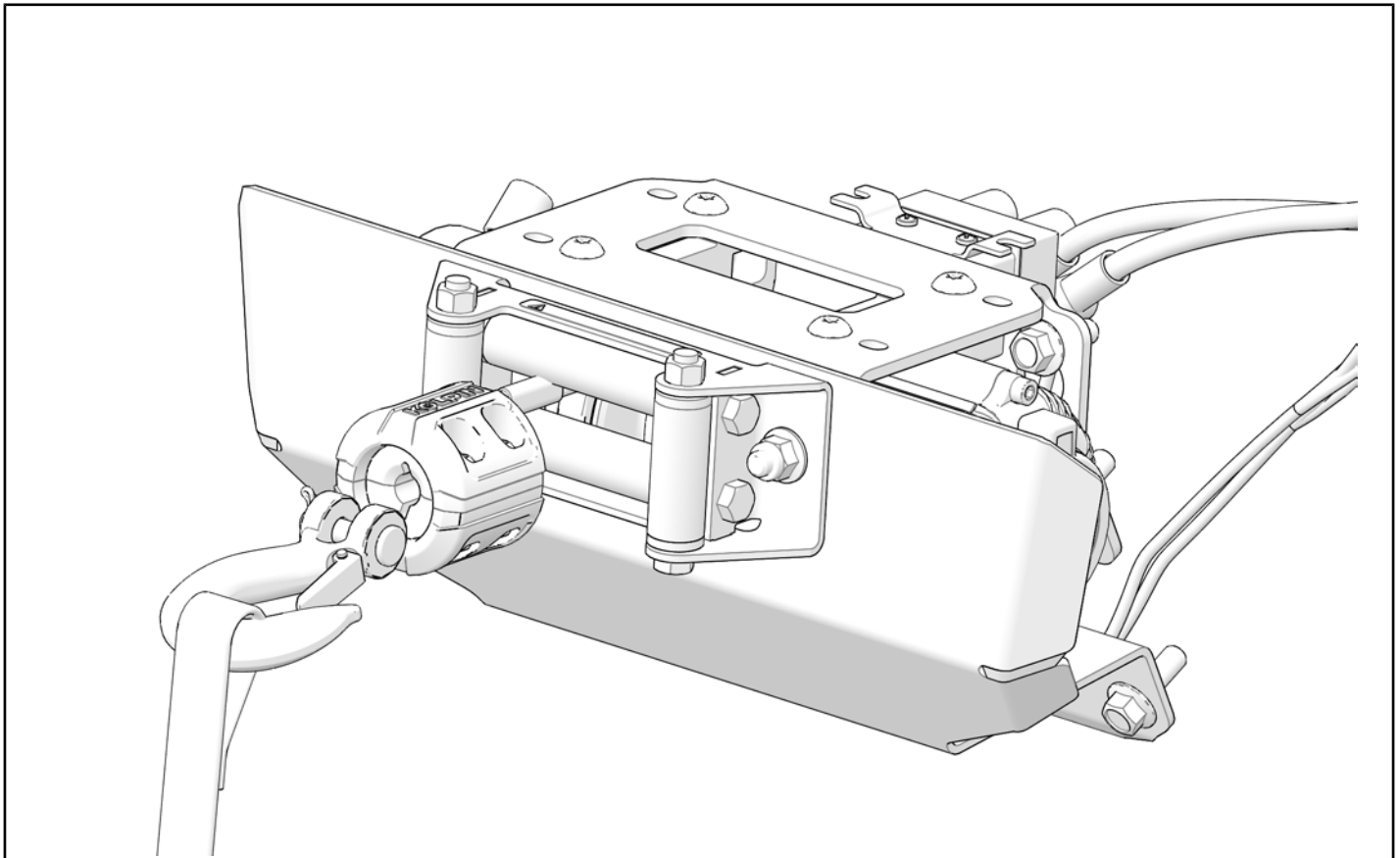

INTRO

Thank you for purchasing Kolpin® engineered products. With proper installation, usage, care, and maintenance, your Kolpin® product will last for years to come.

BEFORE YOU BEGIN

- Read and understand the entire installation manual, including all installation instructions, operating instructions, safety warnings and guidelines before installing or operating your accessory. Failure to comply may result in damage to the product and / or vehicle, and can lead to hazards up to and including death.
- Verify all parts and tools are accounted for. If parts are missing, do not return to the store. Call us for help, **Toll Free 1-877-956- 5746**
- Follow all steps correctly and in the sequence described.
- Keep these instructions for future reference or for informational requests.
- To facilitate installation, make sure that your vehicle is clean and free of debris.
- All directions referring to right and left are from the rider perspective when sitting on the machine.

ASSEMBLY TIME

Approximately 42 minutes

SAFETY INFORMATION

Please read and understand all assembly instructions, notices and warnings before assembling and operating your Kolpin winch system.

Follow these guidelines to ensure satisfactory operation:

- Read this manual and your ATV / UTV operators manual before use.
- Periodically check for wear and tightness of all fasteners. Replace or re-torque fasteners as necessary.

TOOLS REQUIRED

- Safety Glasses
- Safety Goggles
- Socket Set, Metric
- Socket Set, Torx® Bit
- Torque Wrench
- Wrench Set, Metric
- Cutting Tool

KIT CONTENTS

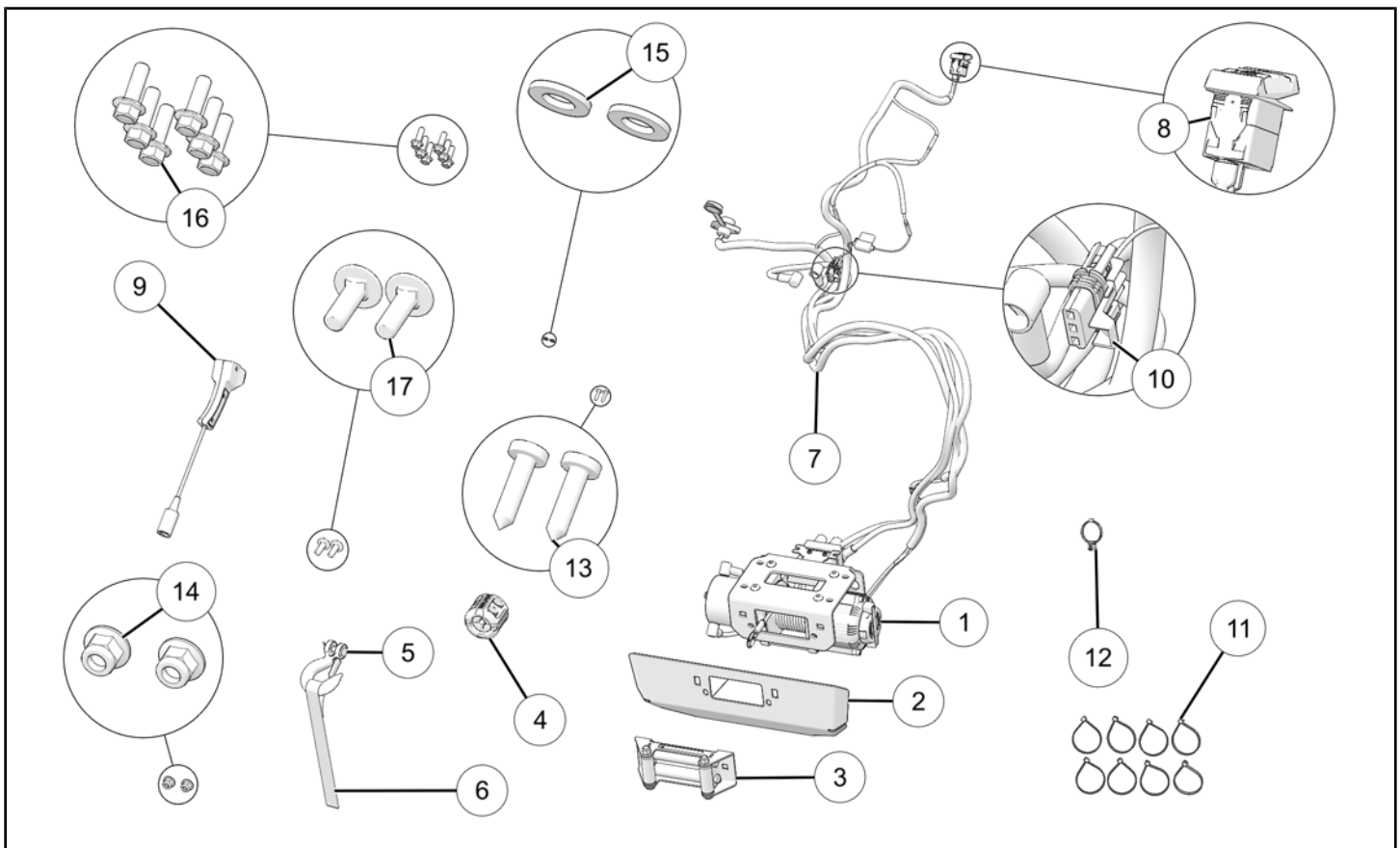

REF	QTY	PART DESCRIPTION	PART NUMBER
1	1	Assembly, Winch	n/a
2	1	Skid Plate	25-3440
3	1	Roller, Fairlead	85087
4	1	Winch Stop	85080
5	1	Hook, Winch	RPR0108
6	1	Strap, Hook	85071
7	1	Harness, Dash	n/a
8	1	Switch, Winch	4015688
9	1	Remote	85067
10	1	Splitter, Three-Wire	26-3000-CP05
11	1	Cable Tie, 25-76 mm	7080492
12	1	Clip, Edge	7082427
13	2	Screw, 10 x 3/4, Hi/Lo	7512026
14	2	Nut, M10 x 1.5 mm	7547423
15	2	Washer	7556724
16	6	Screw, Hex-Flange, M10 x 1.5 x 30 mm	11516328
17	2	Screw, Round Head Carriage, M10 x 1.5 x 30 mm	n/a

WINCH DETAIL

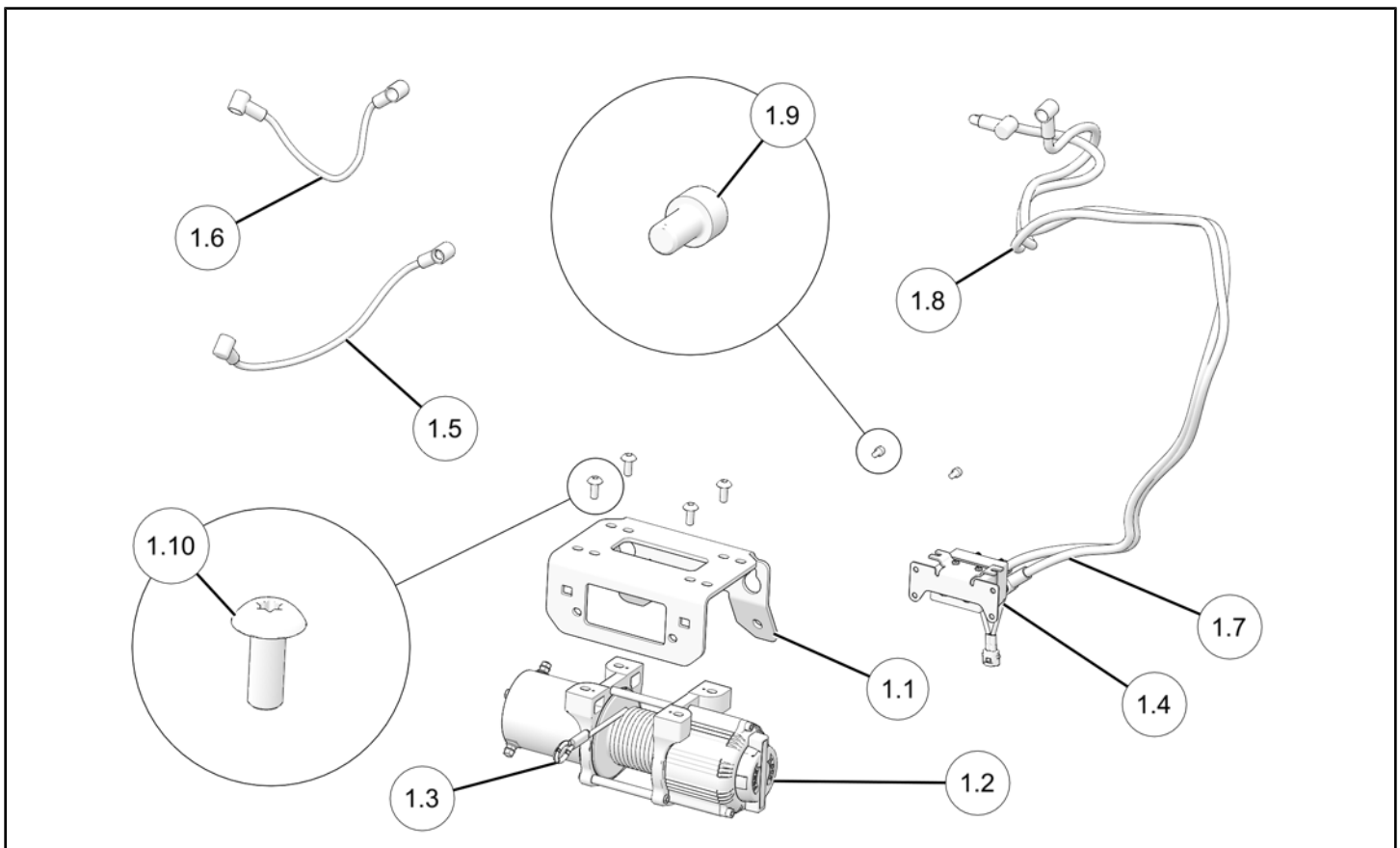

REF	QTY	PART DESCRIPTION	PART NUMBER
1.1	1	Bracket, Mount, Winch	25-3440
1.2	1	Replacement Winch 4500#	25-9450R
1.3	1	Synthetic Rope, Kolpin Brand	85064
1.4	1	Contactor	85068
1.5	1	Cable, Winch, Yellow 6 GA, 319mm	n/a
1.6	1	Cable, Winch, Blue 6 GA, 273mm	n/a
1.7	1	Cable, Power, Winch, Black #6 1350mm	n/a
1.8	1	Cable, Power, Winch, Red #6, 1350mm	n/a
1.9	2	Screw, Socket Head, M6 x 1.0 x 10 mm	7517337
1.10	4	Screw, Torx® Drive, Truss Head, M8 x 1.25 x20 mm	7519260

INSTALLATION INSTRUCTIONS

VEHICLE PREPARATION

GENERAL

1. Park vehicle on a flat surface.
2. Shift vehicle into PARK.
3. Turn key to OFF position and remove key.

SEAT REMOVAL

1. Pull strap to disengage seat. Tilt seat forward and remove from vehicle.

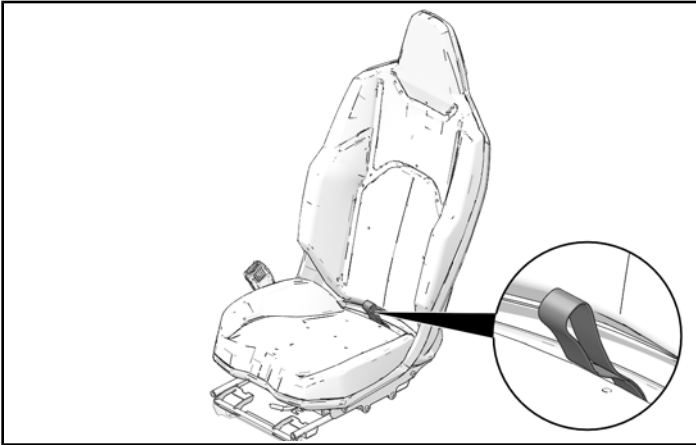

BATTERY DISCONNECT

1. Loosen nut on negative battery terminal and remove negative battery cable from battery.

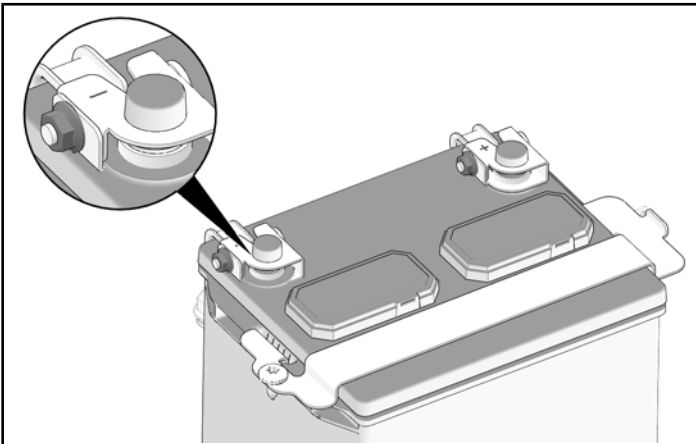

FRONT FASCIA AND BRACKET REMOVAL

1. Remove two screws and two bolts. Remove front fascia.

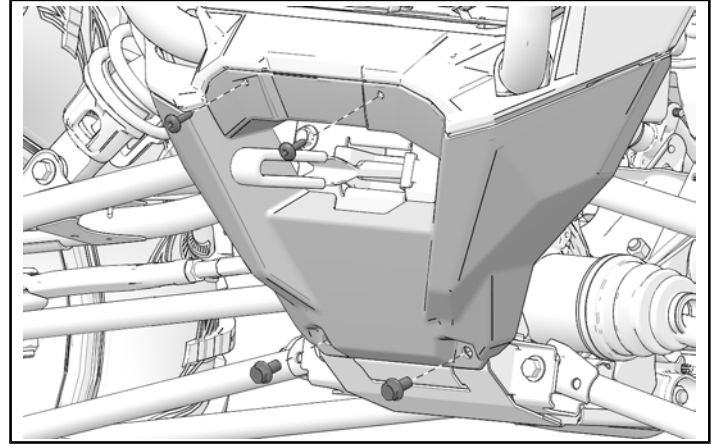

2. Remove two bolts. Remove front drive protection plate and tow strap.

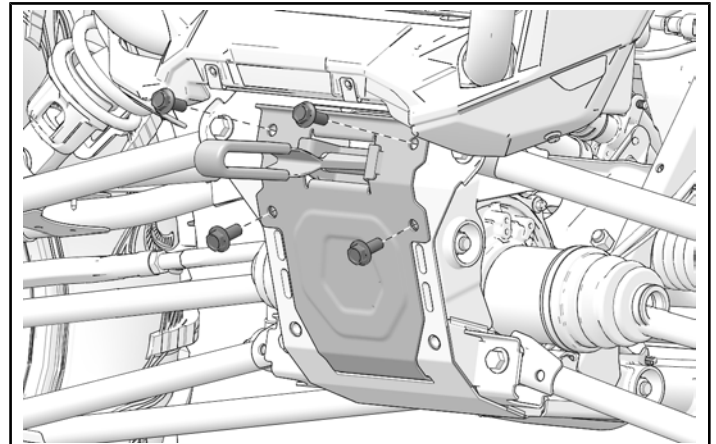

UPPER FASCIA REMOVAL

1. Remove push-pin rivet from side of upper fascia.

NOTICE

Left side shown; right side similar.

NOTICE

Parts of vehicle have been hidden for clarity.

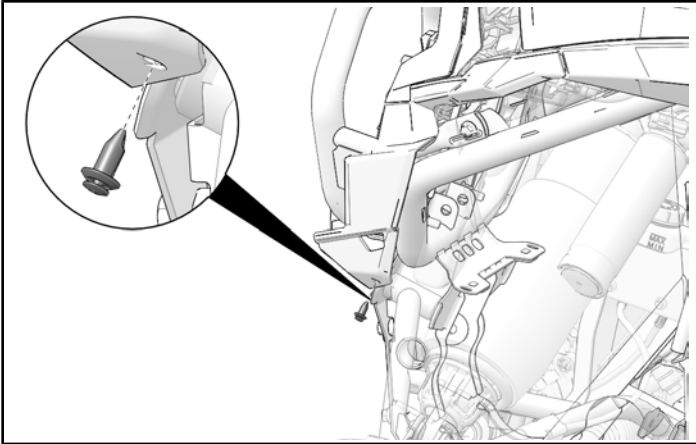

2. Pull upper fascia outward to remove from vehicle.

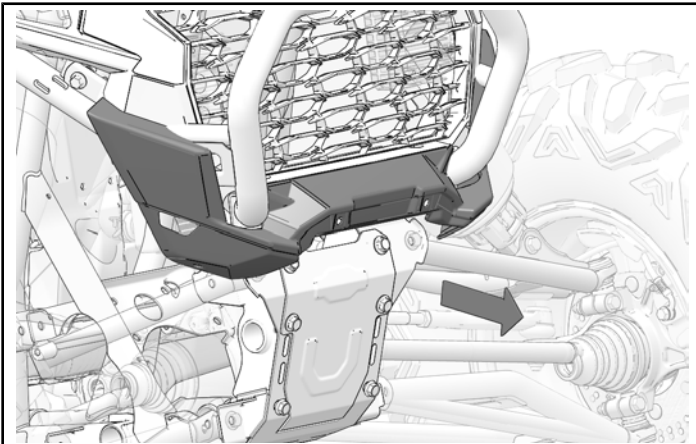

CENTER HOOD REMOVAL

1. Remove two screws. Remove the hood towards the rear.

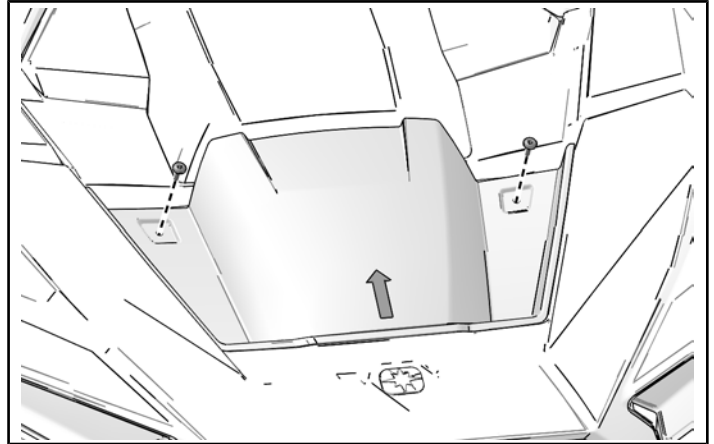

CENTER INSTRUMENT PANEL REMOVAL

1. Remove two screws. Remove center instrument panel.

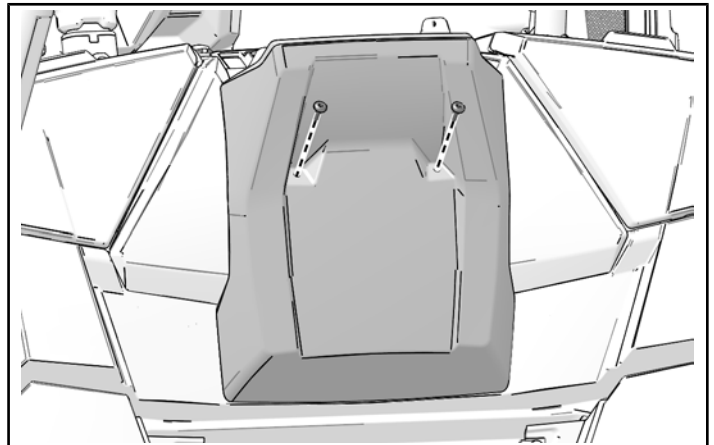

ACCESSORY INSTALLATION

WINCH ASSEMBLY INSTALLATION

1. Loosely install two screws ⑯ to vehicle frame.

NOTICE

Kolpin recommends leaving four or five threads exposed.

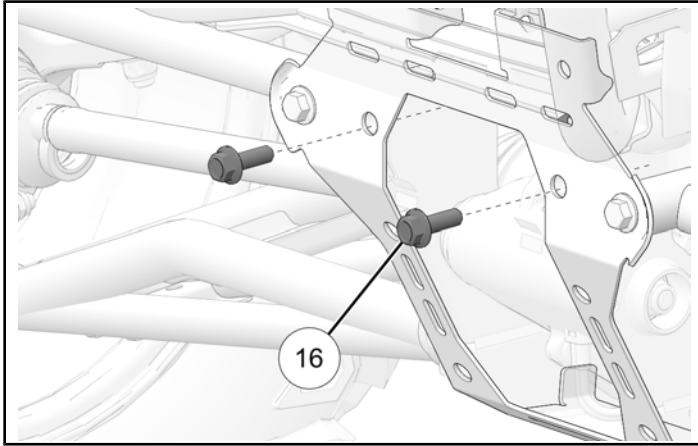

2. Install winch assembly ① onto vehicle frame by aligning upper key holes on winch assembly and lowering assembly onto screws ⑯.

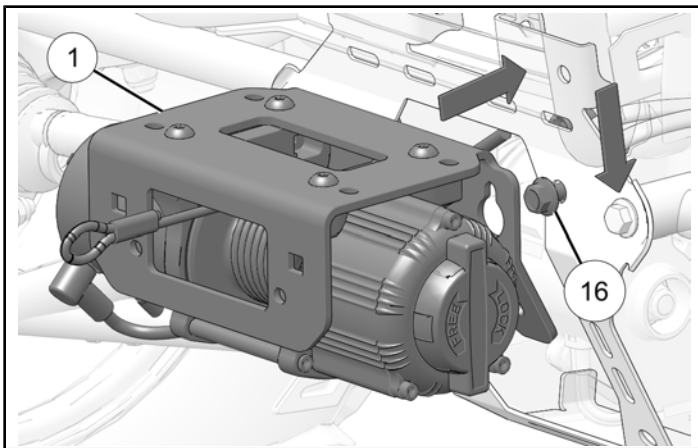

3. Attach winch assembly to vehicle frame with two screws ⑯.

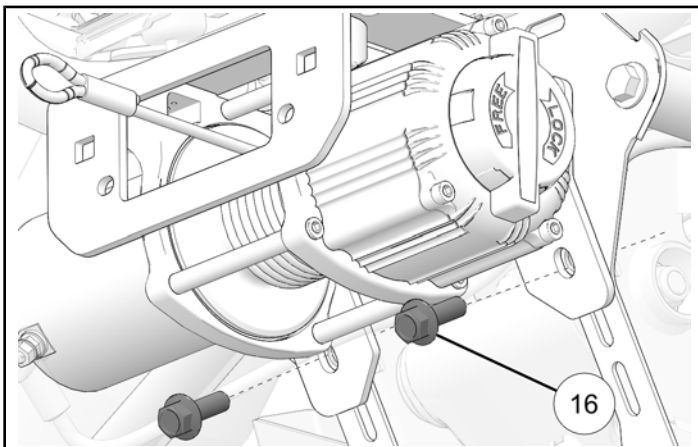

4. Loosely install two screws ⑰ to front of winch assembly.

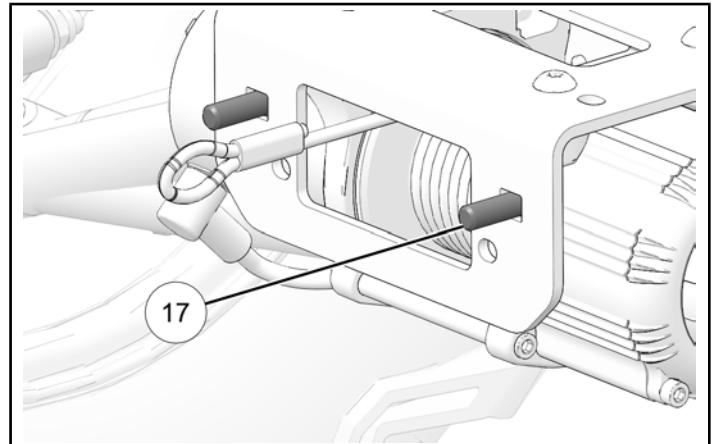

5. Install skid plate ② to vehicle frame by inserting lower end into slot as shown.

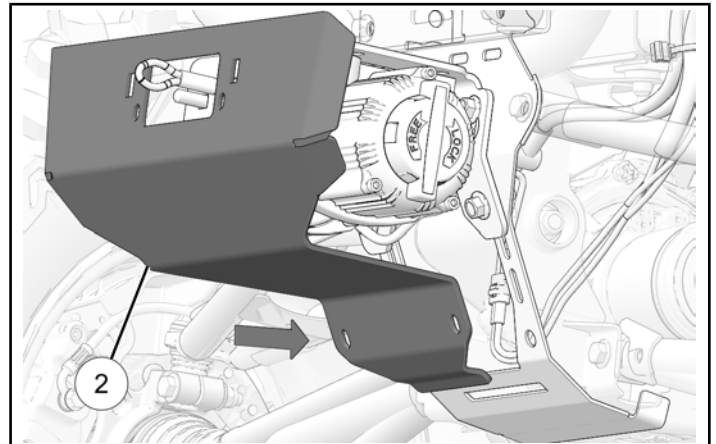

6. Loosely attach skid plate to vehicle frame with two screws ⑯.

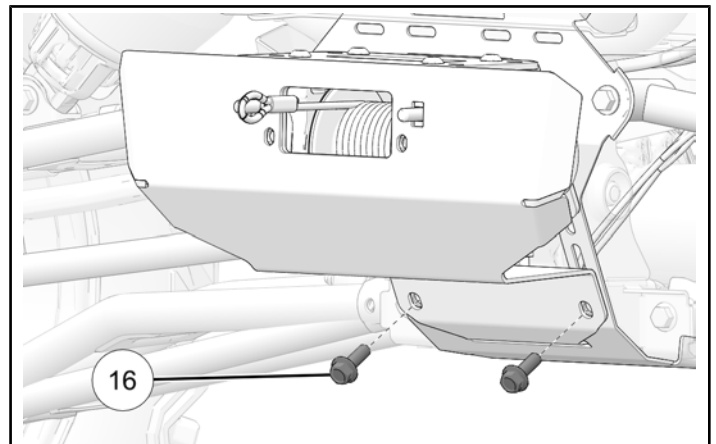

7. Install roller fairlead ③ onto skid plate and attach using two nuts ⑭.

IMPORTANT

Make sure the larger roller is positioned on the bottom.

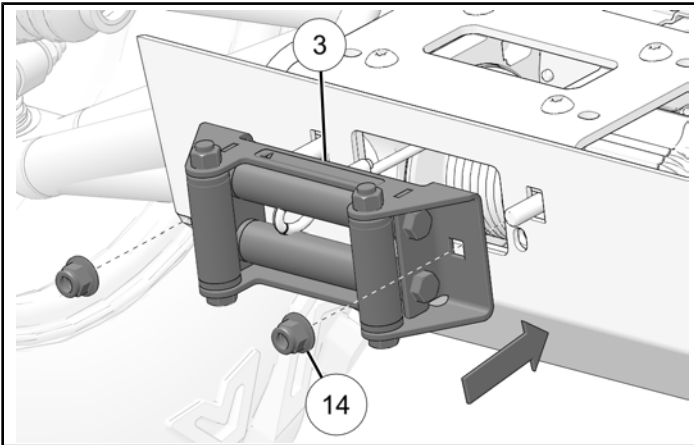

9. Torque winch assembly nuts ⑭ to specification.

TORQUE

Nuts ⑭:
34 ft-lbs (46 N·m)

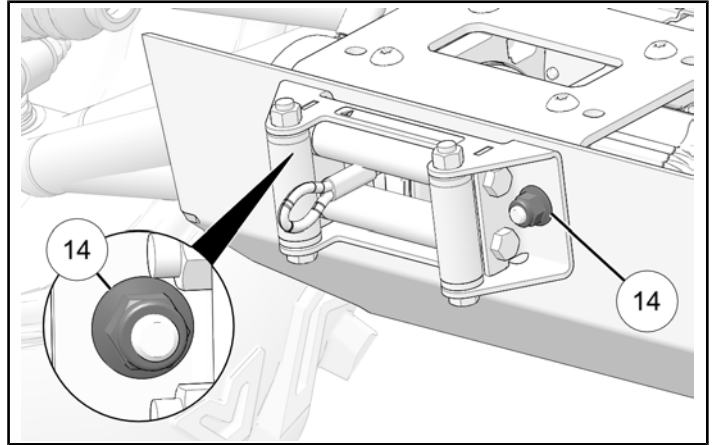

8. Torque winch assembly screws ⑯ until fully seated.

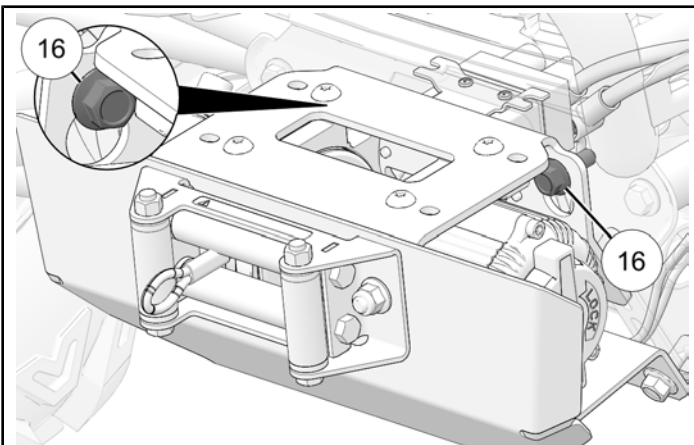

10. Install rubber bumper ④, hook ⑤ and strap ⑥ to winch rope.

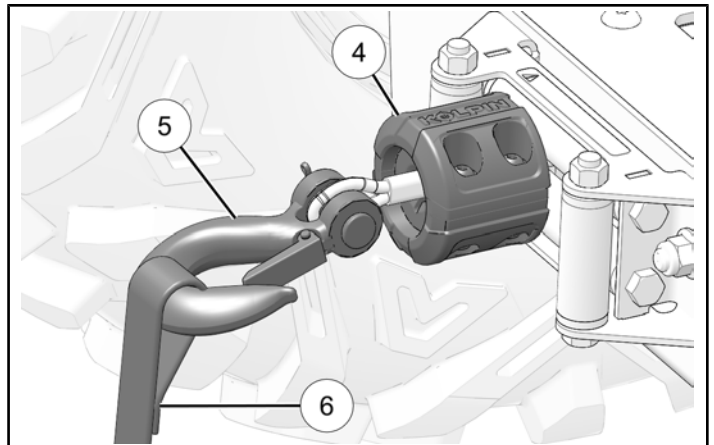

HARNES ROUTING

HARNES ROUTING OVERVIEW

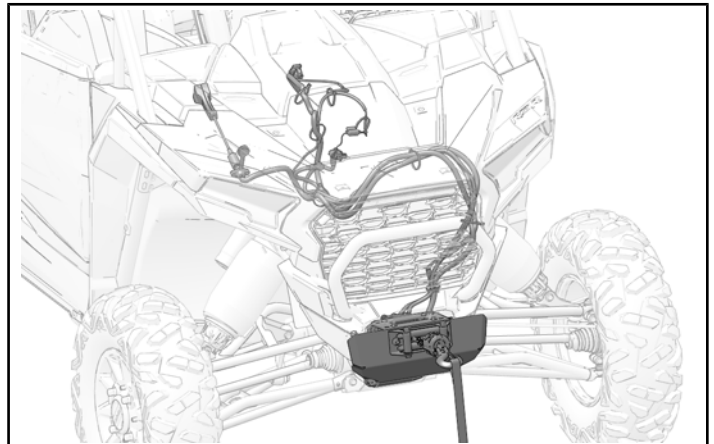

HARNESS ROUTING

1. Route harness along front gearcase area towards hood opening, use cable tie ⑪ to secure harness.

NOTICE

Installer should wait until harness is fully routed before tightening cable ties.

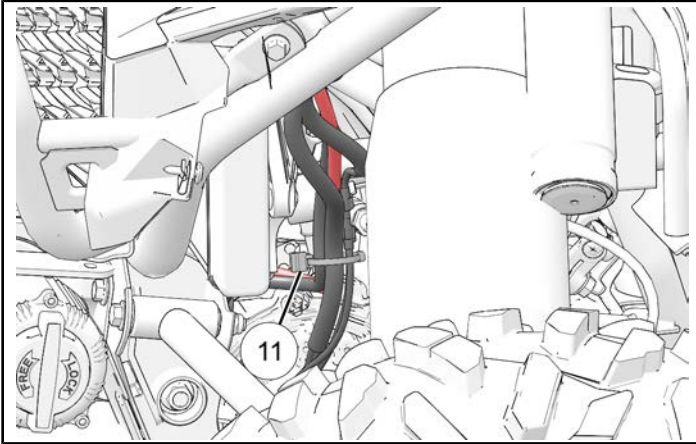

2. Continue routing harness up and over front left upper radiator support, use cable tie ⑪ to secure harness.

NOTICE

Installer should wait until harness is fully routed before tightening cable ties.

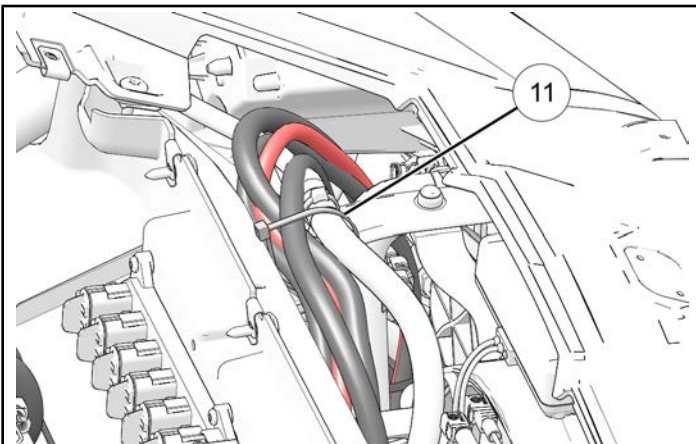

3. Continue routing harness through grommet in the lower dash wall and up towards the Pulse® Bar, use cable tie ⑪ to secure harness.

NOTICE

Parts of the vehicle have been hidden for clarity.

NOTICE

Installer should wait until harness is fully routed before tightening cable ties.

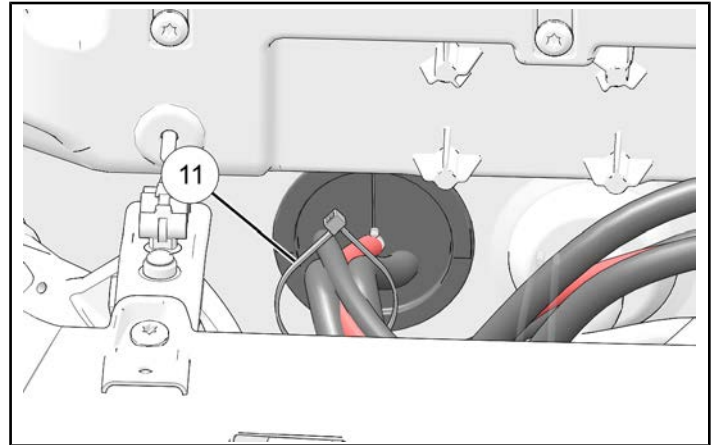

4. Remove and keep nuts from Pulse® Bar.

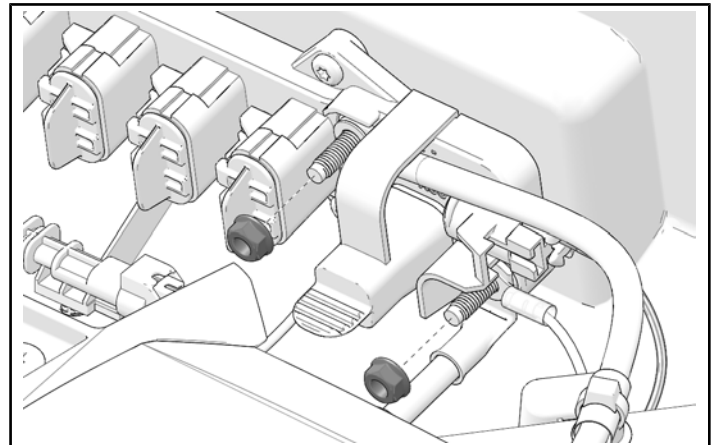

- Attach positive and negative connections to Pulse® Bar using kept nuts.

NOTICE

Parts of the vehicle have been hidden for clarity.

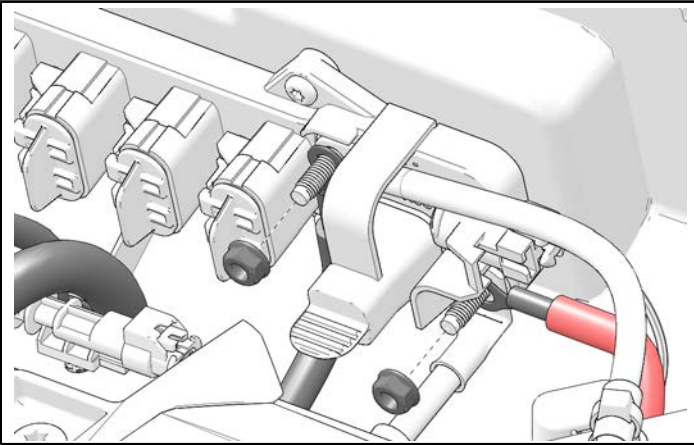

- Torque nuts to specification.

TORQUE

Nuts:
44 in-lbs (5 N·m)

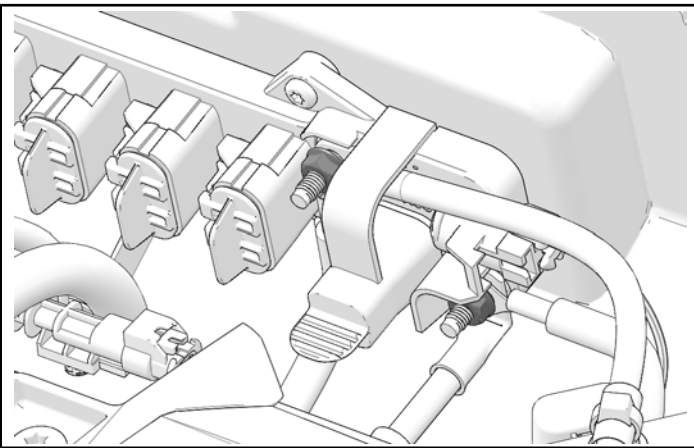

- Install Pulse® bar connection ⑩ to Pulse® bar.

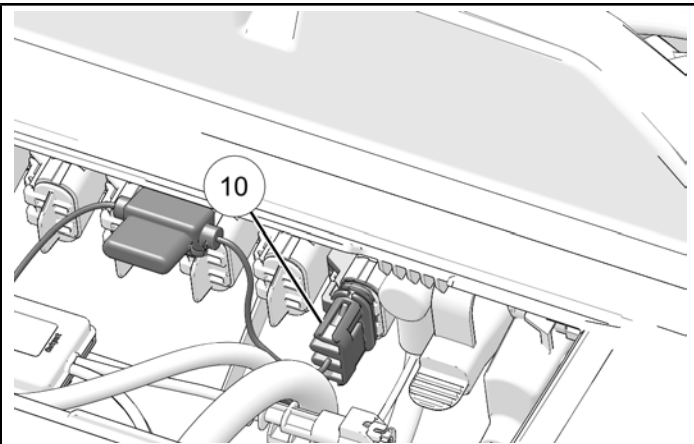

- Use cable ties ⑪ to secure harness in area from Polaris Pulse® Bar.

NOTICE

Parts of the vehicle have been hidden for clarity.

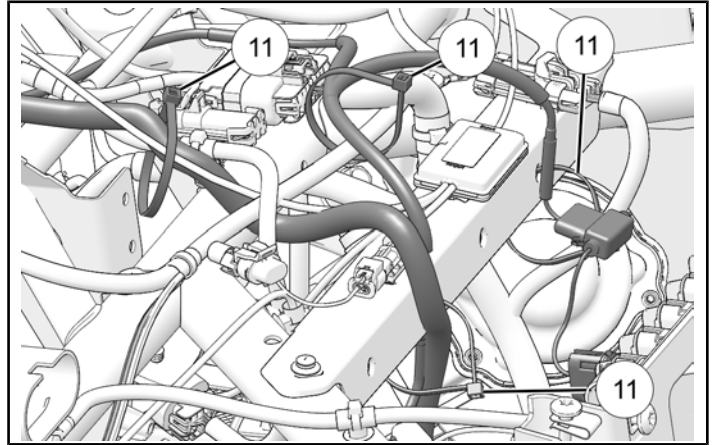

REMOTE CONTROL INSTALLATION

- Locate knock-out pattern inside the glove compartment and cut out the center hole plug.

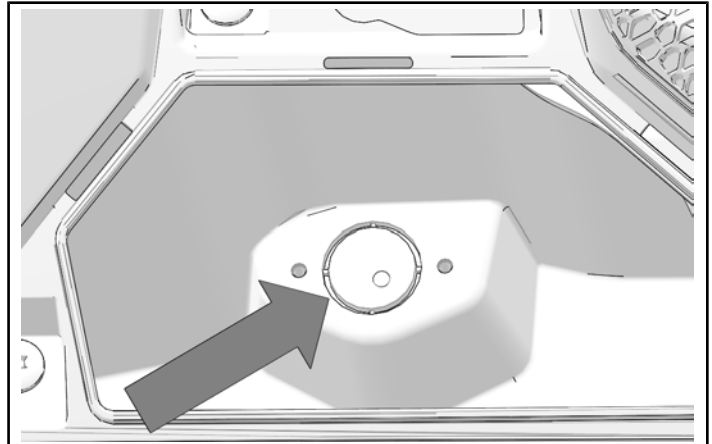

- Route corded remote harness through the large hole and install dash socket using washers ⑮ and screws ⑬.

DO NOT torque fasteners at this time.

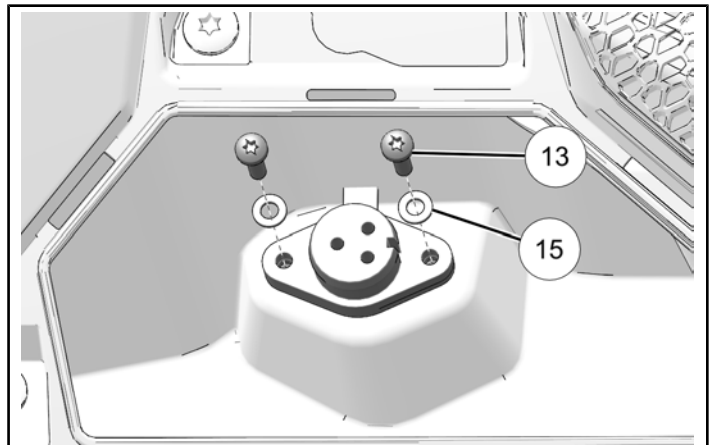

3. Install remote ⑨ by inserting three prongs into corresponding holes in the dash socket.

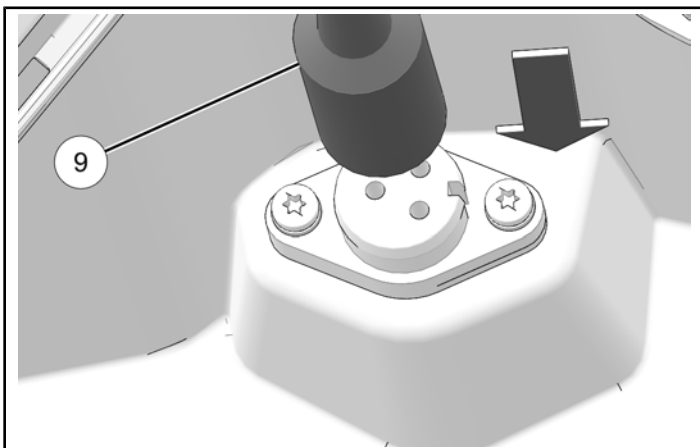

4. Torque screws ⑬ to specification.

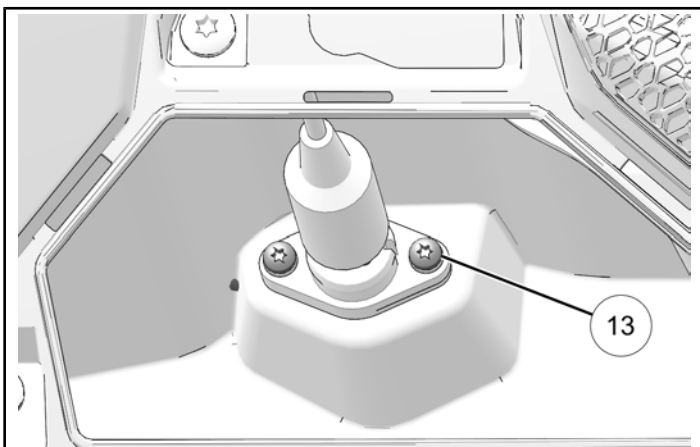

5. Connect remote control harness to connector at rear of winch assembly.

NOTICE

Parts of vehicle have been hidden for clarity.

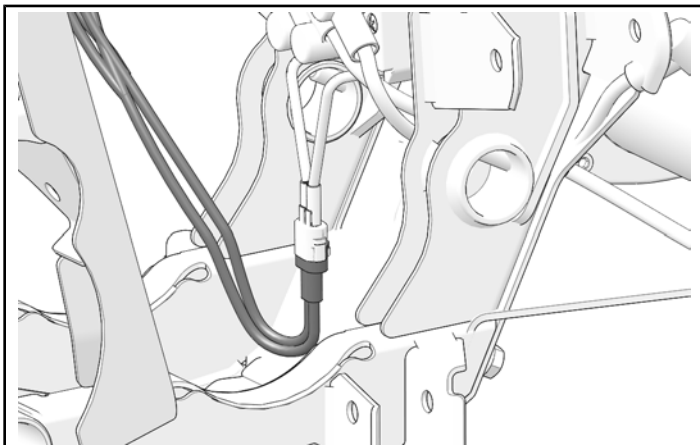

DASH SWITCH INSTALLATION

1. Remove blank cover from desired location.

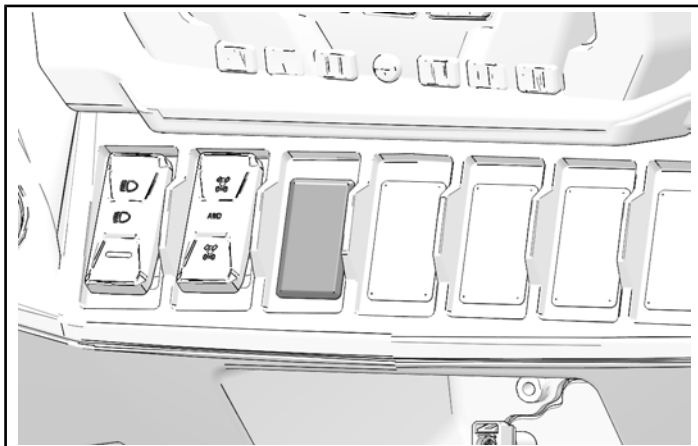

2. Pull switch connection through empty location and connect to switch. Connect green wire to pin one, red wire to pin 2, and black wire to pin 3 in rear of dash switch.

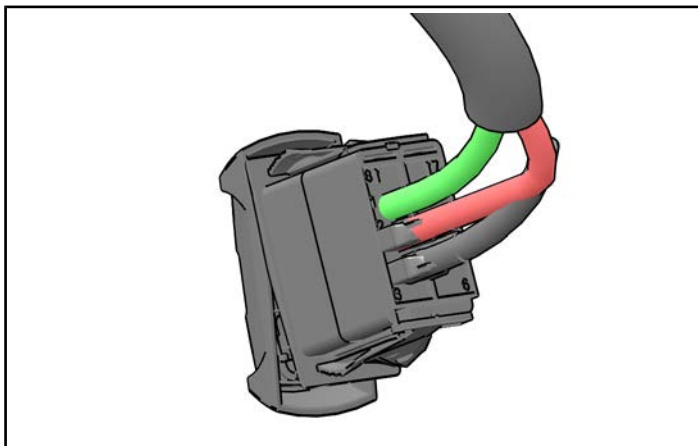
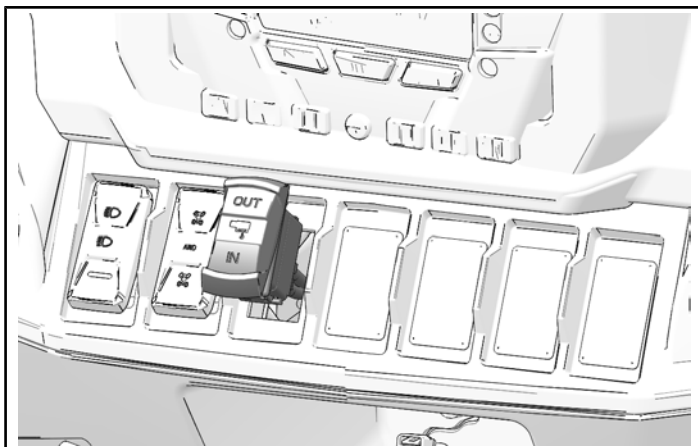

3. Install switch into empty location on dashboard, push switch until click is heard.

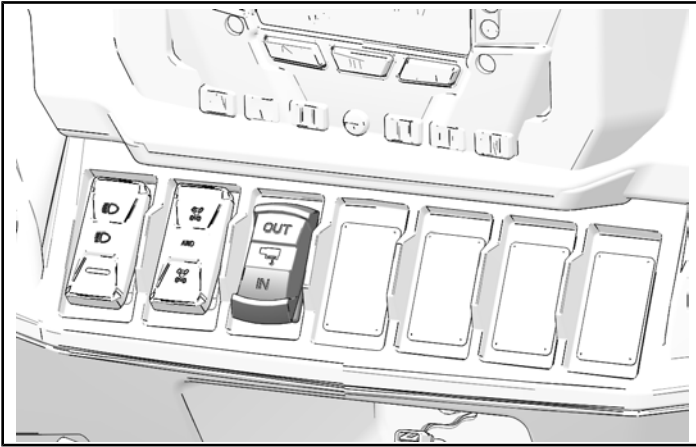

4. Connect dash switch harness to remote control harness.

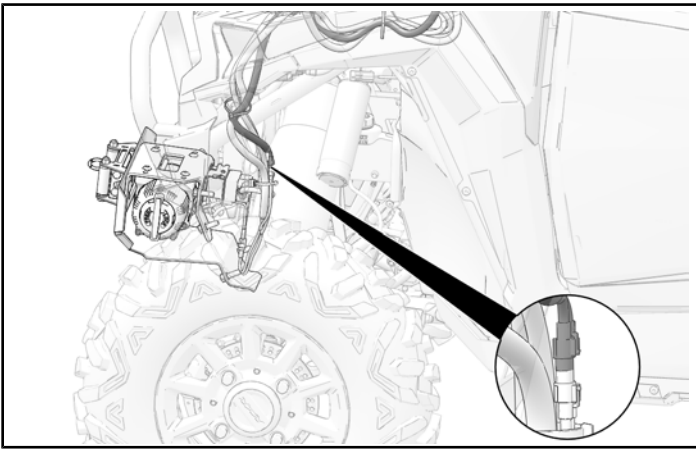

5. Connect three wire splitter in locations shown.

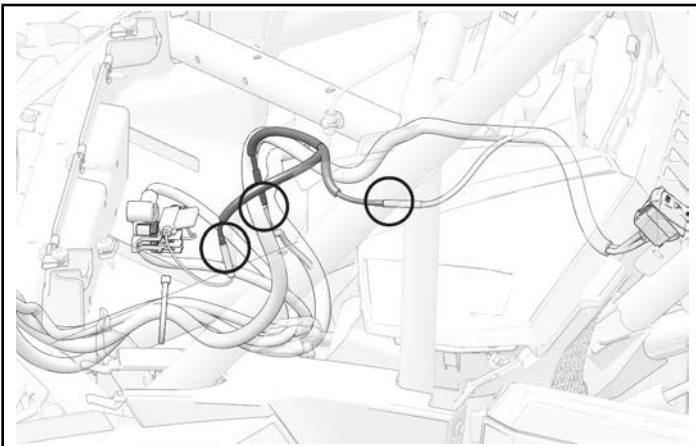

VEHICLE REASSEMBLY

CENTER INSTRUMENT PANEL INSTALLATION

1. Install center instrument panel with two screws.
Torque to specification.

TORQUE

Center Instrument Panel Screws:
88 in-lbs (10 N·m)

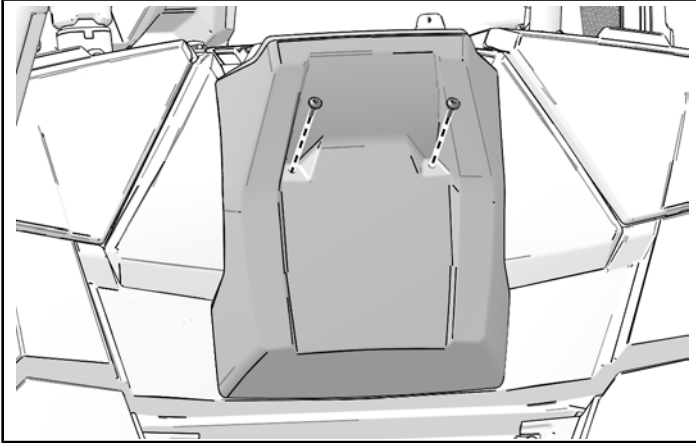

CENTER HOOD INSTALLATION

1. Install center hood from the rear of the vehicle.
Install screws.

TORQUE

Screws:
88 in-lbs (10 N·m)

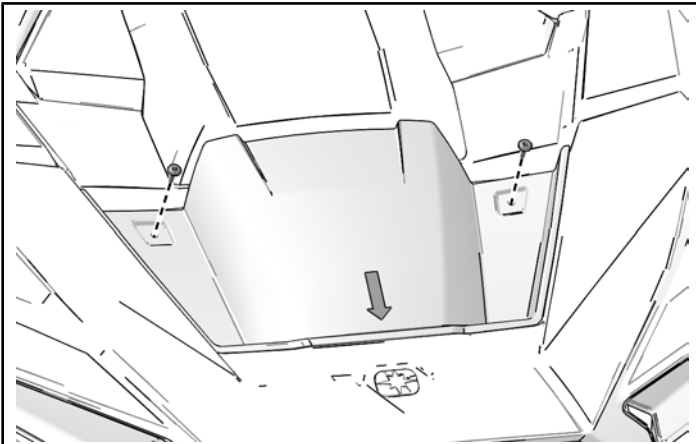

UPPER FASCIA INSTALLATION

1. Put upper fascia in place on vehicle frame.

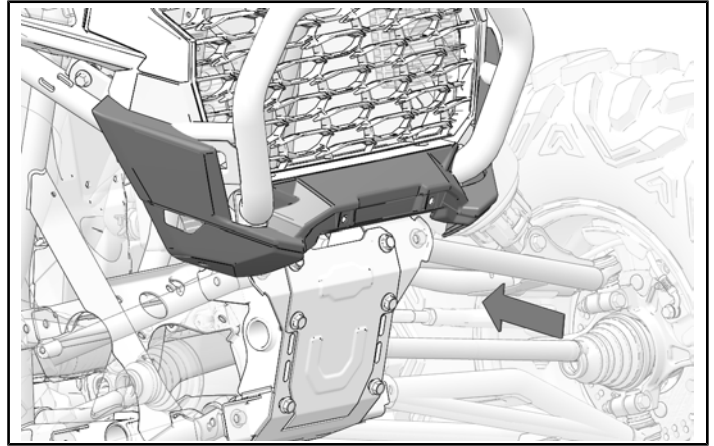

2. Install push-pin rivet to upper fascia.

NOTICE

Left side shown; right side similar.

NOTICE

Parts of vehicle have been hidden for clarity.

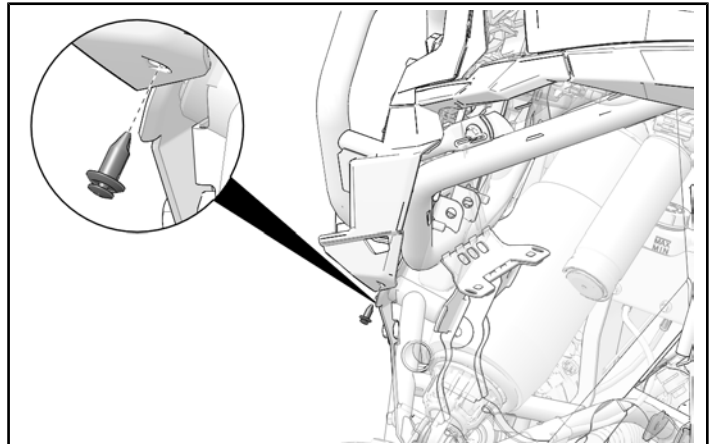

BATTERY CONNECT

1. Put negative battery cable on battery and torque nut to specification.

TORQUE

Battery Nut:
26 ft-lbs (35 N·m)

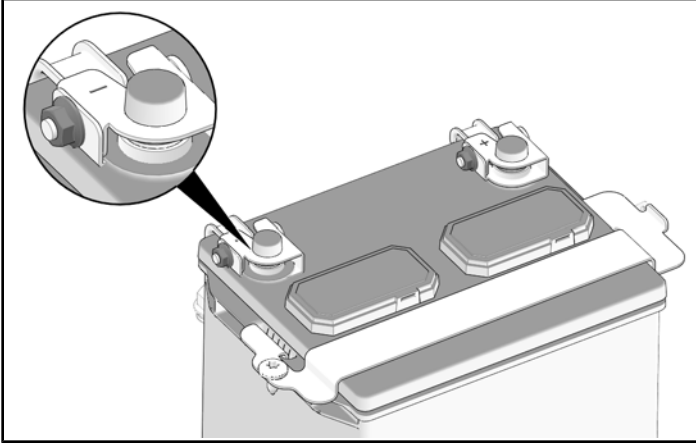

SEAT INSTALLATION

1. Put seat in vehicle with front resting on tube, as shown. Push seat back until it engages with rear tube.

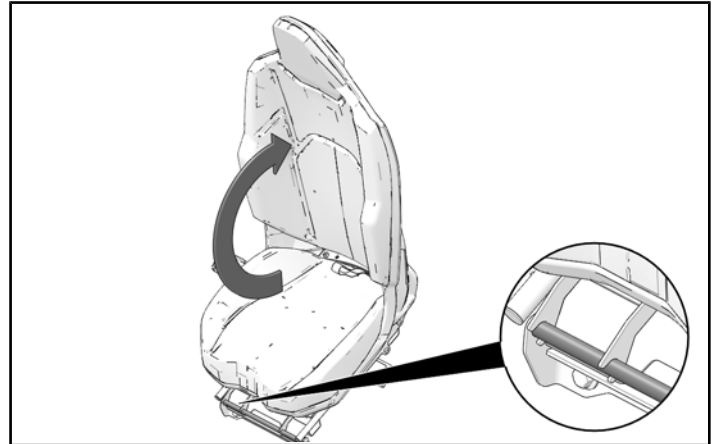

CONTROL SWITCH OPERATION

When properly installed, the control switches allow you to operate the winch while seated in the vehicle using the dash switch or remotely using the corded switch. Proper switch operation is shown.

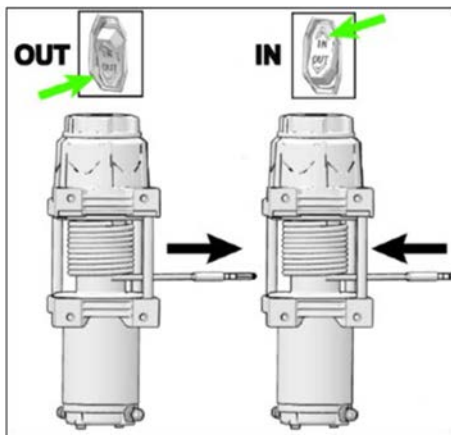

TROUBLESHOOTING

SYMPTOM	POSSIBLE CAUSES	RECOMMENDED SOLUTION
Winch will not operate.	Contactors not receiving power.	Turn vehicle key ON.
	Connections between components not in proper order.	Check connections. Connect wired handlebar switch connection from vehicle main wire harness directly to contactor to make sure a direct connection will operate the winch. If connections are not in the order shown in the pictures on the last page, the whole system may not function, or only certain parts of it will function.

	Loose battery cable connections.	Tighten nuts on all cable connections.
	Keyed power circuit (orange wires) not properly powered.	Check fusebox for 10A accessory circuit. Check voltage in certain places, especially orange wires coming out of the main harness by the steering post.
	Contactor malfunctioning.	Tap contactor to loosen contacts. Apply 12 volts to coil terminals directly. A clicking indicates proper activation.
	Defective switch assembly.	Replace switch assembly.
	Defective motor.	Check for voltage at armature port with switch pressed. If voltage is present, replace winch assembly.
	Nested and bounded cable within winch assembly.	Move free spool knob to the "free spool" position. Manually pull cable out of winch until end is met and then re-spool cable back into winch.
	Water has entered motor.	Allow to drain and dry. Run in short bursts without load until completely dry.
Winch makes noise, but rope does not move.	Contactor powered, but not winch.	If you can hear a clicking sound when you press the winch control, but the winch does not make any sounds, check the connections between the winch and the contactor.
	Winch not in proper gear.	Move free spool knob to the "locked spool" position, then recheck. If problem persists, a qualified technician needs to check and repair.
Winch operates too slowly.	Winch improperly loaded.	Check that the winch is clear and the rope is not bound up.
	Insufficient current or voltage.	The battery is weak, recharge. Run winch with the vehicle motor running (battery should have a strong charge).
	Loose or corroded battery cable connections.	Clean, tighten, or replace.
Winch overheating.	Winch running time too long.	Allow winch to cool down periodically.
Winch operates in one direction only.	Defective or stuck contactor.	Tap contactor to loosen contacts.
		Repair or replace contactor.
	Defective switch assembly.	Replace switch assembly.
	Defective brake assembly.	Replace winch assembly.

ELECTRICAL CONNECTION REFERENCE GUIDE

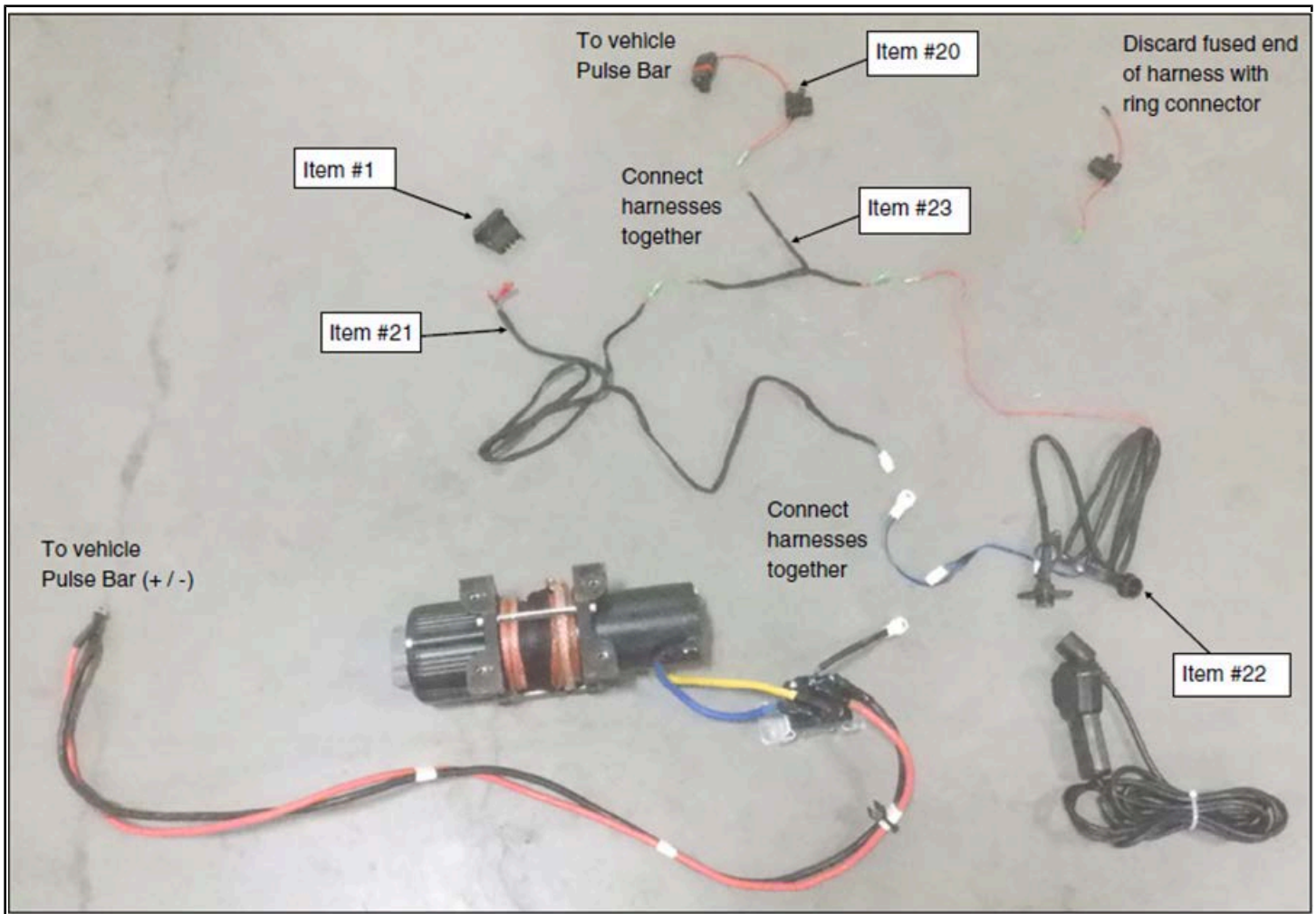

WARRANTY



FIVE YEAR MECHANICAL LIMITED WARRANTY AND THREE YEAR ELECTRICAL LIMITED WARRANTY

For the period of five (5) years from the purchase date, Kolpin will replace for the original purchaser, free of charge, any mechanical part or mechanical parts found upon examination by Kolpin to be defective in material, workmanship, or both. For the period of three (3) years from the purchase date, Kolpin will replace for the original purchaser, free of charge, any electrical part or electrical parts found upon examination by Kolpin to be defective in material, workmanship, or both.

All transportation costs incurred submitting product to Kolpin for warranty consideration must be borne by the purchaser. If Kolpin determines that the product must be returned to the factory for credit, please call 1-877-956-5746 for a Return Merchandise Authorization (RMA) number and shipping instructions.

This warranty does not apply to parts that have been damaged by accident, alteration, abuse, improper maintenance, normal wear, or other causes beyond the manufacturer's control. In order to protect you and your ATV, certain parts of the winch/plow system and/or hardware are designed to fail when the equipment is over-stressed. Parts that are lost due to loosening and improper maintenance are not covered under warranty. This warranty does not cover removal or reinstallation labor fees of the winch/plow system and related components.

Peripheral products such as engines, electric motors, and actuators may carry an original manufacturer's warranty. Most hardware is general in nature and is easily obtained locally. Be sure to replace with minimum metric class 8.8 specification.

Kolpin Outdoors, Inc.

Telephone: (763)-478-5800

Toll Free: (877)-956-5746

Fax Number: (800)-245-7569

www.Kolpin.com

Email: customerservice@kolpin.com