

Polaris Ranger Mid Size Full Tilting Windshield



Product Instructions | Part No: 2779

Application: Verify accessory fitment at Kolpin.com.

Before You Begin: Read these instructions and check to be sure all parts are accounted for. If any items are missing, do not return to the store. Call us at 1-877-956-5746 for assistance. Please retain these instructions for future reference and parts ordering information.

Dealers: Provide Instruction Manual to customer at time of purchase.

Tools Required: 4mm & 5mm Hex Wrench or Socket and Side Cutters or Snips

Product Contents:

Item	Description	Qty	Part Number
1	Windshield Panel	1	
2	Profile Clamp	4	K100140 (Qty 2)
3	Socket Head Screw - M6 x 14mm	4	
4	Button Head Screw - M6 x 18mm	8	
5	Lock Washer - M6	4	
6	Domed Shoulder Washer - M6	4	K100135 (Qty 1)
7	Slide Arm	2	
8	Upper Pivot	2	
9	Lower Pivot	2	
10	Pivot Cylinder	4	
11	T-Knob	2	
12	M6 x 38mm Button Head Screw	4	
13	M6 x 18mm Button Head Screw	2	PUR3355
14	M6 Lock Washer	6	
15	Bulb Seal - 48"	1	

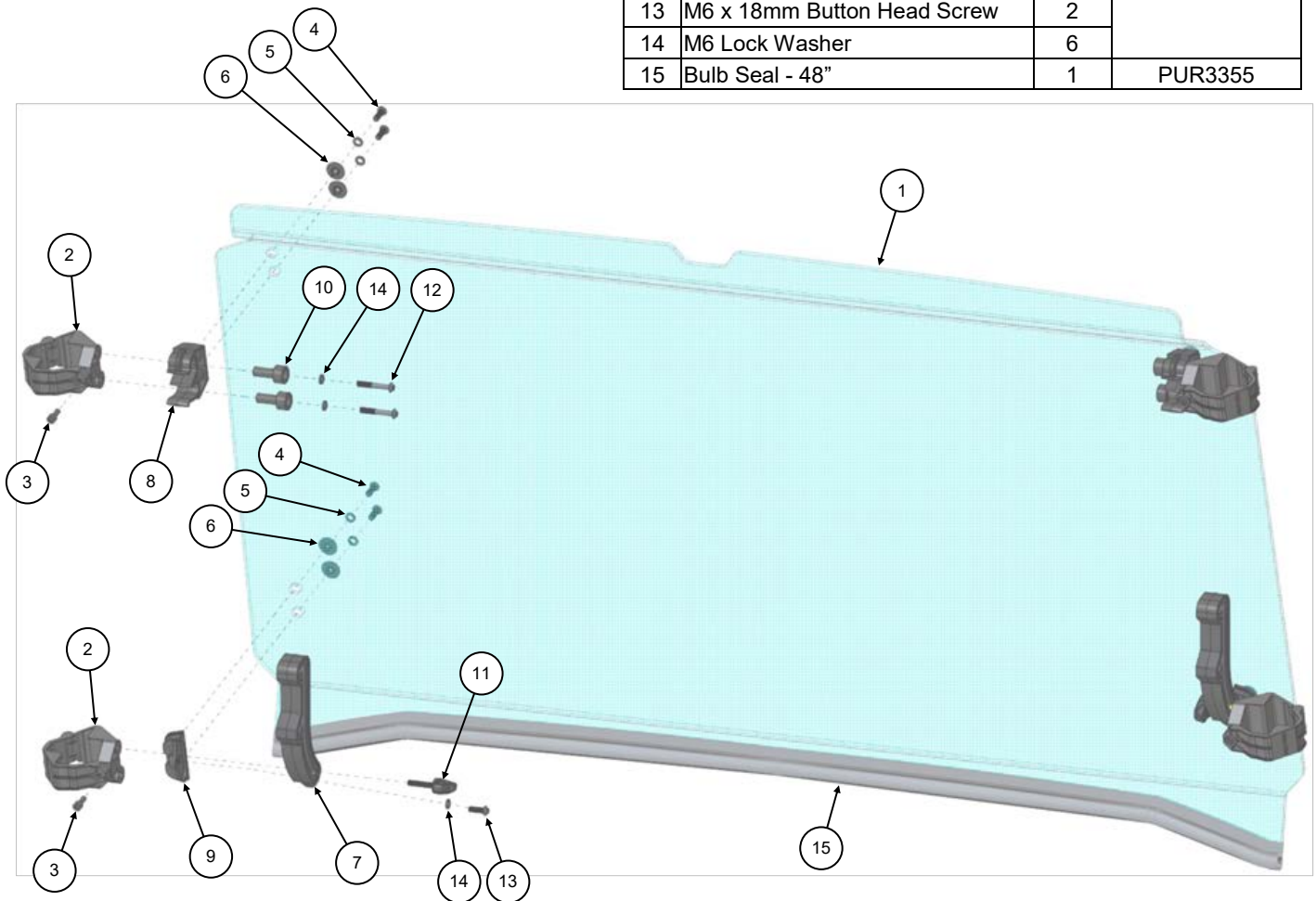

Kolpin Outdoors, Inc. | 9955 59th Ave N | Plymouth, MN 55442

(877) 956-5746 or (763) 478-5800 | www.kolpin.com | customerservice@kolpin.com

Assembly Time: Approximately 25 minutes

Important: This product is exclusively designed for your vehicle. Please read the installation instructions thoroughly before beginning. Installation is easier if the vehicle is clean and free of debris. For your safety, and to ensure a satisfactory installation, perform all installation steps correctly in the sequence shown.

Installation Instructions:

1. Shift vehicle transmission into PARK. Turn key to OFF position and remove from vehicle.
2. Peel back the protective film away from the bottom edge where the Bulb Seal attaches and around the mounting holes on both sides of the Windshield Panel. Leaving the remaining film on the panel will help protect it during installation.
3. Firmly press the Bulb Seal [Item 15] onto the bottom edge of the Windshield Panel [Item 1]. Cut off the excess Bulb Seal length. See Illustration 1-1.
4. During the initial assembly process, leave the hardware finger tight to allow for alignment and position adjustments until the final steps.
5. Attach the Upper Pivots [Item 8] and Lower Pivots [Item 9] to the back side of the Windshield Panel in the orientation shown. See Illustration 1-2.

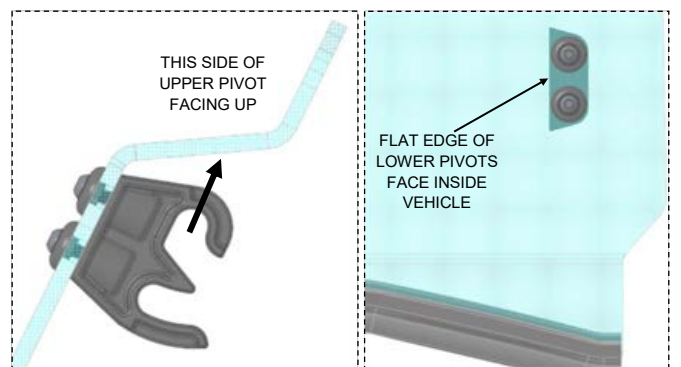
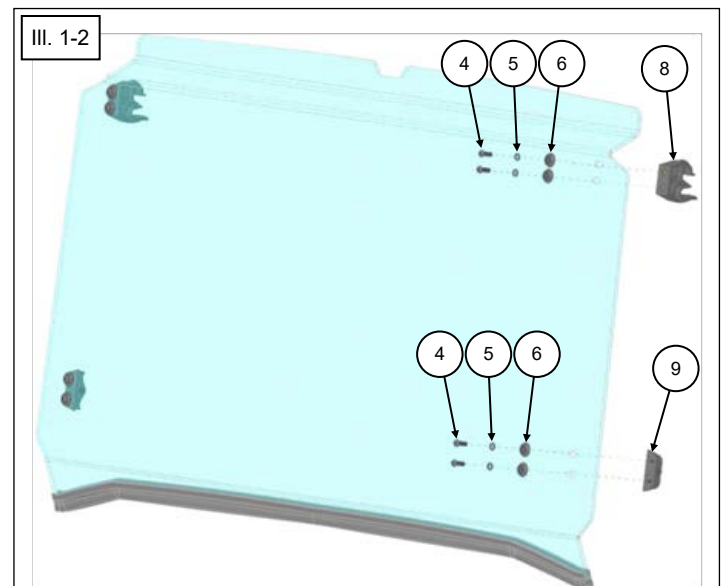
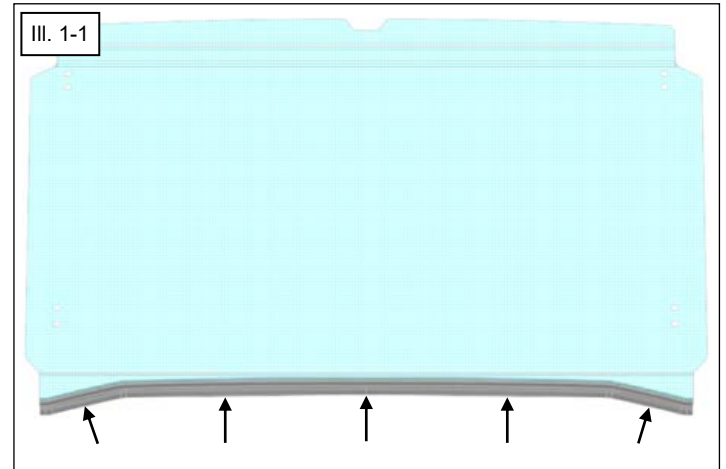

6. Attach the Slide Arms [Item 7] to the Lower Pivots [Item 9]. See Illustration 1-3.

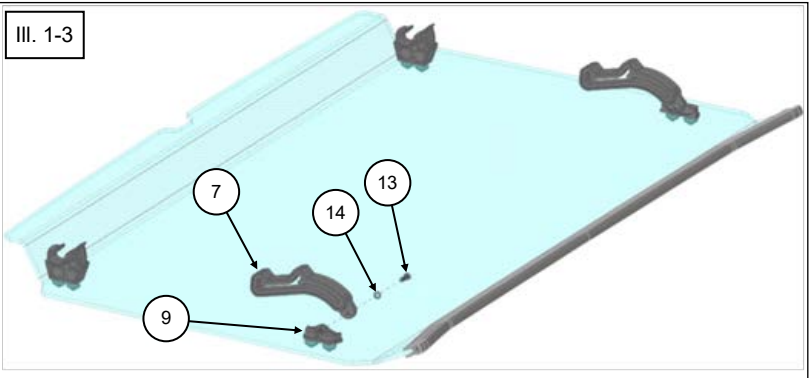

7. Attach the Profile Clamps [Item 2] to the Upper Pivots [Item 8] and Slide Arms [Item 7]. See Illustration 1-4.

8. Carefully position the Windshield Assembly onto the vehicle roll cage and insert the Socket Head Screws [Item 3] into the Profile Clamps [Item 2]. See Illustration 1-5.

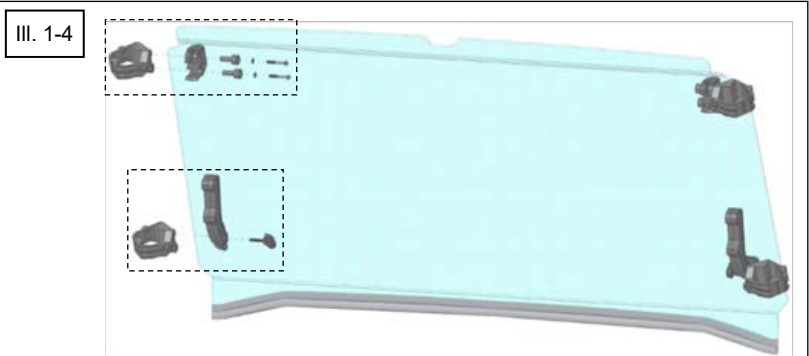

9. Adjust position of Profile Clamps and Slide Arms so that Windshield is aligned evenly and Bulb Seal makes contact with dash plastic.

10. Tighten all hardware.

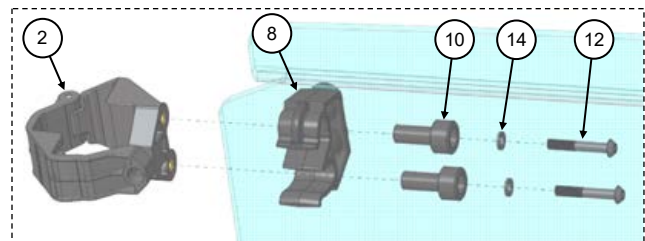

11. Remove the protective film from **BOTH** sides of the Windshield Panel. Protective film may be clear on one or both sides which can be difficult to see.

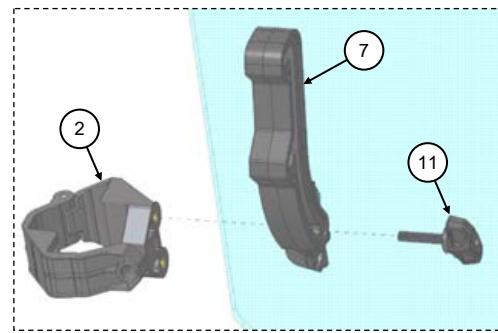

12. To tilt the Windshield open or closed, loosen the T-Knobs [Item 11] and move the Slide Arms & Windshield Panel in or out, then re-tighten. Tilted open positions are designed for low-speed riding **ONLY**.

13. Re-inspect hardware tightness before and after riding or trailering.

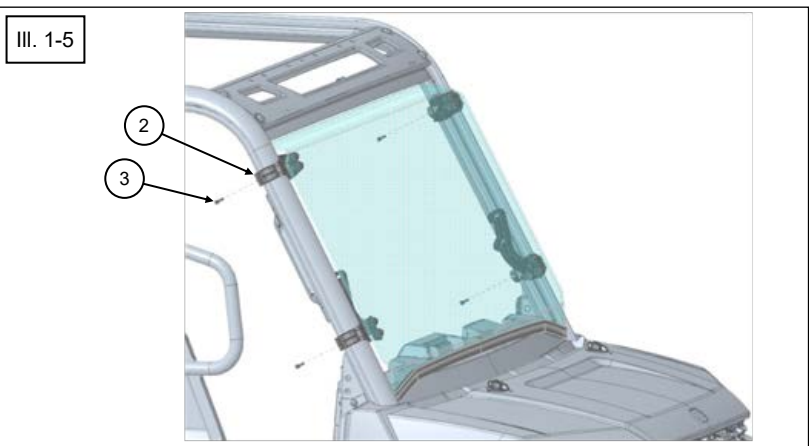

DANGER

TO AVOID SERIOUS INJURY OR DEATH:

1. DO NOT TRAILER VEHICLE FACING REARWARD WITH WINDSHIELD INSTALLED. AIRFLOW MAY CAUSE WINDSHIELD TO SEPARATE FROM VEHICLE, RESULTING IN AN ACCIDENT AND SEVERE INJURY OR DEATH. REMOVE WINDSHIELD OR TRANSPORT VEHICLE IN ENCLOSED TRAILER.
2. UTVs ARE TO ONLY BE DRIVEN WITH CLEAN WINDSHIELDS FOR DRIVING VISIBILITY. IF DIRT OR DEBRIS ACCUMULATES ON THE WINDSHIELD WHEN RIDING, STOP THE UTV AT THE NEXT SAFE LOCATION ON THE TRAIL TO CLEAR OFF THE WINDSHIELD BEFORE YOU RESUME RIDING.
3. ONLY INSTALL WINDSHIELDS THAT ARE DESIGNED FOR THE MAKE AND MODEL OF THE UTV. INSTALLATION OF A WINDSHIELD THAT WAS NOT DESIGNED FOR THE UTV MAKE AND MODEL CAN IMPACT WINDSHIELD DURABILITY AND PERFORMANCE.
4. READ AND UNDERSTAND WINDSHIELD INSTRUCTION SHEETS AND UTV OWNER MANUAL BEFORE WINDSHIELD INSTALLATION OR OPERATING THE VEHICLE.
5. PERIODICALLY CHECK FOR WEAR AND TIGHTNESS OF ALL FASTENERS. ALWAYS INSPECT BEFORE AND AFTER RIDING OR TRAILERING. REPLACE OR RE-TORQUE FASTENERS AS NECESSARY.
6. TILTED OPEN WINDSHIELD POSITIONS ARE DESIGNED FOR LOW-SPEED RIDING ONLY.

Windshield Cleaning Information:

- Remove all dirt, mud, dust and debris from Windshield with water before cleaning.
- Use a mild soap or dishwashing detergent along with a soft sponge or soft cotton cloth to clean Windshield surface. Do not apply in direct sunlight. Rinse with water immediately and dry with a soft cotton cloth or chamois.
- Always test cleaning agents in a small inconspicuous area prior to cleaning entire panel.
- Never use Windshield cleaning fluids (409, Windex, etc.), gasoline, high alkaline cleaners, or solvents.
- Never use abrasives, brushes, razor blades, scrapers, squeegees, gloves or dirty cloths.

ONE YEAR LIMITED WARRANTY

For the period of one (1) year from the purchase date, Kolpin will replace for the original purchaser, free of charge, any part or parts found upon examination by Kolpin to be defective in material, workmanship, or both.

All transportation costs incurred submitting product to Kolpin for warranty consideration must be borne by the purchaser. If Kolpin determines that the product must be returned to the factory for credit, please call 1-877-956-5746 for a Return Merchandise Authorization (RMA) number and shipping instructions.

This warranty does not apply to parts that have been damaged by accident, alteration, abuse, improper maintenance, normal wear, or other causes beyond the manufacturer's control. In order to protect you and your ATV, certain parts of the accessory system and/or hardware are designed to fail when the equipment is over-stressed. Parts that are lost due to loosening and improper maintenance are not covered under warranty. This warranty does not cover removal or reinstallation labor fees of the accessory system and related components. Most hardware is general in nature and is easily obtained locally. Be sure to replace with minimum metric class 8.8 specification.

Kolpin Outdoors, Inc.

Telephone: (763)-478-5800

Toll Free: (877)-956-5746

www.kolpin.com

customerservice@kolpin.com