

Polaris Ranger Crew XP 1000 Rear Half Steel Doors



Product Instructions | Part No: 32010

Application: Polaris Ranger Crew XP 1000 / Ranger Crew 1000, verify accessory fitment at Kolpin.com.

Before You Begin: Read these instructions and check to be sure all parts and tools are accounted for. Please retain these installation instructions for future reference and parts ordering information.

Note: If any hardware is missing, do not return to the store. Call us to help, Toll Free 1-877-956-5746.

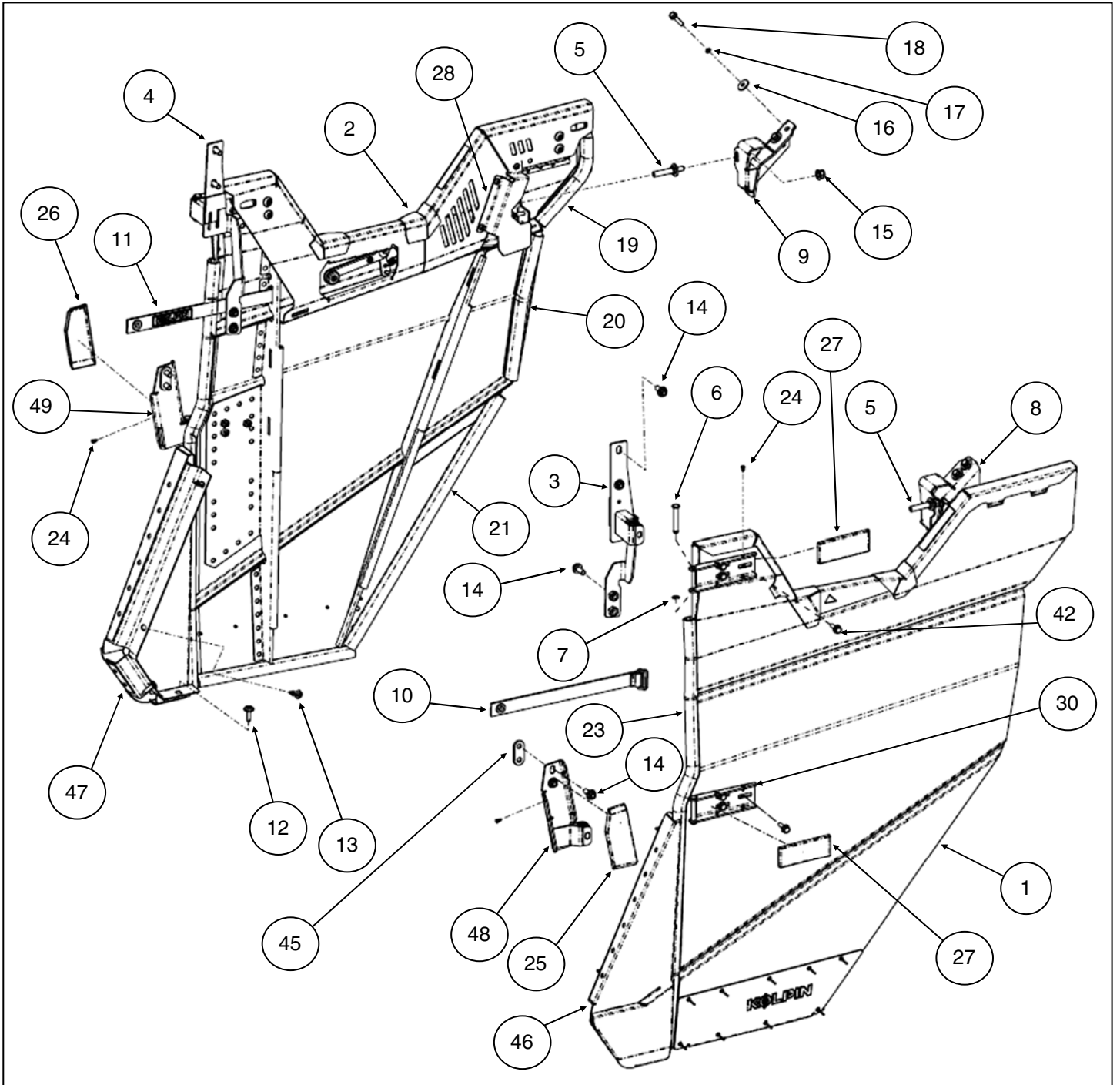

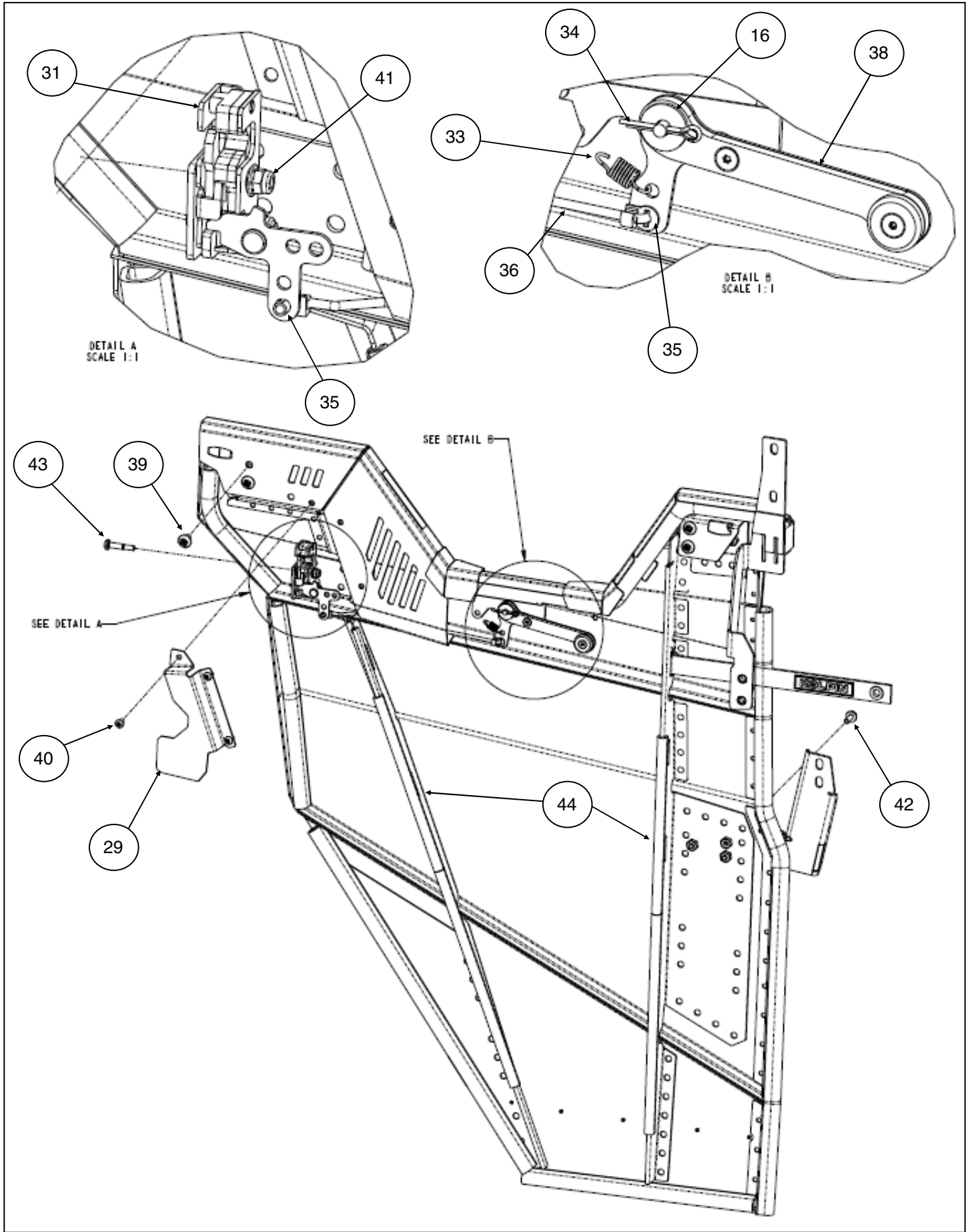

This Kit includes:

Item	Qty	Part Description	Part Number
1	1	LH Ranger Rear Door	-
2	1	RH Ranger Rear Door	-
3	1	LH Vehicle-Side Hinge Upper Bracket	32010-CP03
4	1	RH Vehicle-Side Hinge Upper Bracket	32010-CP17
5	2	Door Striker Pin, Zinc Plated	32000-CP20
6	4	Door Hinge Pin, Zinc Plated	32000-CP01
7	4	Pin E-Clip, M6, DIN 6799	32000-CP01
8	1	LH Door Striker Bracket	-
9	1	RH Door Striker Bracket	-
10	1	LH Door Limit Strap	32010-CP24
11	1	RH Door Limit Strap	32010-CP24
12	4	Truss Screw, Zinc Plated, M6 x 1.0 - 25mm LG, T40 Thread Forming	7519650
13	4	Plastic Tuflok Fender Clip Body Rivet	7661855
14	12	Hex Flange Screw, Zinc Plated, M8 x 1.25 - 20mm LG	7519936
15	2	Hex Flange Locknut, Zinc Plated, M8 x 1.25	7547332
16	6	M6 Flat Washer, Zinc Plated	7556386
17	4	M6 Lock Washer, Zinc Plated	-
18	4	Hex Flange Screw, Zinc Plated, M6 - 1.0 x 25mm LG	7516823
19	2	D-Trim Door Seal Strip, 200mm LG	32010-CP10
20	2	D-Trim Door Seal Strip, 285mm LG	32010-CP10
21	2	D-Trim Door Seal Strip, 525mm LG	32010-CP10
22	2	D-Trim Door Seal Strip, 310mm LG	32010-CP10
23	2	D-Trim Door Seal Strip, 844mm LG	32010-CP10
24	24	Reusable Ribbed Shank Plastic Dart Rivets	32012
25	1	LH Lower Hinge Cover	32010-CP20
26	1	RH Lower Hinge Cover	32010-CP21
27	4	Door Hinge Cover, Painted	-
28	1	RH Door Latch Cover, Painted	-
29	1	LH Door Latch Cover, Painted	-
30	4	Door Hinge, Zinc Plated	32010-CP02
31	1	LH Door Inner Latch, Zinc Plated, R4-10	32000-CP03
32	1	RH Door Inner Latch, Zinc Plated, R4-10 (not shown)	32000-CP03
33	2	Door Lever Spring, Zinc Plated	-
34	2	Cotter Pin, Zinc Plated	-
35	4	Link Clip Retainer, Black Plastic	32002
36	2	Linkage Rod, Zinc Plated	-
37	1	RH Inner Door Handle (not shown)	32000-CP18
38	1	LH Inner Door Handle	32000-CP08
39	8	Torx Button Head Screw, Zinc Plated, M8 x 1.25 - 15mm LG	7520311
40	6	Torx Button Head Screw, Zinc Plated, M6 x 1.0 - 12mm LG	7518330
41	4	Hex Flange Locknut, Zinc Plated, M6 - 1.0	7548027
42	12	Hex Flange Screw, Zinc Plated, M6 - 1.0 x 20mm LG	7518613
43	4	Cap Head Shoulder Screw, Zinc Plated, M6 - 1.0 x 35mm LG	-
44	4	Edge Rubber Trim Seal, 550mm LG	32010-CP10
45	2	Lower Hinge Body Spacer, Painted	-
46	1	LH Corner Garnish Cover, Painted	-
47	1	RH Corner Garnish Cover, Painted	-
48	1	LH Lower Vehicle Hinge, Painted	32010-CP03
49	1	RH Lower Vehicle Hinge, Painted	32010-CP17

Tools Required:

- Safety Glasses
- Socket Set, Torx Bit
- Socket Set, Metric
- Torque Wrench
- Wrench Set, Metric
- Cutting Tool for Plastic (example Dremel)

Assembly Time: Approximately 30 minutes

Note: The 32010 kit comes mostly assembled from the factory. Some assembly is required.

Important: Your Kolpin Ranger Crew XP 1000 Half Door Kit is exclusively designed for your vehicle. Please read the installation instructions thoroughly before beginning. Installation is easier if the vehicle is clean and free of debris. For your safety, and to ensure a satisfactory installation, perform all installation steps correctly in the sequence shown. Additional time may be required to accommodate other installed accessories.

NOTICE

Kolpin recommends two people install this kit.

RANGER CREW PREPARATION:

1. Shift vehicle transmission into "PARK". Turn ignition key to "OFF" position and remove from vehicle ignition.
2. Using hand tools (not electric powered), remove the rear LH side net, upper rear net clip on door B-pillar frame and lower rear net mount on floor. Remove the other T40 Torx drive head screws and two plastic rivets from the rear door frame as shown. (See illustrations 1-1 and 1-2). **Note, reinstall the screws noted to hold bolster bar and lower rear fender.**
3. Remove the LH CREW RANGER REAR door assembly from the packaging.

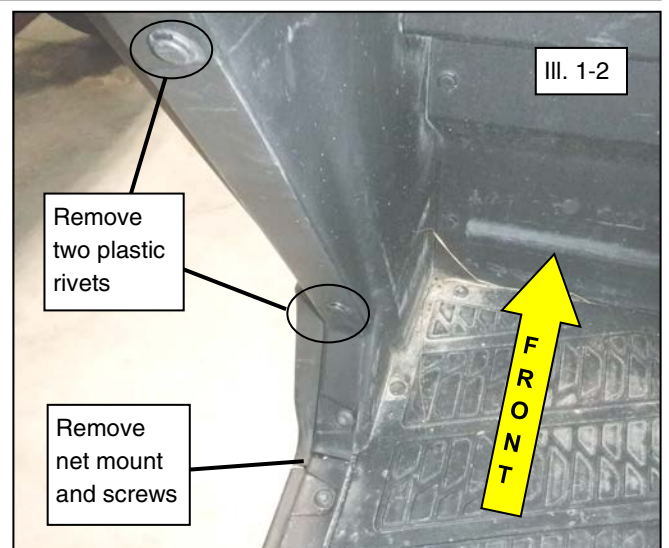
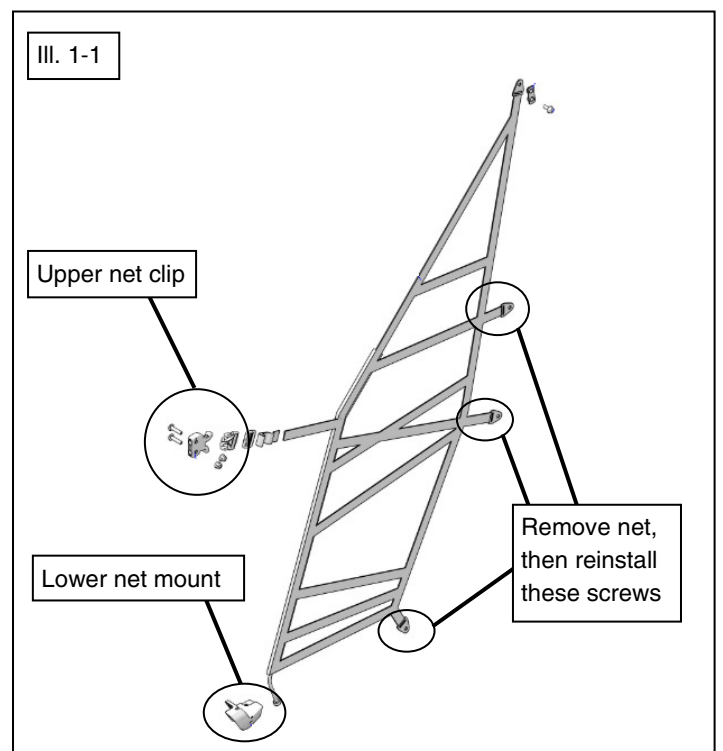

**RANGER CREW REAR DOOR
INSTALLATION:**

4. Remove two OEM screws from top of existing B-pillar cover as shown. Retain screws. Remove two push pin rivets from bottom interior of B-pillar (front rivet and rear rivet), then remove LH cover. Retain rivets. (See illustration 1-3).
5. Trim 2" H x 1" W (50mm H x 25mm W) rectangle opening into the LH as shown. (See illustrations 1-4, 1-5, and 1-6). **Note, pre-cut B-pillar covers (not included in Kolpin kit) could be purchased separately through local Polaris dealer, PNs 5454372-070 and 5454373-070.**
6. Install trimmed cover using the retained screws and plastic push-pin rivets. (See illustrations 1-6, 1-7 and 1-8)

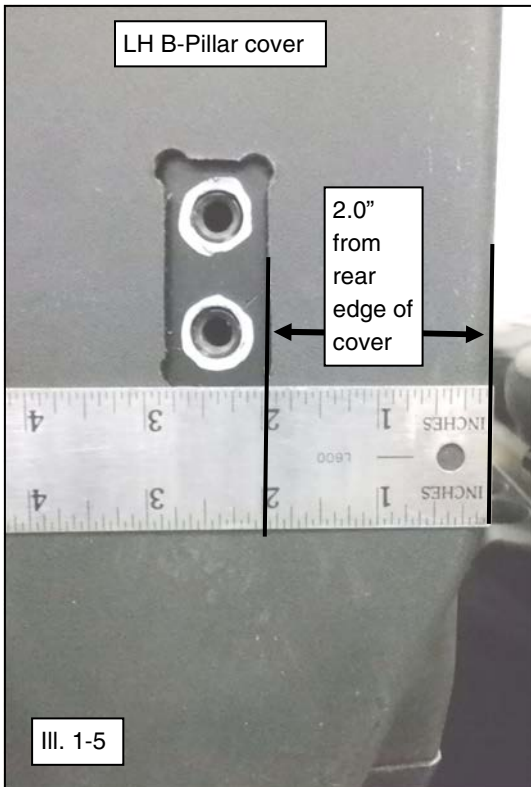
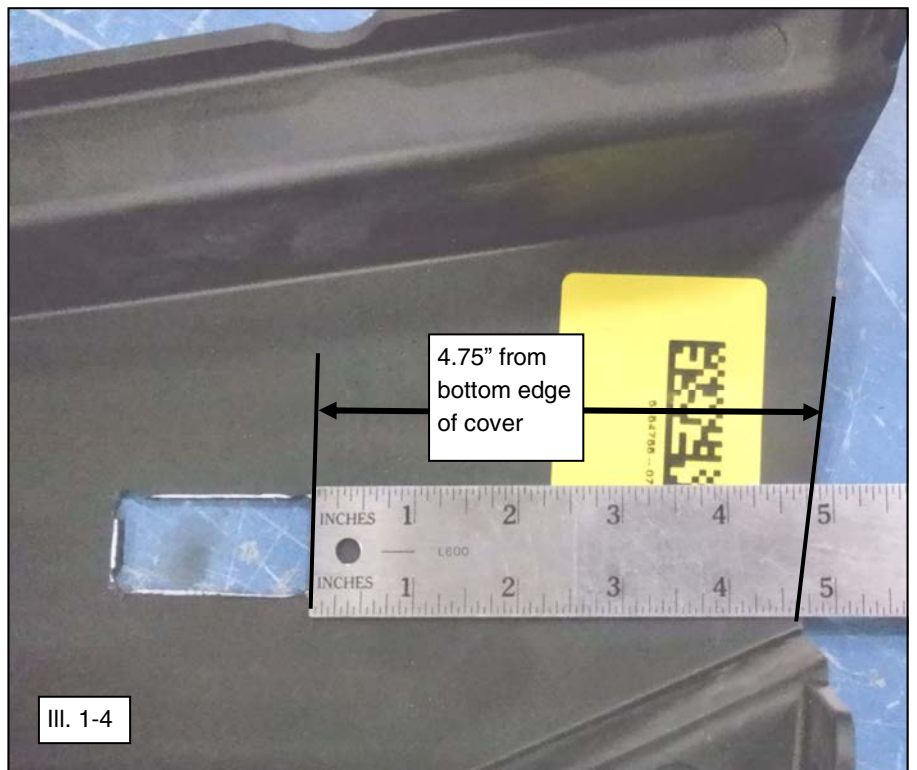
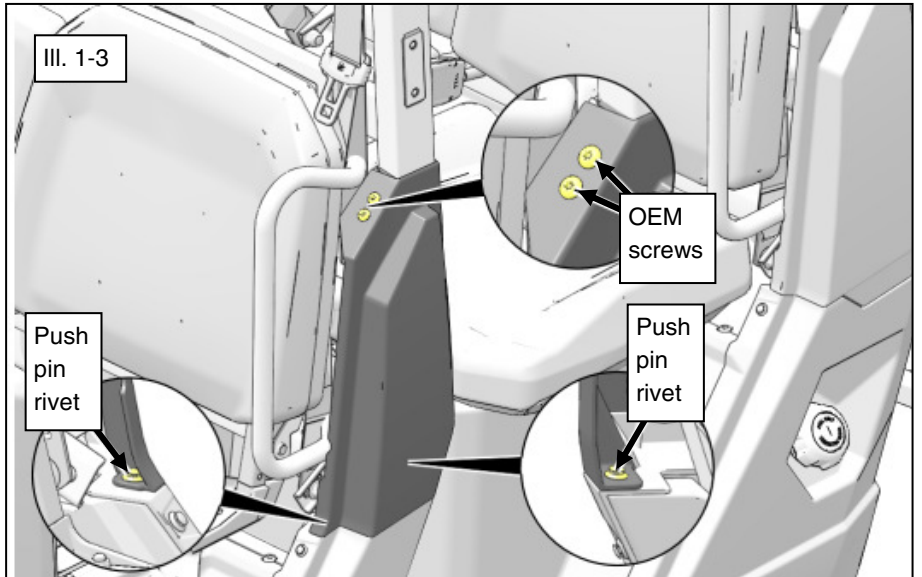

**RANGER CREW REAR DOOR
INSTALLATION (continued):**

7. Install the lower vehicle hinge spacer (item #45) into the 2" x 1" trimmed LH B-pillar cover opening as shown. (See illustration 1-9).
8. Using the supplied plastic push-pin rivets (item #13) and M6 truss screws (item #12), install the lower LH garnish trim cover (item #46) into the door opening as shown. (See illustrations 1-10 and 1-11).
9. Tighten screws to specification noted.

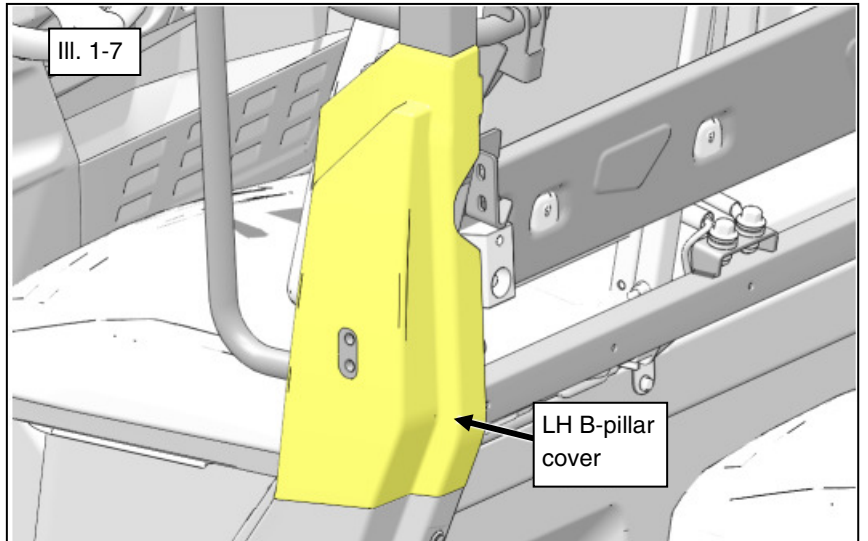

 = T
ITEM #12 M6 FASTENER TORQUE:

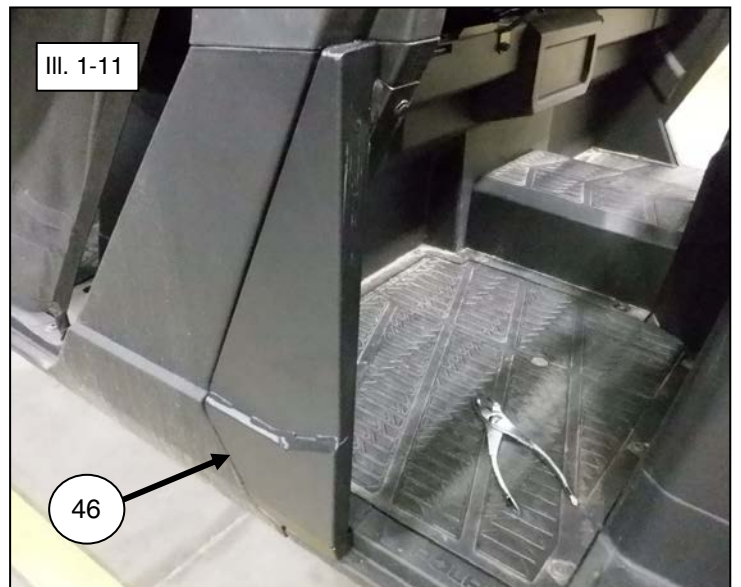
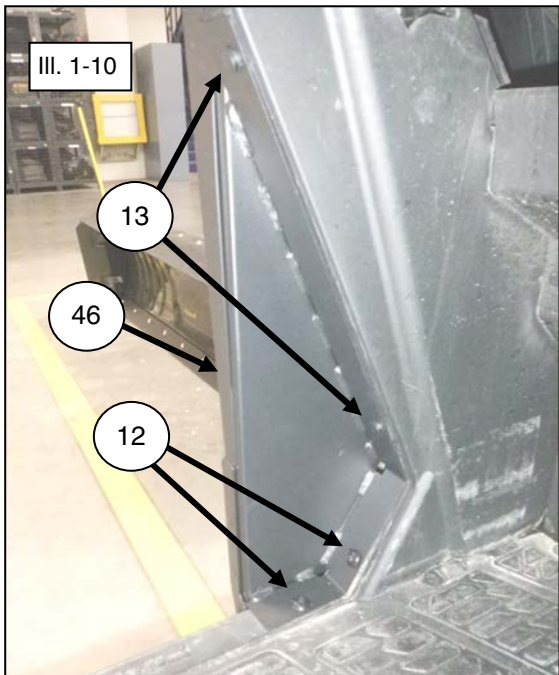
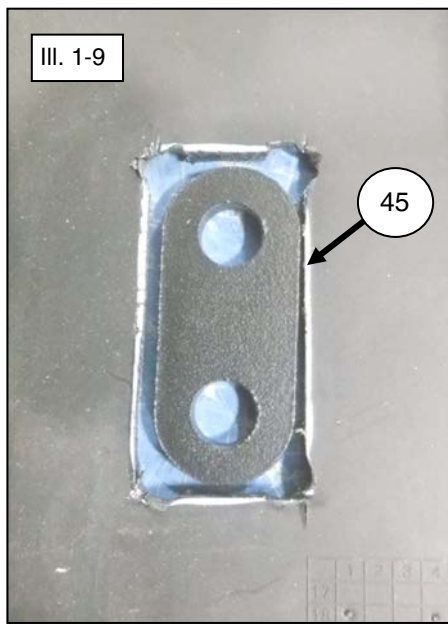

**RANGER CREW REAR DOOR
INSTALLATION (continued):**

10. Install LH Rear Door assembly by aligning vehicle-side hinges, Upper Hinge (item #3) and Lower Hinge (item #48), to vehicle B-pillar mounting tabs and fasten hinges using six M8 screws (item #14) as shown. (See illustrations 1-12, 1-13, 1-14 and 1-15). **Note, for the lower hinge (item #48), the previously installed spacer (item #45) fits between hinge and vehicle B-pillar chassis frame.**

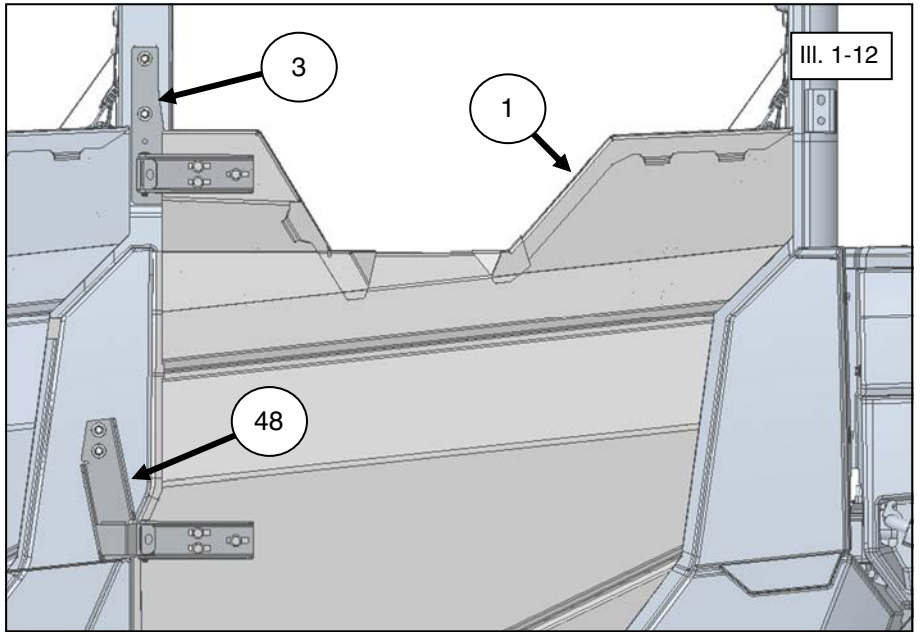

NOTE
LH Door is pre-assembled to LH Vehicle-Side Upper Hinge and Lower Hinge.

11. Tighten screws to specification noted.

ITEM #14 M8 FASTENER TORQUE:
17 ft. lbs. (23.0 Nm)

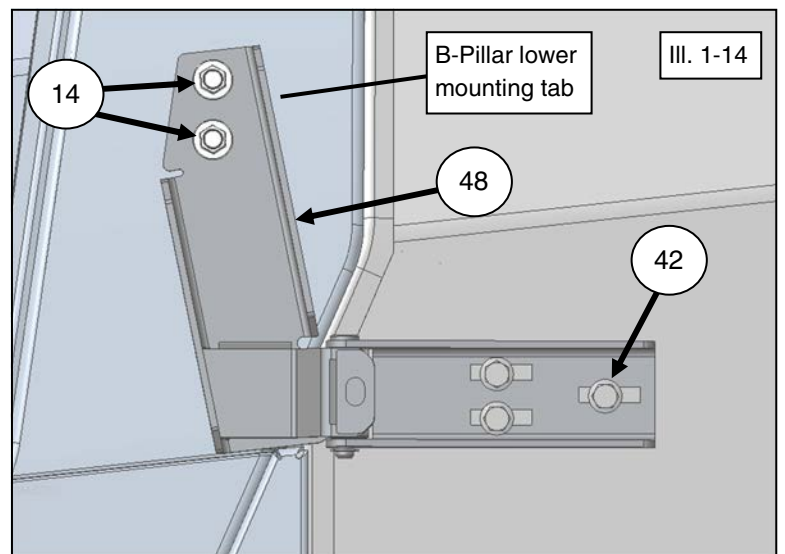
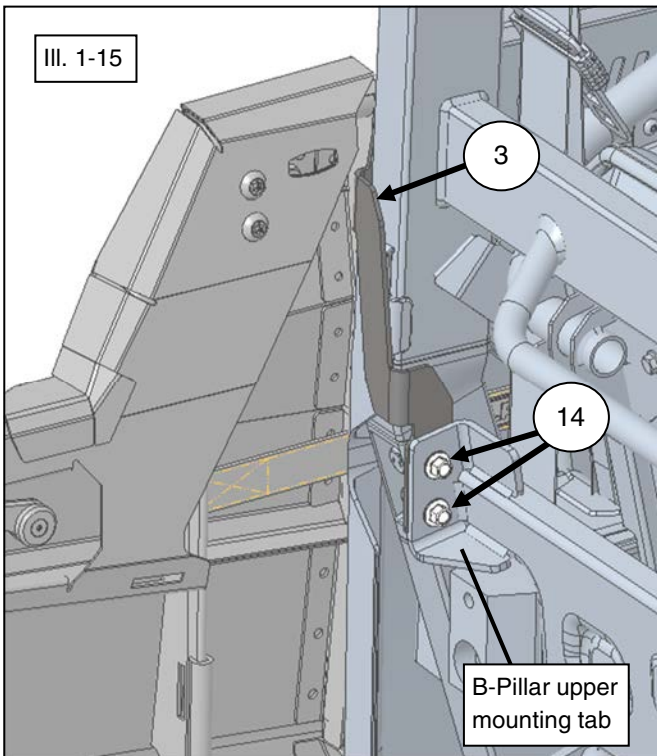
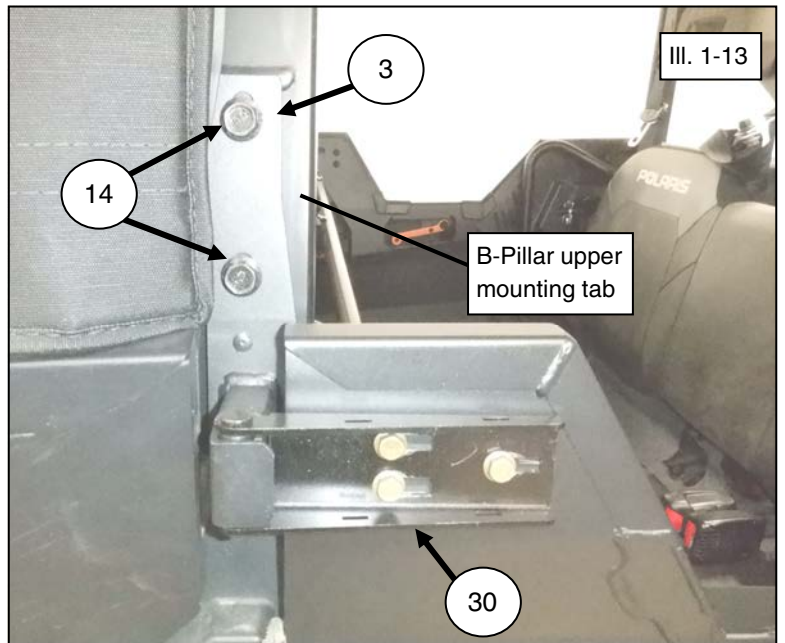

**RANGER CREW REAR DOOR
INSTALLATION (continued):**

12. Slightly loosen the LH door-side hinges (item #30) by loosening the six M6 hex flange screws (item #42). (See illustration 1-16).
13. Then close door. Push door inwards while centering door in ROPS/chassis opening, checking front-to-rear adjustment, then tighten M6 screws to specifications. (See illustrations 1-16 and 1-20). **Note, LH door can be pushed more forward to compress the D-trim door seal (item #23).**

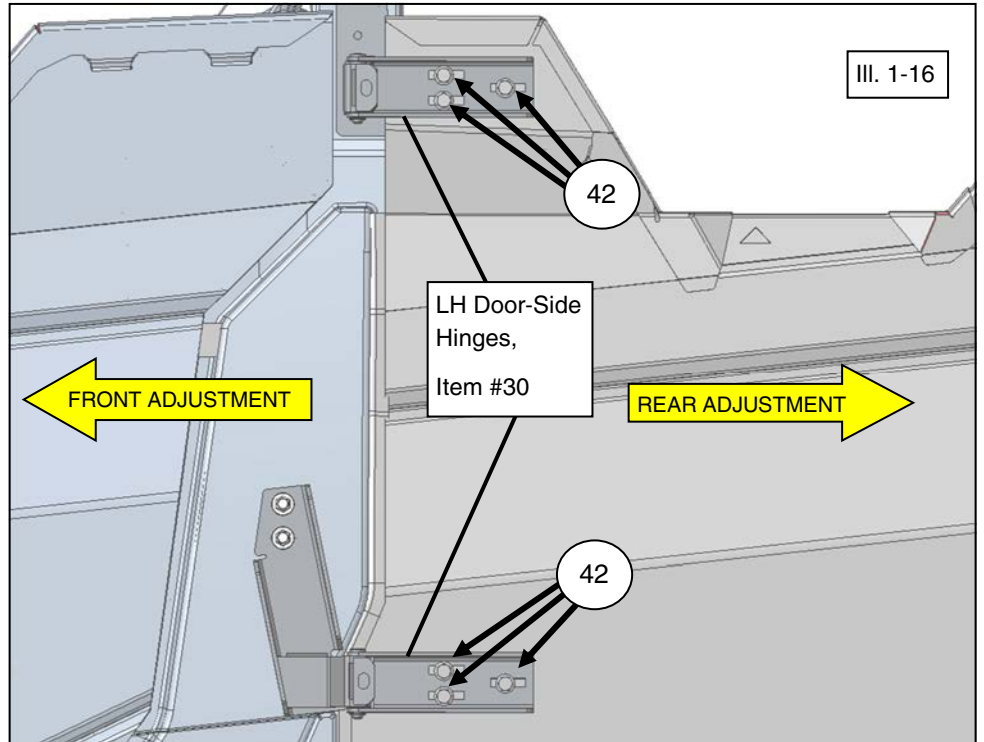

TIP

Have one person push and center the door, and a second person tighten the screws.

14. Install LH striker bracket (item #8) using two hex flange M6 screws (item #16) with two M6 lock washers (item #17) and two M6 flat washers (item #18) as shown. (See illustration 1-17). **Note, LH Striker Bracket (item #8) needs to be installed under LH bolster bar as shown. (See illustration 1-17).**
15. Tighten to specifications noted.

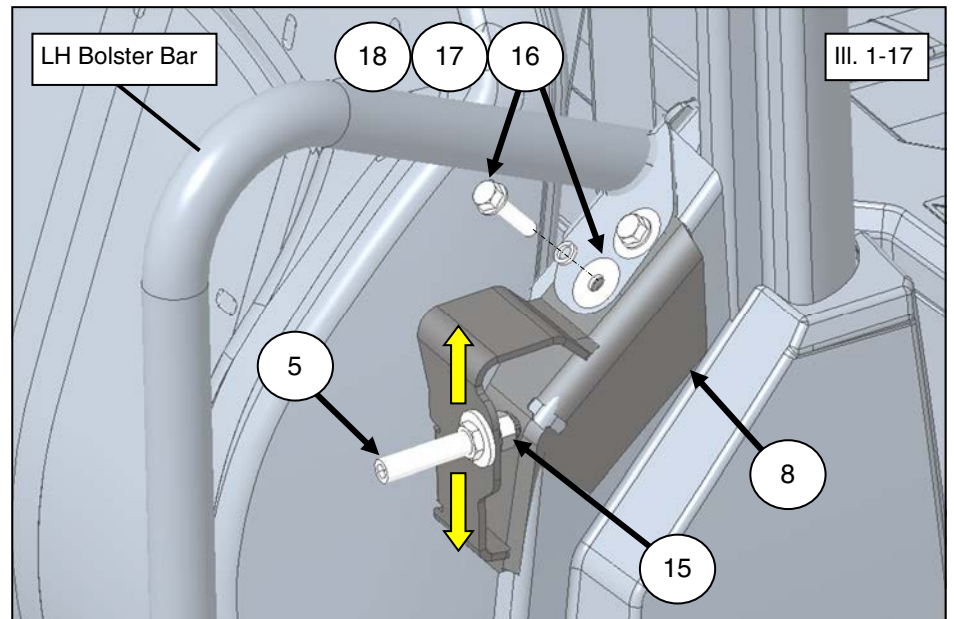

**ITEM #42 DOOR HINGE M6 SCREWS /
ITEM # 16 STRIKER BRACKET M6
FASTENER TORQUE:**
7 ft. lbs. (9.5 Nm)

NOTE

Striker pin (item #5) and striker locknut (item #15) is pre-assembled to LH Striker Bracket.



**RANGER CREW REAR DOOR
INSTALLATION (continued):**

16. Open door latch handle (lifting up on orange handle), then slowly close door and observe engagement of striker pin into door latch.
17. Adjust striker pin to achieve the following:

HEIGHT: Pin should be centered vertically between upper and lower latch opening/ pawls. To adjust, loosen the M8 locknut (item #15) on striker pin/bracket, slide striker pin up or down as required, then retighten M8 striker pin locknut to specification. (See illustrations 1-17, 1-18 and 1-19).

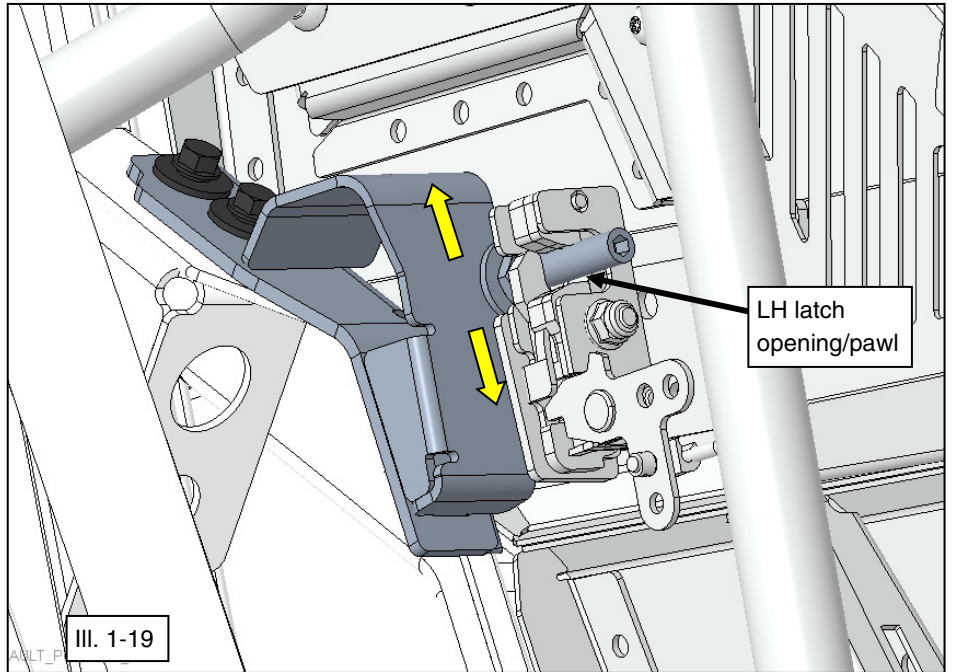

 = T
ITEM #15 STRIKER PIN M8 LOCKNUT FASTENER TORQUE: 12 ft. lbs. (16.3 Nm)

 = T
ITEM #43 LATCH M6 SCREW FASTENER TORQUE: 4 ft. lbs. (5.4 Nm)

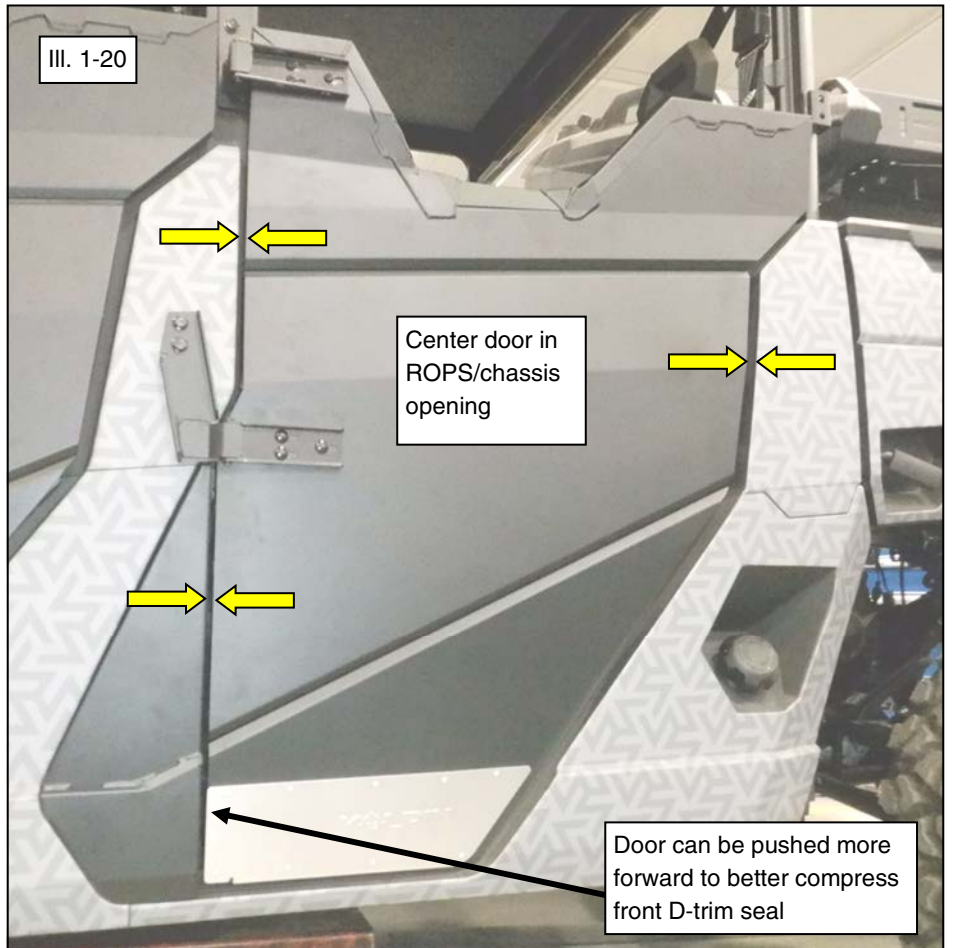

RANGER CREW REAR DOOR INSTALLATION (continued):

18. Adjust striker bracket to achieve the following:

DEPTH: There should be clearance between the top of door and bolster bar. To adjust, loosen striker bracket two screws, and slide bracket left-right of vehicle centerline. To provide more depth adjustment, loosen the striker bracket two screws and slide bracket left-right of vehicle centerline. (See illustration 1-21).

19. Using eight of the small plastic ribbed shank rivets (item #24), install the door hinge covers (item #27) on the upper and lower door hinges (item #30). (See illustrations 1-22 and 1-23).

20. Install the LH vehicle hinge cover (item #25) onto the lower LH vehicle hinge (item #48) using four of the small plastic ribbed shank rivets (item #24). (See illustration 1-23).

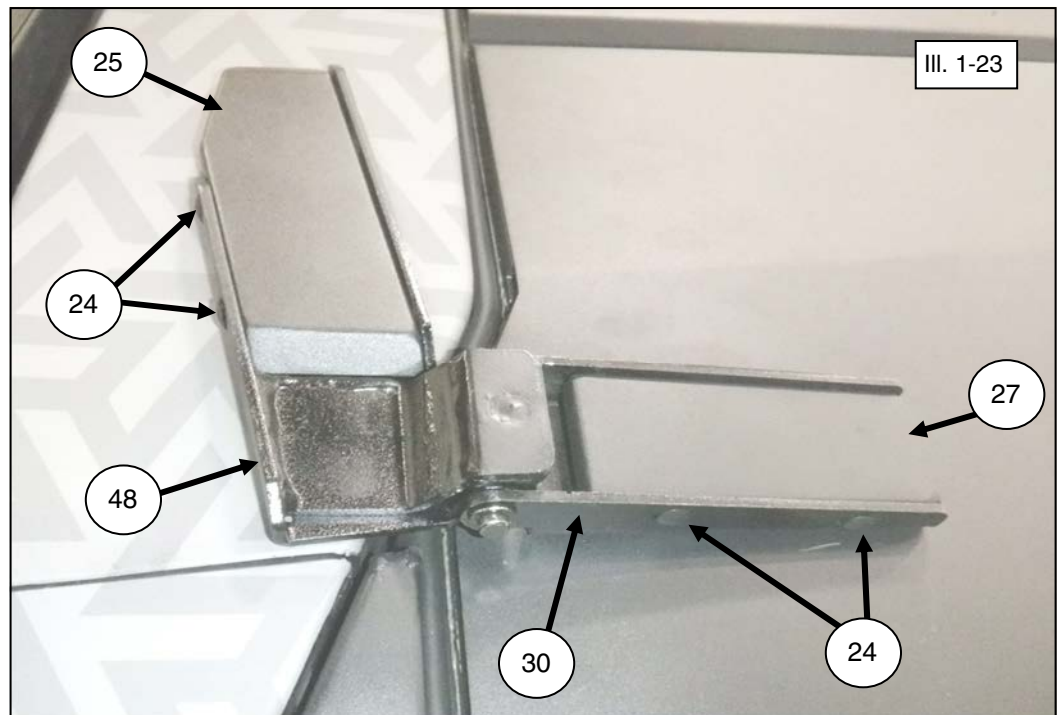
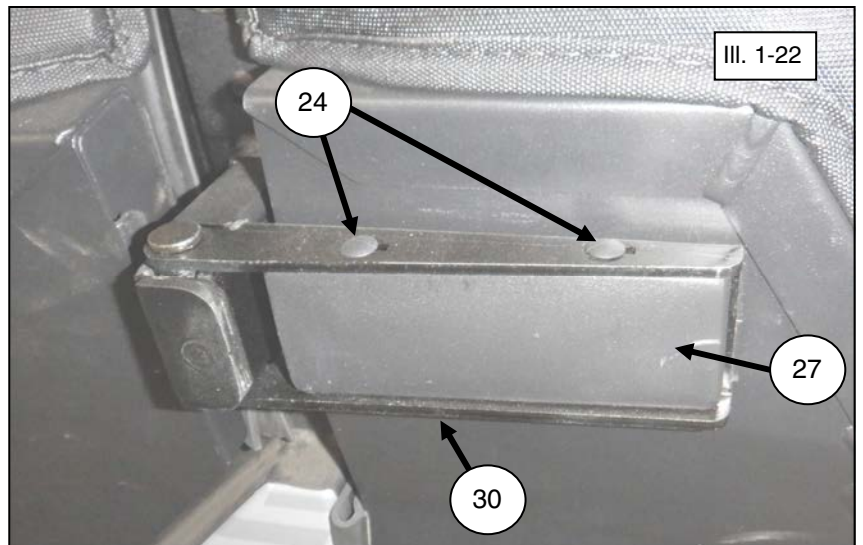
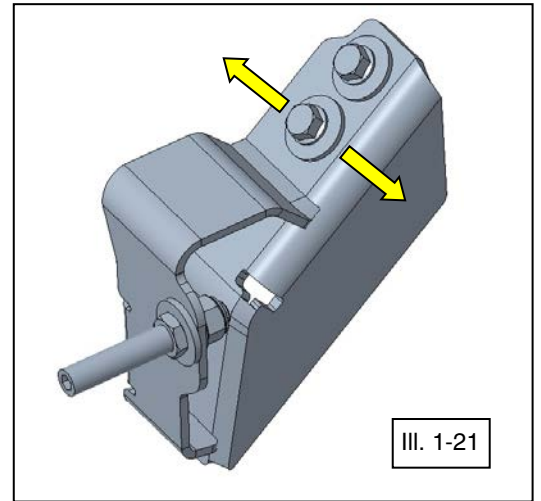

RANGER CREW REAR DOOR INSTALLATION (continued):

21. Install LH door limiter strap (item #10) by feeding strap through opening slot in door frame, looping through steel slider. Then remove M8 screw and re-tighten screw by inserting thru strap grommet hole as shown. (See illustration 1-24).



ITEM #14 M8 FASTENER TORQUE:
17 ft. lbs. (23.0 Nm)

22. Repeat steps 2-21 for RH Door Vehicle-Side Hinges, RH Door and RH Striker Bracket. **Note, RH Striker Bracket (item #9) needs to be installed under RH bolster bar as shown. (See illustration 1-25).**

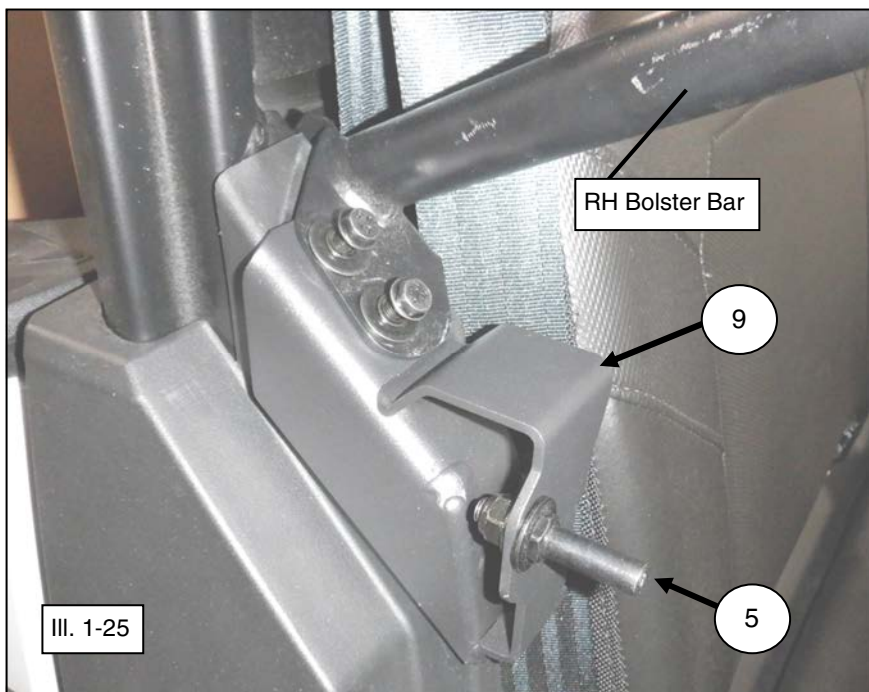
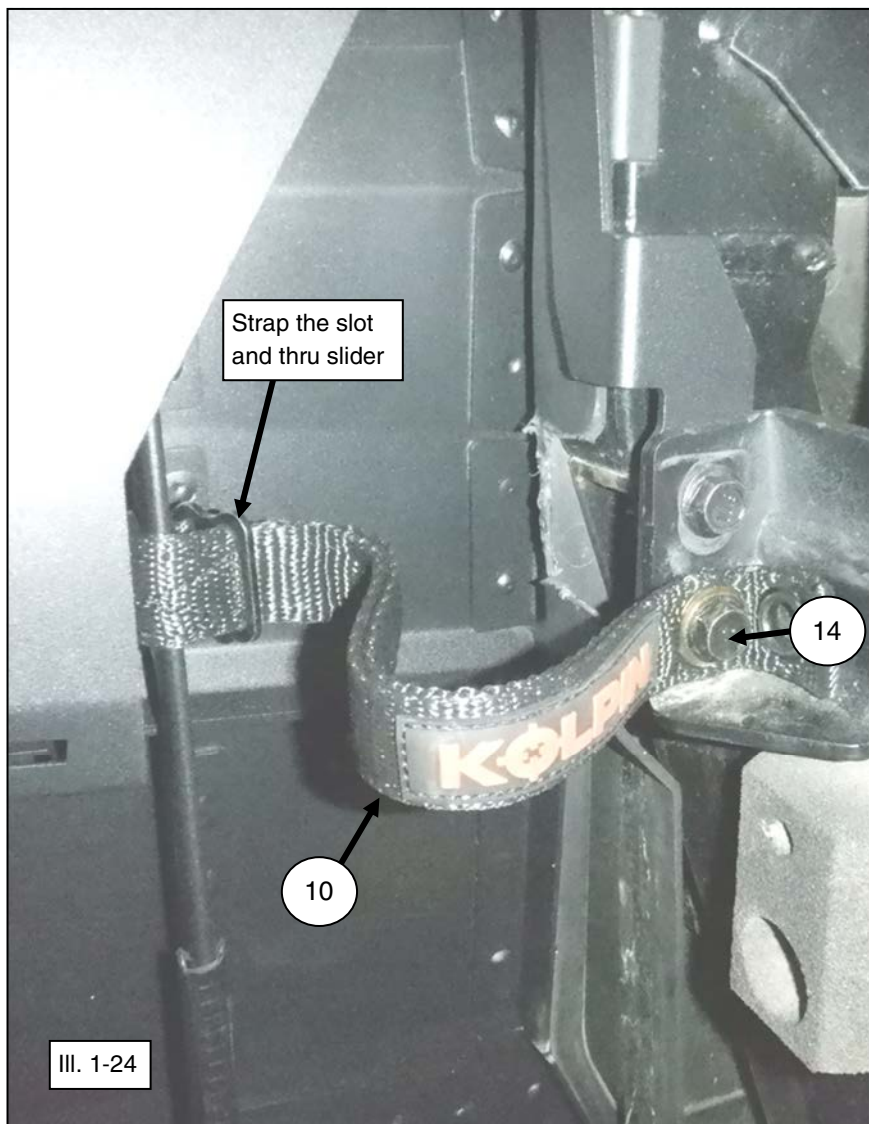

SERVICE KITS

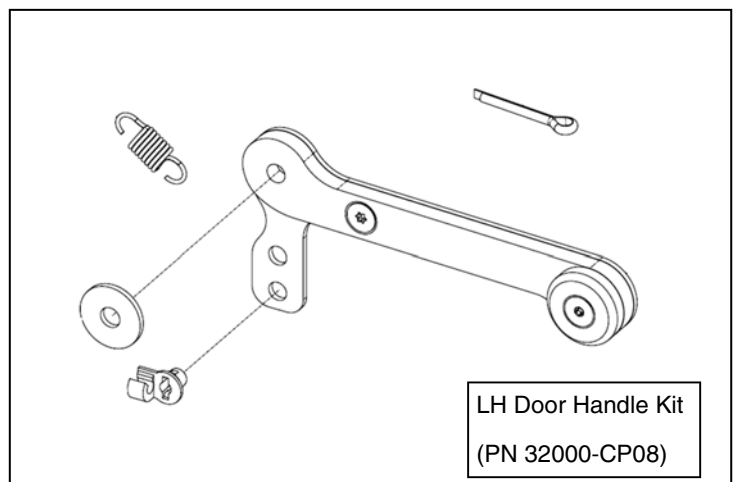
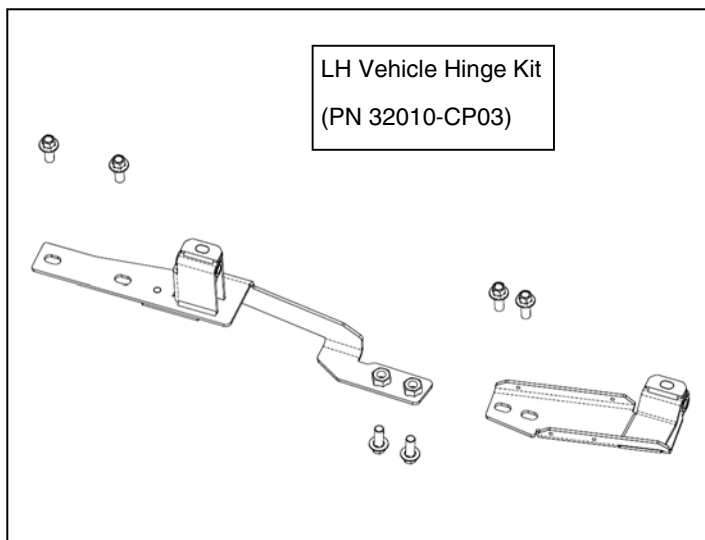
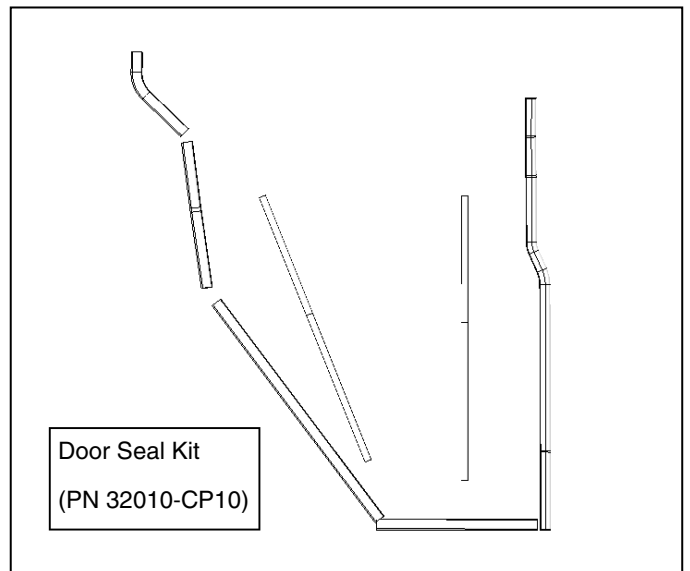
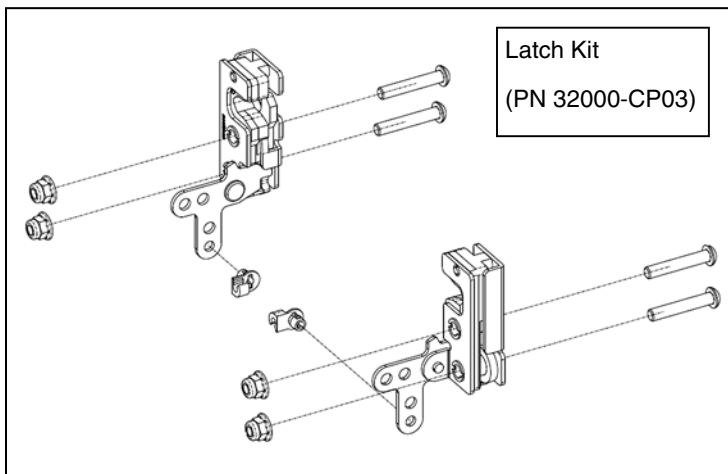
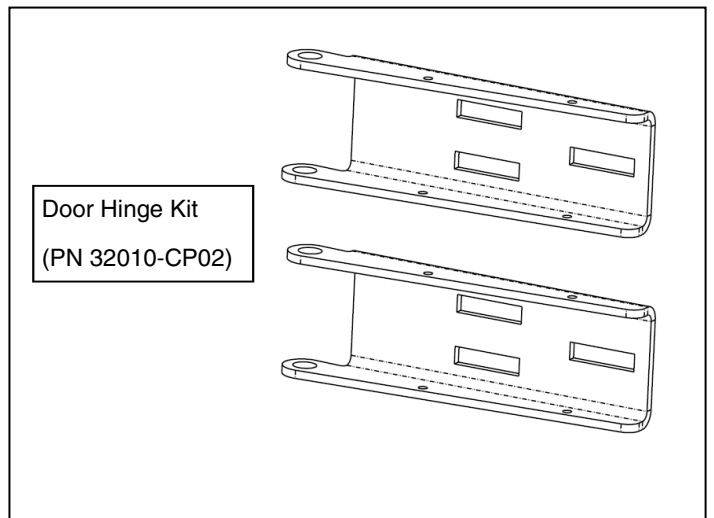
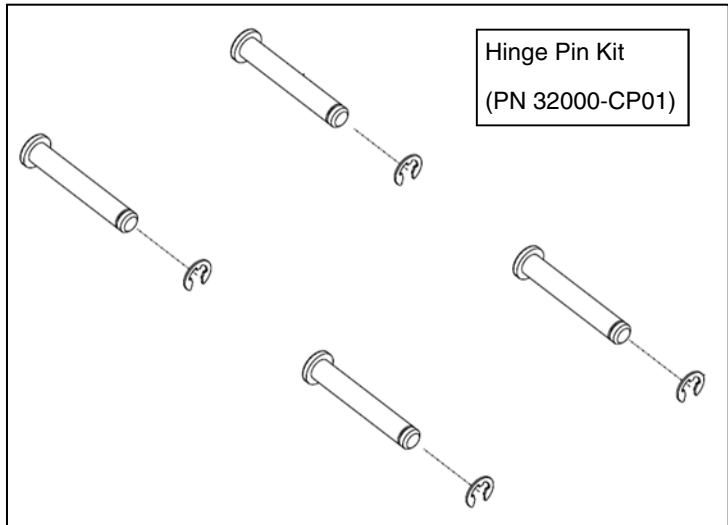

SERVICE KITS

(continued)

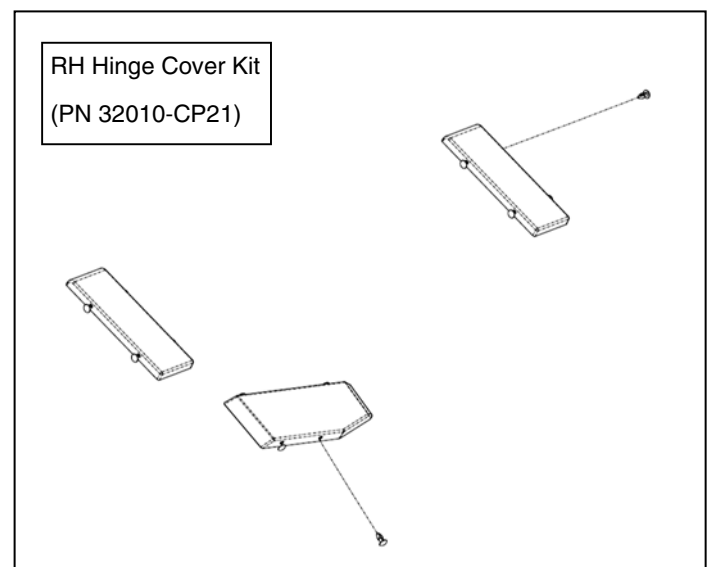
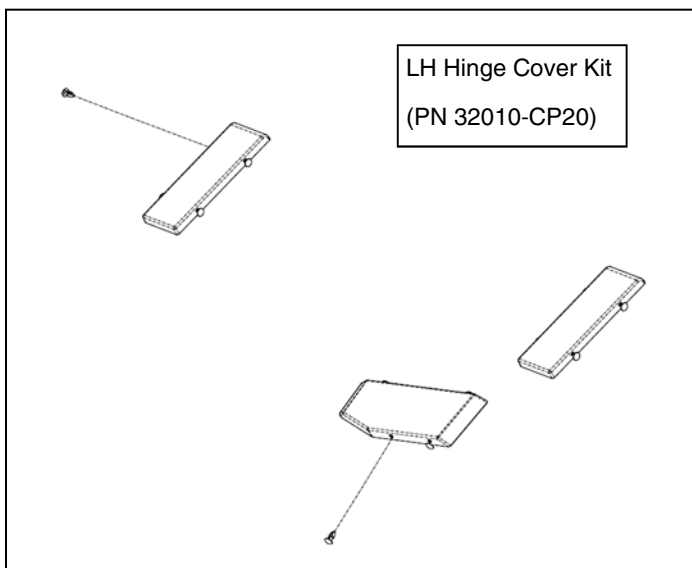
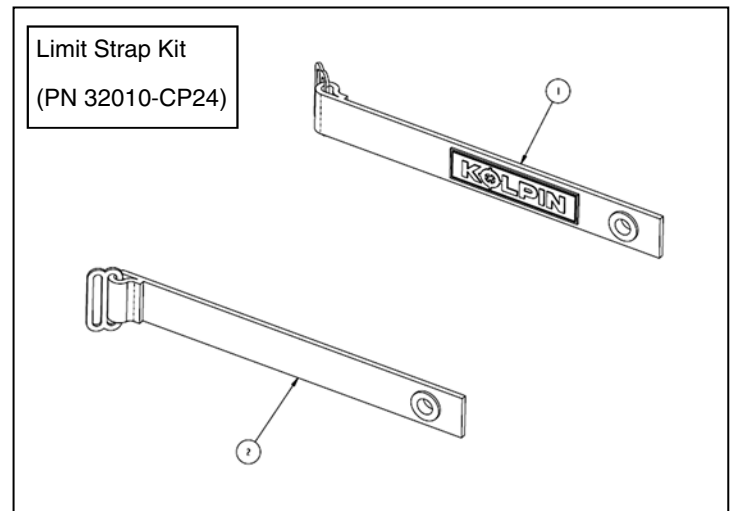
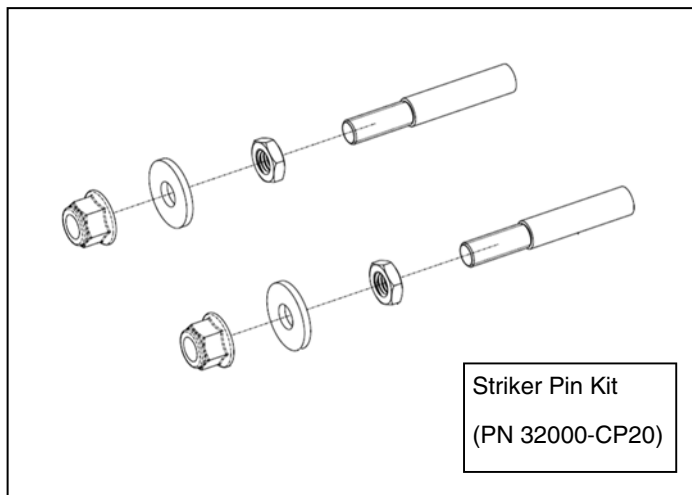
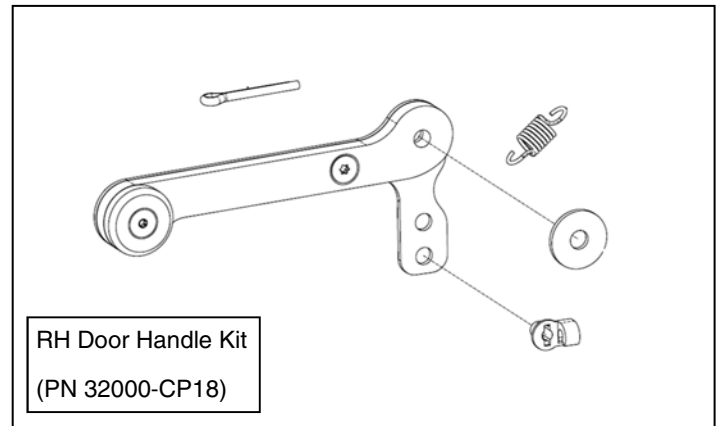
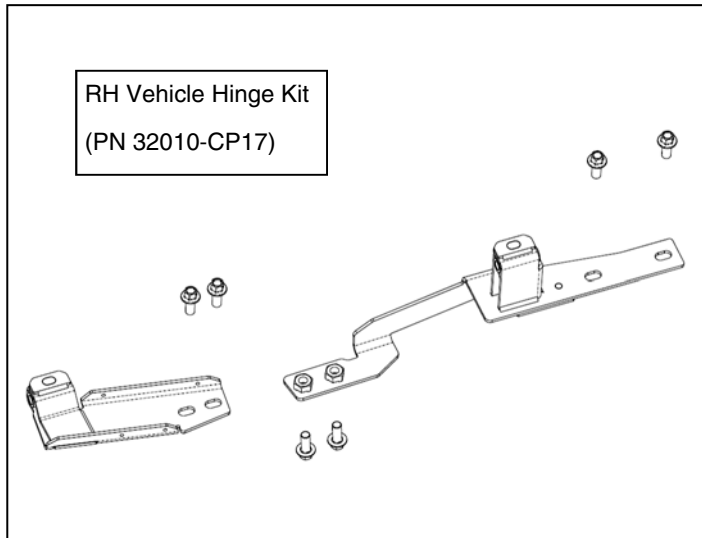

SERVICE KITS

(continued)

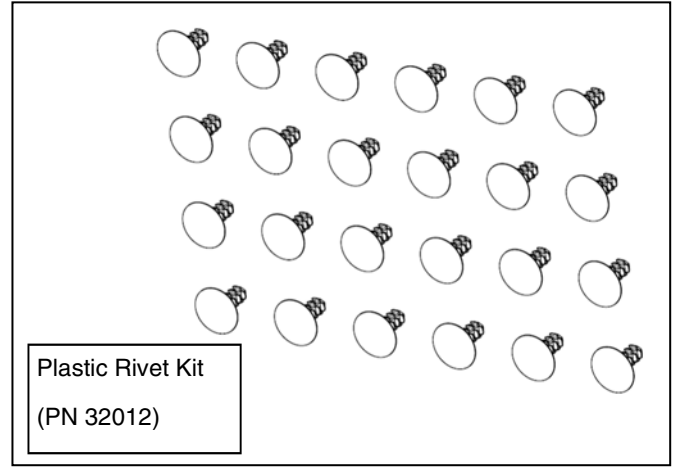
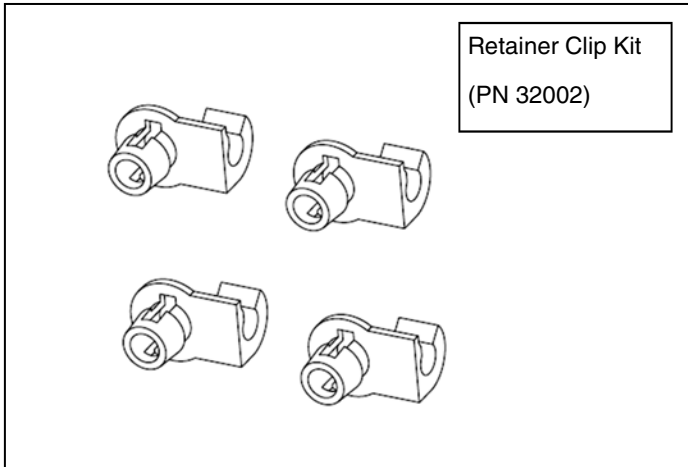

Use and Care Information:

- Grease pins on upper and lower hinges using Polaris All Season Grease (or equivalent).
- Check the accessory mounts frequently and retighten hardware if necessary.
- Replace this accessory with a new one if it is damaged.
- Never use petroleum solvents such as gasoline, thinner, benzene, acid or alkaline cleaners.

For additional assistance, please contact Kolpin customer service department at (877) 956-5746 or (763) 478-5800 or email customerservice@kolpin.com

One Year Limited Warranty

For the period of one (1) year from the purchase date, Kolpin will replace for the original purchaser, free of charge, any part or parts found upon examination by Kolpin to be defective in material, workmanship, or both.

All transportation costs incurred submitting product to Kolpin for warranty consideration must be borne by the purchaser. If Kolpin determines that the product must be returned to the factory for credit, please call 1-877-956-5746 for a Return Merchandise Authorization (RMA) number and shipping instructions.

This warranty does not apply to parts that have been damaged by accident, alteration, abuse, improper maintenance, normal wear, or other causes beyond the manufacturer's control. In order to protect you and your ATV, certain parts of the accessory system and/or hardware are designed to fail when the equipment is over-stressed. Parts that are lost due to loosening and improper maintenance are not covered under warranty. This warranty does not cover removal or reinstallation labor fees of the door system and related components.

Peripheral products such as engines, electric motors, and actuators may carry an original manufacturer's warranty. Most hardware is general in nature and is easily obtained locally. Be sure to replace with minimum metric class 8.8 specification.