

MAINTENANCE PROCEDURES ENGINE OIL LEVEL

Engine **MUST BE AT FULL OPERATING TEMPERATURE** when checking oil level.

1. With the motorcycle in an upright (vertical) position, run the engine for several minutes until operating temperature is reached.
2. Stop engine and wait for 1–2 minutes.
3. Place the machine on a level area and hold it in an upright (centered) position.
4. Remove and clean the oil off of the dipstick ①.

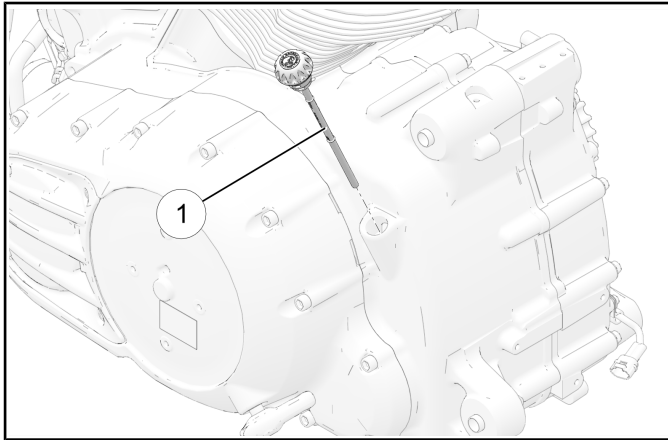

5. Screw the dipstick in until seated.
6. Remove dipstick and view oil level.

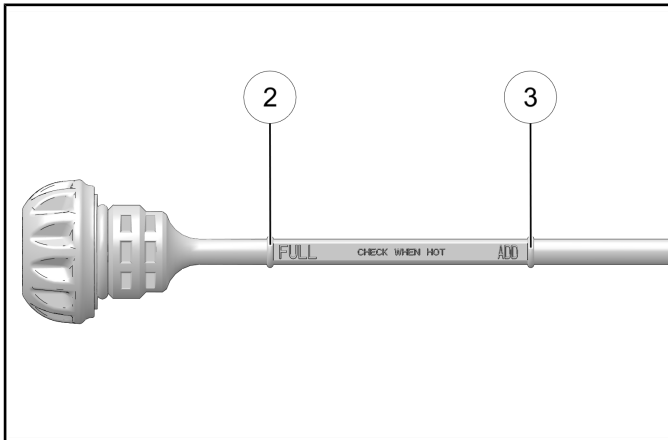

7. Oil level should be between ADD ③ and FULL ② lines on dipstick. If oil level is low, add Indian Motorcycle 20W-40 engine oil and repeat steps 1–6 until the reading is within the safe operation range.

Be careful not to overfill! Approximate volume from ADD to FULL is 1 qt (.95 L).

CAUTION

Oil level will **NOT** be accurate if checked on a cold engine. **DO NOT ADD** oil to bring to FULL mark on a cold engine, as this can result in overfilling.

2

ENGINE OIL & FILTER CHANGE

Engine **MUST BE WARM** while performing the following procedure.

WARNING

HOT COMPONENTS Wear insulated gloves and/or allow engine and exhaust to cool before handling these parts.

1. Start and run the engine until it reaches normal operating temperature. Stop the engine.
2. Securely support the motorcycle in an upright (vertical) position.
3. Place an oil drain pan under both the SCAVENGE ① and STORAGE ② drain plugs.

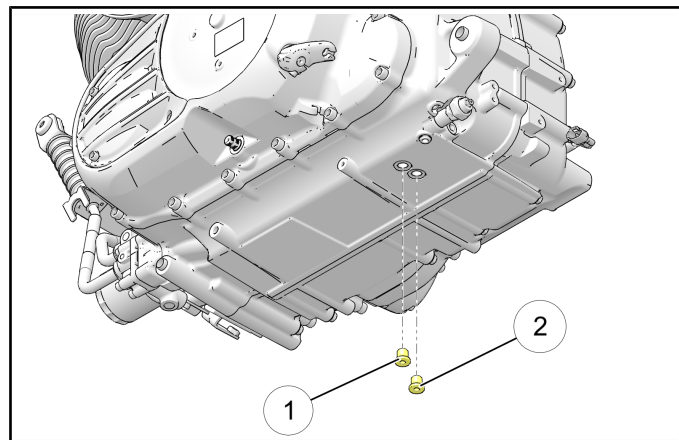

4. Remove both drain plugs and sealing washers.
5. Allow oil to drain completely.
6. Remove oil filter, drain and dispose of oil and filter properly.
7. Clean the oil filter sealing surface and surrounding area.
8. Place a small amount of oil on the seal of the new filter and spin on until the filter seal contacts the sealing surface. Tighten oil filter to specification.

TORQUE

Oil Filter: **Approximately 3/4 turn after seal has contacted the filter adapter.**

MAINTENANCE

9. Use new sealing washers and reinstall both drain plugs. Torque to specification.

TORQUE

Scavenge and Storage Drain Plugs: **15 ft-lbs (20 Nm)**

10. Remove dipstick / filler cap and wipe clean, then using a funnel, install 4.5 US quarts of Indian Motorcycle 20W40 engine oil.

NOTE

4.5 US quarts is an acceptable amount of oil to run the engine for the initial check.

11. With the motorcycle in an upright, centered position, start engine and run at varied speeds to 2500 RPM for approximately 3 minutes.
12. Shut engine OFF and add approximately 1.0 US quarts of Indian Motorcycle 20W40 engine oil. **DO NOT OVERFILL!**

IMPORTANT

Total fill with oil filter change will be approximately 5.5 US quarts.

13. Refer to the Checking Engine Oil section in this chapter for setting proper oil level.

CAUTION

If the low oil pressure indicator remains illuminated longer than usual after an oil change, do not increase RPM above idle until indicator lamp goes out or engine may be damaged.

14. Check for leaks around drain plug and oil filter.

NOTE

Recycle used oil and oil filter in accordance with local regulations.
