

ENGINE - 325

ENGINE OIL LEVEL CHECK - 325

Access the oil dipstick and fill tube from the right side of the vehicle. A rising oil level between checks in cool weather driving can indicate contaminants such as gas or moisture collecting in the crankcase. If the oil level is over the full/safe mark, change the oil immediately.

IMPORTANT

Allowing dirt or debris to enter the engine can result in serious engine damage. Always clean away all dirt and debris from the dipstick area before removing the dipstick.

1. Position the vehicle on a level surface.
2. Place the transmission in PARK.
3. Always clean away all dirt and debris from the area around the dipstick and fill cap before removing. Remove the dipstick. Wipe it dry with a clean cloth.

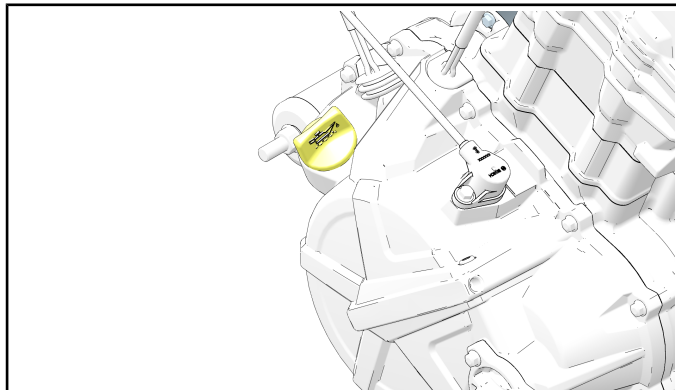

4. Reinstall and tighten the dipstick.
5. Remove the dipstick and check the oil level.

6. Add the recommended fluid as needed to the upper oil fill . Maintain the oil level in the safe range between the FULL and ADD marks. Do not overfill.

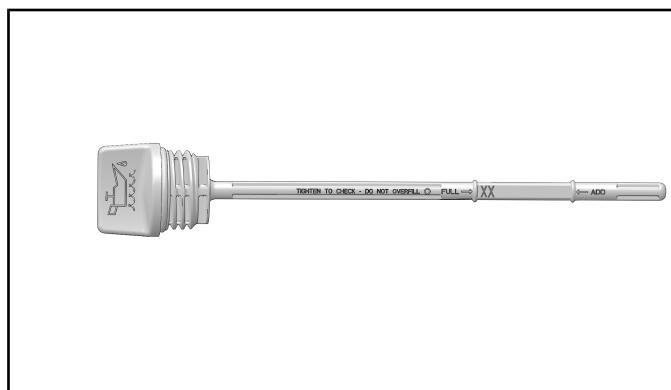
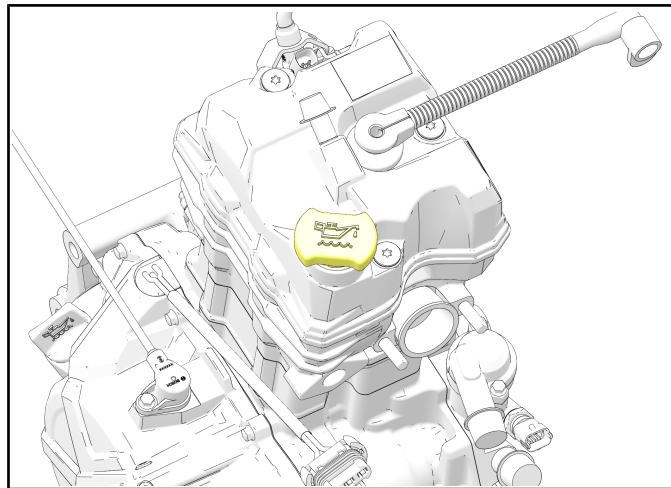

7. Reinstall and tighten the dipstick.

NOTE

Rising oil level between checks in cool weather driving, can indicate moisture collecting in the oil reservoir. If the oil level is over the full mark, change the oil.

MAINTENANCE

ENGINE OIL AND FILTER CHANGE - 325

Always change the engine oil when engine is at operating temperature.

1. Position the vehicle on a level surface. Place the transmission in PARK.
2. Start the engine. Allow it to idle for two to three minutes. Stop the engine.
3. Clean the area around the drain plug.

CAUTION

Hot oil can cause burns to skin. Do not allow hot oil to contact skin.

4. Place a drain pan beneath engine crankcase at the rear of the vehicle and remove the drain plug (item 1) / sealing washer (Item 2).

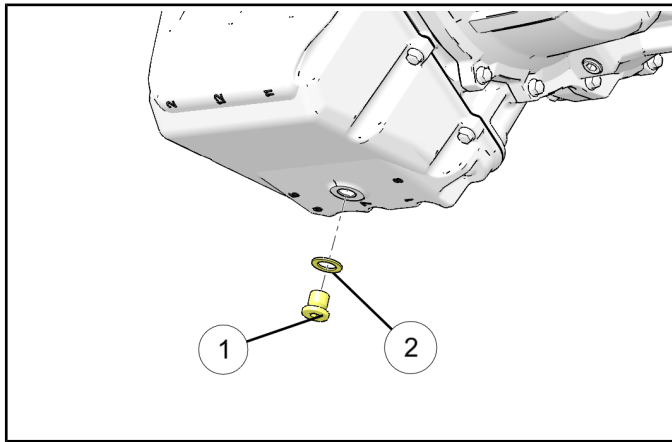

5. Allow the oil to drain completely.
6. Install a new sealing washer (item 2) onto the drain plug (item 1).

NOTE

The sealing surfaces on drain plug and crankcase should be clean and free of burrs, nicks or scratches.

7. Reinstall the drain plug (item 1). Torque to specification.

TORQUE

Oil Pan Drain Plug:
12 ft-lb (17 Nm)

8. Using a clean dry cloth, clean the oil filter cover (item 5) and surrounding area on the crankcase.
9. Place shop towels beneath the filter cover to catch oil drips. Remove the cover screws (item 3).

10. Remove the cover (item 5). The oil filter (item 6*) may or may not come out with the cover. If the filter stays inside the engine, pull it out after removing the cover.

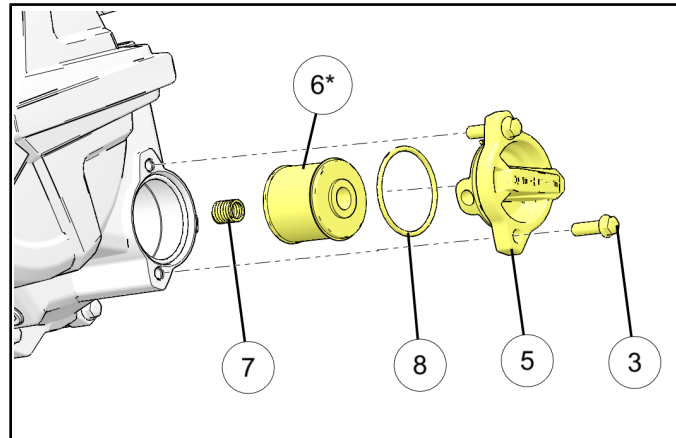

11. Using a clean dry cloth, clean the surface of the crankcase.

12. A spring (item 7) is located inside the oil filter cavity. It may or may not come out with filter. If it comes out with the filter, reinstall it over the fitting (item 9).

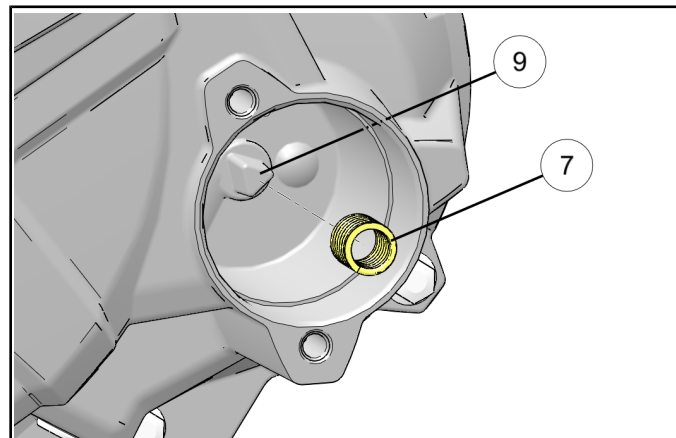

13. Properly dispose the used oil filter. Inspect the cover (Item 4) O-ring (Item 3). Replace if worn or damaged. Note the orientation text on the new oil filter (Item 2) as shown. The oil filter must be installed correctly to prevent severe engine damage.

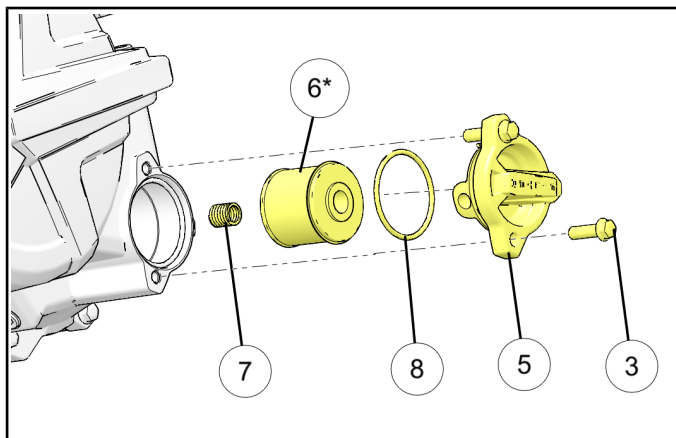

IMPORTANT

Oil flows through the filter and into the cover. Keep cover ports free from foreign material.

14. Verify the oil filter spring is installed inside the filter cavity. Lubricate the O-ring with clean engine oil.
15. Install the new oil filter onto the cover fitting in the correct orientation. Install the filter/cover assembly into the bore. Torque the screws to specification.

TORQUE

Oil Filter Cover:
88 in. lbs. (10 Nm)

16. Fill the sump with 1.75 quarts (1.65 l) of the recommended oil.
17. Reinstall the upper fill cap (if removed) and tighten the dipstick.
18. Make sure the transmission is in PARK. Apply the brakes.
19. Start the engine. Allow it to idle for one to two minutes.
20. Stop the engine. Inspect for leaks.

NOTE

Re-check the oil level on the dipstick and add oil as necessary to bring the level to the upper mark on the dipstick.

21. Dispose of used filter and oil properly.