

TINTED WINDSHIELD KIT



SLINGSHOT

P/N 2882154

APPLICATION

Slingshot; Base, SL and LE Models

BEFORE YOU BEGIN

Read these instructions and check to be sure all parts and tools are accounted for. Please retain these installation instructions for future reference and parts ordering information.

KIT CONTENTS

This Kit includes:

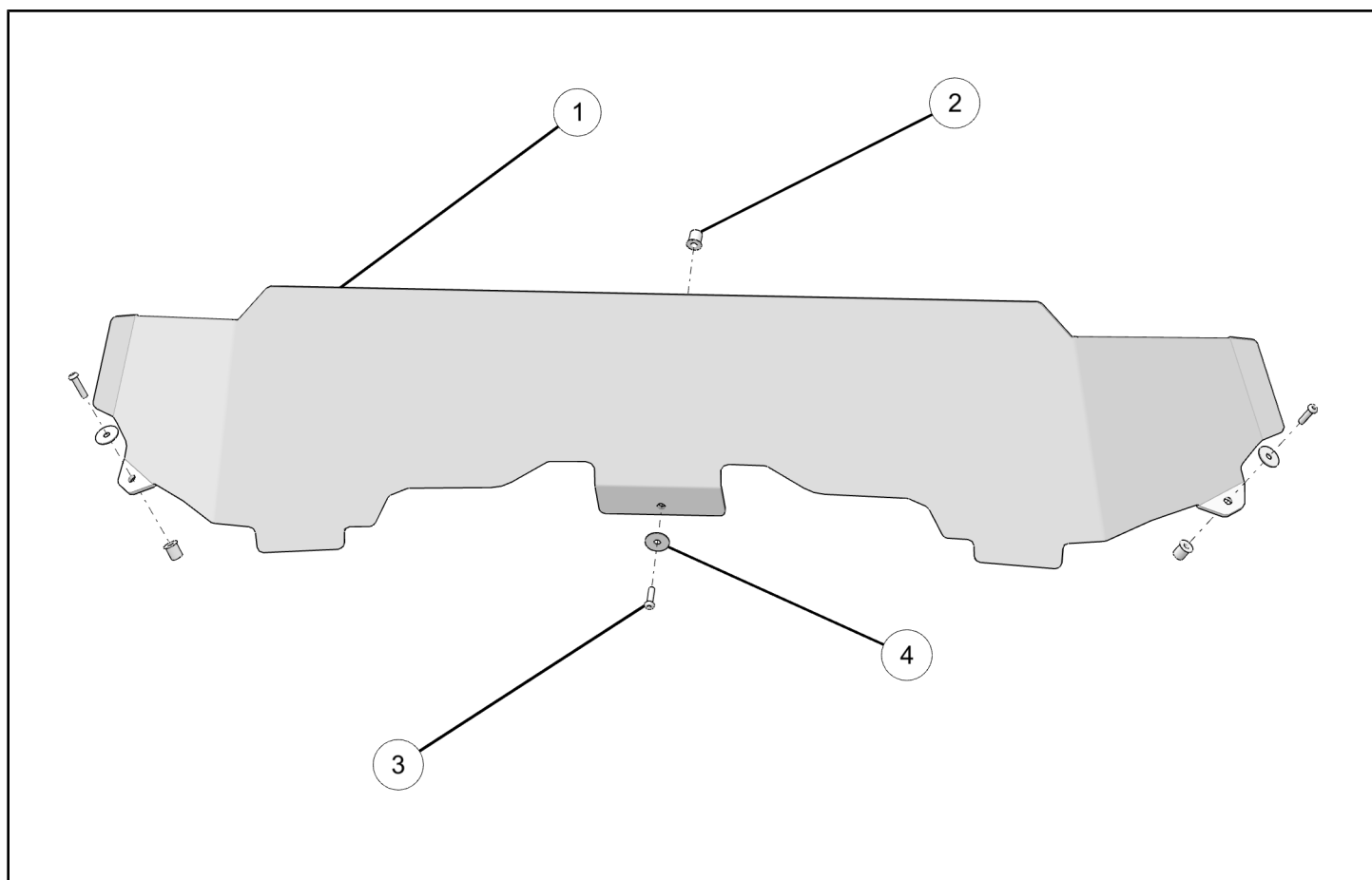

REF	QTY	PART DESCRIPTION	PART NUMBER
1	1	Tinted Windshield	5452973
2	3	Wellnut - M6 X 1.0	7547772
3	3	Screw - M6 X 1.0 X 25	7520236
4	3	Washer - M6 X 1.0	7556879
	1	Instructions	9927307

TOOLS REQUIRED

- Safety Glasses
- Metric Torx® T30 and 5mm Hex Bit
- Drill with 12.5mm Drill Bit
- Marker/Pencil

IMPORTANT

Your TINTED WINDSHIELD KIT is exclusively designed for your vehicle. Please read the installation instructions thoroughly before beginning. Installation is easier if the vehicle is clean and free of debris. For your safety, and to ensure a satisfactory installation, perform all installation steps correctly in the sequence shown.

ASSEMBLY TIME

Approximately 30 minutes

INSTALLATION INSTRUCTIONS

1. Park the vehicle on a level surface. Turn the key to "OFF" position and apply the parking brake.
2. Open the hood (A) using the latch (B) located in the front of vehicle between the middle set of lights. Pull rearward and up to get the hood to open.

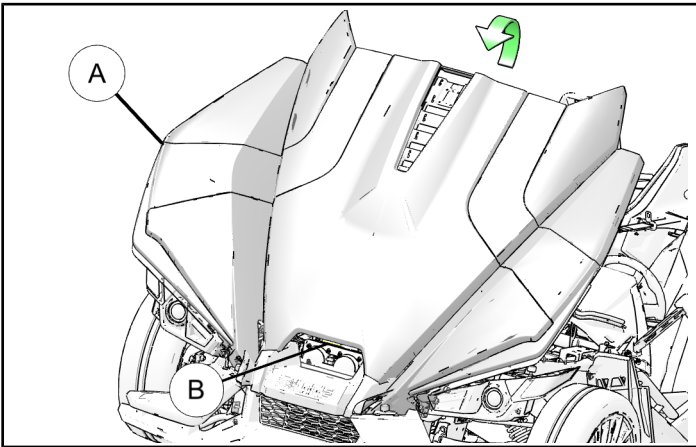

3. Press two wellnuts ② into driver and passenger side main visor panel holes (C) as shown.

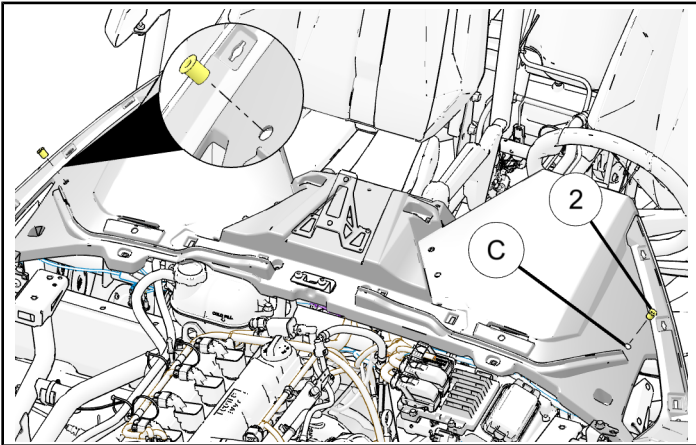

4. Install tinted windshield ① by first engaging the tab and slot in the front then aligning the mounting holes on windshield and main visor.

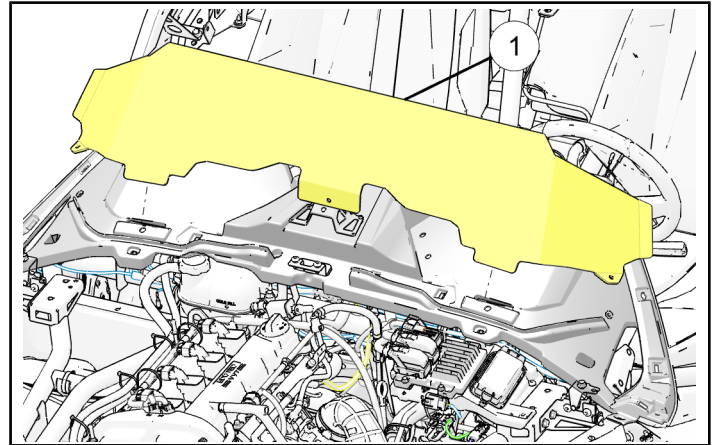

5. Mark the location of center hole in the front of the windshield with a marker/pencil. Remove windshield from vehicle. Drill hole in the marked area using 12.5mm drill bit. Insert third wellnut ② into this center hole.

NOTE

Before drilling, wrap electrical or painter's tape around drill bit at 0.5 inch depth and use this as a depth gauge.

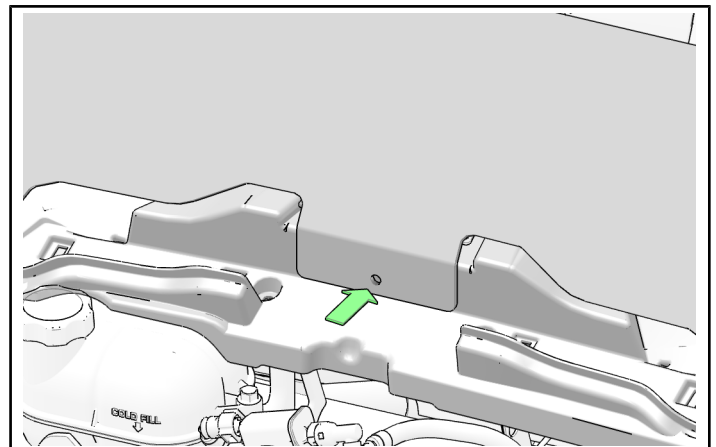

6. Reinstall windshield ① by engaging tab and slot in the front and aligning three holes on windshield. Install screw ③ and washer ④ onto the windshield. Torque screws to specifications.

TORQUE

7±1 ft. lbs. (9.49±1.36 Nm)

