

BEACON KIT



P/N 2884609

BEFORE YOU BEGIN

Read these instructions and check to be sure all parts and tools are accounted for. Please retain these installation instructions for future reference and parts ordering information.

REQUIRED, SOLD SEPARATELY

This kit only contains parts for installation of the Beacon Kit. Prior installation of a Roof Kit is also required (sold separately).

KIT CONTENTS

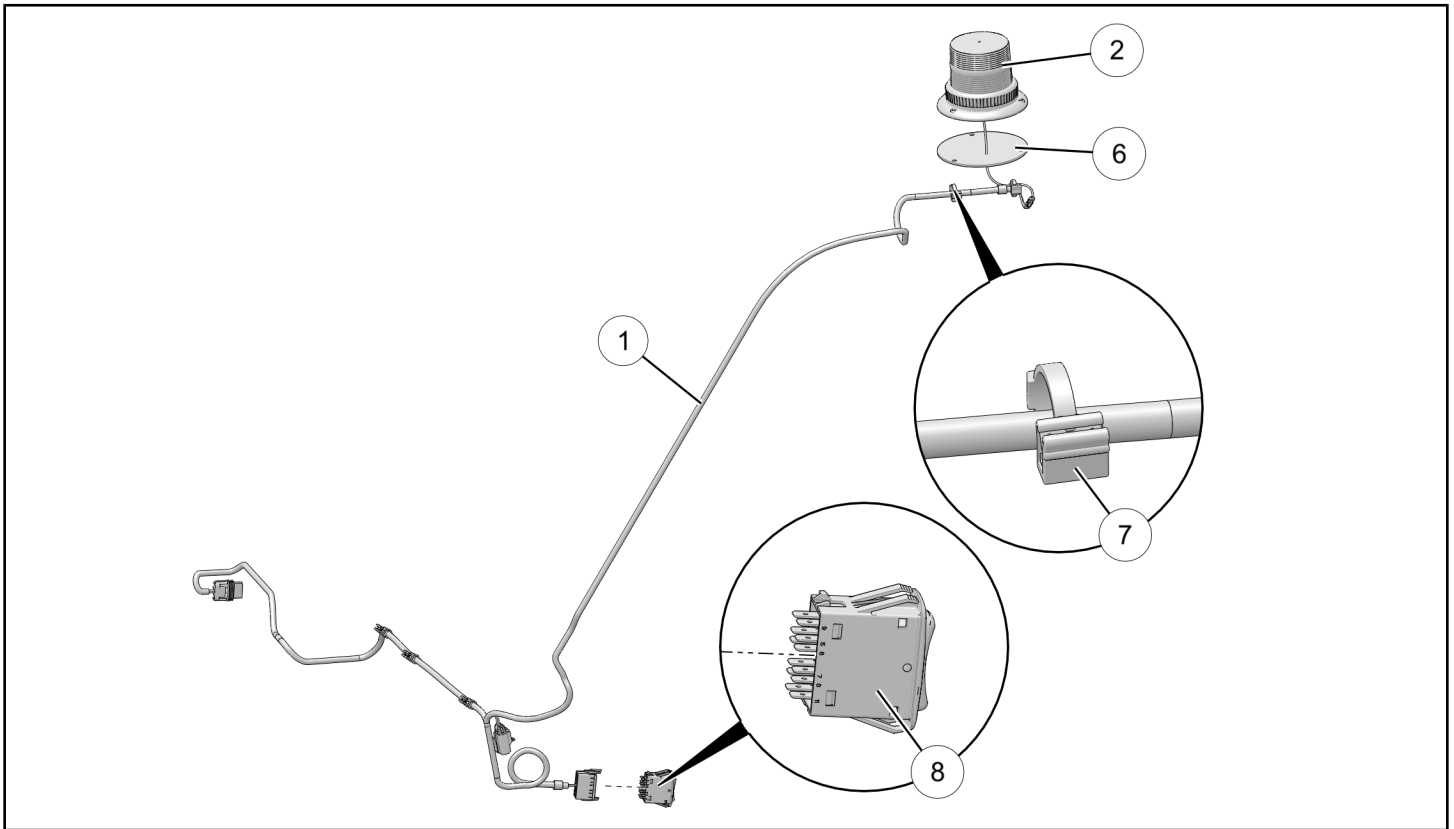

REF	QTY	PART DESCRIPTION	PART NUMBER
1	1	Harness, Electrical	2415403
2	1	Beacon	2413089
3	3	Screw (not shown)	-
4	3	Washer (not shown)	-
5	3	Nut (not shown)	-
6	1	Seal	5814874
7	2	Clip, Edge	7082403
8	1	Switch	4017127
9	1	Cable Tie, 11 inch (not shown)	7080492

TOOLS REQUIRED

- Safety Glasses
- Awl/Ice Pick (or equivalent)
- Cutting Tool
- Deburring Tool
- Drill
- Drill Bit: 1/4 inch (6 mm), 3/8 inch (10 mm)
- Pliers, Push Pin Rivet
- Push Dart (Panel Clip) Tool
- Ruler
- Scissors
- Screwdriver, Phillips
- Screwdriver Set, Torx®
- Socket Set, Metric
- Wrench Set, Metric

IMPORTANT

Your Beacon Kit is exclusively designed for your vehicle. Please read the installation instructions thoroughly before beginning. Installation is easier if the vehicle is clean and free of debris. For your safety, and to ensure a satisfactory installation, perform all installation steps correctly in the sequence shown.

HARNESS DETAIL

HARNESS ①:

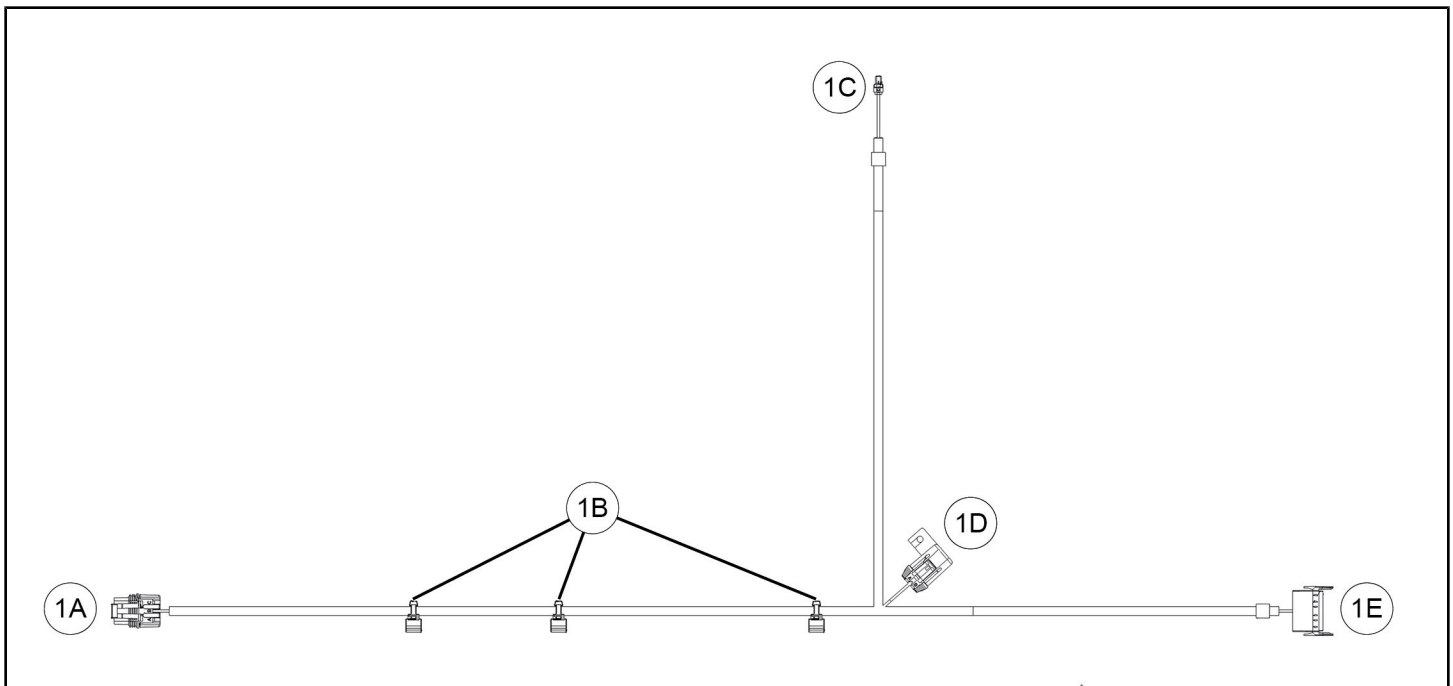

REF	PART DESCRIPTION	WIRE COLOR	PIN QTY/ GENDER	CONNECTS TO
1A	Connector, Terminal Block	-	3 female	Pulse® Busbar
1B	Clip, Edge	-	-	Vehicle structure
1C	Connector, Light (identified as: BEACON)	-	2 female	Light ②
1D	Fuse Block	-	-	Vehicle structure
1E	Connector, Switch (identified as: BEACON SWITCH)	-	12 female	Switch ⑧

INSTALLATION INSTRUCTIONS

NOTE

Installation on *RANGER* vehicle shown; installation on other vehicles similar.

VEHICLE PREPARATION

DISCONNECT BATTERY

1. Shift vehicle transmission into "PARK". Turn ignition switch to "OFF" position and remove key.

⚠ WARNING

Ensure red positive (+) battery terminal is **COMPLETELY COVERED** by protective boot. Accidental tool contact across both battery terminals will result in high current electrical arc, and may result in battery explosion. Death or serious personal injury may occur.

2. Flip up passenger seat bottom (**CREW VEHICLES**: right rear passenger seat bottom) and remove underseat storage compartment. Disconnect black negative (-) cable from battery.

INITIAL STEPS

CREW VEHICLES: If REAR roof liner is installed, then remove fasteners from front edge as required to enable removal of FRONT liner.

NOTE

Only front liner needs to be fully removed. Next section shows liner removal for non-crew vehicles; crew vehicle similar.

REMOVE ROOF LINER

1. Remove optional (roof mounted) speakers and/or dome light, if installed.
2. Remove seven push darts (A), two from rear edge and five from front edge. Retain push darts.

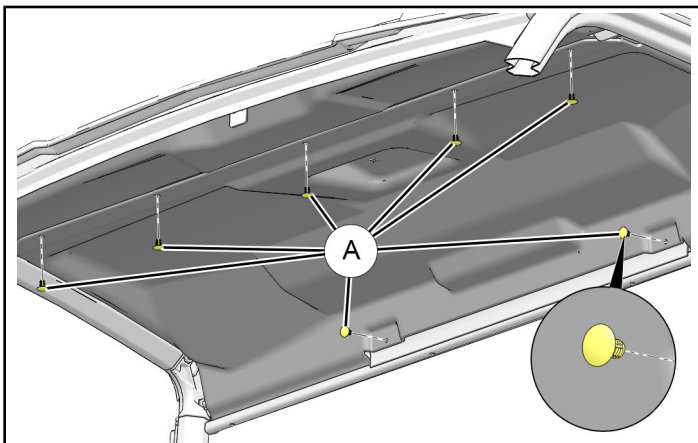

3. Remove two each screws (B) and washers (C) (if installed).

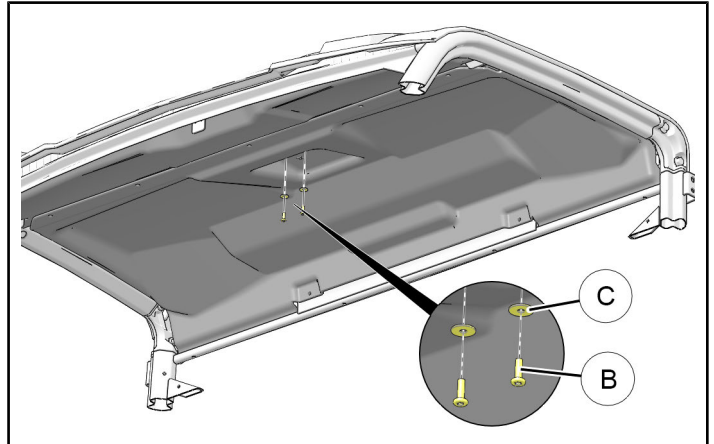

4. Carefully pull LH and RH edges of liner from between ROPS and roof seal, then remove rear edge of liner from roof support channel (D).

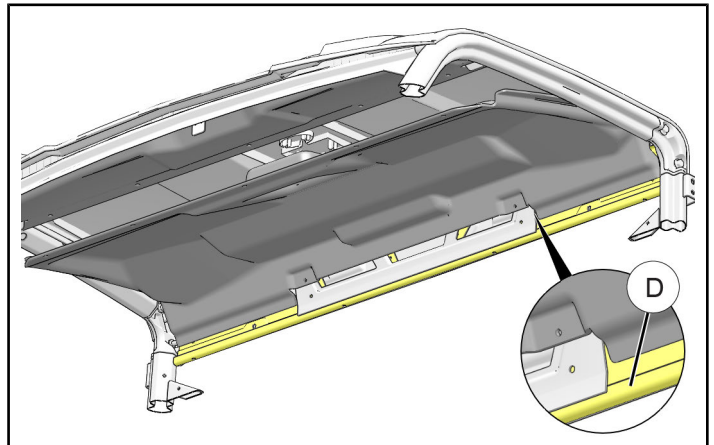

UPPER DASH ACCESS

1. Remove hood.
2. If windshield is installed, then open or remove it as required to gain access to upper dash.
3. Remove upper dash cupholder by removing two push pin rivets (A), then slide cupholder rearward. Retain rivets.

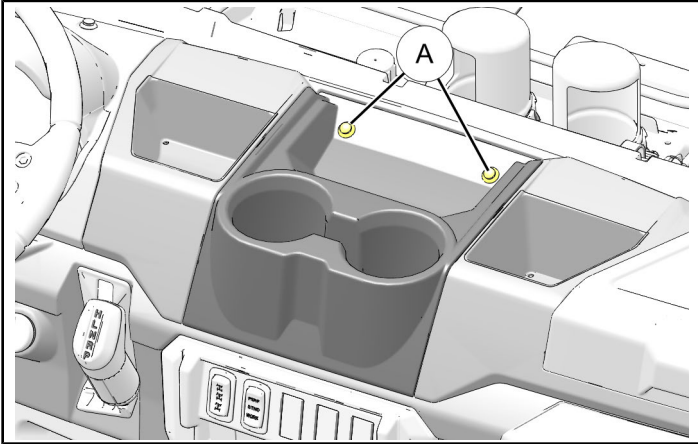

4. Tilt steering wheel to full down position. Detach instrument cluster hood by removing two push pin rivets (B), then slide hood (with instrument cluster) rearward. Disconnect instrument cluster wiring harness. Retain rivets.

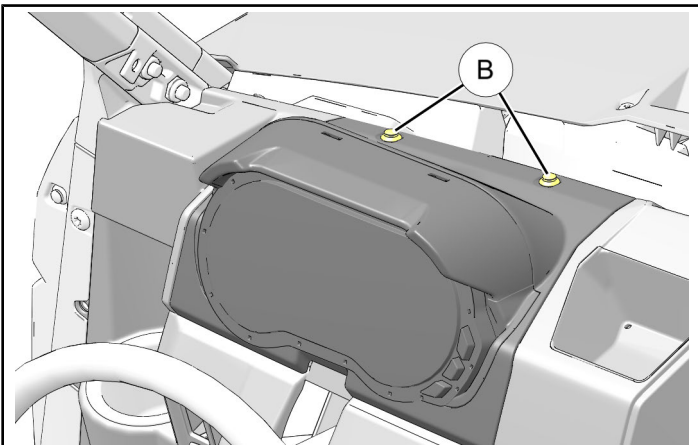

ACCESSORY INSTALLATION

NOTE

Installation on *RANGER* vehicle shown; installation on other vehicles similar.

INSTALL HARNESS AND SWITCH

NOTE

See previous section, **HARNESS DETAIL**, for connector identification.

1. Verify clearance on forward side of dash panel at location of rectangular switch blank (A), then carefully cut opening from main dash panel. Debur edges as required.

IMPORTANT

Control tool depth to prevent damage to underlying structure, components, wiring, lines, ducts, etc.

NOTE

Any open location may be used.

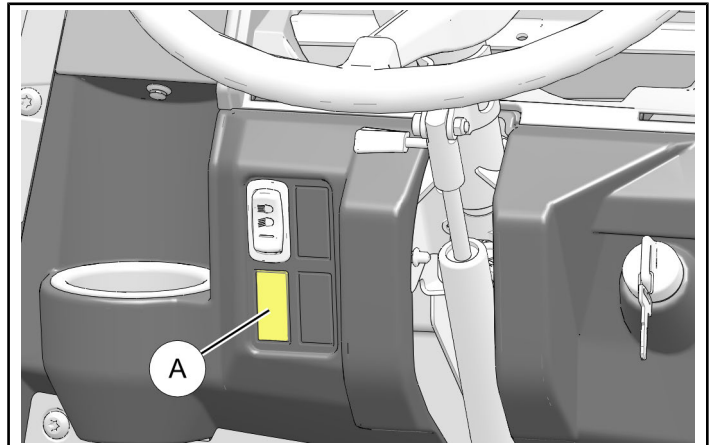

2. Starting from within instrument cluster opening route connector 1A on harness (1) towards center of vehicle, then forward through accessory firewall grommet (B).

Ensure harness is routed to prevent contact with hot components, sharp edges, or moving parts, but do not secure harness at this time.

NOTE

Final connector, harness, and edge clip locations shown for reference.

Steering system hidden for clarity.

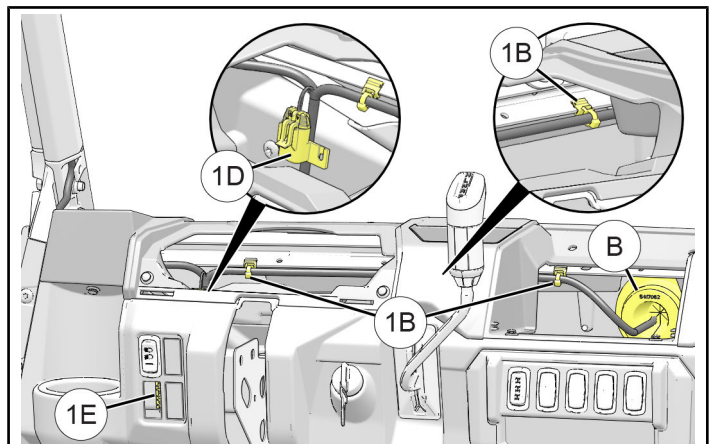

- Remove cap from any open power port on Pulse® terminal block, then plug in connector 1A.

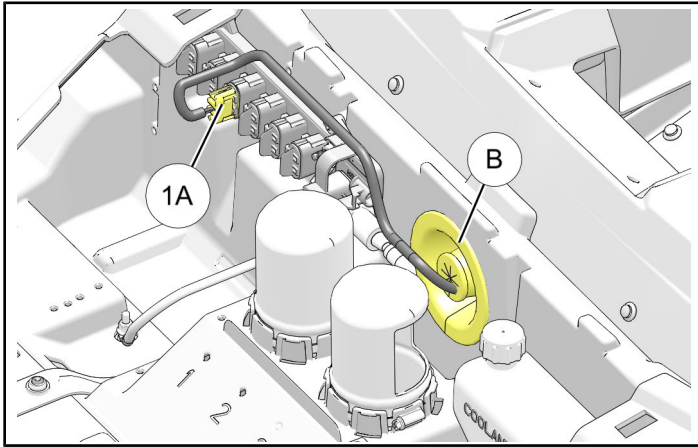

- Install switch ⑧ to main dash panel, locking upper and lower switch tabs to panel.

Ensure connector 1E on harness ① is routed to prevent contact with hot components, sharp edges, or moving parts, then join to switch.

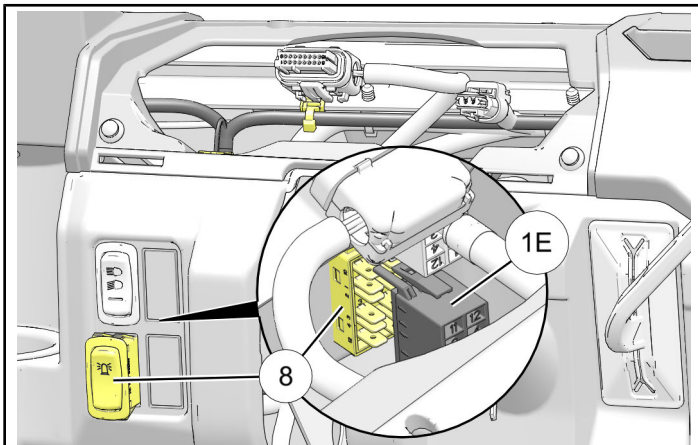

- Reaching through instrument cluster opening route connector 1C on harness ① towards LH edge of upper dash panel, then upwards towards base of A-pillar.

Feed fish tape (or equivalent) through oval hole ③ at top of A-pillar, then down and out hole ④ at base of A-pillar.

Attach harness connector 1C to fish tape, then carefully pull connector up and out top of A-pillar.

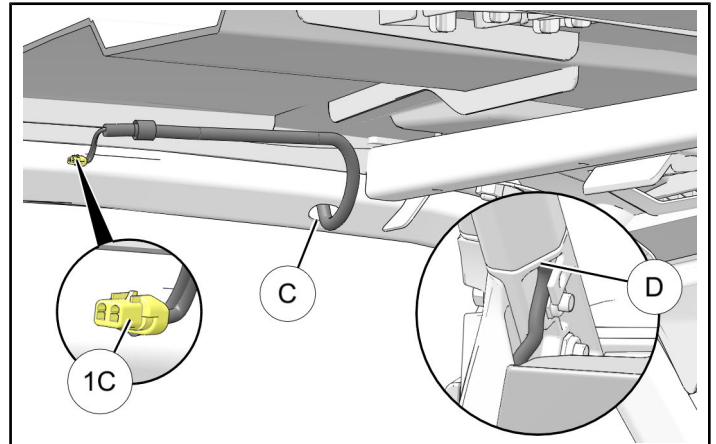

INSTALL BEACON

- Drill beacon mounting holes.
 - Detach template page located at end of this instruction.
 - Locate REFERENCE DIMENSION on template page.

Verify template was printed to proper scale by using ruler to verify REFERENCE DIMENSION is exactly 4 inches.

IMPORTANT

If your measurement is not exactly 4 inches, then reprint template page from electronic file using print setting “**Actual Size**” (not “Fit”) to obtain 1:1 scale.

Electronic file available from your **Authorized Polaris Dealer**.

- Carefully cut out template along lines near page margins. Final template will approximate a skewed rectangle (parallelogram).

IMPORTANT

Template will NOT be a circle.

- d. Secure template (A) to lower surface of roof panel, on DRIVER side, aligning all four outside edges as shown. Ensure template is oriented properly (FRONT).

IMPORTANT

If installing beacon to vehicle other than *RANGER*, then ensure location is within reach of connector 1C installed in previous section.

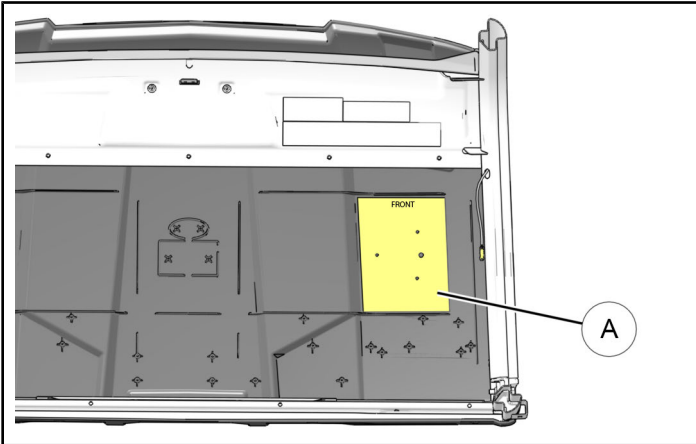

- e. Use ice pick (or equivalent) to mark center of each hole (three mounting holes, plus electrical harness hole), then remove template.
 - f. Carefully drill holes upward through roof panel at each marked location:
 - Three mounting holes: 1/4 inch (6 mm)
 - One harness passage hole: 3/8 inch (10 mm)
2. Route beacon wires downward through seal (6) and larger hole in roof panel, then install beacon (2) and seal to roof using three each screws (3), washers (4), and nuts (5). Tighten screws.

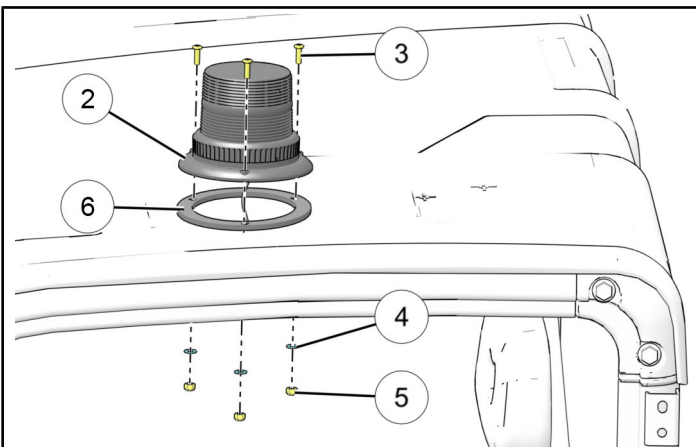

3. Join connector (B) on beacon (2) to connector 1C on harness (1), then secure harness to roof using two edge clips (7) as shown.

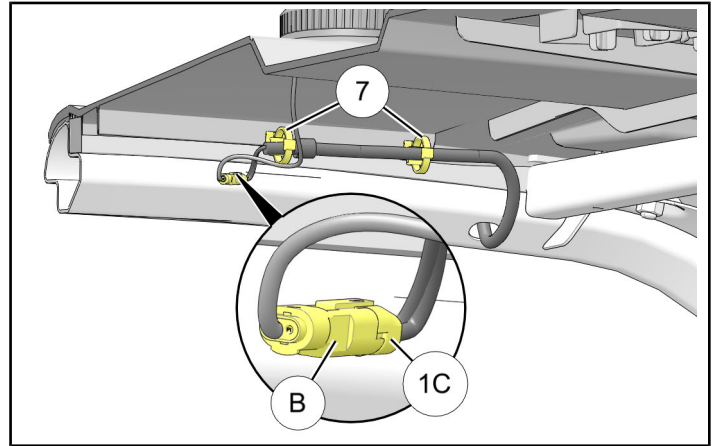

4. Ensure harness is routed to prevent contact with hot components, sharp edges, or moving parts (including steering and shift lever components throughout their full range of travel), then secure to dash support bracket using three edge clips 1B.

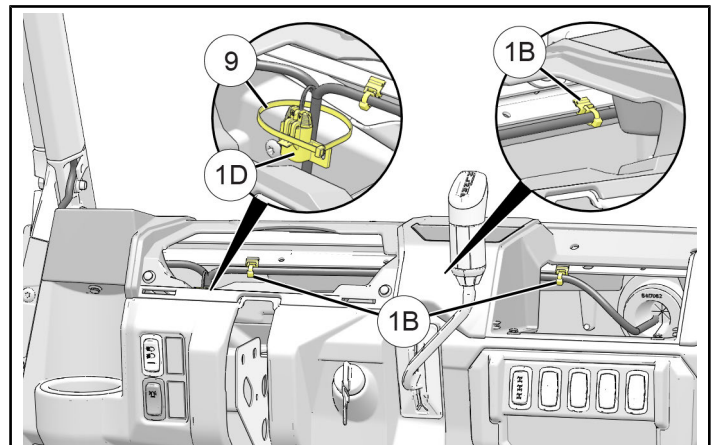

5. Secure fuse block 1D to harness switch branch using cable tie (9).

VEHICLE REASSEMBLY

FINAL STEPS

Restore access by reversing the steps in each of these previous sections:

1. **UPPER DASH ACCESS**
2. **REMOVE ROOF LINER**
3. **INITIAL STEPS**
4. **DISCONNECT BATTERY**

FEEDBACK FORM

A feedback form has been created for the installer to provide any comments, questions or concerns about the installation instructions. The form is viewable on mobile devices by scanning the QR code or by clicking [HERE](#) if viewing on a PC.



THIS PAGE INTENTIONALLY BLANK

FRONT

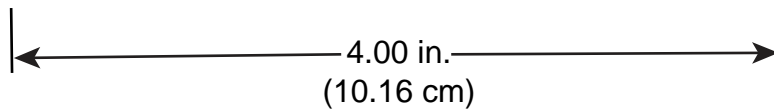
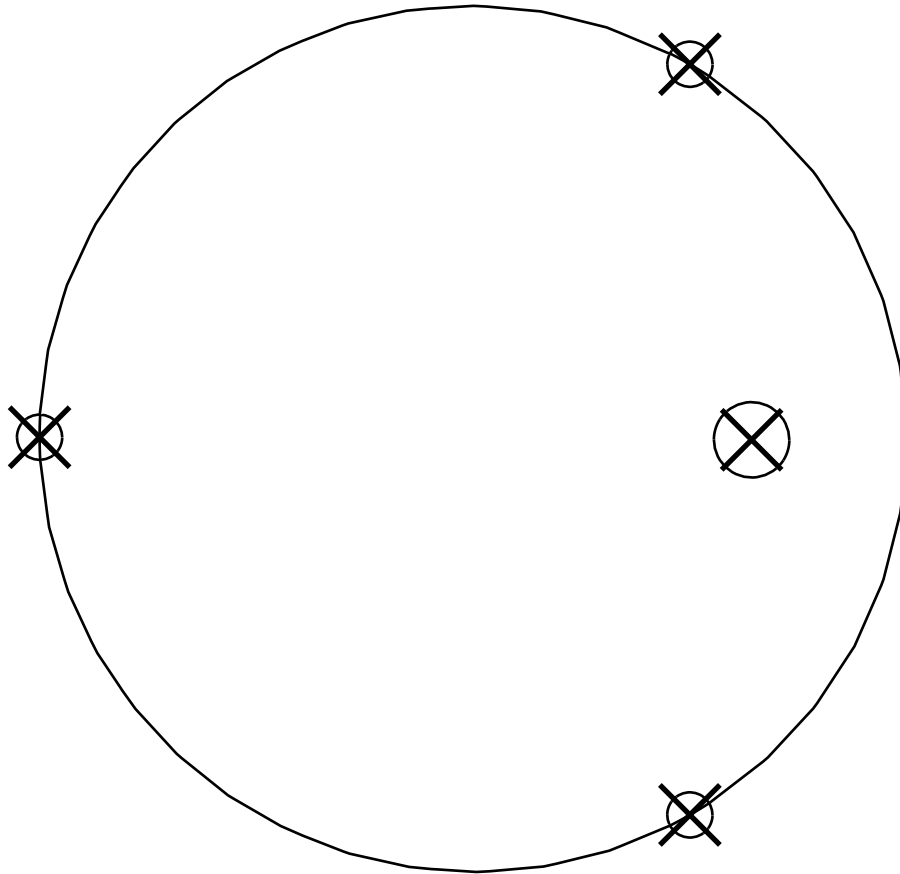

REFERENCE DIMENSION

THIS PAGE INTENTIONALLY BLANK; TEMPLATE ON PREVIOUS PAGE