

# ACE® REAR RACK EXTENDER KIT



**P/N 2882886**

## APPLICATION

Verify accessory fitment at [Polaris.com](http://Polaris.com)

## BEFORE YOU BEGIN

Read these instructions and check to be sure all parts and tools are accounted for. Please retain these installation instructions for future reference and parts ordering information.

## KIT CONTENTS

This Kit includes:

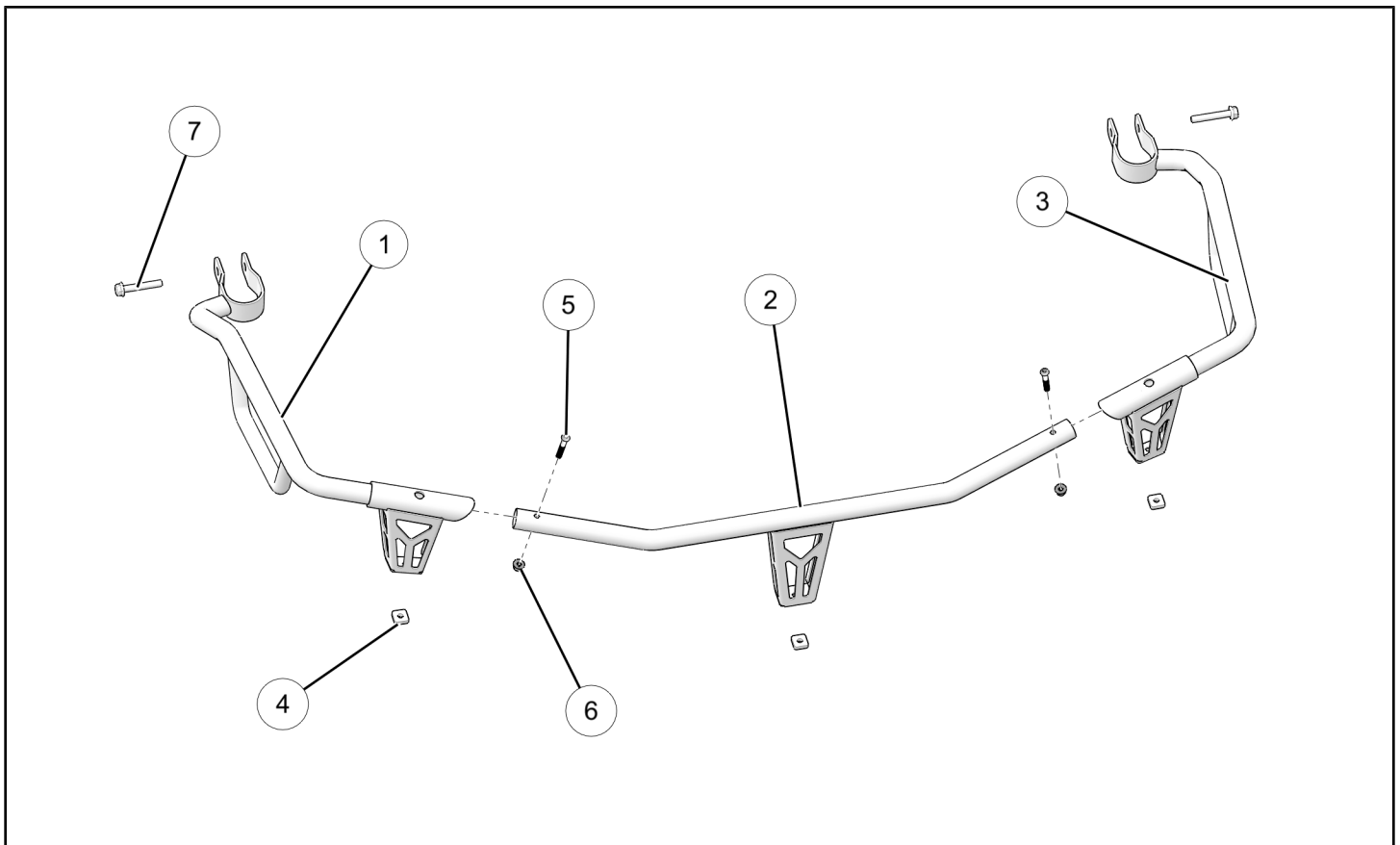

REF	QTY	PART DESCRIPTION	PART NUMBER	INCLUDED IN KIT PN
1	1	Rear Rack Extender - LH	-	2882886
2	1	Rear Rack Extender - MID	-	2882886
3	1	Rear Rack Extender - RH	-	2882886
4	3	Spacer	-	2207377
5	2	Screw - M6 X 1.0 X 40	-	2207377
6	2	Nut, Locking - M6 X 1.0	-	2207377

REF	QTY	PART DESCRIPTION	PART NUMBER	INCLUDED IN KIT PN
7	2	Screw - M8 X 1.25 X 50	-	2207377
	1	Instructions	9928479	

## TOOLS REQUIRED

- Safety Glasses
- Socket Set, Torx® Bit
- Wrench Set, Metric
- Socket Set, Metric

## IMPORTANT

Your ACE® Rear Rack Extender Kit is exclusively designed for your vehicle. Please read the installation instructions thoroughly before beginning. Installation is easier if the vehicle is clean and free of debris. For your safety, and to ensure a satisfactory installation, perform all installation steps correctly in the sequence shown.

## ASSEMBLY TIME

Approximately 30 minutes

## INSTALLATION INSTRUCTIONS

### REAR RACK EXTENDER ASSEMBLY

1. The Rear Rack Extender Kit will need to be assembled before installing on the vehicle. To do so, use the provided screws ⑤ and locking nuts ⑥ to bolt the three main sections ①, ② and ③ together as shown below.

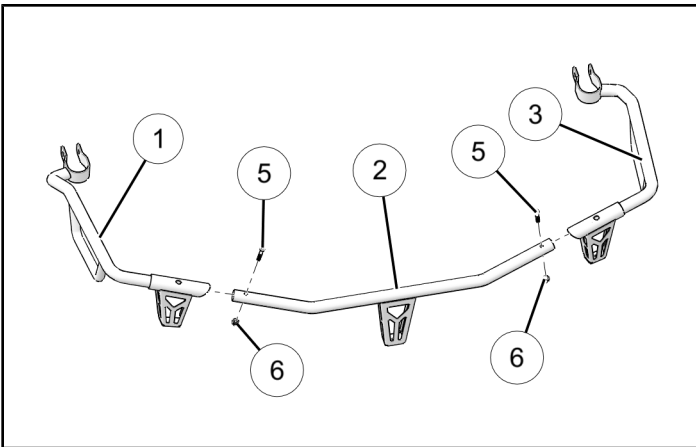

### NOTE

**DO NOT TIGHTEN BOLTS** at this time as it will make it easier to align with the holes on the mounting platform in the next step.

### REAR RACK EXTENDER INSTALLATION

1. Remove the three screws ① located at the rear of the cargo box along with the two screws ② and two locking nuts ③ located on lower portion of each of the rear tubes of the ROPS as shown. Discard the screws ② as they will be replaced with the longer screws supplied with your kit. Retain the locking nuts ③ as they will be reused.

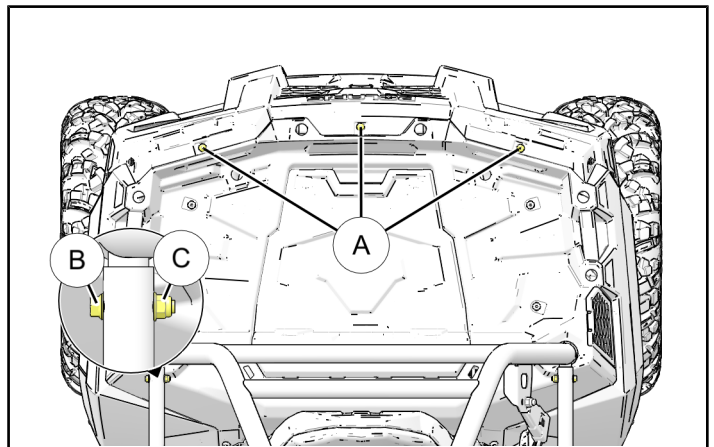

- Place the provided spacers ④ into the locations shown below to fill in the voids in the mounting platform.

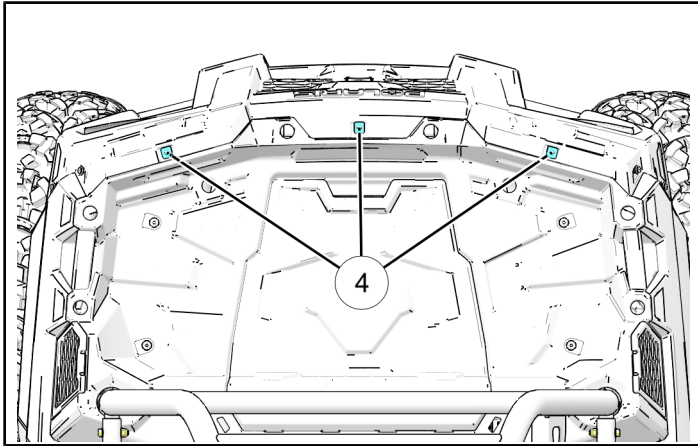

- Place the assembled Rear Rack Extender ⑥ into position as shown below and align rear mounting holes being careful not to displace the spacers previously installed.

#### NOTE

The front tabs ⑦ of the Rear Rack Extender will need to be forced apart and over the ROPS rear tubes ⑤. It may help to place a piece of the cardboard packaging material around the tubes before forcing the mounting tabs from the Rear Rack Extender over the tubes to prevent the paint from being scratched.

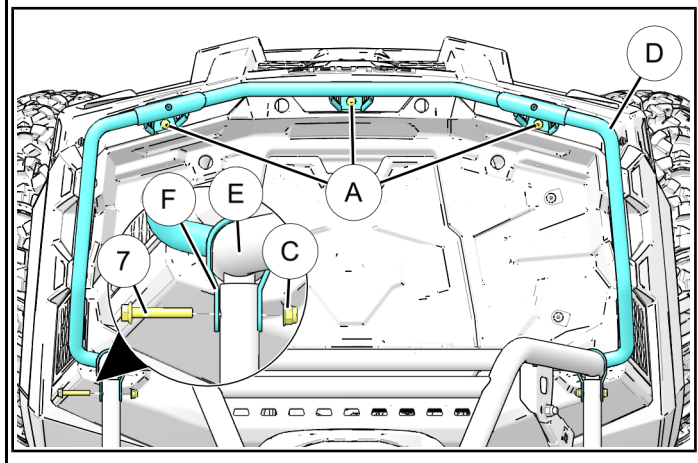

#### FEEDBACK FORM

A feedback form has been created for the installer to provide any comments, questions or concerns about the installation instructions. The form is viewable on mobile devices by scanning the QR code or by clicking [HERE](#) if viewing on a PC.

- Once all bolts have been started, tighten the three rear bolts ⑧.
- Next, torque the front locking nuts ⑨ to the specification listed below.

#### TORQUE

14 ft/lbs (19 Nm)

- Once all mounting bolts have been properly torqued, finish tightening the Rear Rack Extender assembly bolts ⑩ you started in step 1. Torque to specification listed below.

#### TORQUE

8 ft/lbs (11 Nm)

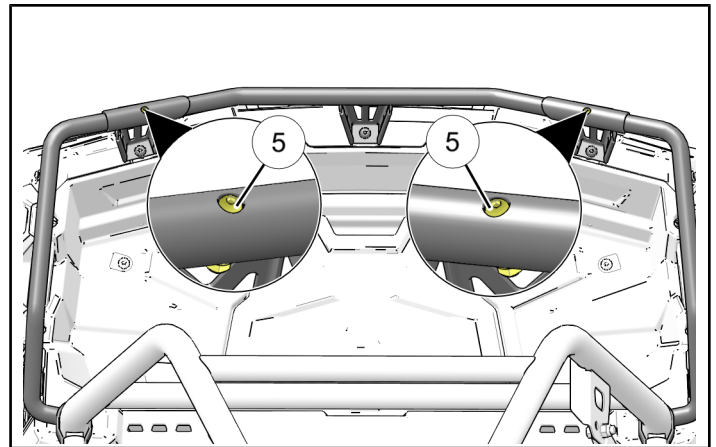

- Check to ensure all tools are accounted for and all steps have been completed.

#### FEEDBACK FORM

