

# FRONT BUMPER KIT



**P/N 2882258**

## APPLICATION

Verify accessory fitment at [Polaris.com](http://Polaris.com).

## BEFORE YOU BEGIN

Read these instructions and check to be sure all parts and tools are accounted for. Please retain these installation instructions for future reference and parts ordering information.

## KIT CONTENTS

This Kit includes:

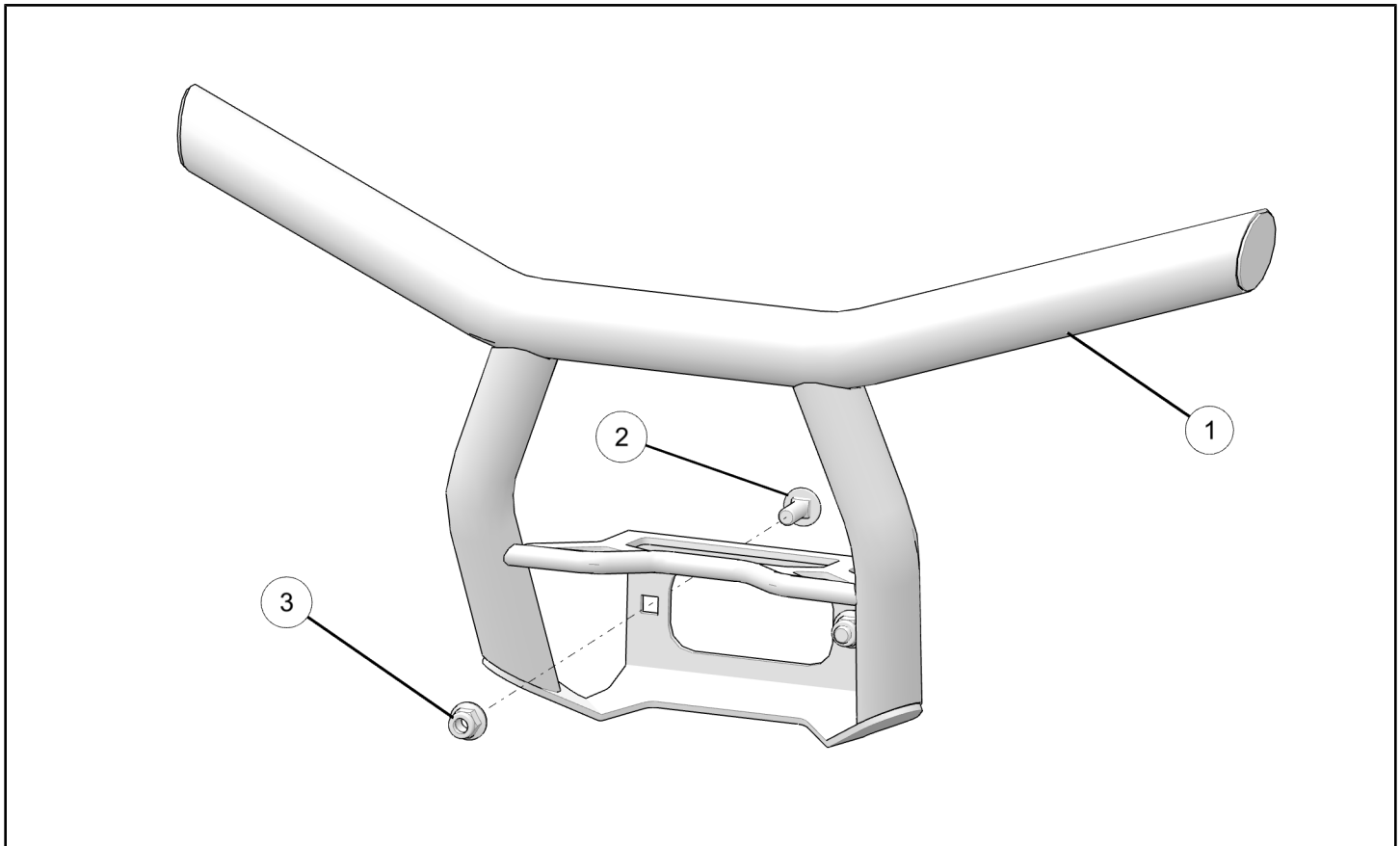

REF	QTY	PART DESCRIPTION	PART NUMBER
1	1	Front Bumper	-
2*	2	Screw, M10 X 1.5 X 25	-
3*	2	Nut, M10 X 1.5	-
	1	Instructions	9927493

Items marked (\*) are included in Hardware Kit PN 2206494.

## TOOLS REQUIRED

- Metric Socket Set
- Metric Ratchet Set

## IMPORTANT

Your FRONT BUMPER KIT is exclusively designed for your vehicle. Please read the installation instructions thoroughly before beginning. Installation is easier if the vehicle is clean and free of debris. For your safety, and to ensure a satisfactory installation, perform all installation steps correctly in the sequence shown.

## ASSEMBLY TIME

Approximately 5 minutes

## INSTALLATION INSTRUCTIONS

1. Shift vehicle transmission into "PARK". Turn key to "OFF" position and remove from vehicle.
2. Install front bumper ① to winch mount (A) using two screws ② and nuts ③ as shown. Torque the screws ② to below specification.
3. If a winch is to be installed, install the winch first, then assemble the bumper ① between the winch mount (A) and the fairlead (B). If vehicle has a winch already installed, remove the fairlead and nuts, but leave bolts installed. Place bumper ① onto winch mount (A), aligned with fairlead mounting bolts. Reinstall fairlead and the nuts as shown.

### TORQUE

18 ft. lbs. (24 Nm)

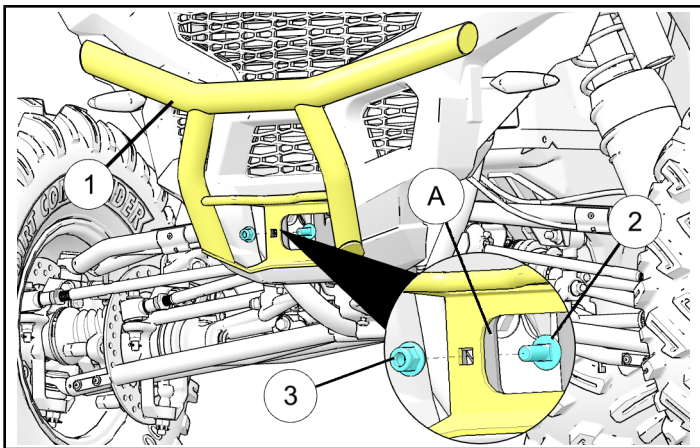

### NOTE

Front fascia is not shown for better clarity.

