

STRONGHOLD™ GUN MOUNT KIT



P/N 2882300

APPLICATION

Verify accessory fitment at Polaris.com.

BEFORE YOU BEGIN

Read these instructions and check to be sure all parts and tools are accounted for. Please retain these installation instructions for future reference and parts ordering information.

KIT CONTENTS

This Kit includes:

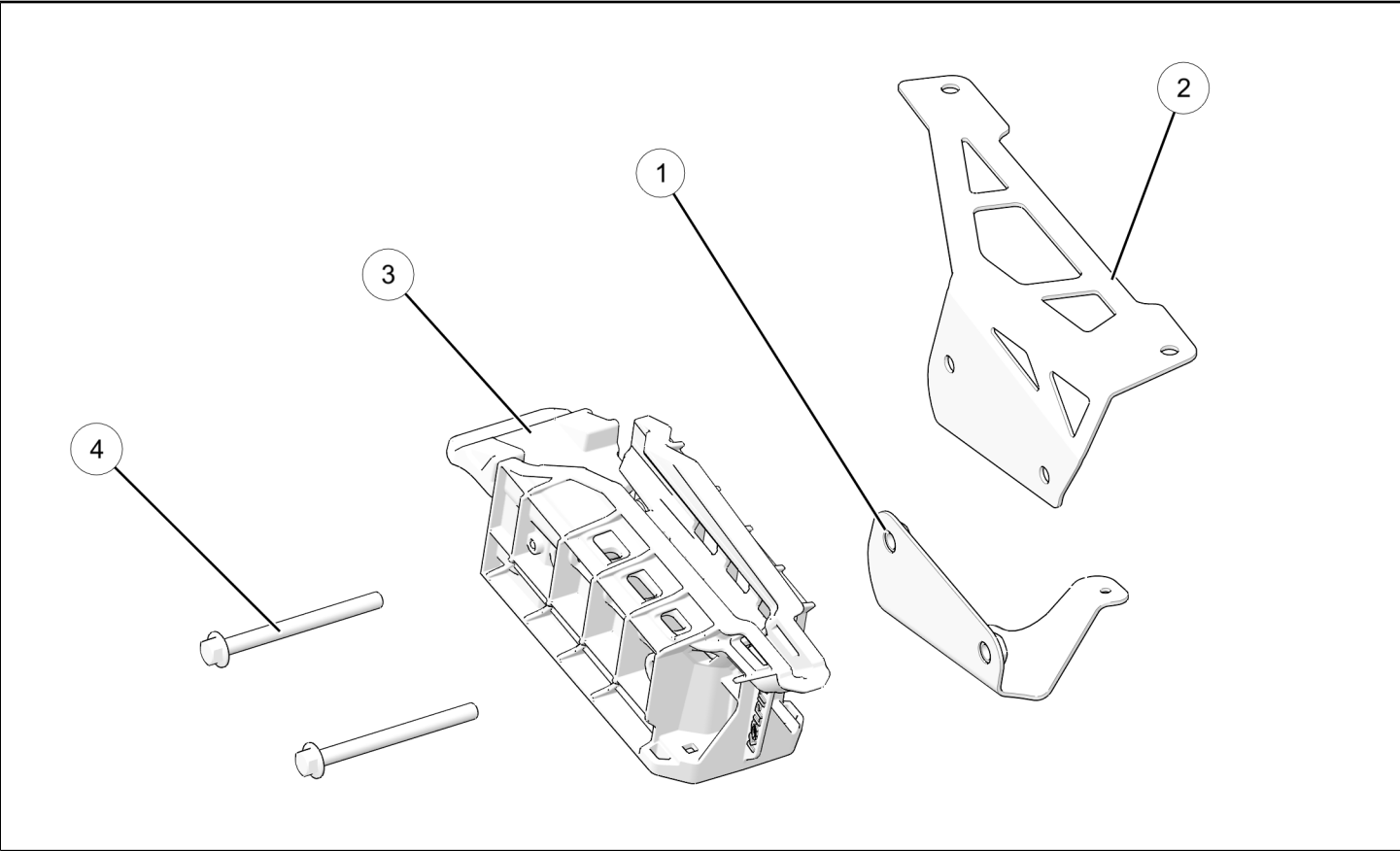

| REF | QTY | PART DESCRIPTION | PART NUMBER |
|-----|-----|---------------------------|-------------|
| 1 | 1 | Gun Mount Bracket - Lower | 1023809 |
| 2 | 1 | Gun Mount Bracket - Upper | 5265240 |
| 3 | 1 | Dovetail Bracket | - |
| 4 | 2 | Bolt - M10 X 1.5 X 115 | - |
| | 1 | Instructions | 9927566 |

TOOLS REQUIRED

- Safety Glasses
- Socket Set, Metric
- Socket Set, SAE
- Socket Set, Torx® Bit
- Torque Wrench

IMPORTANT

Your Stronghold™ Gun Mount Kit is exclusively designed for your vehicle. Please read the installation instructions thoroughly before beginning. Installation is easier if the vehicle is clean and free of debris. For your safety, and to ensure a satisfactory installation, perform all installation steps correctly in the sequence shown.

ASSEMBLY TIME

Approximately 18 minutes

NOTE

Additional time may be required for optional steps, or to accommodate other installed accessories.

INSTALLATION INSTRUCTIONS

Before starting installation shift vehicle transmission into "PARK". Turn key to "OFF" position and remove from vehicle.

1. Remove two rear rack screws (A) and lock nuts (B) from the right side of vehicle as shown.

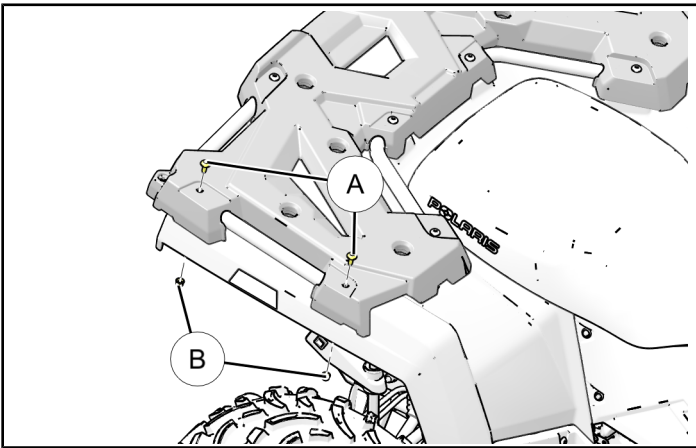

2. Place the upper gun mount bracket (2) into position as shown. Secure in place by inserting the two screws previously removed. Thread the rear nut (B) onto the rear screw (A) to hold bracket in position. **DO NOT** tighten at this time.

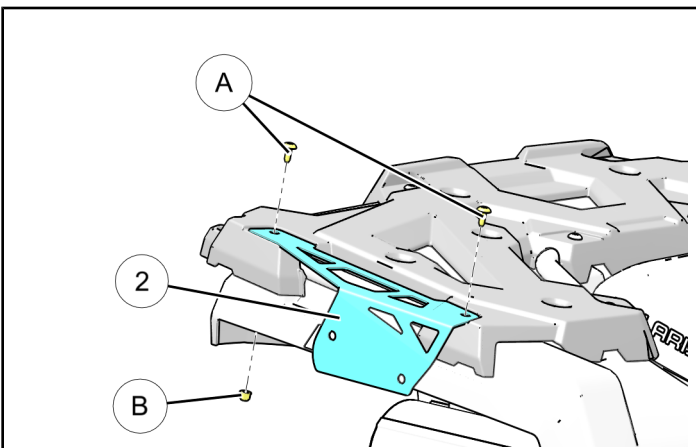

3. Next, place the lower gun mount bracket into position from the bottom side being sure that it is to the inside of the upper gun mount bracket as shown. Secure into position with locking nut (B) previously removed. **DO NOT** tighten at this time.

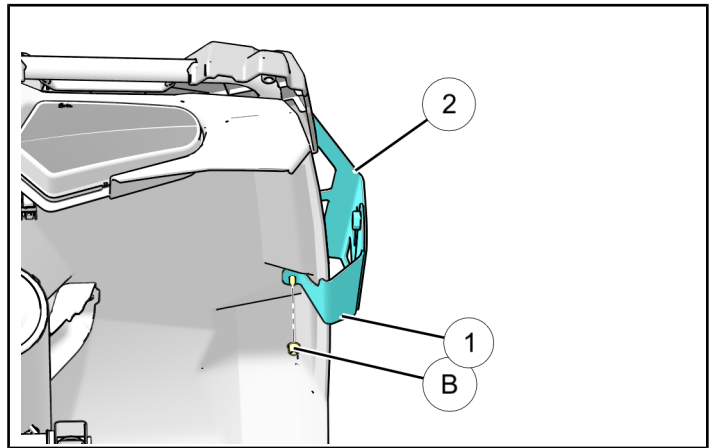

4. Place the dovetail bracket on the side of the upper and lower gun mount brackets by inserting the fasteners (4) through the dovetail bracket and threading into the upper and lower gun mount brackets as shown. Torque dovetail mount fasteners (4) to specification provided.

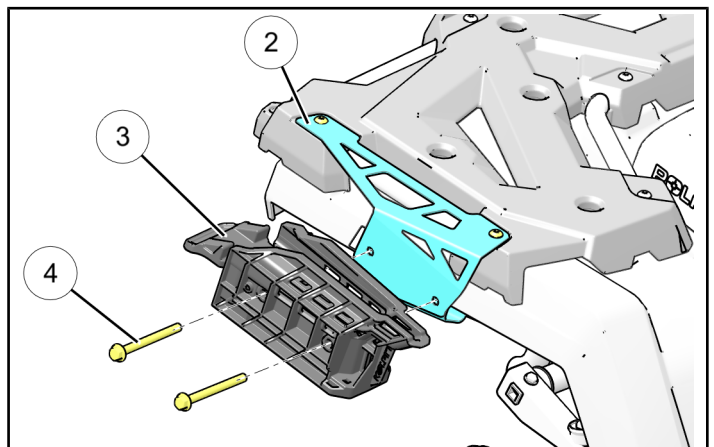

TORQUE

10 Ft. Lbs. (13.5 Nm)

5. Torque upper and lower gun mount bracket screws ① and corresponding locking nut ② (not shown) to specification provided below.
6. Check to ensure all tools are accounted for and all steps have been completed.

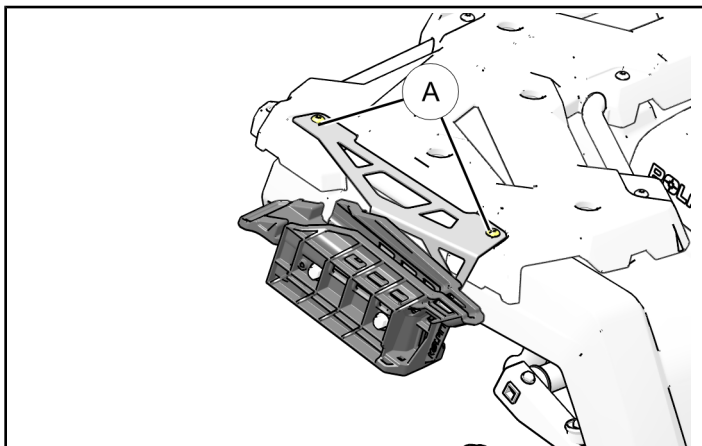

TORQUE

8 Ft. Lbs. (11 Nm)

FEEDBACK FORM

A feedback form has been created for the installer to provide any comments, questions or concerns about the installation instructions. The form is viewable on mobile devices by scanning the QR code or by clicking [HERE](#) if viewing on a PC.

FEEDBACK FORM

