

KEYSTONE MOUNT KIT



P/N 2880536

APPLICATION

MY15 SPORTSMAN 850, SPORTSMAN XP 1000, AND MY15 SPORTSMAN 570 SP MODELS

NOTE: Kit contains mount and hardware only. It will require Interactive Digital Display Kit (PN 2880402) sold separately.

BEFORE YOU BEGIN

Read these instructions thoroughly and make sure all parts are accounted for. Please retain these instructions for future reference and parts ordering information.

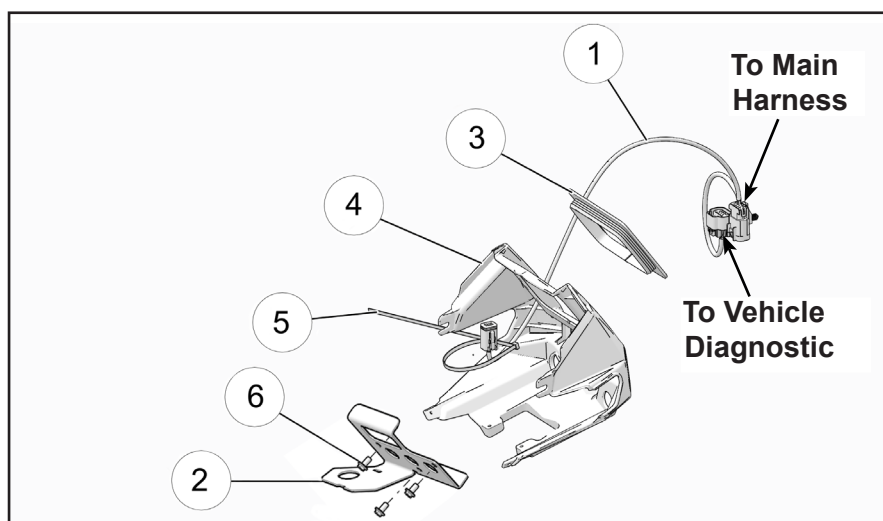

KIT CONTENTS (P/N 2880536)

Ref	Qty	Part Description	Part Number
1	1	GPS Receiver Harness	2413047
2	1	GPS Bracket, SMXP/ SPH	5260355
3	1	Rubber Mount, MFUNC Display	5415138
4	1	Rear Headlight Pod, SMXP/ SPH	5451947-070
5	5	Panduit Strap, 11"	7080492
6	3	Hex Screw-M6X1.0X10, Flange	7518140
	1	Instructions	9925456

POLARIS INTERACTIVE DIGITAL DISPLAY KIT (PN 2880402)

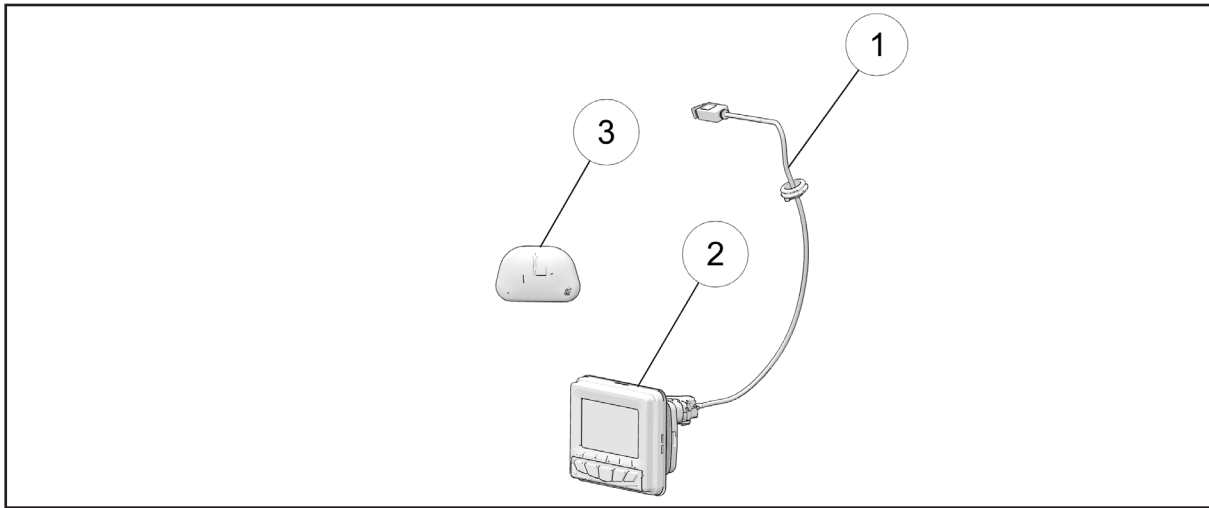

KIT CONTENTS (P/N 2880402)

Ref	Qty	Part Description	Part Number
1	1	USB Harness	2412818
2	1	Digital Display	3280612
3	1	GPS Antenna Receiver	4014811
	1	Owner's Manual	9925416

TOOLS NEEDED

Safety Glasses T-25 Torx 10 mm Socket Wrench Long Extension

APPROXIMATE ASSEMBLY TIME

30 mins

IMPORTANT

Your Polaris KEYSTONE MOUNT KIT is specifically designed for your vehicle. For your safety, and proper installation, perform all steps in the order shown.

INSTALLATION INSTRUCTIONS

1. Put the vehicle transmission into "**PARK**" and turn the key to "**OFF**" position. Remove the key from the vehicle.
2. Open the latch and remove the front rack (A) from the vehicle. See figure.
3. Disconnect the black negative cable from the battery.

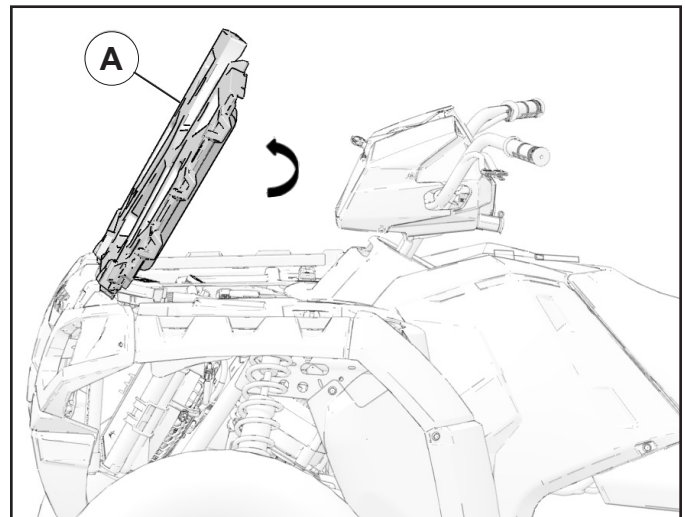

4. For **Sportsman 850/1000**: Remove front cover (B) by removing two screws (C) as shown in figure.

For **Sportsman 570**: Remove front cover (B) by removing four screws (C) as shown in figure.

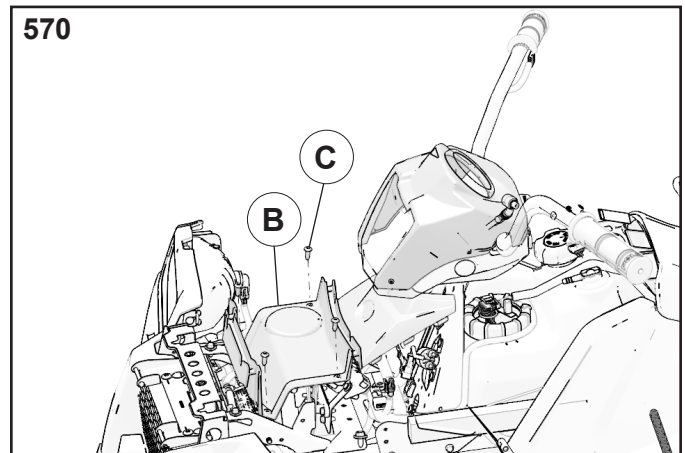
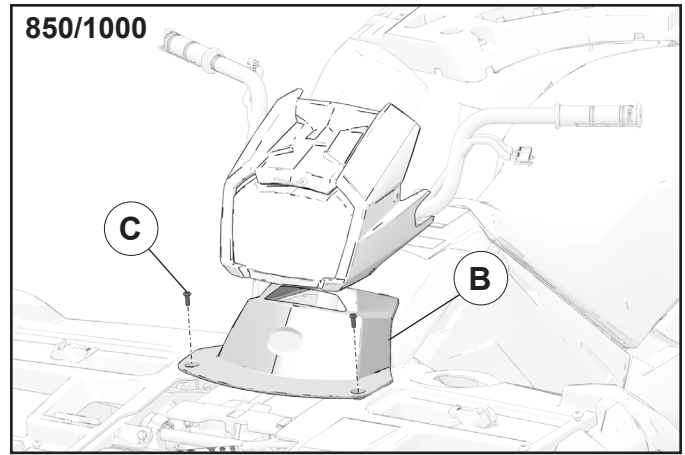

5. Remove the front headlight pod (D) by removing four screws (E) as shown in figure.

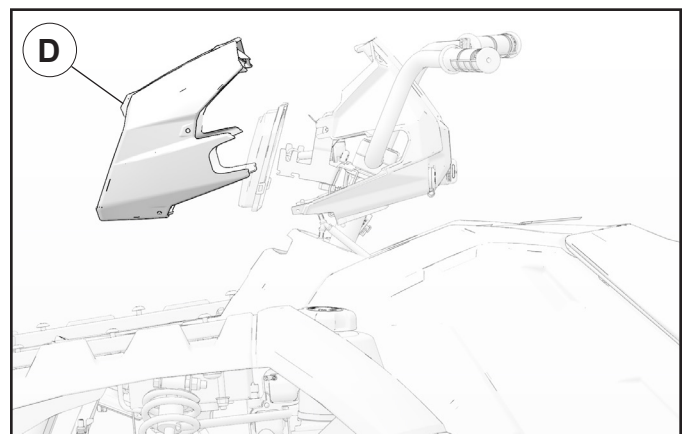
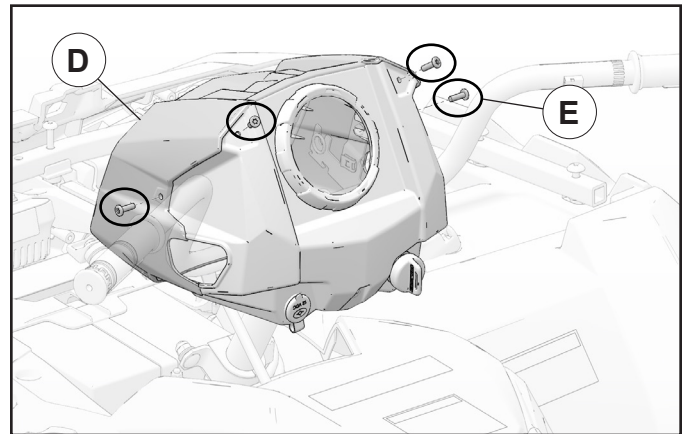

6. Disconnect the display harness and key switch harness. Remove the rear headlight pod (F) by removing one screw (G) from front and two screws (G) from top using a long extension. See figures. Remove the key switch (H) and battery receptacle mount pod (J).

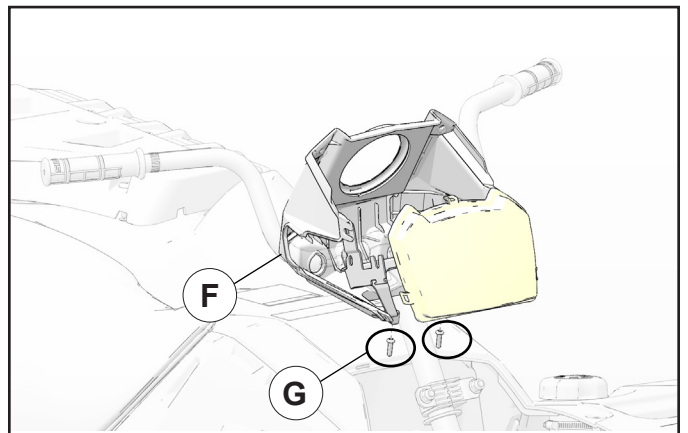
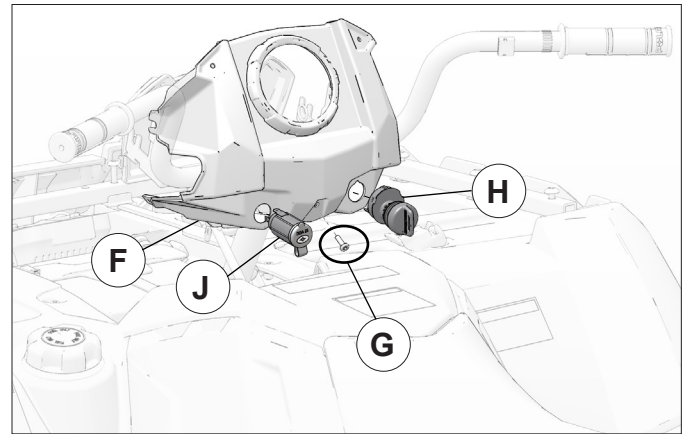

7. Assemble the display (K) onto the rear headlight pod (4) with the rubber mount (3) as shown in figure.

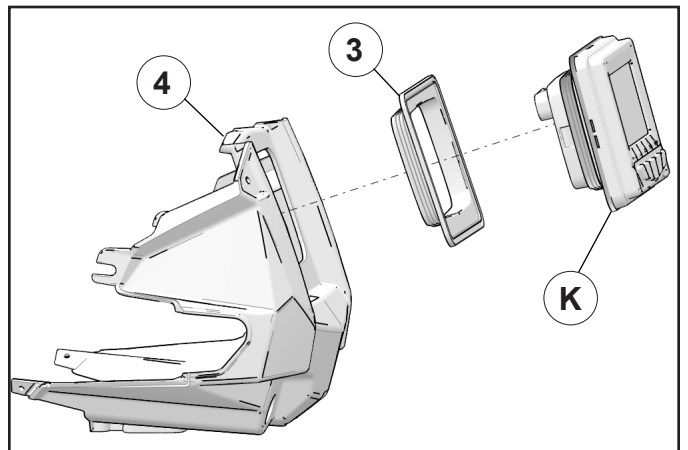

8. Prior to installation of GPS antenna receiver (L) onto the bracket, remove adhesive liner (red color) from bottom of receiver and align it on bracket with arrow pointing forward as shown in figure.
9. Install the GPS bracket (2) onto the mount display with three M6 screws (6) as shown in figure.

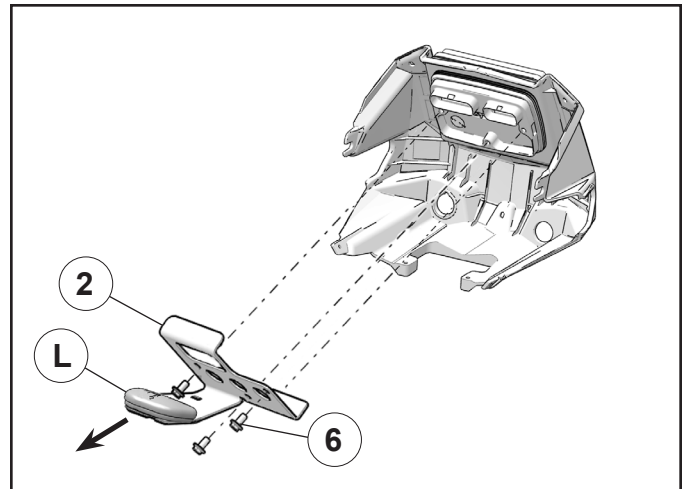

10. Prior to installation of rear headlight pod on vehicle, install the key switch (E) and battery receptacle mount pod (D) as shown in figure.

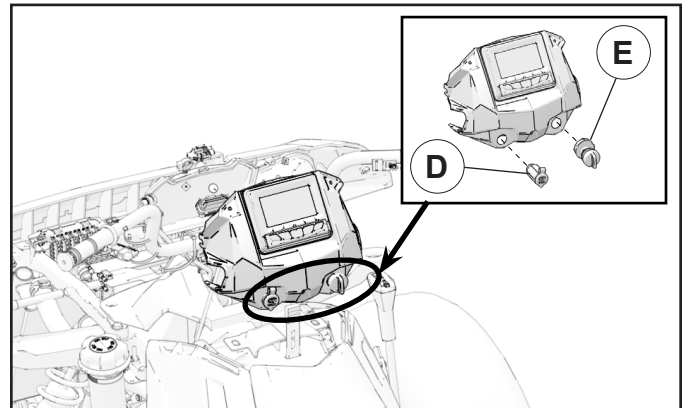

11. Install rear headlight pod (4) on to the vehicle and tighten the screws.

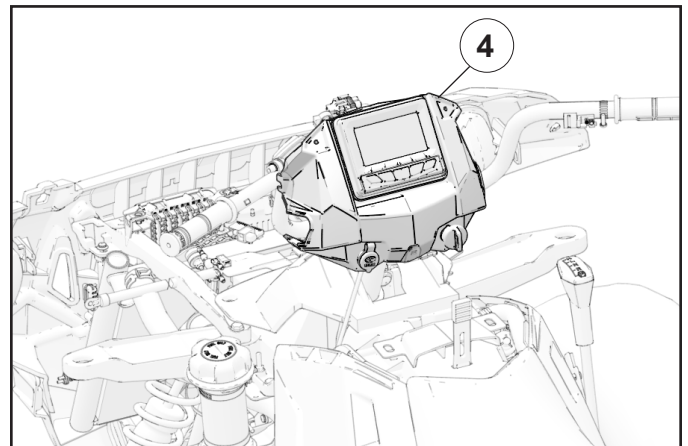

12. Connect the GPS receiver harness (1) to the antenna receiver (L) at the bottom as shown in figure.

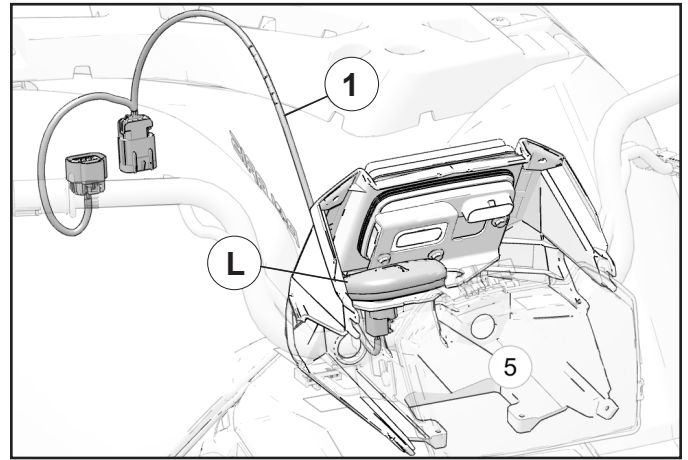

13. Connect the USB harness (M) to the digital display (K) as shown in figure.
14. Connect the display harness (N) to the digital display as shown in figure. Connect the key switch harness.

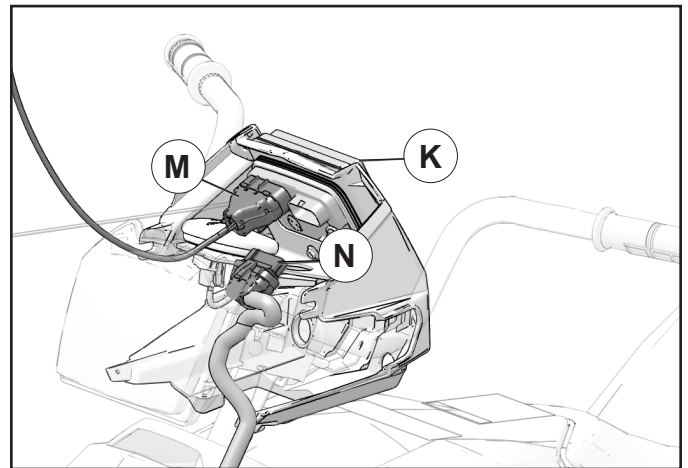

15. Route the GPS receiver harness (1) properly and connect to the vehicle diagnostic and main harness as shown in figure.

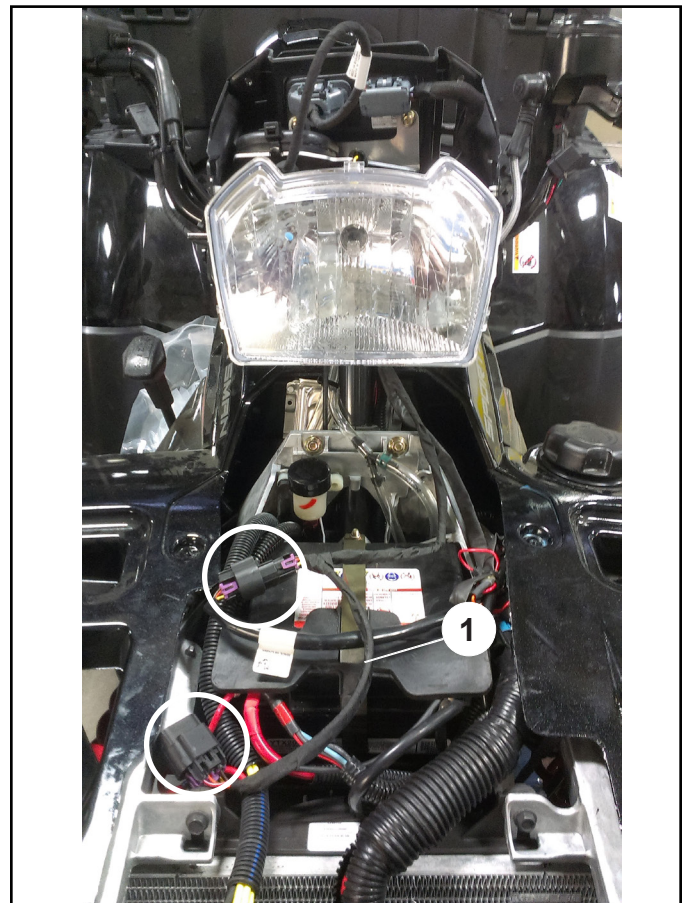

16. Route the USB harness (P) properly and tie with handlebar as shown in figure.

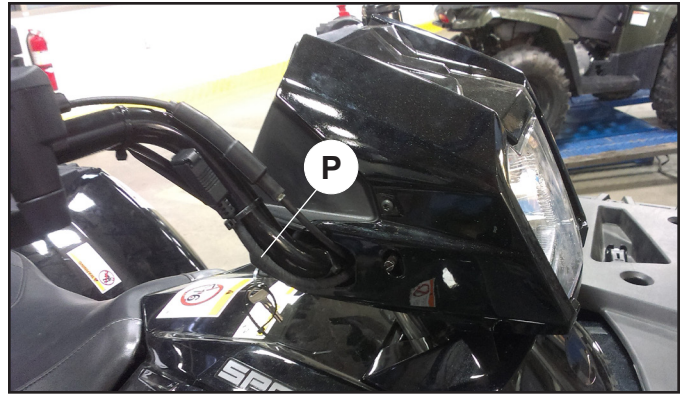

17. Reinstall front headlight pod (D) removed in Step 5. See figure.

18. Reinstall the front cover (B) removed in Step 4.

19. Hook up black negative cable to battery.

20. Reinstall the front rack (A) removed in Step 2.

21. Turn on key and test functionality.

