

# LED LIGHT KIT



P/N 2884859

## BEFORE YOU BEGIN

Read these instructions and check to be sure all parts and tools are accounted for. Please retain these installation instructions for future reference and parts ordering information.

## APPLICATION

Verify accessory fitment at [www.polaris.com](http://www.polaris.com).

## KIT CONTENTS

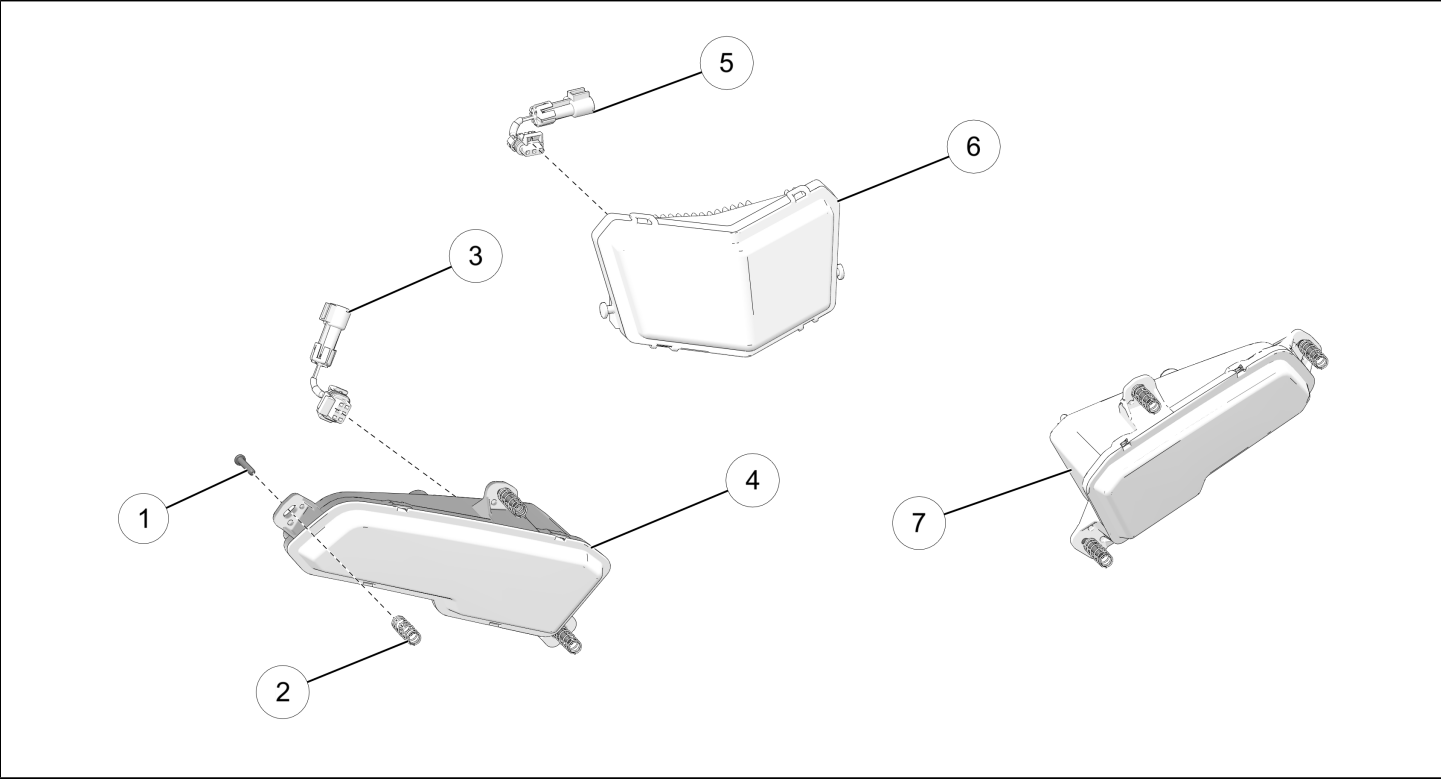

REF	QTY	PART DESCRIPTION	P/N AVAILABLE SEPARATELY
1	6	Screw-10 x 1.12	7512078
2	6	Headlight Spring	7043816
3	2	Bumper Light Harness Adapter	2415664
4	1	RH LED Light	2415662
5	1	Pod Light Harness Adapter	2415663
6	1	Headlight Pod LED Light	2415397
7	1	LH LED Light	2415661

## TOOLS REQUIRED

- Safety Glasses
- Socket Set, Torx® Bit
- Socket Set, Metric
- Wrench Set, Metric

## IMPORTANT

Your LED Light Kit is exclusively designed for your vehicle. Please read the installation instructions thoroughly before beginning. Installation is easier if the vehicle is clean and free of debris. For your safety, and to ensure a satisfactory installation, perform all installation steps correctly in the sequence shown.

## INSTALLATION INSTRUCTIONS

### VEHICLE PREPARATION

#### GENERAL

1. Park vehicle on a flat surface.
2. Push engine stop switch to the OFF position.
3. Turn key to the OFF position and remove key.

### ACCESSORY INSTALLATION

#### HEADLIGHT POD LED LIGHT

1. Remove the four headlight pod screws and remove the front half of the pod from the vehicle.

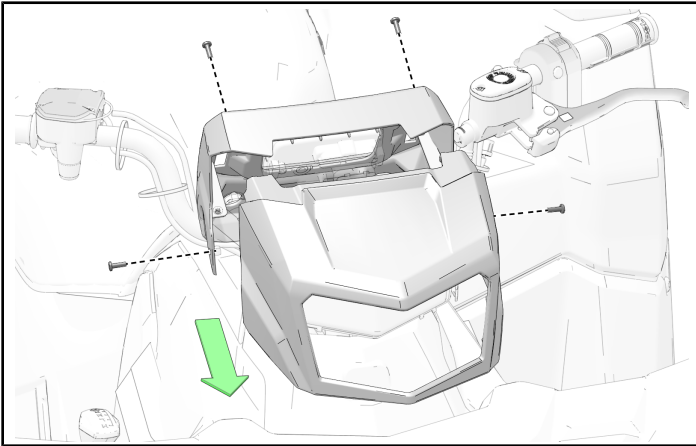

2. Remove the two rubber O-ring retainers from each side of the pod bracket.

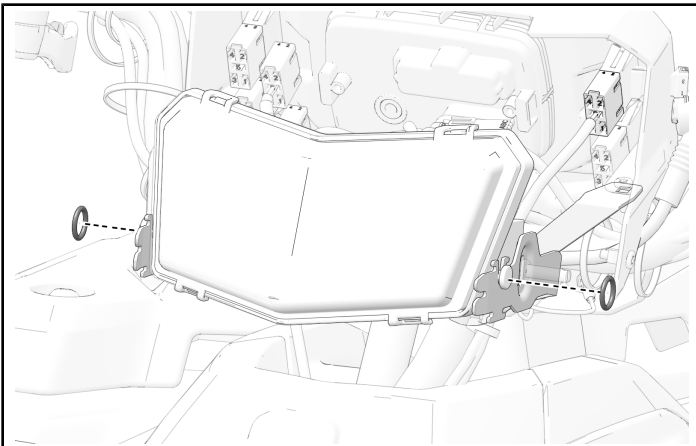

3. Remove the headlight adjuster screw.

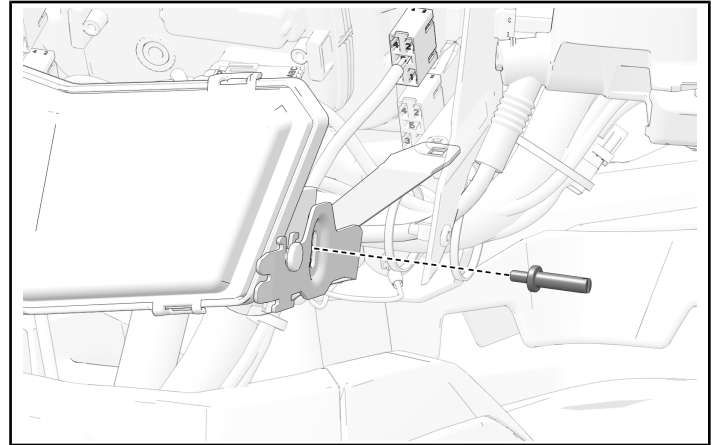

4. Disconnect the wire harness from the back of the headlight and remove the headlight from the pod.

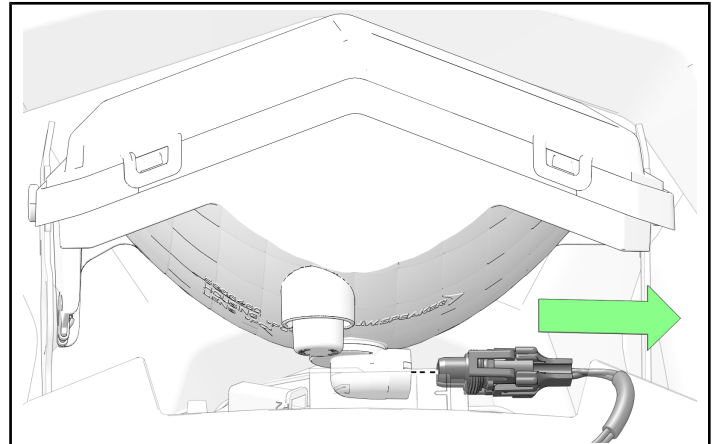

5. Plug the pod light harness adapter ⑤ into the back of the new headlight pod LED light ⑥.

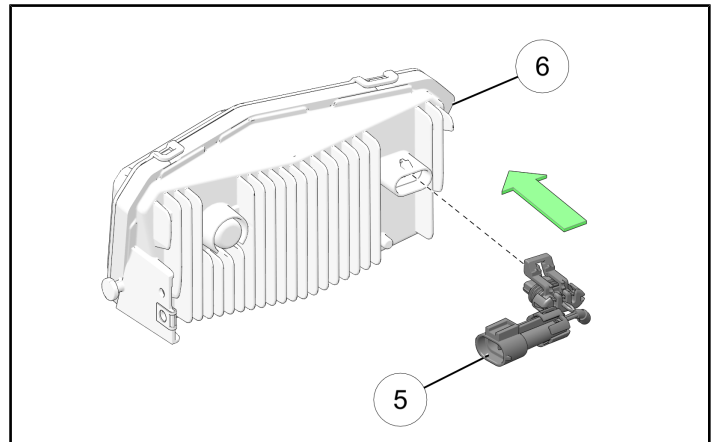

6. Connect the pod light harness adapter ⑤ on the back of the new headlight pod LED light into the wire harness on the vehicle.
7. Install the headlight pod LED light ⑥ into the pod bracket.

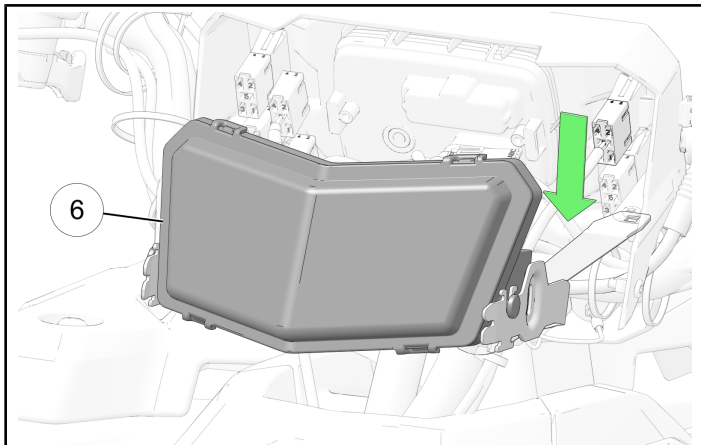

8. Install the headlight adjuster screw.

#### IMPORTANT

Do not tighten the screw at this time. You will need to adjust the aim of the headlight in a later step.

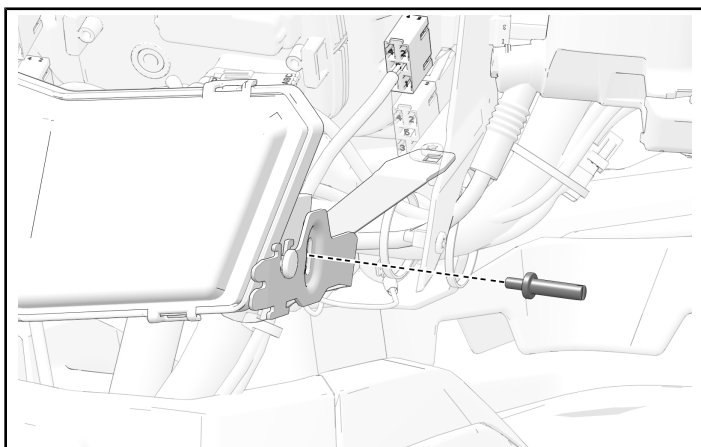

9. Install the two rubber O-ring retainers on each side of the pod bracket.

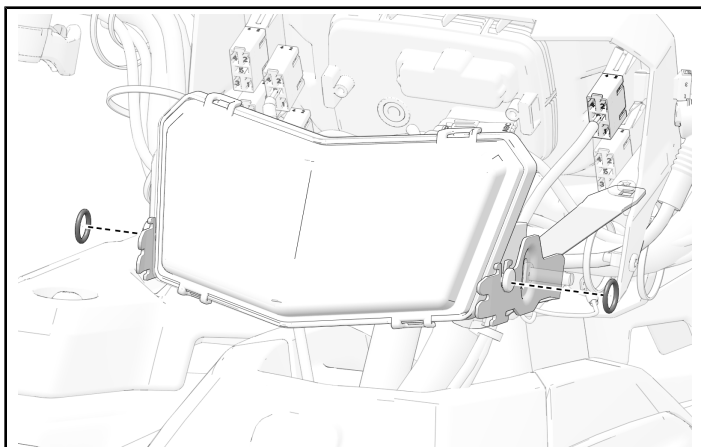

10. Install the front half of the pod and the four headlight pod screws. Torque screws to specification.

#### TORQUE

Headlight Pod Screws:  
**10 in-lbs (1 N·m)**

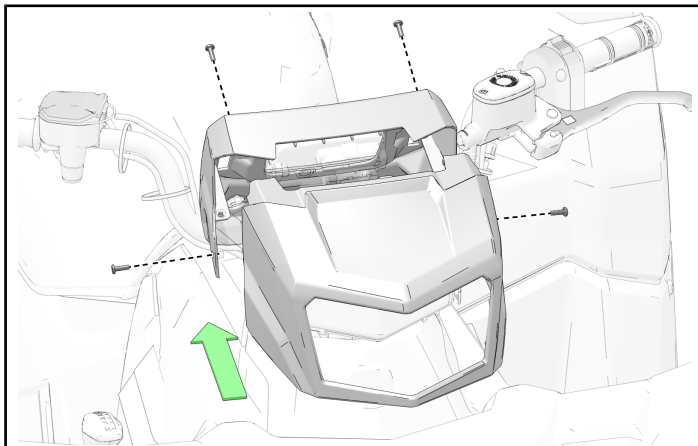

11. See the Owner's Manual for headlight adjustment.
12. Once the headlight is properly adjusted, tighten the headlight adjuster screw.

#### LEFT-HAND / RIGHT-HAND LED HEADLIGHTS

1. Push down on the tab on top of the radiator screen. Then pull the radiator screen forward and upward to remove it.

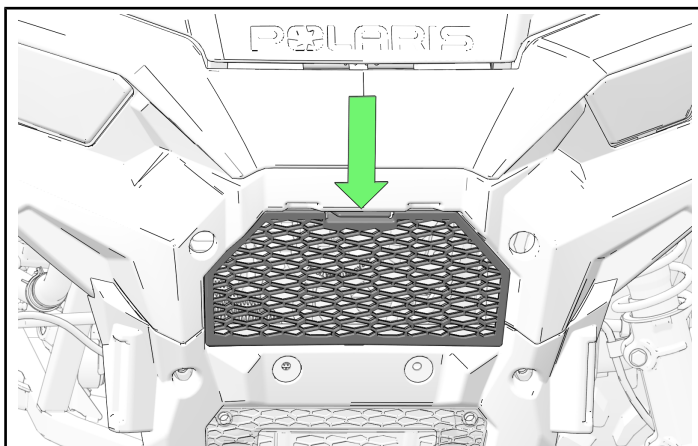

2. Remove the four front lower fascia cover screws and the cover from the vehicle.

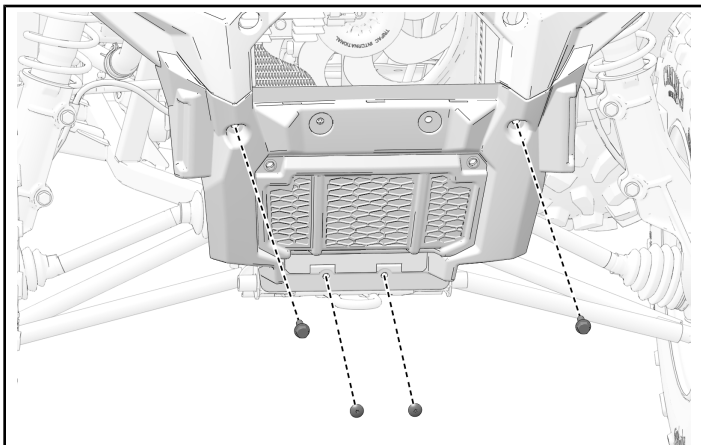

3. Open the front rack assembly and remove the two front upper bumper to chassis screws as shown.

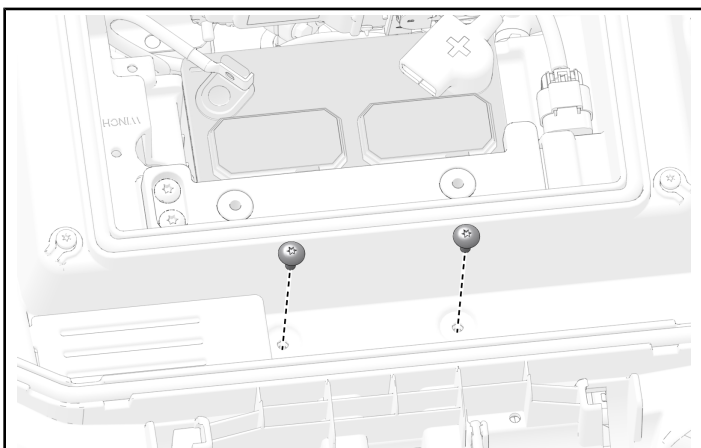

4. Gently lift up on the front of the front cab to remove the two headlight screws and washers as shown. Then remove the two front upper bumper to chassis screws.

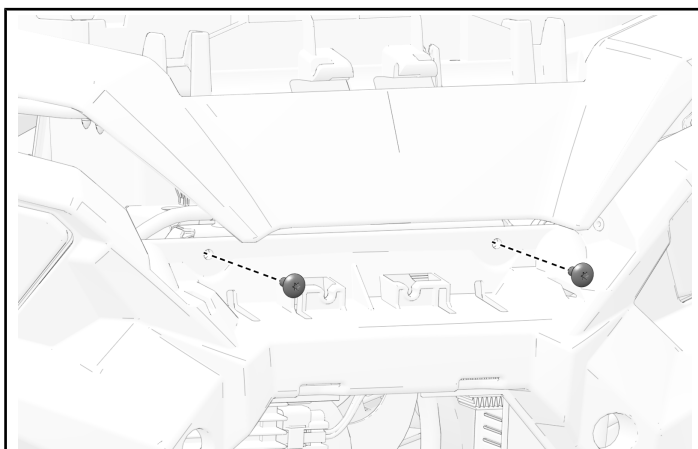
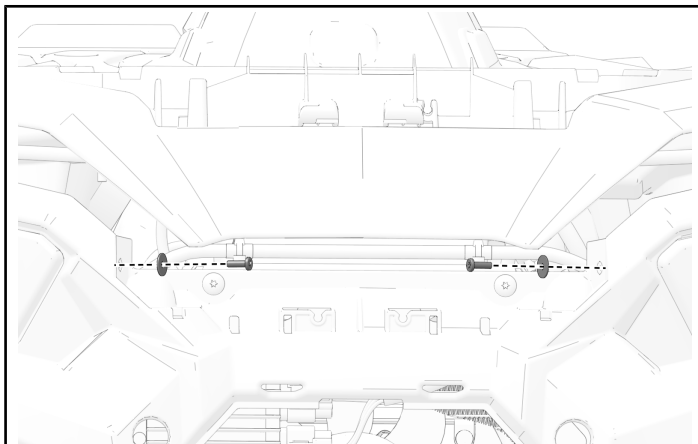

5. Disconnect the wire harness from the back of the left-hand and right-hand headlights.

**NOTICE**

Left-hand side shown.

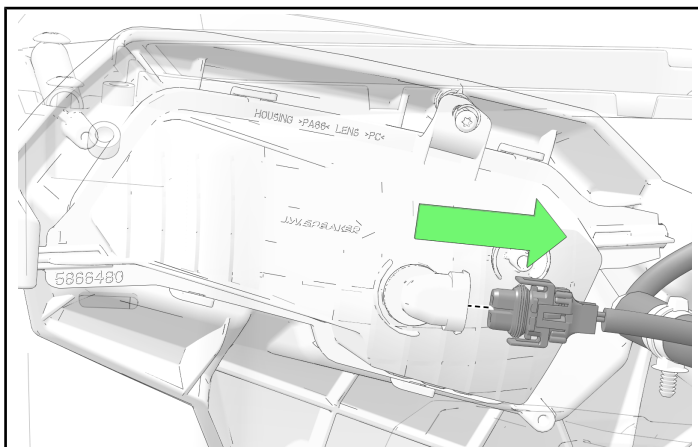



6. Remove the left-hand and right-hand front upper bumper screws and remove the bumper from the vehicle.

**NOTICE**

Left-hand side shown.

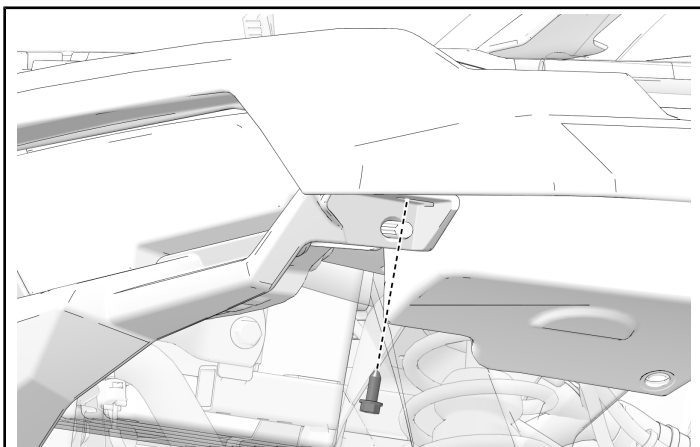

7. Remove the headlight adjuster screw and spring from the front upper bumper.

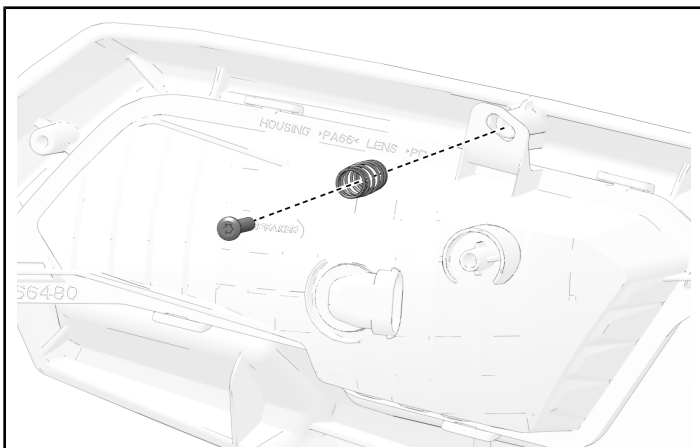

8. Slide the headlight in the direction shown to release the retainer and remove the headlight from the front upper bumper.

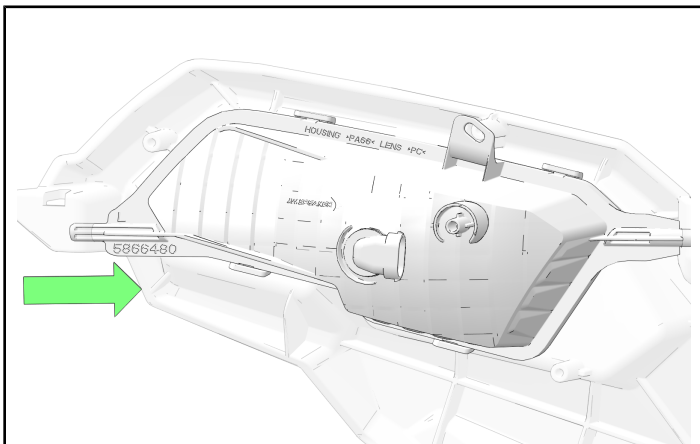

9. Slide the three headlight springs (2) into the three retainers as shown.

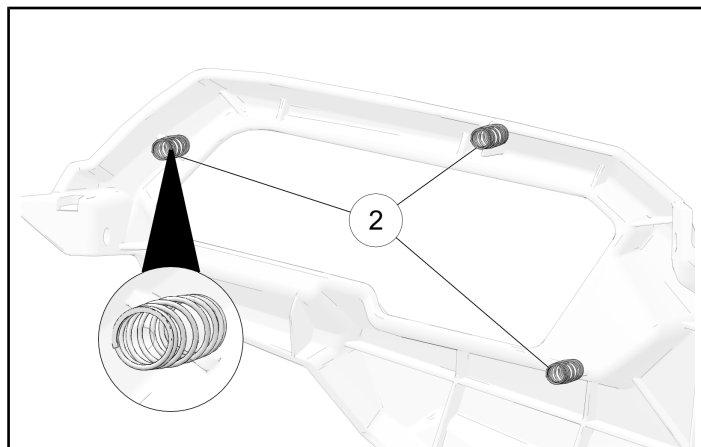

10. Install the new LED headlight (4 or 7) into the front upper bumper.

11. Install the three headlight adjuster screws (1).

**IMPORTANT**

Do not tighten the screws at this time. You will need to adjust the aim of each headlight in a later step.

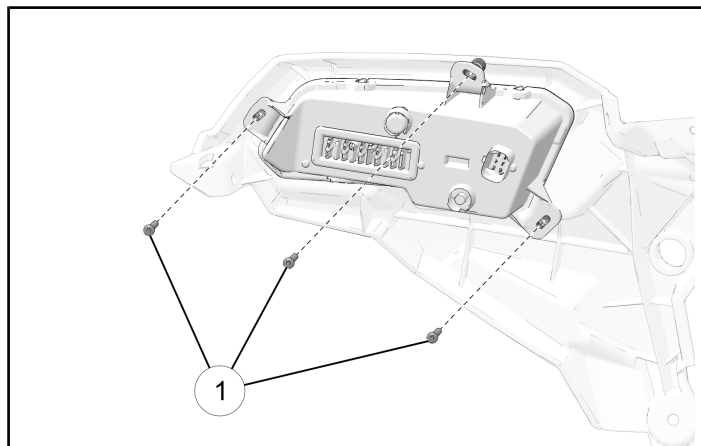

12. Plug the bumper light harness adapter (3) into the back of the new LED headlight (4 or 7).

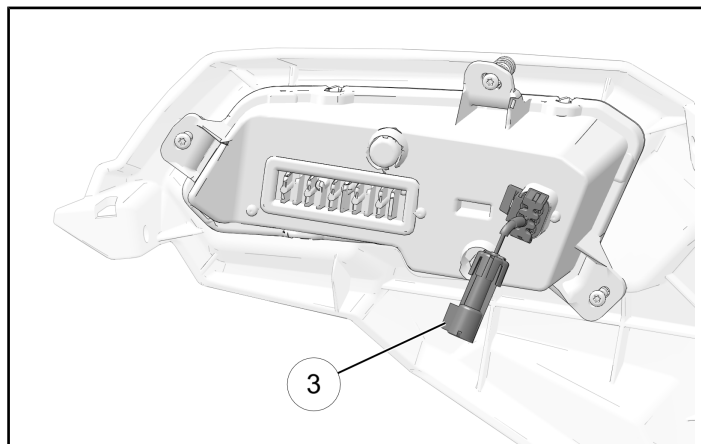

13. Connect the bumper light harness adapter ③ on the back of the new LED light into the wire harness on the vehicle.
14. Repeat steps 7 through 13 on the other side of the vehicle.
15. Install the front upper bumper back into the vehicle and install the left-hand and right-hand front upper bumper screws. Torque screws to specification.

#### NOTICE

Left-hand side shown.

#### TORQUE

Front Upper Bumper to Front Cab Screws:  
**18 in-lbs (2 N·m)**

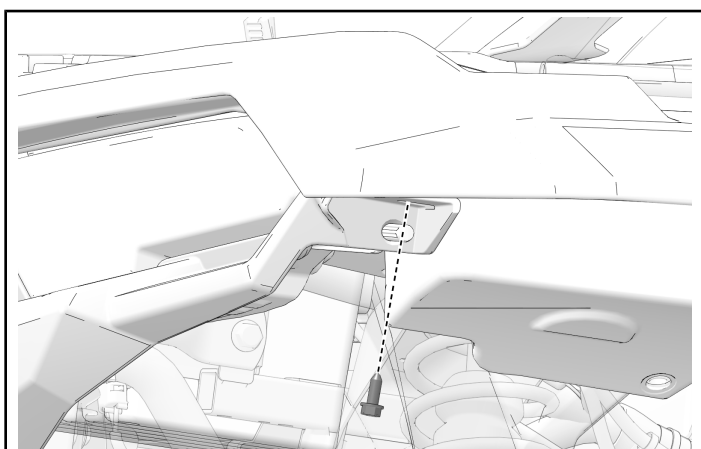

16. Gently lift up on the front of the front cab to install the two front upper bumper to chassis screws. Torque screws to specification.

#### TORQUE

Front Upper Bumper to Chassis Screws:  
**89 in-lbs (10 N·m)**

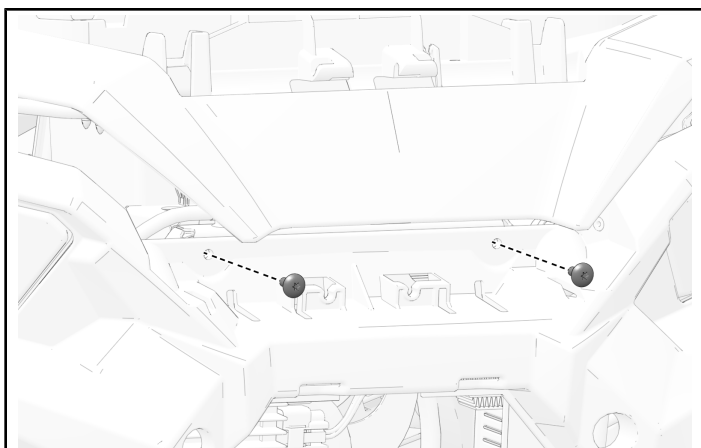

17. Open the front rack assembly and install the two front upper bumper to chassis screws as shown. Torque screws to specification.

#### TORQUE

Front Upper Bumper to Chassis Screws:  
**89 in-lbs (10 N·m)**

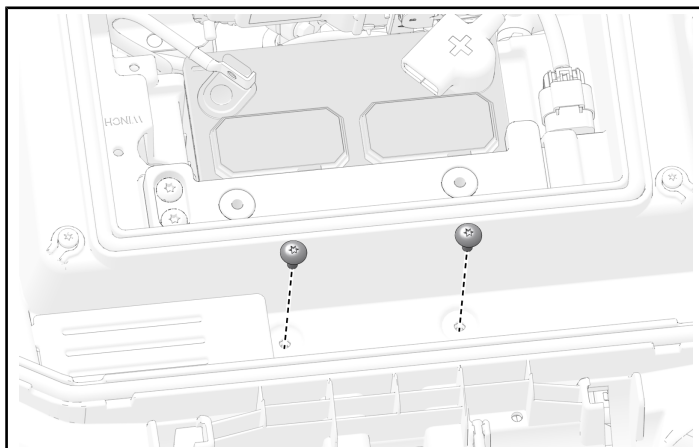

18. Install the front lower fascia cover back onto the vehicle and install the four front lower fascia cover screws. Torque screws to specification.

#### TORQUE

Front Lower Fascia Cover Screws:  
**89 in-lbs (10 N·m)**

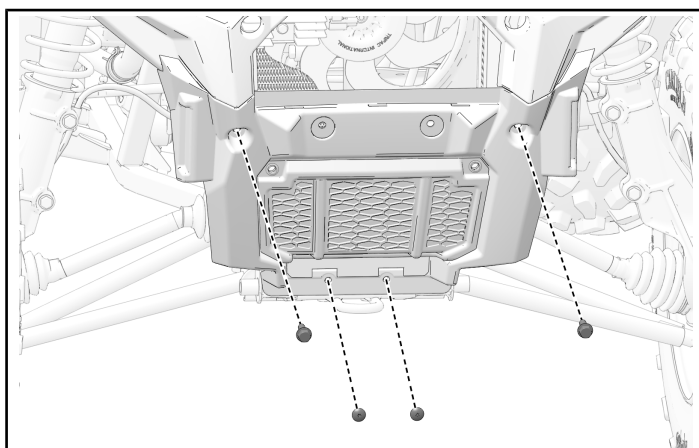

19. Install the radiator screen back into the front upper bumper.

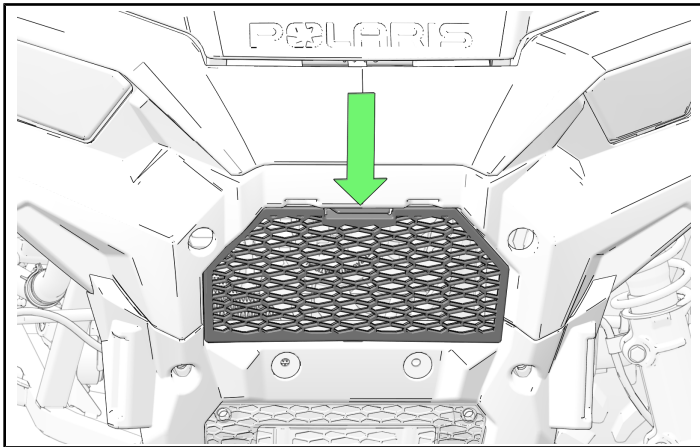

20. See the Owner's Manual for headlight adjustment. Tighten or loosen the three headlight adjuster screws ① on the back of each headlight to adjust the beam upward or downward or to the left or right.

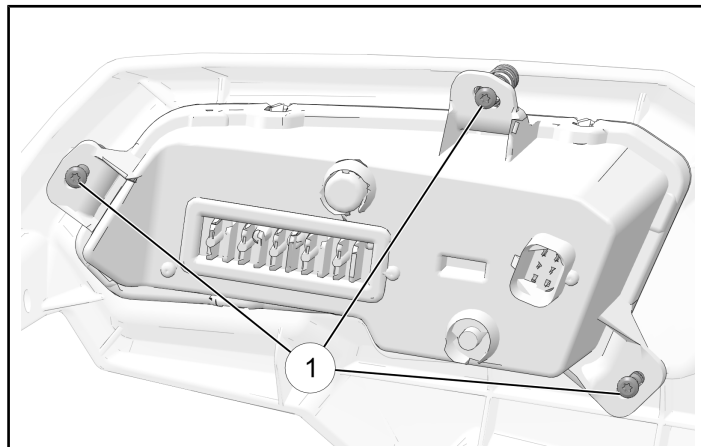

## INSTRUCTION FEEDBACK FORM

A feedback form has been created for the installer to provide any comments, questions or concerns about the installation instructions. The form is viewable on mobile devices by scanning the QR code or by clicking [HERE](#) if viewing on a PC.

