

# FENDER FLARE KIT



**P/N 2881673**

## APPLICATION

2016 GEM eL XD

## BEFORE YOU BEGIN

Read these instructions and check to be sure all parts and tools are accounted for. Please retain these installation instructions for future reference and parts ordering information.

## KIT CONTENTS

This Kit includes:

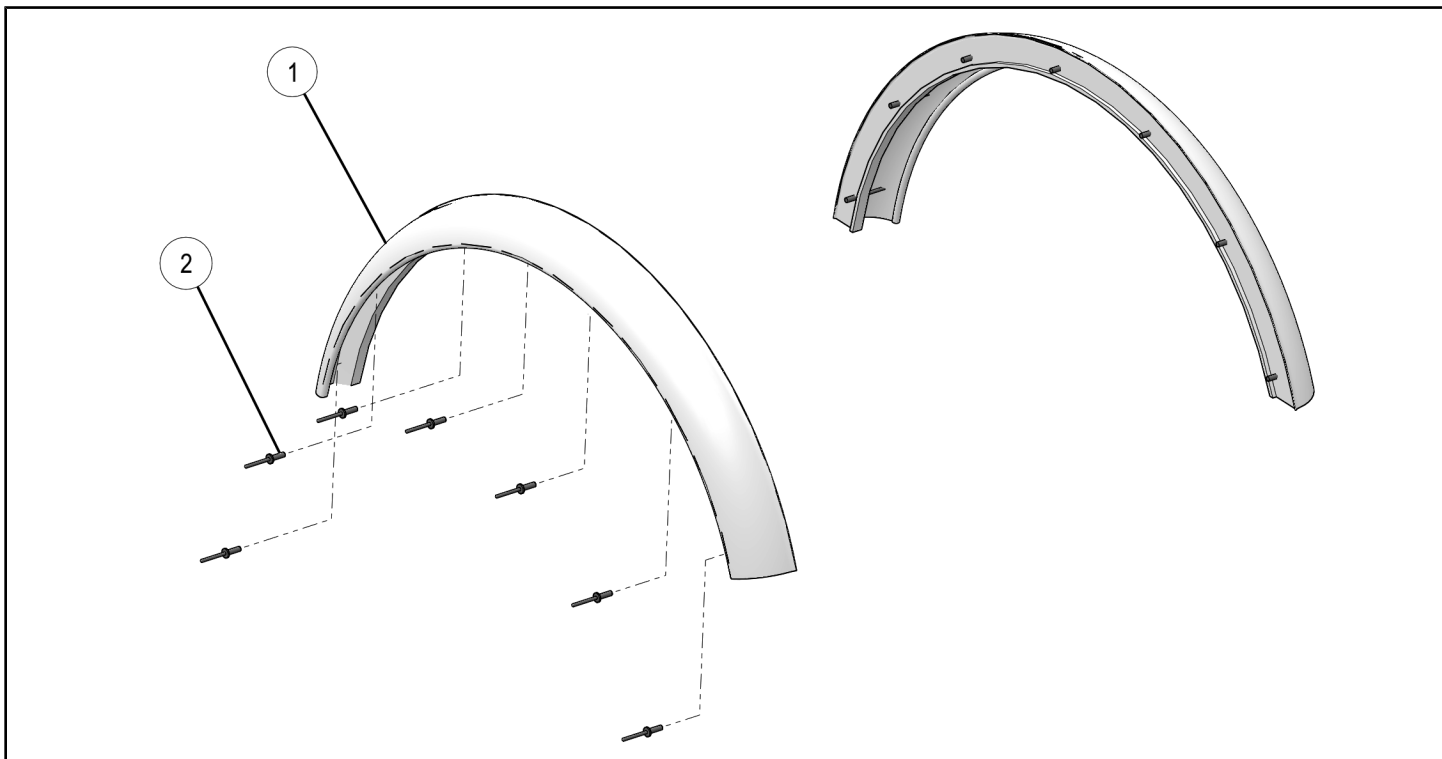

REF	QTY	PART DESCRIPTION	PART NUMBER
1	2	Rear Fender	5522164
2	14	Rivet, 3/16"	7662113
	1	Instructions	9926747

## TOOLS REQUIRED

- Drill Bit
- Power Drill

## IMPORTANT

Your FENDER FLARE KIT is exclusively designed for your vehicle. Please read the installation instructions thoroughly before beginning. Installation is easier if the vehicle is clean and free of debris. For your safety, and to ensure a satisfactory installation, perform all installation steps correctly in the sequence shown.

## ASSEMBLY TIME

Approximately 20 minutes

## INSTALLATION INSTRUCTIONS

### Rear Fender Flares

1. Align the rear fender flares ① with the eL XD body panel as shown. Make sure the flare lines up properly prior to marking or drilling mounting holes.
2. Start from the front of the vehicle, mark and drill the first hole using a 3/16" drill bit. Next insert a rivet ② into the hole to secure the flare in place.
3. Repeat Step 2 for the remaining six holes.

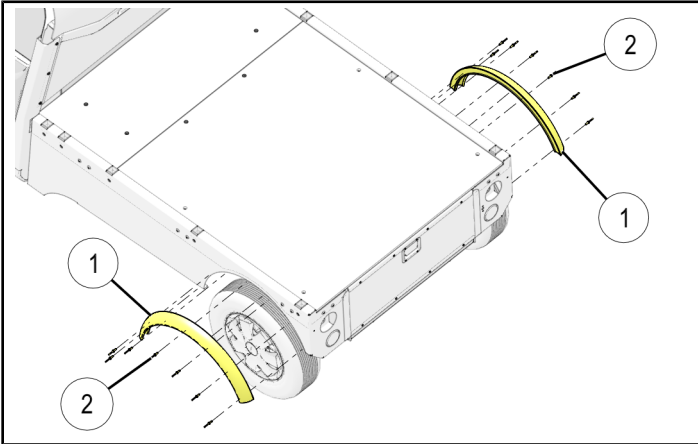

## CLEANING

1. Use an indirect high pressure water supply to rinse the large dirt particles from the fender flares.
2. Once the majority of dirt is removed, use warm soapy water and a cotton terry cloth to wash all fender flare components.
3. Rinse thoroughly and allow to air dry.