



INSTRUCTIONS

Product: GEM Electric Motorcars

Models: All 2005 Model GEM Vehicles



Subject: Stereo Accessory Installation Instructions

Estimated Completion Time: .75 Hours

Parts: See Page # 6

REQUIRED TOOLS & SUPPLIES:

- | | |
|----------------------------|--|
| (1) 3/8" Drive Ratchet | (1 Pair) Safety Glasses |
| (1) 3/8" Socket | (1) Wire Cutter |
| (1) Small felt tip Marker | (1) Needle Nose Pliers |
| (1) Drill | (1) Tape Measure |
| (1) Center Punch | (1) 6 Ft. of 18 Ga. Mechanics Wire |
| (1) Ø 1/4" Drill Bit | (2) Spring loaded Adjustable Shower Curtain Rods |
| (1) Ø 3/8" Drill Bit | (1) Tube of Epoxy |
| (6") Masking Tape | (1) Epoxy Gun |
| (1) Phillips Screwdriver | |
| (1) Small Flat Screwdriver | |
| (1) Med. Flat Screwdriver | |

WARNING!

To prevent personal injury or property damage: Switch the 72-volt Master Disconnect to "OFF", be sure the ignition switch is always in the "OFF" position and that the "KEY" is removed. Set the parking brake before servicing, adjusting, or repairing.

WARNING!

HIGH VOLTAGE



You could be seriously or fatally injured by electric shock if you attempt to open, repair, test, inspect or adjust. Only qualified technicians should open and service. Consult service manual.

The following instructions are for installing the Stereo accessory to all models of GEM cars.

To install the stereo, proceed as follows.

1. Switch master disconnect off. (See Fig. # 1.

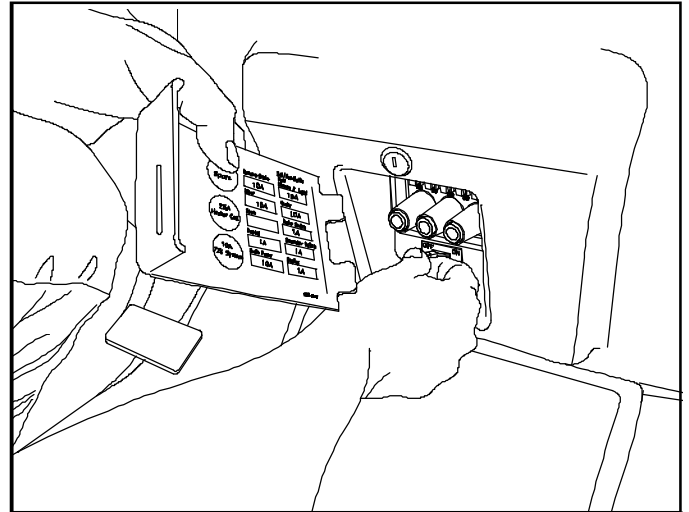

Fig. # 1 Switch the "Master Disconnect" off

2. Unclasp the hood latch. (See Fig # 2).

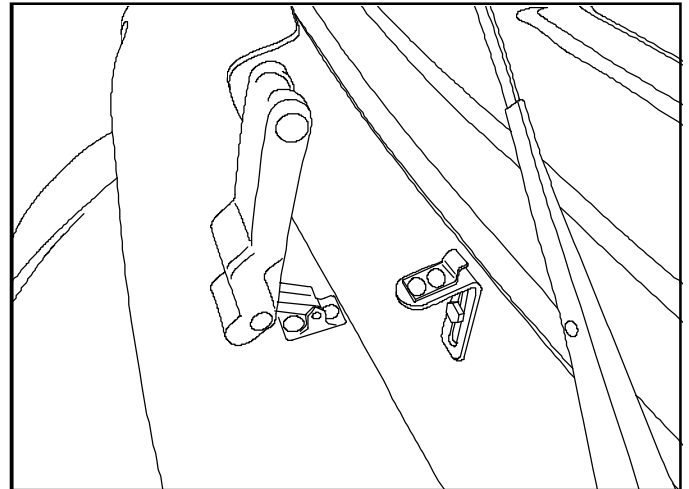

Fig. # 2 unclasp latch

3. Open the hood.

REMOVING THE DASH

- Loosen the Qty. two (2) dash mount bolts securing the upper dash located on the front of the lower windshield support. (See Fig. # 3)

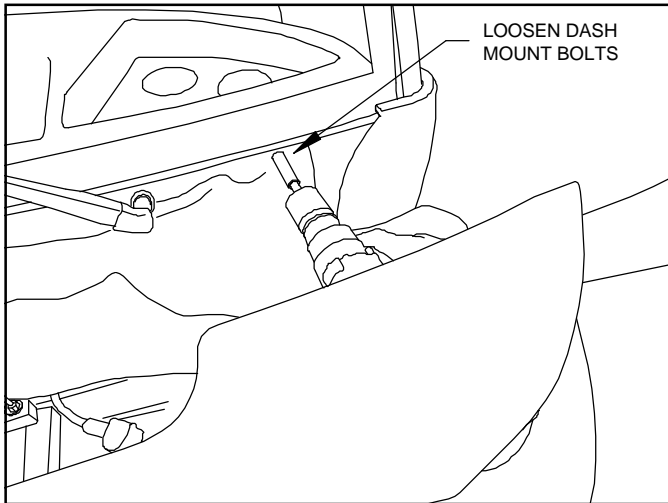

Fig. # 3 Loosen dash mount bolts

- Remove the upper dash by unlatching the velcro on the front of the dash, and lift upwards. Then remove the dash from the vehicle out the passenger side of the vehicle. (See Fig. # 4 & # 5)

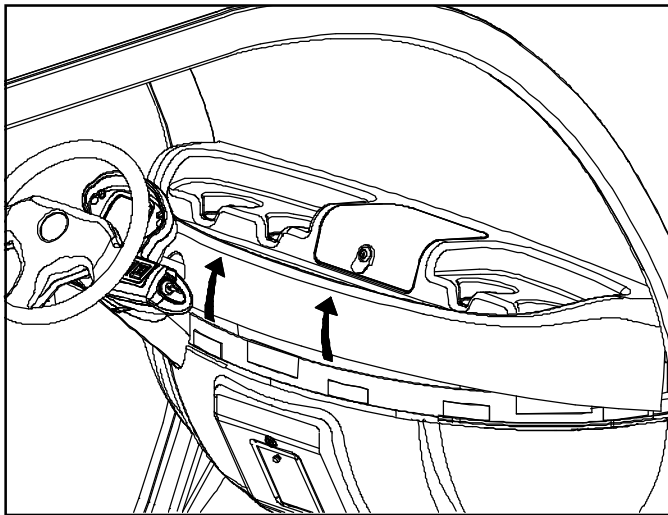

Fig. # 4 Remove upper dash

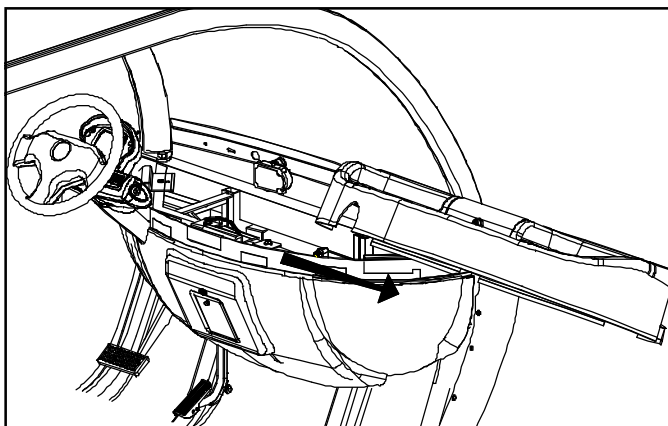

Fig. # 5 Remove upper dash

- Remove Qty. three (3) lower dash mounting bolts. (See Fig. # 6)

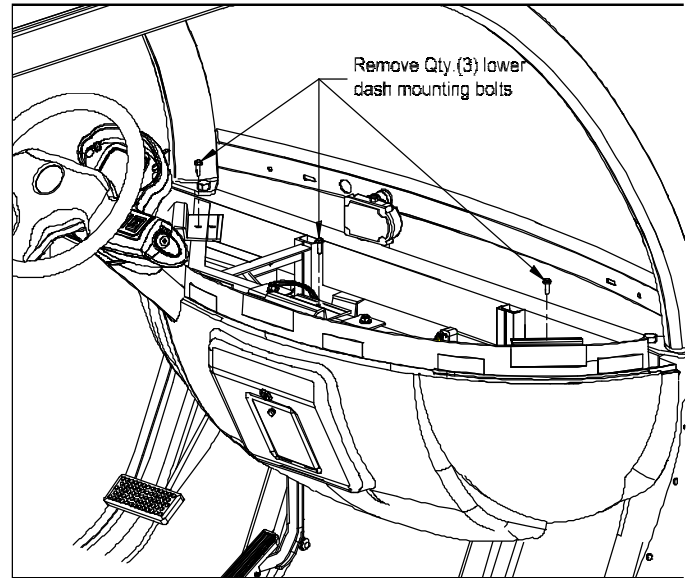

Fig. # 6 Remove lower dash mount bolts

REMOVING THE GRAB HANDLES

- Remove grab handles from each side of vehicle. First remove the plastic caps with a small flat tip screwdriver. Then remove the screws securing the grab handles. (See Fig. # 7)



Fig. # 7 Remove grab handles

LOCATING THE STEREO CONSOLE

9. Locate the stereo console on the inside roof of vehicle.
10. Mark the hole locations for the wiring harness to be routed at the driver side of vehicle on the roof rail and stereo console. (See Fig. # 8, 9, 10, & 11)



Fig. # 8 Mark hole locations for wiring harness

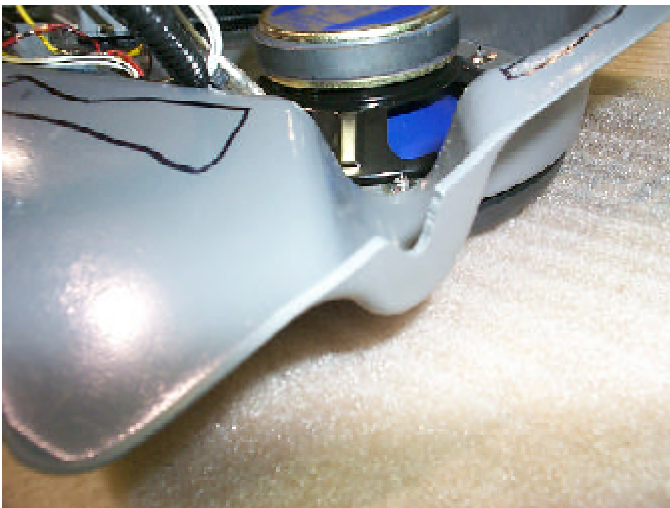

Fig. # 9 Align notch with hole to be drilled in roof rail



Fig. # 10 Mark roof rail 1/2" down from ceiling

11. Drill hole on upper roof rail to $\text{Ø}3/8$ " through one side of roof rail and console. Deburr holes after drilling.



Fig. # 11 Place a mark 3-1/4" from front window brace

12. Drill a $\text{Ø}3/8$ " hole at the lower inner corner of roof rail below dash.



Fig. # 12 Drill lower hole in roof rail

ROUTING WIRING HARNESS

13. Install (Qty. 2) bushings provided to protect the wires.
14. Use a 6Ft. length of 18 Ga. mechanics wire to form a fish tape and insert in the bottom hole and out the top hole.
15. Attach wiring harness to fish tape and pull down through bottom.
16. Dry fit the stereo console to roof to check for fit.
17. Apply epoxy to the stereo console at the locations shown in (Fig. # 13). Typically 3" long increment of epoxy and 3" to 4" center to center. Be sure to keep epoxy away from edge of console.

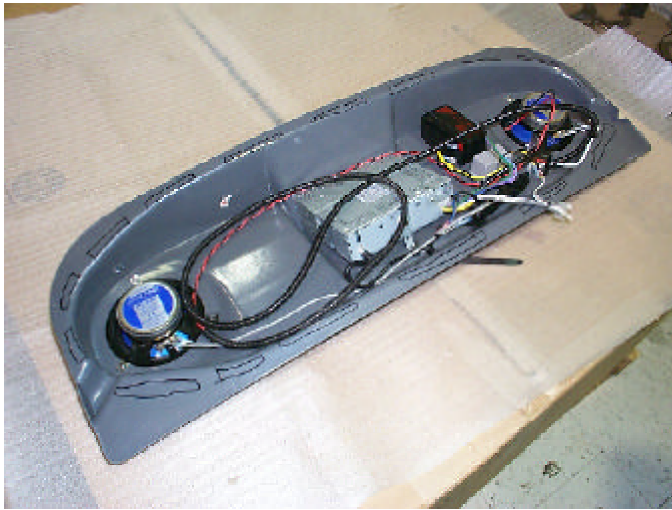

Fig. # 13 Apply epoxy to stereo console

18. Carefully fit console to roof and support by the spring loaded adjustable shower curtain rods. (See Fig. # 14)

IMPORTANT

Make sure console does not slip out of position after mounted to roof of vehicle.

19. Allow epoxy to dry as recommended per the epoxy manufacturer's directions.



Fig. # 14 Drill lower hole in roof rail

WIRING

20. Route the stereo wiring harness to the PSDM.
21. Terminate the **Red** and **Yellow** wires with the supplied female spades.
22. Terminate the **Black** wire with the supplied ring terminal.
23. Connect the **Red** wire to Spade # 1 (See Fig. # 15).
24. Connect the **Yellow** wire to Spade # 6 (See Fig. # 15).
25. Connect the black wire to the main ground. (See Fig. # 16)
26. Install a 10 amp fuse to **F10**. (See Fig. # 16)
27. Install a 1 amp fuse to **F3**. (See Fig. # 16)
29. Secure remaining wires with tie straps.

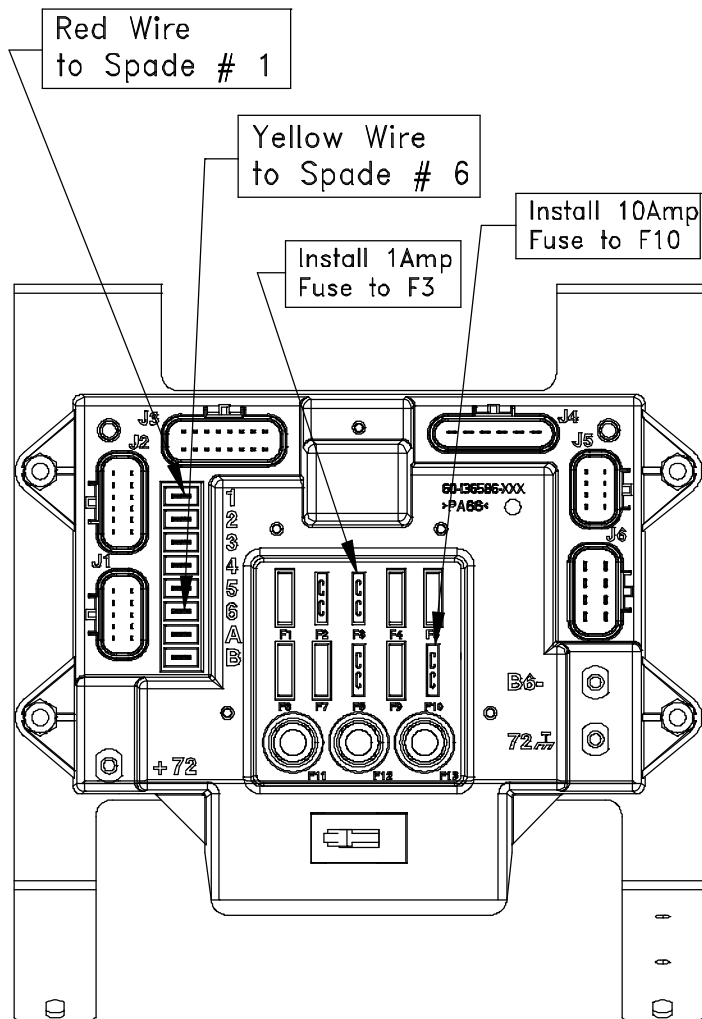

Fig. # 15 PSDM detail

RE-ASSEMBLY

31. Re-install grab handles to roof rail.
32. Install lower and upper dash in the reverse dis-assembly procedure.
33. Install safety decal to location shown in (Fig. # 16). Use P/N 0350-00549 for 2 passenger vehicles. Use P/N 0350-00548 for 4 passenger vehicles.
34. Close hood.
35. Turn master disconnect switch to the "ON" position.

NOTE: The stereo may stay on up to 20 seconds after the ignition is turned to the "OFF" position.



Fig. # 16 Stereo installation finished



Global Electric Motorcars, LLC

A DaimlerChrysler Company

Toll Free: 866.764.0616

Fax: 701.446.0105

e-mail: service@gemcar.com

Web Site: www.gemcar.com



PARTS

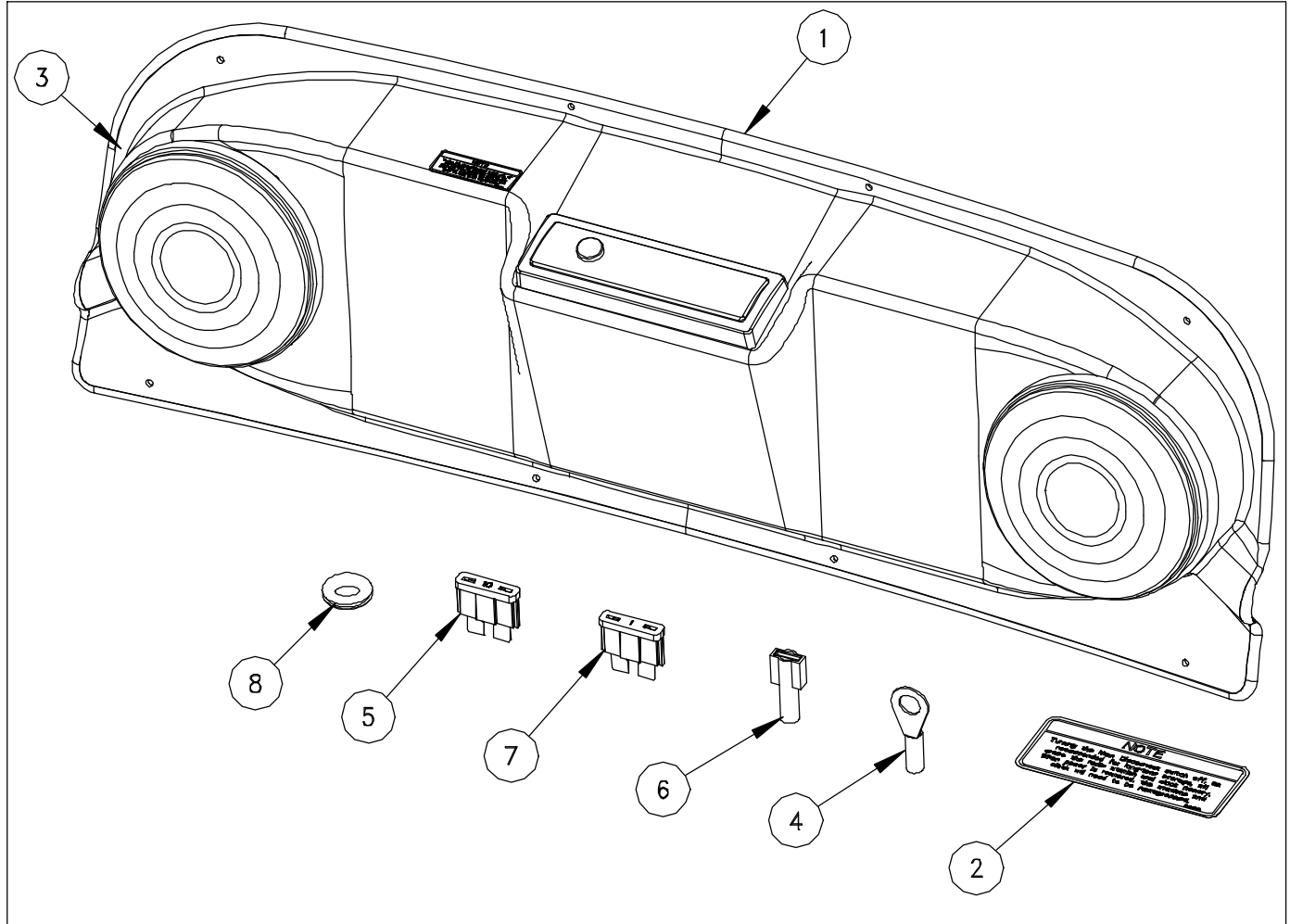

7

L0107-01224



Above: Shown installed in a 2 passenger GEM

ASSY, STEREO PACKAGE - 2005

<u>ITEM</u>	<u>PART NO.</u>	<u>DESCRIPTION</u>	<u>QTY.</u>
1	0106-01218	ASSY, STEREO PACKAGE OVERHEAD CONSOLE 05	1
2	0350-01504	DECAL, RADIOMEMORY	1
3	0408-00139	ADVESIVE, METHACRYLATE	1
4	0606-00095	TERMINAL, RING 22-18 - 1/4 - RED	1
5	0606-00293	FUSE, ATC-10	1
6	0606-00403	TERMINAL, SPADE - FEMALE INSULATED 1/4", 22-18 GA	1
7	0606-00476	FUSE, ATC-1	1
8	0619-00359	BUSHING, OPEN/CLOSE -.50 INCH HOLE	1
9	0107-01224	ASSY, STEREO PACKAGE - 2005 (Includes All of the items above)	1