



COVER SHEET

Short Bed Conversion Installation Instructions

REV. 2 03/24/11

* The information contained in the attached document is of the latest released version. Use this as a reference. Insert the document in to the Service Publications Reference Guide Manual (Part # 1010-00223), Section 4 – Installation Instructions.

NOTICE – CONFIDENTIAL INFORMATION

The information contained in this communication is privileged and strictly confidential. It is intended solely for the use of the individual or entity on the mailing address. If the reader of this message is not the intended recipient, or the employee or agent of the intended recipient, please notify the sender immediately and then delete the communication from all data storage devices and destroy all hard copies. Any unauthorized dissemination, distribution, copying or other use of the information contained in this communication is strictly prohibited.



Short Bed Conversion Instructions

Models: e2 & e4

Part No: 0107-03808

Table of Contents:

<i>Bed Assembly</i>	1
<i>Bed Installation</i>	7
<i>NY (New York) Reverse Light – (Optional)</i>	9
<i>Back Panel Latch Plate Cover Installation</i>	12
<i>Parts List</i>	13

Procedure:

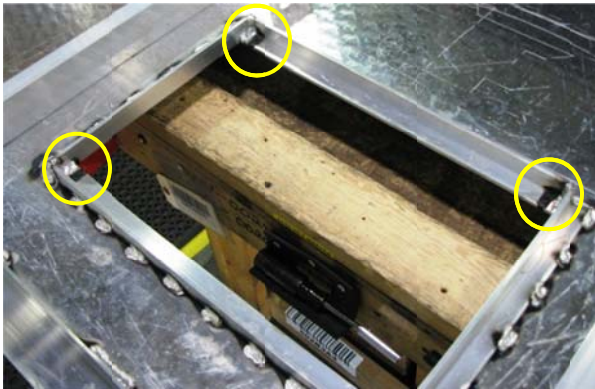
<i>Bed Assembly</i>	
1. Unpack materials from package.	<ul style="list-style-type: none"> ▪ Lay out all materials in a clean environment so as not to harm the bed during installation.
2. Locate a clean, flat workspace.	<ul style="list-style-type: none"> ▪ Move the bed onto a work space. ▪ Short beds are heavy and may require the assistance from another person. <p>PN: 0105-02318 ASSY, BED SHORT W/COVER</p>
3. Attach J-nuts. 	<ul style="list-style-type: none"> ▪ Around the battery access port there is four (4) holes. ▪ Attach the provided extruded J-type nut clips, one to each hole. ▪ See picture to left. <p>PN: 0521-00385 NUT, EXTRUDED J - #8 - BLK</p>

4. Attach Battery Access Panel cover.

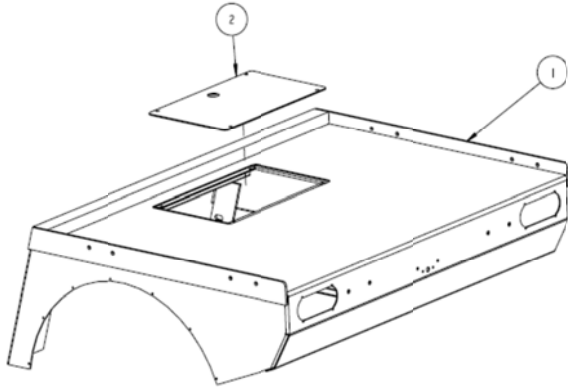

- Place the Battery Access Panel in the opening of the bed. The hole should be oriented towards the front.
- Align each of the four (4) mount holes to the previously installed J-nuts.
- Using the screws provided, secure the cover with a #2 Phillips screwdriver.
- See picture to left. Item 1 – Bed, Item 2 – Bed Cover.

PN: 0523-00397 SCREW, PHILLIPS - FLAT HEAD - #8 X 3/4 TAPPING, ZINC PLATED

5. Attach rubber Fender Flare.



- Cut Rubber Fender Flare to a manageable length to work with, approximately 39" is finished cut so be sure to allow extra.
- Align one clean cut end of the rubber to the surface edge of the bed.
- See picture to left.
- Hold the rubber fender in place with a clamp.
- Then, using a 3/16" drill bit, drill through the pre-drilled holes of the bed, using these holes as a guide to drill through the rubber.
- Using the provided rivets (14), push the rivets through the fender and bed before setting the rivet.
- Continue along fender tight against the curve.
- Pull and set each rivet with a Rivet Gun.

PN: 0418-00223 - EXTENSION, FENDER FLARE - RUBBER

PN: 0520-00430 - RIVET, BLIND - 3/16" BDY DIA, 3/8" DOME HEAD 1/4-3/8 AL

6. Cut fender for finished edge.



- Using a utility knife cut the excess fender smooth and level with the edge of the bed.
- See picture to left.

7. Install wire harness.



- Flip bed over on workspace.
- Lay harness into bed.
- Harness runs along the RH side bed support as shown.
- See picture to left.
- RH light wires: shorter
- LH light wires: longer

PN: 0106-03353 – ASSY, WIRE HARNESS – TAIL LAMP

8. Secure the wire harness.



- Using the clamps provided, secure the wire harness to the support bar of the bed.
- Use two (2) clips on the support.
- Using the screws provided attach the clamps to the bed support to secure the wire harness.
- See picture to left.

PN: 0510-00154 CLAMP, P 3/8 STL/BLK VINYL COATED

PN: 0523-00032 SCREW, HEX - WASHER HEAD SELF DRILL 1/4

9. Light installation.



- Insert the rubber grommet of the tail lights into the rear openings of the bed.
- Insert light into rubber grommet. The plastic lens has "TOP" written on it. Insert light to correct orientation.

HINT: Fitment of the light is snug. Start one side and a firm push or a slight tap with a light rubber mallet will slide the other side of the taillight in to place.

- See pictures to left.
- Connect the taillights to the wire harness. Press firmly to ensure a proper fit.

PN: 0606-00144 - LIGHT, TAIL – SEALED – UTILITY BED

PN: 0606-00145 – GROMMET, RUBBER – TAIL LIGHT – UTILITY BED

10. Attach the license plate bracket.

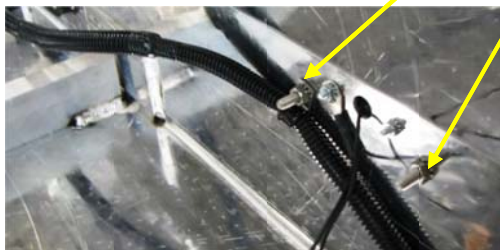
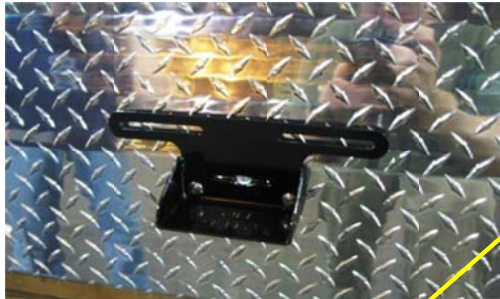

- The license plate bracket bolts through the rear of the bed.
- Using the provided hardware (nuts & bolts) secure the bracket to the bed.
- Tighten bolts with a T27 Torx bit driver.
- See pictures to left.

PN: 0251-00250 WLD, BRACKET- PLATE - LICENSE REAR

PN: 0522-00333 BOLT, TORX - TRUSS HEAD - 1/4 - 20 X 1

PN: 0521-00071 NUT, KEPS - 1/4 - 20 UNC ZINC PLATED

NOTE: For New York vehicles or those with optional Reverse Light, skip to Step 19.

11. Attach the license plate light.



- License plate light cover is removable. You will need to remove the lens cover to get proper access to bolt on the light.
- Using the hardware provided (nuts & bolts) bolt through the light, bracket, and bed.
- Connect the wire harness black wire with ring terminal to one of the bolts of the license plate light. Secure the wire and bolt with a provided nut in the kit.
- Tighten the bolts with a #2 Phillips screwdriver.
- See picture to left.

PN: 0606-00206 KIT, LICENSE PLATE LAMP

PN: 0523-00282 SCREW, MACHINE - 8-32 x 3/4" PHILLIPS PA

PN: 0521-00317 NUT, KEPS - 8-32 ZINC PLATED

12. Screw cover on light.



- Using a #2 Phillips screwdriver, secure the cover of the license plate light in place.
- DO NOT over tighten.
- See picture to left. (shown upside down)

13. Locate rear decals.

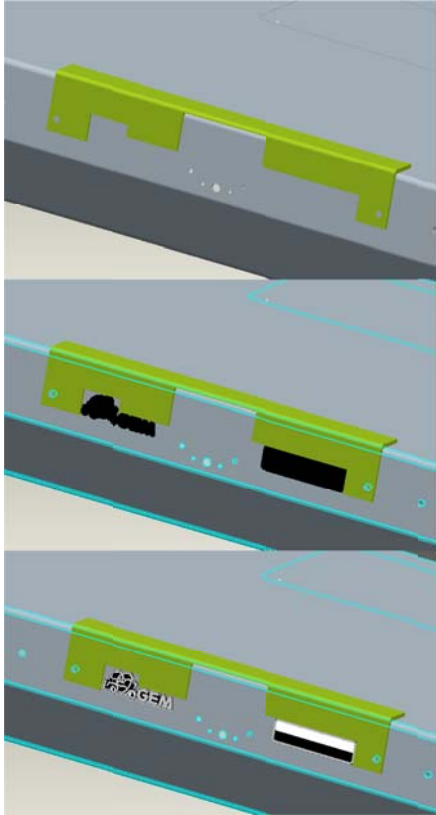

- Rear decals are centered on backer plates.
- Each decal is located center of the tail light and license plate light. (Use the pictures to left as a reference only.)
- Press firmly to adhere backer plate to the valleys of the diamond plate.
- Adhere decal to the backer plate.

PN: 0110-02813 - ASSY, DECAL BACKER PLATE - REAR BED

PN: 0350-03144 - DECAL, REAR EMBLEM - COMPANY NAME

PN: 0110-03112 - ASSY, DECAL BACKER PLATE - REAR BED

PN: 0350-03259 - DECAL, REAR EMBLEM - COMPANY LOGO

14. Adhere side reflectors.



- Place the red reflector at the rear of the side, along the lower edge on the side member. Apply to both sides.
- See pictures to left.

PN: 0350-00542 - DECAL, REFLECTORS

15. Locate Cargo Warning decal.



- The Cargo Warning load decal is to be placed on the driver's side of the vehicle.
- Place it on the flat aluminum surface above the fender.
- Use the correct limit decal to the model of the vehicle.

E2	E4
330 lbs	250 lbs

- Note the location shown in the picture to the left. The stake pocket location is between the reflector and decal.

PN: 0350-03255 - DECAL, WARNING - PAYLOAD E4

PN: 0350-02495 - DECAL, WARNING - PAYLOAD ES

Bed Installation

16. Bolt in frame.

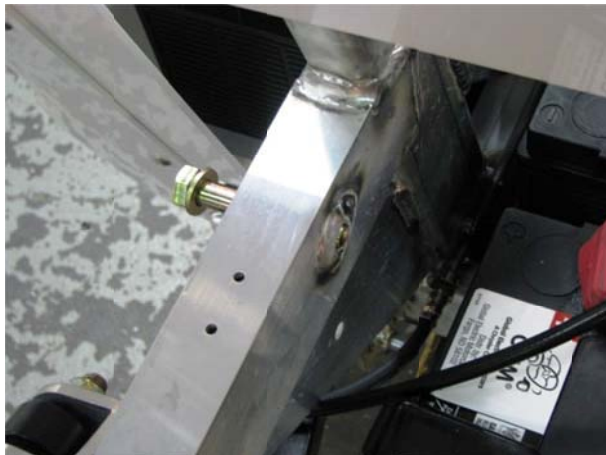

- Use a 1/2" drill bit to clear the holes in the frame.
- Insert bolts with washers into the frame. Bolts even with inside edge of frame ready for the bed.
- See picture to left.

PN: 0522-00076 BOLT, HEX - 1/2 - 13 UNC X 3.0 GR 8

PN: 0524-00115 WASHER, FLAT - M12 13mm ID x 24mm OD x 2

17. Bolt through tab of bed.



- Use caution so as not to hit the body panels while moving the bed.
- Lift the assembled short bed in to place with the front tabs to be in between the frame rails.
- Bolts are now pushed thru the bed tabs and will hold it in place. Secure with nuts.
- Leave loose for now until other mounting bolts are in to position.
- See picture to left.

PN: 0521-00024 NUT, HEX FLANGE - TECH LOCK 1/2 - 13 UNC

18. Bolt bed to frame.





- Raise vehicle to work comfortably under the bed if necessary.
- Bolt through the bed support and frame. Leave loose until all four (4) mounting bolts are in position.
- Washer under bolt and nut.
- Then tighten and secure the bed to the frame of the vehicle with the installed hardware – 9/16” wrenches and 3/4” wrenches needed.
- See picture to left.

PN: 0522-00063 BOLT, HEX - 3/8 - 16 UNC X 1.0 GR 5

PN: 0524-00009 WASHER, FLAT - 3/8 SAE

PN: 0521-00010 NUT, HEX - NYLOCK - 3/8 - 16 UNC

<p><i>NY (New York) Reverse Light – (Optional)</i></p>	
<p>19. Prepare the Reverse light.</p> 	<ul style="list-style-type: none"> ▪ Remove light cover. ▪ Prepare the light by running the black wire through the hole in the backing plate. ▪ Strip and crimp a ¼" male spade connector to the wire. (not shown) ▪ See picture to left. <p>PN: 0606-00207 KIT, REVERSE LAMP PN: 0606-00117 TERMINAL, SPADE-MALE INSULATED 1/4"18-22</p>
<p>20. Locate mount position for bracket and light.</p> 	<ul style="list-style-type: none"> ▪ Use the appropriate license plate bracket with reverse light for this option. (See Step 21) ▪ Use the bracket as a jig to drill holes for the light to the center rear of the bed. The license plate should line up with previous holes for the bracket as it does in Step 10. ▪ Drill the four (4) holes with a 5/32" drill bit. ▪ Drill the offset holes with a ½" drill bit. ▪ See picture to left as reference only.
<p>21. NY license plate bracket.</p> 	<ul style="list-style-type: none"> ▪ Bolt the NY license plate bracket to the rear of the bed. ▪ Secure light harness with a C-clamp. (not shown) ▪ Leave bolts loose to allow alignment of the lights. <p>PN: 0251-00322 WLD, BRACKET -REAR LIC PLATE W/REV LAMP PN: 0522-00333 BOLT, TORX - TRUSS HEAD - 1/4 - 20 X 1 PN: 0510-00154 CLAMP, P 3/8 STL/BLK VINYL COATED PN: 0521-00071 NUT, KEPS - 1/4 - 20 UNC ZINC PLATED</p>

22. Install reverse light.



- Use gasket that came with light.
- Bolt light and gasket to bracket and bed.
- Secure using a #2 Phillips screwdriver.
- See picture to left. (shown upside down)

PN: 0523-00282 SCREW, MACHINE - 8-32 x 3/4" PHILLIPS PA

PN: 0521-00317 NUT, KEPS - 8-32 ZINC PLATED

23. Install license plate light.



- Install License plate light same as standard bracket, noted in Step 11 above.
- Ground wire of license plate light will also ground the reverse light.
- Tighten all bolts in lights and bracket using a T27 Torx driver and a #2 Phillips screwdriver
- See picture to left. (shown upside down)

PN: 0606-00206 KIT, LICENSE PLATE LAMP

PN: 0523-00282 SCREW, MACHINE - 8-32 x 3/4" PHILLIPS PA

PN: 0521-00317 NUT, KEPS - 8-32 ZINC PLATED

24. Screw covers on to lights.



- Using a #2 Phillips screwdriver, secure the cover of the license plate light in place.
- DO NOT over tighten.
- See picture to left.

25. Route the yellow wire.





- Strip and crimp a ¼" female spade connector on to the yellow wire.
- Connect to the black wire of the reverse light. This is the power lead.
- Run the yellow wire along the wire harness under the bed. Cut it about the same length as the wire harness. (Approximately 60")
- Strip and crimp a ¼" male spade connector to the end of the yellow wire.
- See picture to left.

PN: 0406-00281 WIRE, YELLOW - 18 GA
PN: 0606-00108 TERMINAL SPADE-FEMALE INSULATED 1/4"14-16
PN: 0606-00117 TERMINAL, SPADE-MALE INSULATED 1/4"18-22

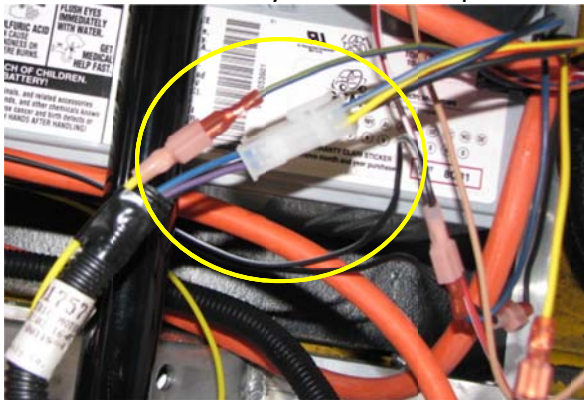
26. Connect the yellow wire to power.

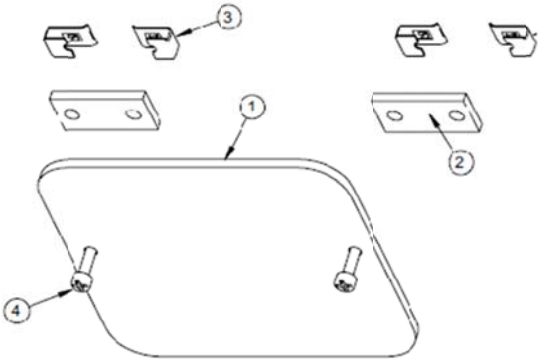

- While installing the bed (see Step 16), connect the yellow wire to the Blue/Yellow wire of the rear harness located under the base of the Bench style seat.
- Connect the 4-pin white Molex plug in to its mating connector as well.
- See picture to left.

<i>Back Panel Latch Plate Cover Installation</i>	
<p>27. Assemble Latch Plate Cover.</p> 	<ul style="list-style-type: none"> ▪ Assemble the plastic tabs. ▪ Attach provided extruded J nuts (qty 4) to the plastic tabs using the screws provided, securing them through the latch plate cover. (You will need to drill two more holes, one on the opposite ends of the tabs, using a 3/16" drill bit). ▪ See illustration to left. <p>PN: 0305-01796 PLATE, COVER – PACK LATCH PN: 0305-01797 PLATE, FILLER - TAB EU PN: 0521-00385 NUT, EXTRUDED J - #8 - BLK PN: 0523-00458 SCREW, #8 X 1" PAN PHILLIPS T/A - SS EU</p>
<p>28. Attach Pack Latch Cover assembly.</p> 	<p>HINT: The rear seat base and back may need to be removed for best accessibility.</p> <ul style="list-style-type: none"> ▪ The assembly will need to be fitted to the Back Panel opening. ▪ The plastic tabs will be secured inside the back panel using screws from the outside. ▪ Hold the assembly in the opening so the face of the cover goes into the opening and the tabs are on the outside of the back panel. ▪ Using a pencil, mark the tab locations. ▪ Locate the center of the tabs locations from the holes already drilled in the tabs from the step above and mark a center hole location. ▪ Using a 3/16" drill bit drill the holes on each side of the back panel for the tab mounting screws. ▪ Using the two remaining screws provided secure the tabs to the back panel. ▪ Set the cover in place and secure the cover. ▪ See picture to left.
<p>29. Installation Complete.</p>	<ul style="list-style-type: none"> ▪ Done.

[Go to Top](#)

Parts List:

0107-03808 ASSY, BED - E2 E4 CONVERSION

<u>NO.</u>	<u>PART NO.</u>	<u>PART DESCRIPTION</u>	<u>QTY</u>
1	0105-02318	ASSY, BED SHORT W/COVER	1
2	0106-03353	ASSY, WIRE HARNESS - TAIL LAMP, ES	1
3	0251-00250	WLD, BRACKET- PLATE - LICENSE REAR	1
4	0305-01796	PLATE, COVER - PACK LATCH EU	1
5	0305-01797	PLATE, FILLER - TAB EU	2
6	0350-00542	DECAL, REFLECTORS	2
7	0350-02495	DECAL, WARNING - PAYLOAD ES	1
8	0350-03255	DECAL, LOAD - BED, E4	1
9	0418-00223	EXTENSION, FENDER FLARE - RUBBER	8FT
10	0510-00154	CLAMP, P 3/8 STL/BLK VINYL COATED	4
11	0520-00430	RIVET,BLIND-3/16"BDIA, 3/8" DHEAD1/4-3/8	14
12	0521-00010	NUT, HEX - NYLOCK - 3/8 - 16 UNC	2
13	0521-00024	NUT, HEX FLANGE - TECH LOCK 1/2 - 13 UNC	2
14	0521-00071	NUT, KEPS - 1/4 - 20 UNC ZINC PLATED	2
15	0521-00317	NUT, KEPS - 8-32 ZINC PLATED	2
16	0521-00385	NUT, EXTRUDED J - #8 - BLK	8
17	0522-00063	BOLT, HEX - 3/8 - 16 UNC X 1.0 GR 5 ZN	2
18	0522-00076	BOLT, HEX-1/2-13 UNC X 3.0 GR 8 ZN YELLO	2
19	0522-00333	BOLT TORXTRUSSHD 1/4-20X1T-27 DR 18-8 SS	2
20	0523-00032	SCR,.25-14X.75,HFL,SD,,CZ	4
21	0523-00282	SCREW, MACH 8-32x3/4" PHILLIPS PAN HD ZN	2
22	0523-00397	SCR,PHIL FLT HD SLFTAPPNG #8x.75, 82D ZN	4
23	0523-00458	SCREW, #8 X 1" PAN PHILLIPS T/A - SS	4
24	0524-00009	WSH, FLT 3/8 SAE .406 IDx.8125ODx .80 ZN	4
25	0524-00115	WSHR, FLT-M12 13MM IDx24MM OD x 2.5MMTHK	4
26	0606-00117	TERMINAL, SPADE-MALE INSULATED 1/4"18-22	3
27	0606-00144	LIGHT, TAIL - SEALED - UTILITY BED	2
28	0606-00145	GROMMET, RUBBER - TAIL LIGHT - UTILITY B	2
29	0606-00206	KIT, LICENSE PLATE LAMP	1
30	0350-03259	DECAL, REAR EMBLEM - COMPANY LOGO	1
31	0350-03144	DECAL, REAR EMBLEM - COMPANY NAME	1
32	0110-02813	ASSY, DECAL BACKER PLATE - REAR BED	1
33	0110-03112	ASSY, DECAL BACKER PLATE - REAR BED	1

[Go to Top](#)