

# LADDER RACK KIT



**P/N 2881663**

## APPLICATION

2016 eL XD

## BEFORE YOU BEGIN

Read these instructions and check to be sure all parts and tools are accounted for. Please retain these installation instructions for future reference and parts ordering information.

## KIT CONTENTS

This Kit includes:

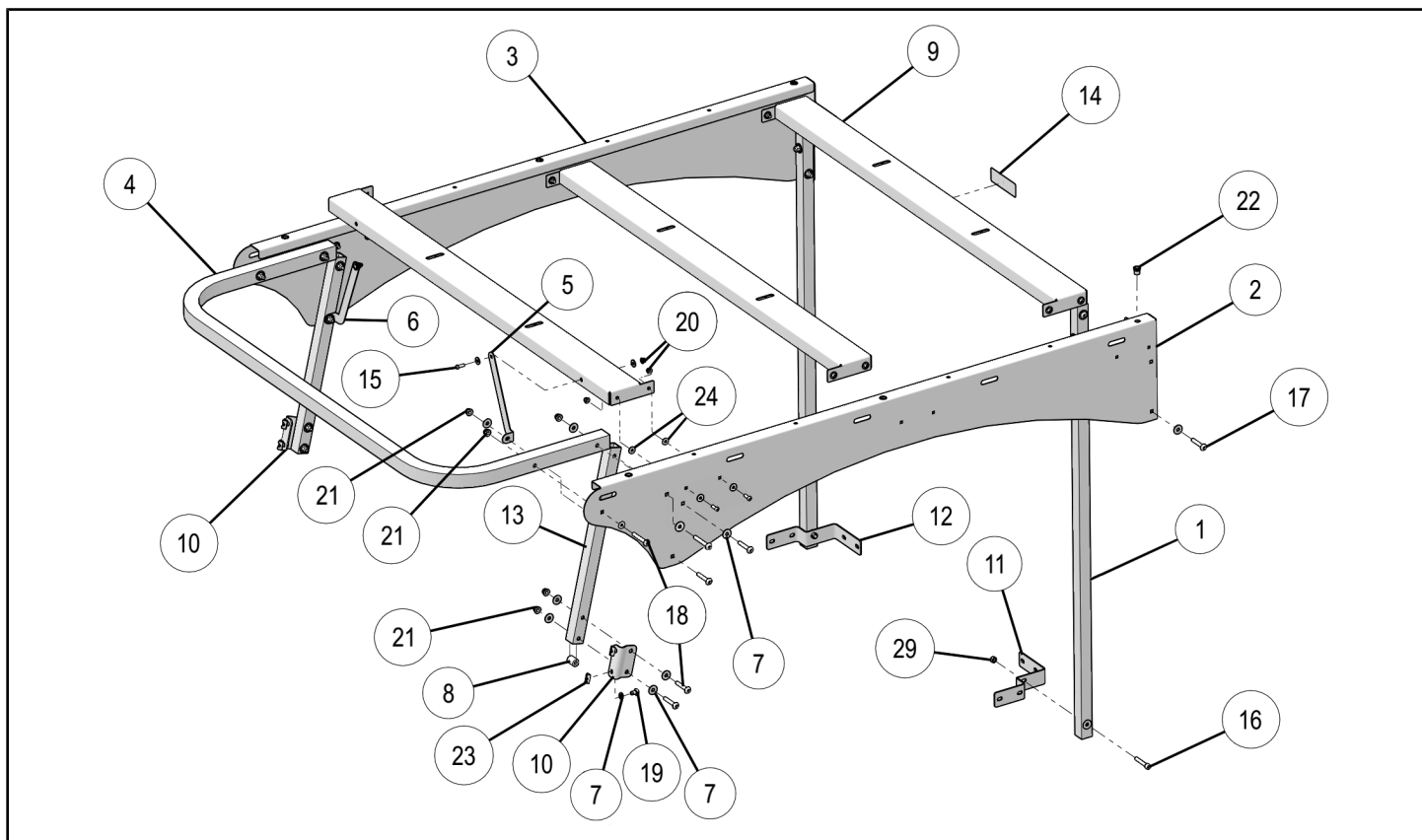

REF	QTY	PART DESCRIPTION	PART NUMBER
1*	2	Rear tube, Roof	5339446
2*	1	Panel, LH, Roof	5261914
3*	1	Panel RH, Roof	5261915
4*	1	Front tube, Roof	5339407
5*	1	Support bracket, LH	5262246
6*	1	Support bracket, RH	5262256
7	44	Washer - 8.4 X 16.0 X 1.6	7556305
8	6	Spacer, Roof	5140044

REF	QTY	PART DESCRIPTION	PART NUMBER
9	3	Support Bracket, Roof	5261916
10	2	Support Bracket, OPS, Roof	5262878
11	1	Support Bracket, Bed, Roof, Rack, LH	5262923
12	1	Support Bracket, Bed, Roof, Rack, RH	5262939
13	2	Tube Support, Roof, Rack, Front	5339825
14	1	Decal, Load Leader, Rack	7178186
15	14	Screw, Hex Button Head - M6 X 1.0 X 20	7517391
16	2	Screw, Socket Head - M8 X 1.25 X 40	7519895
17	6	Screw, Torx® Button Head - M8 X 1.25 X 50	7520307
18	12	Screw, Torx® - M8 X 1.25 X 60	7520367
19	6	Screw, Torx® - M8 X 1.25 X 15	7520391
20	14	Nut, Hex Flange - M6 X 1.0	7547453
21	22	Nut, Hex Flange - M8 X 1.25	7547454
22	6	Nut, Rivnut - M8 X 1.25	7547788
23	4	Nut, Roll-in - M8 X 1.25	7547806
24	28	Washer - 6.4 X 18.0 X 1.6	7556064
	1	Instructions	9926733

Items marked (\*) are included in Roof Assembly PN 2636203.

## TOOLS REQUIRED

- Safety Glasses
- Torx® Bits
- Metric Ratchet Set
- Internal Hex Bit

## IMPORTANT

Your LADDER RACK KIT is exclusively designed for your vehicle. Please read the installation instructions thoroughly before beginning. Installation is easier if the vehicle is clean and free of debris. For your safety, and to ensure a satisfactory installation, perform all installation steps correctly in the sequence shown.

## ASSEMBLY TIME

Approximately 60 minutes

## INSTALLATION INSTRUCTIONS

1. Shift vehicle transmission into "PARK". Turn key to "OFF" position and remove from vehicle.
2. Install support brackets ⑨ to LH panel ② with bolts ⑮, washers ⑳, and nuts ㉔. Attach LH panel ② to rear support bracket with screw ⑲, washers ⑦, and nut ㉑. Torque fasteners to specification.

### TORQUE

Side Nuts ㉔: 12 ft. lbs. (16.3 Nm)  
Rear Nut ㉑: 17 ft. lbs. (23 Nm)

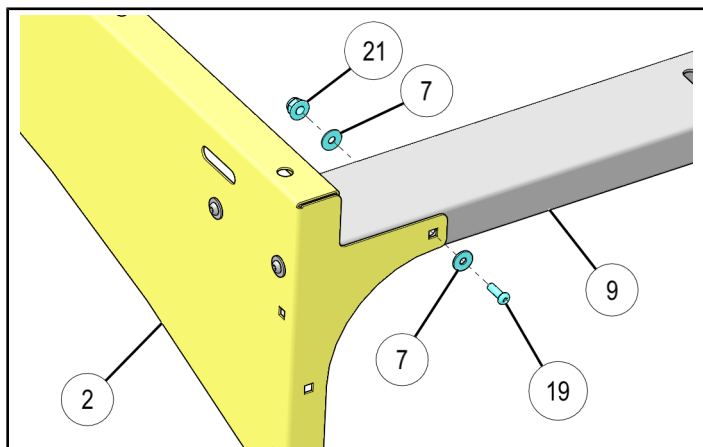
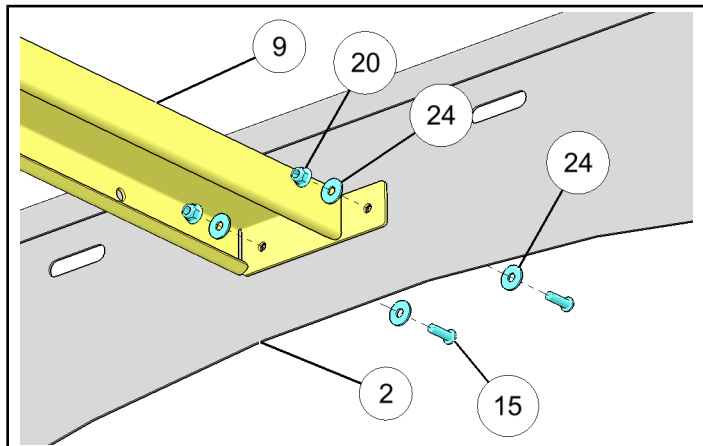

3. Attach the RH panel ③ to support brackets with bolts ⑮, washers ⑳, and nuts ㉔. Attach RH panel ③ to rear support bracket with screw ⑲, washers ⑦, and nut ㉑. Torque fasteners to specification.

### TORQUE

Side Nuts ㉔: 12 ft. lbs. (16.3 Nm)  
Rear Nut ㉑: 17 ft. lbs. (23 Nm)

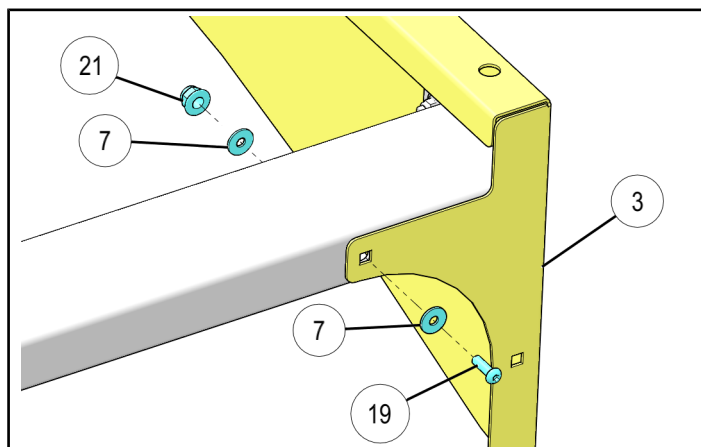
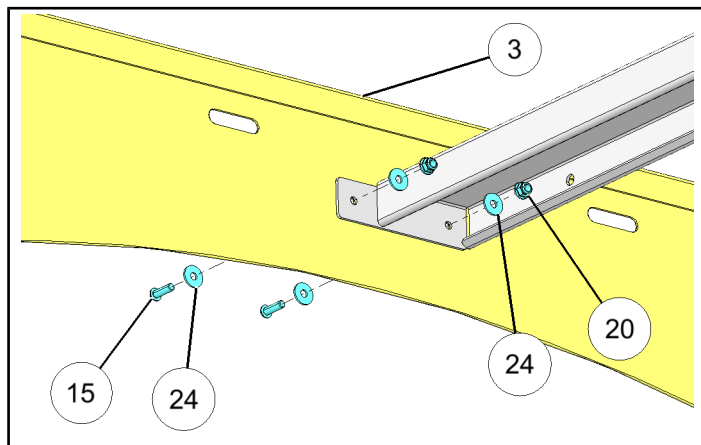

- Attach the front tube ④ at both sides with bolts ⑱, washers ⑦, and nuts ⑳. Torque to specification.

### TORQUE

17 ft. lbs. (23 Nm)

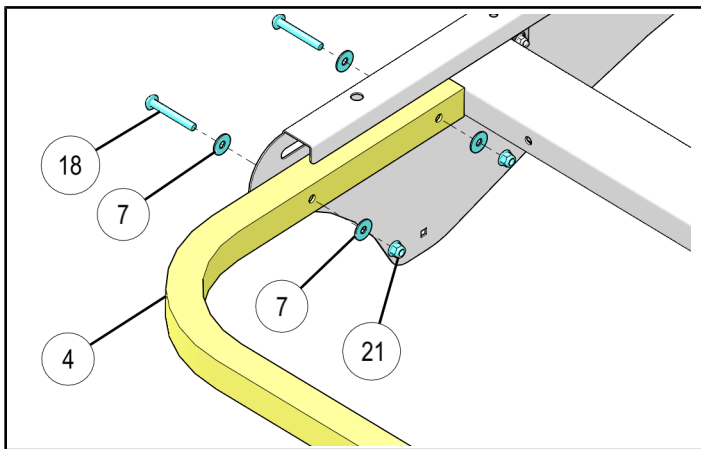

- Attach front support tube ⑬ one on each side with bolts ⑰, washers ⑦, and nuts ⑳. Torque to specification.

### TORQUE

17 ft. lbs. (23 Nm)

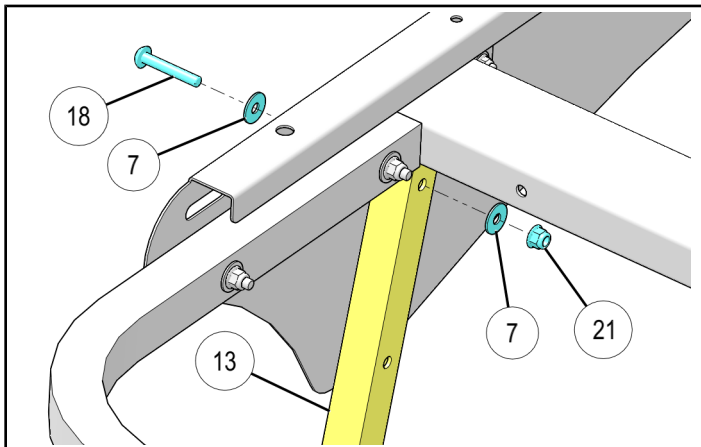

- Attach LH and RH support brackets ⑤ ⑥ to front support tube with bolts ⑰, washers ⑦, and nuts ⑳. Torque to specification.

### TORQUE

17 ft. lbs. (23 Nm)

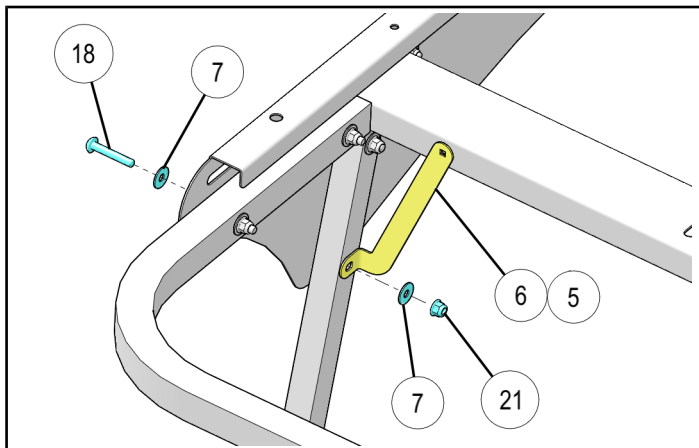

- Attach LH and RH support brackets ⑤ ⑥ to support brackets ⑨ with bolts ⑮, washers ⑳, and nuts ㉑. Torque to specification.

### TORQUE

12 ft. lbs. (16.3 Nm)

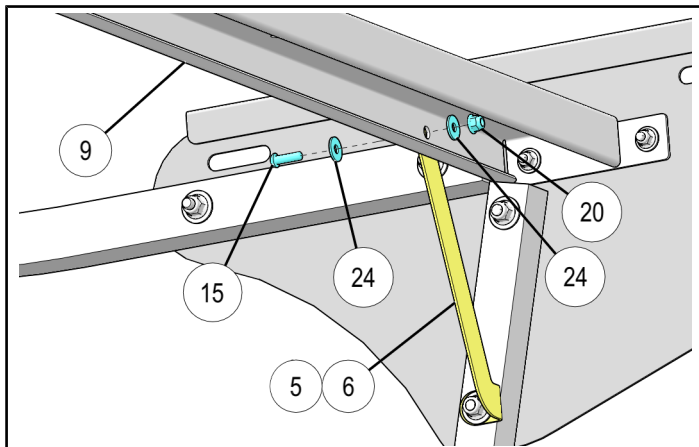

8. Attach rear tubes ① one on each side with bolts ⑰, washers ⑦, and nuts ⑳. Torque to specification.

### TORQUE

17 ft. lbs. (23 Nm)

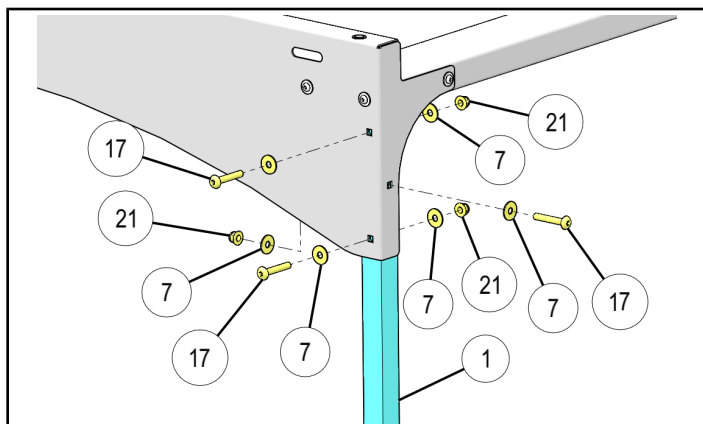

9. Slide four roll-in T-nuts ㉓ into OPS (2 per side) and attach OPS support bracket ⑩ with bolts ⑲ and washers ⑦ positioning the support brackets 15mm from the end of the OPS. Torque to specification.

### TORQUE

17 ft. lbs. (23 Nm)

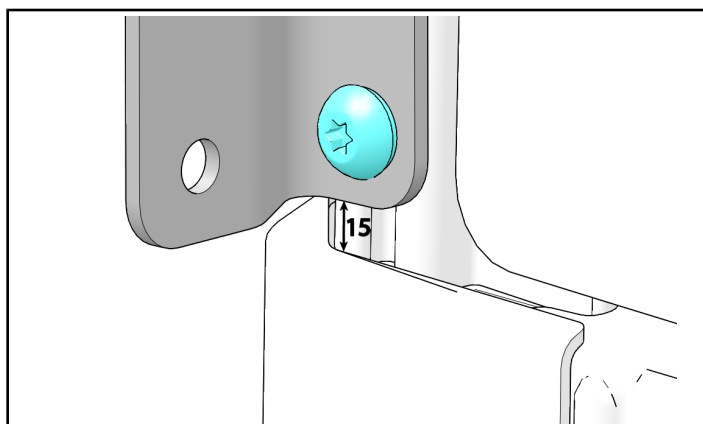
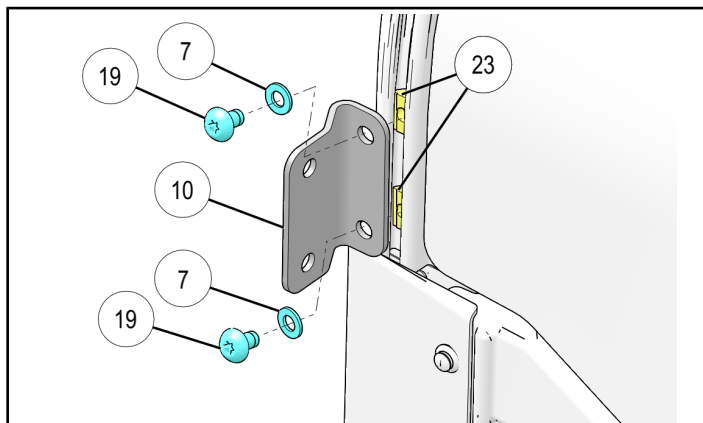

10. Attach ladder rack assembly to bed, by sliding in rear tubes into chassis as shown. Secure front tubes to OPS bracket ⑩ with bolts ⑱, washers ⑦, spacers ⑧, and nuts ㉑. Torque to specification.

### TORQUE

17 ft. lbs. (23 Nm)

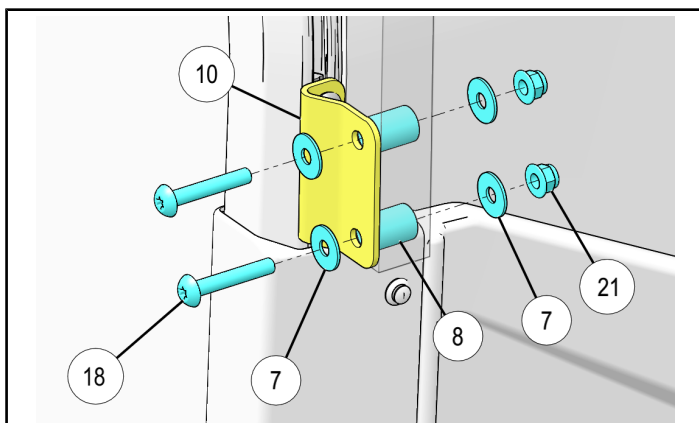
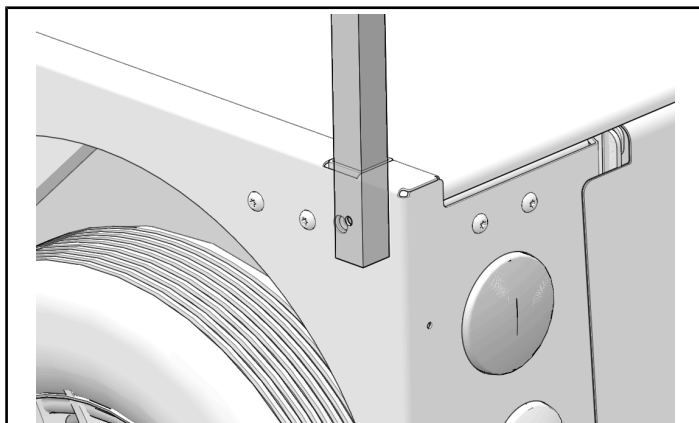

11. Attach LH and RH bed support brackets ⑪ ⑫ to chassis using existing screws (A), mounting rear ladder rack tubes with bolts ⑱, spacers ⑧, and nuts ㉑. Torque to specification.

### TORQUE

17 ft. lbs. (23 Nm)

