

# LOCK & WORK TIEDOWN ASSEMBLY KIT



**P/N 2881722**

## APPLICATION

2016 eL XD, eM 1400, eM 1400 LSV, M1400

## BEFORE YOU BEGIN

Read these instructions and check to be sure all parts and tools are accounted for. Please retain these installation instructions for future reference and parts ordering information.

## KIT CONTENTS

This Kit includes:

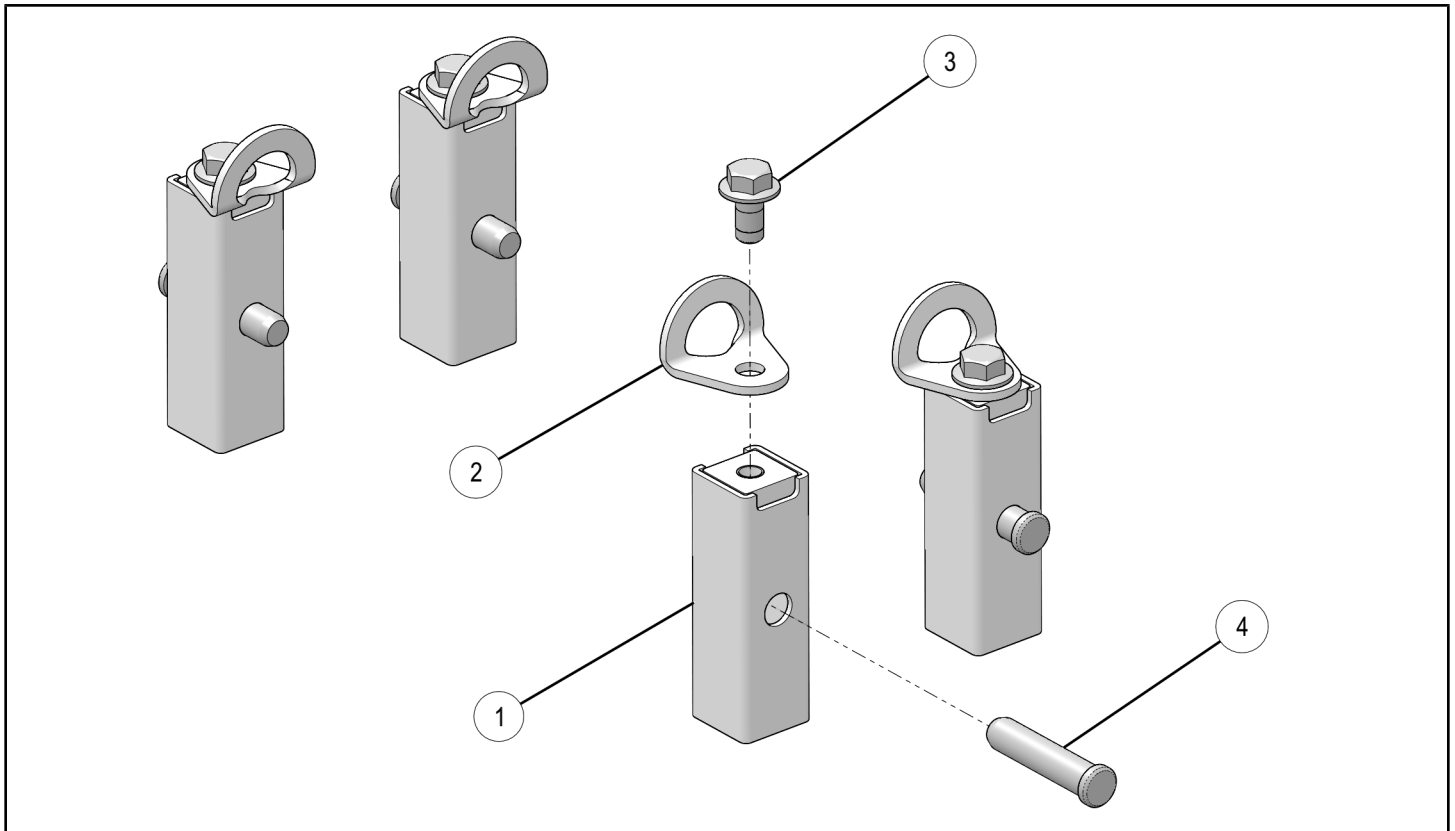

REF	QTY	PART DESCRIPTION	PART NUMBER
1	4	Adapter Tube, Welded	1020354
2	4	Tiedown Bracket	5262121
3	4	Screw, Hex Flange - M10 X 1.5 X 20	7519905
4	4	Detent Pin	7662293
	1	Instructions	9926822

## TOOLS REQUIRED

- Torque Wrench
- Metric Socket Set

## IMPORTANT

Your LOCK & WORK TIEDOWN ASSEMBLY KIT is exclusively designed for your vehicle. Please read the installation instructions thoroughly before beginning. Installation is easier if the vehicle is clean and free of debris. For your safety, and to ensure a satisfactory installation, perform all installation steps correctly in the sequence shown.

## ASSEMBLY TIME

Approximately 5 minutes

## INSTALLATION INSTRUCTIONS

1. Tiedowns can be installed in Lock & Work location.
2. Install Lock & Work adapters ① in desired locations using detent pins ④ as shown.
3. Install tiedowns ② using screws ③ as shown. Torque to below specification. See below image for proper orientation.

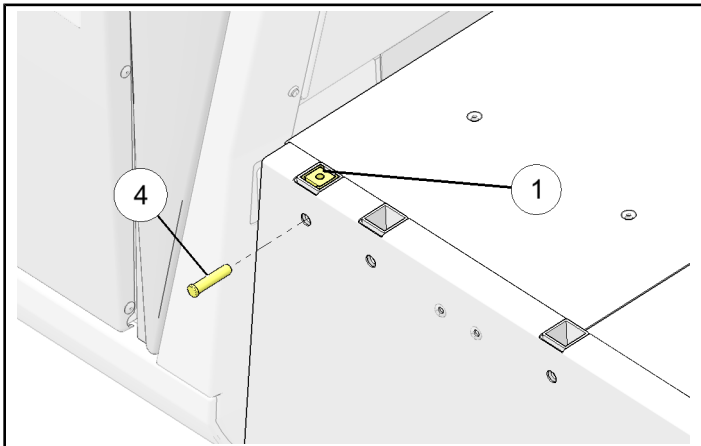

## TORQUE

14 ft. lbs. (19 Nm)

