

FRONT PANEL KIT



P/N 2881778

APPLICATION

2016 GEM eL XD

BEFORE YOU BEGIN

Read these instructions and check to be sure all parts and tools are accounted for. Please retain these installation instructions for future reference and parts ordering information.

KIT CONTENTS

This Kit includes:

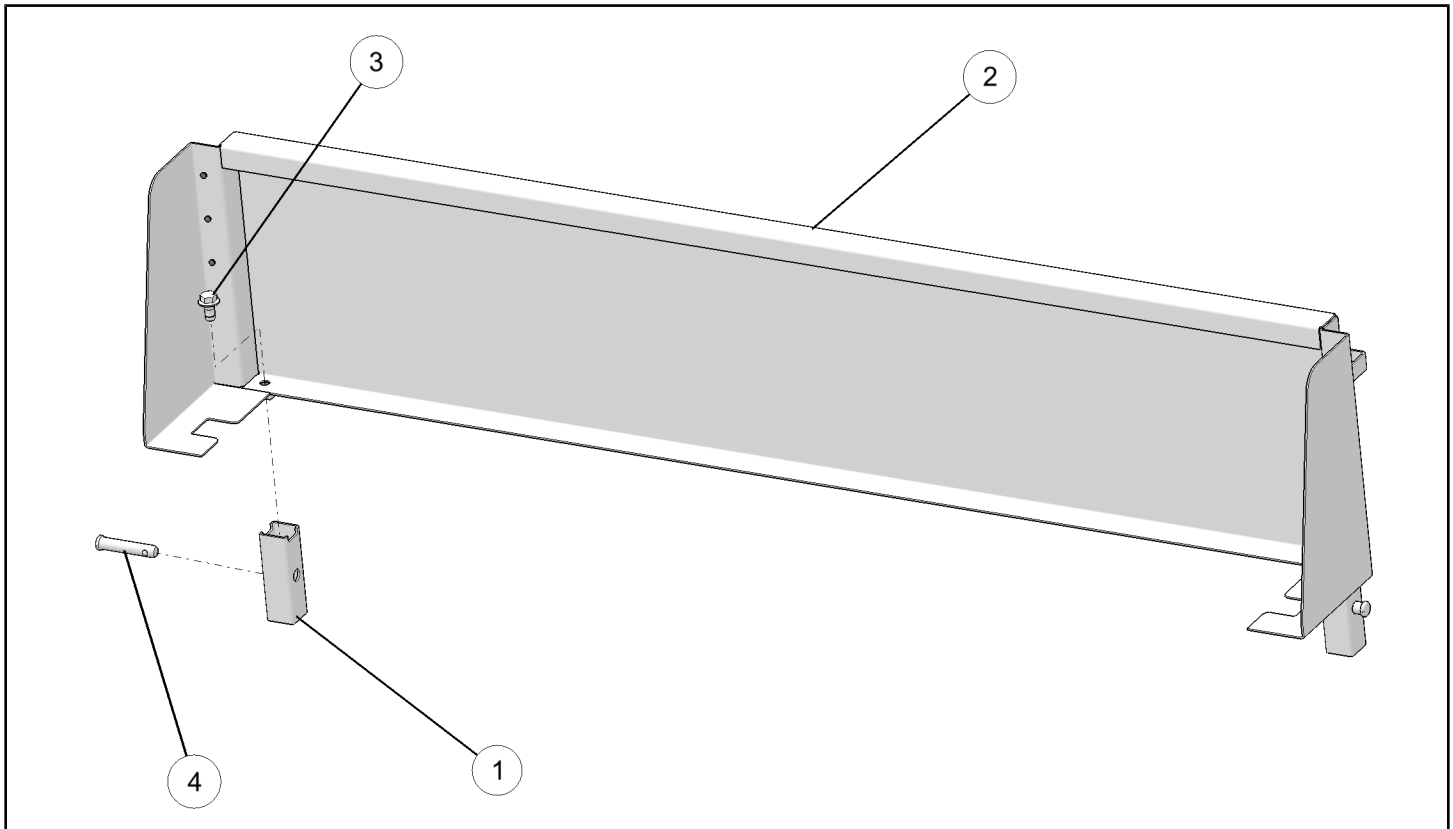

| REF | QTY | PART DESCRIPTION | PART NUMBER |
|-----|-----|------------------------------------|-------------|
| 1 | 2 | Weld - Tube, Adapter | 1020354 |
| 2 | 1 | Front Panel Assembly | 2636100 |
| 3 | 2 | Screw, Hex Flange - M10 X 1.5 X 20 | 7519905 |
| 4 | 2 | Clevis Pin, Detent | 7662293 |
| | 1 | Instructions | 9926878 |

TOOLS REQUIRED

- Safety Glasses
- Metric Wrench Set and Ratchet

IMPORTANT

Your FRONT PANEL KIT is exclusively designed for your vehicle. Please read the installation instructions thoroughly before beginning. Installation is easier if the vehicle is clean and free of debris. For your safety, and to ensure a satisfactory installation, perform all installation steps correctly in the sequence shown.

ASSEMBLY TIME

Approximately 15 minutes

INSTALLATION INSTRUCTIONS

1. Insert lock and work adapters ① into the bed locations (LH & RH) as shown. Lock in place with detent pins ④.

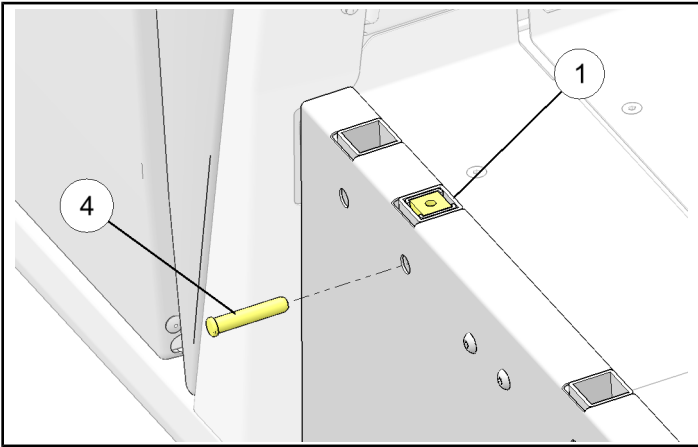

3. Final installation of front panel assembly as shown.

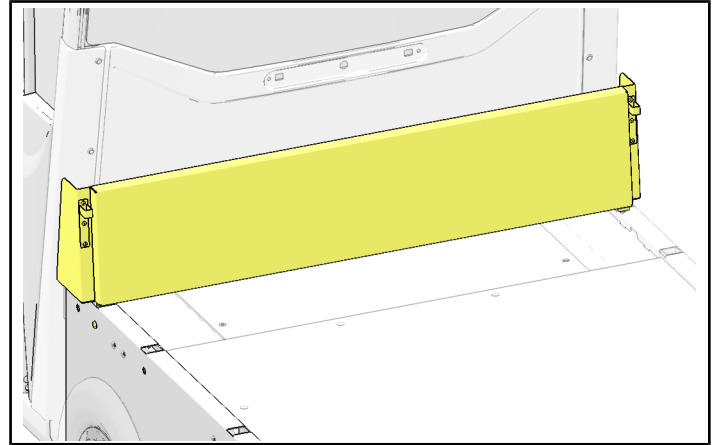

2. Mount front panel ② on bed using two screws ③ as shown. Torque to specification.

TORQUE

10 ft. lbs. (13.5 Nm)

