

# LONG BOX KIT



**P/N 2882712**

## APPLICATION

Verify accessory fitment at [Polaris.com](http://Polaris.com).

## BEFORE YOU BEGIN

Read these instructions and check to be sure all parts and tools are accounted for. Please retain these installation instructions for future reference and parts ordering information.

## KIT CONTENTS

This Kit includes:

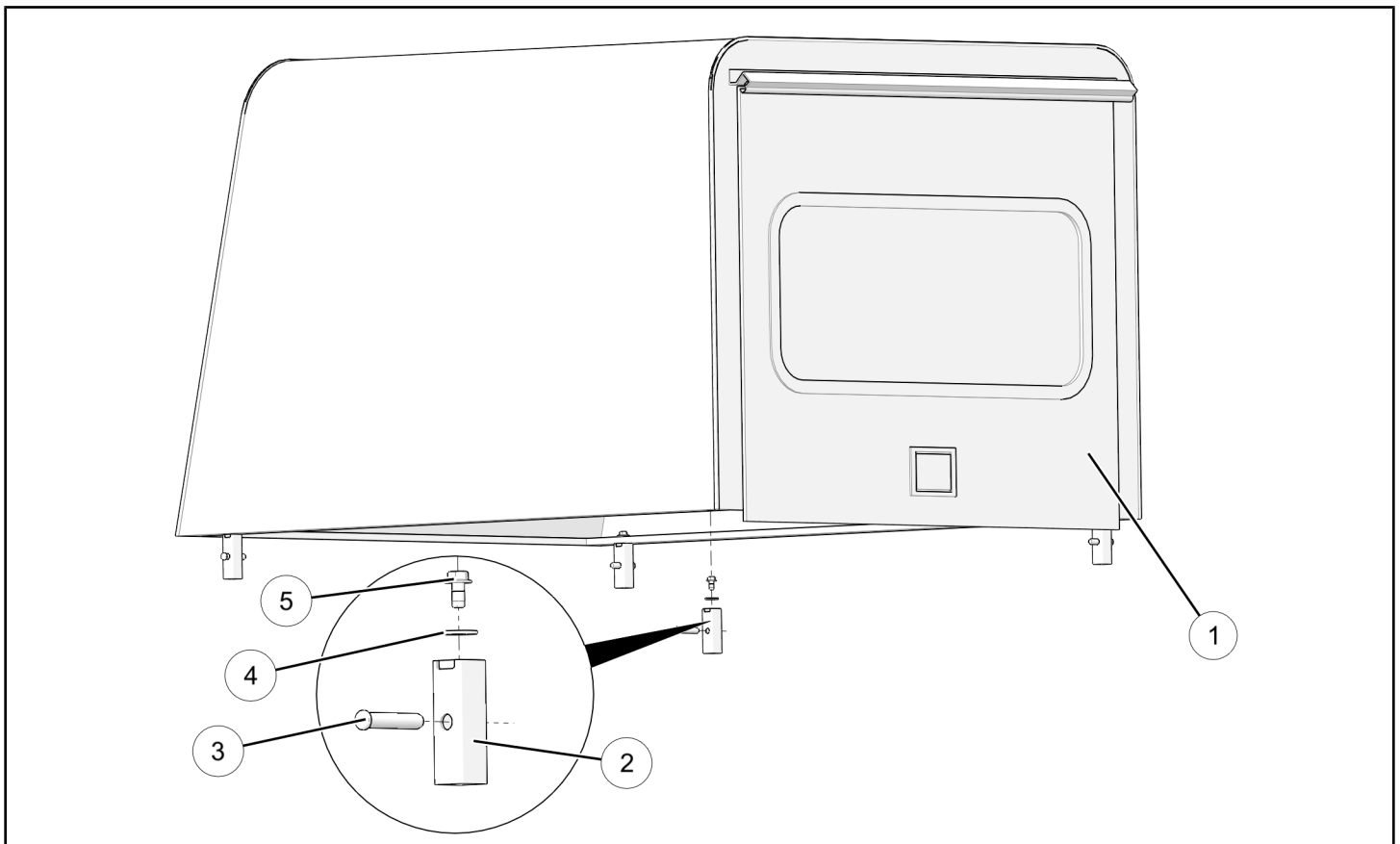

REF	QTY	PART DESCRIPTION	PART NUMBER
1	1	Assembly, Long Box	2636436
2	4	Adapter, Weld Tube	1020354
3	4	Pin-Clevis, Detent	7662293
4	4	Washer, 10.5 X 30 X 2.5	7556973
5	4	Screw, Hex Flange Head, M10 X 1.5 X 20	7519905
6	1	Sealing Tape (Not Shown)	-

REF	QTY	PART DESCRIPTION	PART NUMBER
7	1	Bulb Seal, 1 inch (Not Shown)	-
	1	Instructions	9927877

## TOOLS REQUIRED

- Safety Glasses
- Screwdriver, Phillips
- Socket Set, Metric
- Torque Wrench
- Wrench Set, Metric

## IMPORTANT

Your Long Box Kit is exclusively designed for your vehicle. Please read the installation instructions thoroughly before beginning. Installation is easier if the vehicle is clean and free of debris. For your safety, and to ensure a satisfactory installation, perform all installation steps correctly in the sequence shown.

## ASSEMBLY TIME

Approximately 24 minutes

## INSTALLATION INSTRUCTIONS

1. Place gear selector in "N". Apply parking brake. Turn key to "OFF" position and remove from vehicle.

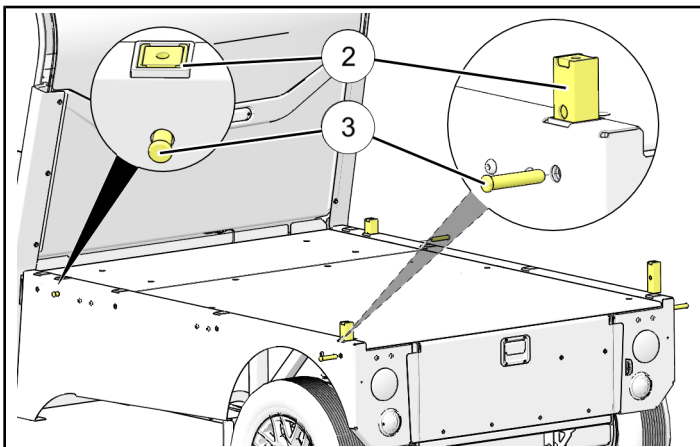

2. Insert lock and work adapters ② into the bed locations (LH and RH) as shown. Lock in place with detent pins ③.
3. Place a protective cloth down and set long box upside down on cloth.

4. **Installing seals.**

- a. For vehicles with **Truck Bed**

- i. Clean surfaces and install sealing tape ⑥ on base surface of each side panel as shown. Install bulb seal ⑦ on lower edge of aluminum extrusion piece.

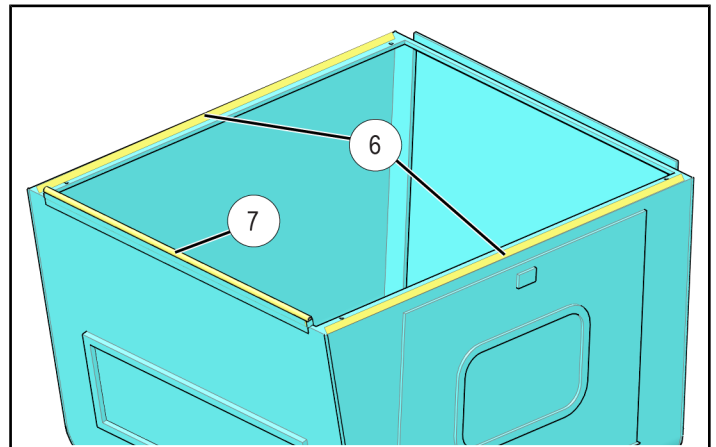

b. For vehicles with **Flat Bed or Flat Bed with Storage**

- i. Remove fasteners (A) and extrusion piece (B) from assembly.

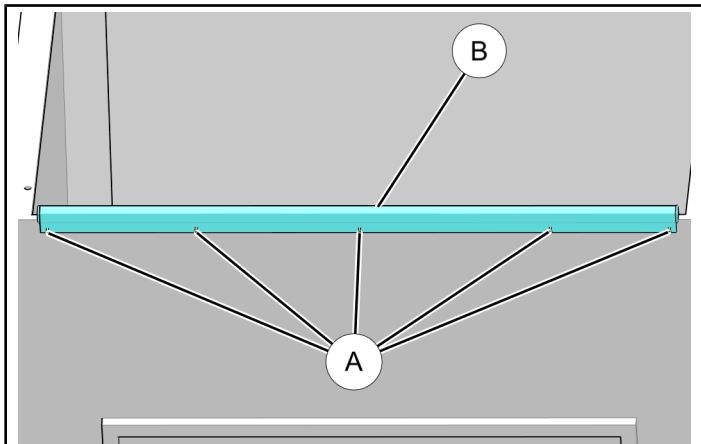

- ii. Clean surfaces and install sealing tape (6) on base surface of each side panel as shown. Install bulb seal (7) to front bottom edge of box as shown.

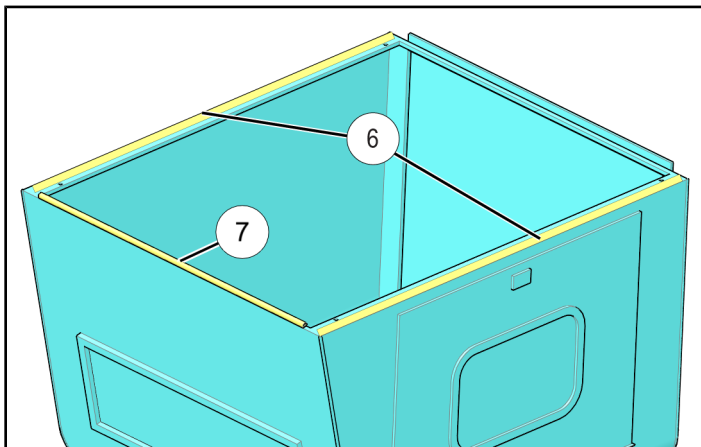

5. Place long box assembly (1) on bed and loosely install four washers (4) and four screws (5). Align box and torque screws to specification.

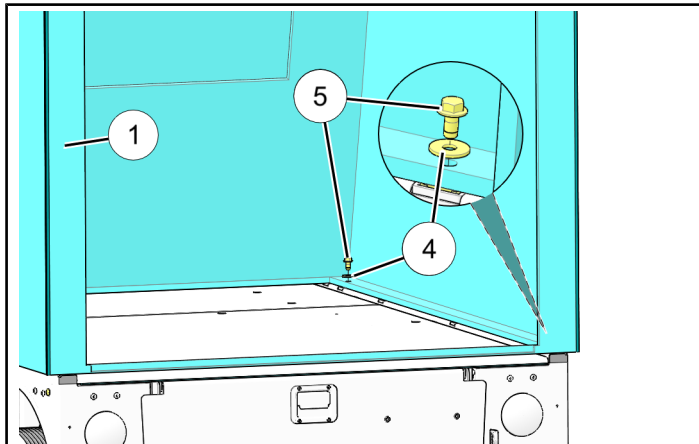

**TORQUE**

10 ft. lbs. (13.5 Nm)

**FEEDBACK FORM**

A feedback form has been created for the installer to provide any comments, questions or concerns about the installation instructions. The form is viewable on mobile devices by scanning the QR code or by clicking [HERE](#) if viewing on a PC.

**FEEDBACK FORM**

