

SHORT BOX KIT



P/N 2882713

APPLICATION

e2, e4, e6®

BEFORE YOU BEGIN

Read these instructions and check to be sure all parts and tools are accounted for. Please retain these installation instructions for future reference and parts ordering information.

KIT CONTENTS

This kit contains parts for installation of the Short Box only. Prior installation of the Short Bed Kit (MY17), PN 2882432, is also required (sold separately).

This Kit includes:

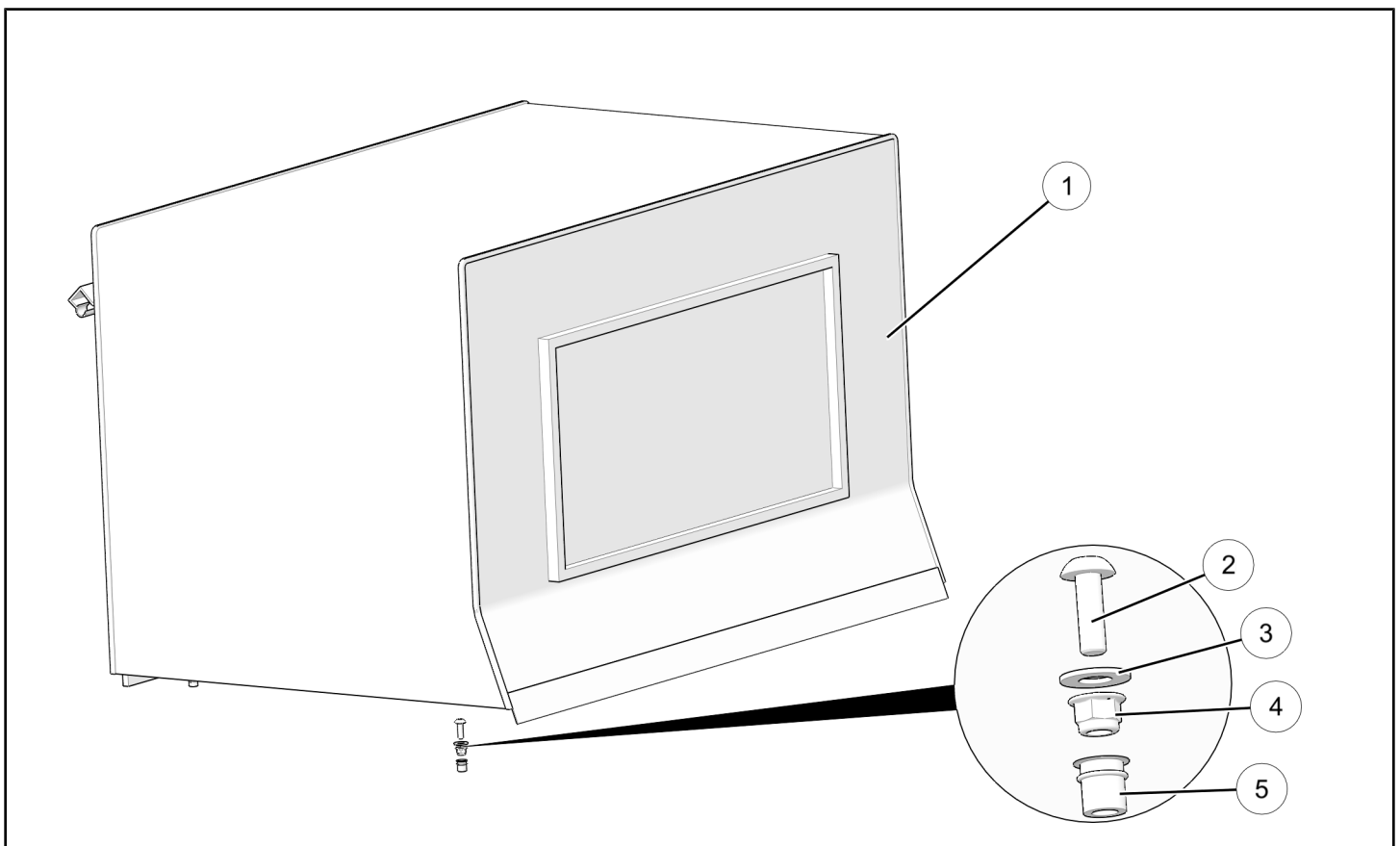

REF	QTY	PART DESCRIPTION	PART NUMBER
1	1	Assembly, Short Box	-
2	4	Screw, Torx® Head, M8 X 1.25 X 25	7520416
3	4	Washer, 10.5 X 22 X 1.6	7556155
4	4	Nut, Hex Flange, M8 X 1.25	7547454
5	4	Threaded Insert, Expanding, M8 X 1.25	7547788

REF	QTY	PART DESCRIPTION	PART NUMBER
6	1	Sealing Tape (Not Shown)	-
	1	Instructions	9927878

TOOLS REQUIRED

- Safety Glasses
- Threaded Insert Installation Tool
- Socket Set, Metric
- Socket Set, Torx® Bit
- Torque Wrench
- Wrench Set, Metric

IMPORTANT

Your Short Box Kit is exclusively designed for your vehicle. Please read the installation instructions thoroughly before beginning. Installation is easier if the vehicle is clean and free of debris. For your safety, and to ensure a satisfactory installation, perform all installation steps correctly in the sequence shown.

ASSEMBLY TIME

Approximately 18 minutes

INSTALLATION INSTRUCTIONS

1. Place gear selector in "N". Apply parking brake. Turn key to "OFF" position and remove from vehicle.
2. *If Threaded Insert Installation tool is available:* Install four threaded inserts ⑤ into holes on top edges of short bed ④ as shown.
4. Clean surfaces and install sealing tape ⑥ on base surface of each side panel as shown.

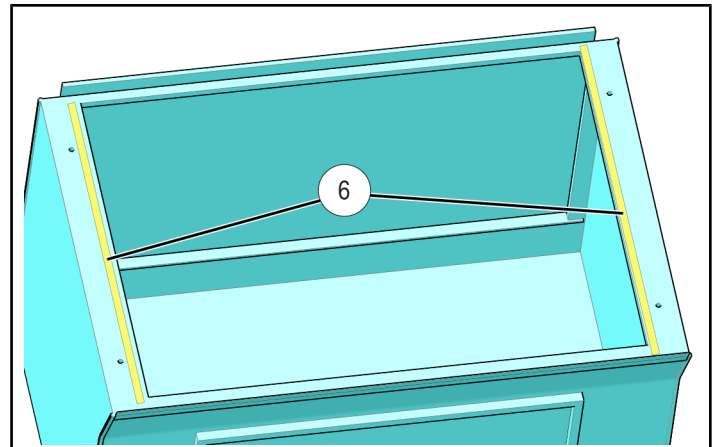
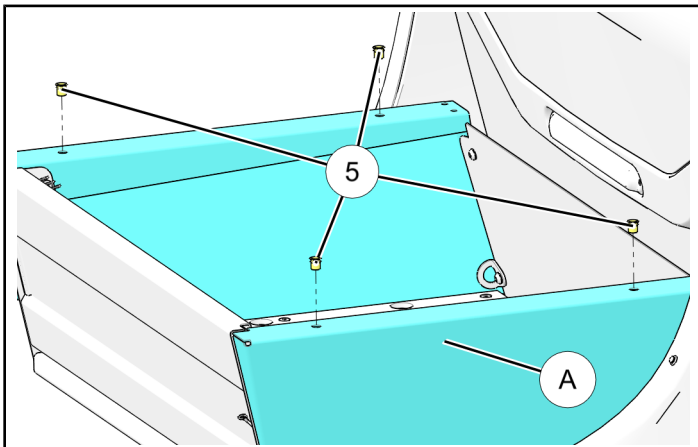

3. Place a protective cloth down and set short box upside down on cloth.

5. Installing box onto vehicle

a. **With threaded inserts installed.**

- i. Place short box assembly ① on short bed sides. Loosely install four washers ③ and four screws ② into pre-installed threaded inserts ⑤.

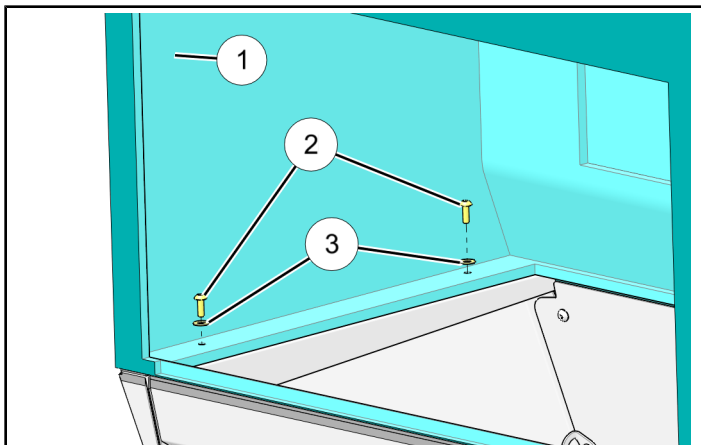

- ii. Align short box ① and torque four screws ② to specification.

TORQUE

10 ft. lbs. (13.5 Nm)

b. **Without threaded inserts installed.**

- i. Place short box assembly ① on short bed sides. Loosely install four washers ③ and four screws ② from top side of box. Loosely install four hex nuts ④ from bottom.

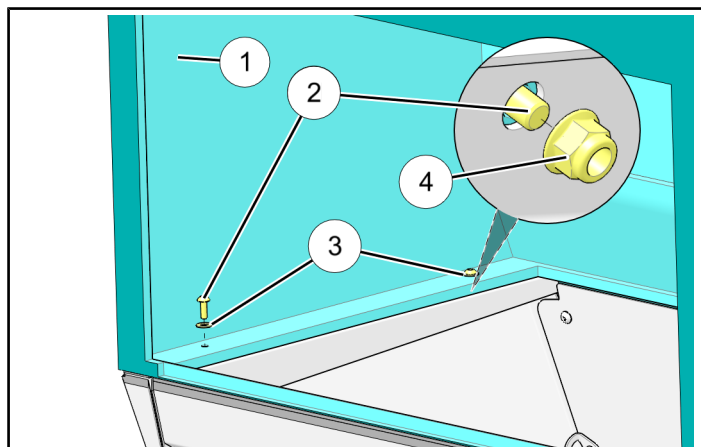

- ii. Align short box ①. Counter hold 4 hex nuts ④ and torque screws to specification.

TORQUE

10 ft. lbs. (13.5 Nm)

- 6. Verify function of door and adjust as needed.

FEEDBACK FORM

A feedback form has been created for the installer to provide any comments, questions or concerns about the installation instructions. The form is viewable on mobile devices by scanning the QR code or by clicking [HERE](#) if viewing on a PC.

FEEDBACK FORM

