

# DOOR SEAL KIT



**P/N 2207257, 2207267, 2207268**

## APPLICATION

GEM® e2, e4, e6®, and eL XD

## BEFORE YOU BEGIN

Read these instructions and check to be sure all parts and tools are accounted for. Please retain these installation instructions for future reference and parts ordering information.

## KIT CONTENTS

This kit contains parts for installation of the Door Seals Kit only. Prior installation of one or both of the following additional kits is also required (sold separately):

- Front Full Hard Door, PN 2635825-XXX & 2635826-XXX
- Middle/Rear Full Hard Door, PN 2635827-XXX & 2635828-XXX

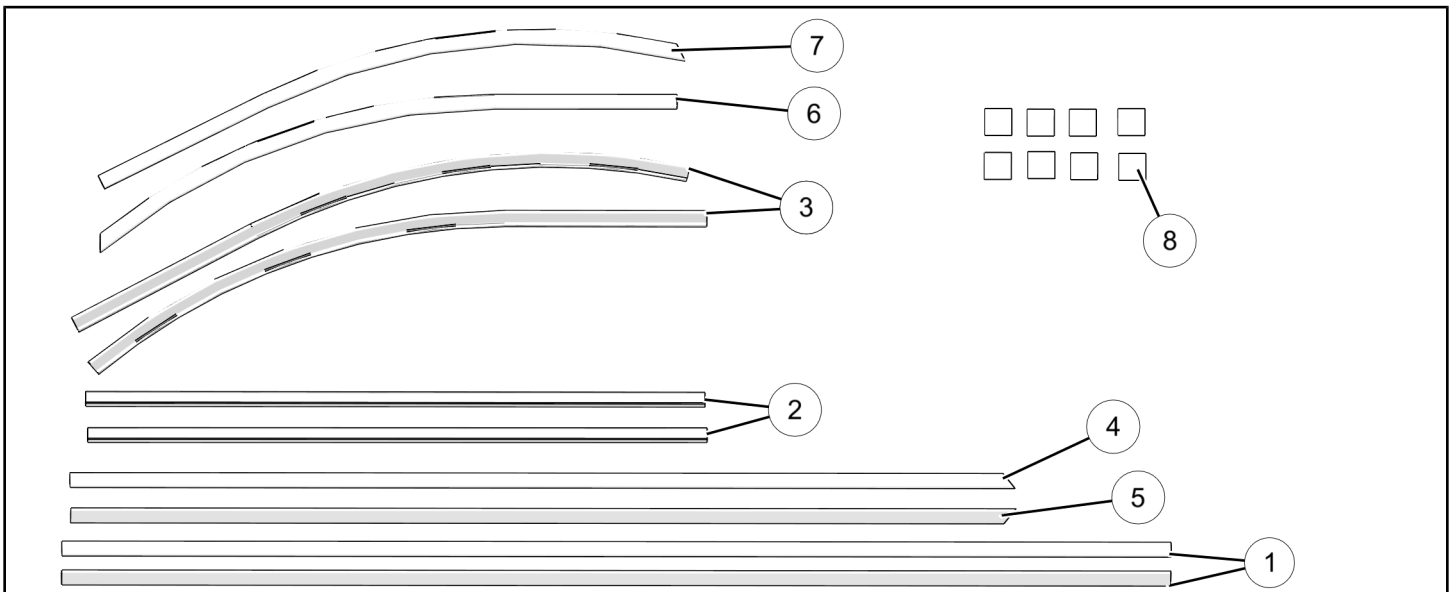

Kit 2207257 includes:

REF	QTY	PART DESCRIPTION	PART NUMBER
1	2	Foam Weatherstrip, Black, 1442 MM	5522211-1442
2	2	Foam Weatherstrip, Black, 805 MM	5522211-805
3	2	Foam Weatherstrip, Black, 850 MM	5522211-850
4	1	Foam Weatherstrip, A-Pillar, LH	5522242
5	1	Foam Weatherstrip, A-Pillar, RH	5522243
6	1	Foam Weatherstrip, OPS, LH	5522244
7	1	Foam Weatherstrip, OPS, RH	5522245
8	8	Tape, Black, Frame	8360180
	1	Instructions	9928287

Kit 2207267 includes:

REF	QTY	PART DESCRIPTION	PART NUMBER
1	6	Foam Weatherstrip, Black, 1442 MM	5522211-1442
2	8	Foam Weatherstrip, Black, 805 MM	5522211-805
3	2	Foam Weatherstrip, Black, 850 MM	5522211-850
4	1	Foam Weatherstrip, A-Pillar, LH	5522242
5	1	Foam Weatherstrip, A-Pillar, RH	5522243
6	1	Foam Weatherstrip, OPS, LH	5522244
7	1	Foam Weatherstrip, OPS, RH	5522245
8	16	Tape, Black, Frame	8360180
	1	Instructions	9928287

Kit 2207268 includes:

REF	QTY	PART DESCRIPTION	PART NUMBER
1	10	Foam Weatherstrip, Black, 1442 MM	5522211-1442
2	14	Foam Weatherstrip, Black, 805 MM	5522211-805
3	2	Foam Weatherstrip, Black, 850 MM	5522211-850
4	1	Foam Weatherstrip, A-Pillar, LH	5522242
5	1	Foam Weatherstrip, A-Pillar, RH	5522243
6	1	Foam Weatherstrip, OPS, LH	5522244
7	1	Foam Weatherstrip, OPS, RH	5522245
8	24	Tape, Black, Frame	8360180
	1	Instructions	9928287

## TOOLS REQUIRED

- Safety Glasses
- Cutting Tool
- Flashlight
- Mirror
- Seam Roller
- Chalk

## CONSUMABLES REQUIRED

- Gloves, Chemical Resistant
- Solvent Wipe (99% Isopropyl Alcohol)
- Lint Free Cloth

## IMPORTANT

Your Door Seal Kit is exclusively designed for your vehicle. Please read the installation instructions thoroughly before beginning. Installation is easier if the vehicle is clean and free of debris. For your safety, and to ensure a satisfactory installation, perform all installation steps correctly in the sequence shown.

## ASSEMBLY TIME

Approximately 40 minutes per door

# INSTALLATION INSTRUCTIONS

## IMPORTANT

- Installation temperature must be between 60-110°F (15-44°C)
- Clean surface is critical for adhesion performance
- Backing Liners should not be removed until part is going to be applied.
- 15 lbs of force is required when rolling seals.
- DO NOT stretch seals during installation or delamination may occur.

1. Place gear selector in "N". Apply parking brake. Turn key to "OFF" position and remove from vehicle.

## REMOVAL AND SURFACE PREPARATION

1. Open all doors and remove rubber door seals (A) from doors. (If needed)

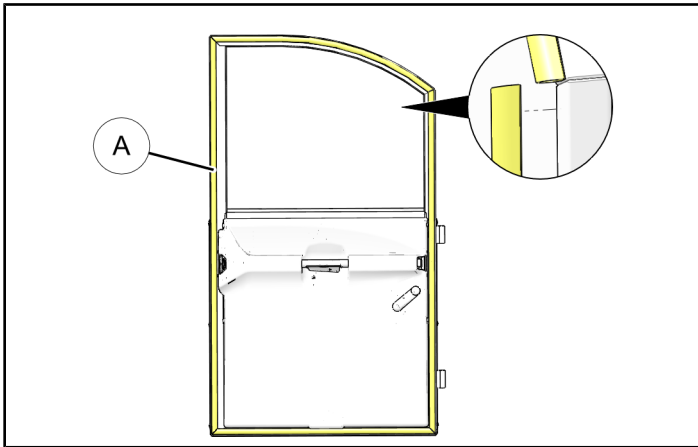

2. Clean adhesive from surfaces with adhesive remover.

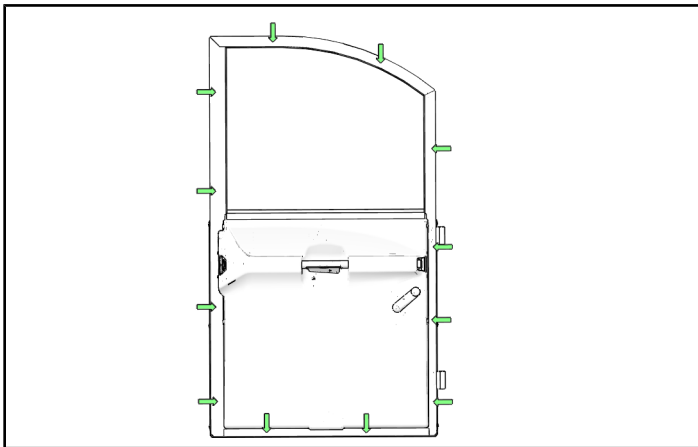

## ⚠ WARNING

Follow all chemical manufacturer instructions and safety precautions. Failure to follow all manufacturer instructions and precautions may result in severe injury or death.

3. Clean mounting surfaces for new seals with lint free cloth, and solvent wipes. Surfaces include: Top horizontal surface of door (B), bottom vertical surface on inner door panel (C), and inner vertical surfaces of door frame as shown.

## NOTE

Clean surface no more than 20 minutes prior to installation.

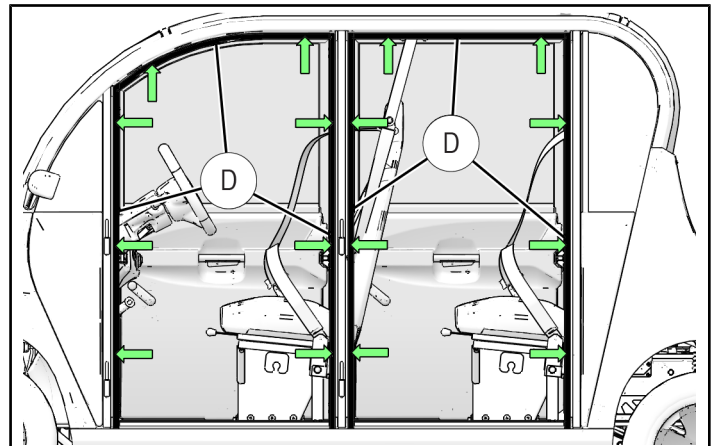
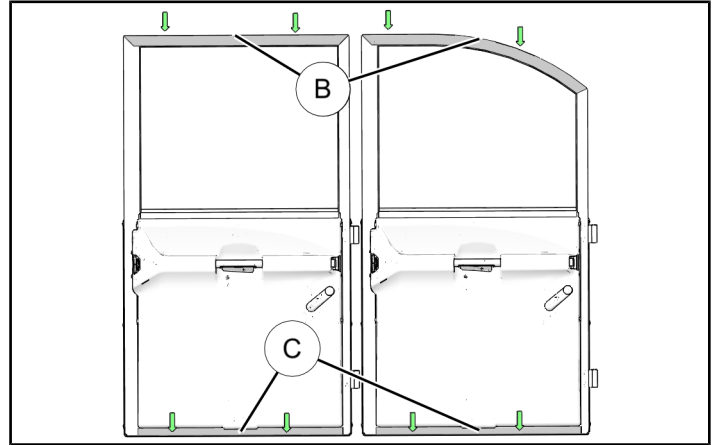

## ⚠ WARNING

Isopropyl alcohol is hazardous to your health. See isopropyl alcohol packaging for proper handling instructions, including recommended personal protective equipment such as goggles and chemical resistant gloves.

## INSTALL SEAM SEALING TAPE

1. On each door, install four pieces of black sealing tape ⑧, over seams on each corner as shown.

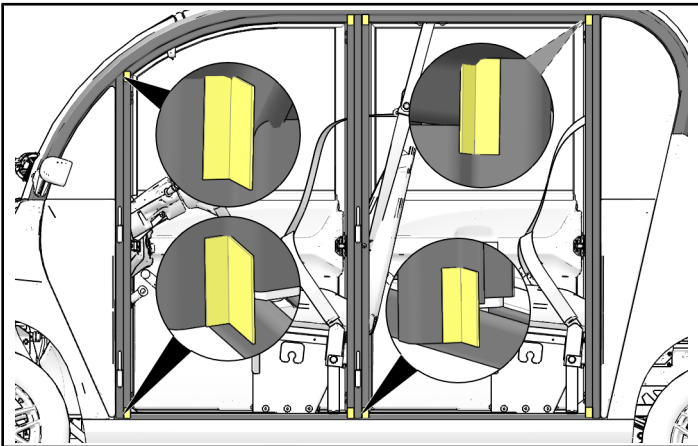

2. Ensure that tape is secured and flush to frame. Use seam roller if needed. Apply firm pressure over entire tape surface for proper adhesion. Remove clear liner from tape.

## INSTALL A-PILLAR SEALS

1. Peel backing liner from LH A-pillar seal ④ and install to A-pillar starting at top of pillar with angled end of seal flush to top of frame and working down. Align open end edge of seal with inner edge of door frame as shown.

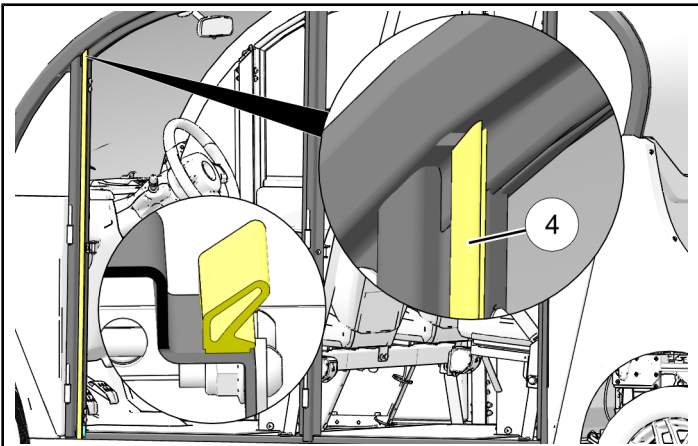

2. Use seam roller on seal. Press firmly (15 lbs of force) to ensure that seal is secured to A-Pillar frame.
3. Repeat **Steps 1 & 2** for RH A-pillar seal ⑤.

## INSTALL B, C, & D-PILLAR SEALS

1. One at a time, peel backing liner from longest weather-strip piece ① and install to vertical door frames, starting by mounting flush to top of frame as shown. Align open end edge of seal with inner edge of door frame as shown.

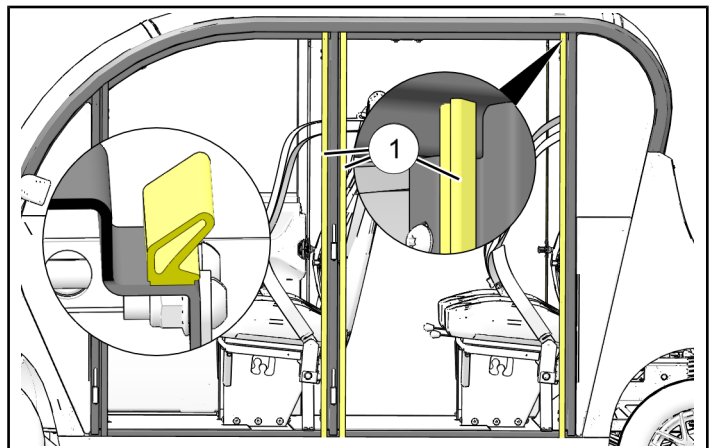

- e2 and eL XD will have TWO long seals.
  - e4 will have SIX long seals.
  - e6® will have TEN long seals.
2. Trim excess rubber from **BOTTOM** of seal ensuring seal is still flush with bottom frame.
  3. Use seam roller on seals. Press firmly (15 lbs of force) to ensure seals are secured to frame.

## INSTALL UPPER DOOR FRAME SEALS

1. Peel backing liner from front upper LH door frame seal ⑥ and adhere to upper door frame starting at the front edge. Tuck upper seal behind A-pillar seal as shown. Trim end of seal at B-Pillar (if needed) and tuck behind B-Pillar seal.
2. Repeat **step 1** for front upper RH door frame seal ⑦.
3. One at a time, peel backing liner from middle/rear upper door frame seals ② and install one seal per middle or rear upper door frame on vehicle, front to rear, tucking seal behind vertical pillar seals as in **step 1** of this section. These seals may also need to be trimmed to fit.

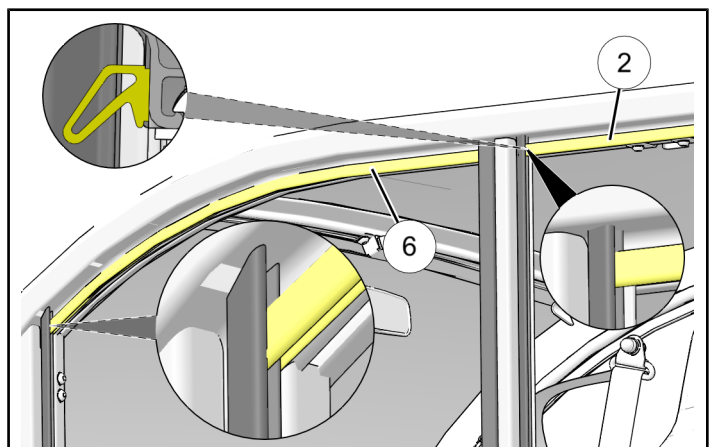

- Use seam roller on all newly installed seals. Press firmly (15 lbs of force) to ensure seals are secured to frame.

## INSTALL UPPER AND LOWER DOOR SEALS

- One at a time, peel backing liner from front upper door seals ③ and adhere to top surface of front window frame as shown. If needed, trim seal to fit.
- One at a time, peel backing liner from middle and rear upper door seals ② and adhere to top surface of middle and rear window frame as shown. If needed, trim seals to fit.
- One at a time, peel backing liner from lower door seals ② and adhere to lower inner surface of doors as shown. **DO NOT TRIM LOWER SEALS AT THIS TIME**

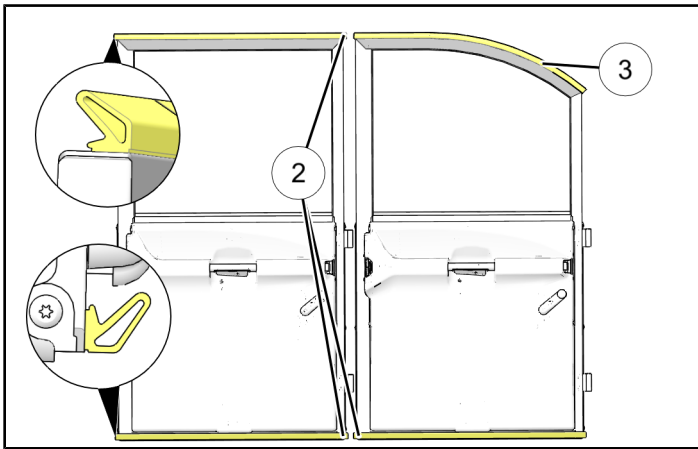

- Use seam roller on all newly installed seals. Press firmly (15 lbs of force) to ensure seals are secured to door.

## SET LOWER DOOR SEAL GAP

- Open door and mark the lower inner edges of the vertical seals ④, ⑤, and ① with chalk.

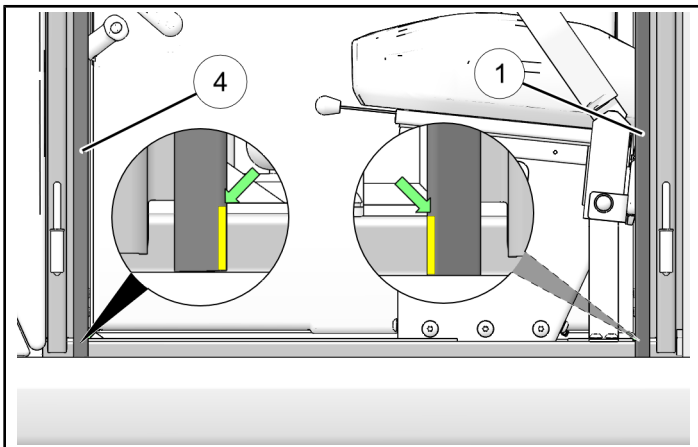

- Close each door firmly. Open and note where chalk marks are on lower door seals.

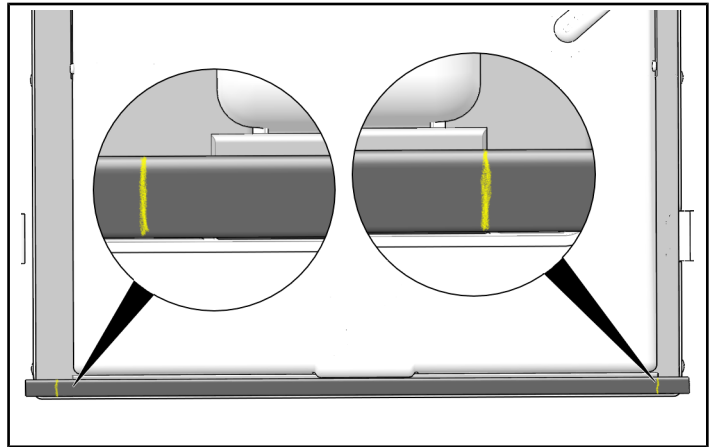

- Trim each end of each lower door seal ② on chalk mark so there will be a 1-3 mm gap (shown with arrows) between vertical seals and lower door seal when doors are closed.

### TIP

It is better to cut too little, than too much. Use caution when cutting lower seal to ensure that too much material is not removed.

### TIP

Gaps can be checked from inside vehicle with doors closed, using mirror and flashlight.

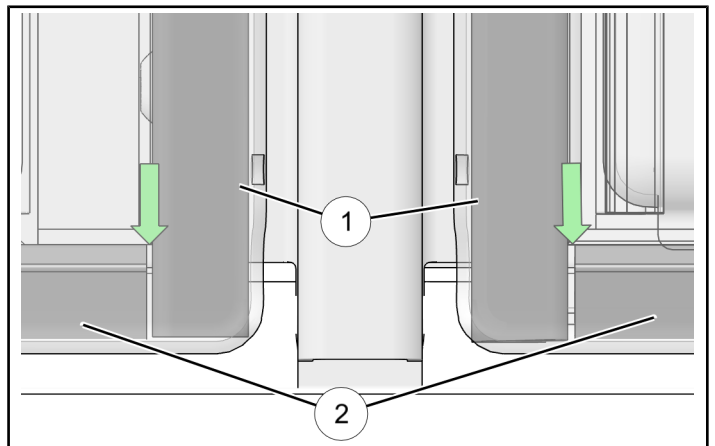

## FEEDBACK FORM

A feedback form has been created for the installer to provide any comments, questions or concerns about the installation instructions. The form is viewable on mobile devices by scanning the QR code or by clicking [HERE](#) if viewing on a PC.

