

DASH FAN KIT



P/N 2412024/2412027

APPLICATION

ALL 72-VOLT 1999-CURRENT MODEL YEAR GEM VEHICLES

BEFORE YOU BEGIN

Read these instructions thoroughly and make sure all parts and tools are accounted for. Please retain these installation instructions for future reference and parts ordering information.

WARNING: Before attempting service on the GEM vehicle, to reduce the risk of personal injury or property damage, be sure to turn the master disconnect switch (mds) to the 'OFF' position.

NOTE: This kit may be installed on any Model GEM, however is Model Year specific; follow instructions closely. For proper component protection, accessories must be wired with a fused connection. Follow the below procedure.

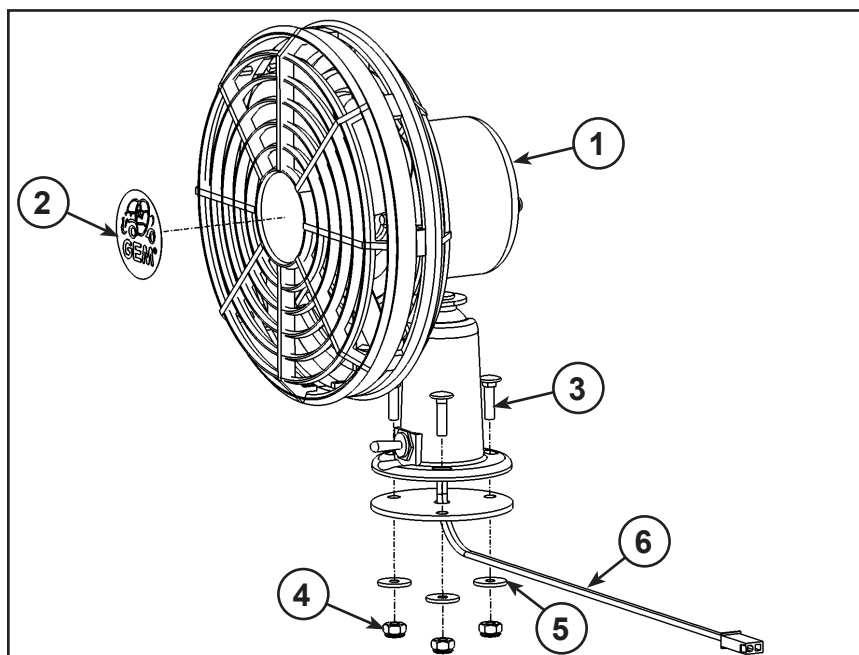

KIT CONTENTS:

Ref	Single Fan Qty (2412024)	Dual Fan Qty (2412027)	Part Description	Part Number
1	1	2	Dash Fan Assembly	2411997
2	1	2	Dash Fan Decal	7178211
3	3	6	Screw, 10-24x3/4	7519710
4	3	6	Nylock Nut	7541925
5	3	6	Flat Washer	7556717
6	1	1	Wire Harness - Dash Fan Assembly	2412106
	1	1	Instructions	9926039

TOOLS NEEDED

Wire Stripper Tool

Wire Crimper

English Socket Set

APPROXIMATE ASSEMBLY TIME

8 min/fan

IMPORTANT

Your Polaris DASH FAN KIT is exclusively designed for your vehicle. Please read the installation instructions thoroughly before beginning. Installation is easier if the vehicle is clean and free of debris. For your safety, and to ensure a satisfactory installation, perform all installation steps correctly in the sequence shown.

INSTALLATION INSTRUCTIONS

1. Remove Upper Dash:

- a) Unlatch and open hood.
- b) Remove two screws located immediately below windshield towards outer edges.
- c) Slowly, lift upper dash assembly out and towards passenger side, taking care to disconnect any electrical connections if applicable.
- d) Disconnect heater ducts at heater assembly (if equipped).

NOTE: Take care not to scratch steering column/instrument pod covers.

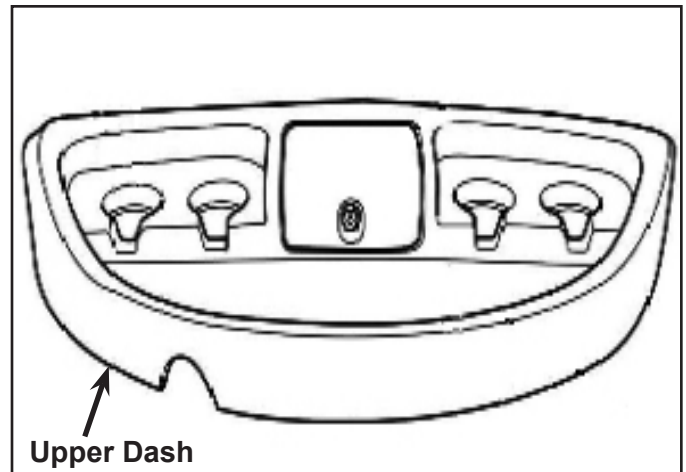

2. Remove Lower Dash:

- a) Remove three screws on top surface mounting tabs.
- b) Slowly lift lower dash panel out taking care to tag and disconnect any electrical connections and heater ducts. Then lift up, until lower tabs are clear of the slots in the floor pan.

NOTE: Take care not to scratch steering column/instrument pod covers.

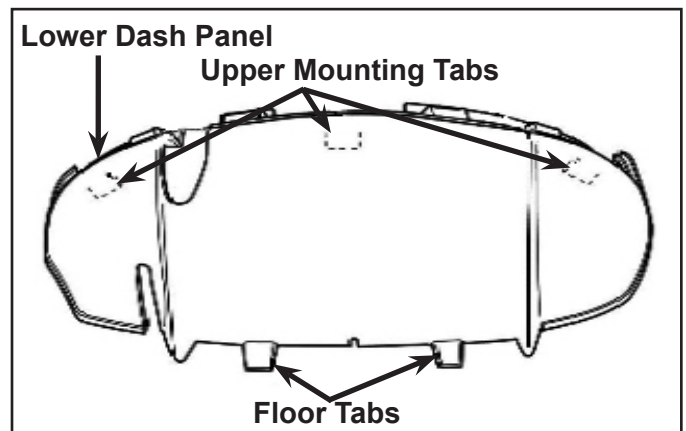

3. Determine mounting location on upper Dash:

- a) Consider which side of dash you want the fan mounted.

NOTE: Dash Fan Option can be installed on either Left, Right or Both sides.

- b) Instructions below show installation of one fan installed on the Driver's side of a 2007 Model Year GEM.

NOTE: For wire termination see specific instructions per Model Year in Steps below. For 2004-Older Model vehicles see Step 14.

4. Mark out mounting hole locations:

- a) Remove the rubber gasket from the fan. Use rubber gasket as a template and position it so the fan is mounted with the toggle switch facing the operator.
- b) Mark out the three mount hole locations (A) using an awl or center punch. (try to center holes in slot).
- c) Mark out center of gasket (B) as well, as this will be the access hole for routing wires. See figure.

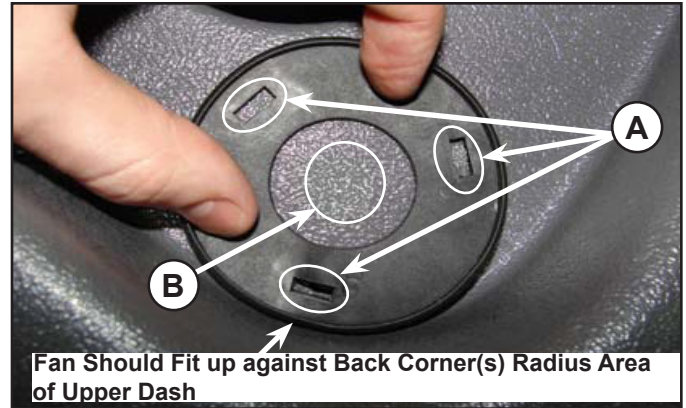

5. For Dual Fan install repeat step 4 for opposite side.

6. Drill out the holes:

- a) Drill the three mount holes (C) using an 11/64" drill bit and drill the center hole (D) with a 1/2" drill bit or step drill bit, as shown in figure.

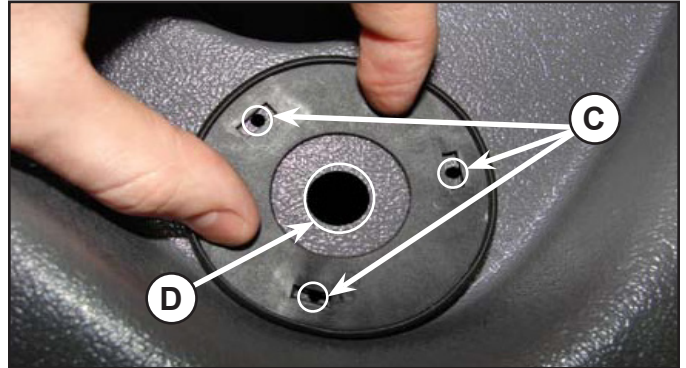

7. For Dual Fan install repeat step 6 for opposite side.

8. Prepare the fan(s) for installation:

- a) Remove the decal/sticker from the back of the fan body.
- b) Using isopropyl alcohol or Goo Gone, remove and clean any adhesive residue from the previously removed decal area.
- c) Using isopropyl alcohol clean the front center of the fan.
- d) Apply the supplied vinyl GEM decal to the front-center, making sure it is level and centered.

9. Make wire terminations to fan(s):

- a) Cut black wires from fan about 24".
- b) Spread wires apart about 3/4" and strip back insulation about 1/8".
- c) Crimp provided male Molex pins to each wire. (Special tool for this type of pin is best recommended – Molex brand Part # 63811-1000.)
- d) Insert terminated male pins to the provided white female Molex connector as shown in figure.

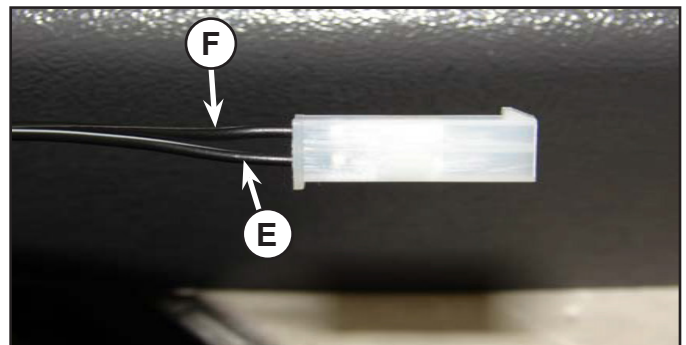

NOTE: Orientation is specific – Black wire to top (F) with catch, Black/White wire to bottom (E).

NOTE: When connected to mating Molex connector the black wires should align, as well will the red & black/white wires.

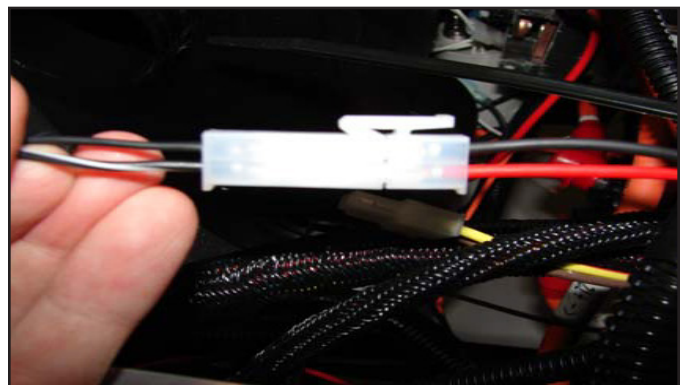

10. Mount the fan(s) on the dash:

- a) Be sure the rubber gasket is installed to the base of the fan.
- b) Feed previously terminated two wire harness from fan through the ½" drilled center hole of dash.
- c) Rubber gasket should fit over wire – wire fits between rubber gasket and dash.
- d) Align the three mounting holes and secure using hardware provided in kit – three bolts (PN 7519710), washers (PN 7556717) and nuts (PN 7541925).
- e) Be sure to position the fan so the switch is facing the operator as shown in figure.



11. For Dual Fan install repeat step 10 for opposite side.

12. Install the wire harness:

- a) Position the wire harness along the top of the aluminum dash frame support bracket. (Same for ALL Models 1999-current)
- b) Place harness in the fashion that the spliced end is facing the driver side.
- c) Attach harness using black plastic tie wraps as shown in figures.

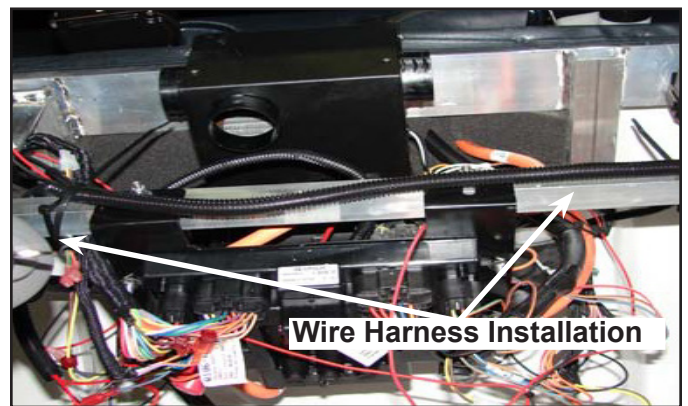

13. Connection of Harness for 2005-Current Model:

- a) If a heater/defogger is installed and connected to S2, disconnect the heater wire and then connect it to the red male spade wire of the dash fan harness. If there is no heater/defogger present disregard and cover unused wire with tape or heat shrink.
- b) Connect the red power wire with female spade terminal to S2 of the spade block next to Fuse Panel.
- c) Connect the black wire with round eyelet terminal to 12 V chassis ground (frame). Secure using a self-tapping screw. Located behind PSDM as shown in figure.

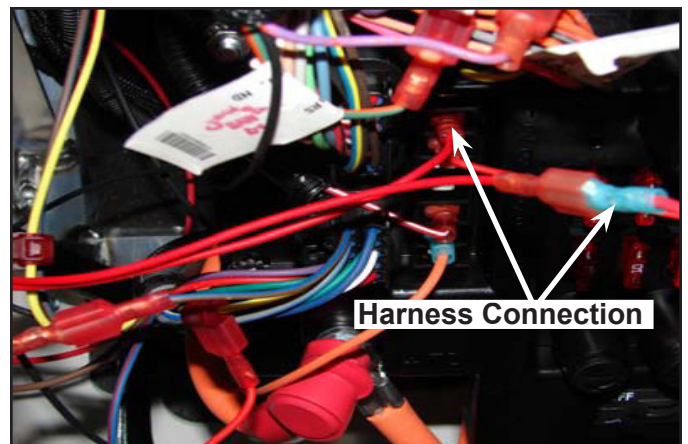

NOTE: Use no more than three wires per ground screw.

- d) Install a standard automotive spade type 10 Amp fuse to F2 in Fuse Panel. (See also Owner's Manual.)



14. Connection of Harness for 2004-Old Model:

- a) Connect the red female spade terminal from the dash fan harness to one of the two (2) wires located on the ECM controller harness. (Green/Red or Brown/Red) (G).
- b) Remove the black heat shrink from the wire and then crimp on a male spade terminal.
- c) Connect the black wire with round eyelet terminal to 12 V chassis ground (frame). Secure using a self-tapping screw.
- d) Locate the fuse block under hood on passenger side. (See also Owner's Manual.) Insert a 10 Amp fuse, max. (a 3 Amp or 5 Amp fuse may be sufficient depending on installation of either the single or dual dash fan option.)

NOTE: Wires not being used should be covered by tape or heat shrink for protection.

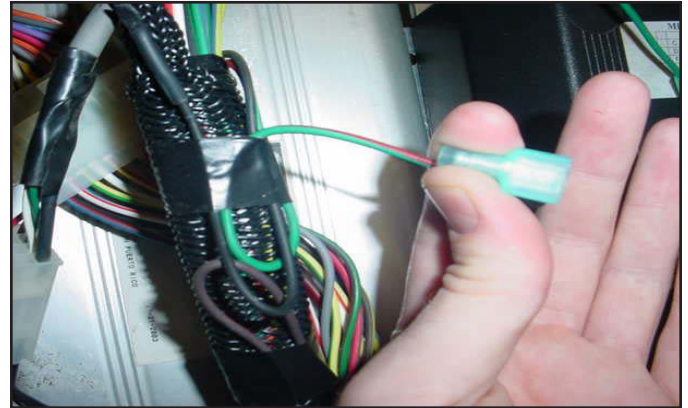
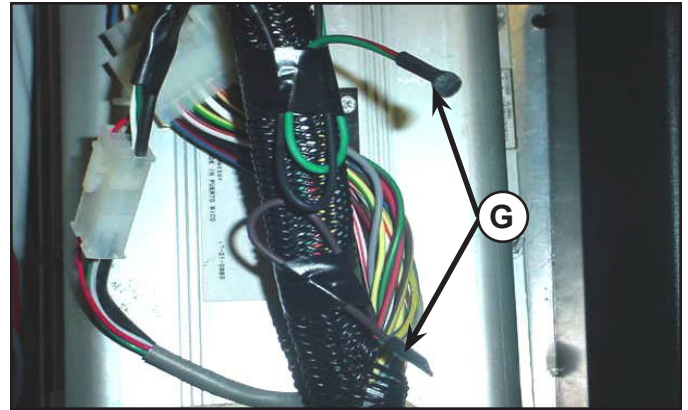

15. Reinstall Lower Dash:

- a) Install lower panel tabs into slots in floor pan.
- b) Remove electrical tags and connect any electrical connections. Then slowly rock lower panel forward into place.
- c) Install three screws on top surface mounting tabs.

NOTE: Take care not to scratch steering column/instrument pod covers.

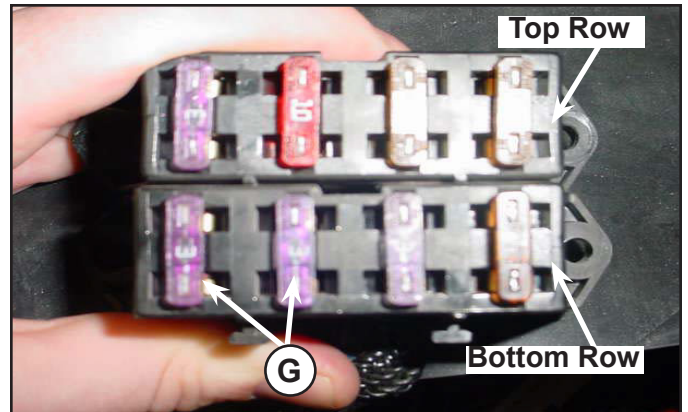

16. Reinstall Upper dash

- a) Connect heater ducts at heater assembly (if equipped).
- b) Connect electrical connections, if applicable.
- c) Position upper dash assembly on lower dash assembly.
- d) Attach upper dash to the lower windshield support with two screws.
- e) Close hood and latch.

NOTE: Take care not to scratch steering column/instrument pod covers. Also take care not to cross thread bolts or jack nuts, or dash panel will strip.



17. Connect dash fan(s) to their mating 2- pin white Molex connectors on the dash fan harness.

NOTE: See above figures in Step 9 for connecting fan(s) to harness.

18. Verify Operation

a) Turn MDS to the 'ON' position.

b) Turn ignition key switch on.

c) Flip toggle switch on base of dash fan(s) on and verify dual speed (high/low) fan operation.