

TURN SIGNAL KIT



P/N 2880882

APPLICATION

eM1400, eM1400 LSV, M1400

BEFORE YOU BEGIN

Read these instructions thoroughly and make sure all parts and tools are accounted for. Please retain these installation instructions for future reference and parts ordering information.

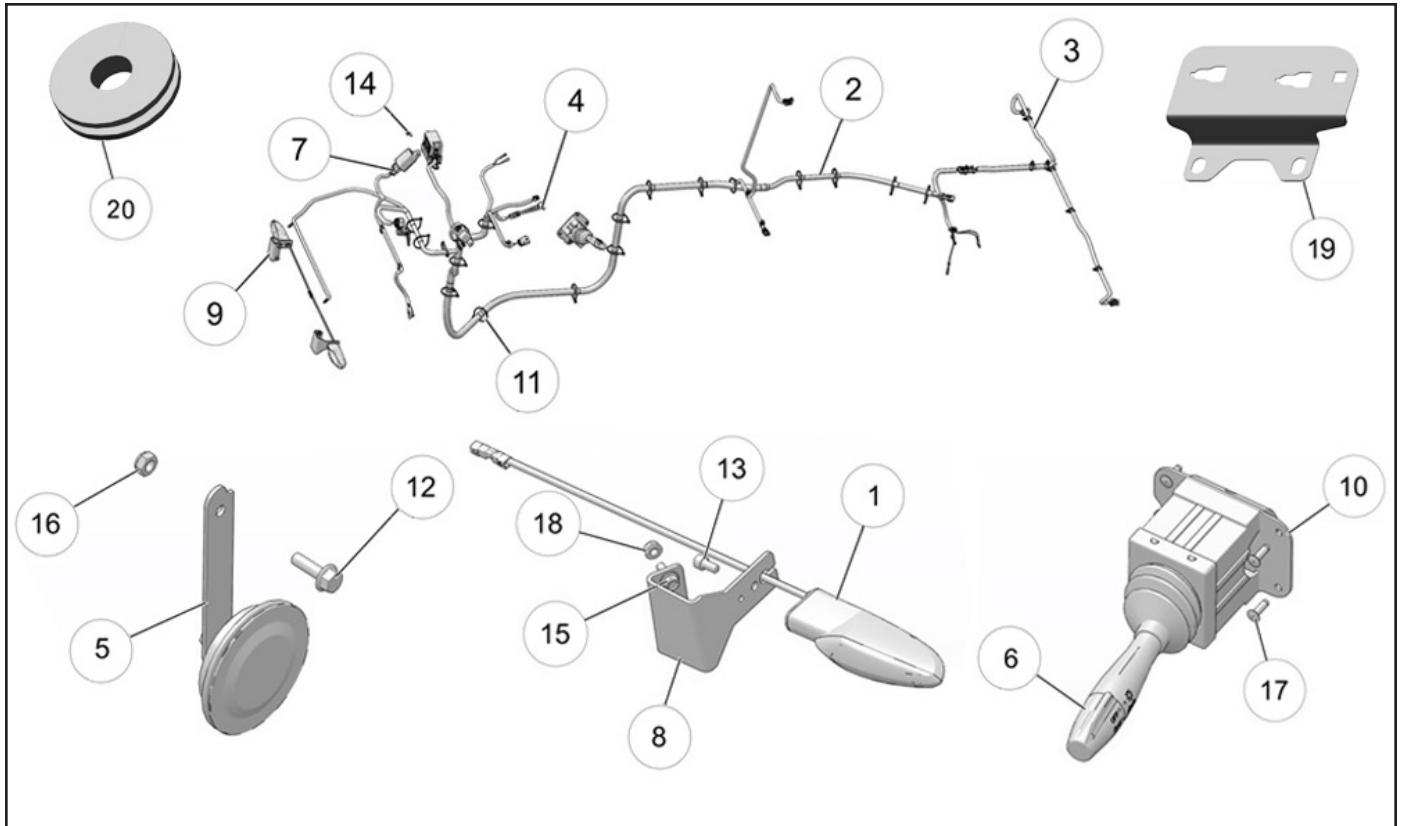

KIT CONTENTS

| Ref | Qty | Part Description | Part Number |
|-----|-----|--------------------|-------------|
| 1 | 2 | Turn Signal | 2411114-463 |
| 2 | 1 | Parasite Harness | 2412998 |
| 3 | 1 | Harness Cargo box | 2413000 |
| 4 | 1 | Turn Indicator | 4011464 |
| 5 | 1 | Horn Disc | 4011579 |
| 6 | 1 | Switch Block | 4015159 |
| 7 | 1 | Flasher LED Module | 4015291 |
| 8 | 1 | Signal Bracket LH | 5260290-458 |
| 9 | 1 | Signal Bracket RH | 5260291-458 |
| 10 | 1 | Turn stock Mount | 5260477-458 |
| 11 | 19 | Panduit Strap | 7080138 |
| 12 | 1 | Screw M6X1.0X20 | 7516822 |

| Ref | Qty | Part Description | Part Number |
|-----|-----|--------------------|-------------|
| 13 | 2 | Screw M6X1.0X12 | 7517781 |
| 14 | 3 | Screw M6X1.0X20 | 7518529 |
| 15 | 4 | Screw M6X1.0X26 | 7518773 |
| 16 | 1 | Nut M6X1 | 7546703 |
| 17 | 4 | Rivet POP3/16 | 7621462 |
| 18 | 4 | Nut M6X1 | 7710495 |
| 19 | 1 | Fuse Block Bracket | 5253928 |
| 20 | 1 | Grommet | 5414504 |
| | | Instructions | 9925874 |

TOOLS NEEDED

Metric Socket Set
Metric Wrench Set

Safety Glasses
3/16" Drill bit

1.25" Hole Saw
Utility Knife

Drill
5/16" Drill bit

APPROXIMATE ASSEMBLY TIME

60 mins

IMPORTANT

Your Polaris TURN SIGNAL KIT is exclusively designed for your vehicle. Please read the installation instructions thoroughly before beginning. Installation is easier if the vehicle is clean and free of debris. For your safety, and to ensure a satisfactory installation, perform all installation steps correctly in the sequence shown.

INSTALLATION INSTRUCTIONS

1. Park the vehicle. Turn key to "OFF" position and remove from the vehicle.
2. Remove seat bottom.
3. **M1400:** Disconnect negative (black) and positive (red) cables from battery.
eM1400, eM1400LSV: Disconnect main power connector. See Owner's Manual for reference.
4. Mount signal bracket LH (8) by using two screws (15) and nuts (18) as shown in figure.
Apply Torque to 6 ft. lbs. (8.14 Nm).

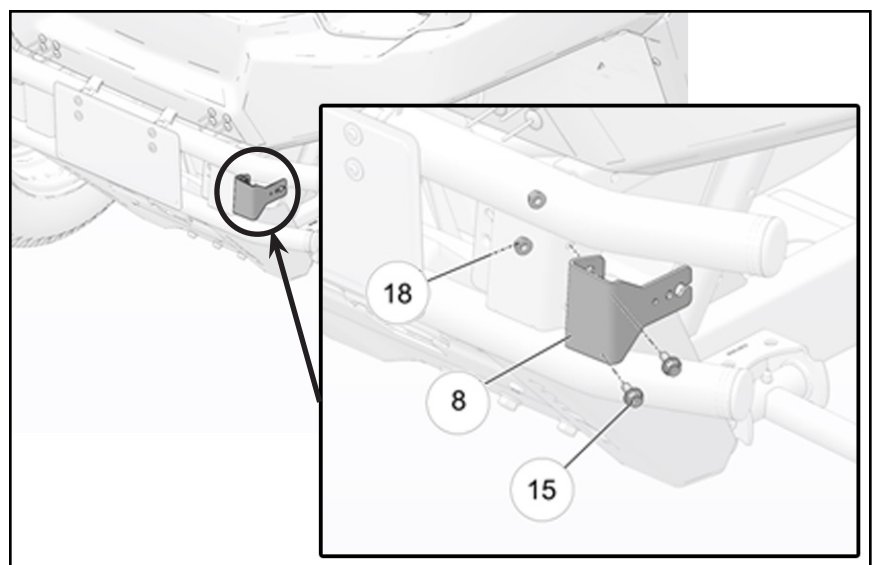

5. Repeat Step 4 for signal bracket RH (9).
6. Install turn signal (1) on to the bracket (8) by using M6 screw (13) as shown in figure.
Apply Torque to 6 ft. lbs. (8.14 Nm).

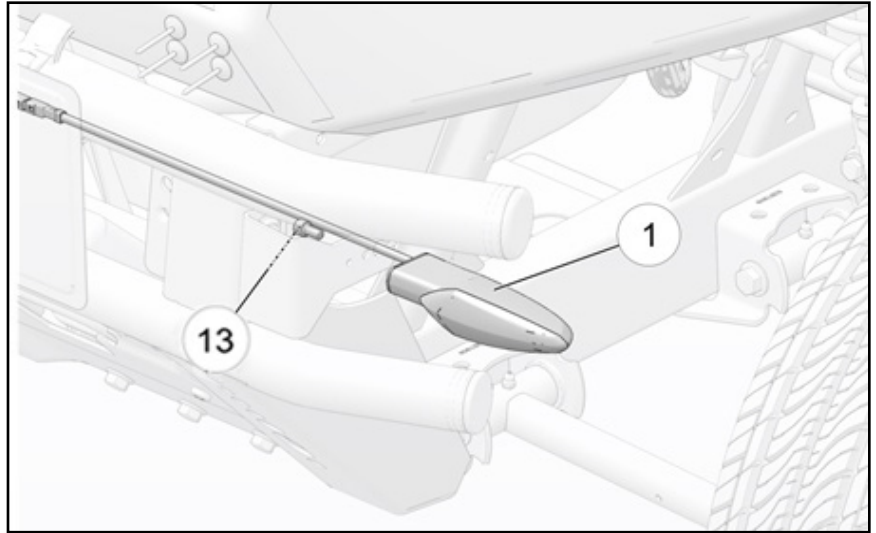

7. Repeat Step 6 for turn signal (1) in right hand side.
8. Open the hood (A) by detaching retainer strap as shown in figure.

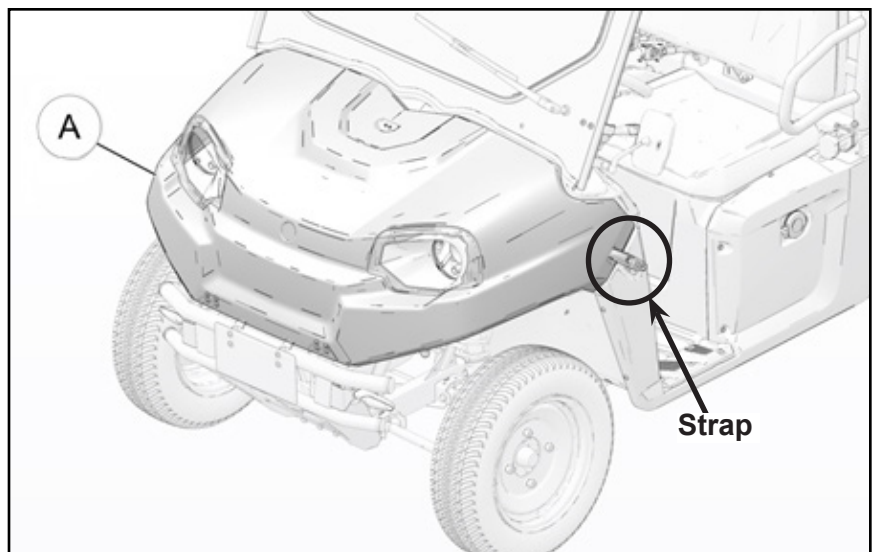

9. Install horn disc (5) on to the chassis by using M6 screw (12) and nut (16).
Apply Torque to 6 ft. lbs. (8.14 Nm).

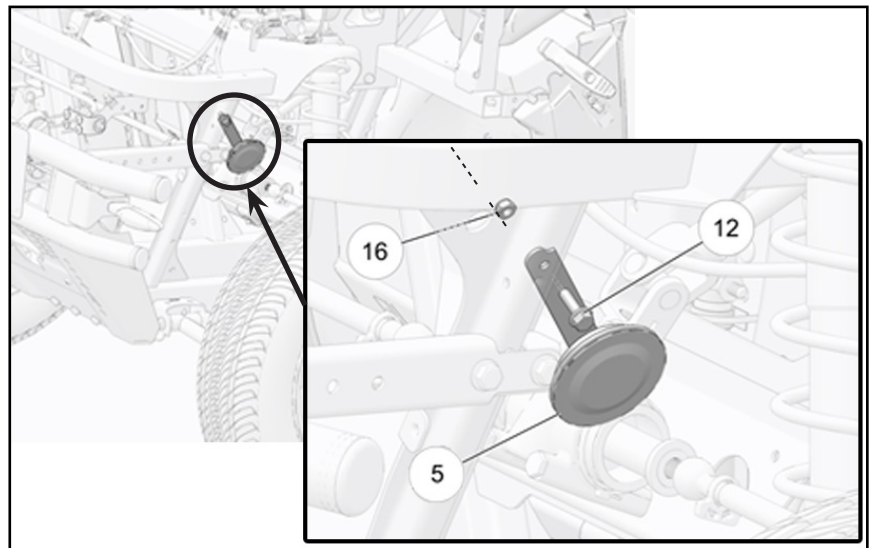

10. Use mounting plate (10) to mark the location of the turn stock and drill 4- 3/16" holes, and 2- 5/16" holes. Attach mounting plate (10) to turn stock (6) using two screws supplied with the turn stock. Install turn stock (6) with the mounting plate (10) by using four rivets (17) on to the column as shown in figure.
11. Use 1.25" holesaw to drill hole in the dash forward of the turnstock. Route the turn stock wire harness through the hole using the grommet (20).

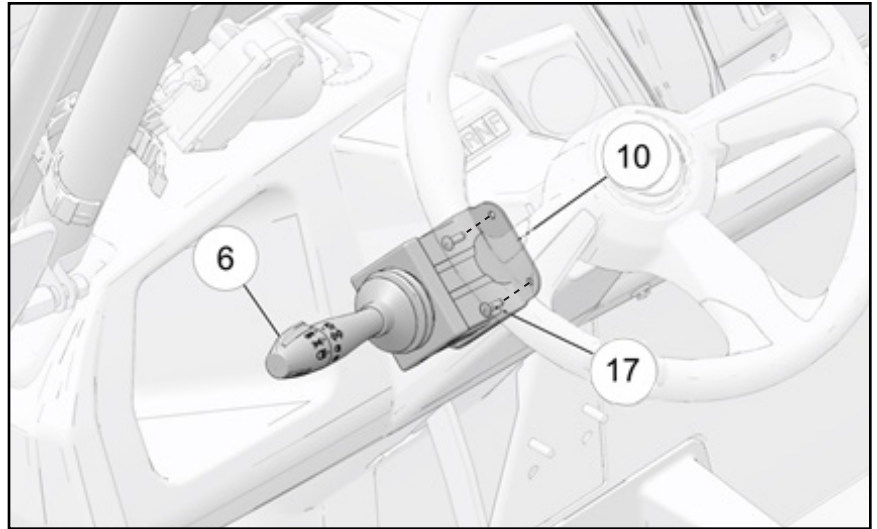

12. Cut 33.0 X 9.6 mm rectangular slot using a utility knife and snap turn indicator (4) in the dash panel (B) as shown in figure.

NOTE: Ensure enough access behind dash panel for mounting and routing of harness and remove burrs / sharp edges.

CAUTION: Do not cut any wires behind the dash panel.

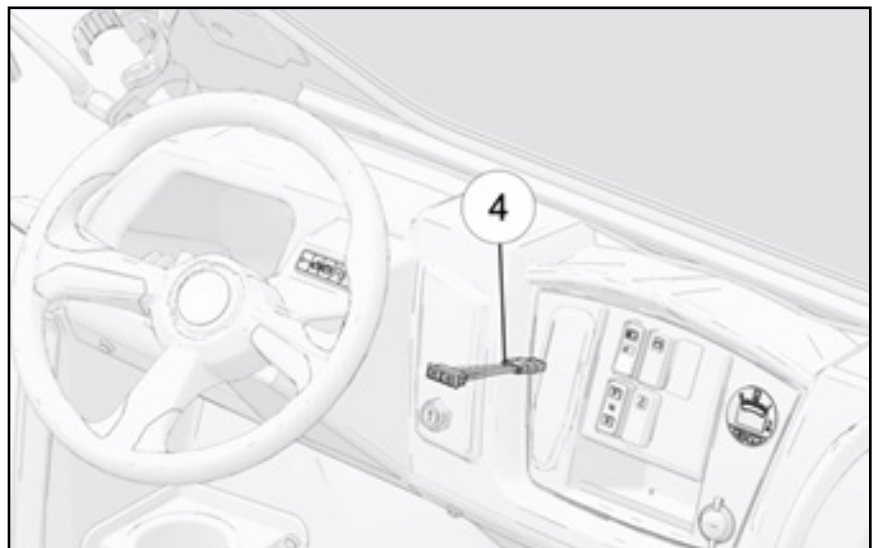
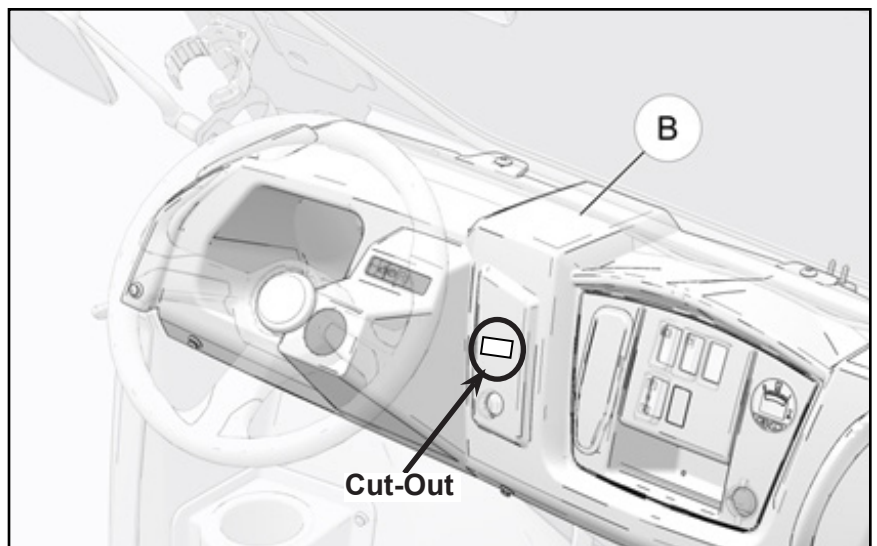

13. Install flasher LED module (7) on to the chassis by using M6 screw (14) as shown in figure.
Apply Torque to 6 ft. lbs. (8.14 Nm).

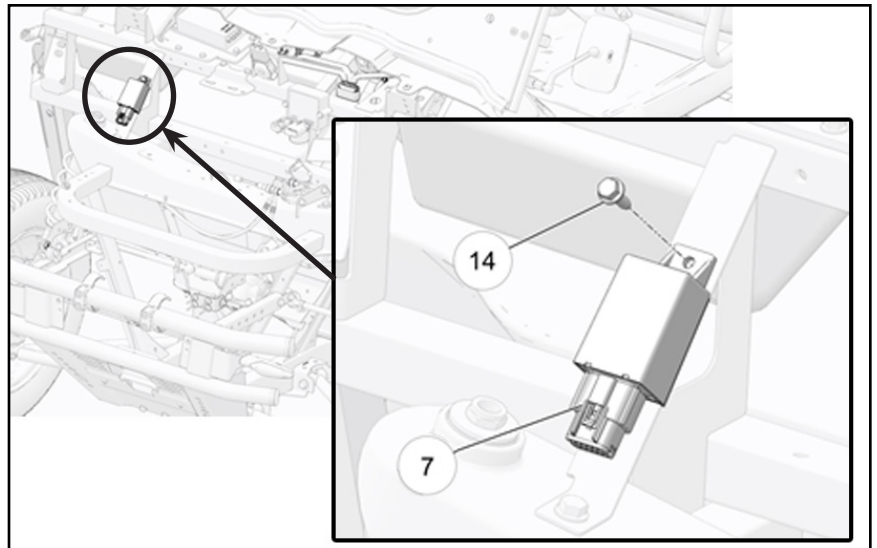

14. Install fuse block bracket (19) using two M6 screws (14) as shown in figure.

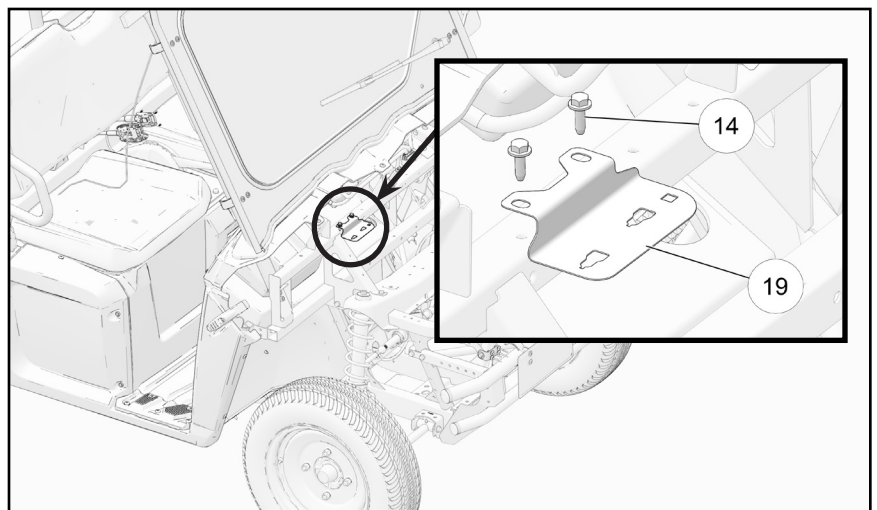

15. Route the parasite harness (2) from bottom vehicle up to the dash and make connections as shown in figure.

NOTE: Keep harness away from the radiator (If present).

C = LH Front Turn Signal.

D = RH Front Turn Signal.

E = Flasher Module.

F = Diagnostic.

J = Diagnostic Interconnect.

K = Horn.

L = Terminal Block.

M = Relay.

N = Diode/Relay Center.

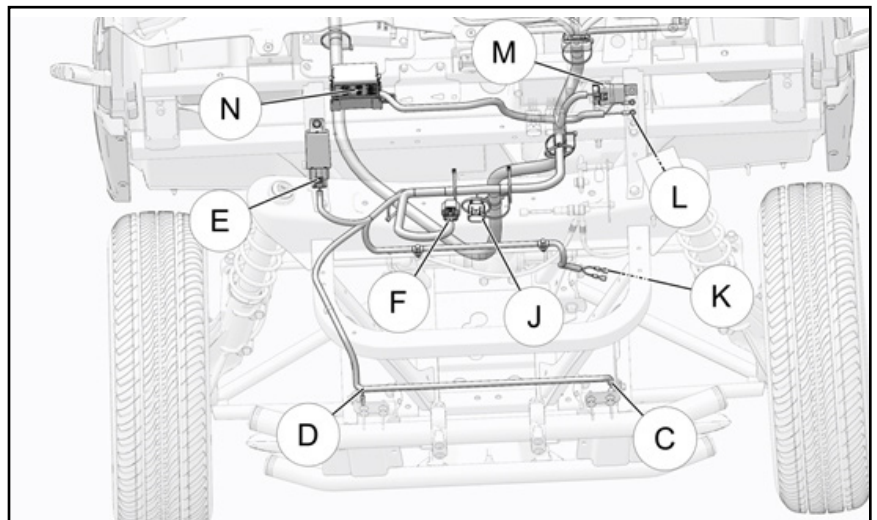

16. Tie the harness using panduit straps (11) at the shown locations to avoid contact with rotating parts and sharp edges and push the fastening clips into the corresponding holes in frame as shown in figure.

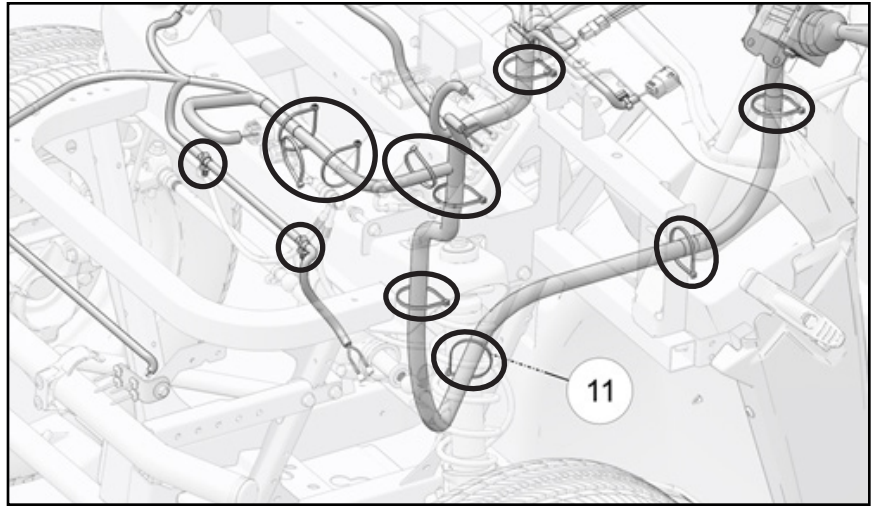

17. Make connections of the parasite harness (2) on the dash panel side as shown in figure.

P = Turn Indicator panel.

Q = Turn/Hazard/Horn switch.

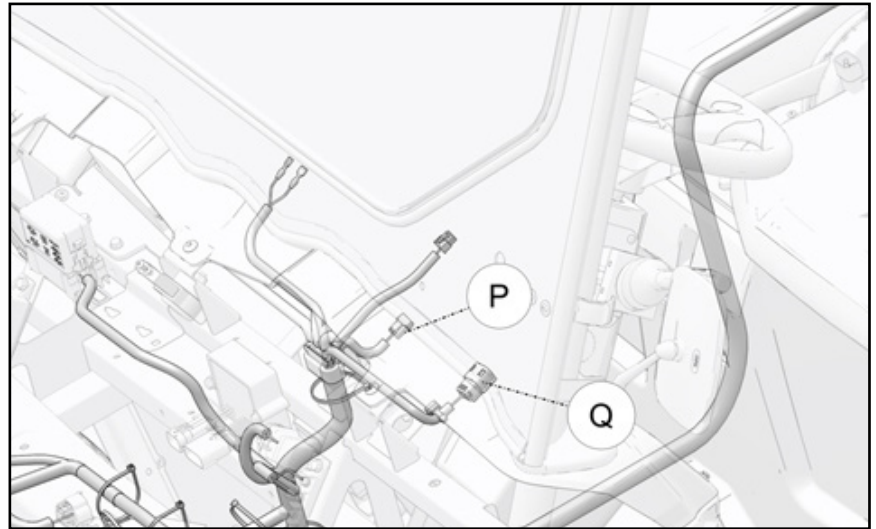

18. Route the parasite harness (2) under the vehicle body as shown path, Tie the harness to the main harness using panduit straps (11) at the shown locations to avoid contact with rotating parts and sharp edges.

NOTE: Harness will route along passenger side on eM1400 and eM1400LSV. The harness will route along driver's side on M1400. Raising vehicle off of the ground and supporting securely will allow access to wiring underneath vehicle and aid in routing the cable.

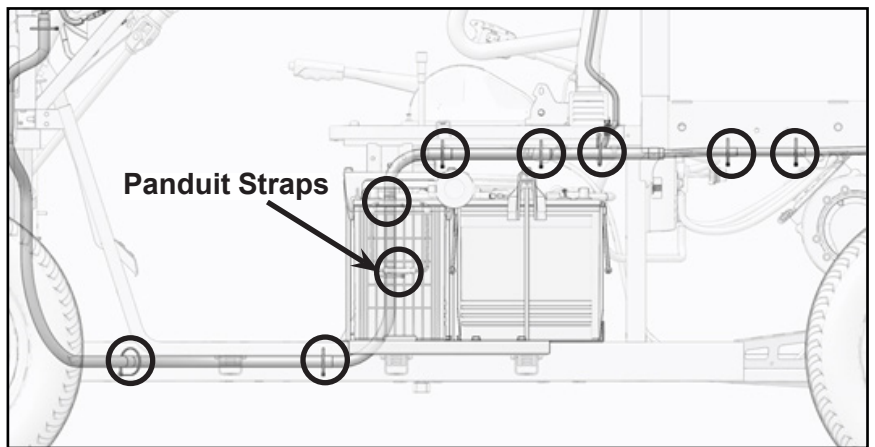
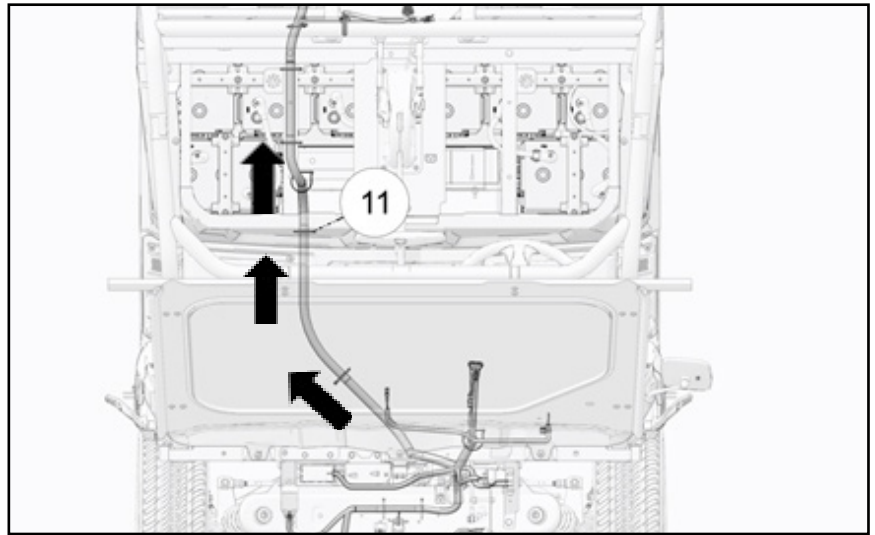

19. Make connections of the parasite harness (2) on the rear side of the vehicle as shown in figure.
20. Chassis Inline connector.

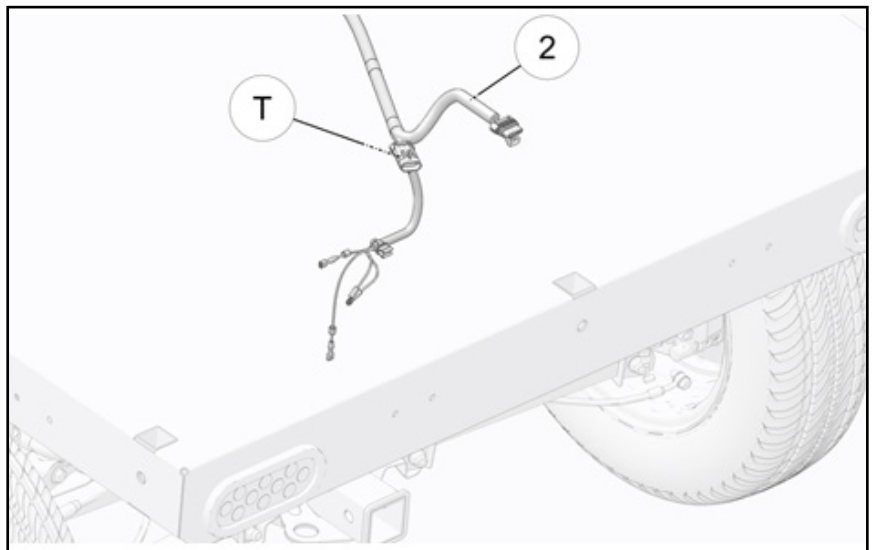

21. Make connections of the cargo box harness (3) with parasite harness (2) on the rear side of the vehicle and push the fastening clips into the corresponding holes in frame which are circled in the figure.

U = Tail/Brake light LH.

V = Tail/Brake light RH.

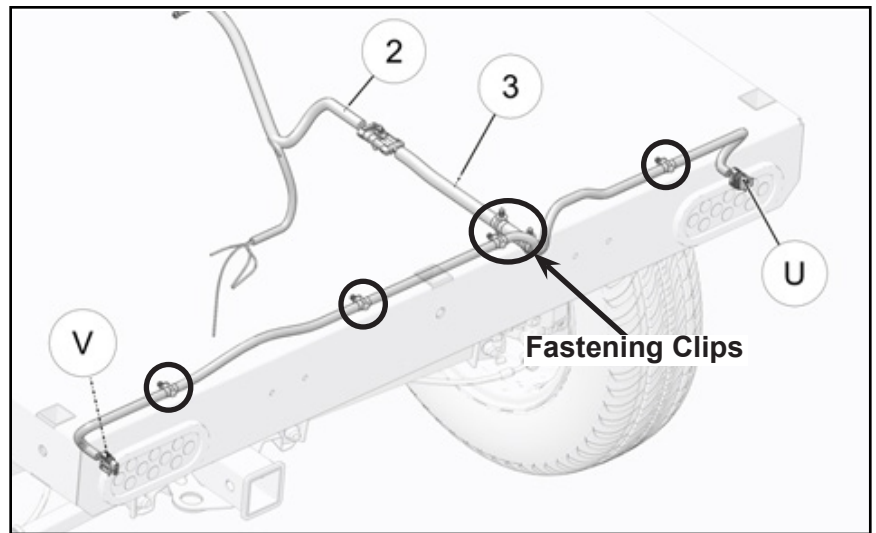

22. Secure all unused connections and wrap with electrical tape.

23. **M1400:** Reconnect the negative (black) and positive (red) cables to battery.

eM1400, eM1400 LSV: Reconnect master disconnect plug.

24. Reinstall seat bottoms and close the hood.

25. Restart the vehicle and check the properly functionality of the turn signal.