

# PREMIUM CREW DOOR KIT

**POLARIS**

ENGINEERED PARTS  
ACCESSORIES & APPAREL

**P/N 2883082**

## APPLICATION

Verify accessory fitment at [Polaris.com](https://polaris.com).

## BEFORE YOU BEGIN

Read these instructions and check to be sure all parts and tools are accounted for. Please retain these installation instructions for future reference and parts ordering information.

## KIT CONTENTS

This Kit includes:

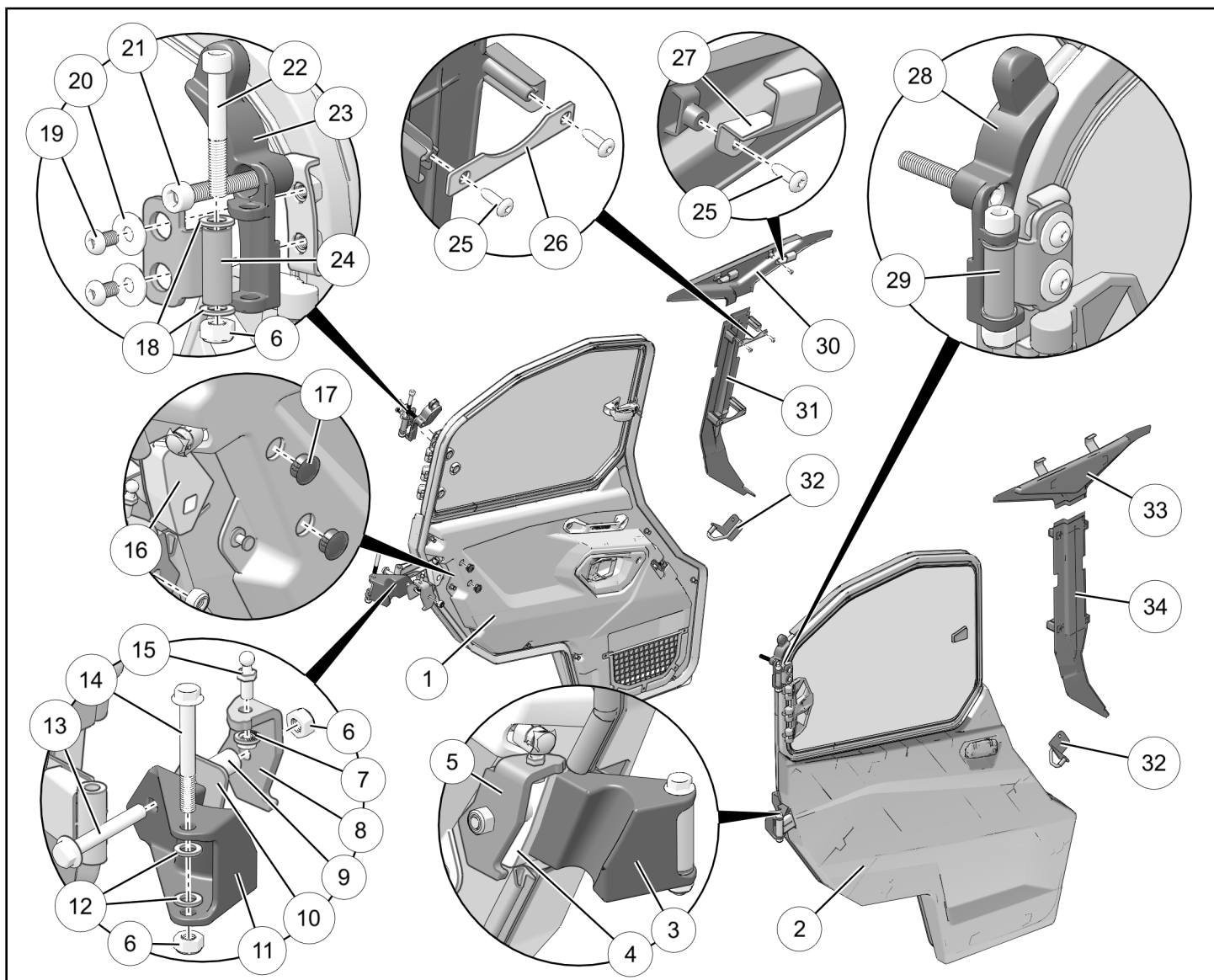

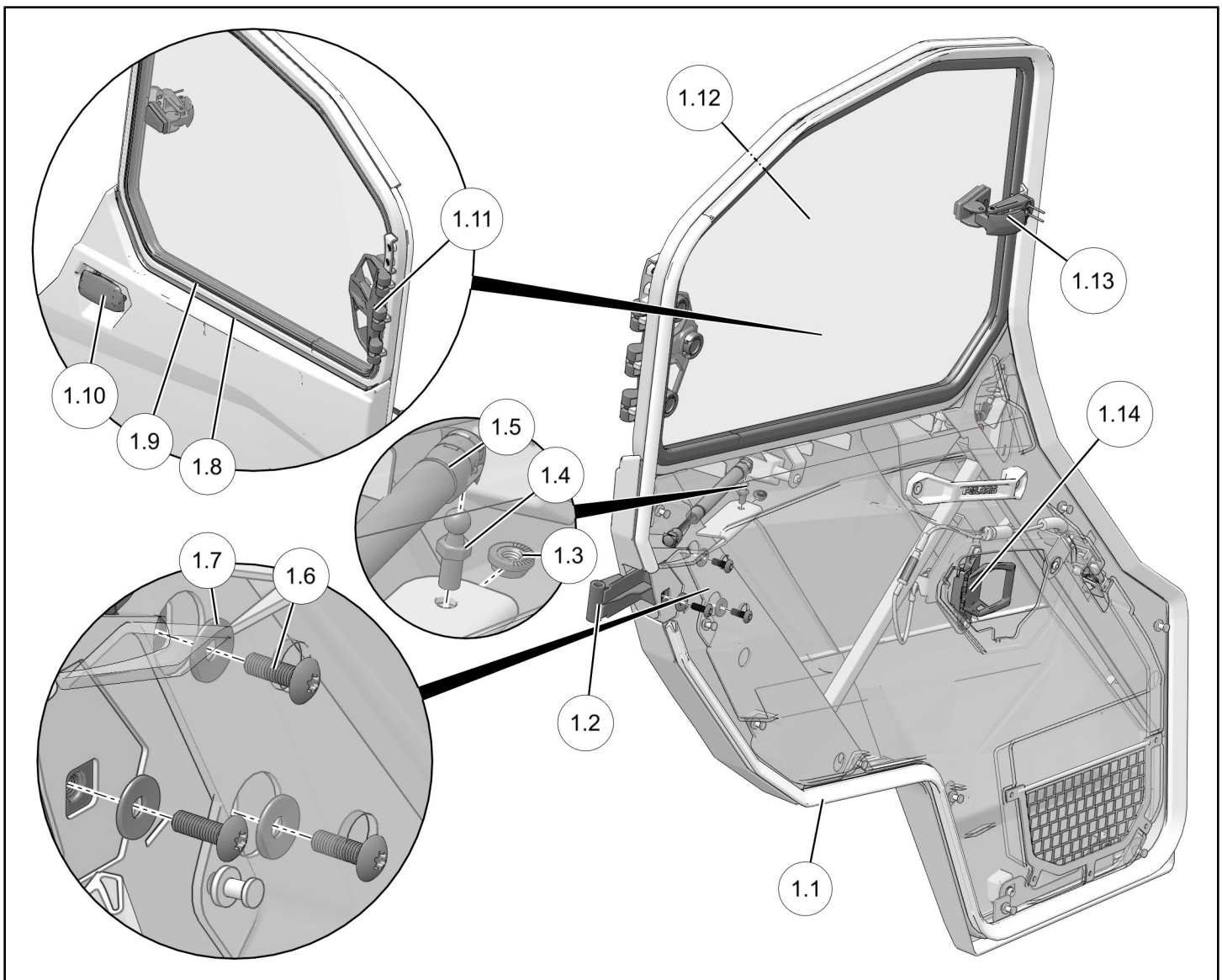

REF	QTY	PART DESCRIPTION	PART NUMBER	INCLUDED IN SERVICE KIT
1	1	Door Assembly, LH (includes items 1.1–1.14)	2636815	-
1.1	1	- Seal, Door, Perimeter, LH	-	2207998*
1.2	1	- Hinge, Door-Side, Lower LH	-	2207995**
1.3	1	- Nut, Hex Flange, Locking, Serrated - M8	-	2208000**
1.4	1	- Fitting, Ball-End	7082301	2208000**
1.5	1	- Strut	7044799	2208000**
1.6	3	- Screw, Torx® Truss Head - M8 X 25	-	2207995**
1.7	3	- Washer, Conical Spring - M8	-	2207995**
1.8	1	- Seal, Lower Window Frame	-	2207998*, 2207999*
1.9	1	- Seal, Glass, Perimeter	-	2207998*, 2207999*
1.10	1	- Latch Assembly, Exterior, LH	7082354	-

REF	QTY	PART DESCRIPTION	PART NUMBER	INCLUDED IN SERVICE KIT
1.11	1	- Hinge, Window (with clips)	-	2207992*
1.12	1	- Glass, LH	-	2207993*
1.13	1	- Latch, Window (with hardware)	-	2207997*
1.14	1	- Latch Assembly, Interior	-	2208002*
2	1	Door Assembly, RH (includes items 2.1, 2.2, 2.10, 2.12; all <b>other</b> parts same as those identified in 1.x above)	2636816	-
2.1	1	- Seal, Door, Perimeter, RH	-	2207999*
2.2	1	- Hinge, Door-Side, Lower RH	-	2207995**
2.10	1	- Latch Assembly, Exterior, RH	7082353	-
2.12	1	- Glass, RH	-	2207994*
3	1	Hinge, Chassis-Side, Lower RH	-	2207996**
4	1	Seal, Foam, RH	-	2207999*
5	1	Bracket, Strut Mounting, RH	-	2208000**
6	6	Nut, Hex - M10 X 1.5	7547039	2207996**
7	2	Nut, Hex Flange, Locking, Serrated - M8	-	2208000**
8	1	Bracket, Strut, LH	-	2208000**
9	2	Spacer, Cylindrical	-	2207996**
10	2	Spacer, Flat	-	-
11	1	Hinge, Chassis-Side, Lower LH	-	2207996**
12	4	Washer, Nylon - 10.3 ID X 19.0 OD X 2.0 thick	5439712	2207996**
13	2	Bolt, Hex Flange - M10 X 1.5 X 65	7519903	2207996**
14	2	Bolt, Hex Flange - M10 X 1.5 X 80	-	2207996**
15	2	Fitting, Ball	7082301	2208000**
16	1	Seal, Foam, LH	-	2207998*
17	4	Plug - 0.75	-	-
18	4	Washer, Nylon - 11.1 ID X 15.9 OD X 0.8 thick	-	2207996**
19	4	Screw, Hex Socket Button Head - M8 X 16	-	2207995**
20	4	Washer, Conical Spring - M8	-	2207995**
21	2	Screw, Hex Socket Cap - M10 X 1.5 X 55	-	2207996**
22	2	Screw, Hex Socket Cap - M10 X 1.5 X 70	-	2207996**
23	1	Hinge, Chassis-Side, Upper LH	-	2207996**
24	1	Hinge, Door-Side, Upper LH	-	2207995**
25	12	Screw, Torx® Truss Head, High/Low - #14 X 3/4	7519045	2207990*, 2207991*

REF	QTY	PART DESCRIPTION	PART NUMBER	INCLUDED IN SERVICE KIT
26	4	Bracket, B-Pillar Lower Trim	-	2207990*, 2207991*
27	4	Bracket, B-Pillar Upper Trim	-	2207990*, 2207991*
28	1	Hinge, Chassis-Side, Upper RH	-	2207996**
29	1	Hinge, Door-Side, Upper RH	-	2207995**
30	1	Trim, B-Pillar, Upper LH	5455746	2207990*
31	1	Trim, B-Pillar, Lower LH	5455747	2207990*
32	2	Striker Bracket	1024864-458	-
33	1	Trim, B-Pillar, Upper RH	5455748	2207991*
34	1	Trim, B-Pillar, Lower RH	5455749	2207991*
	1	Instructions	9928347	-

\* Service kit contains parts and hardware required for ONE side of vehicle.

\*\* Service kit contains parts and hardware required for BOTH sides of vehicle.

## TOOLS REQUIRED

- Safety Glasses
- Pliers, Push Pin Rivet
- Push Dart (Panel Clip) Tool
- Screwdriver Set, Torx®
- Socket Set, Hex Bit, Metric
- Socket Set, Metric
- Socket Set, Torx® Bit
- Torque Wrench
- Wrench Set, Metric

## CONSUMABLES REQUIRED

- Gloves, Chemical Resistant
- Grease, Polaris All Season (or equivalent)

## IMPORTANT

Your Premium Crew Door Kit is exclusively designed for your vehicle. Please read the installation instructions thoroughly before beginning. Installation is easier if the vehicle is clean and free of debris. For your safety, and to ensure a satisfactory installation, perform all installation steps correctly in the sequence shown.

## INSTALLATION INSTRUCTIONS

### REMOVE EXISTING REAR DOORS

#### NOTE

Polaris recommends two people install perform this section.

Retain all door parts for seasonal reinstallation.  
LH side shown; RH side opposite.

1. Shift vehicle transmission into "PARK". Turn ignition switch to "OFF" position and remove key.
2. Remove rear seats.
3. Open and support door while removing nuts (A), bolts (B), and bushings (C) from upper and lower hinges. Set door aside.

#### NOTE

View looking rearward at left rear door.

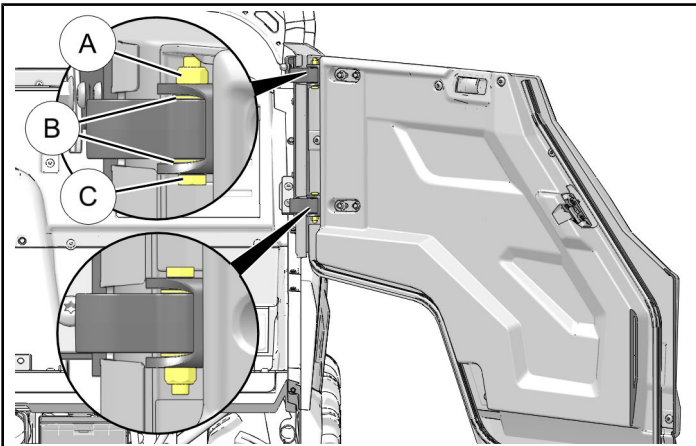

4. Remove bolster panel by removing four screws (D).

#### NOTE

Panel removal is required to remove bolt (F) in next step.

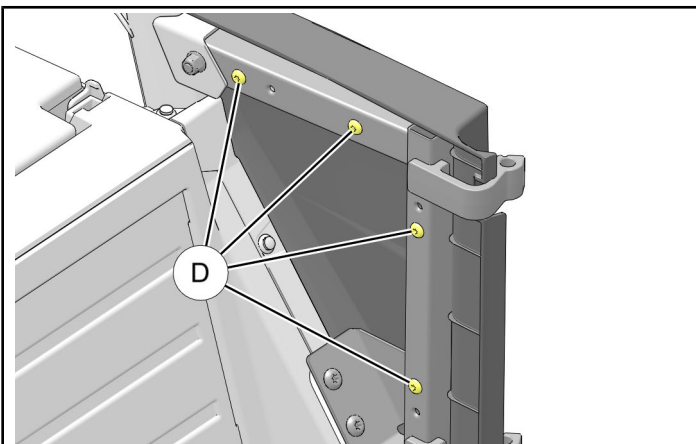

5. Remove bolster frame by removing nut (E), bolt (F), and two screws (G).

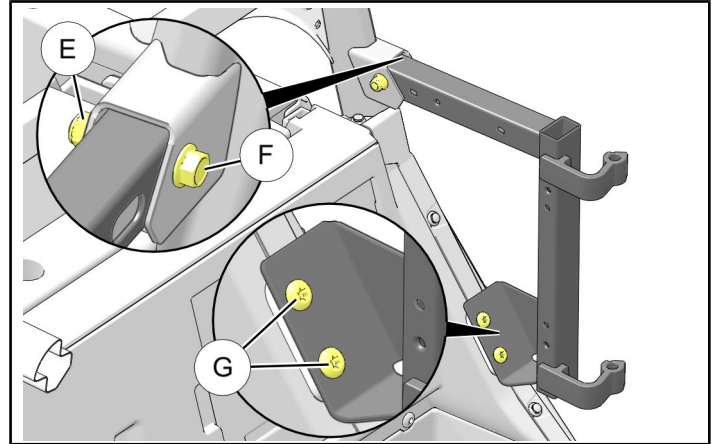

6. Remove striker bracket by removing two screws (H).

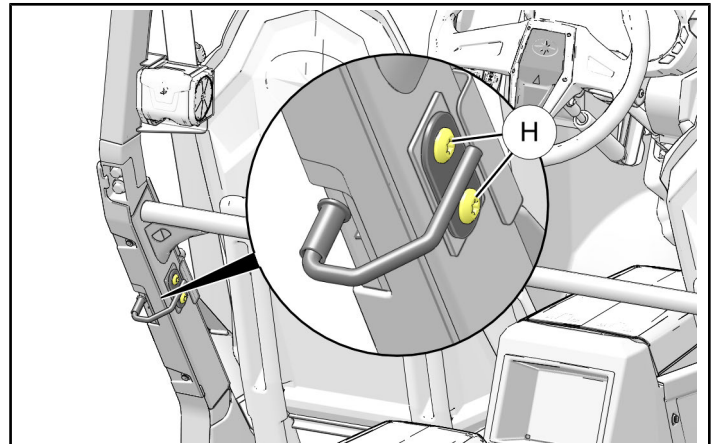

7. Remove push pin rivet (J).

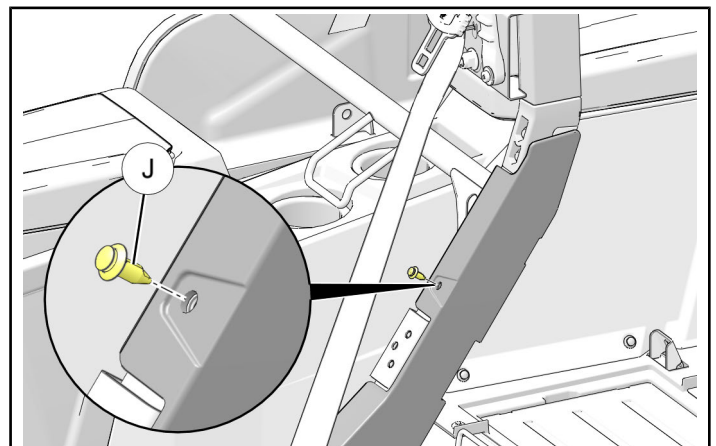

8. Repeat Steps 1–7 for RH side of vehicle.



## INSTALL NEW REAR DOORS

### NOTE

Polaris recommends two people install perform this section.  
LH side shown; RH side opposite.

1. Remove LOWER REAR screw ① from top of ROPS C-pillar fitting.

### IMPORTANT

Do NOT loosen or remove upper forward screw ①.

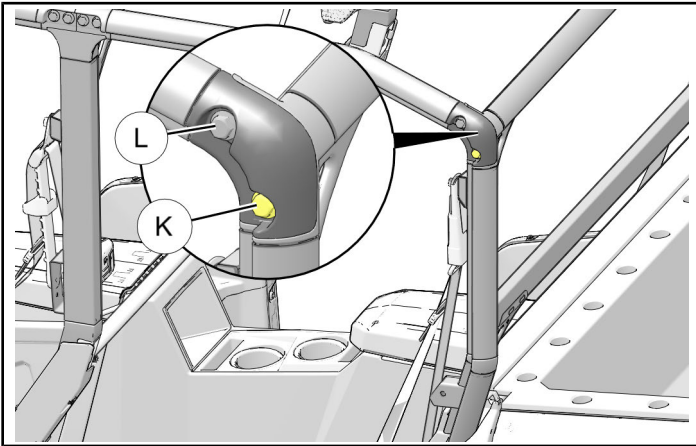

2. Identify 55 mm long cap screw ②. Notice differences from 70 mm long cap screw ③.

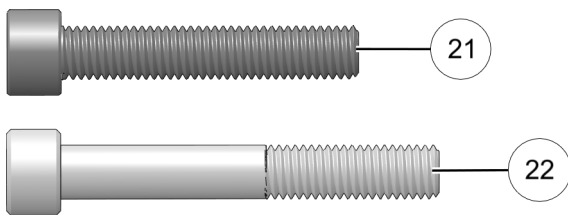

### ⚠ WARNING

Failure to torque fasteners as directed in next step will adversely affect ROPS integrity and may lead to severe injury or death in an accident.

3. Install upper LH chassis-side hinge ③ to ROPS C-pillar fitting using 55 mm long cap screw ②. Torque to specification.

### TORQUE

40 ft. lbs. (54 Nm)  $\pm$  10%

### NOTE

Hinge uses existing screw ① for alignment only.  
Hinge is not secured by screw.

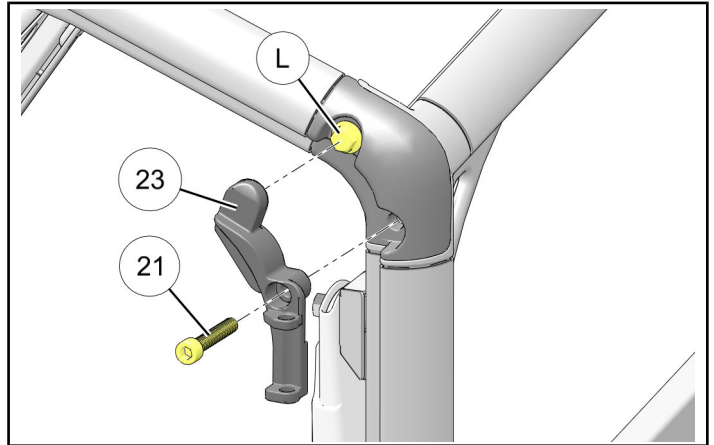

4. Install lower LH chassis-side hinge ④ and LH strut bracket ⑤ to ROPS mounting bracket using 65 mm hex flange bolt ⑥, spacer ⑦, and nut ⑧. Torque to specification.

### IMPORTANT

If weldment prevents hinge from lying flat against ROPS mounting bracket, then install spacer ⑦ between hinge and bracket.  
Spacer is ONLY needed to accommodate weldment interference.

### TORQUE

40 ft. lbs. (54 Nm)  $\pm$  10%

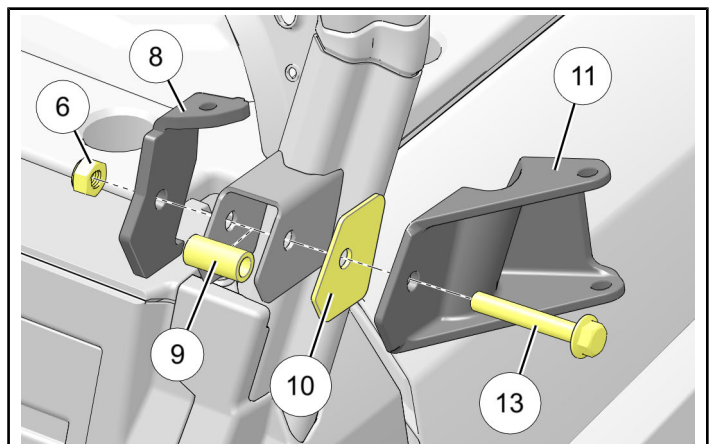

5. Install ball fitting ⑮ to LH strut bracket ⑧ using nut ⑦. Tighten nut.

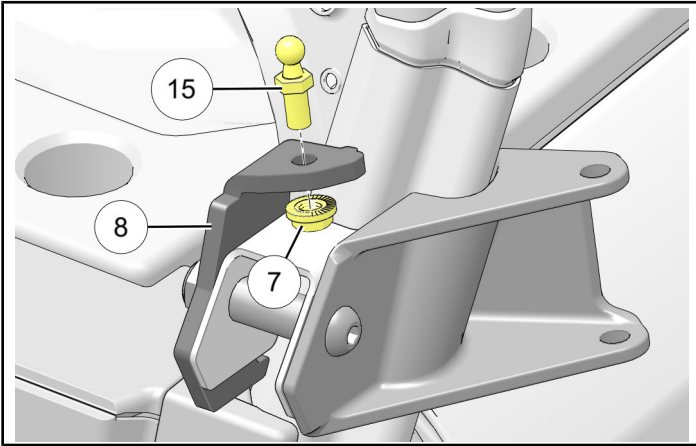

6. Loosely install upper LH door-side hinge ⑳ to door frame using two each screws ㉑ and conical spring washers ㉒. Ensure cupped (concave) side of washer is towards hinge.

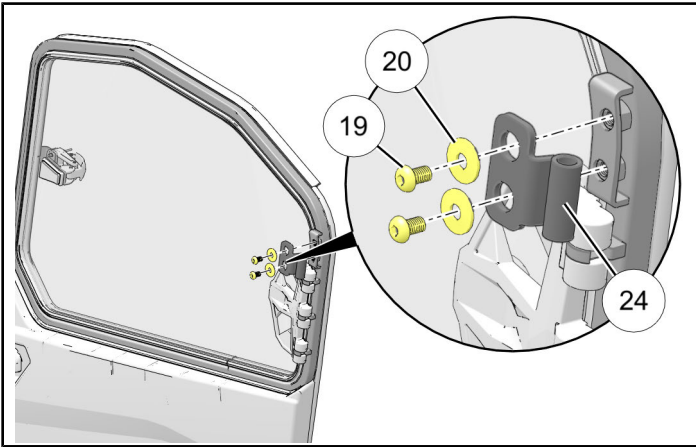

**⚠ WARNING**

Follow all chemical manufacturer instructions and safety precautions in next step. Failure to follow all manufacturer instructions and precautions may result in severe injury or death.

7. Grease hinge fasteners ㉒ and ⑭ with Polaris All Season Grease (or equivalent).

8. Install LH door assembly ① to upper and lower chassis-side hinges as follows:

- **UPPER:** Hex socket cap screw ㉒, two thinner and smaller nylon washers ⑱ (inserted between chassis and door-side hinges), and nut ⑥
- **LOWER:** Hex flange bolt ⑭, two larger and thicker nylon washers ⑫ (inserted between chassis and door-side hinges), and nut ⑥

Torque both hinge nuts to specification.

**TORQUE**

8 ft. lbs. (11 Nm)  $\pm$  10%

**NOTE**

Washer acts as bearing surface to assist in smooth door operation.

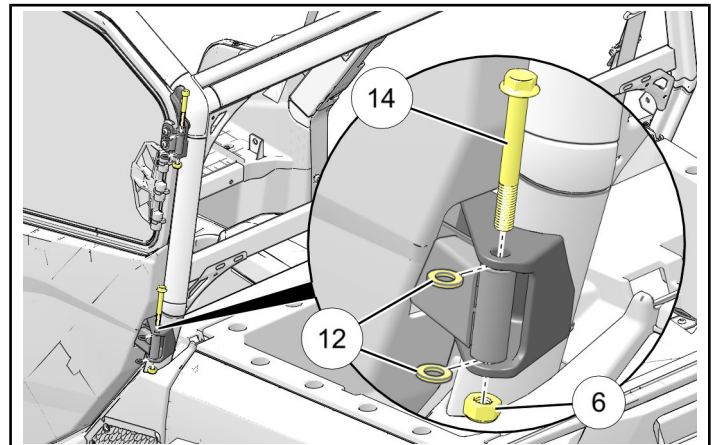
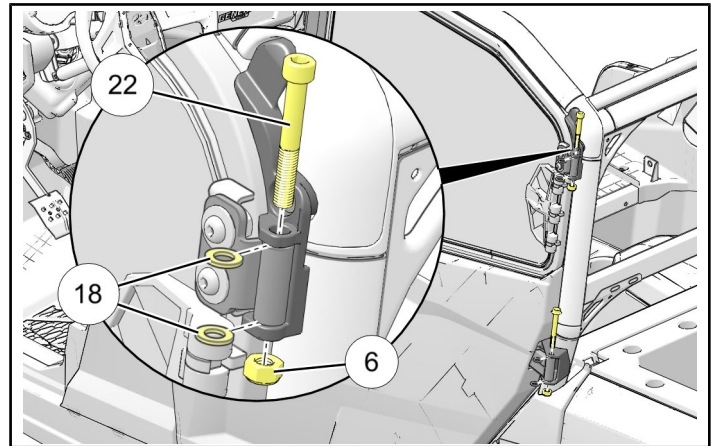

9. Ensure two upper DOOR-SIDE hinge screws ⑰ are slightly loose, then close door.

Push door inwards while attempting to center door in ROPS/chassis opening. Hold door in place, then observe gap between door and ROPS/chassis (around entire perimeter of door).

- **IF PERIMETER GAP IS EVEN:** Tighten screws ⑰.
- **IF PERIMETER GAP IS UNEVEN:** Open door, loosen three lower DOOR-SIDE hinge screws ① (interior side of door), close and center door in ROPS/chassis opening, then tighten screws ① and ⑰.

#### TIP

Have one person hold and center the door, and a second person tighten the screws.

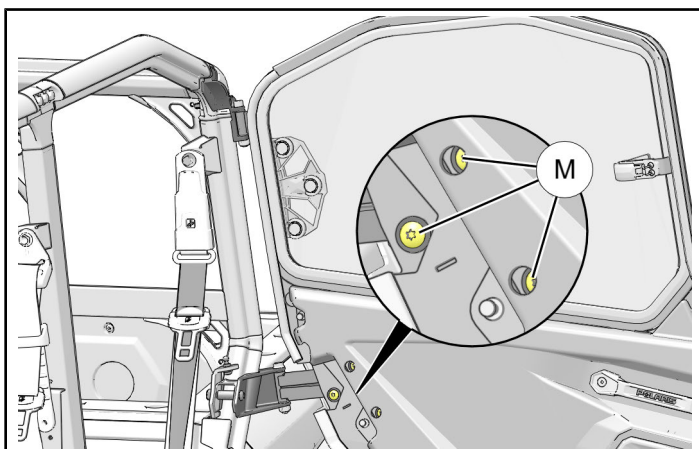
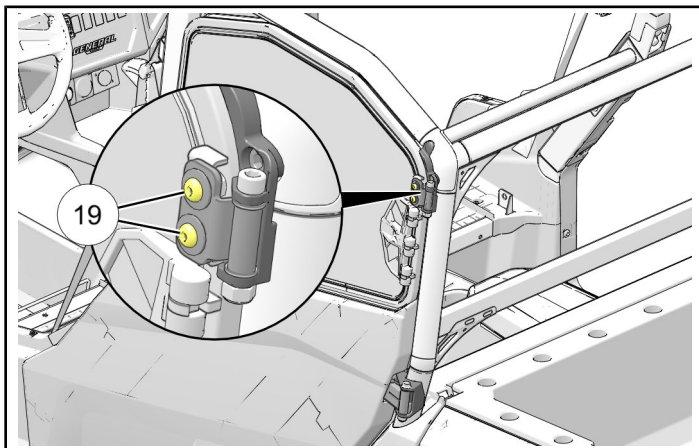

10. Torque all four upper hinge screws ⑰ (and lower hinge screws ①, if loosened) to specification.

#### TORQUE

17 ft. lbs. (23 Nm)  $\pm$  10%

11. Identify LH foam seal ⑰. Peel adhesive backing from seal, then press firmly into place, aligning hole in seal with door-side hinge screw ①.

Install two plugs ⑰.

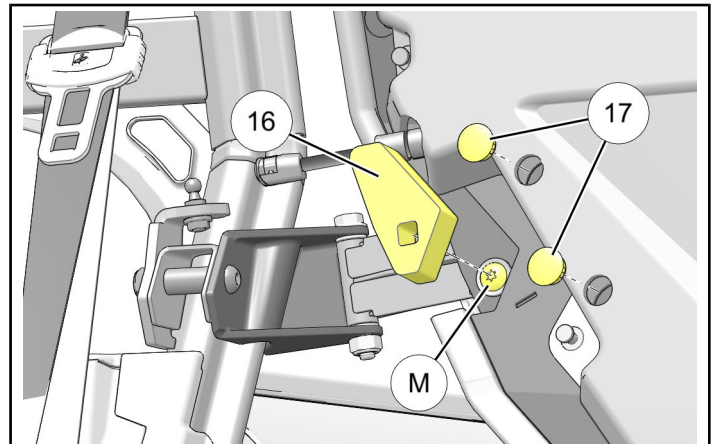

12. Install upper LH B-pillar trim ③① using two each brackets ②⑦ and screws ②⑤. Do not overtighten screws.

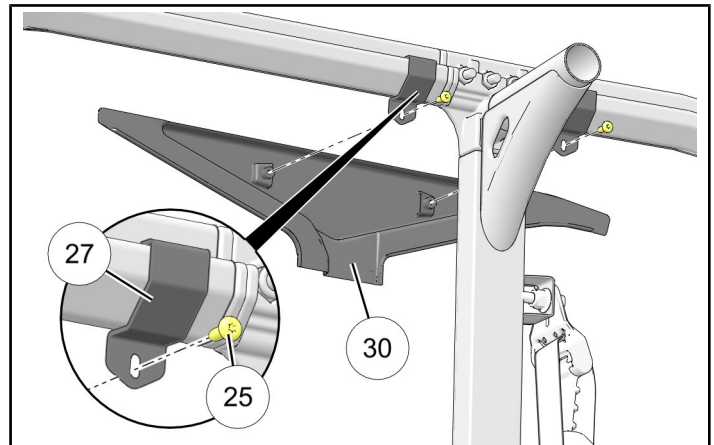

13. Install lower LH B-pillar trim ③② using two each brackets ②⑥ and screws ②⑤. Do not overtighten screws.

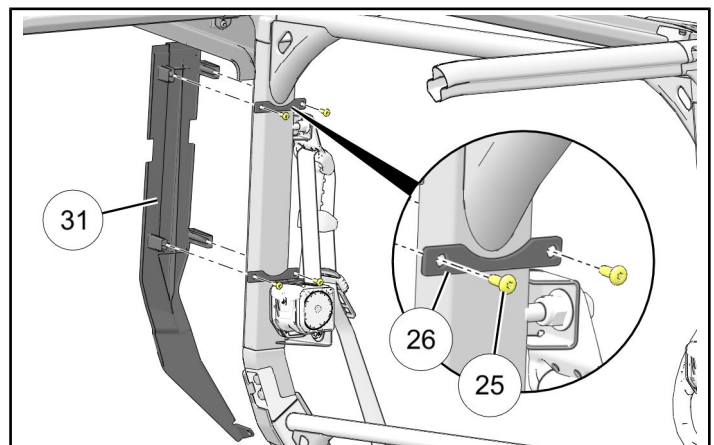



14. Secure lower portion of lower LH B-pillar trim ③① using retained push pin rivet ① (see previous section **REMOVE EXISTING REAR DOORS**, Step 7).

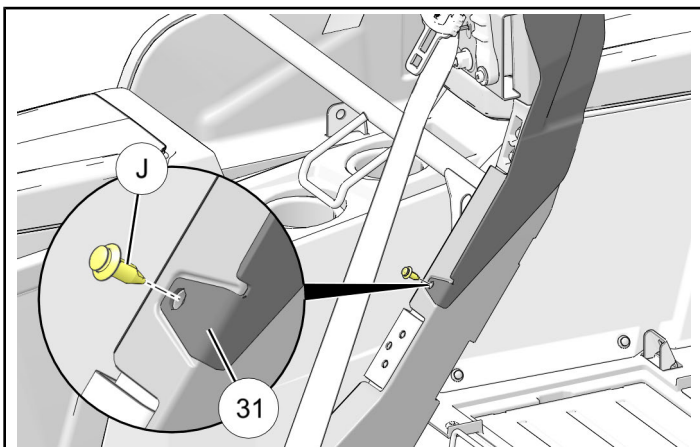

15. Install striker bracket ③② to chassis using two retained screws ④ (see previous section **REMOVE EXISTING REAR DOORS**, Step 6). Center bracket, then tighten screws.

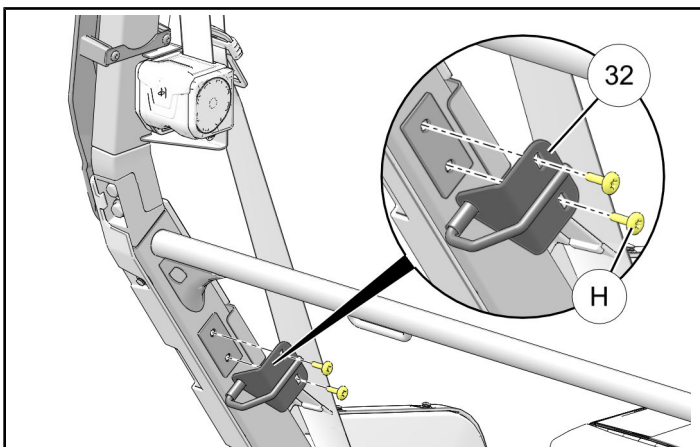

16. Open door latch (to ensure pawl is properly positioned), then slowly close door and observe engagement of striker pin ④ into latch mechanism. Adjust as follows:

- a. **HEIGHT:** Pin ④ should be centered vertically in opening of latch frame ⑤. To adjust, loosen two screws ⑥, slide striker bracket ③② up or down as required, then torque screws to specification.

#### TORQUE

6 ft. lbs. (8 Nm)  $\pm$  10%

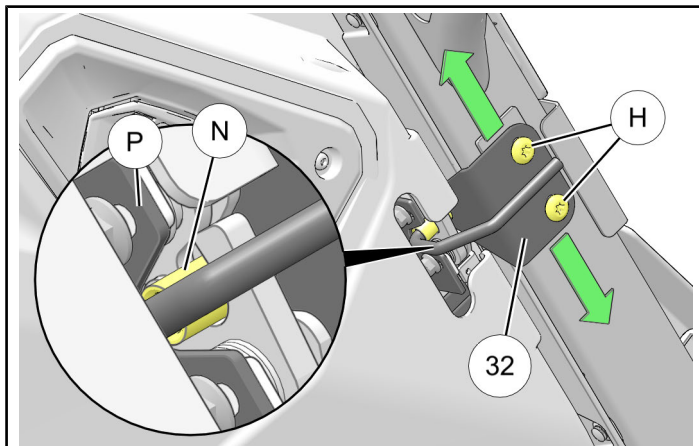

- b. **DEPTH:** As required to achieve desired seal compression and door fairing. To adjust, loosen two screws ⑦, slide latch mechanism ⑧ inboard or outboard as required, then retighten screws.

#### IMPORTANT

Ensure depth adjustment is made with door **FULLY** latched (second "click"), not partially latched (first "click").

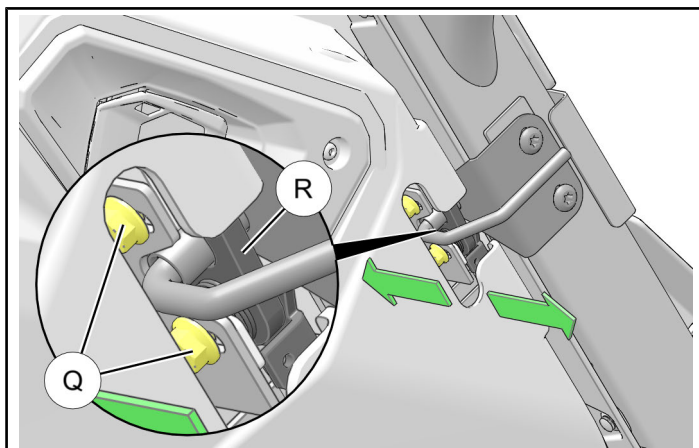

17. Install strut ⑤ to ball fitting ⑮ by firmly pushing strut into fitting. Retention clip will snap into place when strut is fully seated.

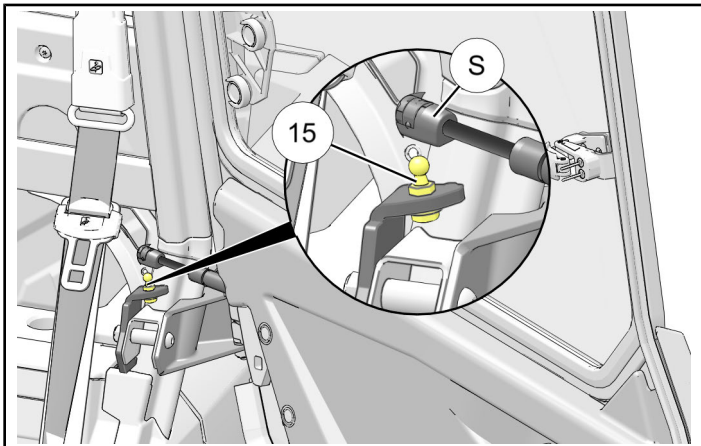

18. Repeat Steps 1–17 for RH door assembly ② using the following RH parts:

- Lower RH chassis-side hinge ③
- RH foam seal ④
- RH strut mounting bracket ⑤
- Upper RH chassis-side hinge ⑳
- Upper RH door-side hinge ㉑
- Upper RH B-pillar trim ㉓
- Lower RH B-pillar trim ㉔

19. Reinstall rear seats.

## FEEDBACK FORM

A feedback form has been created for the installer to provide any comments, questions or concerns about the installation instructions. The form is viewable on mobile devices by scanning the QR code or by clicking [HERE](#) if viewing on a PC.

### FEEDBACK FORM

