

PLOW CONTROLLER KIT

POLARISENGINEERED PARTS
ACCESSORIES & APPAREL**P/N 2883247**

APPLICATION

Verify accessory fitment at Polaris.com.

BEFORE YOU BEGIN

Read these instructions and check to be sure all parts and tools are accounted for. Please retain these installation instructions for future reference and parts ordering information.

KIT CONTENTS

This kit contains parts for installation of the plow controller only. Prior installation of a plow system (frame, lift method, and blade) is also required (each sold separately).

This Kit includes:

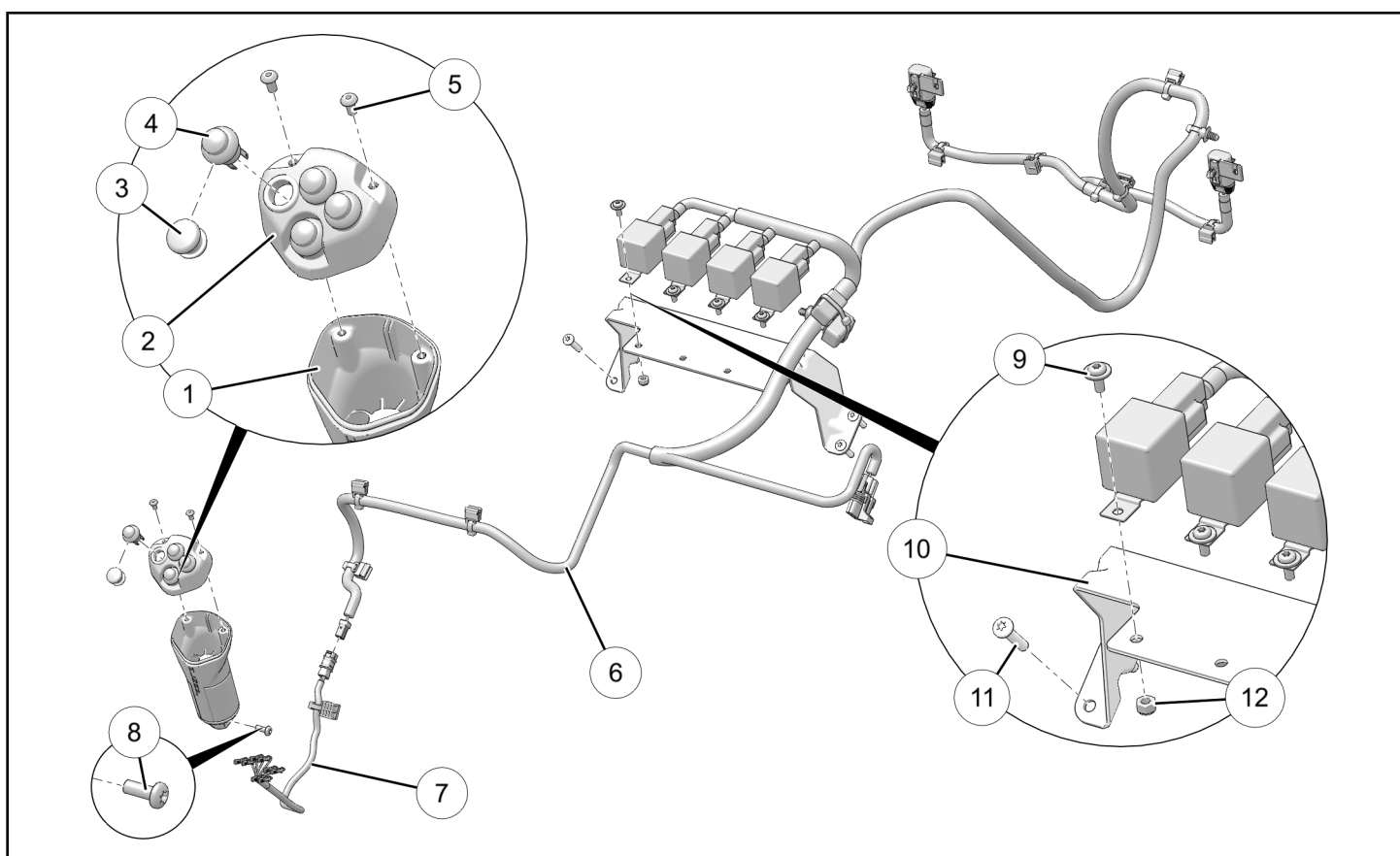

REF	QTY	PART DESCRIPTION	PART NUMBER
1	1	Grip, Plow Control	-
2	1	Cap, Plow Control	-
3	4	Plug, Filler	5455599
4	4	Switch	4017301
5	2	Screw, Torx® Pan Head, High/Low - #10 X 3/4	7512026
6	1	Harness, Front	2414106
7	1	Harness, Rear	2414278

REF	QTY	PART DESCRIPTION	PART NUMBER
8	1	Screw, Torx® Pan Head - #10–24 X 1/2	7512024
9	4	Screw, Torx® Pan Head, with integral washer - #10–24 X 1/2	7512084
10	1	Bracket, Relay and Circuit Breaker	-
11	4	Screw, Torx® Truss Head, High/Low - #14 X 3/4	7519045
12	4	Nut, Locking - #10–24	7541925
	1	Instructions	9928570

TOOLS REQUIRED

- Safety Glasses
- Pliers, Push Pin Rivet
- Screwdriver Set, Torx®
- Socket Set, Metric
- Wrench Set, Metric

IMPORTANT

Your Plow Controller Kit is exclusively designed for your vehicle. Please read the installation instructions thoroughly before beginning. Installation is easier if the vehicle is clean and free of debris. For your safety, and to ensure a satisfactory installation, perform all installation steps correctly in the sequence shown.

ASSEMBLY TIME

Approximately 50–60 minutes

NOTE

Additional time may be required to accommodate other accessories.

HARNESS DETAIL

FRONT HARNESS ⑥:

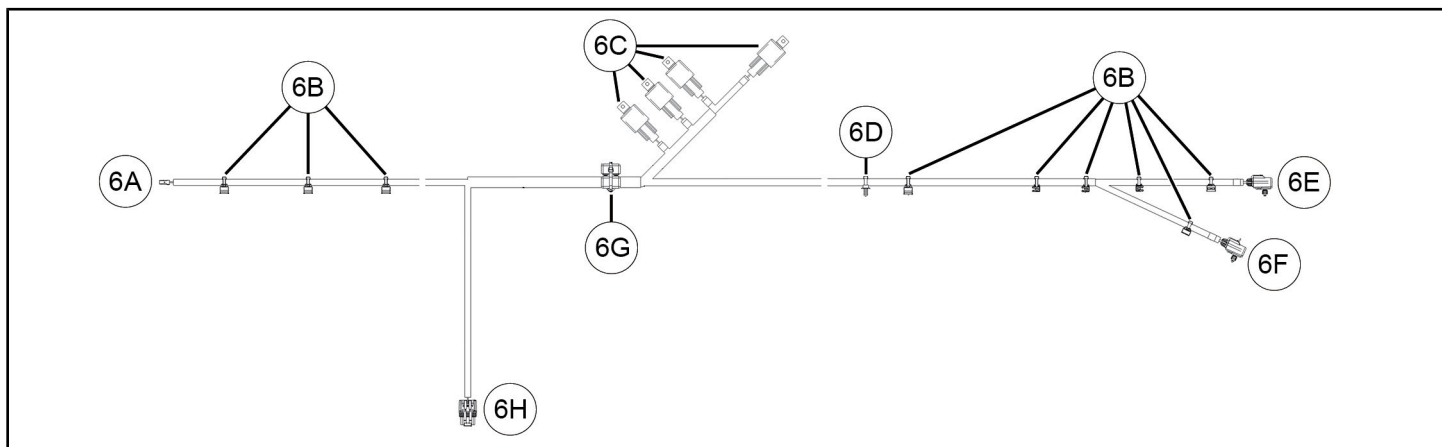

REF	PART DESCRIPTION	WIRE COLOR	PIN QTY/ GENDER	CONNECTS TO
6A	Connector, Plow Control	-	5 female	Rear harness ⑦, connector 7A
6B	Clip, Edge	-	-	Vehicle structure
6C	Relays	-	-	Bracket ⑩
6D	Clip, Routing	-	-	Vehicle structure

REF	PART DESCRIPTION	WIRE COLOR	PIN QTY/ GENDER	CONNECTS TO
6E	Connector, Plow Cylinder, with attached routing clip (identified as: TILT)	-	2 female	OPTIONAL: Angle System Kit (PN 2883409)
6F	Connector, Plow Cylinder, with attached routing clip (identified as: LIFT)	-	2 female	OPTIONAL: Lift System Kit (PN 2883410)
6G	Circuit Breakers, with attached routing clip	-	-	Bracket ⑩
6H	Connector, Terminal Block	-	3 female	Vehicle terminal block

REAR HARNESS ⑦:

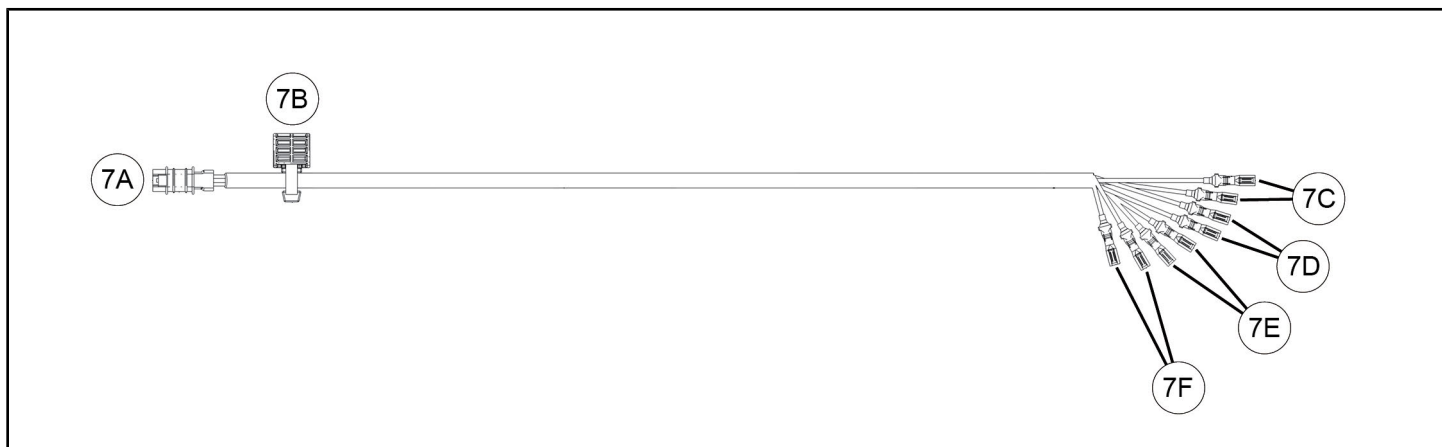

REF	PART DESCRIPTION	WIRE COLOR	PIN QTY/ GENDER	CONNECTS TO
7A	Connector, Plow Control	-	5 male	Front harness ⑥, connector 6A
7B	Clip, Edge	-	-	Vehicle structure
7C	Terminal, Spade; wire pair identified as PLOW (RIGHT)	-	1 female	Switch ④
7D	Terminal, Spade; wire pair identified as PLOW (UP)	-	1 female	Switch ④
7E	Terminal, Spade; wire pair identified as PLOW (LEFT)	-	1 female	Switch ④
7F	Terminal, Spade; wire pair identified as PLOW (DOWN)	-	1 female	Switch ④

INSTALLATION INSTRUCTIONS

1. Shift vehicle transmission into "PARK". Turn ignition switch to "OFF" position and remove key.
2. Flip up passenger seat bottom, remove driver's seat and underseat storage compartment, then disconnect black negative (-) cable from battery.
3. Gain access.
 - a. Remove hood.
 - b. Remove upper dash cupholder by removing two push pin rivets **A**, then slide cupholder rearward. Retain rivets.

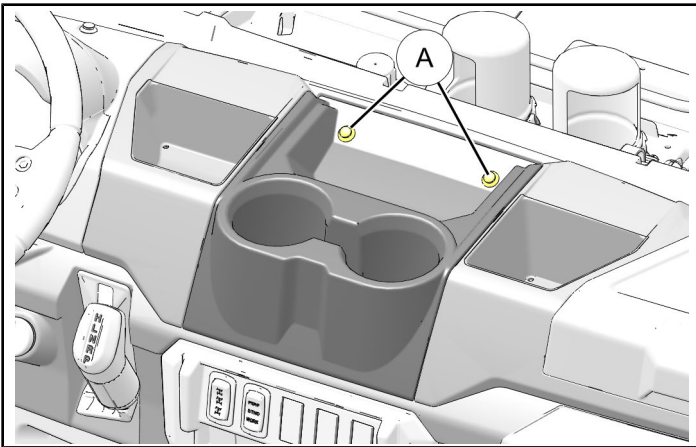

- c. Tilt steering wheel to full down position. Detach instrument cluster hood by removing two push pin rivets **B**, then slide hood (with instrument cluster) rearward. Disconnect instrument cluster wiring harness. Retain rivets.

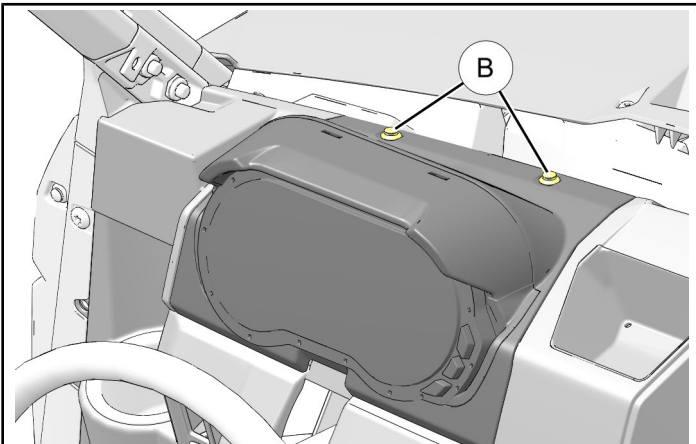

4. Install front harness.
 - a. Install bracket **10** to under-hood liner using four screws **11**. Do not over-tighten screws.

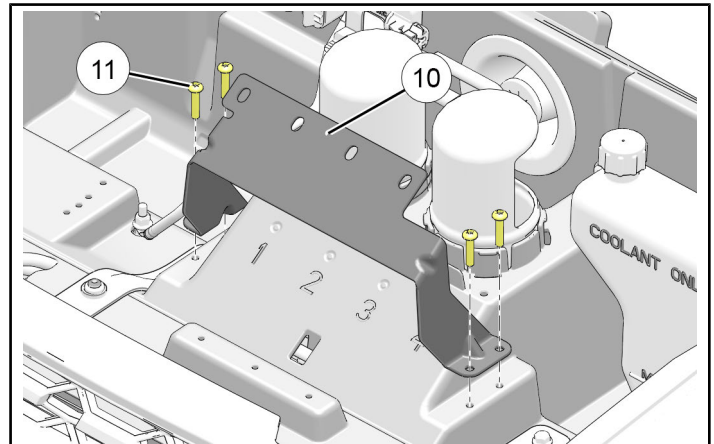

- b. Route plow control connector 6A on front harness **6** from under-hood compartment rearward through firewall grommet **C** into upper dash compartment.

NOTE

View looking down.
Harness components 6C through 6H remain on forward side of firewall grommet.
See previous section, **HARNESS DETAIL**, for connector identification.

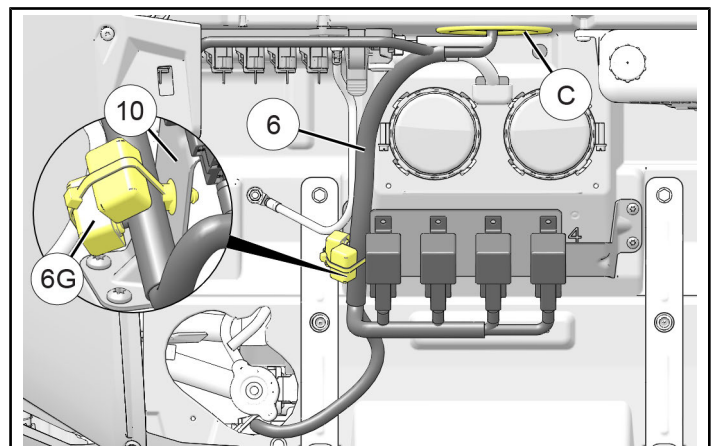

- c. Install circuit breakers 6G to bracket **10** using attached routing clip.

- d. Install each of four relays 6C to bracket 10 using screw 9 and nut 12. Ensure screw 9, with integral washer, is used; do not use screw 8.

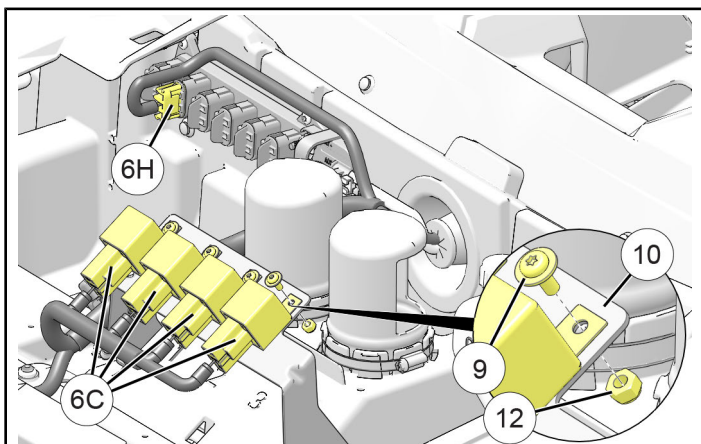

- e. Open power cap on vehicle terminal block at any open location, then plug in connector 6H.
- f. Route plow cylinder connectors 6E and 6F forward across under-hood liner, down through radiator cap opening, then forward to bumper. Ensure routing will prevent harness contact with hot components, sharp edges, or moving parts.

NOTE

Front fascia hidden for clarity.

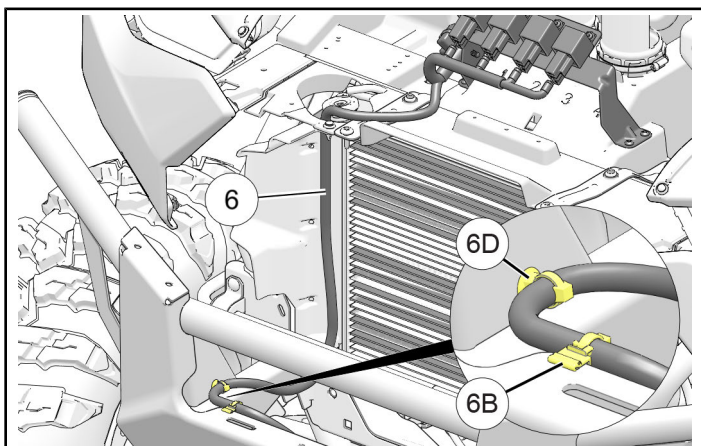

- g. Secure harness to bumper support structure using routing clip 6D, and to stamping flange using edge clip 6B.

- h. Secure harness to fairlead support bracket (on rear side of bumper) using edge clip 6B, then route harness forward through cutout in bumper stamping.

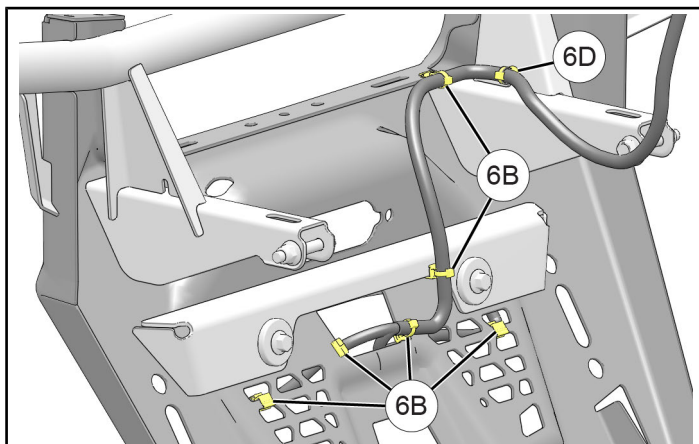

- i. Secure **TILT** and **LIFT** connectors as follows:

If plow system is installed (sold separately):

Remove caps from **TILT** connector 6E and **LIFT** connector 6F. Join connectors to corresponding connectors on plow cylinders. Install caps into bumper stamping using attached routing clips.

If plow system is NOT installed: Secure **TILT** connector cap 6E to LH side of bumper stamping using attached routing clip, and secure **LIFT** connector cap 6F to RH side of bumper stamping using attached routing clip.

IMPORTANT

Always reinsert connectors into caps when plow is not installed.

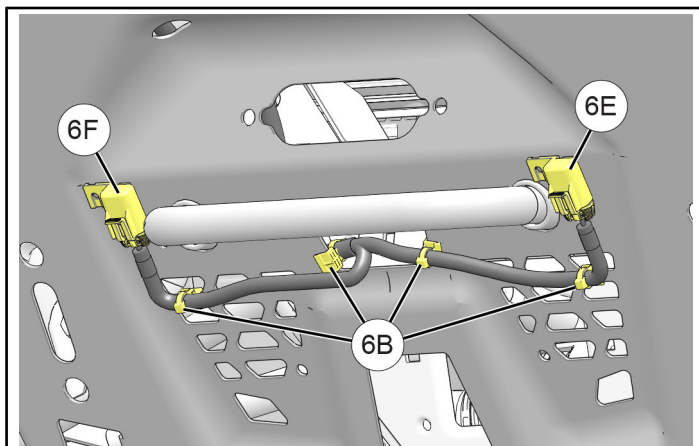

- j. Secure harness to main bumper stamping using remaining four edge clips 6B.

- k. Reaching through cupholder and instrument cluster openings, loosely route plow control connector 6A along front dash support bracket towards LH side of vehicle, then rearwards towards shift lever.

Ensure routing will prevent harness contact with hot components, sharp edges, or moving parts. Do not secure with edge clips 6B at this time.

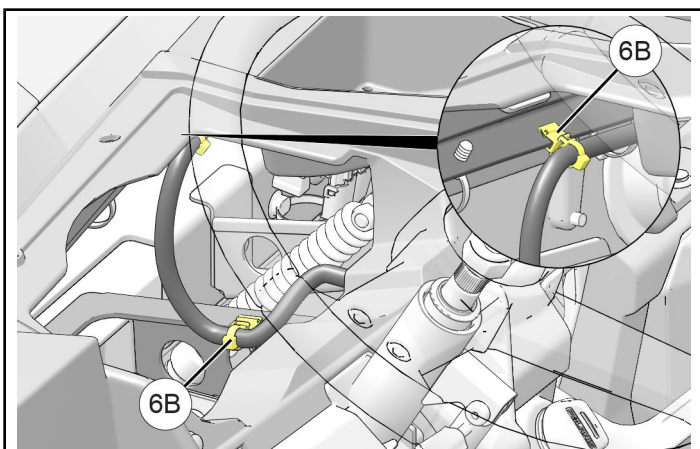
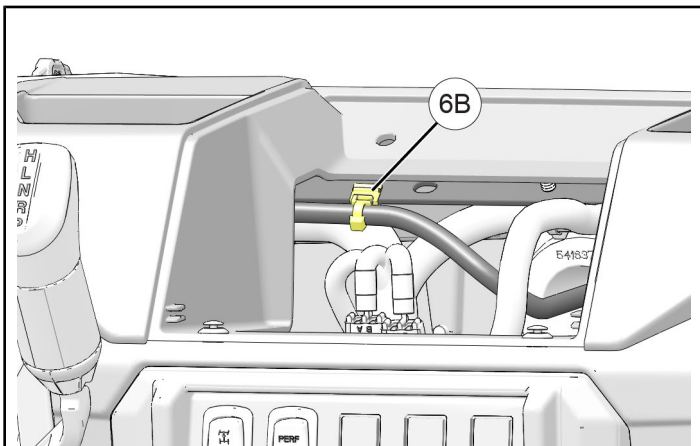

5. Install rear harness.

- a. Remove screw ⑩ from lower end of shift control grip ⑤. Retain screw.

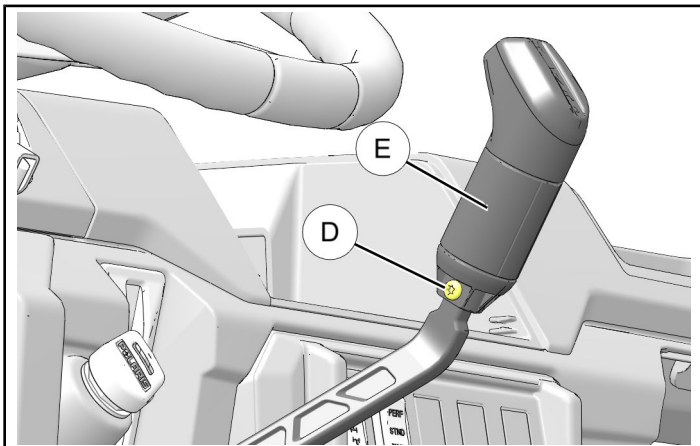

- b. Pull shift control grip ⑤ straight off shift lever. Grip will not be reused.

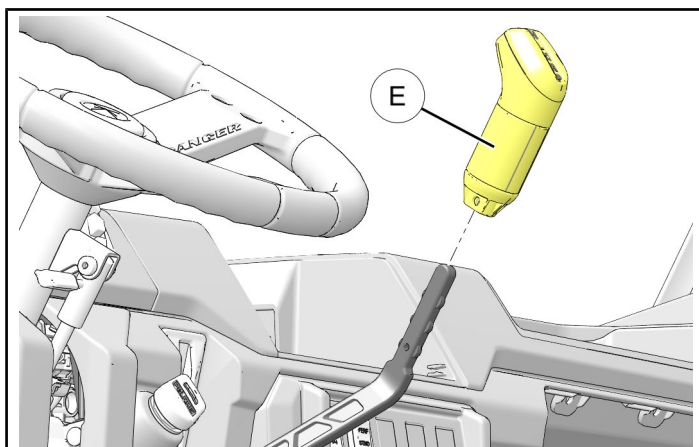

- c. Install plow control grip ① to shift lever, then secure with screw ⑧.

NOTE

Screw is installed from RH side of grip, opposite to removed grip.

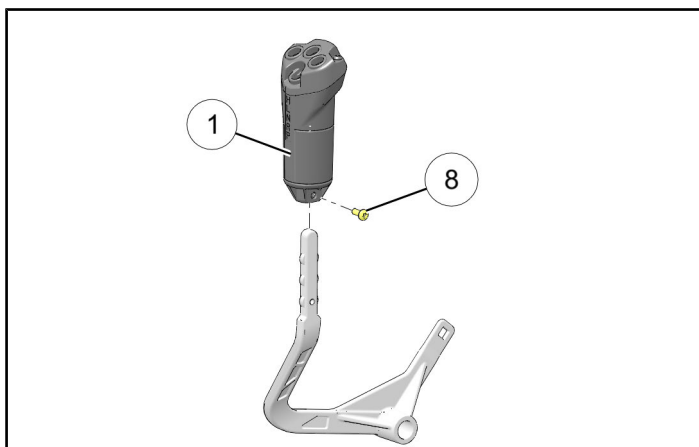

- d. Remove plow control cap ② from grip ① by removing two screws ⑤. Retain screws.

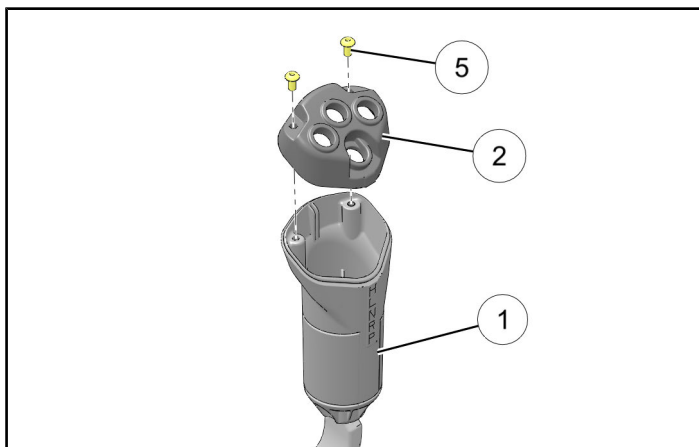

- e. Install switches ④ and filler plugs ③ into cap ②:

NOTE

All switches are identical.

- If using winch to provide UP-DOWN plow control, then install switches into LEFT and RIGHT holes, and plugs into TOP and BOTTOM holes.

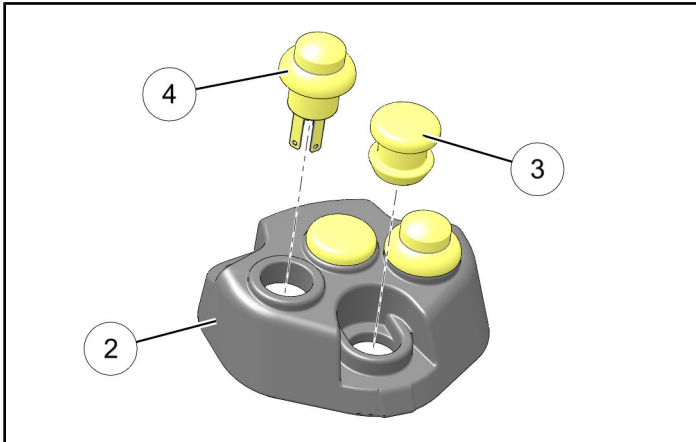

- If NOT using winch to provide UP-DOWN plow control, then install switches into all four holes.

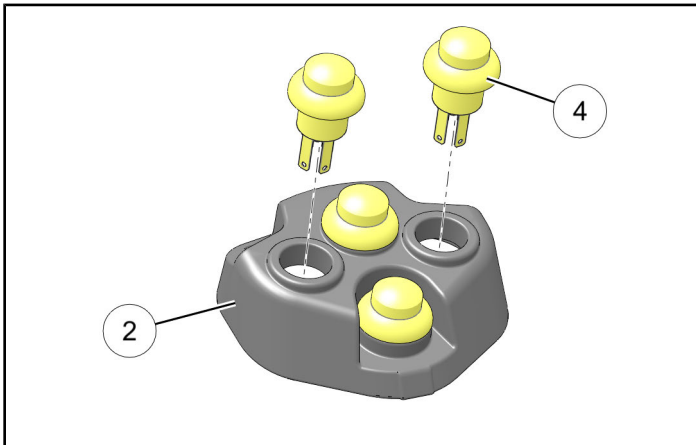

- f. Insert four pairs of spade terminals 7C through 7F on rear harness ⑦ upwards through tunnel on LH side of plow control grip ①.

NOTE

Labels can either be coiled around wires before inserting into grip, or carefully removed. If labels are removed, be sure to record plow function for each wire color.

One orange/white stripe wire is routed to each switch.

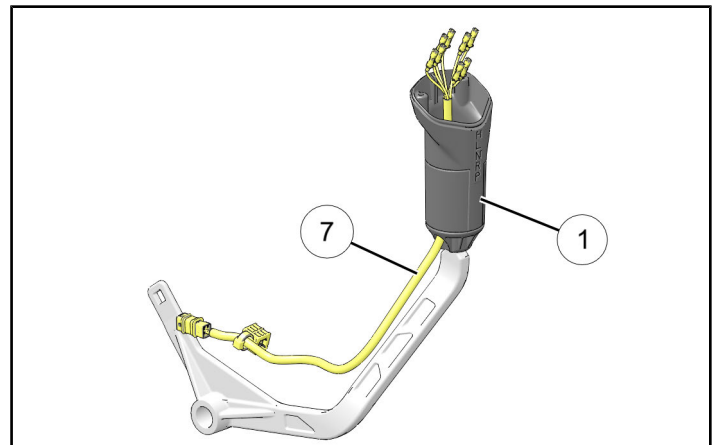

- g. Join spade terminal pairs 7C and 7E (plus 7D and 7F, if applicable) to switches ④.

If UP-DOWN plow control is not used, then tuck spade terminal pairs 7D and 7F down into grip body.

NOTE

There is no switch polarity; it does not matter how each wire pair is connected to each switch.

- h. Carefully pull rear harness ⑦ downwards, then reinstall cap ② to grip ① using two retained screws ⑤. Ensure harness wiring is not pinched when cap is installed.

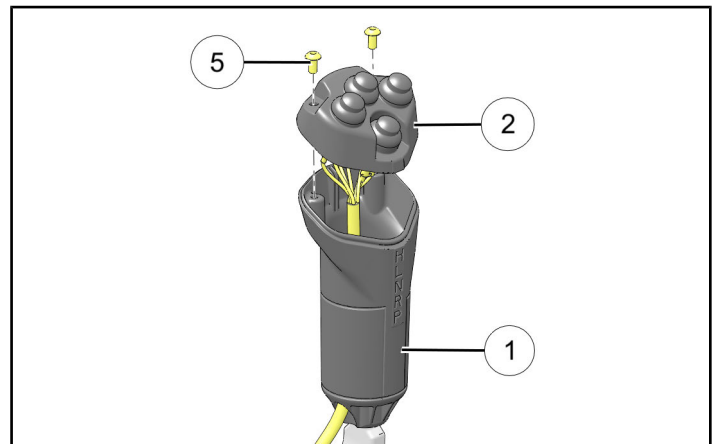

- i. Join connector 7A on rear harness ⑦ to connector 6A on front harness ⑥, then secure rear harness to shift lever using edge clip 7B.

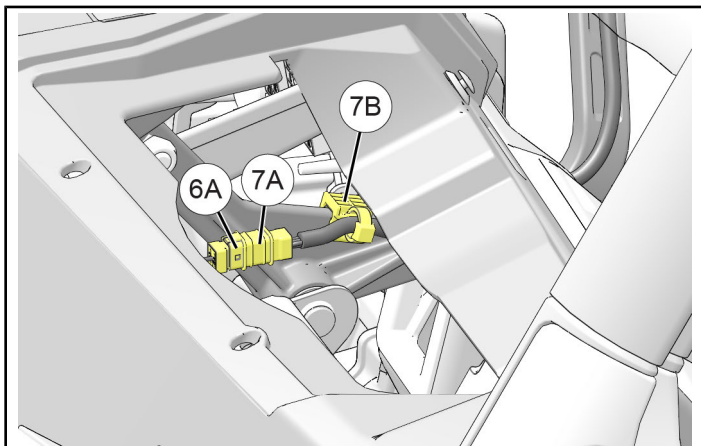

- j. Secure front harness ⑥ to support brackets using three edge clips 6B. See Step 4k for detail.
- 6. Restore access.
 - 7. Reconnect black negative (-) cable to battery, then reinstall under-seat storage compartment and driver's seat.

FEEDBACK FORM

A feedback form has been created for the installer to provide any comments, questions or concerns about the installation instructions. The form is viewable on mobile devices by scanning the QR code or by clicking [HERE](#) if viewing on a PC.

FEEDBACK FORM

