

# 3500 WINCH KIT



**P/N 2881098**

## APPLICATION

All RXR Models

### NOTE

Your vehicle comes pre-wired for winch installation.  
No additional parts are required besides what is included in this kit.

## BEFORE YOU BEGIN

Read these instructions and check to be sure all parts and tools are accounted for. Please retain these installation instructions for future reference and parts ordering information.

## KIT CONTENTS

This kit includes:

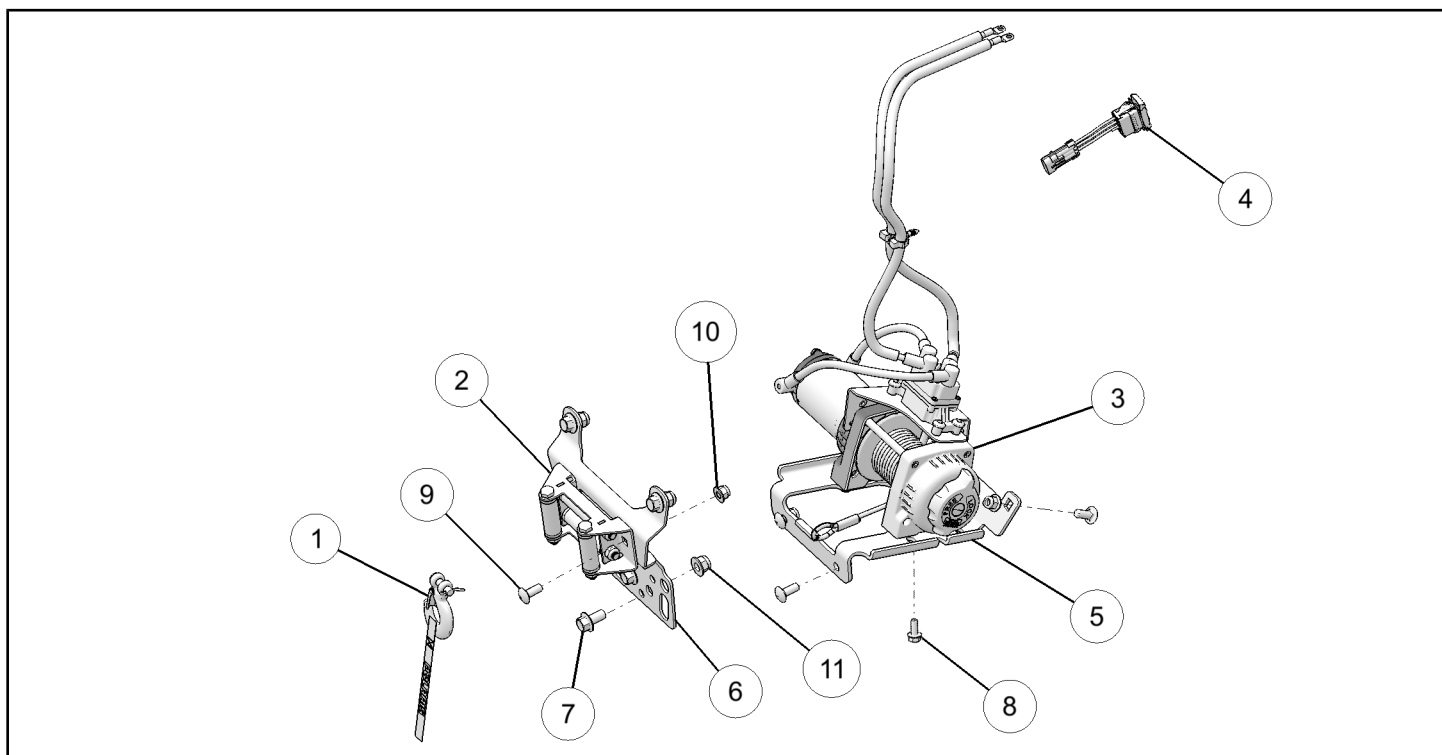

REF	QTY	PART DESCRIPTION	PART NUMBER
1	1	Hook-Latch, Winch	2411836
2	1	Roller-Fairlead, Winch	2411848
3	1	Assembly Winch, with Contactor, 3500	2635953
4	1	Switch - Winch, Sealed	4015043
5	1	Mount Bracket-Winch	-
6	1	Fairlead Mount Bracket	5257963
7*	4	Screw-HXFL-M12 X 1.75 X 25	7519072

REF	QTY	PART DESCRIPTION	PART NUMBER
8*	4	Screw-HXFL-M8 X 1.25 X 20	7519133
9*	6	Screw-RHCAR-M10 X 1.5 X 25	7519372
10*	6	Nut-M10 X 1.5	7547423
11*	4	Nut-HXFL-M12 X 1.75	7547441
	1	Winching Guide	9923644
	1	Instructions	9926966
		Service Handle (includes freespool handle and screw)	2205265

Items marked (\*) are included in Hardware Kit PN 2206300.

## TOOLS REQUIRED

- Standard and Metric Socket Set (2X)
- Drill and Drill Bit Set
- Phillips Screwdriver
- 1 1/16" Hole Saw or Drill
- Torx® Drivers

## IMPORTANT

Your 3500 WINCH KIT is exclusively designed for your vehicle. Please read the installation instructions thoroughly before beginning. Installation is easier if the vehicle is clean and free of debris. For your safety, and to ensure a satisfactory installation, perform all installation steps correctly in the sequence shown.

## ASSEMBLY TIME

Approximately 45 minutes

## INSTALLATION INSTRUCTIONS

1. Place vehicle in "PARK". Turn key to "OFF" position and remove from vehicle. Remove seats. Disconnect cables (black negative (B), red positive (A)) from battery.
2. Remove hood (C) from the vehicle by twisting two knobs (D) and pulling up.

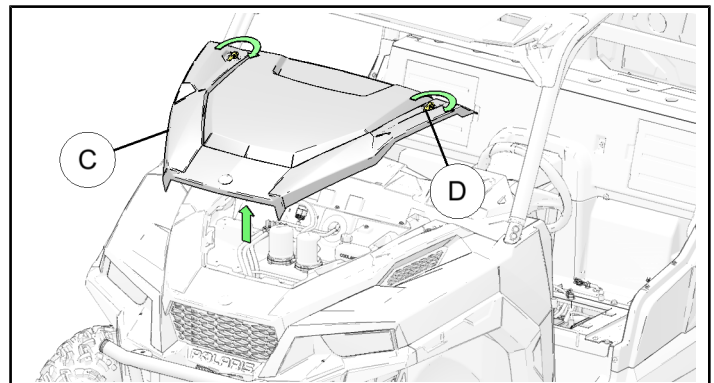
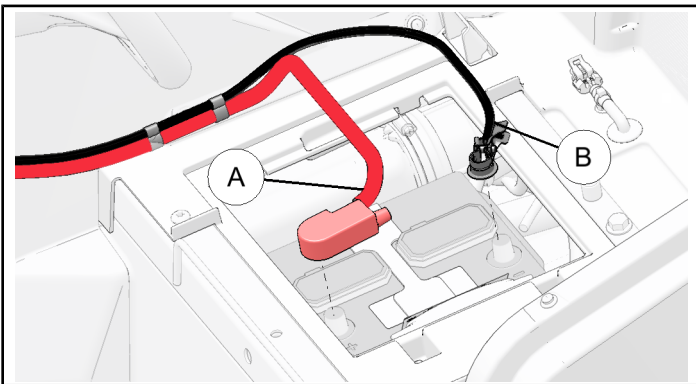

- Remove lower front fascia (E) by removing four push rivets (F).

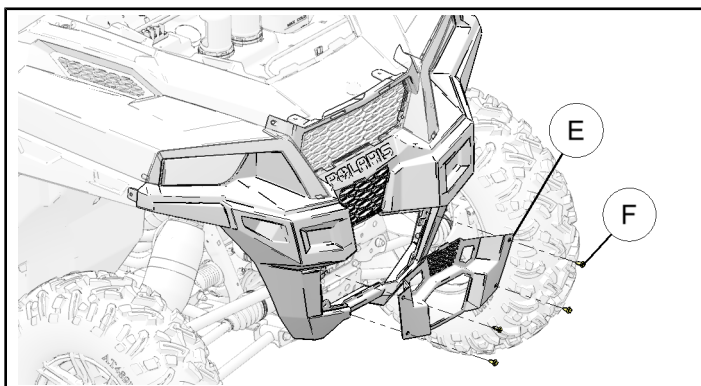

- Slide winch mounting bracket (5) into position from the passenger side as shown.

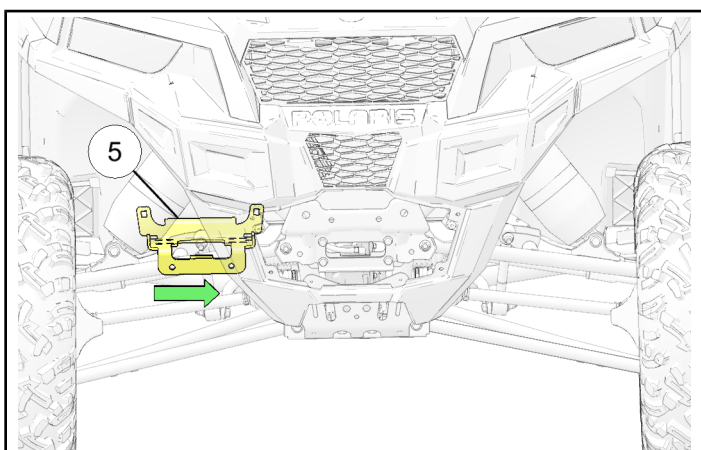

- Install winch mounting bracket (5) onto the front suspension bracket (H) and steering brackets (G) with four screws (9) and lock nuts (10). Torque to below specification.

#### TORQUE

20 ft. lbs. (21.7 Nm)

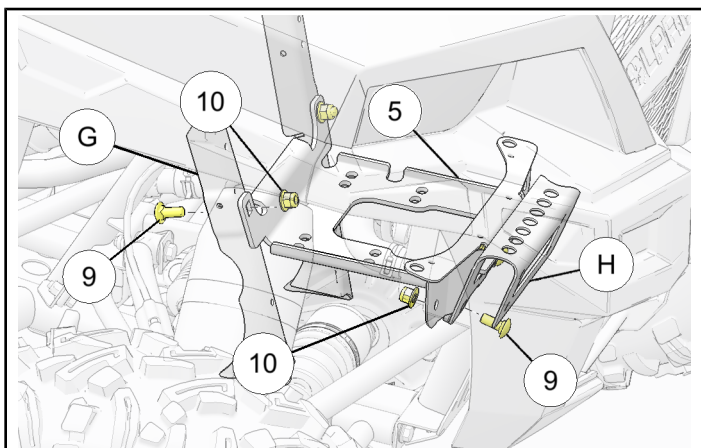

- Slide winch (3) from passenger side as shown onto winch mounting bracket.

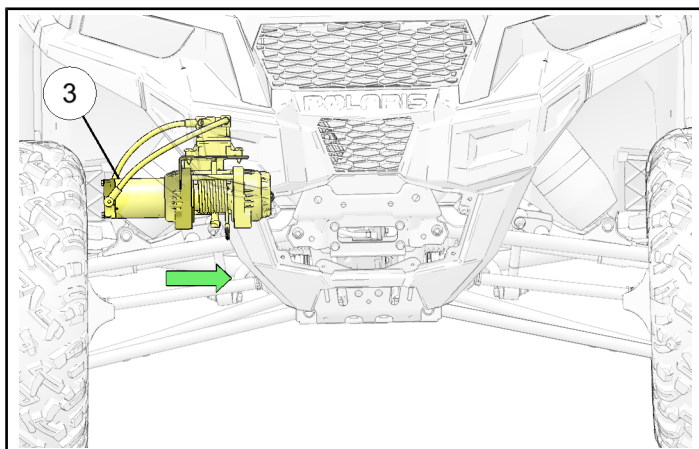

- Install winch (3) onto the winch mounting bracket (5) using four screws (8). Torque to below specification.

#### TORQUE

20 ft. lbs. (21.7 Nm)

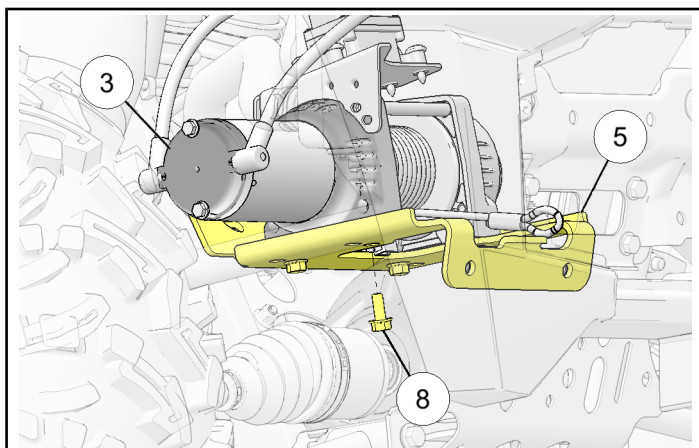

- Mount roller fairlead (2) onto front plate bracket (6) with two screws (9) and nuts (10).

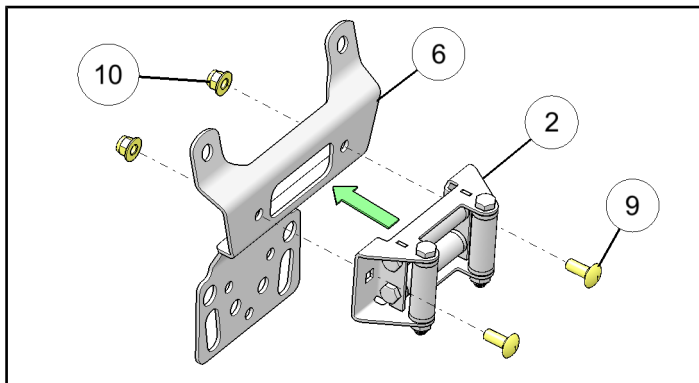

9. Install front plate bracket with roller fairlead as subassembly onto the vehicle with four bolts ⑦ and nuts ⑪.

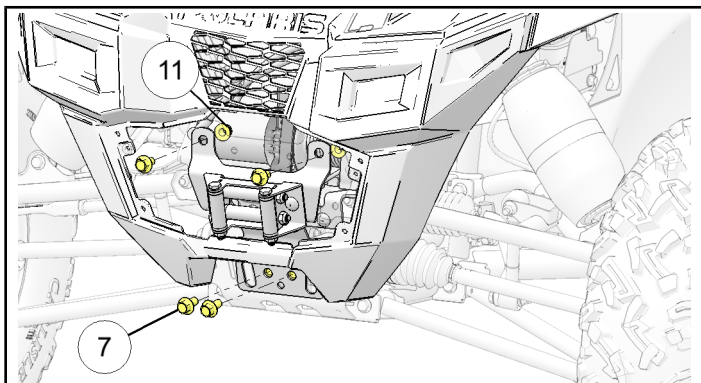

10. Twist knob (J) on the winch to release rope. Pull rope 6–12" out through front plate bracket and roller fairlead and twist knob again to re-lock spool.

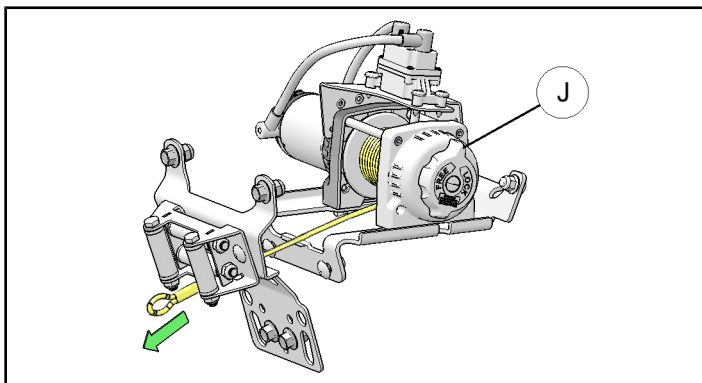

11. Attach hook ① to the rope by inserting clip through it.

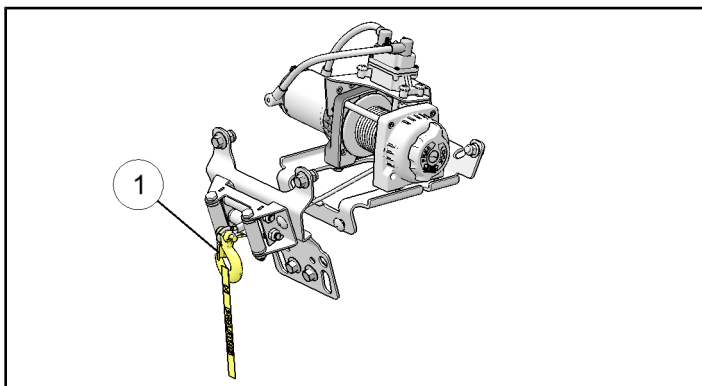

12. Hook up winch negative (black) and positive (red) terminals to the bus bar. Match the color of the wires you install to the color of the wires already installed.

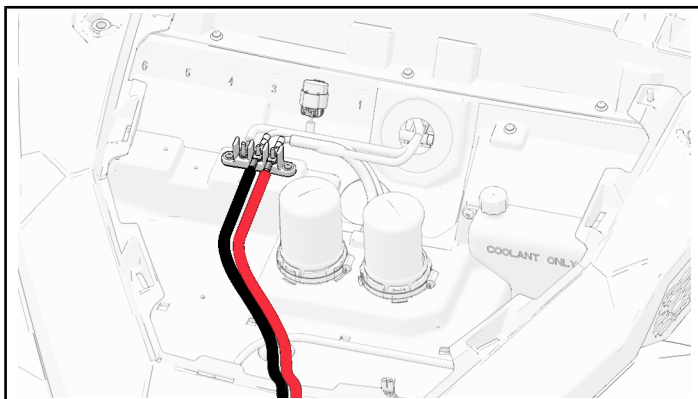

13. Remove control console panel (N) by inserting screwdriver at bottom and pulling control panel outside as shown. Remove one of the rectangular knockout holes. Locate switch connector from main wire harness.

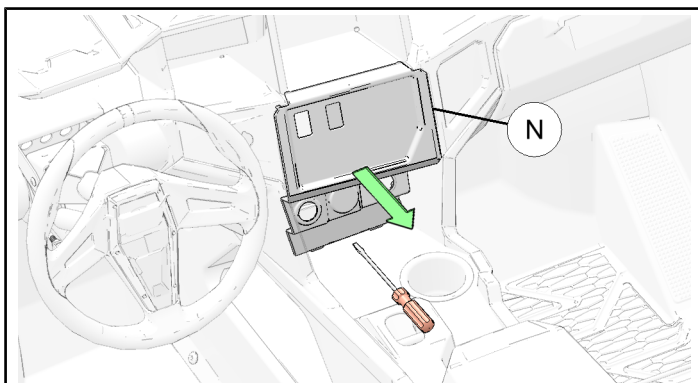

14. Install winch switch ④ onto the control console panel (N). Push switch into hole to seat. Connect switch to corresponding connector on main wire harness as shown.

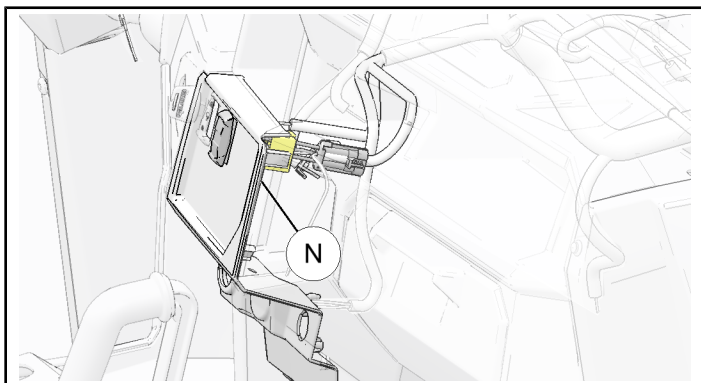
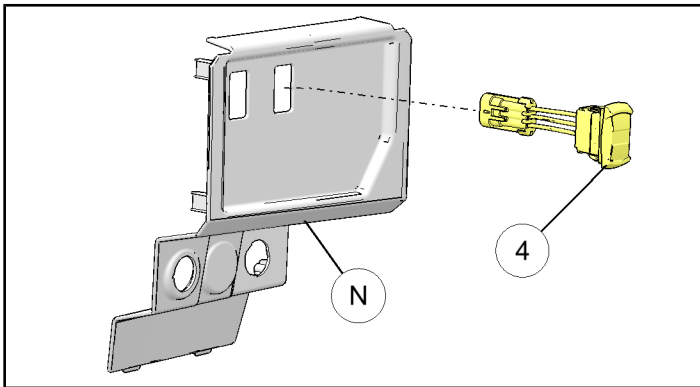

15. Reinstall control console panel (N) with winch switch ④ onto vehicle.

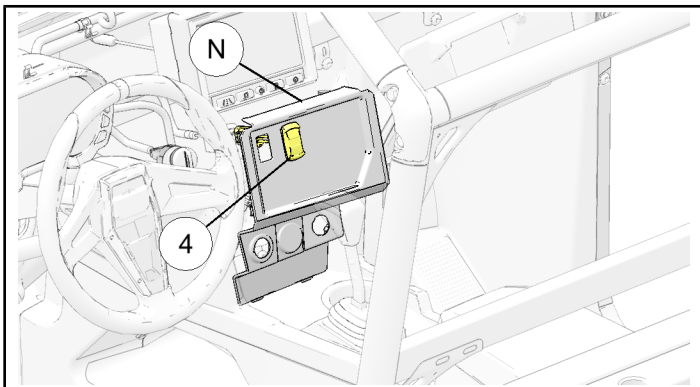

16. Connect main wire harness connection to winch contactor as shown.

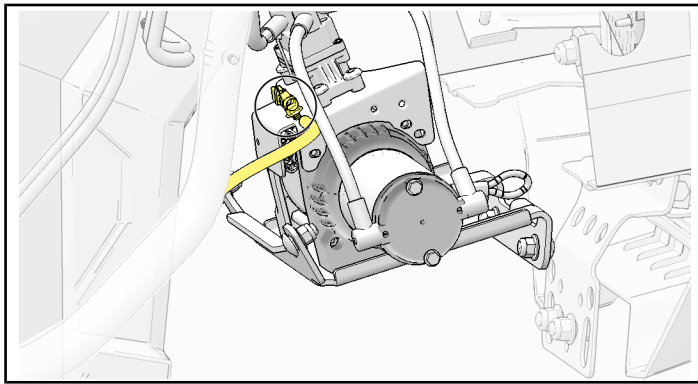

17. Connect the negative (black) and positive (red) cables to the battery which was disconnected in Step 1.
18. Check function of the winch using dash switch. Make sure winch only operates when key is 'ON'.
19. Reinstall lower front fascia, hood, and seats onto the vehicle.