

POLY TIP-DOWN WINDSHIELD KIT



P/N 2882174

APPLICATION

Verify accessory fitment at Polaris.com.

BEFORE YOU BEGIN

Read these instructions and check to be sure all parts and tools are accounted for. Please retain these installation instructions for future reference and parts ordering information.

KIT CONTENTS

This Kit includes:

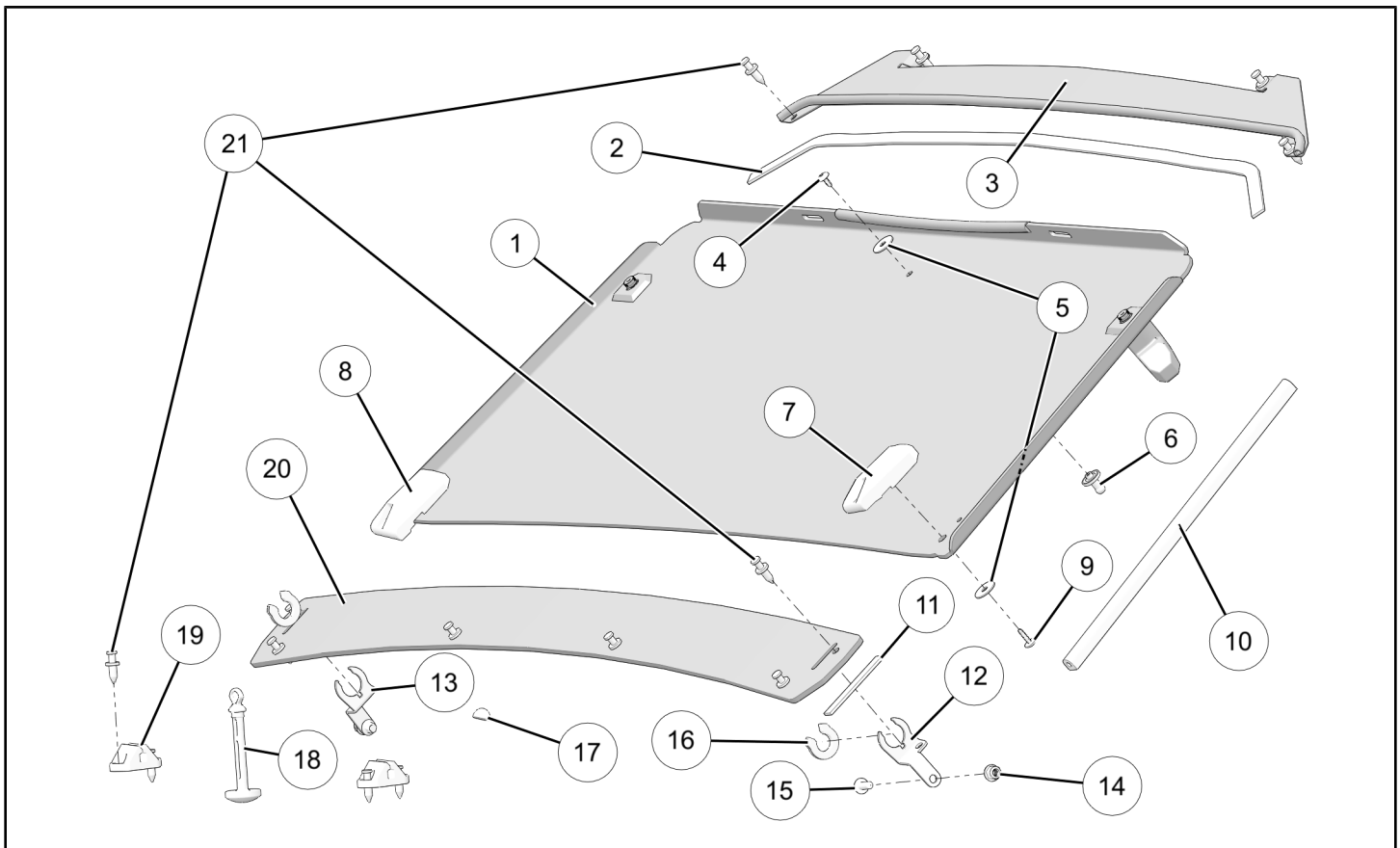

REF	QTY	PART DESCRIPTION	PART NUMBER
1	1	Windshield Assembly	-
2*	-	Tape, Foam (4.1 ft)	-
3	1	Panel, Upper Trim	-
4*	1	Screw, Torx® - 10-12 X 1/2	-
5*	3	Washer, Fender - 1/4	-
6*	1	Ball Stud	-
7*	1	Hinge, LH	-
8*	1	Hinge, RH	-

REF	QTY	PART DESCRIPTION	PART NUMBER
9*	2	Screw, Torx® - 10-12 X 3/4	-
10*	-	D-seal (2.75 ft; cut as required)	-
11*	-	Tape, Foam (0.6 ft; cut as required)	-
12	1	Bracket, LH	-
13	1	Bracket, RH	-
14*	2	Nut, Hex Flange - M8 X 1.25	-
15*	2	Screw, Hex Flange - M8 X 1.25 X 20	-
16*	2	Insert, Bracket	-
17*	1	Bumper, Rubber	-
18*	1	Strap, Latch	-
19*	2	Slot Clamp, Rubber	-
20	1	Panel, Lower Trim	-
21*	14	Rivet, Push Pin	-
	1	Instructions	9927337

Items marked (*) are included in Hardware Kit PN 2206446.

TOOLS REQUIRED

- Safety Glasses
- Drill
- Drill Bit: 1/8 inch, 5/16 inch, 1/2 inch
- Pliers, Push Pin
- Socket Set, Metric
- Wrench Set, Metric
- Utility Knife/Cutting Tool

IMPORTANT

Your Poly Tip-Down Windshield Kit is exclusively designed for your vehicle. Please read the installation instructions thoroughly before beginning. Installation is easier if the vehicle is clean and free of debris. For your safety, and to ensure a satisfactory installation, perform all installation steps correctly in the sequence shown.

ASSEMBLY TIME

Approximately 60 minutes

INSTALLATION INSTRUCTIONS

1. Shift vehicle transmission into "PARK". Turn key to "OFF" position and remove from vehicle.
2. Vehicle preparation.
 - a. Remove roof (if installed).
 - b. Ensure vehicle ROPS is at room temperature ($\geq 68^{\circ}$ F) for proper application of D-seals ⑩ and foam tape ⑪.

3. Install upper trim panel.

- a. Drill two 5/16 inch holes (A) through visor at INBOARD indentation marks as shown.

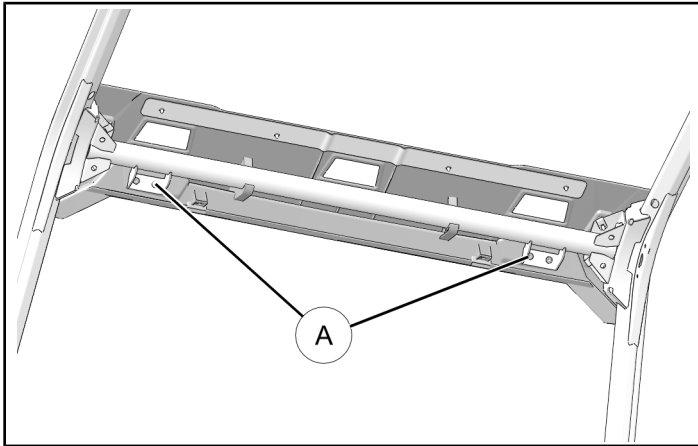

- b. Install upper trim panel (3) to visor using two push pin rivets (21) through previously drilled holes as shown.

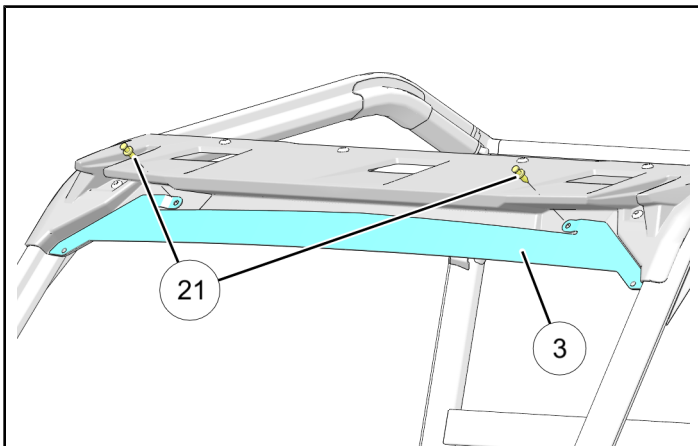

- c. Using upper trim panel (3) as template, mark and drill two 5/16 inch holes through visor, then secure using two push pin rivets (21) as shown.

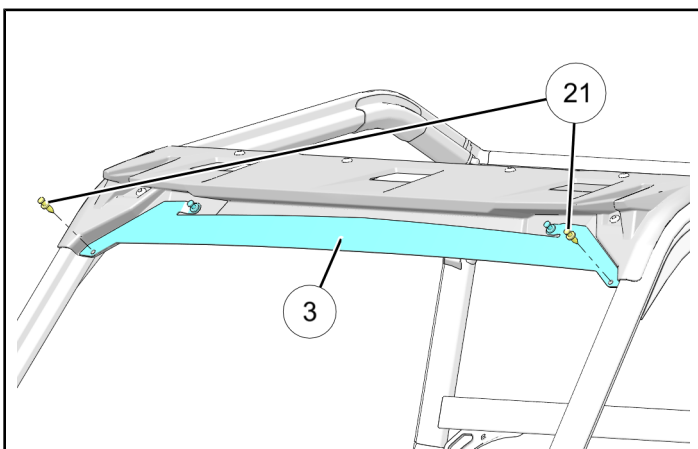

4. Install lower trim panel.

- a. Carefully trim upper dash panel (B) as required to accommodate LH bracket (12), then install bracket to lower ROPS A-pillar attach ear using screw (15) and nut (14) as shown. Ensure bracket is square to A-pillar. Repeat for opposite side using RH bracket (13).

IMPORTANT

Do not damage ROPS during trim operation. ROPS damage will adversely affect ROPS integrity and may lead to severe injury or death in an accident.

NOTE

LH side shown; RH side opposite.

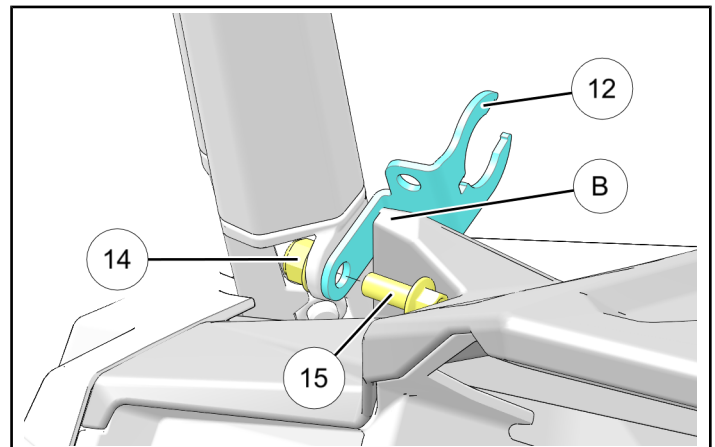

- b. Clean LH and RH ROPS A-pillars from upper trim panel (3) to upper dash panel (B) in preparation for foam tape (11) and D-seal (10). Wipe dry.
- c. Temporarily slide lower trim panel (20) over brackets (12) and (13) and position against ROPS, aligning push pin attach holes. Note location of panel edge (C) on LH and RH A-pillars, then remove trim panel.

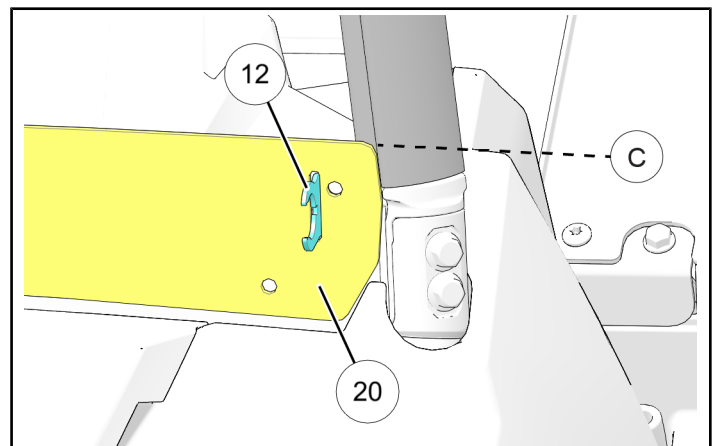

- d. If not already accomplished by factory, cut adhesive foam tape ⑪ in half (each piece approximately 3-1/2 inches in length), peel off backing, and apply to A-pillar between upper dash panel and location ③ as shown. Trim tape as required. Repeat for opposite side.

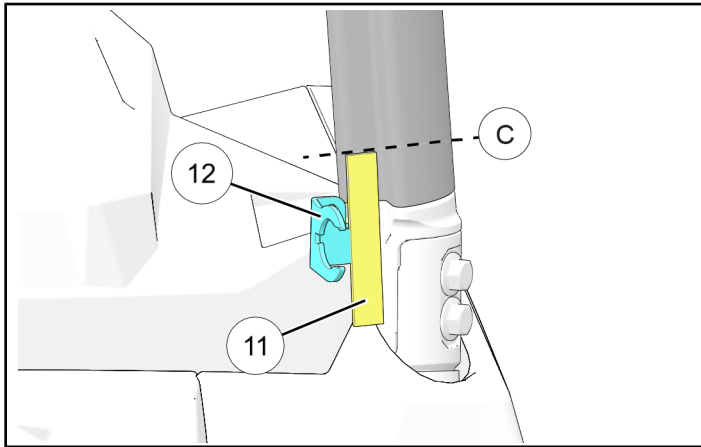

- e. Install lower trim panel ⑳ to brackets ⑫ and ⑬ using two push pin rivets ㉑ as shown.

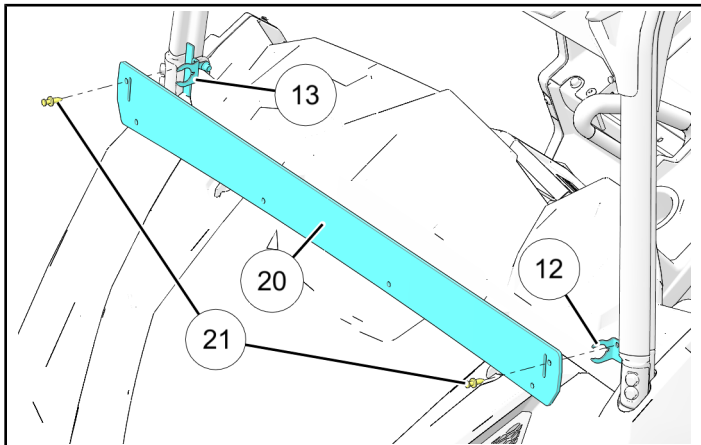

- f. Using lower trim panel ⑳ as template, mark and drill four 5/16 inch holes through upper dash panel. Starting from middle of lower trim panel, secure using four push pin rivets ㉑ as shown.

IMPORTANT

Control drill depth to prevent damage to underlying structure or components.

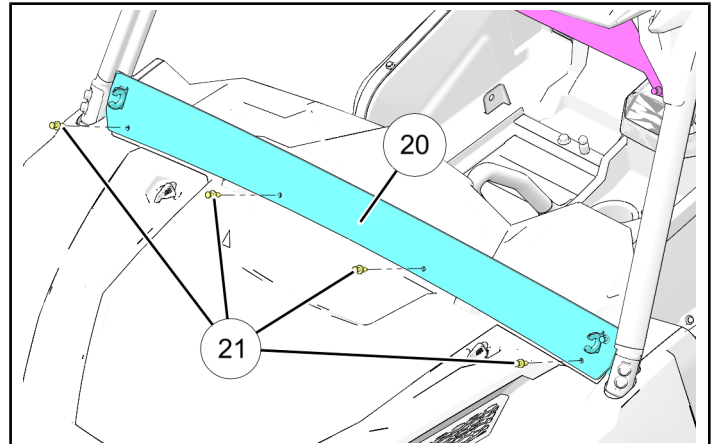

5. Install bracket insert ⑯ to brackets ⑫ and ⑬ as shown.

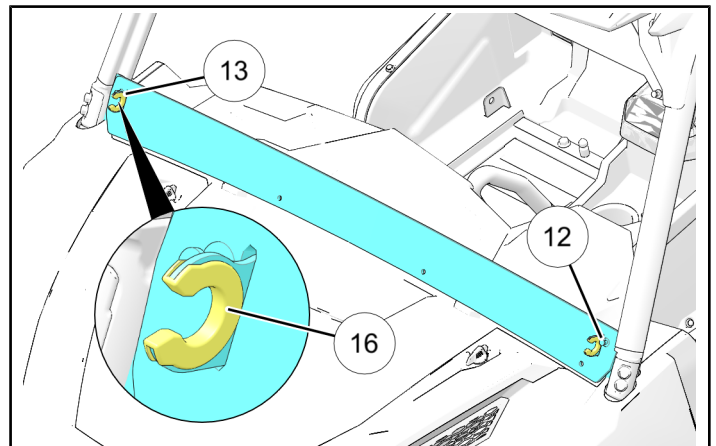

6. Install windshield assembly.

- a. Cut D-seal ⑩ in half, peel off backing, then apply to LH and RH A-pillars between upper trim panel ③ and lower trim panel ⑳ as shown. Trim as required.

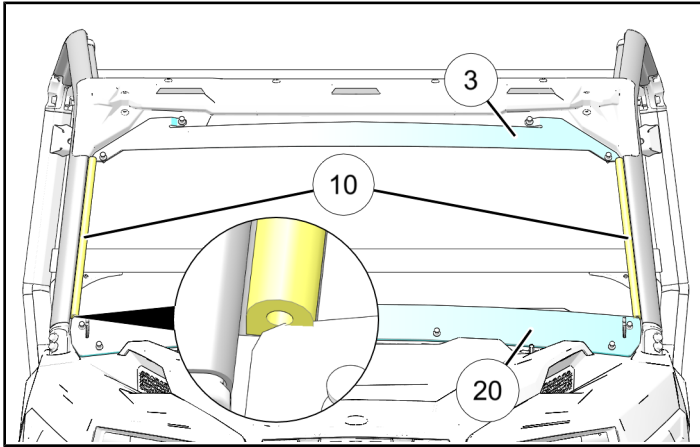

- b. Position windshield assembly ① as shown, then insert into hinge assemblies.

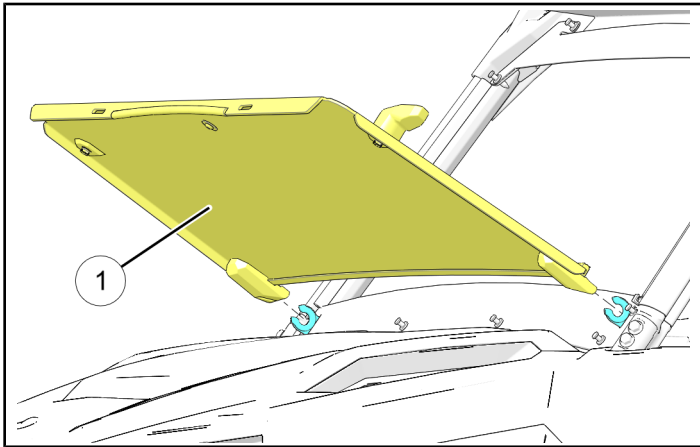

- c. Tip windshield assembly ① up as shown, then rotate both handles ① 1/4 turn to lock windshield to A-pillars. Adjust brackets ⑫ and ⑬ as required to ensure windshield assembly is centered in ROPS opening.

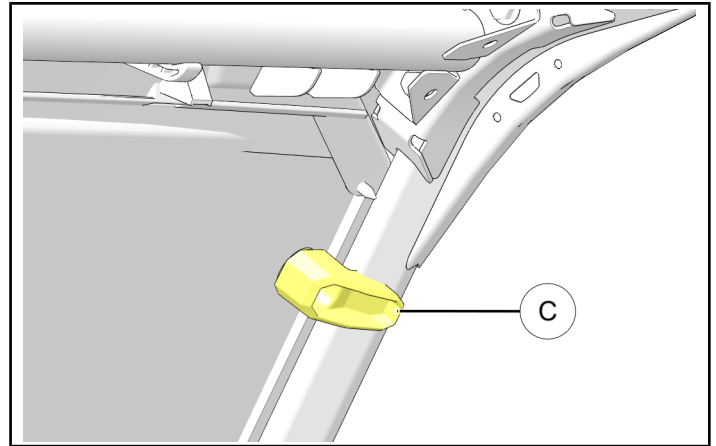
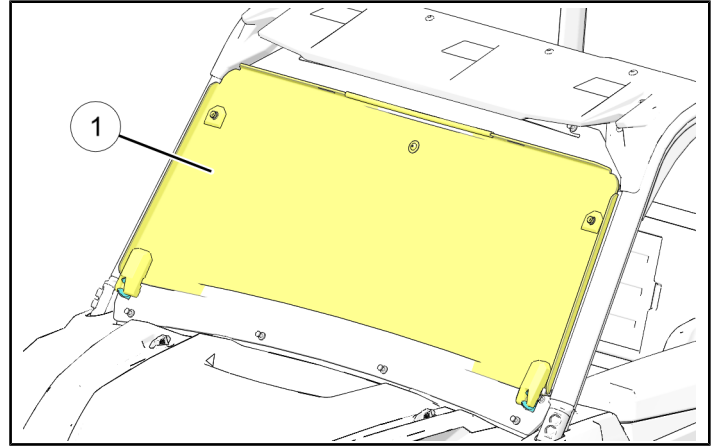

7. Install slot clamps to hood.
 - a. Install two slot clamps ⑱ to slots in windshield assembly ①, then tip windshield down, gently laying clamps flat against hood as shown.

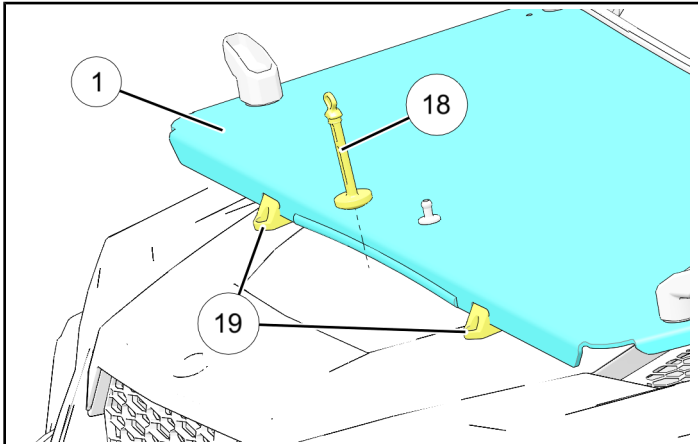

- b. Using slot clamps ⑱ as template, mark four fastener holes on hood as previously shown. Also, mark hole in center of hood, 1/2 inch forward of windshield, for latch strap ⑱ as shown.
 - c. Remove hood.
 - d. Carefully drill four 5/16 inch holes through hood at marked clamp fastener locations, and one 1/2 inch hole at marked latch strap location.

TIP

Drill 1/8 inch pilot holes first, verify hole locations, then upsize to final dimension.

- e. Push latch strap ⑱ up through 1/2 inch hole.

NOTE

Keeper flange on top of strap will prevent it from falling through hole when not in use.

- f. Reinstall hood.
 - g. Install two slot clamps ⑱ to hood using four push pin rivets ㉑ as shown.

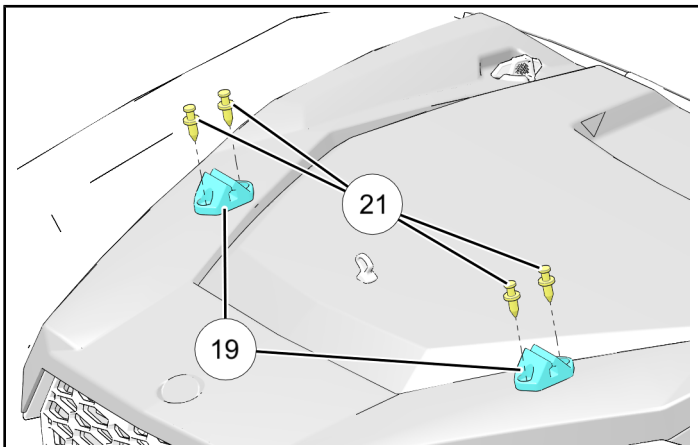

8. Clean hood at location shown and wipe dry. Peel adhesive backing from bumper ⑰ and firmly apply to hood.

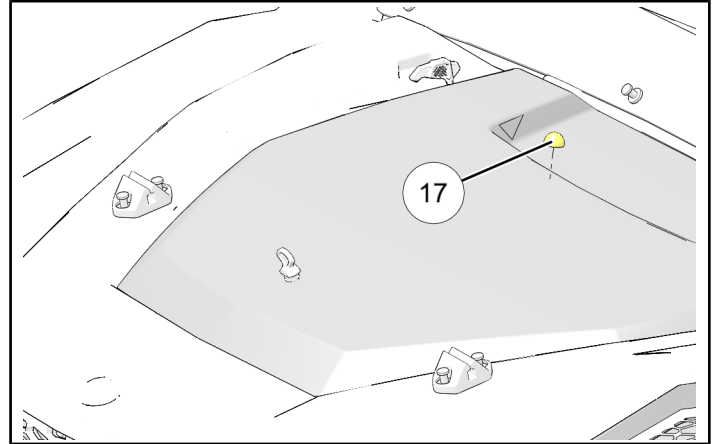

9. Reinstall roof (if previously removed)

⚠ WARNING

If vehicle is trailered **FACING FORWARD**, windshield must be **CLOSED** (upright) and **LOCKED** to upper ROPS. Failure to close and lock windshield may allow airflow to separate windshield from vehicle, resulting in an accident and severe injury or death.

Do **NOT** trailer vehicle **FACING REARWARD** with windshield installed. Airflow may cause windshield to separate from vehicle, resulting in an accident and severe injury or death. Remove windshield or transport vehicle in enclosed trailer.