

# P3200IE HIGH ALTITUDE KIT



P/N 2884866

## APPLICATION

Verify accessory fitment at [www.polaris.com](http://www.polaris.com).

## BEFORE YOU BEGIN

Read these instructions and check to be sure all parts and tools are accounted for. Please retain these installation instructions for future reference and parts ordering information.

## INSTALLATION VIDEO

This video will provide more clarity for kit installation. There are three ways to access the kit installation video:

- Scan the QR Code with a mobile device.
- Click the QR Code if viewing the instruction as a PDF.
- Enter the following URL in a web browser: <https://www.youtube.com/watch?v=eZXMH2llxog>



## KIT CONTENTS

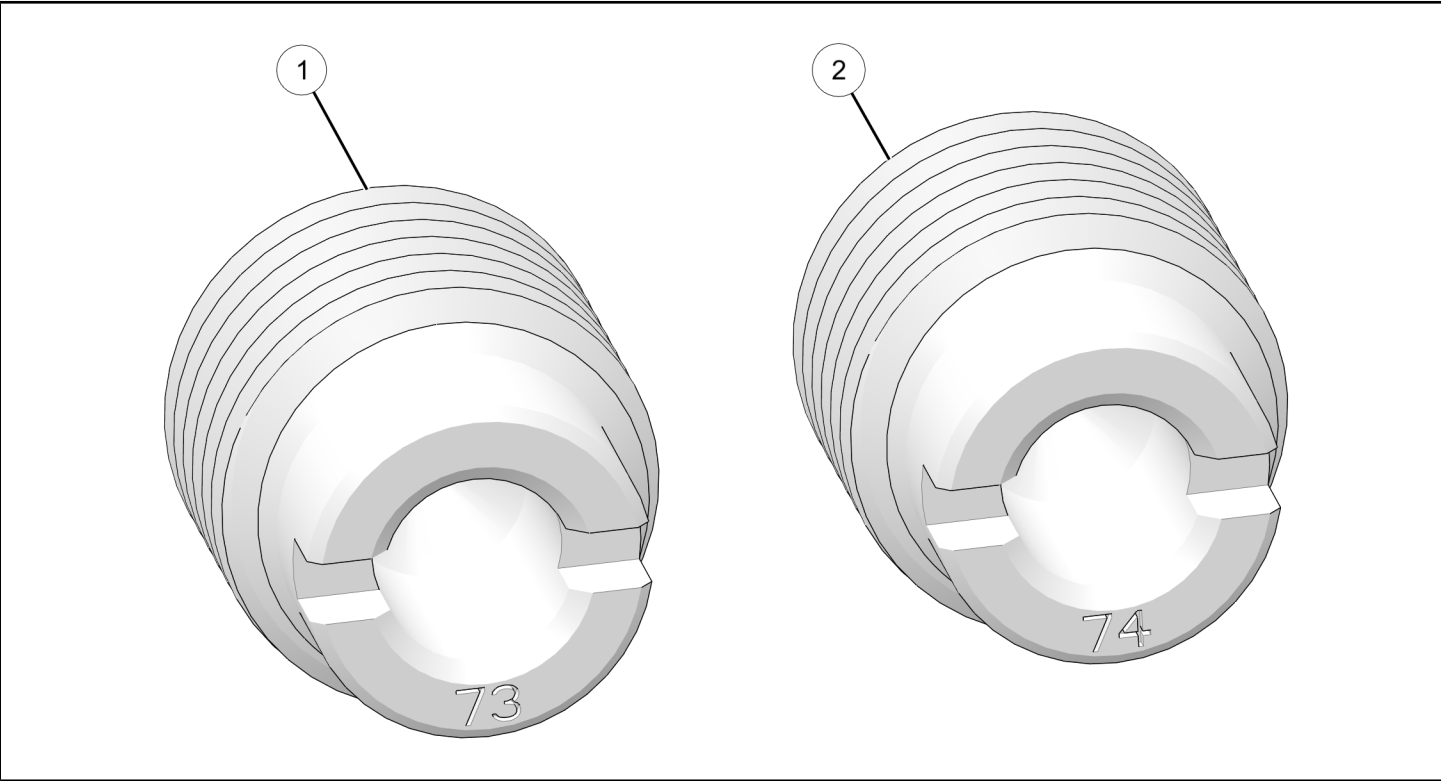

REF	QTY	PART DESCRIPTION	P/N AVAILABLE SEPARATELY
1	1	Main Jet - 73	N/A
2	1	Main Jet - 74	N/A

## TOOLS REQUIRED

- Safety Glasses
- Drain Pan
- Screwdriver, Phillips
- Screwdriver, Slotted
- Socket Set, Metric
- Wrench Set, Metric

## CONSUMABLES REQUIRED

- Gloves, Chemical Resistant
- Shop Rags

## IMPORTANT

Your P3200iE High Altitude Kit is exclusively designed for your vehicle. Please read the installation instructions thoroughly before beginning. Installation is easier if the vehicle is clean and free of debris. For your safety, and to ensure a satisfactory installation, perform all installation steps correctly in the sequence shown.

## INSTALLATION INSTRUCTIONS

### ACCESSORY INSTALLATION

#### WARNING

Gasoline is highly flammable and is explosive. You can be burned or seriously injured when handling fuel. Keep heat, sparks, and flame away. Wipe up spills immediately.

#### NOTICE

Using the wrong carburetor main jet may cause poor engine performance. If too lean of a main jet is used, severe engine damage may result.

### ALTITUDE JET SPECIFICATIONS

MODEL	ENGINE	ALTITUDE	ALTITUDE JET MARK
P3200iE	208cc	3000-6000 ft	74
		6000-8000 ft	73

## JET INSTALLATION

To change the carburetor main jet, follow this procedure:

1. Turn the fuel valve switch to the OFF position.

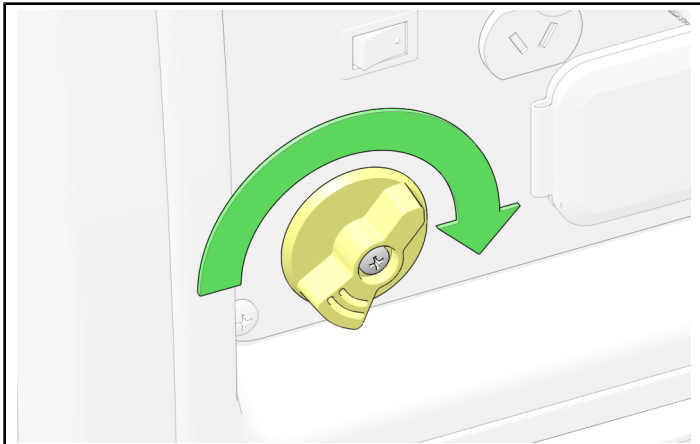

2. Loosen the two maintenance cover fasteners and remove the cover.

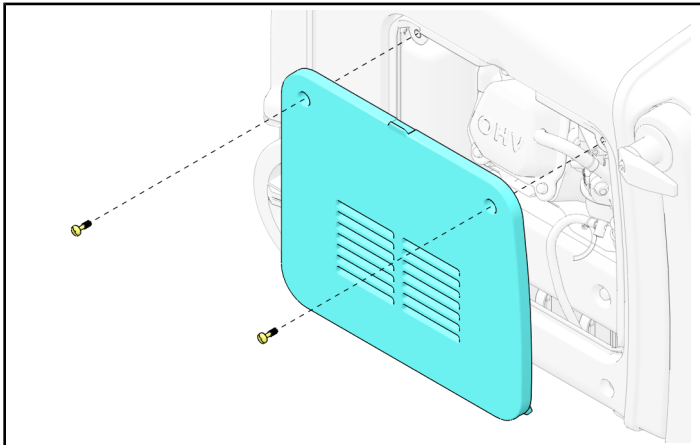

3. Pull the fuel hose out and into a suitable container.

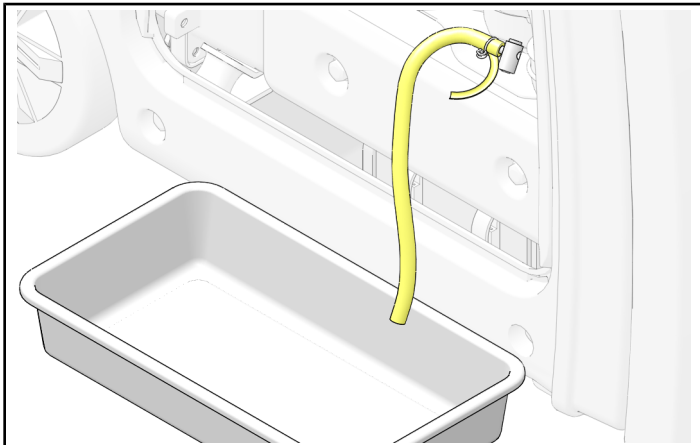

4. Loosen the carburetor drain screw and drain the fuel.

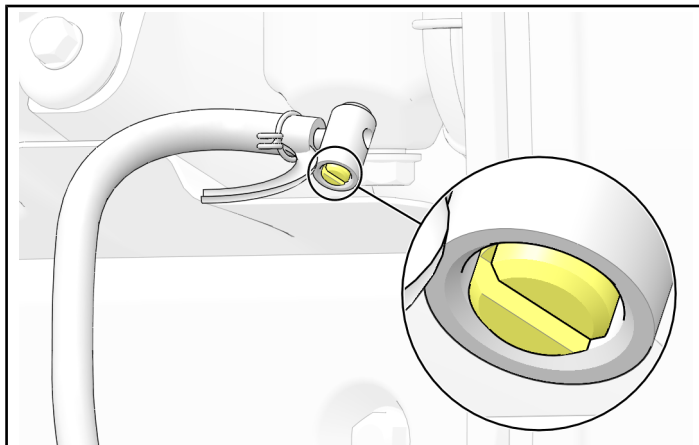

5. Remove the airbox cover fasteners. Remove the cover and air filter.

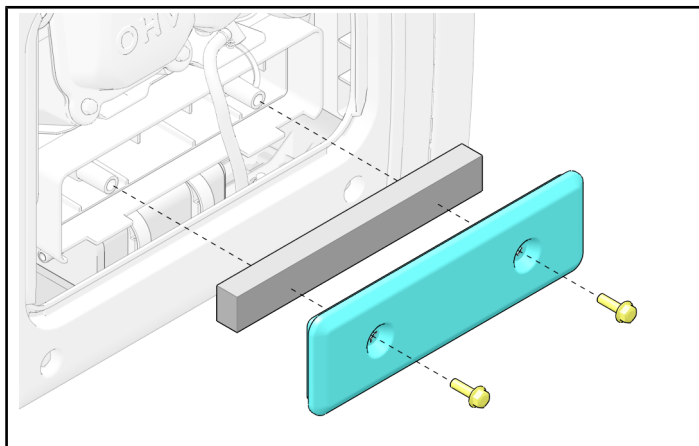

6. To remove the air filter box, loosen the hose clamp.

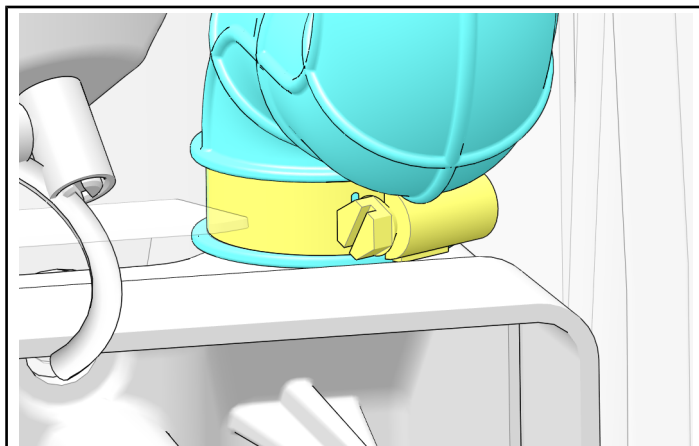

7. Remove the two fasteners securing the air filter box and remove the box.

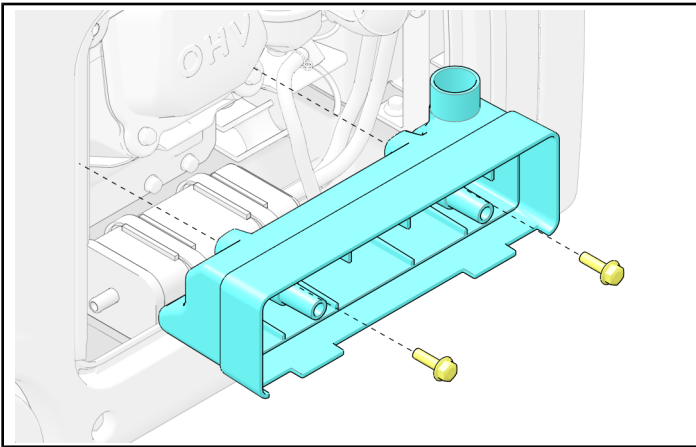

8. Remove the float bowl chamber bolt and remove the bowl.

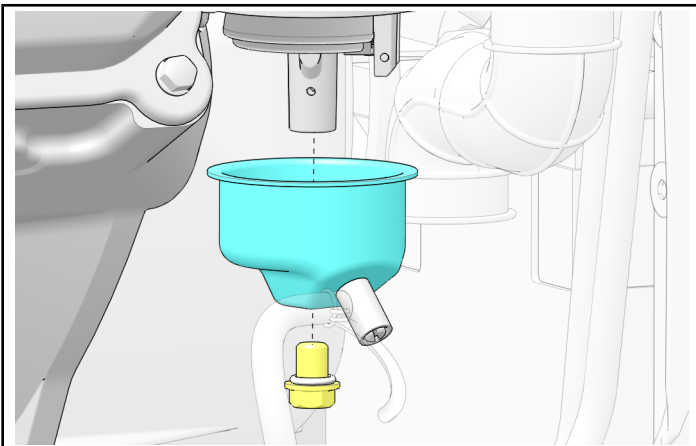

9. Remove the main jet from the carburetor.

#### NOTICE

The nozzle will likely come out when the main jet is removed.

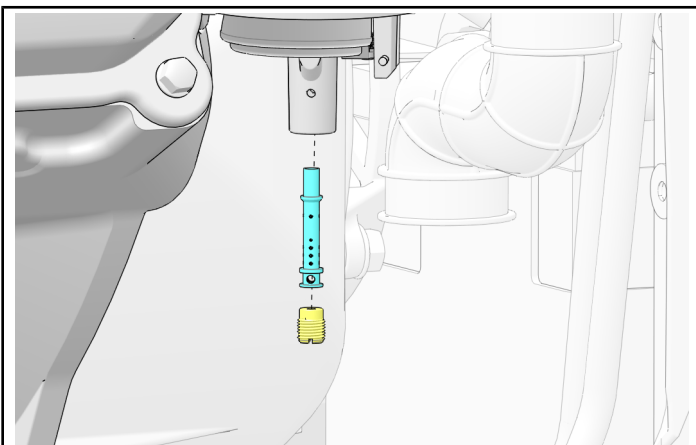

10. Install the correct main jet for the altitude in which the generator is operating. Do not over-tighten the jet.

#### NOTICE

Make sure to install the nozzle back in when installing the main jet.

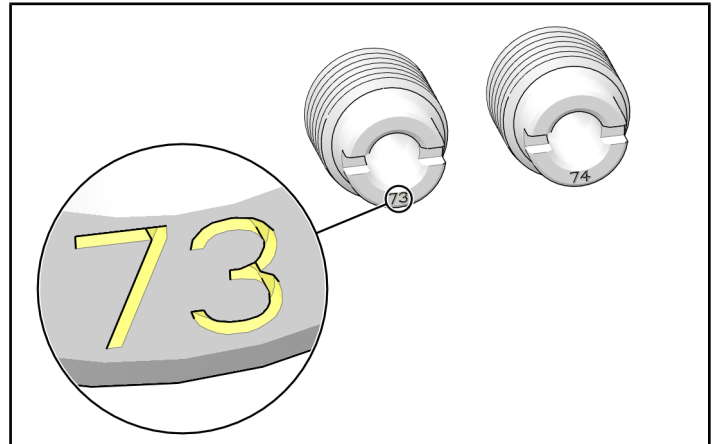

MODEL	ENGINE	ALTITUDE	ALTITUDE JET MARK
P3200iE	208cc	3000-6000 ft	74
		6000-8000 ft	73

11. Align the float chamber o-ring and reinstall the float bowl and chamber bolt.
12. Reinstall the air filter box. Tighten the clamp and fasteners until fully seated.
13. Reinstall the air filter and cover. Tighten the fasteners until fully seated.
14. Close carburetor drain screw.
15. Re-position the fuel hoses in their respective holders.
16. Turn on the fuel supply. Start generator and let engine run for several minutes.
17. Turn off generator. Verify there are no fuel leaks.
18. Reinstall the maintenance cover and tighten the fasteners until fully seated.

## INSTRUCTION FEEDBACK FORM

A feedback form has been created for the installer to provide any comments, questions or concerns about the installation instructions. The form is viewable on mobile devices by scanning the QR code or by clicking [HERE](#) if viewing on a PC.

