

# HEADLIGHT COWL KIT



P/N 2884673, 2884812

## APPLICATION

Verify accessory fitment at [www.indianmotorcycle.com](http://www.indianmotorcycle.com).

## BEFORE YOU BEGIN

Read these instructions and check to be sure all parts and tools are accounted for. Please retain these installation instructions for future reference and parts ordering information.

## KIT CONTENTS

### CARBON FIBER HEADLIGHT COWL KIT, P/N 2884673

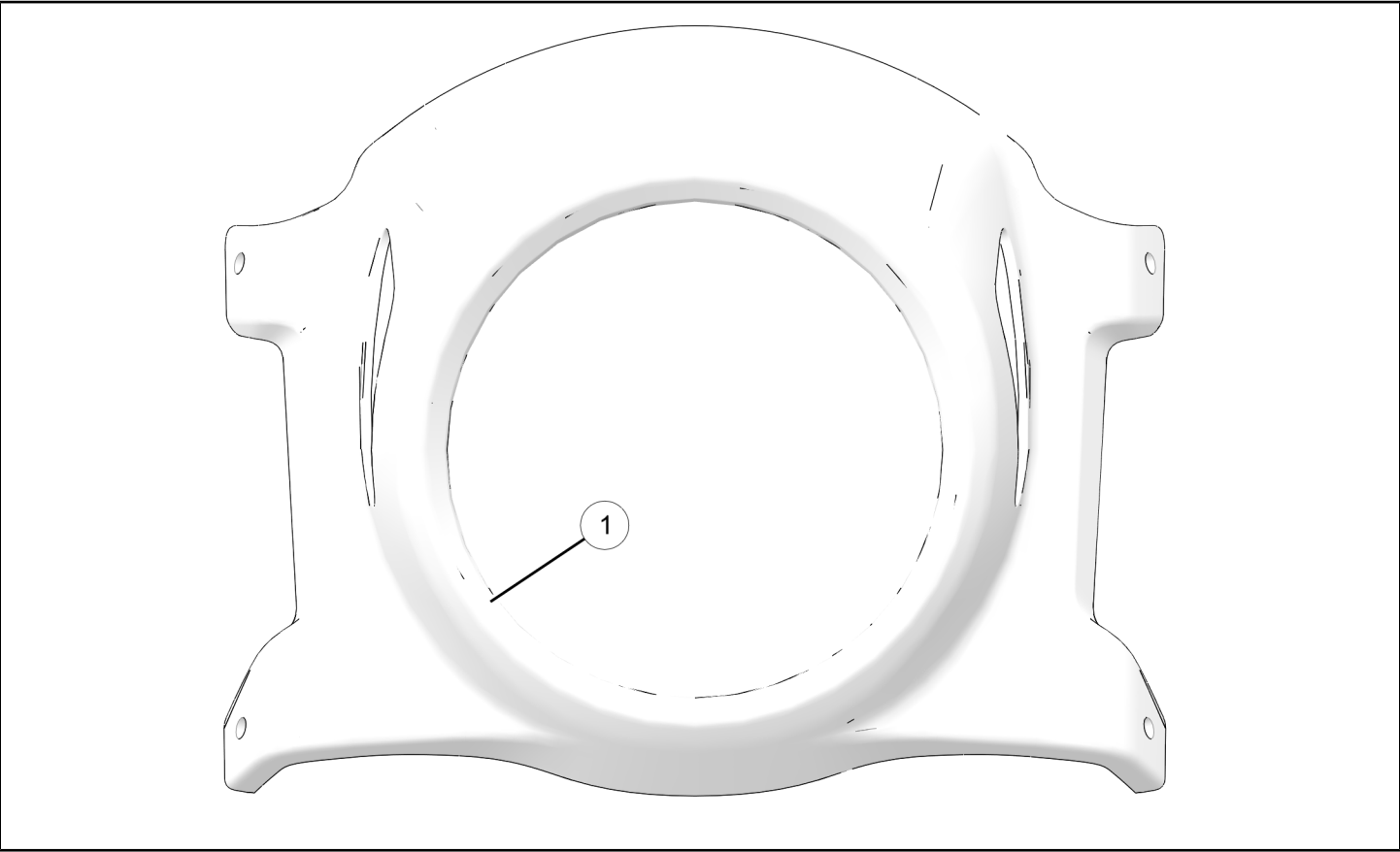

REF	QTY	PART DESCRIPTION	P/N AVAILABLE SEPARATELY
1	1	Cowl-Headlight, Carbon Fiber	2637693

**CARBON FIBER HEADLIGHT COWL KIT, P/N 2884812**

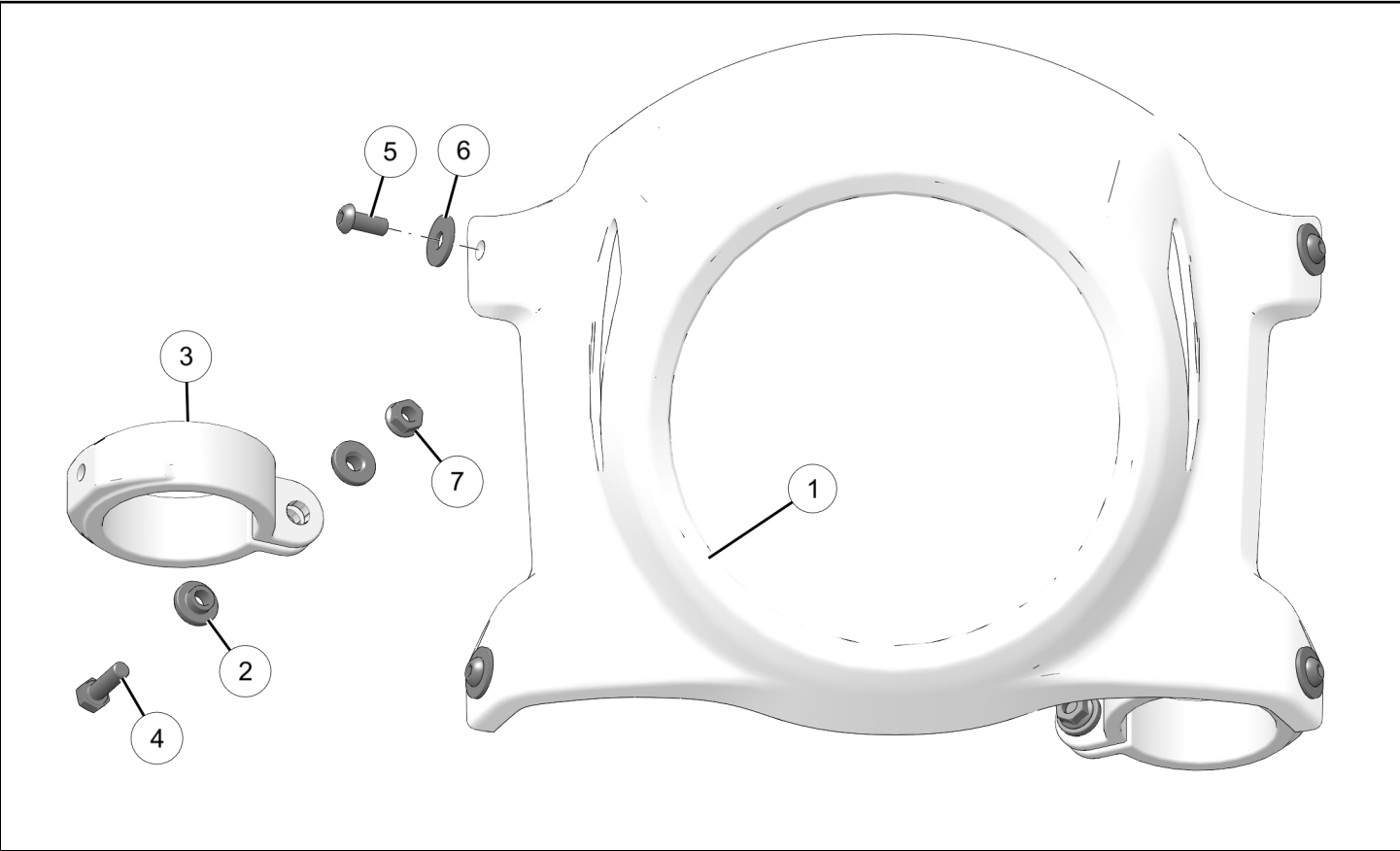

REF	QTY	PART DESCRIPTION	P/N AVAILABLE SEPARATELY
1	1	Cowl-Headlight, Carbon Fiber	2637693
2	4	Sleeve-Turn Signal Mount	5134083
3	2	Mount-Cowl	5416727
4	2	Screw-Hex Head, M6 x 1.0 mm x 20 mm	7517429
5	4	Screw-Hex Button Head, M6 x 1.0 mm x 14 mm	7519061
6	4	Washer-6.4 mm x 18.0 mm x 1.6 mm	7556064
7	2	Nut-Hex Flange, M6 x 1.0 mm	7710495

**TOOLS REQUIRED**

- Safety Glasses
  - Hex Key Set, Metric
  - Socket Set, Hex Bit, Metric
- Socket Set, Metric
  - Torque Wrench
  - Wrench Set, Metric

**IMPORTANT**

Your accessory kit is exclusively designed for your vehicle. Please read the installation instructions thoroughly before beginning. Installation is easier if the vehicle is clean and free of debris. For your safety, and to ensure a satisfactory installation, perform all installation steps correctly in the sequence shown.

## INSTALLATION INSTRUCTIONS

### VEHICLE PREPARATION

#### GENERAL

1. Turn key or ignition switch to OFF position and remove key.
2. Ensure motorcycle is parked on a flat surface, kickstand is fully extended, and vehicle is stable prior to installation.

#### HEADLIGHT COWL REMOVAL (IF APPLICABLE)

1. Remove and retain four screws and four washers from headlight cowl.

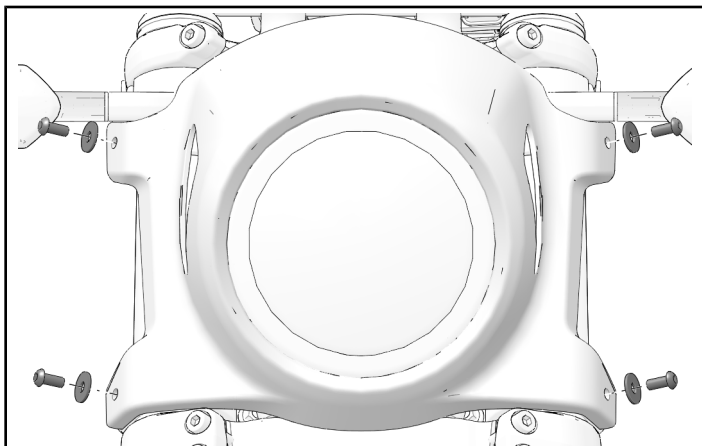

2. Remove headlight cowl.

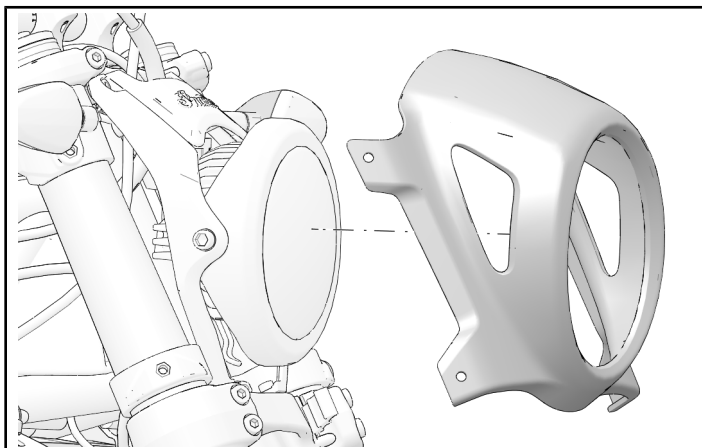

### ACCESSORY INSTALLATION

#### CARBON FIBER HEADLIGHT COWL KIT, P/N 2884673

1. Place headlight cowl over headlight assembly.

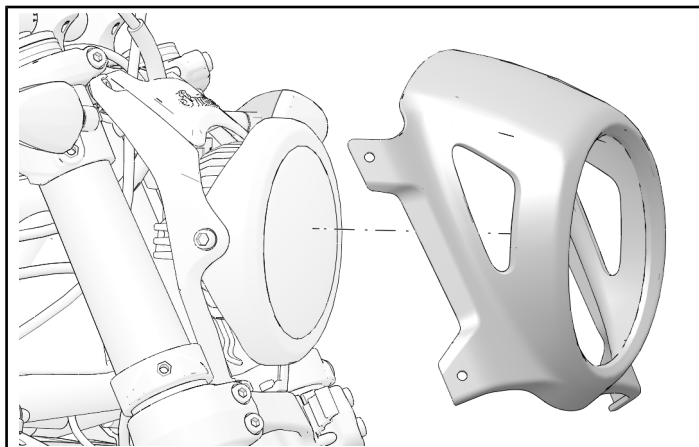

2. Install headlight cowl with retained washers and fasteners.

#### TORQUE

Headlight Cowl Fasteners:  
**18 in-lbs (2 N·m)**

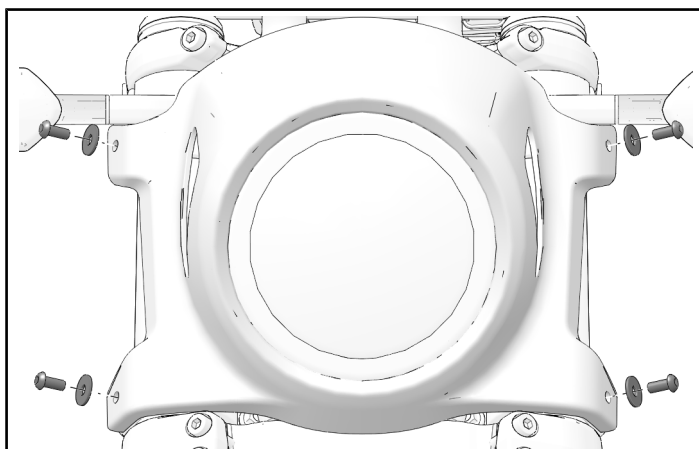

## **CARBON FIBER HEADLIGHT COWL KIT, P/N 2884812**

### **LEFT-HAND MOUNT**

1. Loosely install cowl mount with one fastener ④, two sleeves ②, and one nut ⑦.

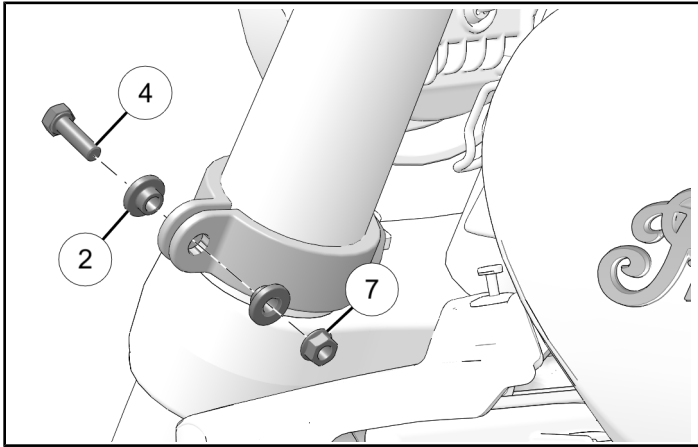

2. Rotate cowl mount on fork and hand tighten fastener.

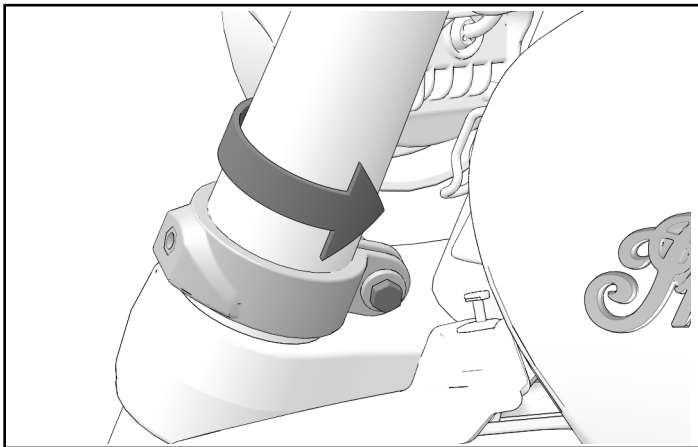

### **RIGHT-HAND MOUNT**

1. Loosely install cowl mount with one fastener ④, two sleeves ②, and one nut ⑦.

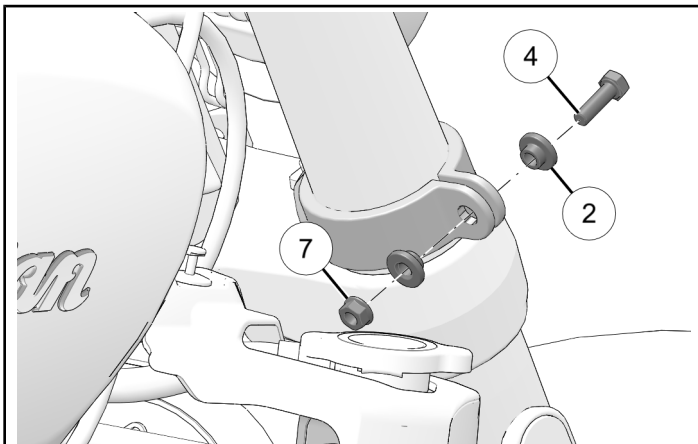

2. Rotate cowl mount on fork and hand tighten fastener.

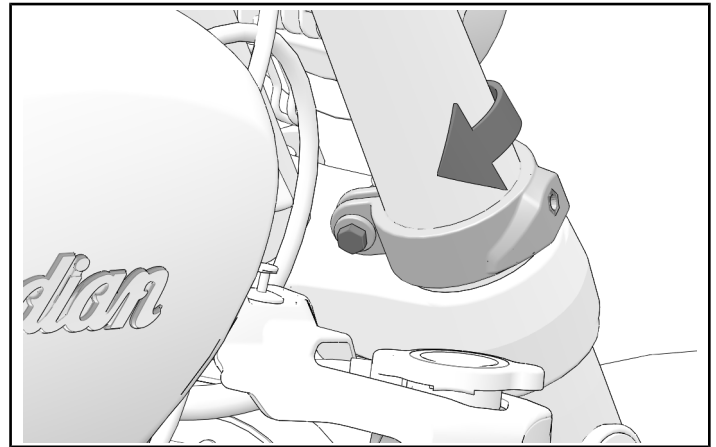

### **HEADLIGHT COWL INSTALLATION**

1. Place headlight cowl over headlight assembly.

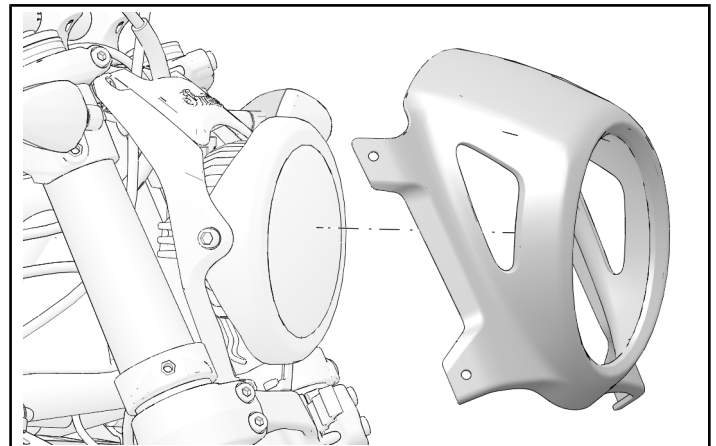

2. Install headlight cowl with four washers ⑥ and four fasteners ⑤.

### **TORQUE**

Headlight Cowl Fasteners ⑤:  
**18 in-lbs (2 N·m)**

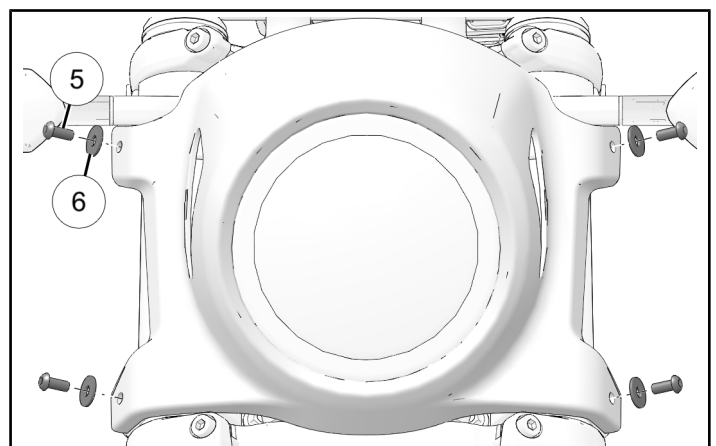

3. Tighten headlight cowl mount fasteners.

TORQUE
Mount Fastener: <b>36 in-lbs (4 N·m)</b>

## FEEDBACK FORM

A feedback form has been created for the installer to provide any comments, questions or concerns about the installation instructions. The form is viewable on mobile devices by scanning the QR code or by clicking [HERE](#) if viewing on a PC.

