

# **KIT PRINTING ALERT**

**These instructions include a template using "ANSI B" size paper (11" x 17")**

**BEFORE PRINTING THESE INSTRUCTIONS TO PACKAGE IN KITS, YOU MUST SET YOUR PRINTING SETUP DIALOG TO PRINT THE RIGHT SIZE PAPER, "ANSI B" (11" X 17").**

**Failure to do so will result in not printing the correct size template.**

**In the Print Set up Dialog Box**

**Under Page Handling**

**First Uncheck Auto Rotate and Center box**

**and then Check the Choose Paper Source by PDF Size, and click OK**

**DO NOT INCLUDE THIS PAGE WITH INSTRUCTIONS**

**Contact Technical Publications if you have any questions**

# FENDER HEADRESS KIT



**P/N 2883668-XXX**

## APPLICATION

Verify accessory fitment at [www.indianmotorcycle.com](http://www.indianmotorcycle.com).

## BEFORE YOU BEGIN

Read these instructions and check to be sure all parts and tools are accounted for. Please retain these installation instructions for future reference and parts ordering information.

## KIT CONTENTS

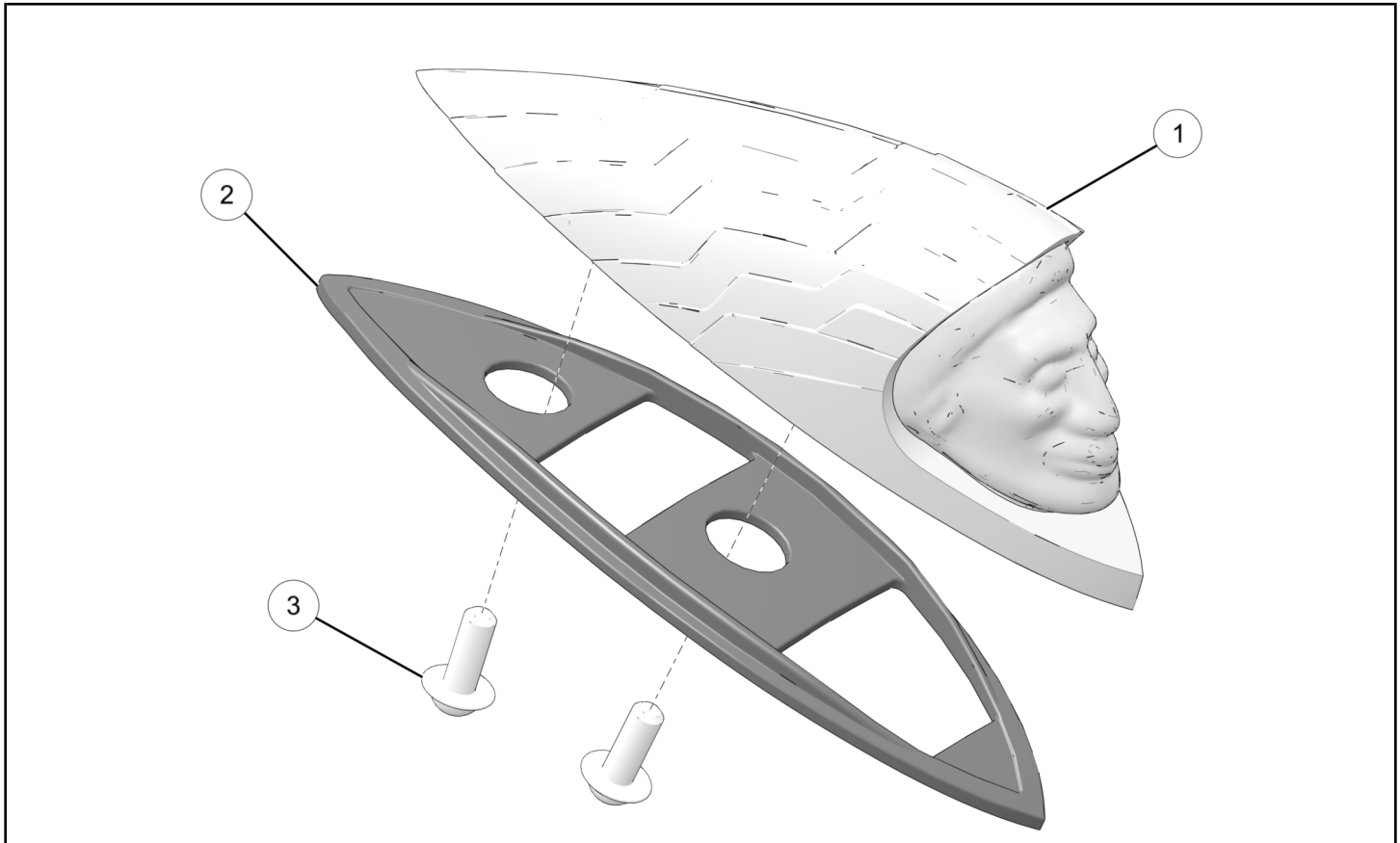

### NOTE

XXX = Indian® color code (For example: 266 = Black)

REF	QTY	PART DESCRIPTION	P/N AVAILABLE SEPARATELY
1	1	Unlit Headdress, 19 in. Fender	2414568-XXX
2	1	Gasket, Headdress, 19 in. Fender	5416941
3	2	Screw, Torx® Button Head, M6 X 1.0 X 16	7520992
	1	Instructions	9929362

## TOOLS REQUIRED

- Safety Glasses
- Deburring Tool
- Drill
- Drill Bit: 17/64 inch (6.75 mm)
- Flexible Ruler (Cloth, Paper, etc)
- Ruler
- Scissors
- Socket Set, Hex Bit, Metric
- Socket Set, Torx® Bit
- Torque Wrench

## CONSUMABLES REQUIRED

- Tape, Masking

## IMPORTANT

Your Indian Fender Headdress Kit is exclusively designed for your vehicle. Please read the installation instructions thoroughly before beginning. Installation is easier if the vehicle is clean and free of debris. For your safety, and to ensure a satisfactory installation, perform all installation steps correctly in the sequence shown.

## INSTALLATION INSTRUCTIONS

### VEHICLE PREPARATION

#### GENERAL

1. Turn key or ignition switch to **OFF** position and remove key. If equipped with keyless fob, remove fob from proximity of vehicle.
2. Ensure motorcycle is parked on a flat surface, kickstand is fully extended, and vehicle is stable prior to installation.

#### FRONT FENDER REMOVAL

1. Remove and retain two fasteners **A** from each side of fender

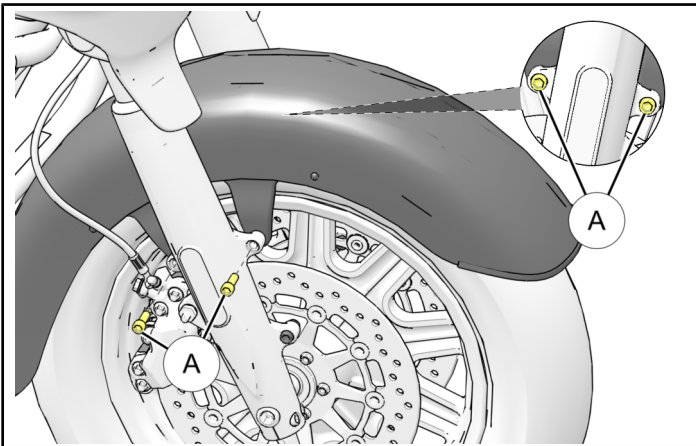

2. Stand in front of motorcycle facing front fender and squeeze sides together while “rolling” fender out from fork legs.

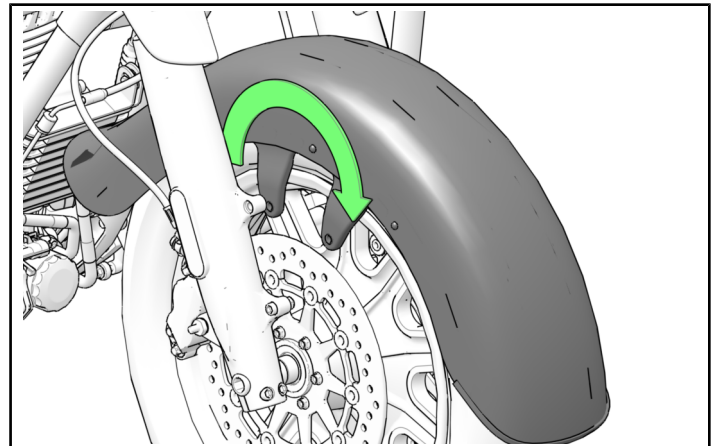

### ACCESSORY INSTALLATION

#### INSTALL TEMPLATE

1. Detach template page located at end of this instruction.
2. Locate REFERENCE DIMENSION on each template page.

Verify templates were printed to proper scale by using ruler to verify REFERENCE DIMENSION is exactly 3 inches (77 mm).

#### **IMPORTANT**

If measurement is not exactly 3 inches (77 mm), reprint template pages from electronic file using print setting “**Actual Size**” to obtain 1:1 scale.

Electronic file available from your  
**Authorized Polaris® Dealer.**

3. Carefully cut out template along exterior lines.
4. Start by aligning template rivet (A) on side of fender as shown. Secure with masking tape (B). Repeat procedure on opposite side.

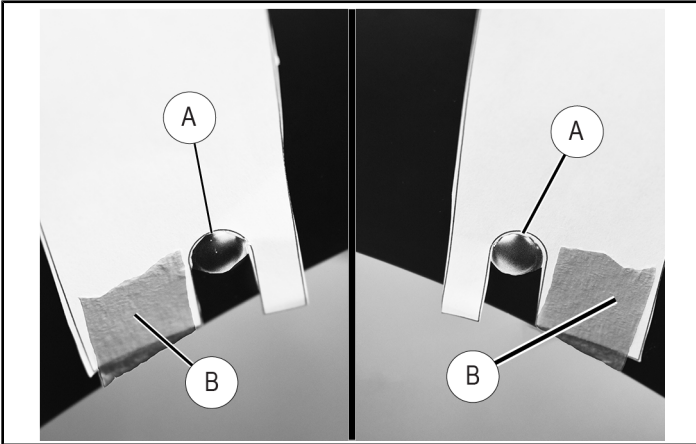

5. Align edges of template with edges of fender as shown and secure with masking tape (B). Template will pivot on hinges slightly.

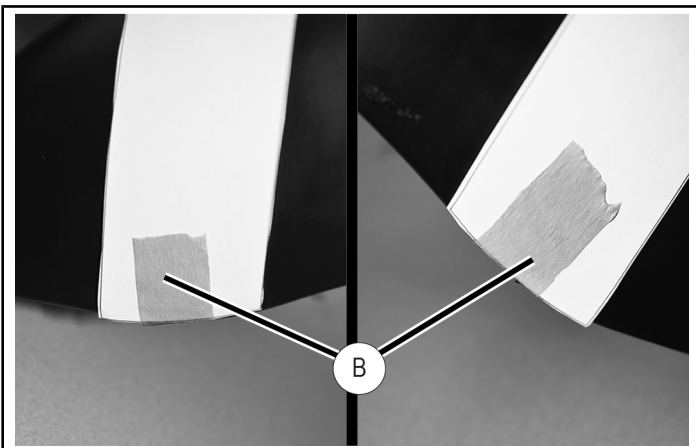

6. Template should be installed as shown.



7. Ensure template is centered on fender using a flexible ruler. Measure from centerline to fender edge. Distances should be identical from side to side. Measure in a few locations along centerline to verify template is installed properly.



8. Use ice pick (or equivalent) to mark center of each hole.

### DRILL HOLES

1. Carefully drill 17/64 inch (6.75 mm) hole at each marked location.
2. Debur as required.

## INSTALL HEADDRESS

1. Place Headdress Seal ② and Headdress ① onto fender, align threaded holes in Headdress with drilled holes in fender. Loosely install headdress with two new screws ③.

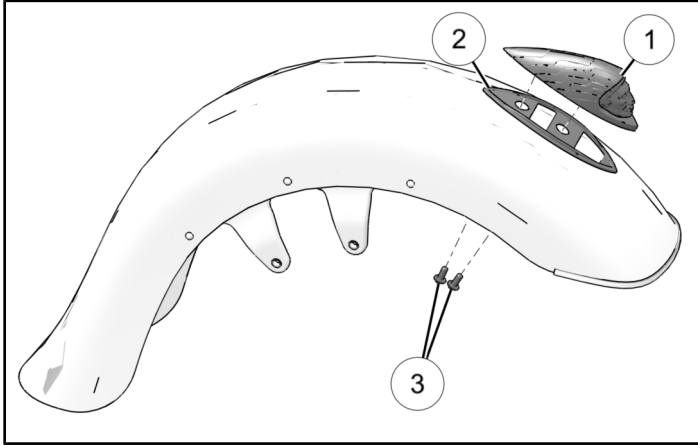

2. Ensure headdress is centered and straight. Torque screws to specification.

### TORQUE

36 in. lbs. (4 Nm)

## VEHICLE REASSEMBLY

### GENERAL

### REINSTALL FRONT FENDER

1. Gently squeeze sides of front fender and “roll” fender into position so fastener holes line up.
2. Install two retained fasteners (A) on each side of fender and torque to specification.

### TORQUE

18 ft. lbs. (24 Nm)

## FEEDBACK FORM

A feedback form has been created for the installer to provide any comments, questions or concerns about the installation instructions. The form is viewable on mobile devices by scanning the QR code or by clicking [HERE](#) if viewing on a PC.

### FEEDBACK FORM



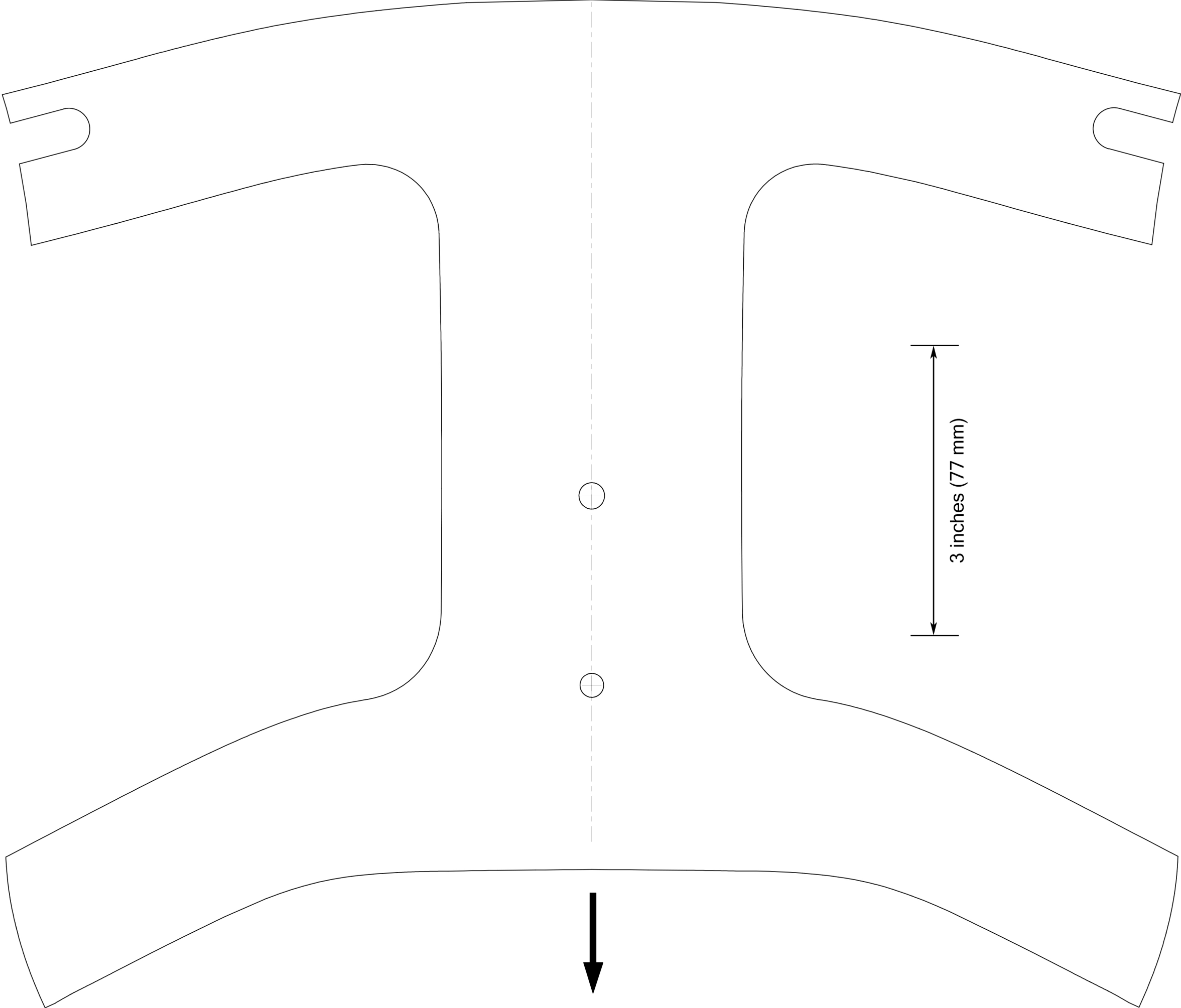

3 inches (77 mm)

