

# 2 INTO 1 EXHAUST KIT



P/N 2884111-XXX

## IMPORTANT

Due to the technical nature of this kit and the required Digital Wrench® activation, Indian Motorcycle® insists this installation be performed by a certified Indian Motorcycle® Technician.

## APPLICATION

Verify accessory fitment at [www.indianmotorcycle.com](http://www.indianmotorcycle.com).

## BEFORE YOU BEGIN

Read these instructions and check to be sure all parts and tools are accounted for. Please retain these installation instructions for future reference and parts ordering information.

## KIT CONTENTS

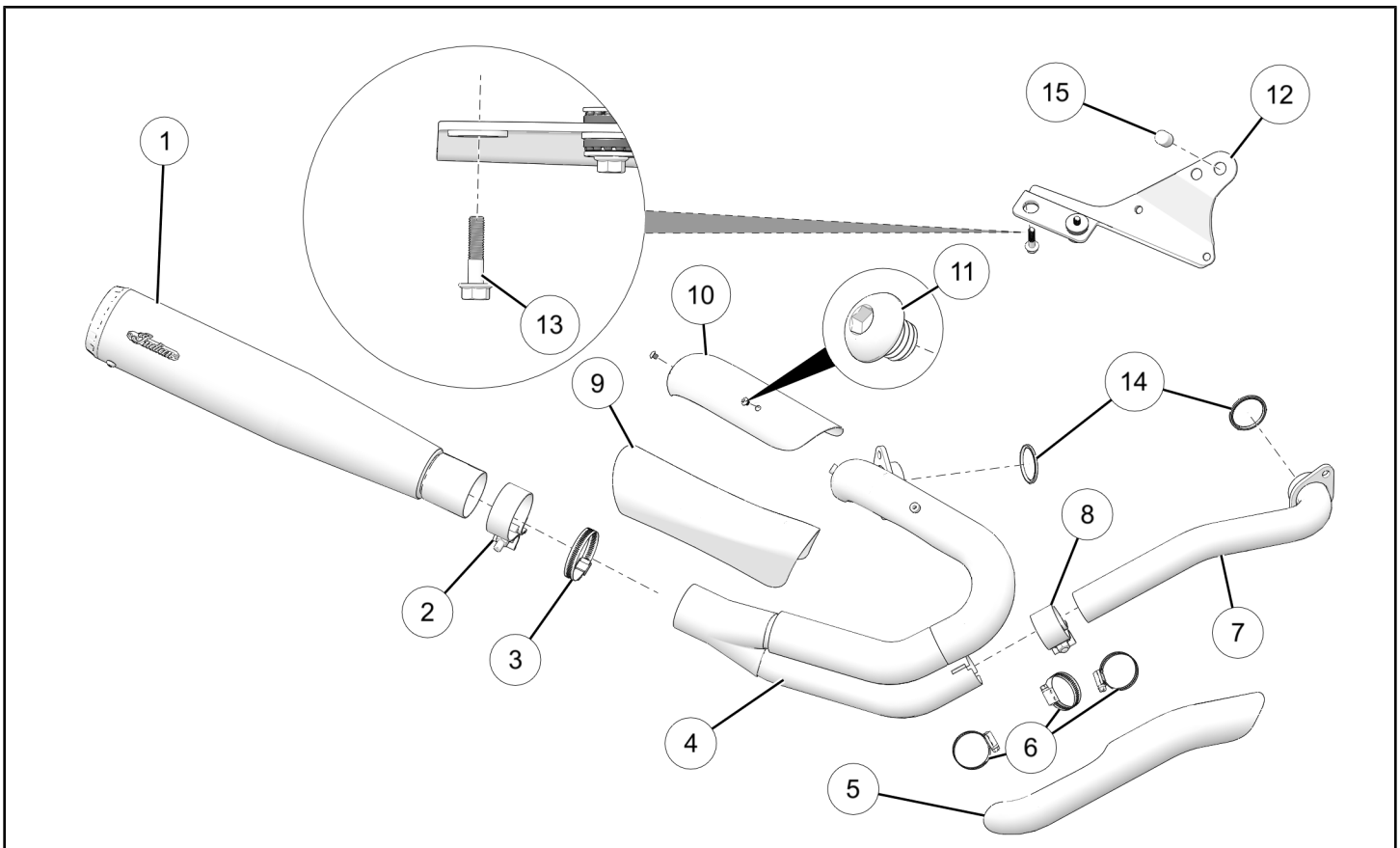

REF	QTY	PART DESCRIPTION	P/N AVAILABLE SEPARATELY	AVAILABLE SERVICE KIT
1	1	Muffer Assembly, 4 in.	-	
2	1	Clamp, Muffer, Band Style, 2.5 in.	-	2208030
3	1	Clamp, Hose, Worm Drive, #40	-	2208030
4	1	Exhaust Header, Assembly	-	
5	1	Heat Shield, Front	-	

REF	QTY	PART DESCRIPTION	P/N AVAILABLE SEPARATELY	AVAILABLE SERVICE KIT
6	3	Clamp, Hose, Worm Drive, #20	-	2208030
7	1	Exhaust Header, Front, Weldment	-	
8	1	Clamp, Muffler, Band Style, 1.75 in.	-	
9	1	Heat Shield, Collector	-	2208030
10	1	Heat Shield, Rear-Secondary	-	
11	2	Screw, Button Head Hex, M6 X 8 mm	-	
12	1	Mounting Bracket	-	2208030
13	2	Screw, Hex Flange Head, M8 X 35 MM	-	
14	2	Gasket, Exhaust Header	5261515	
15	1	Swing arm Bolt Cap	-	2208030
16	1	Loctite® Red Threadlocker 263 (Not Shown)	-	
17	1	Calibration Card (Not Shown)	4014490	

## TOOLS REQUIRED

- Safety Glasses
- Cutting Tool/Utility Knife
- Digital Wrench™
- Flashlight
- Hammer, Soft Face
- Socket Set, Hex Bit, Metric
- Socket Set, Metric
- Socket Set, Torx® Bit
- Torque Wrench
- Vehicle Lift/Support Equipment

## CONSUMABLES REQUIRED

- Cloth, Non-Abrasives (Cheesecloth or equivalent)

## IMPORTANT

Your Indian Motorcycle® 2 Into 1 Exhaust Kit is exclusively designed for your vehicle. Please read the installation instructions thoroughly before beginning. Installation is easier if the vehicle is clean and free of debris. For your safety, and to ensure a satisfactory installation, perform all installation steps correctly in the sequence shown.

## INSTALLATION INSTRUCTIONS

### VEHICLE PREPARATION

#### GENERAL

1. Support motorcycle securely in an upright position. Clamp front tire securely in a wheel vise.
2. Turn key or ignition switch to "OFF" position and remove key. If equipped with keyless fob, remove fob from proximity of vehicle.

### ACCESSORY INSTALLATION

#### REMOVE STOCK EXHAUST

1. Remove stock Muffler and Head Pipe from motorcycle as per service manual.

2. Retain four exhaust header nuts (A) and discard two gaskets (B).

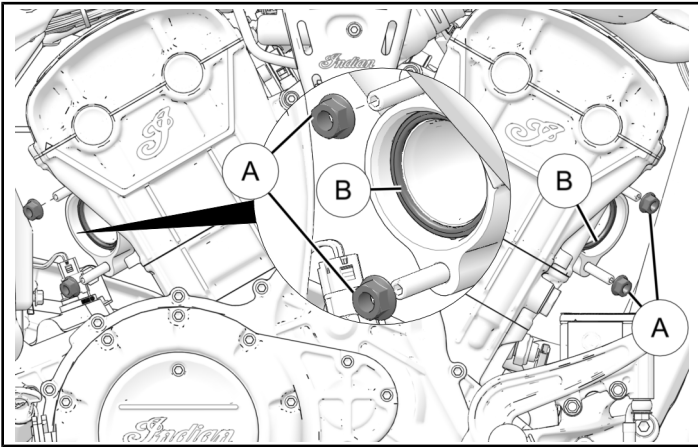

3. Make note of allocation of front and rear Oxygen Sensors. Carefully remove and retain front (C) and rear (D) Oxygen Sensors.

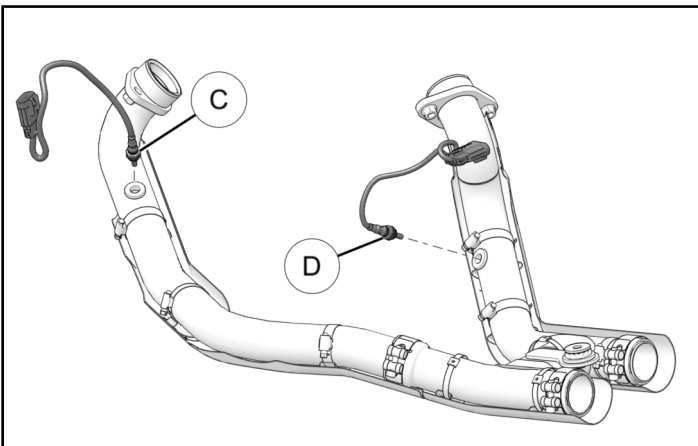

4. Remove and retain two screws (E), one nut (F), and one washer (G) from stock muffler mount (H). Remove stock muffler mount (H) and set aside.

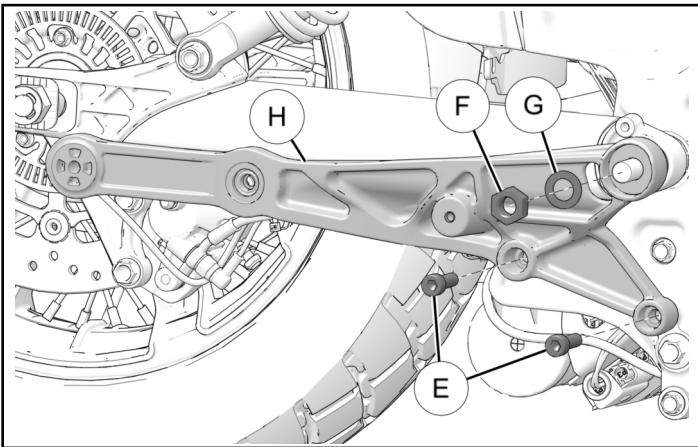

5. Remove and retain two washers (J), four rubber grommets (K) and two sleeve washers (L) from stock muffler mount (H).

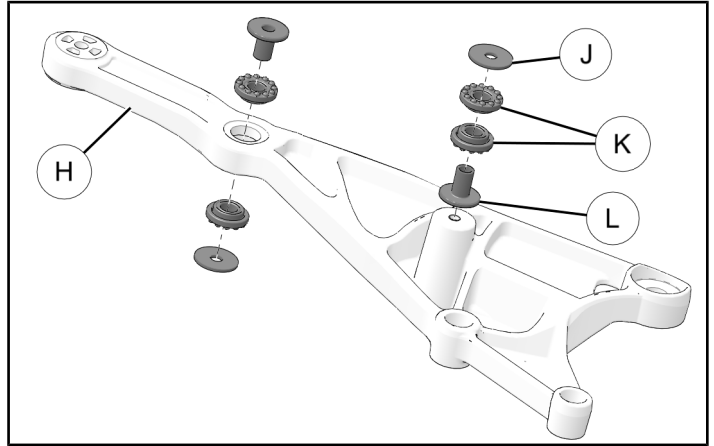

### **MOUNTING BRACKET INSTALLATION**

1. Install new Mounting Bracket (12) to frame using retained screws (E), nut (F), and washer (G). Torque fasteners to specification.

#### **TORQUE**

Mounting Bracket Screws (E):  
**35 ft-lbs (47 N·m)**  
 Exhaust Bracket Mount Nut (F):  
**50 ft-lbs (68 N·m)**

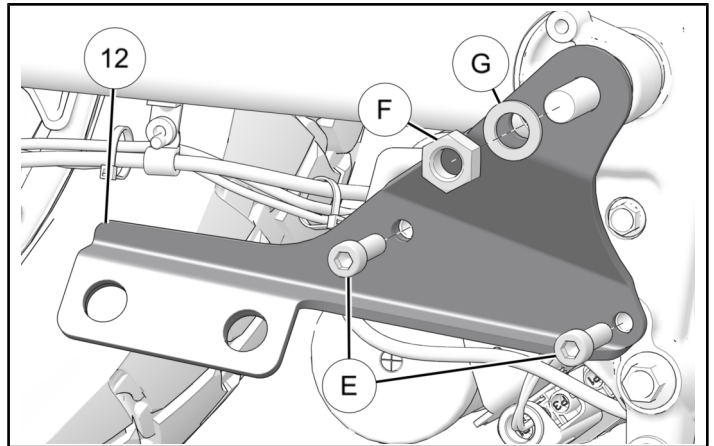

2. Install Swing Arm Cap ⑮ onto threaded end of exposed stud.

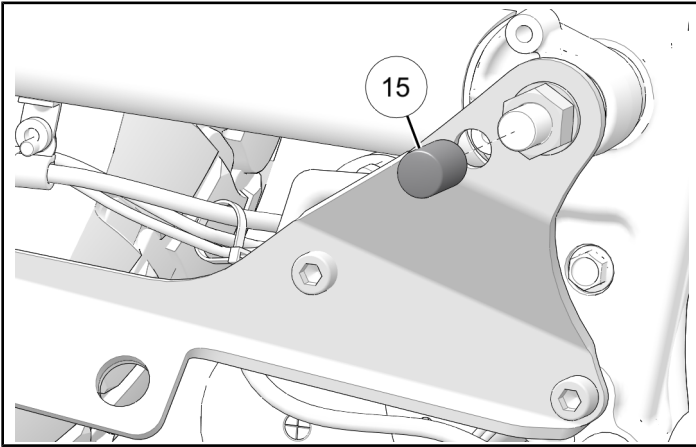

### EXHAUST HEADER INSTALLATION

1. Loosely install front ⑦ and rear ④ retained Oxygen Sensors into front ⑦ and rear ④ header pipes.

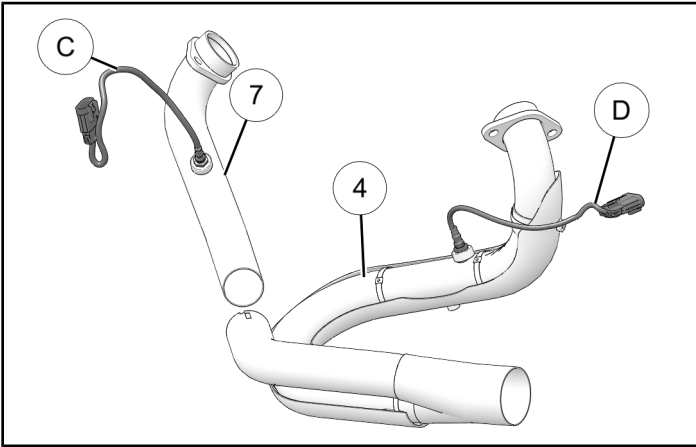

2. Install new exhaust header gaskets ⑭.

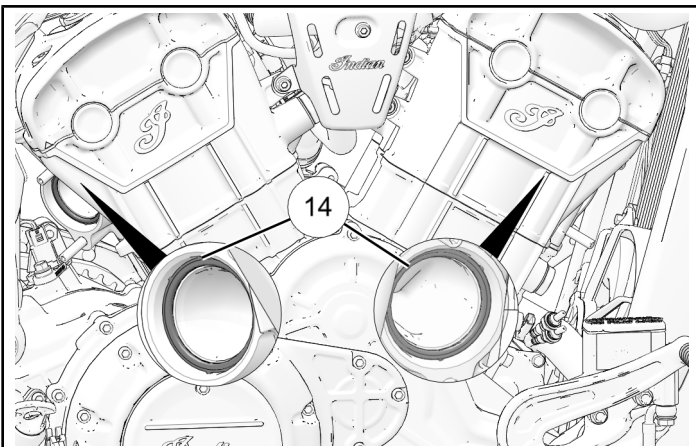

3. Loosely install front exhaust header ⑦ using two retained nuts ①. **DO NOT tighten fasteners at this time.** Ensure Oxygen Sensor wiring is routed back to connector.

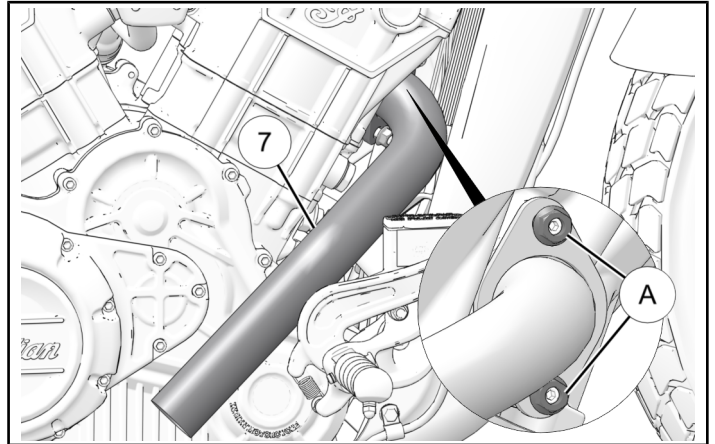

4. Slide clamp ⑧ onto rear header ④ with nut facing down and outward as shown. Insert front header pipe into rear header pipe opening and slide rear header into place. Loosely install rear exhaust header using two retained nuts ①. Ensure Oxygen Sensor wiring is routed back to connector.

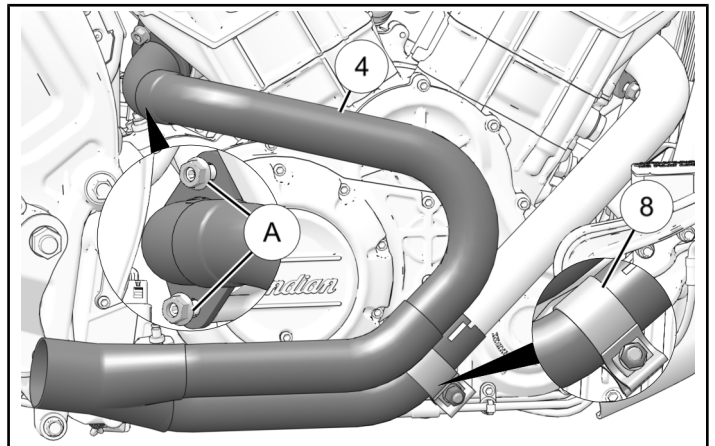

5. Snug down (**DO NOT torque**) front ⑦ and rear ④ exhaust header nuts in order:

- ① Rear Lower
- ② Front Lower
- ③ Rear Upper

#### ④ Front Upper

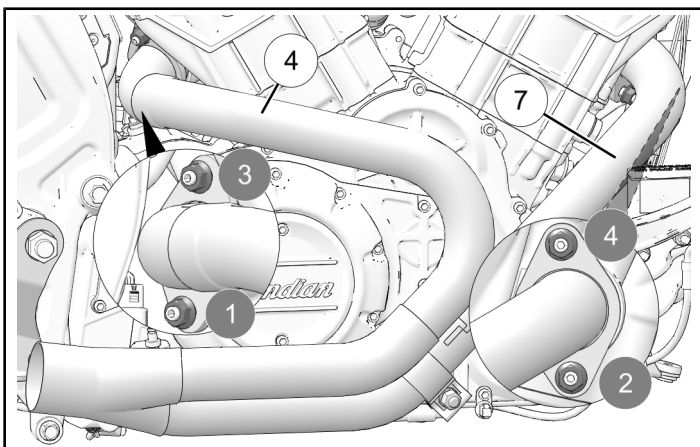

6. Torque exhaust header nuts to specification in same order as previous step.

#### TORQUE

Exhaust Header Nuts:  
**12 ft-lbs (16 N·m)**

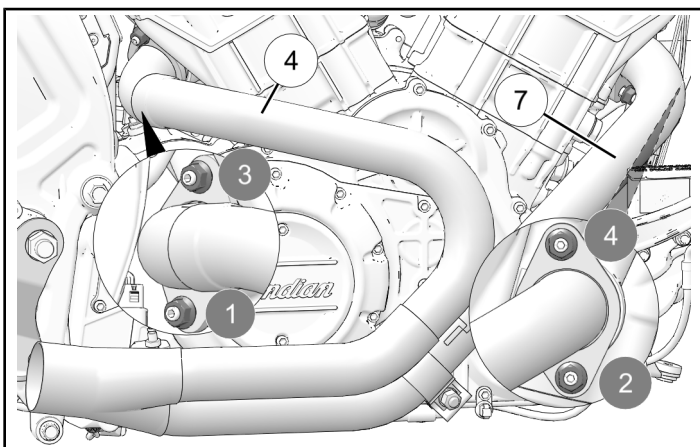

7. Torque Oxygen Sensors to specification.

#### TORQUE

Oxygen Sensors:  
**14 ft-lbs (19 N·m)**

8. Torque clamp ⑧ to specification.

#### TORQUE

Muffler Clamp ⑧:  
**40 ft-lbs (54 N·m)**

### MUFFLER INSTALLATION

1. Stack two screws ⑬, two washers ①, and two rubber grommets ①. Install each stack through mounting bracket ⑫, one more rubber grommet ① and one sleeve ① into threaded hole in muffer ①. **DO NOT** torque fasteners at this time.

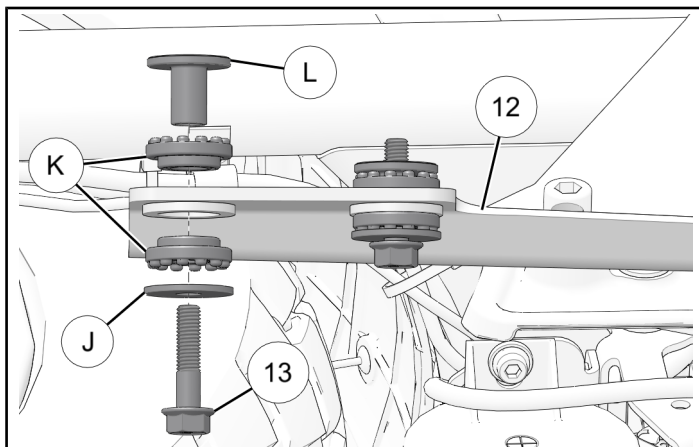

2. Slide muffler clamp ② onto muffer assembly ① and slide muffer assembly ① onto rear header ④. **DO NOT** tighten clamp at this time.

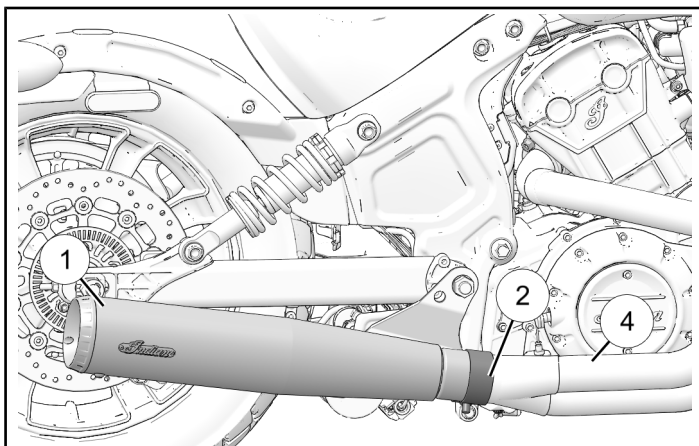

- Align muffler assembly, rotate muffler clamp ② away from ground and torque clamp ② and mounting bracket screws ⑬ specifications.

**TORQUE**

Muffler Clamp ②:  
**40 ft-lbs (54 N·m)**

**TORQUE**

Mounting Bracket Screws ⑬:  
**18 ft-lbs (24 N·m)**

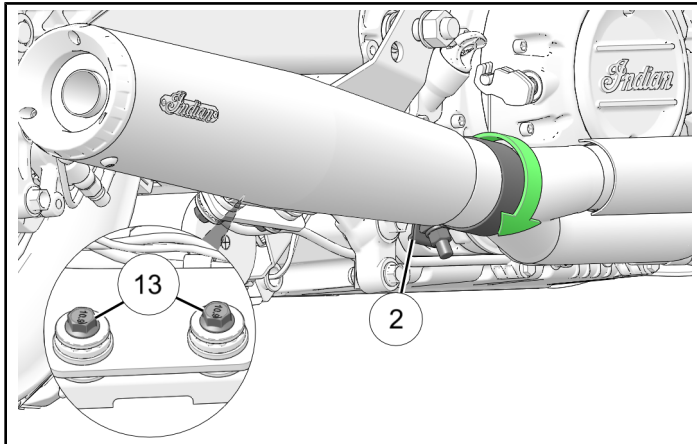

**HEAT SHIELD INSTALLATION**

- Open up and Insert clamp ③ into slot on collector heat shield ⑨ in orientation shown.

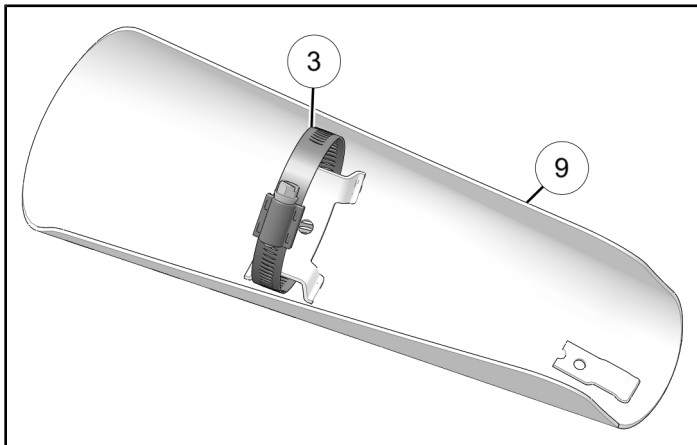

- Install collector heat shield ⑨ by first inserting tab (shown with inset) under rear edge of installed heat shield, then securing with clamp ③. Torque clamp screw to specification.

**TORQUE**

Exhaust Clamp ③:  
**27 in-lbs (3 N·m)**

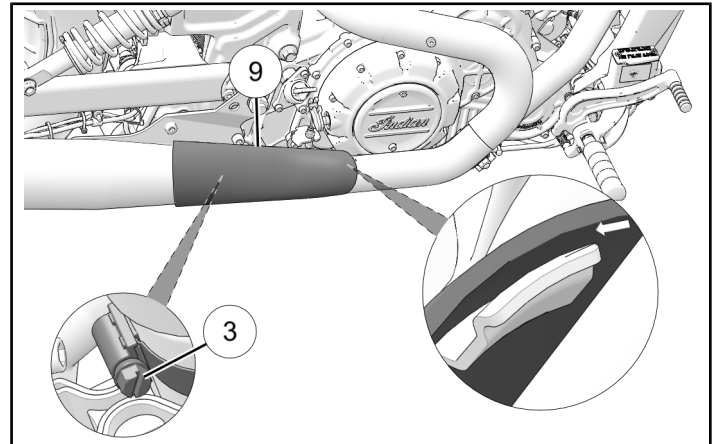

- Insert three clamps ⑥ into slots on front lower heat shield ⑤ in orientation shown.

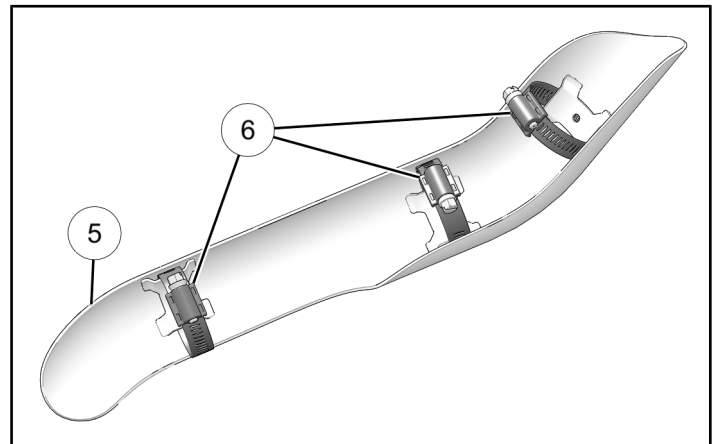

4. Install lower front heat shield ⑤ in place and secure with three clamps ⑥. Torque clamps to specification.

#### TORQUE

Exhaust Clamp ⑥:  
**27 in-lbs (3 N·m)**

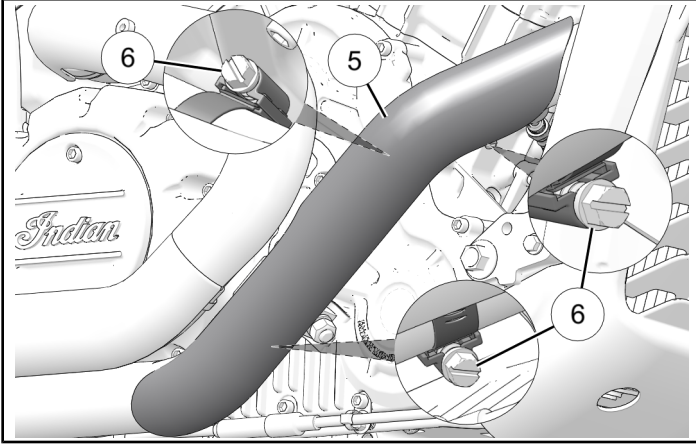

5. Install rear heat shield ⑩ to secondary pipe, install Loctite® onto threads of two screws ⑪ and secure heat shield with two screws ⑪. Torque screws to specification.

#### TORQUE

Rear heat shield screw ⑪:  
**84 in-lbs (9.5 N·m)**

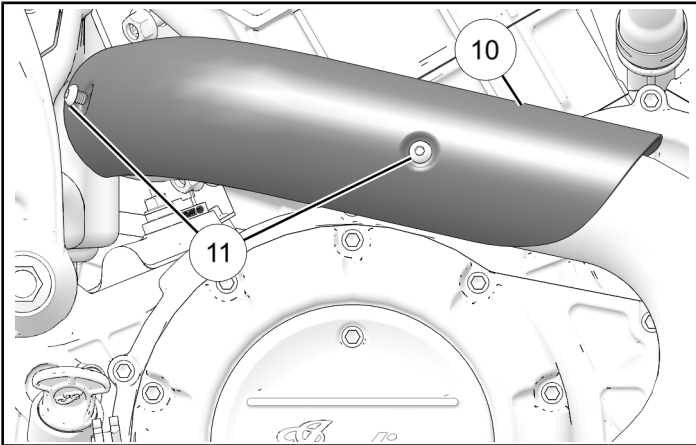

#### UPDATE ECM

1. Update ECM with new calibration software using included calibration card

#### IMPORTANT

This step must be completed by an Authorized Indian® Dealer. Do not operate vehicle until recalibration of vehicle is complete.

## FEEDBACK FORM

A feedback form has been created for the installer to provide any comments, questions or concerns about the installation instructions. The form is viewable on mobile devices by scanning the QR code or by clicking [HERE](#) if viewing on a PC.

