

# THUNDER STROKE® PERFORMANCE CLUTCH KIT



P/N 2883957

## IMPORTANT

Due to the technical nature of this kit, Indian Motorcycle® insists this installation be performed by a certified Indian Motorcycle® Technician.

## APPLICATION

Verify accessory fitment at [www.indianmotorcycle.com](http://www.indianmotorcycle.com).

## BEFORE YOU BEGIN

Read these instructions and check to be sure all parts and tools are accounted for. Please retain these installation instructions for future reference and parts ordering information.

## KIT CONTENTS

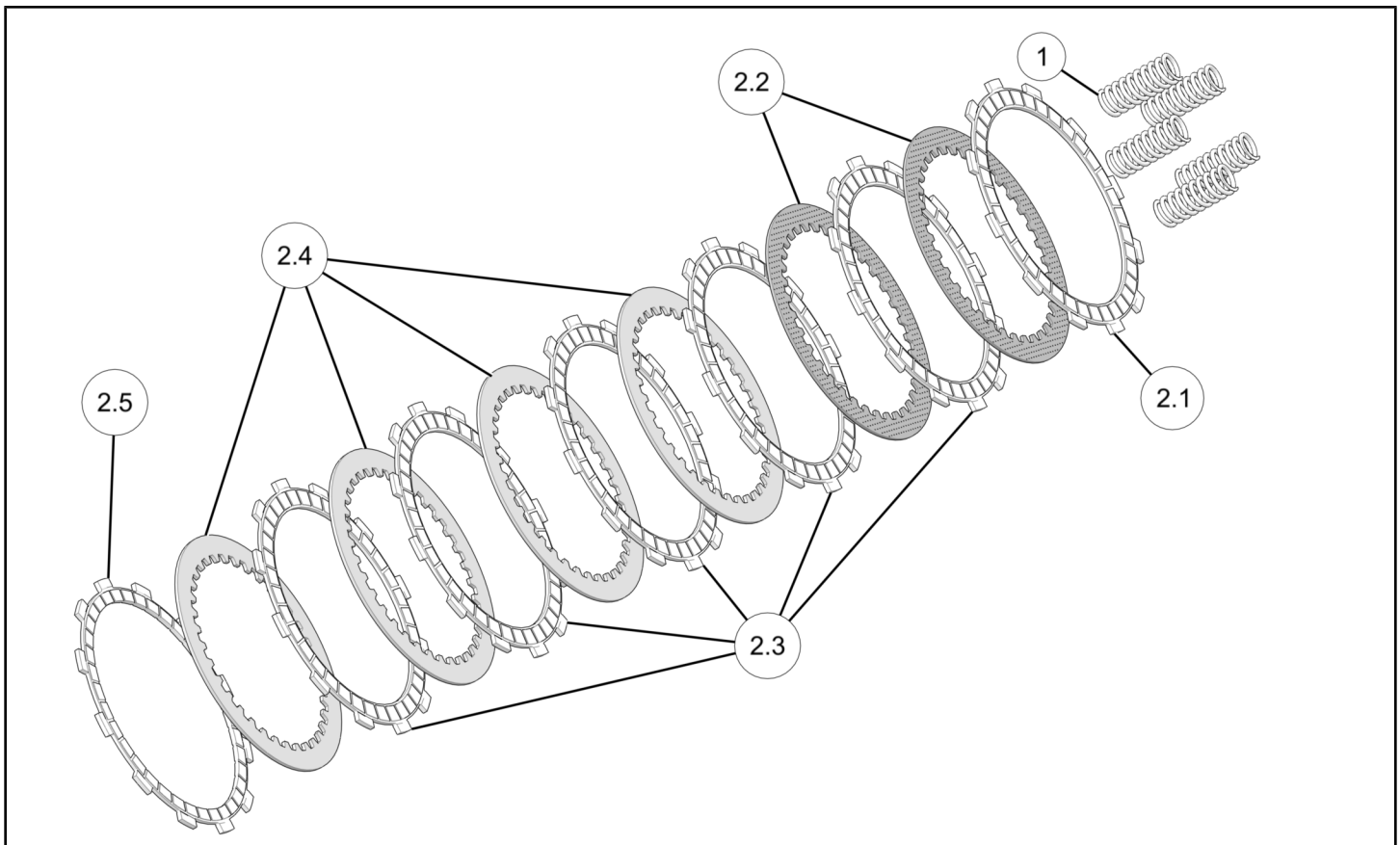

| REF | QTY | PART DESCRIPTION                    | P/N AVAILABLE SEPARATELY |
|-----|-----|-------------------------------------|--------------------------|
| 1   | 5   | Spring, Clutch, 395N                | 7044826                  |
| 2   | 1   | Kit, Clutch Pack                    | 2205282                  |
| 2.1 | 1   | - Friction Plate A                  | 1323056                  |
| 2.2 | 2   | - Separator Plate, With Oil Pockets | 5257903                  |
| 2.3 | 5   | - Friction Plate C                  | 1323105                  |

| REF | QTY | PART DESCRIPTION   | P/N AVAILABLE SEPARATELY |
|-----|-----|--------------------|--------------------------|
| 2.4 | 4   | - Separator Plate  | 5256847                  |
| 2.5 | 1   | - Friction Plate B | 1323057                  |
|     | 1   | Instructions       | 9929256                  |

## TOOLS REQUIRED

- Safety Glasses
- Socket Set, Hex Bit, Metric
- Socket Set, Metric
- Torque Wrench
- Wrench Set, Metric
- Vehicle Lift/Support Equipment

## IMPORTANT

Your Indian Thunder Stroke® Performance Clutch Kit is exclusively designed for your vehicle. Please read the installation instructions thoroughly before beginning. Installation is easier if the vehicle is clean and free of debris. For your safety, and to ensure a satisfactory installation, perform all installation steps correctly in the sequence shown.

## INSTALLATION INSTRUCTIONS

### ACCESSORY INSTALLATION

#### IMPORTANT

Clutch plates will be packaged in the correct order. Make note of and maintain this order.

#### NOTE

The clutch basket does not require removal for installation of this kit.

1. See appropriate vehicle service manual for instructions on clutch kit removal and installation.

## FEEDBACK FORM

A feedback form has been created for the installer to provide any comments, questions or concerns about the installation instructions. The form is viewable on mobile devices by scanning the QR code or by clicking [HERE](#) if viewing on a PC.

#### FEEDBACK FORM

