

LOUVERED HEAT SHIELD KIT



P/N 2883482-XXX

APPLICATION

Verify accessory fitment at www.indianmotorcycle.com.

BEFORE YOU BEGIN

Read these instructions and check to be sure all parts and tools are accounted for. Please retain these installation instructions for future reference and parts ordering information.

KIT CONTENTS

This Kit includes:

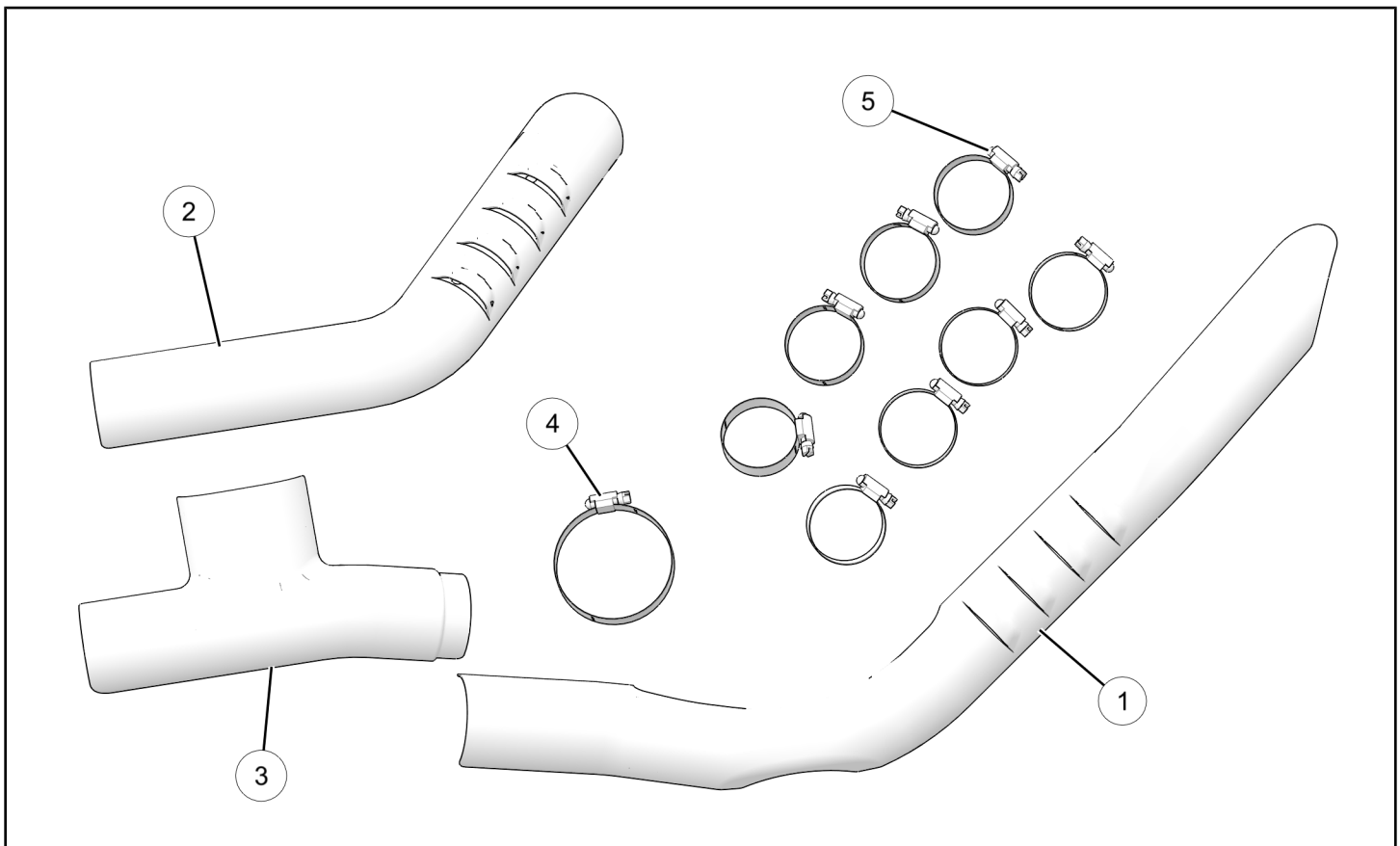

NOTE

XXX = Indian® color code (For example: 266 = Black)

REF	QTY	PART DESCRIPTION	PART NUMBER
1	1	Shield, Exhaust, Front	1263055-XXX
2	1	Shield, Exhaust, Rear Upper	1263238-XXX
3	1	Shield, Exhaust, Rear Lower	1263189-XXX
4	1	Clamp, Hose, 65 mm	7081623
5	8	Clamp, Hose, 56 mm	7082440
	1	Instructions	9928715

TOOLS REQUIRED

- Safety Glasses
- Pliers, Side Cutting
- Screwdriver, Phillips

- Screwdriver, Slotted
- Socket Set, SAE
- Torque Wrench

IMPORTANT

Your Indian Louvered Heat Shield Kit is exclusively designed for your vehicle. Please read the installation instructions thoroughly before beginning. Installation is easier if the vehicle is clean and free of debris. For your safety, and to ensure a satisfactory installation, perform all installation steps correctly in the sequence shown.

ASSEMBLY TIME

Approximately 45 minutes

INSTALLATION INSTRUCTIONS

MOTORCYCLE PREPARATION

1. Turn key or ignition switch to “OFF” position and remove key. If equipped with keyless fob, remove fob from proximity of vehicle.
2. Ensure motorcycle is parked on a flat surface, kickstand is fully extended, and vehicle is stable prior to installation.

REMOVE STOCK SHIELDS

1. Cut three clamps **A** and remove front heat shield **B**.

TIP

Pry clamps away from exhaust pipe using a slotted screwdriver first to help grab clamp with side cutting pliers.

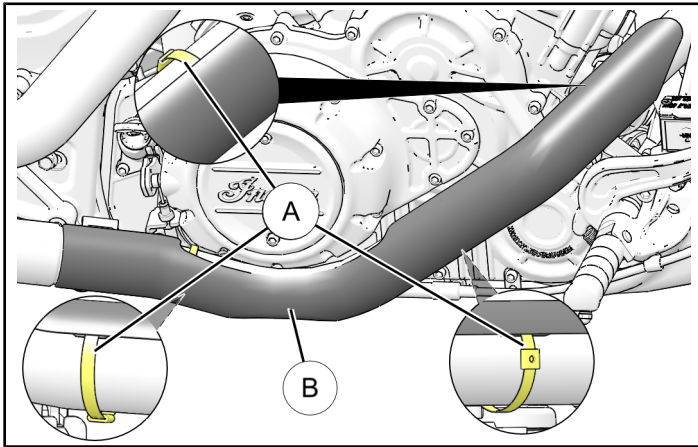

2. Cut two small clamps **C** and one larger clamp **D** and remove rear lower heat shield.

TIP

Pry clamps away from exhaust pipe using a slotted screwdriver first to help grab clamp with side cutting pliers.

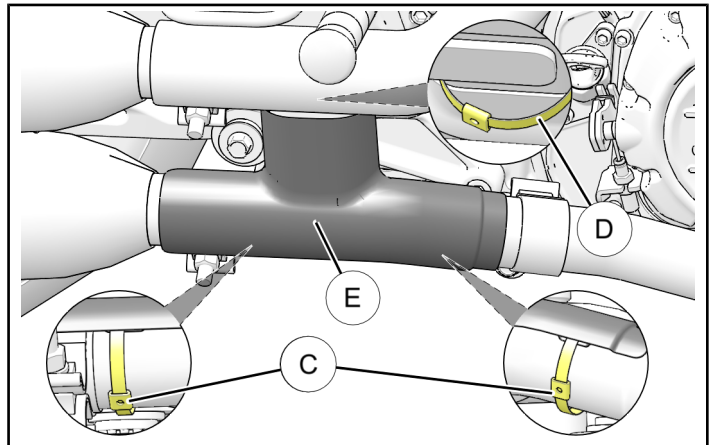

3. Cut three clamps (F) and remove rear upper heat shield (G).

TIP

Pry clamps away from exhaust pipe using a slotted screwdriver to help grab clamp with side cutting pliers.

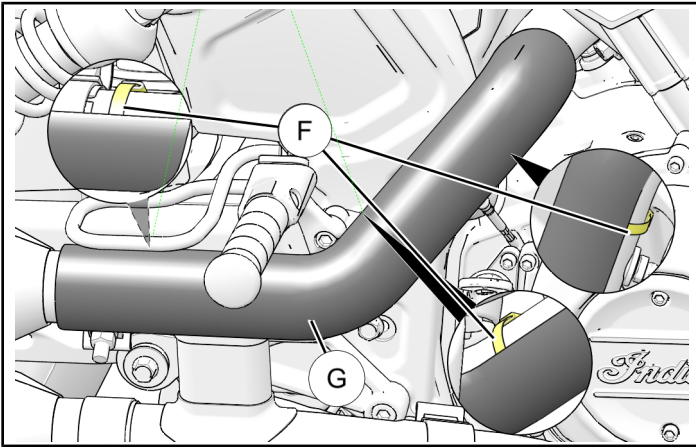

INSERT CLAMPS INTO NEW SHIELDS

Front heat shield (1)

1. Open and insert three small hose clamps (5) into front heat shield (1), oriented as shown.

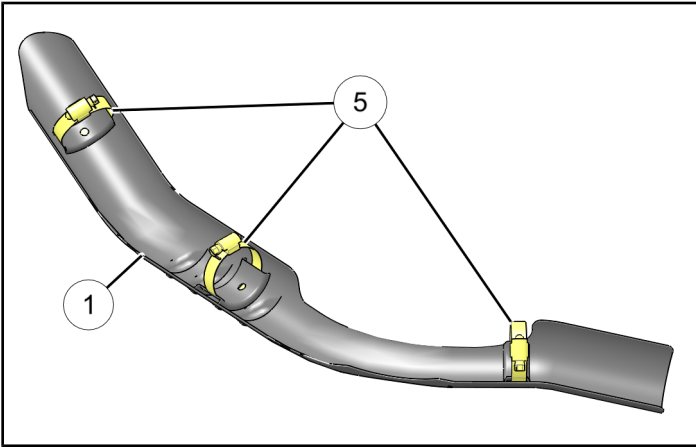

Rear upper heat shield (2)

1. Open and insert three small hose clamps (5) into rear upper heat shield (2), oriented as shown.

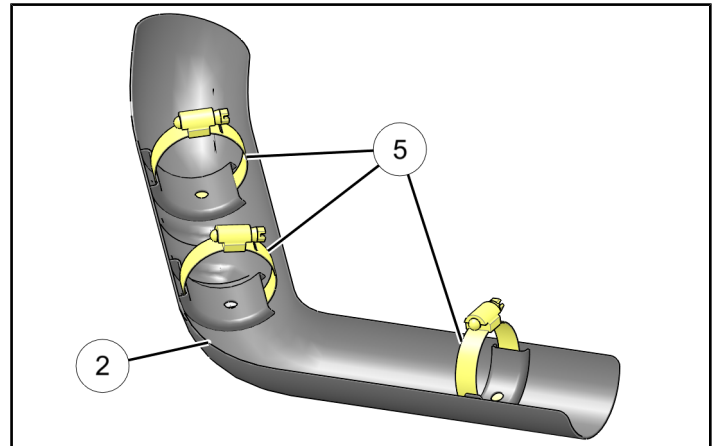

Rear lower heat shield (3)

1. Open and insert two small hose clamps (5) into rear lower heat shield (3), oriented as shown.
2. Open and insert one large hose clamp (4) into large channel, oriented as shown.

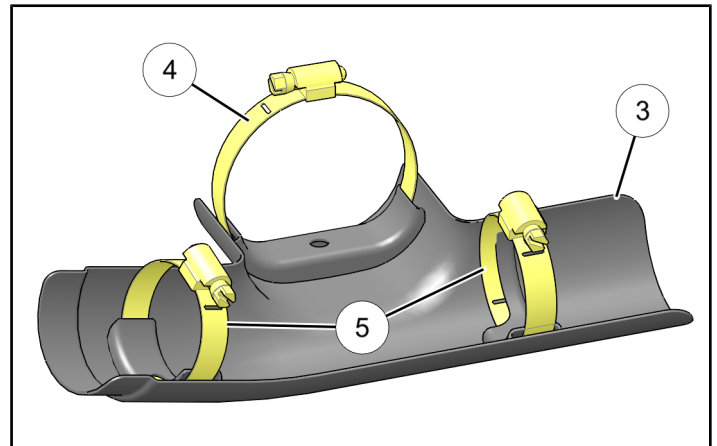

INSTALL HEAT SHIELDS

1. Open clamps far enough to slip them over exhaust pipe and install rear lower heat shield ③ over exhaust pipe. Loosely install hose clamps ④ and ⑤. **DO NOT torque clamps at this time.**

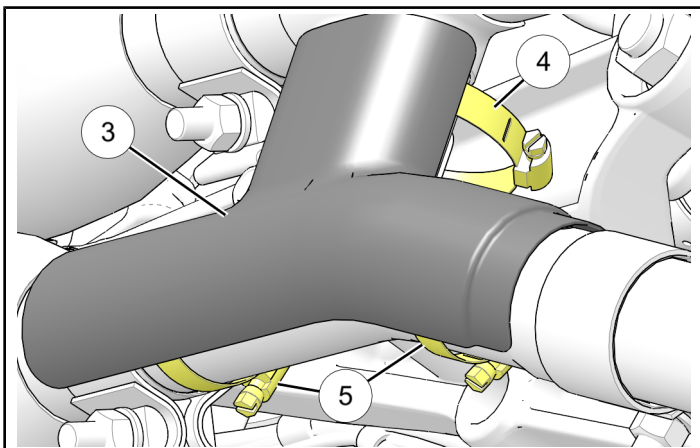

2. Open clamps far enough to slip them over exhaust pipe and install front heat shield ① over exhaust pipe. Loosely install hose clamps ⑤. **DO NOT torque clamps at this time.**

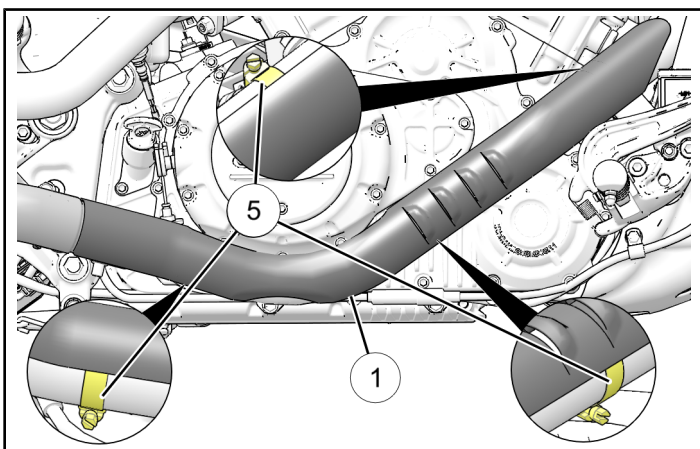

3. Ensure seam between front ① and rear lower ③ heat shield is even and shields are straight. Tighten hose clamps to specification.

TORQUE

27 ± 3 in. lbs. (3 ± 0.3 Nm)

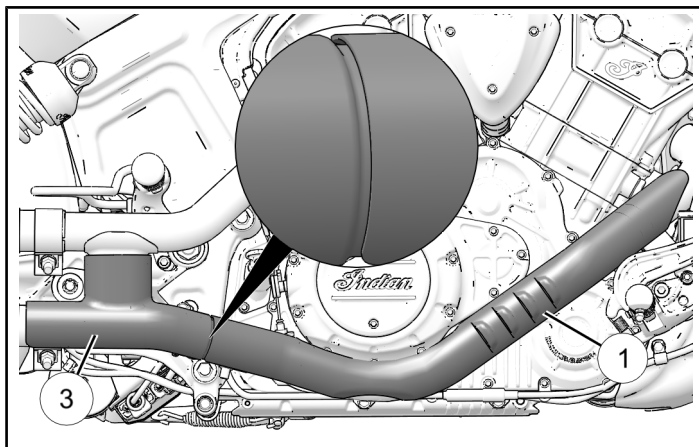

4. Open clamps far enough to slip them over exhaust pipe and install rear upper heat shield ② over exhaust pipe. Adjust heat shield to fit and torque hose clamps ⑤ to specification.

TORQUE

27 ± 3 in. lbs. (3 ± 0.3 Nm)

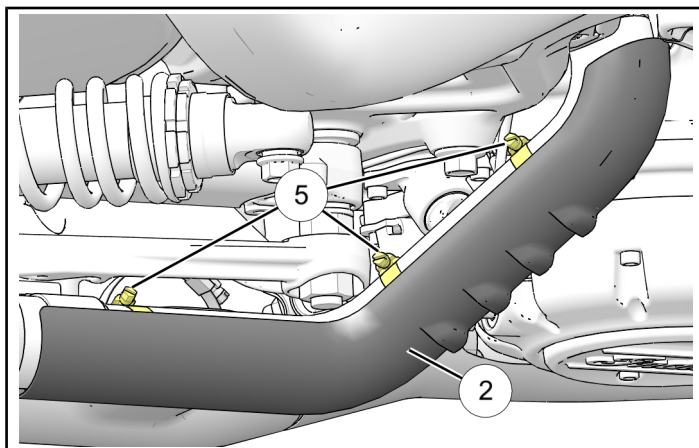

FINAL TORQUING PROCEDURE

After 500 miles of driving, check orientation and re-torque all hose clamps.

TORQUE

27 ± 3 in. lbs. (3 ± 0.3 Nm)

FEEDBACK FORM

A feedback form has been created for the installer to provide any comments, questions or concerns about the installation instructions. The form is viewable on mobile devices by scanning the QR code or by clicking [HERE](#) if viewing on a PC.

