

TOE REST PEGS KIT



P/N 2881848-XXX

APPLICATION

All Indian Motorcycle® Cruiser, Bagger, and Touring models with stock or accessory highway bar installed.

See Kit Contents for compatible accessory highway bars.

Verify accessory fitment at www.indianmotorcycle.com.

BEFORE YOU BEGIN

Read these instructions and check to be sure all parts and tools are accounted for. Please retain these installation instructions for future reference and parts ordering information.

KIT CONTENTS

This kit contains parts for installation of the Foot Rest Kit only. If stock highway bar is not installed, prior installation of one of the following additional kits is also required (sold separately):

- Front Highway Bar Kit, PN 2879581-XXX
- Front Highway Bar Kit For Lower Fairing, PN 2880287-XXX
- Front Highway Bar Kit, PN 2880787-XXX

This Kit includes:

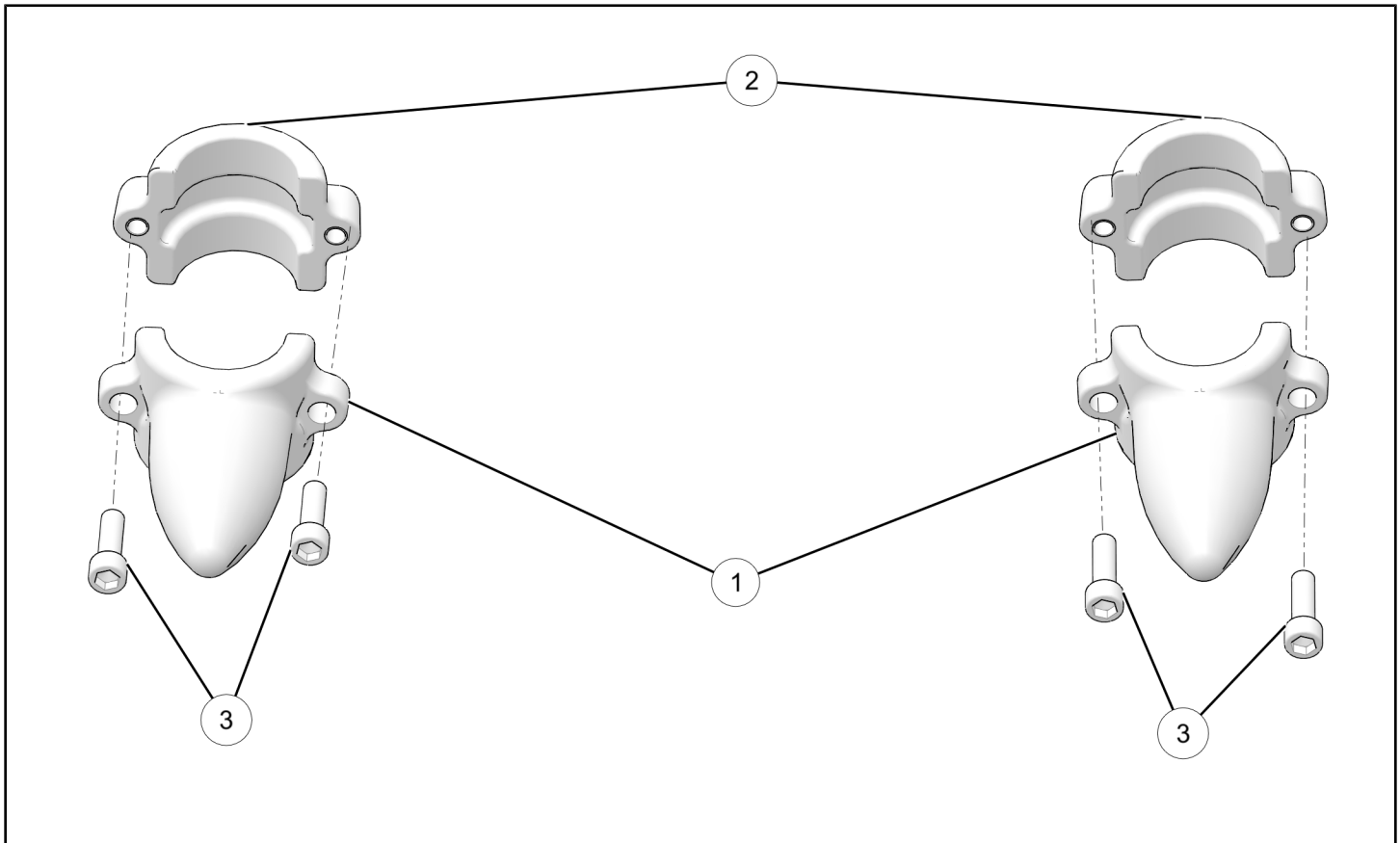

NOTE

XXX = Indian® Color Code (For Example: 266 = Black)

REF	QTY	PART DESCRIPTION	PART NUMBER
1	2	Clamp, Foot Rest	5633617-XXX
2	2	Clamp, Highway	5138668-XXX
3	4	Screw, Socket Head, M6 X 1.0 X 20	7520595
	1	Instructions	9926963

TOOLS REQUIRED

- Torque Wrench
- Socket Set, Hex Bit, Metric

IMPORTANT

Your Indian Toe Rest Pegs Kit is exclusively designed for your vehicle. Please read the installation instructions thoroughly before beginning. Installation is easier if the vehicle is clean and free of debris. For your safety, and to ensure a satisfactory installation, perform all installation steps correctly in the sequence shown.

ASSEMBLY TIME

Approximately 6 minutes

INSTALLATION INSTRUCTIONS

1. Turn key or ignition switch to “OFF” position and remove key. If equipped with keyless fob, remove fob from proximity of vehicle.
2. Ensure motorcycle is parked on a flat surface, kickstand is fully extended, and vehicle is stable prior to installation.
2. Repeat **Previous Step** for opposite side.

FOOT REST INSTALLATION

1. Position foot rests clamps ① and ② at desired height on vertical post of highway bar ④ and rotate 30 degrees towards rear of motorcycle before tightening foot rests with two fasteners ③.

Torque two fasteners ③ to specification.

TORQUE

10 ft. lbs. (13.5 Nm)

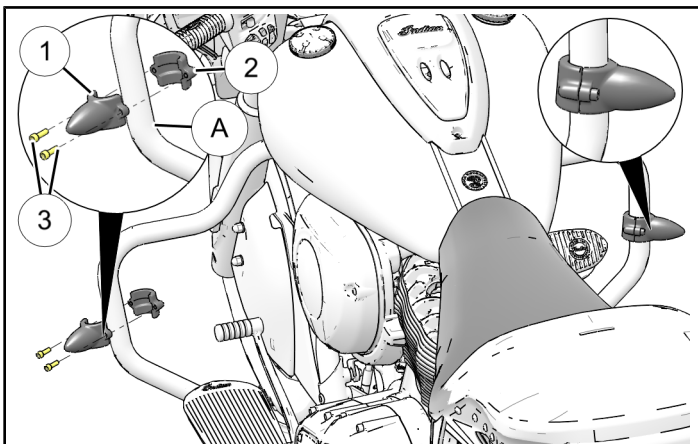

IMPORTANT

Clamps are designed to be installed on vertical posts of highway bar only as to not interfere with vehicle operation.

NOTE

Cycle through all controls and pivot handle bars to ensure Foot Rests do not interfere with control or operation of vehicle.

⚠ WARNING

Interference with control or operation of vehicle while riding may cause bodily harm.

IMPORTANT

Re-torque fasteners after 500 miles (800 km) of riding.

FEEDBACK FORM

A feedback form has been created for the installer to provide any comments, questions or concerns about the installation instructions. The form is viewable on mobile devices by scanning the QR code or by clicking [HERE](#) if viewing on a PC.

FEEDBACK FORM

