

# TOE REST PEGS KIT



P/N 2881848-XXX

## APPLICATION

Verify accessory fitment at [www.indianmotorcycle.com](http://www.indianmotorcycle.com).

## BEFORE YOU BEGIN

Read these instructions and check to be sure all parts and tools are accounted for. Please retain these installation instructions for future reference and parts ordering information.

## REQUIRED SOLD SEPARATELY

Only parts for installation of the Indian Motorcycle® Toe Rest Pegs Kit are included. Prior installation of a highway bar is also required (sold separately).

## KIT CONTENTS

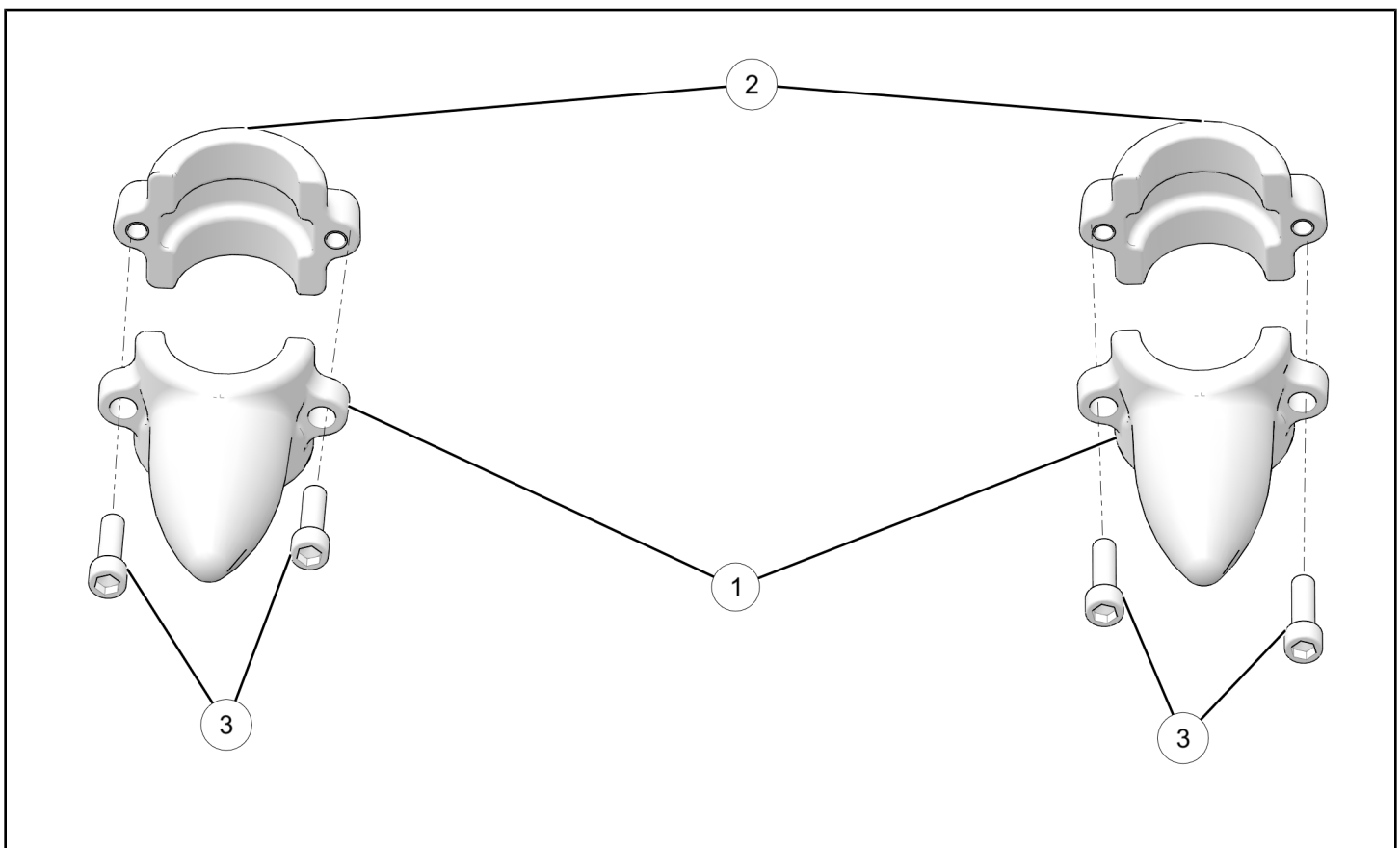

### NOTICE

XXX = Indian® Color Code (For Example: 266 = Black)

REF	QTY	PART DESCRIPTION	P/N AVAILABLE SEPARATELY
1	2	Clamp, Foot Rest	5633617-XXX
2	2	Clamp, Highway	5138668-XXX
3	4	Screw, Socket Head, M6 X 1.0 X 20	7517506

## TOOLS REQUIRED

- Safety Glasses
- Socket Set, Hex Bit, Metric
- Torque Wrench

## IMPORTANT

Your Indian Motorcycle® Toe Rest Pegs Kit is exclusively designed for your vehicle. Please read the installation instructions thoroughly before beginning. Installation is easier if the vehicle is clean and free of debris. For your safety, and to ensure a satisfactory installation, perform all installation steps correctly in the sequence shown.

## INSTALLATION INSTRUCTIONS

### IMPORTANT

Clamps are designed to be installed on vertical posts of highway bar only as to not interfere with vehicle operation.

### NOTICE

Cycle through all controls and pivot handle bars to ensure Foot Rests do not interfere with control or operation of vehicle.

### IMPORTANT

Re-torque fasteners after 500 miles (800 km) of riding.

## VEHICLE PREPARATION

### GENERAL

1. Turn key or ignition switch to OFF position and remove key. If equipped with keyless fob, remove fob from proximity of vehicle.
2. Ensure motorcycle is parked on a flat surface, kickstand is fully extended, and vehicle is stable prior to installation.

## FEEDBACK FORM

A feedback form has been created for the installer to provide any comments, questions or concerns about the installation instructions. The form is viewable on mobile devices by scanning the QR code or by clicking [HERE](#) if viewing on a PC.

## ACCESSORY INSTALLATION

### NOTICE

Left toe rest peg show; right peg similar.

1. Loosely install foot rests clamps ① and ② on highway bar's vertical post with two clamp fasteners ③. Rotate peg assembly 30° towards rear of motorcycle and ensure peg assembly is at desired height before tightening two fasteners ③ to specification.

### TORQUE

Clamp Fasteners ③:  
**10 ft-lbs (13.5 N·m)**

