

SCOUT GRIP KIT



P/N MULTIPLE

APPLICATION

Verify accessory fitment at www.indianmotorcycle.com.

BEFORE YOU BEGIN

Read these instructions and check to be sure all parts and tools are accounted for. Please retain these installation instructions for future reference and parts ordering information.

REQUIRED SOLD SEPARATELY

Only parts for installation of the Indian Motorcycle® Scout Grip Kit are included. Purchase of additional adhesive is also required (sold separately):

- Loctite® 496 Instant Adhesive

KIT CONTENTS

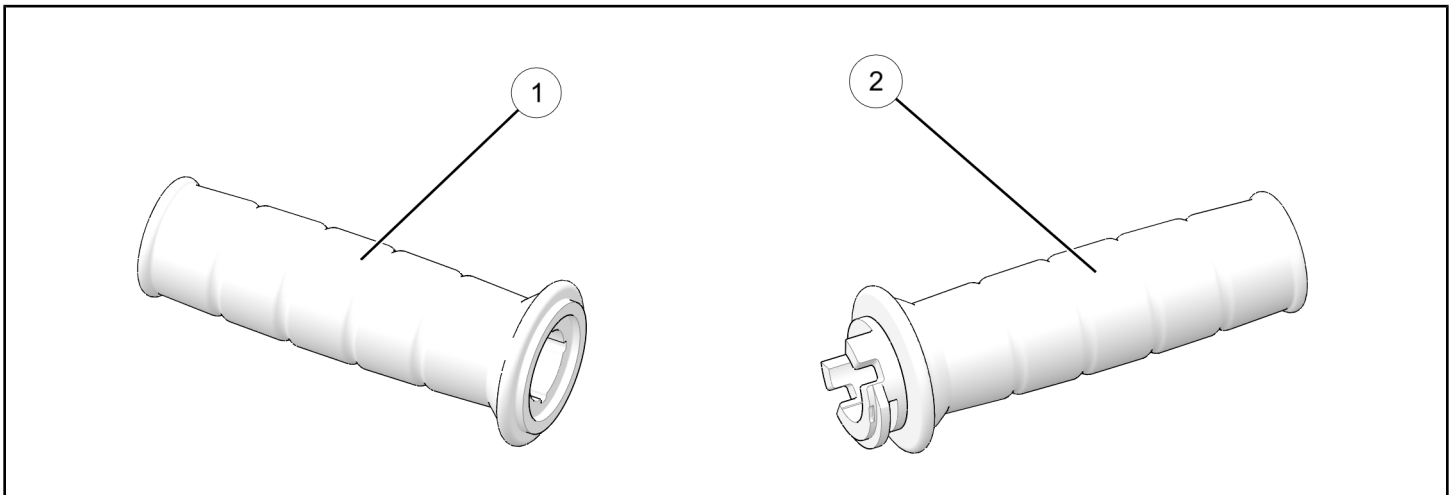

REF	QTY	PART DESCRIPTION
1	1	Grip, LH
2	1	Grip, RH

TOOLS REQUIRED

- Safety Glasses
- Screwdriver, Slotted
- Wrench, Strap
- Socket Set, Torx® Bit
- Torque Wrench

CONSUMABLES REQUIRED

- Adhesive Solvent

IMPORTANT

Your Indian Motorcycle® Scout Grip Kit is exclusively designed for your vehicle. Please read the installation instructions thoroughly before beginning. Installation is easier if the vehicle is clean and free of debris. For your safety, and to ensure a satisfactory installation, perform all installation steps correctly in the sequence shown.

INSTALLATION INSTRUCTIONS

VEHICLE PREPARATION

1. Turn key to "OFF" position and remove from vehicle.
2. Ensure motorcycle is parked on a flat surface, kickstand is fully extended, and vehicle is stable prior to installation.

REMOVE STOCK LEFT GRIP

1. On front side of left grip, remove and retain two screws (A) and remove switch housing (B). Retain all parts for reinstallation.

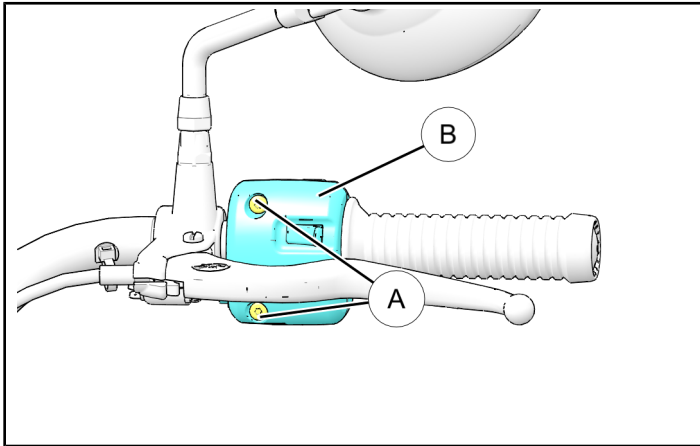

⚠ WARNING

Follow all chemical manufacturer instructions and safety precautions. Failure to follow all manufacturer instructions and precautions may result in severe injury or death.

2. Remove left grip (C) by gently inserting a slotted screwdriver between grip and handlebar to release adhesive. Adding a small amount of adhesive solvent will help loosen adhesive.

NOTE

Be careful not to get solvent on any painted surfaces.

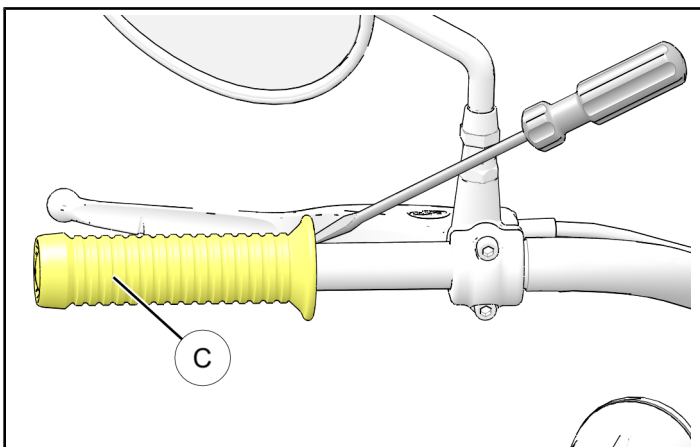

3. Firmly grasp left grip (C) and remove it from handlebar.

NOTE

Strap wrench or compressed air can be used to assist in removal.

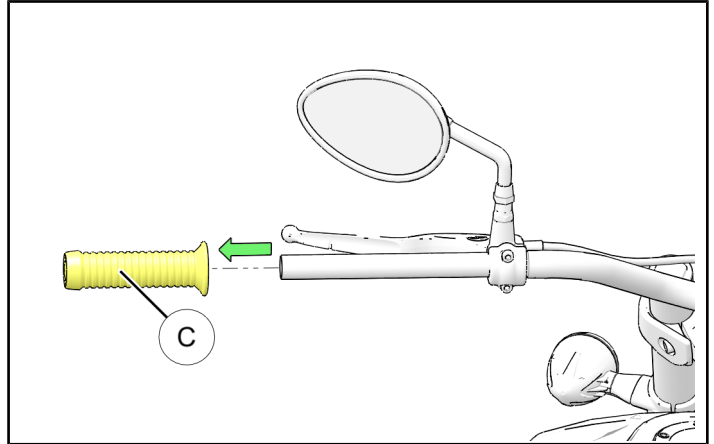

4. Remove any adhesive residue or grip material from handlebar.

INSTALL NEW LEFT GRIP

1. Reinstall switch housing (B) and torque screws (A) to specification

TORQUE

Switch housing screws (A):
36 in-lbs (4 N·m)

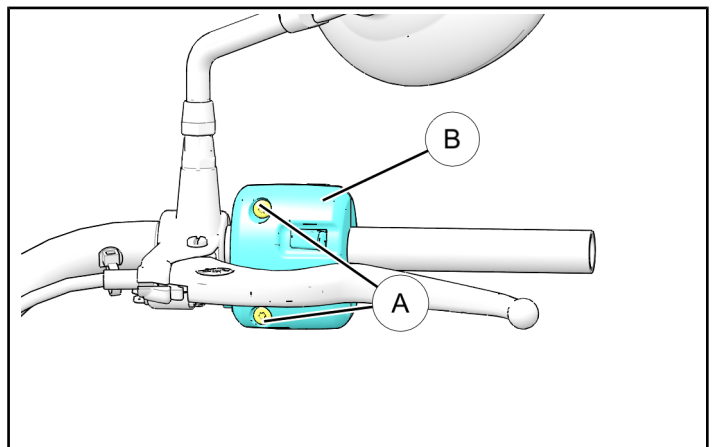

- Apply Loctite[®] 496 adhesive ③ to handlebar end covering as much as possible and distributing adhesive evenly. Quickly force left grip ① onto handlebar until grip bottoms out against handlebar end. Quickly rotate grip to desired rotation before adhesive sets.

⚠ WARNING

Failure to use required Loctite[®] 496 may result in inadequate adhesion between grip and handlebar, resulting in a loose grip, which may cause loss of control, resulting in injury or death.

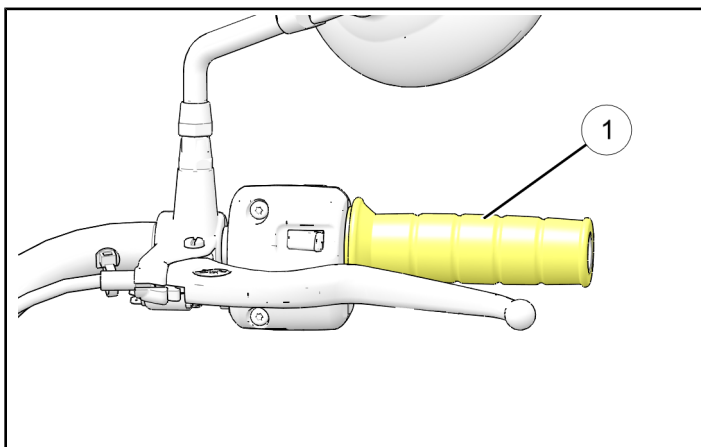

REMOVE STOCK RIGHT GRIP

- On front side of right grip, remove and retain four screws ④, and remove back side of switch housing ⑤.

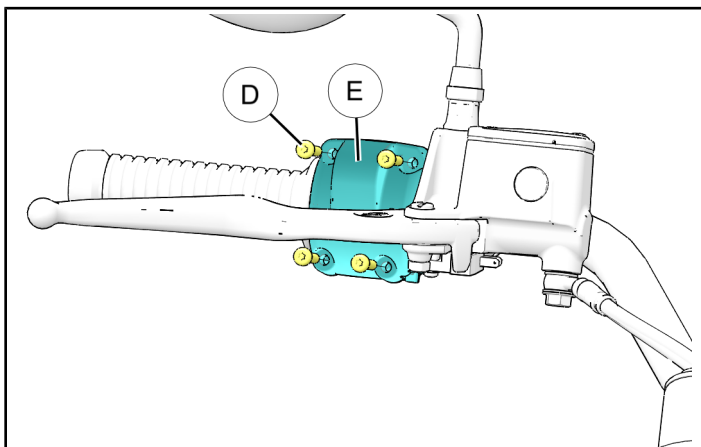

- Separate right switch housing halves and slide right grip and throttle tube ⑥ off handlebar.

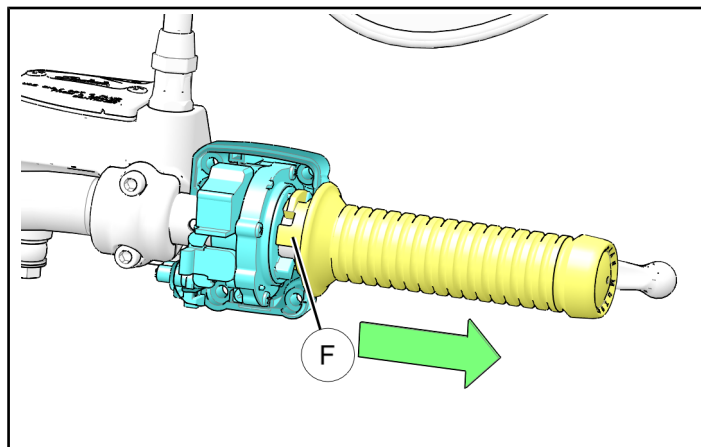

INSTALL NEW RIGHT GRIP

- Install new Right grip ② on handlebar. Ensure slots in throttle tube ⑥ line up to throttle housing.

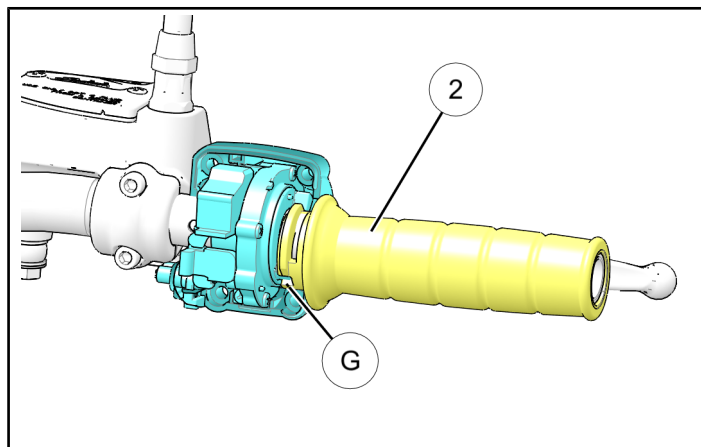

- Reinstall back side of switch housing ⑤ and four screws ④. Torque screws to specification.

TORQUE

Switch Cube Screws ④:
36 in-lbs (4 N·m)

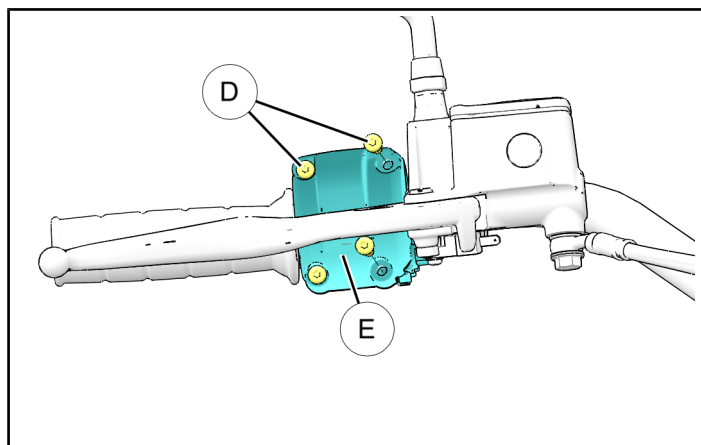

3. Cycle throttle after reassembly to confirm it moves freely and does not bind.

IMPORTANT

Allow motorcycle to sit for a period of 24 hours to allow glue to dry and set properly.

FEEDBACK FORM

A feedback form has been created for the installer to provide any comments, questions or concerns about the installation instructions. The form is viewable on mobile devices by scanning the QR code or by clicking [HERE](#) if viewing on a PC.

