

# HARD LOWER FAIRING KIT



**P/N 2883984-XXX**

## APPLICATION

Verify accessory fitment at [www.indianmotorcycle.com](http://www.indianmotorcycle.com).

## BEFORE YOU BEGIN

Read these instructions and check to be sure all parts and tools are accounted for. Please retain these installation instructions for future reference and parts ordering information.

## REQUIRED SOLD SEPARATELY

The Indian Hard Lower Fairing Kit contains parts for installation of the Indian Hard Lower Fairing Kit only. Prior installation of the following additional kits is also required (sold separately):

- Highway Bar Kit, PN 2884063-XXX,

## KIT CONTENTS

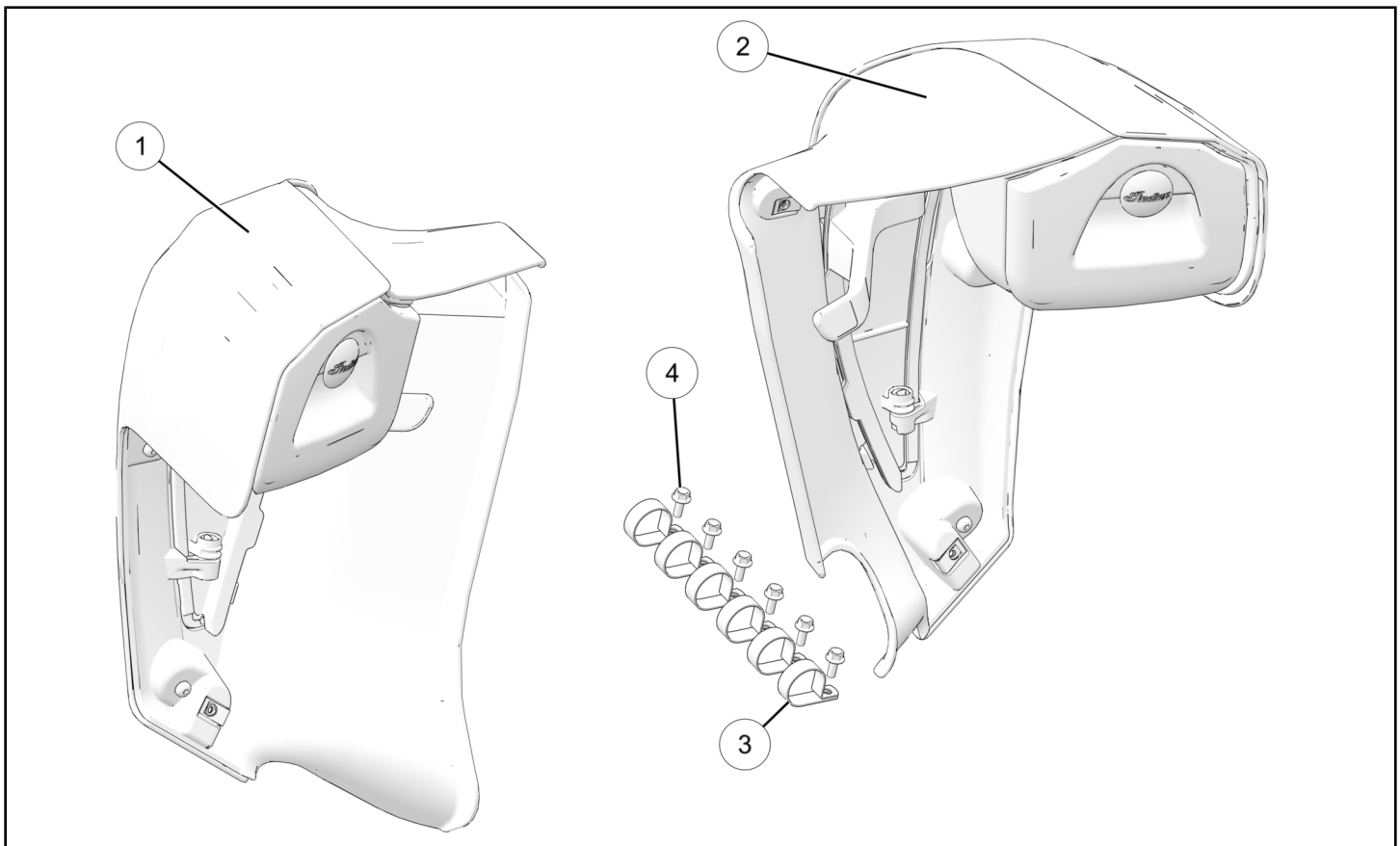

### NOTE

XXX = Indian Motorcycle® color code (For example: 266 = Black)

### NOTE

Contact your **Authorized Indian Motorcycle® Dealer** for serviceable parts not identified in following table.

REF	QTY	PART DESCRIPTION	P/N AVAILABLE SEPARATELY
1	1	Assembly, Lower Fairing, LH	2637256-XXX
2	1	Assembly, Lower Fairing, RH	2637257-XXX
3	6	Clamp, Hose	7080807
4	6	Screw, Hex Flange Head, M6 X 1.0 X 16	7518591
	1	Instructions	9929365

## TOOLS REQUIRED

- Safety Glasses
- Socket Set, Metric
- Torque Wrench

## IMPORTANT

Your Indian Hard Lower Fairing Kit is exclusively designed for your vehicle. Please read the installation instructions thoroughly before beginning. Installation is easier if the vehicle is clean and free of debris. For your safety, and to ensure a satisfactory installation, perform all installation steps correctly in the sequence shown.

## INSTALLATION INSTRUCTIONS

### VEHICLE PREPARATION

#### GENERAL

1. Turn key or ignition switch to “OFF” position and remove key. If equipped with keyless fob, remove fob from proximity of vehicle.
2. Ensure motorcycle is parked on a flat surface, kickstand is fully extended, and vehicle is stable prior to installation.

### ACCESSORY INSTALLATION

1. Install three hose clamps ③ onto RH highway bar ① in orientation shown.

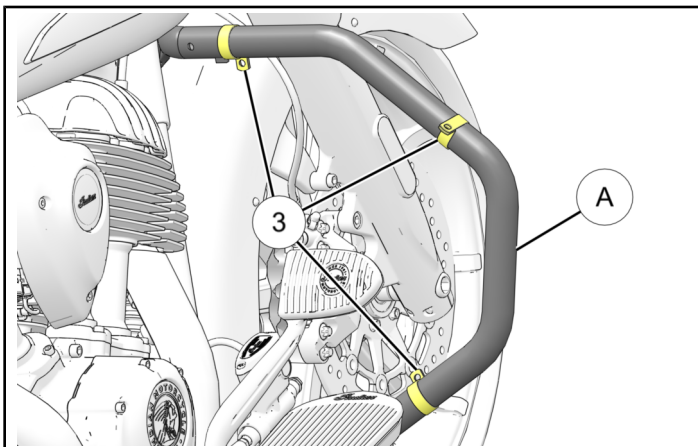

2. Loosely thread three screws ④ into RH lower fairing ②. **DO NOT** tighten screws at this time.

#### TIP

Have a second person hold fairing up to highway bar while you thread in screws.

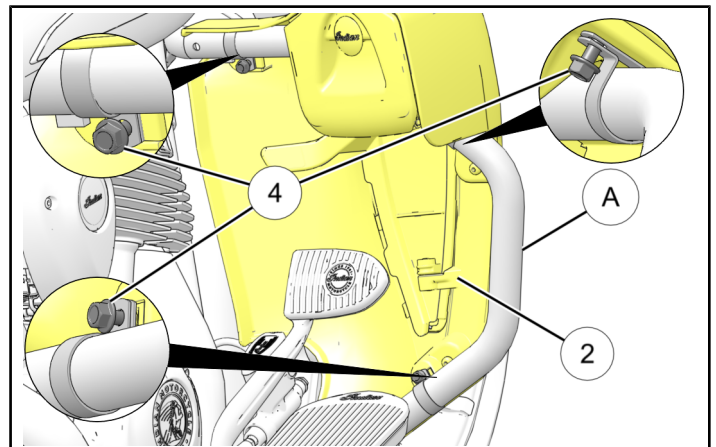

3. Ensure clamps are aligned on highway bar and torque each screw ④ to specification using the sequence shown..

4. Repeat procedure for LH lower fairing ①.

**TORQUE**

36 in. lbs. (4 Nm)

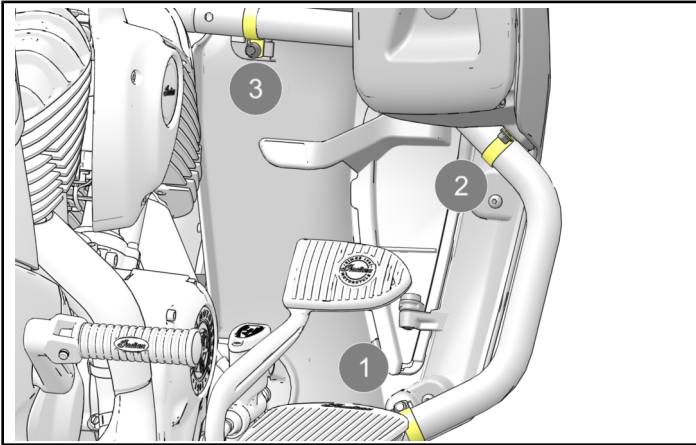

**FEEDBACK FORM**

A feedback form has been created for the installer to provide any comments, questions or concerns about the installation instructions. The form is viewable on mobile devices by scanning the QR code or by clicking [HERE](#) if viewing on a PC.

**FEEDBACK FORM**

