

WINDSHIELD/WIND-DEFLECTOR KIT



P/N MULTIPLE; SEE KIT CONTENTS FOR DETAILS

APPLICATION

2014 and newer Indian® Non-Fairing Motorcycles with the Thunderstroke® 111.

BEFORE YOU BEGIN

Read these instructions and check to be sure all parts and tools are accounted for. Please retain these installation instructions for future reference and parts ordering information.

KIT CONTENTS

Full installation of this kit may also require additional parts (sold separately). See table on page 2 for details:

This Kit includes:

NOTE

Kit PN 2880915 shown; Other kits similar except as noted in table on page 2.

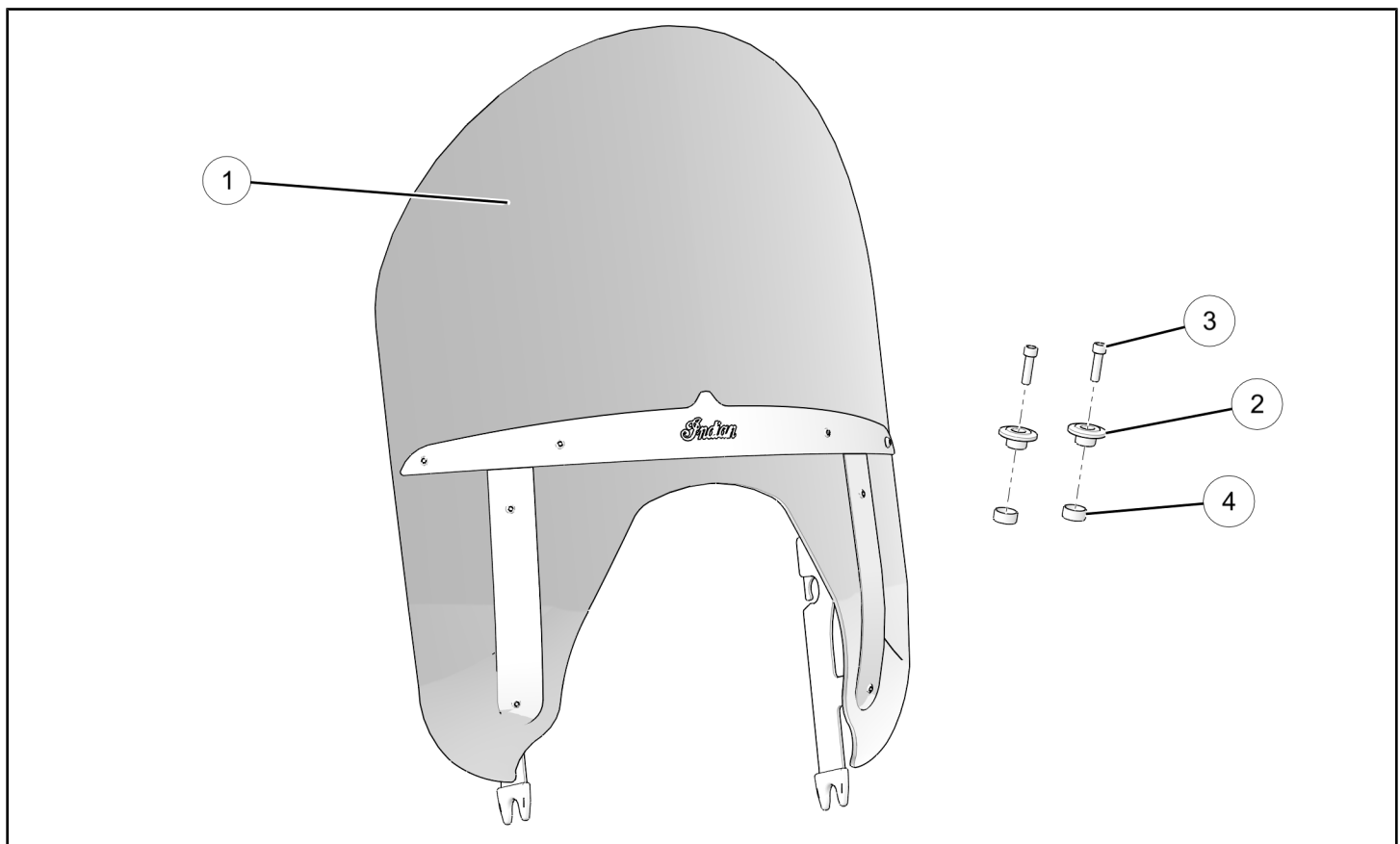

| REF | QTY | PART DESCRIPTION | PART NUMBER |
|-----|-----|--|-------------|
| 1 | 1 | Windshield/Wind-Deflector, Cruiser, Low, Clear, (Kit P/N 2879574-01)** Windshield/Wind-Deflector, Cruiser, Low, Tinted, (Kit P/N 2879574-02)** Windshield/Wind-Deflector, Cruiser, Mid, (Kit P/N 2879575)* Windshield/Wind-Deflector, Cruiser, Tall, (Kit P/N 2879576)* Windshield/Wind-Deflector, Cruiser, Super-low, (Kit P/N 2880724)* Windshield/Wind-Deflector, Cruiser, Low, Smoke/Black, (Kit P/N 2880725)* Windshield/Wind-Deflector, Cruiser, Mid, (Kit P/N 2880761)* Windshield/Wind-Deflector, Springfield, Tall, (Kit P/N 2880915)* Windshield/Wind-Deflector, Springfield, Low, (Kit P/N 2880916)* Windshield/Wind-Deflector, Springfield, Mid, (Kit P/N 2881943)* Windshield/Wind-Deflector, Cruiser, Flare, Tinted, (Kit P/N 2882220)* * Windshield/Wind-Deflector, Springfield, Flare, Tinted (Kit P/N 2882221)* | - |
| 2 | 2 | Bushing, Cruiser Windshield/Wind Deflector | 5138827 |
| 3 | 2 | Screw, Socket Head, M8 X 1.25 X 30 | 7520004 |
| 4 | 2 | Spacer, Upper, Cruiser Windshield/Wind-Deflector | 5139763 |
| | 1 | Instructions | 9924354 |

*Top Mounted Spool Kit (PN 2881476), Sold Separately, required for motorcycles **without** factory Windshield/Wind-Deflector.

**Top Mounted Spool Kit (PN 2881476) Included with Windshield/Wind-Deflector Kit.

TOOLS REQUIRED

- Safety Glasses
- Socket Set, Hex Bit, Metric
- Torque Wrench

IMPORTANT

Your Indian Windshield/Wind-Deflector Kit is exclusively designed for your vehicle. Please read the installation instructions thoroughly before beginning. Installation is easier if the vehicle is clean and free of debris. For your safety, and to ensure a satisfactory installation, perform all installation steps correctly in the sequence shown.

ASSEMBLY TIME

Approximately 6 minutes

INSTALLATION INSTRUCTIONS

1. Turn ignition switch to "OFF" position and remove keyless fob from proximity of vehicle.
2. Ensure motorcycle is parked on a flat surface, kickstand is fully extended, and vehicle is stable prior to installation.

NOTE

Protect all finished surfaces during these operations.

SPACER INSTALLATION (FOR MOTORCYCLES WITHOUT FACTORY INSTALLED WINDSHIELD/WIND-DEFLECTOR)

Removal

1. Remove and discard one screw (A) and one washer (B) from each side of nacelle as shown.

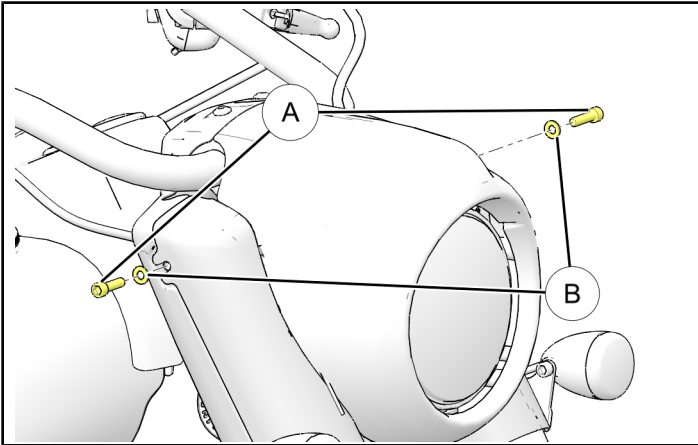

Installation

1. Install new spacer (4), bushing (2), and screw (3) as shown. Torque screws (3) to specification.

TORQUE

18 ft. lbs. (24 Nm)

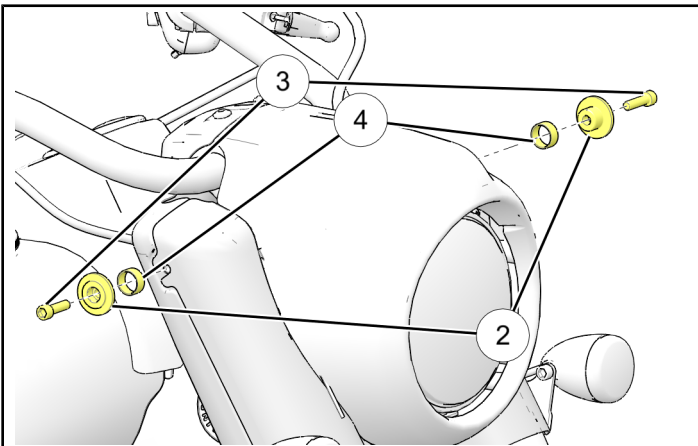

WINDSHIELD/WIND-DEFLECTOR REMOVAL (IF REPLACING FACTORY WINDSHIELD/WIND-DEFLECTOR)

1. Locate and open upper locking tabs (C). Stand in front of vehicle. Hold sides of windshield/wind-deflector and pull outward to disengage top mounts from top mounting bushings.

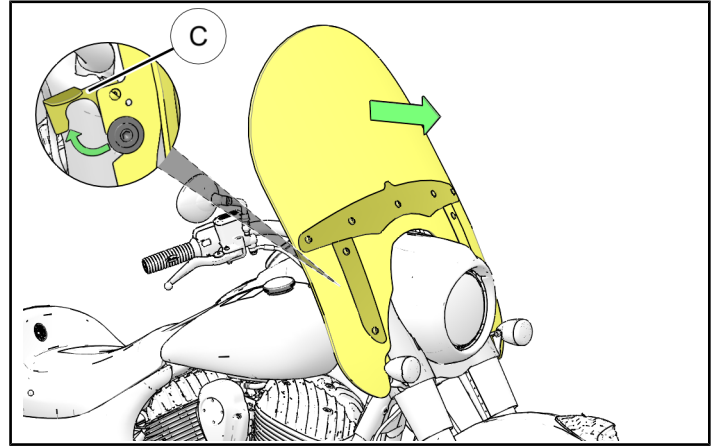

2. Lift windshield/wind-deflector straight up off lower bushings and off motorcycle.

WINDSHIELD/WIND-DEFLECTOR INSTALLATION

CAUTION

Polycarbonate (Plastic) is easily scratched. Protect during installation.

1. Set lower mounts (D) of windshield (1) onto lower bushings (E) and press into place. Open two upper locking tabs (F) and press upper mounts (G) onto upper bushings (2).

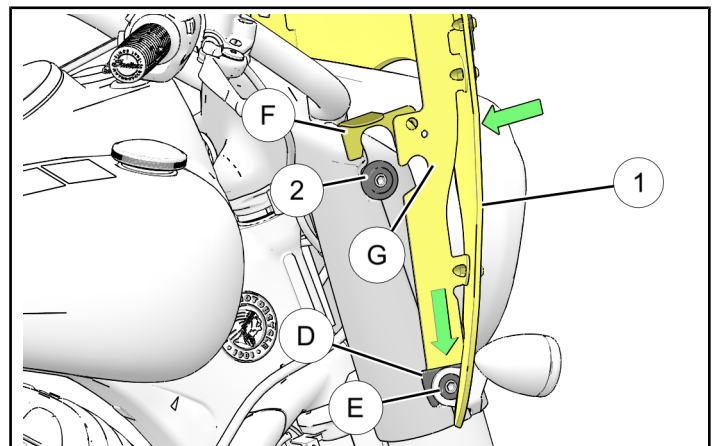

2. Close locking tabs **F** on upper mounts.

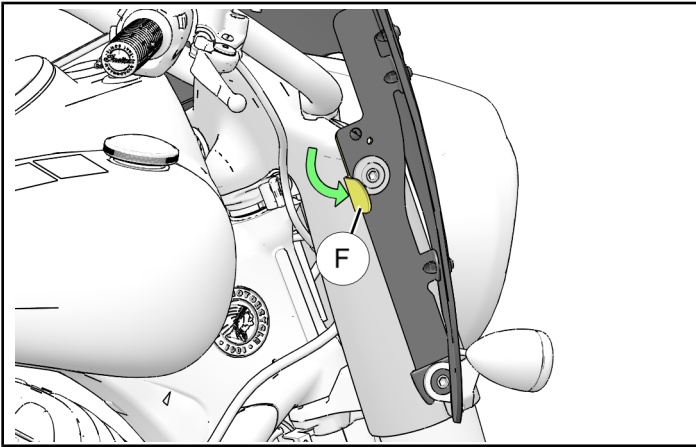

CAUTION
Do NOT use glass cleaner, water or soil repellents, petroleum or alcohol based cleaners as the product can damage the polycarbonate (plastic) material.

3. Optional: Add M6 screws **H** (not included) through locking tabs for theft deterrence.

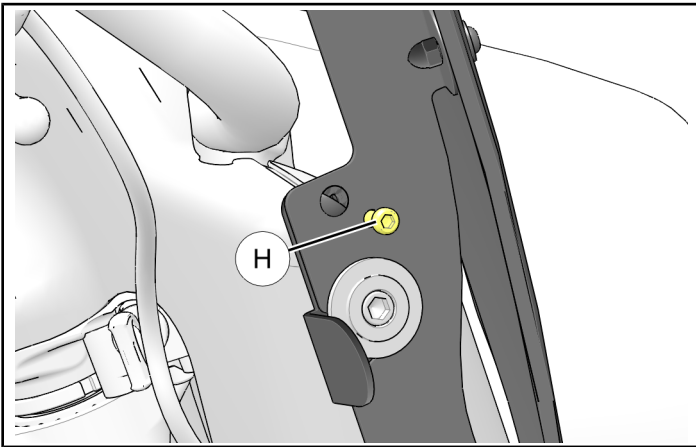

FEEDBACK FORM

A feedback form has been created for the installer to provide any comments, questions or concerns about the installation instructions. The form is viewable on mobile devices by scanning the QR code or by clicking [HERE](#) if viewing on a PC.

