

CRUISER WIND DEFLECTOR KIT



KIT P/N 2880724

APPLICATION

2014-2016 INDIAN CRUISER MOTORCYCLES WITH THE THUNDERSTROKE 111

BEFORE YOU BEGIN

Read these instructions and check to be sure all parts and tools are accounted for. Please retain these installation instructions for future reference and parts ordering information.

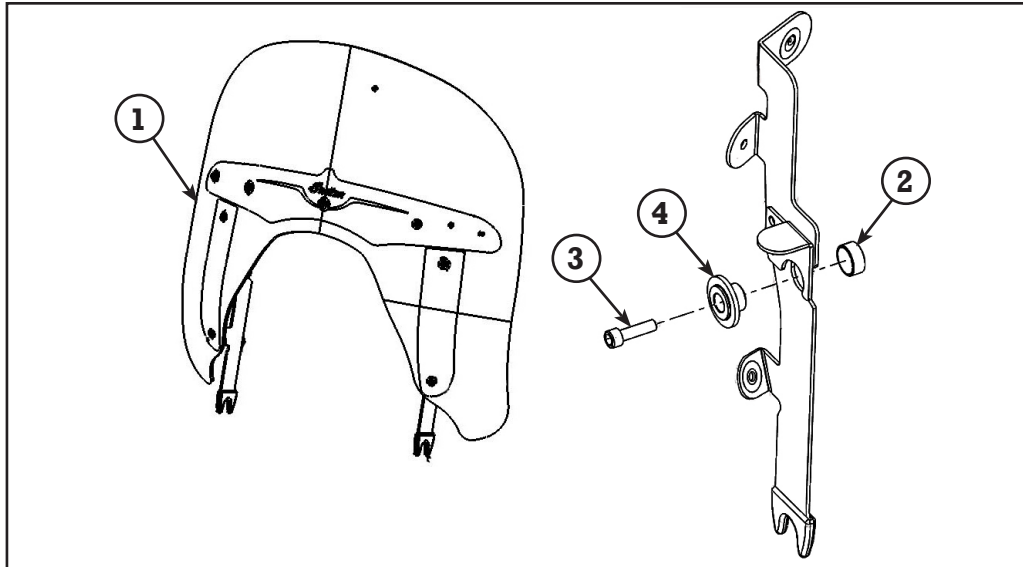

KIT CONTENTS

Ref	Qty	Part Description	Part Number
1	1	Cruiser Wind Deflector	2880724
2	2	Bushing, Windshield	5138827
3	2	Screw-M8X1.25X30 10.9 ZPB	7520004
4	2	Spacer	5139763-463
	1	Instructions	9925914

TOOLS NEEDED

Protective Cloth

Motorcycles without Top Mounting Spacer for Windscreen:

Torque Wrench Socket Wrench Hex Socket

APPROXIMATE ASSEMBLY TIME

10 min

IMPORTANT

Your Indian CRUISER WIND DEFLECTOR KIT is exclusively designed for your vehicle. Please read the installation instructions thoroughly before beginning. Installation is easier if the vehicle is clean and free of debris. For your safety, and to ensure a satisfactory installation, perform all installation steps correctly in the sequence shown.

INSTALLATION INSTRUCTIONS

INSTALLATION INSTRUCTIONS FOR DARK LOW WINDSHIELD

Removal

1. Remove screws (A) and washers from both sides of top of the nacelle.

Installation

1. Install new spacer (B) with bushing (C) using included screws (D).
2. Torque to 18 ft. lbs. (24.4 Nm).

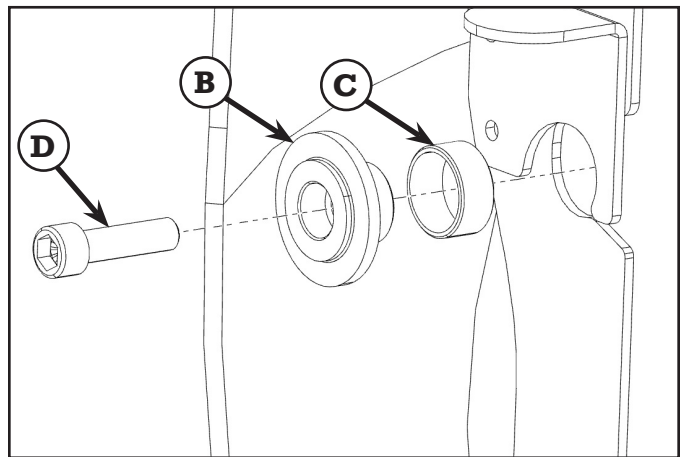
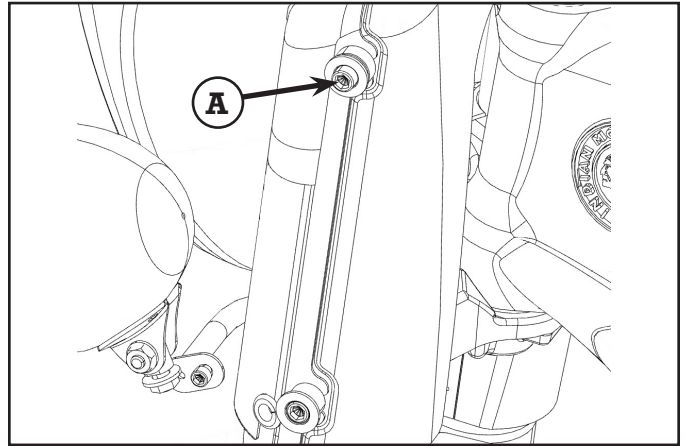

INSTALLATION INSTRUCTIONS FOR ALL MY14, MY15 INDIAN CRUISER MOTORCYCLES

NOTE: Protect all finished surfaces during these operations.

Removal

1. If installing a replacement accessory wind deflector, remove wind deflector by locating and opening upper locking tabs. While holding on the sides of the wind deflector and standing in front of the vehicle, pull a short distance until the top mounts disengage from the top two mounting spools. Lift straight up to disengage the lower wind deflector mounts from the lower spools.

Installation

1. While holding the sides of the wind deflector and standing in front of the vehicle, locate and place the lower mounts of the wind deflector over the lower mounting spools on the front suspension.
2. Open the two upper locking tabs.
3. Rotate the wind deflector about the lower spools until the upper wind deflector mount snaps into place over the upper mounting spools on the front suspension.
4. Close the upper locking tabs until they lock into place.
5. Optional: Add M6 screws through locking tabs for theft deterrence.

CAUTION: Do not use glass cleaner, water or soil repellents, petroleum or alcohol based cleaners as the product can damage the lexan (plastic) material.

CAUTION: The lexan plastic is easily scratched. Protect during installation.