

# SCOUT® BOBBER PASSENGER SEAT KIT



**P/N 2882853, 2883055**

## APPLICATION

2018 Indian® Scout® Bobber

## BEFORE YOU BEGIN

Read these instructions and check to be sure all parts and tools are accounted for. Please retain these installation instructions for future reference and parts ordering information.

## KIT CONTENTS

Kit 2882853 includes:

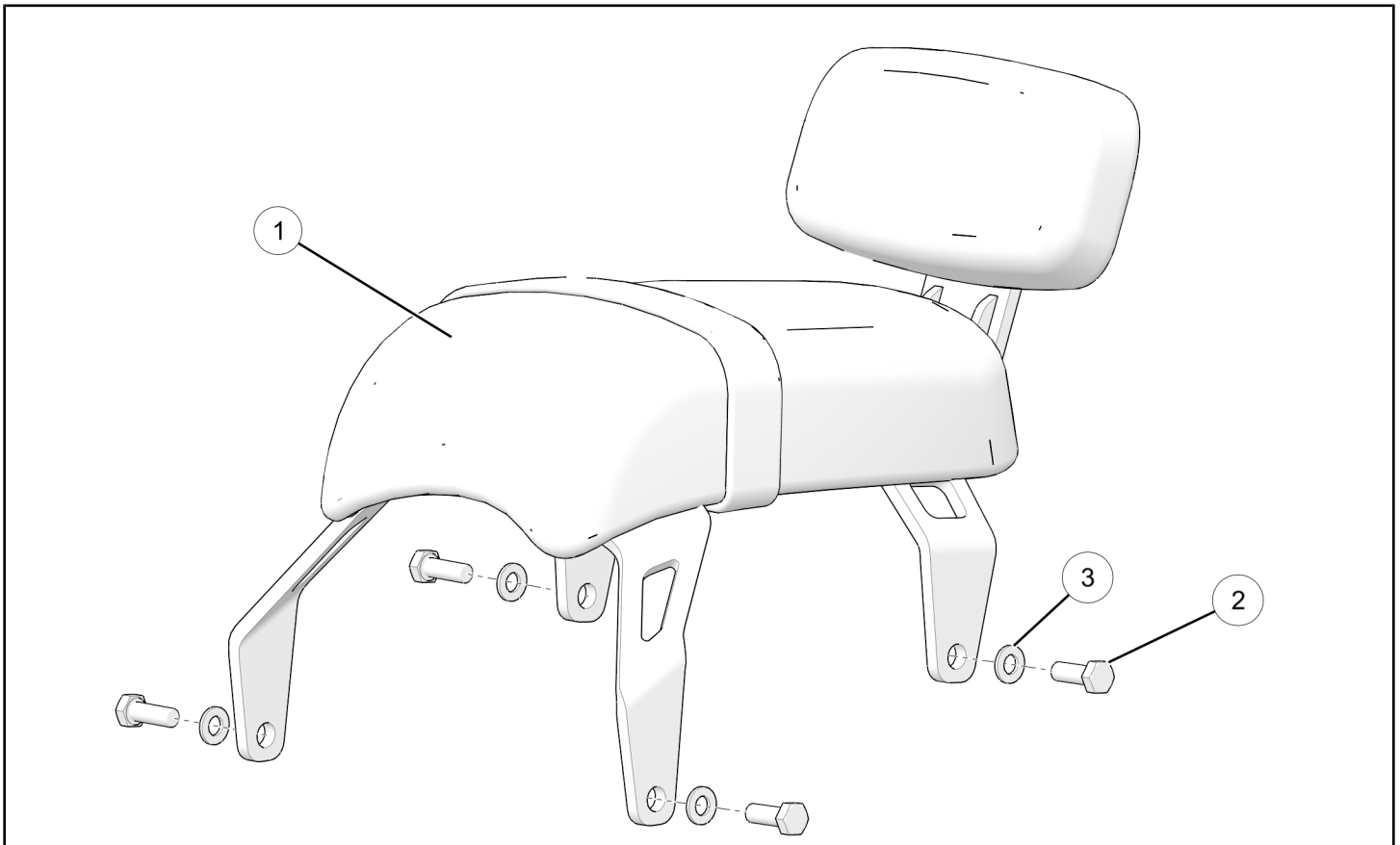

REF	QTY	PART DESCRIPTION	PART NUMBER
1	1	Assembly, Seat, Passenger, With Backrest	2687820
2	4	Screw, Hex Head, M8 X 1.25 X 22	7520743
3	4	Washer, 8.4 X 16.0 X 1.6	7556305
	1	Instructions	9925881

Kit 2883055 includes:

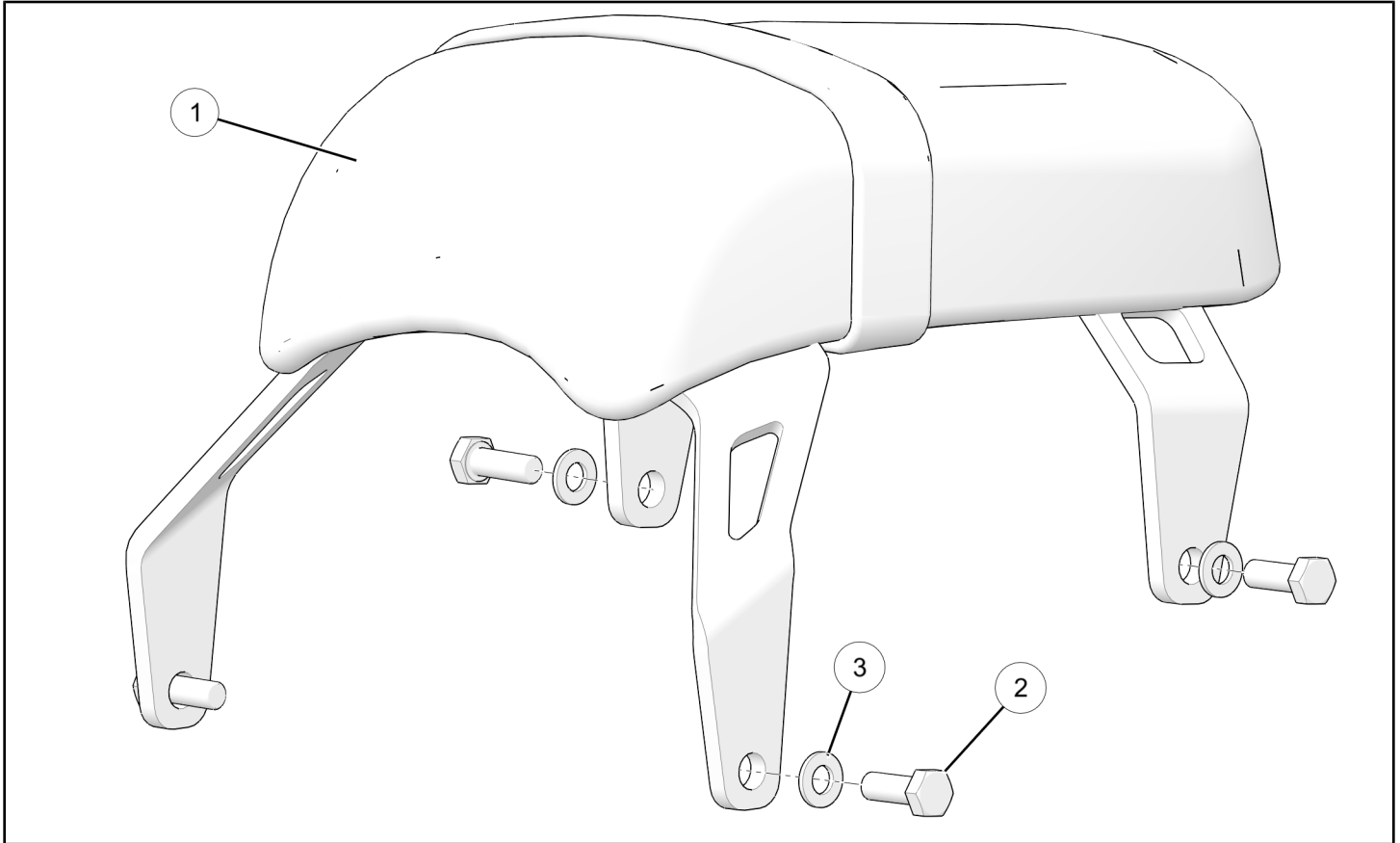

REF	QTY	PART DESCRIPTION	PART NUMBER
1	1	Assembly, Seat, Passenger, Without Backrest	2688078
2	4	Screw, Hex Head, M8 X 1.25 X 22	7520743
3	4	Washer, 8.4 X 16.0 X 1.6	7556305
	1	Instructions	9925881

## TOOLS REQUIRED

- Safety Glasses
- Clean Towel
- Socket Set, Hex Bit, Metric, Long
- Socket Set, Metric
- Torque Wrench

## IMPORTANT

Your Indian Scout® Bobber Passenger Seat Kit is exclusively designed for your vehicle. Please read the installation instructions thoroughly before beginning. Installation is easier if the vehicle is clean and free of debris. For your safety, and to ensure a satisfactory installation, perform all installation steps correctly in the sequence shown.

## ASSEMBLY TIME

Approximately 18 minutes

## INSTALLATION INSTRUCTIONS

1. Turn key or ignition switch to “OFF” position and remove key. If equipped with keyless fob, remove fob from proximity of vehicle.
2. Ensure motorcycle is parked on a flat surface, kickstand is fully extended, and vehicle is stable prior to installation.

- Remove driver seat from vehicle as per owner's manual.
- Remove and retain four fasteners (A) and remove LH (B) and RH (C) side strut covers. Carefully hang strut cover assemblies.

### CAUTION

Once all four fasteners are removed, fender will be loose and can move freely. Use caution to ensure damage does not occur to fender finish, taillight housings or wiring.

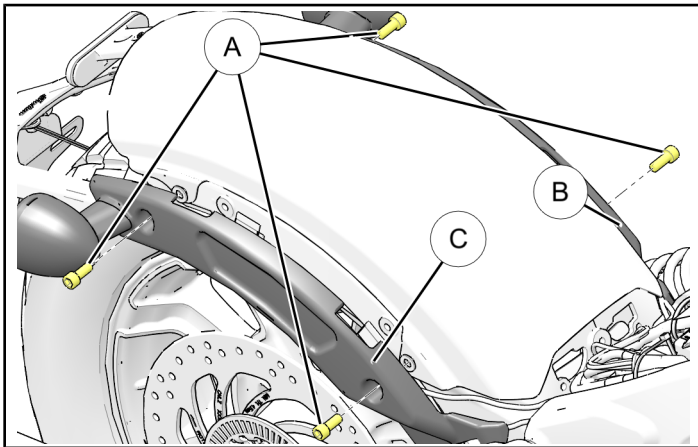

- Place a clean towel over top of fender to protect from scratches during installation.
- Lower seat (1) over top of fender (Seat from kit 2882853 shown) (**Do not set seat on fender**). Hand start four new screws (2) and washers (3). Remove towel. Torque screws to specification.

### TORQUE

18 ft. lbs. (24 Nm)

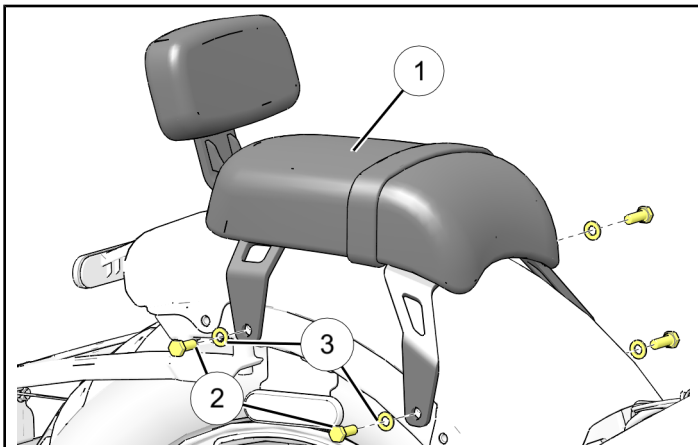

- Remove rubber blanks (D) from each strut cover.

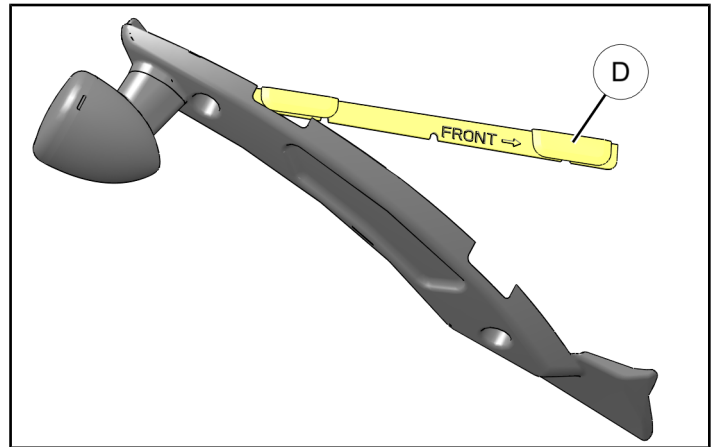

- Ensure rear light wiring is properly secured in strut covers (shown with arrow) and hand start strut cover and rear fender mounting screws (A). Confirm rear light wiring is positioned to avoid pinching and torque screws to specification.

### TORQUE

84 in. lbs. (9.5 Nm)

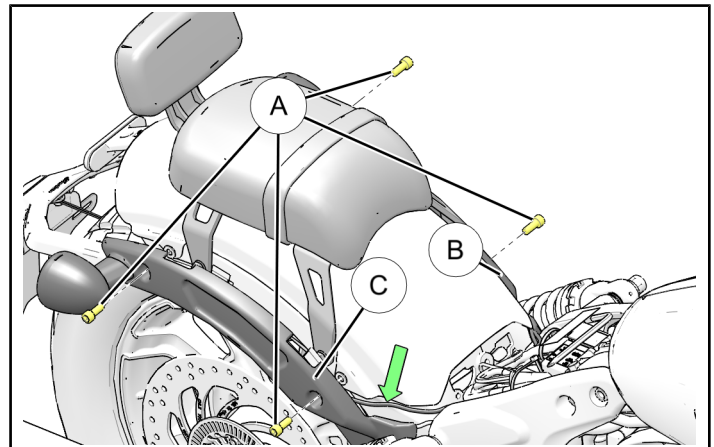

- Reinstall driver seat as per owners manual.

## FEEDBACK FORM

A feedback form has been created for the installer to provide any comments, questions or concerns about the installation instructions. The form is viewable on mobile devices by scanning the QR code or by clicking [HERE](#) if viewing on a PC.

