

SADDLEBAG QUICK RELEASE KIT



P/N 2884045

APPLICATION

All 2019 and newer Indian Motorcycle® Cruiser, Bagger, and Touring models

Verify accessory fitment at www.indianmotorcycle.com.

BEFORE YOU BEGIN

Read these instructions and check to be sure all parts and tools are accounted for. Please retain these installation instructions for future reference and parts ordering information.

REQUIRED SOLD SEPARATELY

The Indian Saddlebag Quick Release Kit contains parts for installation of the Indian Saddlebag Quick Release Kit only. For complete installation on Indian® Chief®, Chief® Classic, and Chief Dark Horse® models, the following hardware and one of the following pairs of Strut Covers is required (sold separately):

Chrome	Black
1. LH Strut Cover: PN 5139598-156	1. LH Strut Cover: PN 5139598-266
2. RH Strut Cover: PN 5139599-156	2. RH Strut Cover: PN 5139599-266
3. Four Screws: PN 7517272	3. Four Screws: PN 7517272

KIT CONTENTS

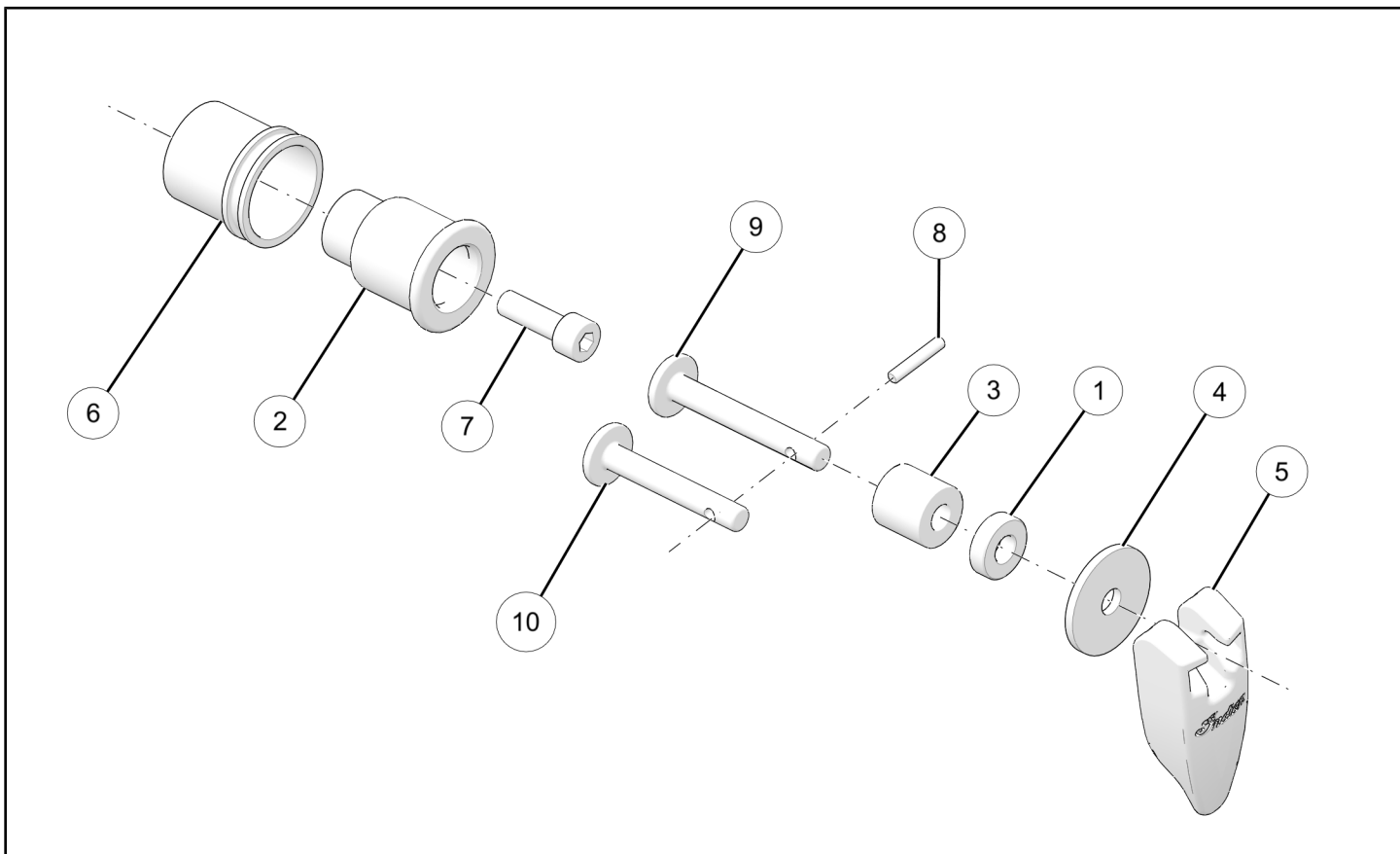

REF	QTY	PART DESCRIPTION	P/N AVAILABLE SEPARATELY
1	4	Spacer-Latch, Saddlebag	5139225
2	4	Spool-Trunk	5139711
3	4	Bushing-Anchor, Saddlebag	5414757
4	4	Washer-RBR, 3 mm X 350 OD X 8.6 OD	5414770
5	4	Cam-Latch, Saddlebag	5450622
6	4	Bushing-Spool, Trunk	5455069
7	4	Screw-Socket Head, M8 X 1.25 X 25	7520170
8	4	Pin-Dowel, 5/32 in. X 7/8 in.	7661970
9	4	Shaft-Anchor, Saddlebag, Hard	7662154
10	4	Shaft-Anchor, Saddlebag, Leather	7662284
	1	Instructions	9929348

TOOLS REQUIRED

- Safety Glasses
- Socket Set, Metric
- Torque Wrench

IMPORTANT

Your Indian Saddlebag Quick Release Kit is exclusively designed for your vehicle. Please read the installation instructions thoroughly before beginning. Installation is easier if the vehicle is clean and free of debris. For your safety, and to ensure a satisfactory installation, perform all installation steps correctly in the sequence shown.

INSTALLATION INSTRUCTIONS

CRUISER PREPARATION

GENERAL

1. Turn key or ignition switch to OFF position and remove key. If equipped with keyless fob, remove fob from proximity of vehicle.
2. Ensure motorcycle is parked on flat surface, kickstand is fully extended, and vehicle is stable prior to installation.

STRUT COVER REMOVAL

1. Remove and discard two screws (A) from each strut cover. Remove and discard left and right strut covers.

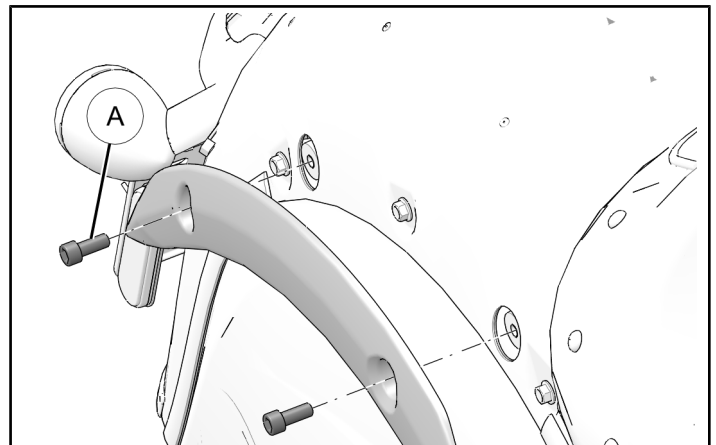

- Remove and discard two screws **B** and washers (not shown, if applicable) from each side of rear fender.

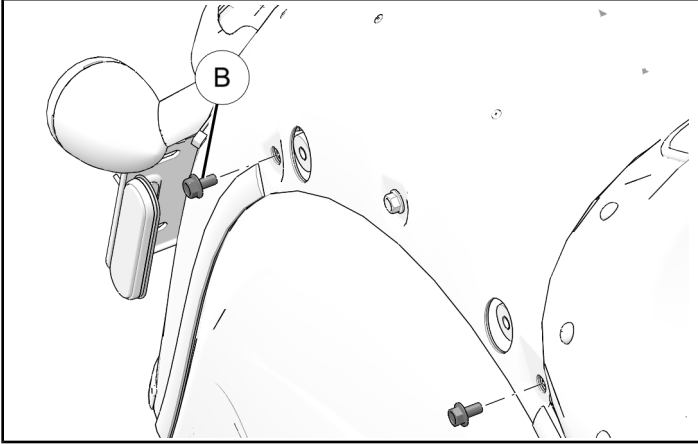

STRUT COVER INSTALLATION

- Identify new left and right strut covers (required, sold separately). Left cover is identified **L** inside and right cover is identified **R** inside as shown.

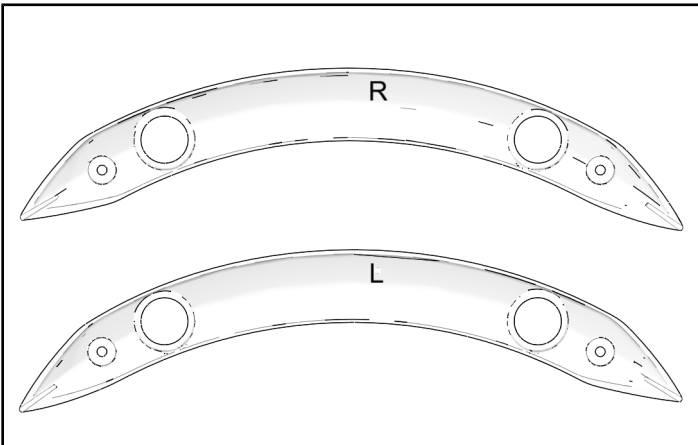

- Install left strut cover with two fasteners **A** (required, sold separately).

TORQUE

Two fasteners : 84 in. lbs. (9.5 Nm)

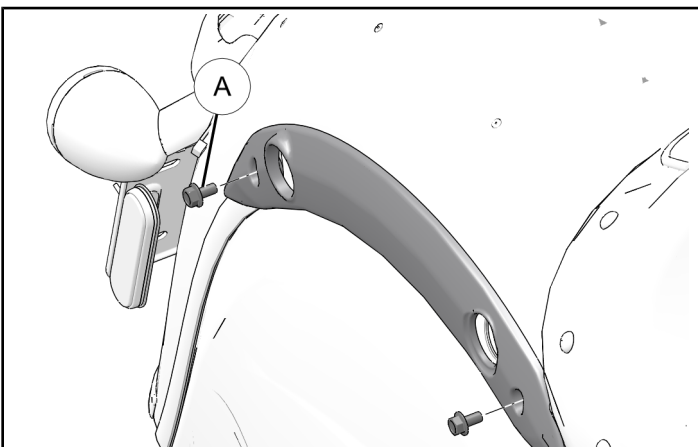

BAGGER AND TOURING PREPARATION

GENERAL

- Turn key or ignition switch to OFF position and remove key. If equipped with keyless fob, remove fob from proximity of vehicle.
- Ensure motorcycle is parked on flat surface, kickstand is fully extended, and vehicle is stable prior to installation.

SADDLEBAG REMOVAL

HARD SADDLEBAGS ONLY:

- Unlock electric saddlebag lock (if equipped).

TIP

Provided key can also be used in latch release buttons to unlock saddlebag lids.

- Remove and retain RH side cover.

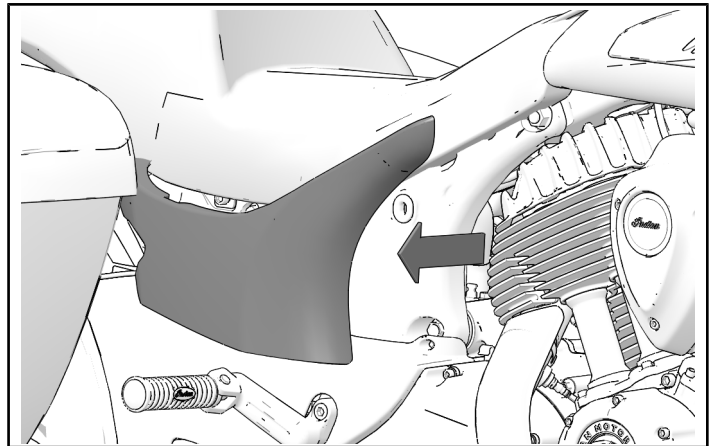

- Disconnect saddle bag lock wiring near seat.

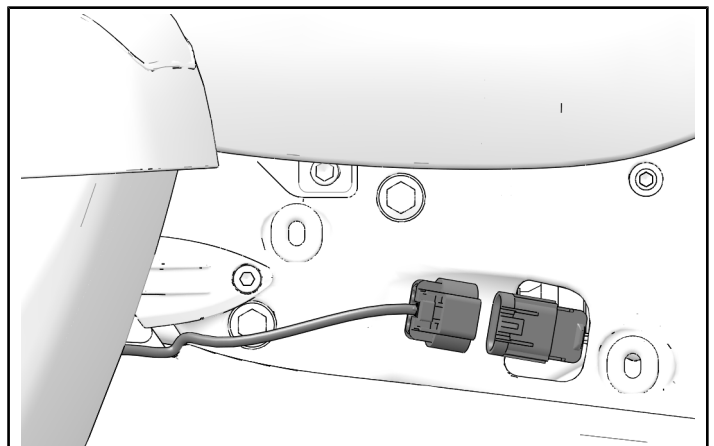

- Repeat this section for LH side.

HARD AND SOFT SADDLEBAGS:

- Open saddlebag.

2. Remove and discard two screws (A), securing saddlebag to strut cover.

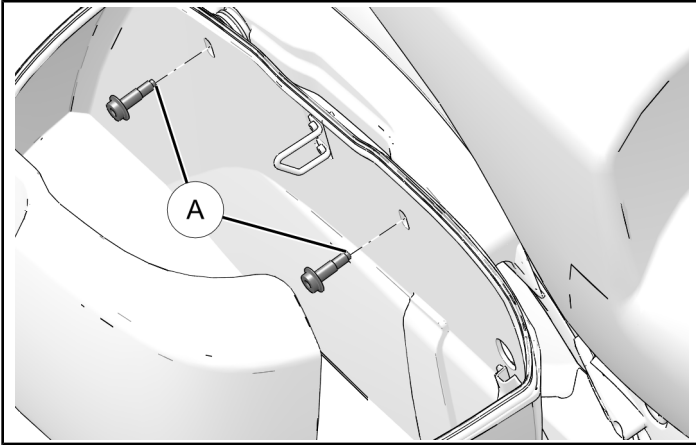

3. Tilt saddlebag away from frame and remove from vehicle.

NOTE

Lift leather saddlebags up-and-off spools before tilting off frame.

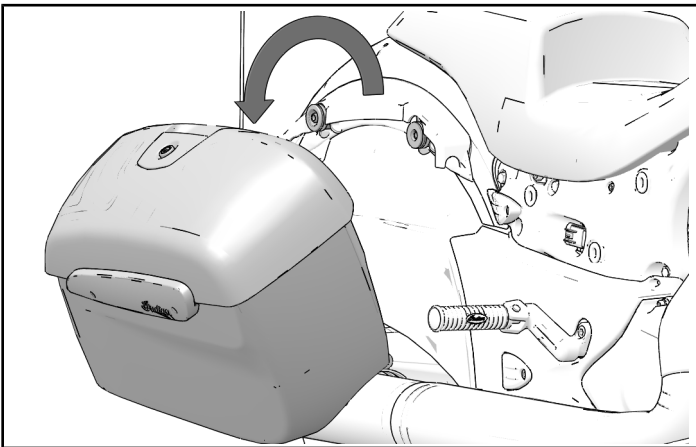

4. Repeat this section for opposite saddlebag.

SADDLEBAG SPOOL REMOVAL

1. Remove and discard two special fasteners (A), two spools (B), and two spool bushings (C) (if equipped) from strut cover.

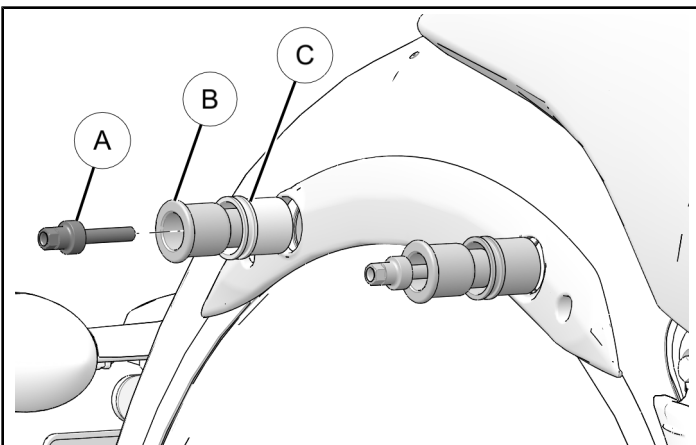

ACCESSORY INSTALLATION

1. Slide two spools (2) into two spool bushings (6) and install with two screws (7).

TORQUE

Two screws (7): 25 ft. lbs. (34 Nm)

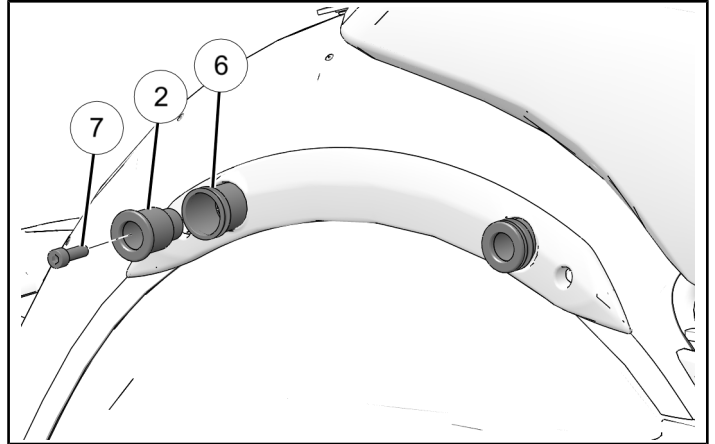

2. Stack two bushings (3), two spacers (1), and two washers (4) onto two pins (9) before passing hardware into fender-side of saddlebag.

IMPORTANT

Hard saddlebags use anchor (9) (longer)
Soft saddlebags use anchor (10) (shorter)

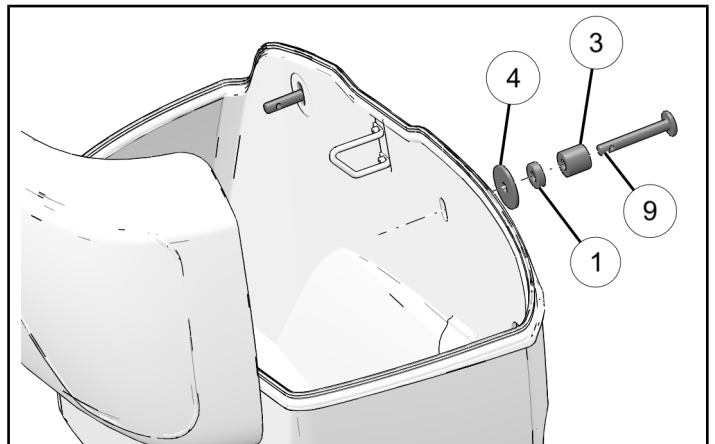

- Pass two dowels ⑧ through two pins ⑨ and snap one latch ⑤ onto each dowel ⑧.

IMPORTANT

Hard saddlebags use anchor ⑨ (longer)
Soft saddlebags use anchor ⑩ (shorter)

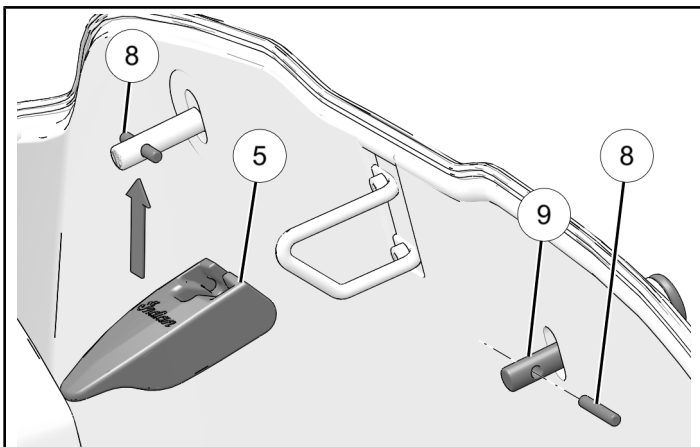

- Align latch/bushing assembly within spool assembly. Ensure soft saddlebag mounts hook onto spools.

- Hard saddlebags only:

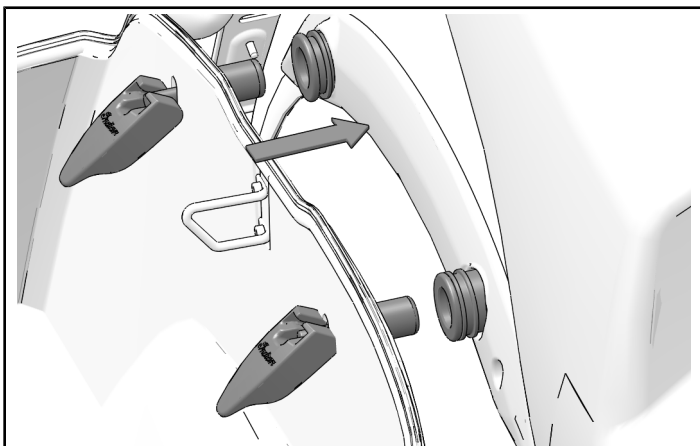

- Soft saddlebags only:

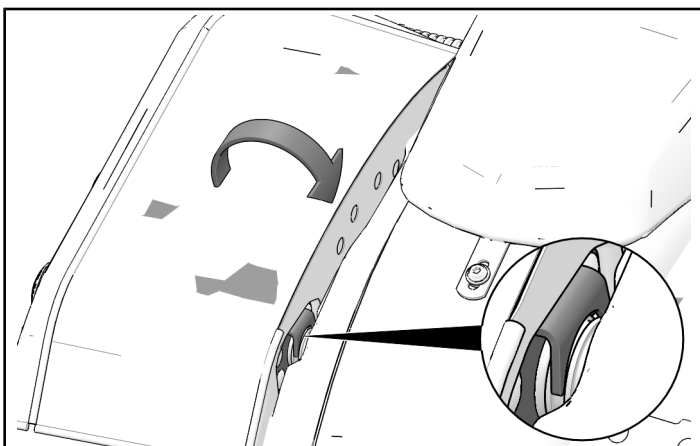

- Ensure bushings are fully seated within spools before closing quick release latches ⑤.

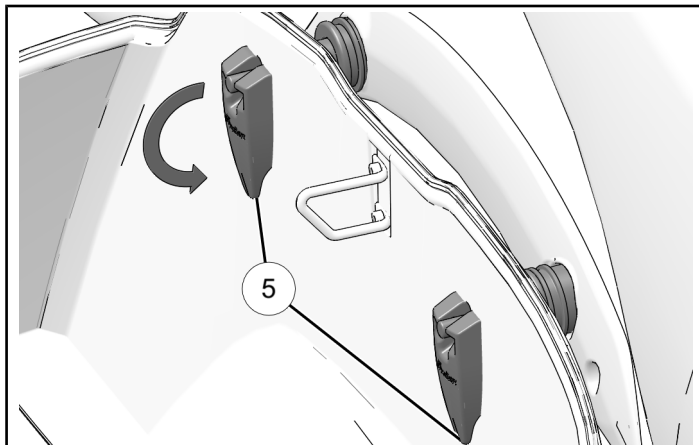

- Repeat this section for opposite side.

VEHICLE REASSEMBLY

GENERAL

- Reconnect saddlebag lock wiring near seat.
- Replace RH and LH side covers.

QUICK RELEASE SADDLEBAG REMOVAL

HARD SADDLEBAG REMOVAL

- Unlock electric saddlebag lock (if equipped).

TIP

Provided key can also be used in latch release buttons to unlock saddlebag lids.

- Remove and retain RH side cover.

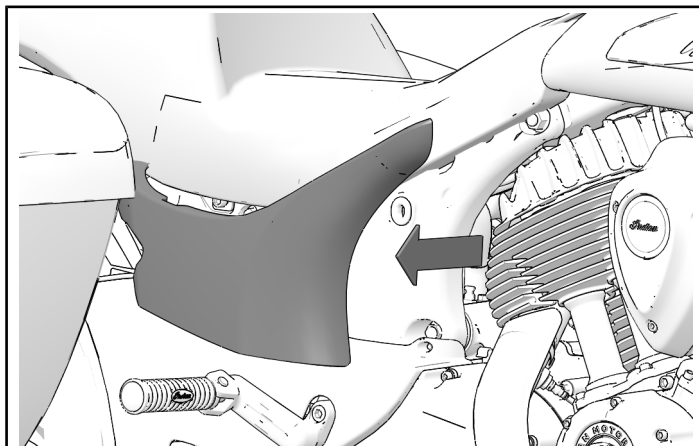

3. Disconnect saddle bag lock wiring near seat.

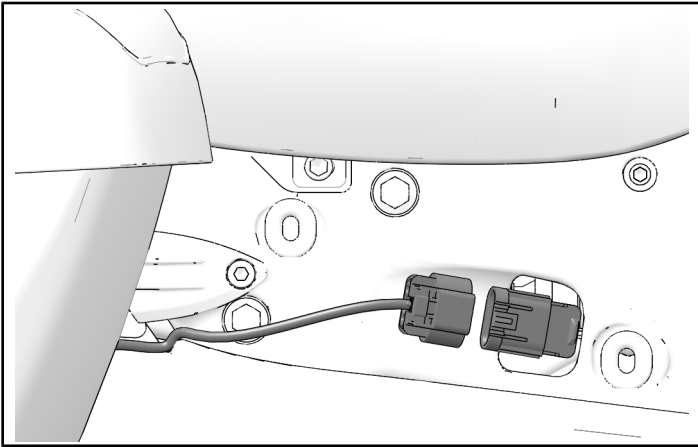

4. Repeat previous two steps for LH side.

5. Open saddlebag lid and flip two quick release latches up.

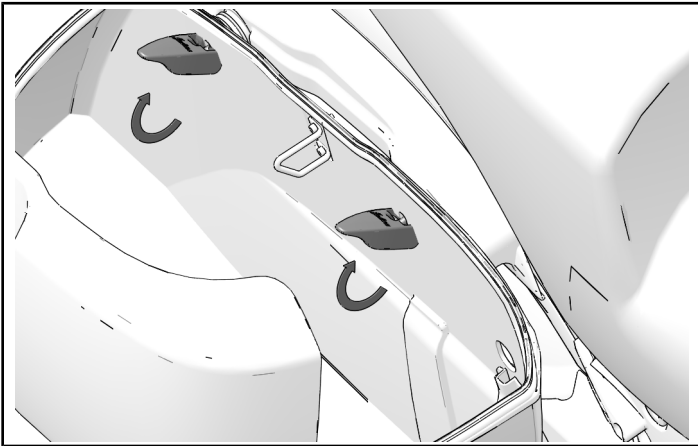

6. Tilt saddlebag away from frame and remove from vehicle.

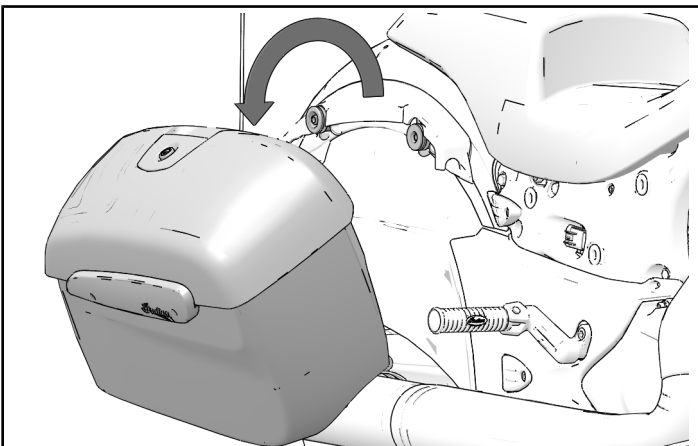

7. Repeat this section for opposite saddlebag.

SOFT SADDLEBAG REMOVAL

1. Open saddlebag lid and flip up two quick release latches.

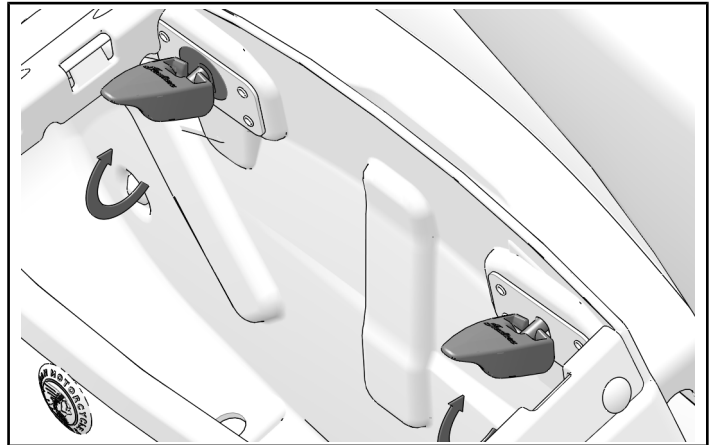

2. Lift saddlebag mounts off quick release spools and tilt away to remove from motorcycle.

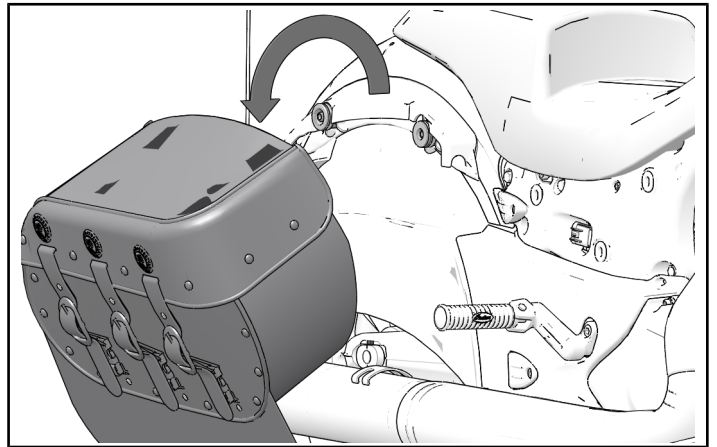

3. Repeat this section for opposite side.

FEEDBACK FORM

A feedback form has been created for the installer to provide any comments, questions or concerns about the installation instructions. The form is viewable on mobile devices by scanning the QR code or by clicking [HERE](#) if viewing on a PC.

FEEDBACK FORM

