

TRUNK BACKREST KIT



P/N MULTIPLE

BEFORE YOU BEGIN

Read these instructions and check to be sure all parts and tools are accounted for. Please retain these installation instructions for future reference and parts ordering information.

APPLICATION

Verify accessory fitment at www.indianmotorcycle.com.

KIT CONTENTS

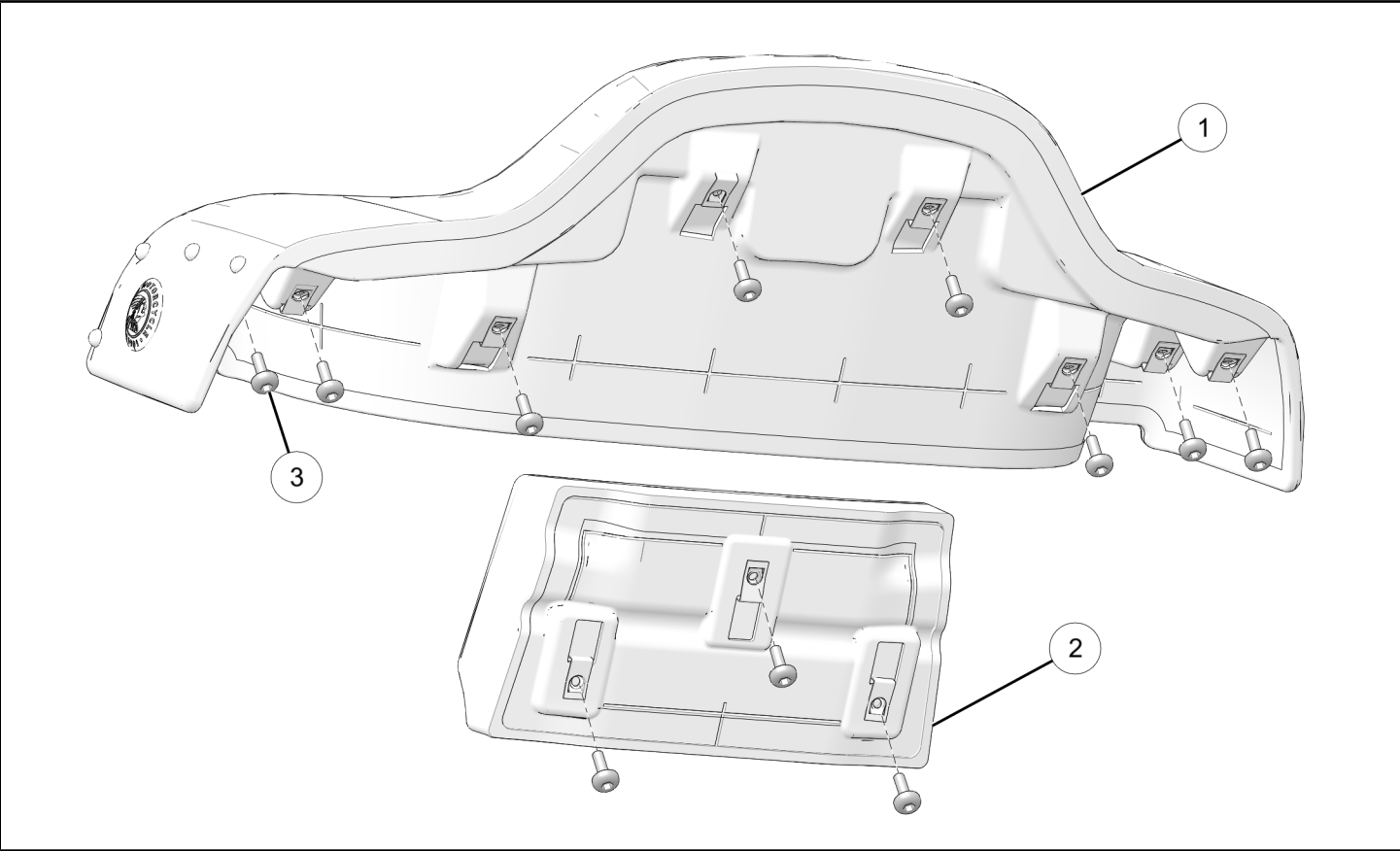

NOTICE

XXX = Indian Motorcycle® color code (For example: 266 = Black)

REF	QTY	PART DESCRIPTION	P/N AVAILABLE SEPARATELY
1	1	Lower Pad	n/a
2	1	Upper Pad	n/a
3	11	Button Head Screw - M6 x 1.0 x 15	7518484

TOOLS REQUIRED

- Safety Glasses
- Hex Key Set, Metric
- Torque Wrench

CONSUMABLES REQUIRED

- Cleaning Solution (99% water + 1% mild dishwashing detergent)
- Cloth, Non-Abrasive (Cheesecloth or equivalent)

IMPORTANT

Your Indian Motorcycle® Trunk Backrest Kit is exclusively designed for your vehicle. Please read the installation instructions thoroughly before beginning. Installation is easier if the vehicle is clean and free of debris. For your safety, and to ensure a satisfactory installation, perform all installation steps correctly in the sequence shown.

INSTALLATION INSTRUCTIONS

VEHICLE PREPARATION

GENERAL

1. Park motorcycle on a flat surface, fully extend kickstand, and make sure vehicle is stable.
2. Turn key or ignition switch to OFF position and remove key. If equipped with keyless fob, remove fob from proximity of vehicle.

ACCESSORY INSTALLATION

NOTICE

Vehicle hidden for clarity of images.

1. Remove trunk liner.
2. Remove and discard two screws and keep two washers (A).

NOTICE

If already equipped with trunk pads, remove and discard nine screws (circled). Remove and discard trunk pads.

CAUTION

Do not let the trunk lid drop when removing cable screws, it could result in injury.

3. Keep trunk lid open and set top ① and bottom ② pads in place.

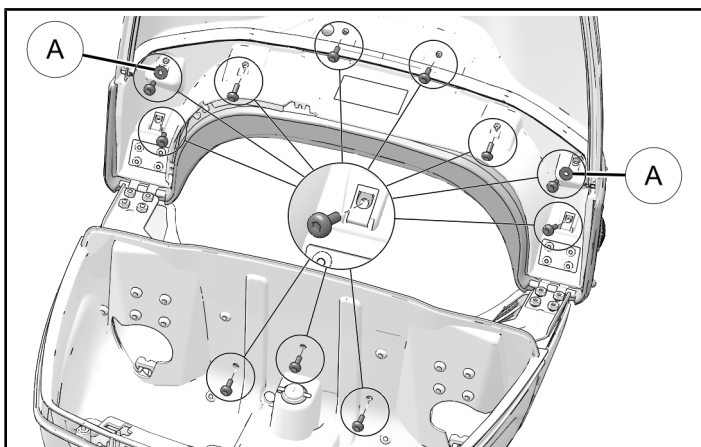
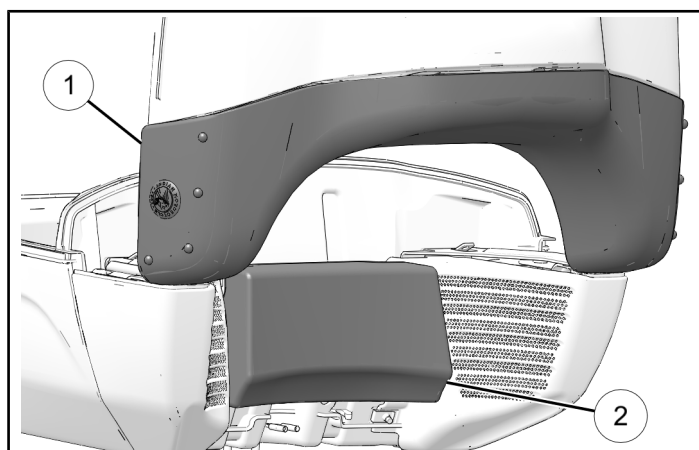

4. Install nine screws ③ to secure pads to trunk. Install two screws ③ with reserved washers ① and cable eyes. Torque to specification.

TIP

To make sure cable eyes swivel around fasteners, install cable eye on top of washer ①.

TORQUE

Trunk Pad Screws ③:
36 in-lbs (4 N·m)

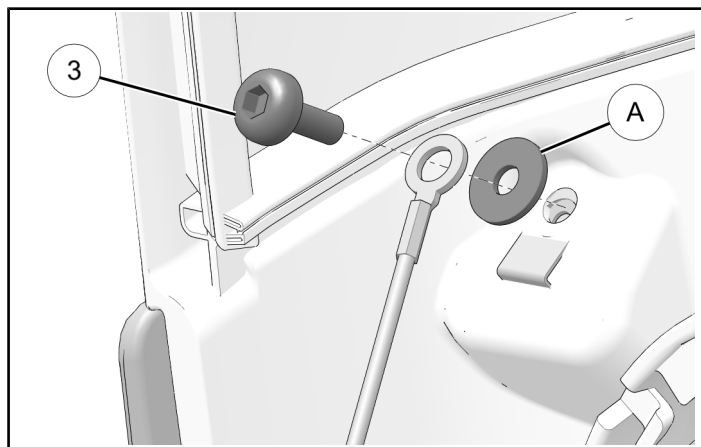

5. Clean pads and let air dry.

NOTICE

Leather will lose oils and condition with time and exposure to elements. Use *Leather Care Kit P/N 2205789* to gain back many oils lost to exposure and weather. Apply dressing with clean dry cloth. Use generously and allow to soak in. Wipe off excess and dry overnight. Under normal conditions, monthly application is sufficient.

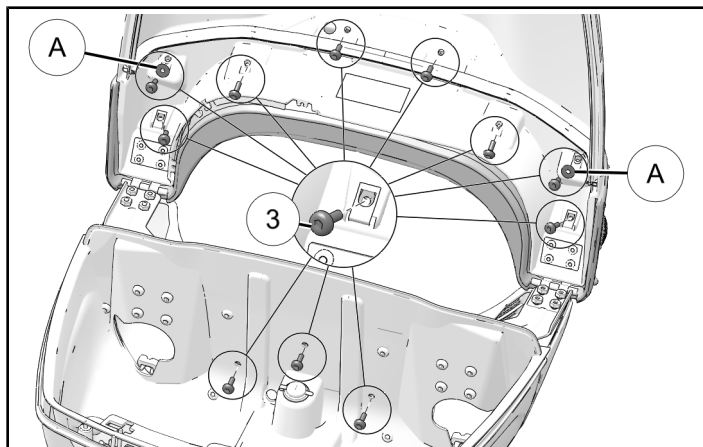

INSTRUCTION FEEDBACK FORM

A feedback form has been created for the installer to provide any comments, questions or concerns about the installation instructions. The form is viewable on mobile devices by scanning the QR code or by clicking [HERE](#) if viewing on a PC.

