

PASSENGER BACK REST PAD KIT



P/N MULTIPLE

APPLICATION

Verify accessory fitment at www.indianmotorcycle.com.

BEFORE YOU BEGIN

Read these instructions and check to be sure all parts and tools are accounted for. Please retain these installation instructions for future reference and parts ordering information.

KIT CONTENTS: 2879666-XXX SHOWN

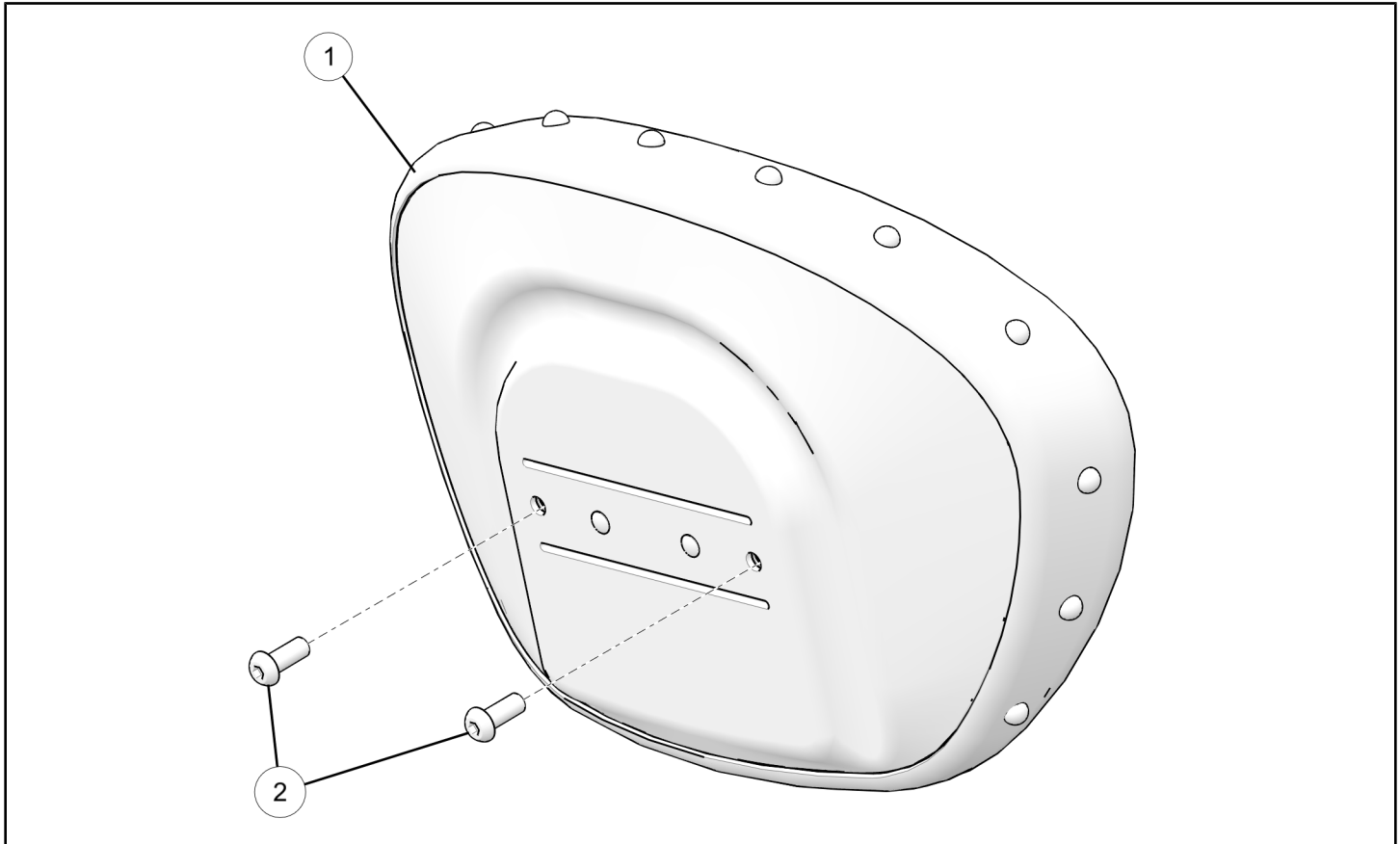

NOTE

XXX = Indian Motorcycle® color code (For example: 266 = Black)

REF	QTY	PART DESCRIPTION	P/N AVAILABLE SEPARATELY
1	1	Passenger Back Rest Pad	-
2	2	Screw, Button Head, M8 X 20 (2879666-XXX Only) Screw, Button Head, M8 X 16 (2883728-XXX Only) (Assorted Colors)	7518305 -

TOOLS REQUIRED

- Hex Key Set, Metric
- Torque Wrench

IMPORTANT

Your Indian Motorcycle® Passenger Back Rest Pad Kit is exclusively designed for your vehicle. Please read the installation instructions thoroughly before beginning. Installation is easier if the vehicle is clean and free of debris. For your safety, and to ensure a satisfactory installation, perform all installation steps correctly in the sequence shown.

INSTALLATION INSTRUCTIONS

VEHICLE PREPARATION

GENERAL

1. Turn key or ignition switch to **OFF** position and remove key. If equipped with keyless fob, remove fob from proximity of vehicle.
2. Ensure motorcycle is parked on a flat surface, kickstand is fully extended, and vehicle is stable prior to installation.

ACCESSORY INSTALLATION

1. Orient pad ① on back rest ④ as shown and install screws ②. Torque screws to proper specification.

TORQUE

Pad Screw (2879666-XXX Only) ②:
12 ft-lbs (16.3 N·m)

TORQUE

Pad Screw (2883728-XXX Only) ②:
18 ft-lbs (24.4 N·m)

FEEDBACK FORM

A feedback form has been created for the installer to provide any comments, questions or concerns about the installation instructions. The form is viewable on mobile devices by scanning the QR code or by clicking [HERE](#) if viewing on a PC.



NOTE

Kit 2883728-XXX: Install pad screw ② to match backrest mount ④ color.

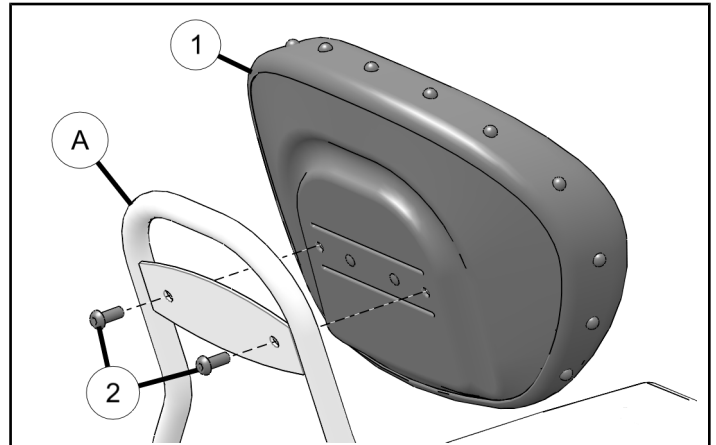

2. Clean pad with warm water, mild soap and soft cloth. Let air dry.

NOTE

See owner's manual for seat and pad care instructions.